

ASSEMBLY & INSTALLATION INSTRUCTIONS

Snaps Cone Pendant Large 401322

A1049

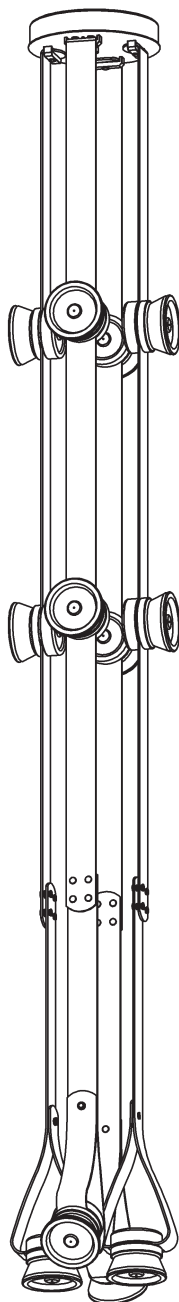

HUBBARDTON FORGE.

ASSEMBLY & INSTALLATION INSTRUCTIONS

A1049

Snaps Cone Pendant Large 401322

Component Parts

A	Canopy	Y	Toggle Anchor (8)
B	Canopy cap	Z	2" Stud (8)
C	Nipple	AA	Hook (8)
D	Cover Plate	AB	Wood Stud (8)
E	Lock Nut	AC	Adapter (8)
F	Ground Screw	AD	Knurled Nut (8)
G	Cupped Washer		
H	Cover (4)		
I	Nut (8)		
J	Knurled Screw (4)		
K	Long Leather Strap (4)		
L	Short Leather Strap (4)		
M	LED Stud (12)		
N	Knob (24)		
O	LED Board (24)		
P	Housing (12)		
Q	Female Snap (16)		
R	Male Snap (16)		
S	Glass (12)		
T	Frosted Lens (24)		
U	Metal Cone (12)		
V	Glass Cone (12)		
W	Short Knurled Screw (4)		
X	Cap (4)		



HUBBARDTON FORGE.

ASSEMBLY & INSTALLATION INSTRUCTIONS

A1049

Snaps Cone Pendant Large 401322

CAUTION: FAILURE TO INSTALL THIS FIXTURE PROPERLY MAY RESULT IN SERIOUS PERSONAL INJURY OR DEATH AND PROPERTY DAMAGE. We recommend installation by a licensed electrician. This product must be installed in accordance with applicable installation code(Q), by a person familiar with the construction and operation of the product and the hazards involved.*

Caution: Do not exceed maximum wattage noted on fixture. Use only recommended bulbs with fixture.

Please Note: After installation extra hardware and accessories are possible; our kits are used on multiple products.

To Install Fixture (Figure 1)

CAUTION: BE SURE POWER IS OFF AT THE MAIN BREAKER BOX PRIOR TO INSTALLATION.

1. Carefully unpack all components from the carton.
2. Locate canopy (A) and unscrew canopy cap (B) from nipple (C). Remove cover plate (D). Retain for later step. Nipple (C) and lock nut (E) do not need to be removed.
3. Thread wires in electrical box through hole in canopy (A) while moving canopy (A) into position. Using two machine screws (not provided) fasten canopy (A) to the electric box.

Note: A new electrical box comes with screws. When replacing a fixture, retain the existing screws for use with the new fixture.

4. Attach a pigtail lead to the canopy (A) using the ground screw (F) and cupped washer (G), found in kit bag.
5. Hold cover plate (D) close to canopy (A). Using suitable wire connectors (not provided), connect driver wires to supply wires (white to white and black to black). Connect all ground wires (bare copper or green to bare copper or green) together.

CAUTION: MAKE SURE WIRE CONNECTORS ARE TWISTED ON SECURELY, AND NO BARE WIRE IS EXPOSED.

6. Raise cover plate (D) to canopy (A). Align hole in cover plate (D) with nipple (C) and secure with canopy cap (B).
7. Follow steps on next page to continue installation.

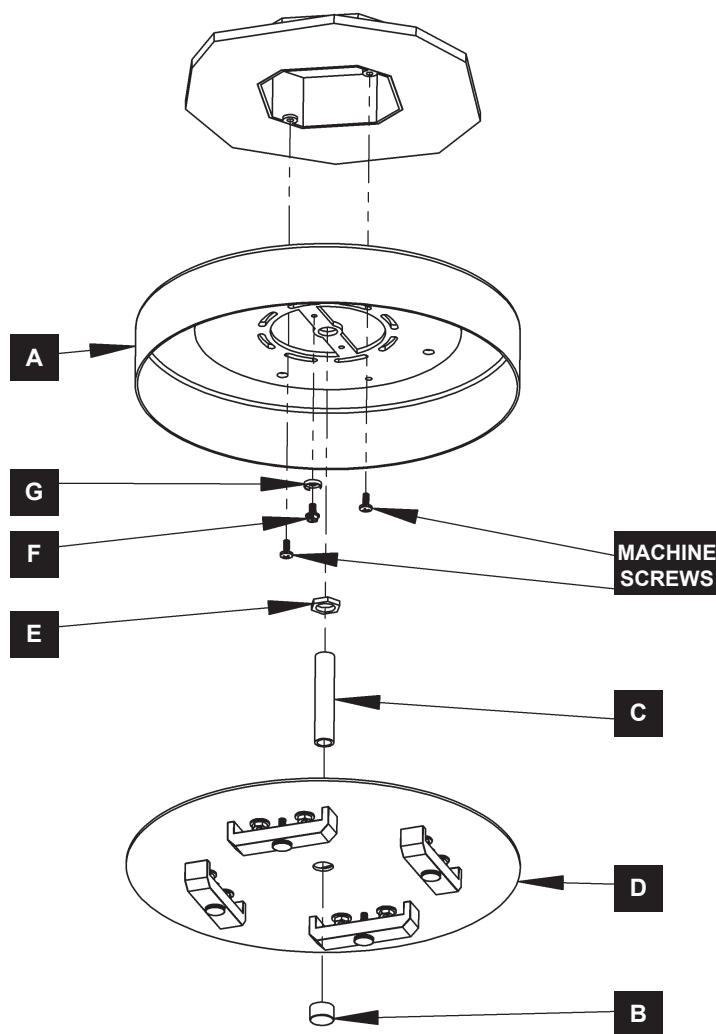

(Figure 1)



HUBBARDTON FORGE.

Snaps Cone Pendant Large 401322

To Install Leather To Canopy (Figure 2)

1. Remove knurled screw (J) from cover plate (D), then remove cover (H) and two nuts (I) from fixture studs. Retain these parts for later use.
2. Align holes in long leather strap (K) with fixture studs and secure with nuts (I).

Caution: *Be sure to tighten as this creates an electrical connection.*

3. Reattach cover (H) by threading knurled screw (J) into canopy (A). Knurled screw (J) should align with center hole of leather strap (K).
4. Repeat steps for remaining long leather straps (K).
5. Follow steps on next page to complete installation.

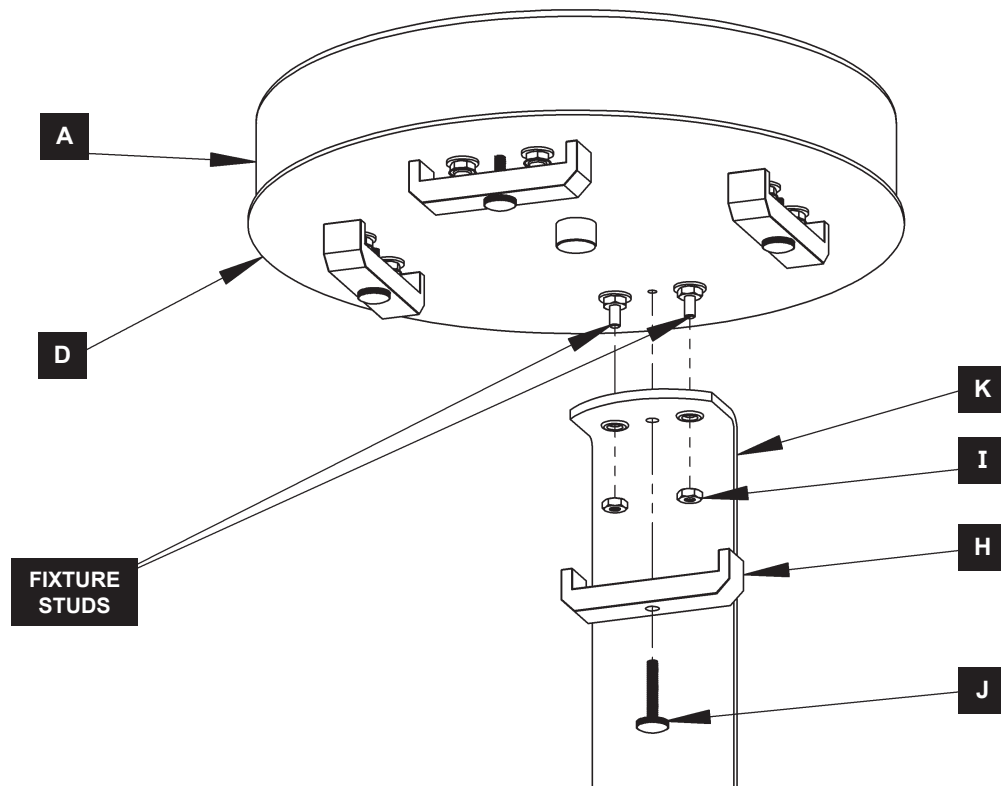

(Figure 2)



Snaps Cone Pendant Large 401322

To Connect Leather Straps *(Figure 3)*

1. Align female snaps (Q) on short leather strap (L) with male snaps (R) on long strap (K).
2. Press firmly to lock all snaps (Q & R) together.
3. Follow steps on next page to install LED Boards & Glass.

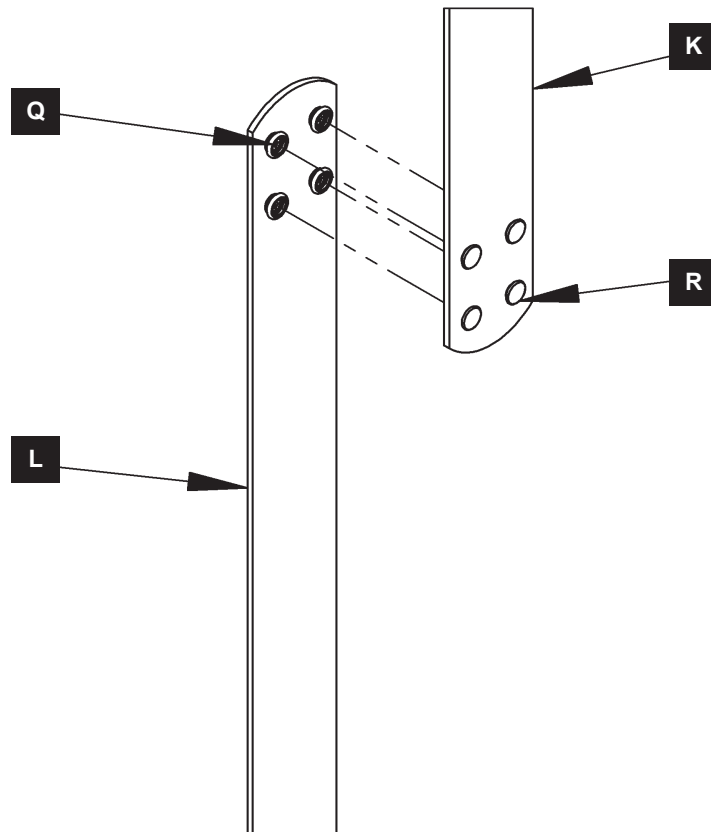

(Figure 3)



Snaps Cone Pendant Large 401322

To Install Glass (Figures 4A & 4B)

1. Locate lenses (T), housings (P) and LED boards (O).
2. Slide housing (P) over leather strap and center over male snaps (R).
3. Locate (+) side of fixture/leather strap. Align (+) side of LED board (O) with leather strap and pop led board onto snaps. Be sure both snaps on board engage fully.
4. Repeat steps for LED board (O) on opposite side, being sure (+) side is aligned with (+) side of fixture/leather strap (Q).
5. Locate lenses (T). Align clip on lens (T) with notch in LED board (O). Insert clip into notch and rotate lens (T) until it engages with LED board (O). Repeat for remaining lens (T).
6. Carefully unpack glass (S), metal cone (U), and glass cone (V).
7. Locate LED stud (M) with knobs (N) attached in kit bag. Remove one knob (N) and retain for later step.
8. Slide stud (M) through glass cone (V), lens (T), hole in leather strap, second lens (T) and glass (S).

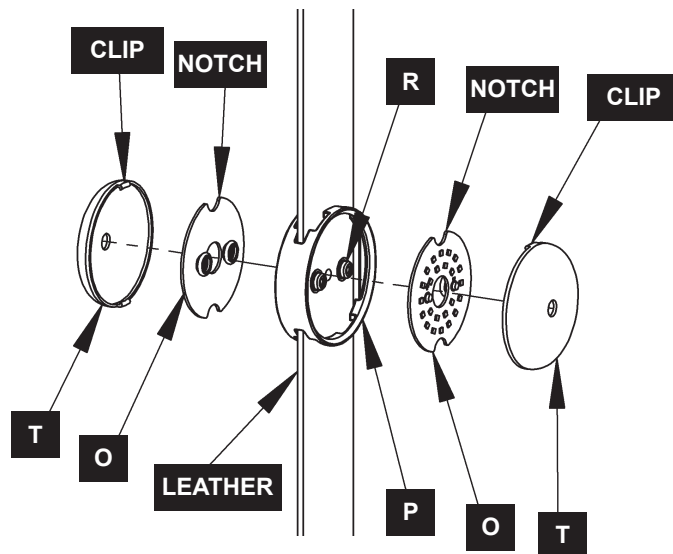

(Figure 4A)

- Note:** Be careful not to harm LED boards (O) when assembling.
9. Thread knob (N) onto stud (M) and tighten to secure glass (S & V) around housing (P).

Note: Be careful not to overtighten as this could break glass.

10. Repeat for remaining LED boards and glass.
11. Restore electricity at main breaker.

NOTE: If any LED Boards do not light, remove glass and lenses and check orientation of (+) and (-) sides of board. LED board might need to be rotated on leather strap.

12. Follow steps on following pages to complete install.

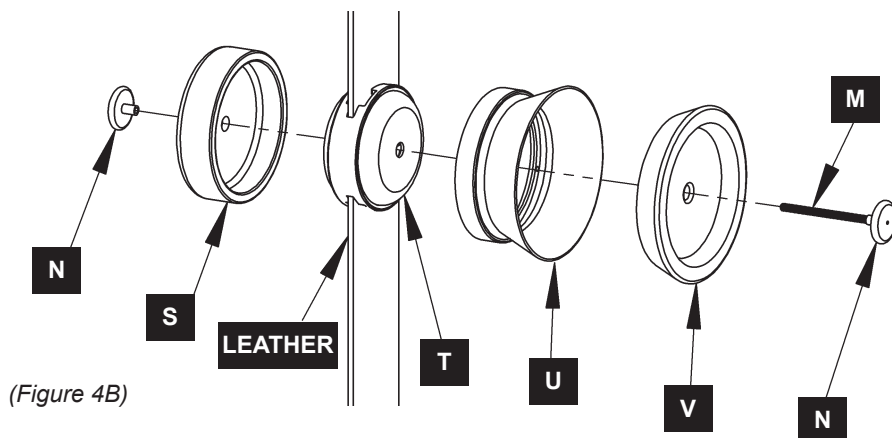

(Figure 4B)



ASSEMBLY & INSTALLATION INSTRUCTIONS

A1049

Snaps Cone Pendant Large 401322

To Loop Leather (Figure 5A & 5B)

1. Locate short knurled screw (W) and cap (X) found in kit bag.
2. Locate end of leather strap.
3. Carefully pull end up and align with other singular hole in leather strap.
4. Place short knurled screw (W) through both holes in leather strap. Thread cap (X) onto knurled screw (W) and tighten to secure.
5. There are (2) straps that will position the glass pointing downward and (2) straps that will hold glass at 45 degrees. Straps can be unsnapped and moved to desired locations.
6. See next pages for optional mounting instructions.

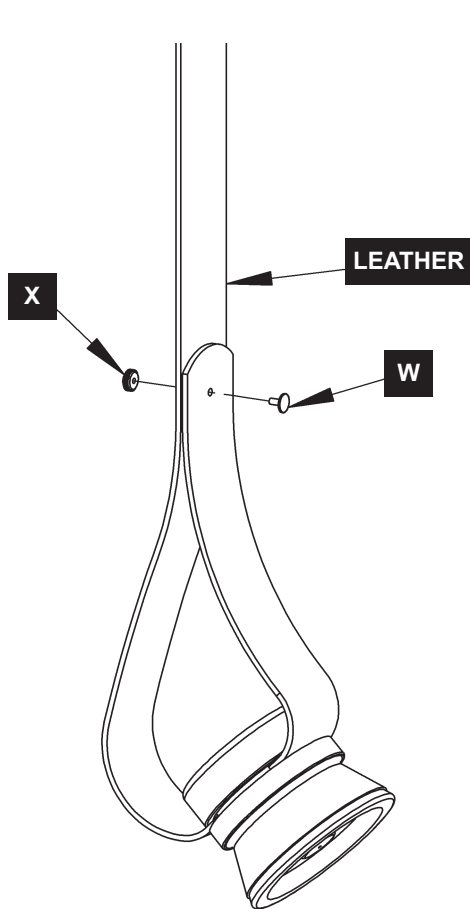

(Figure 5A)

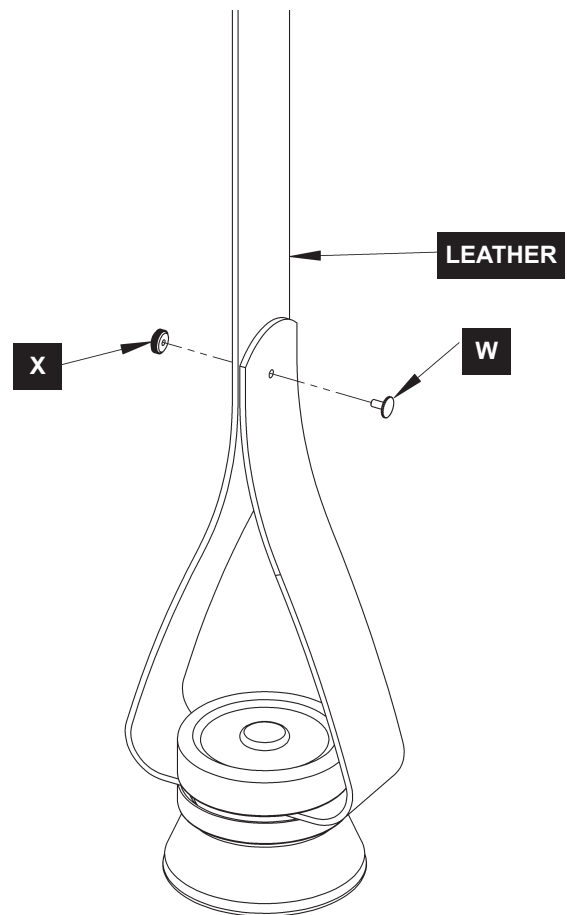

(Figure 5B)



HUBBARDTON FORGE.

Optional Mounting - Leather Hook

To Mount in Drywall - (Figure 6A)

1. Locate toggle anchor (Y), 2" stud (Z), hook (AA), all found in kit bag.
2. Drill 1/2" hole in ceiling/wall in desired location.
3. Thread toggle (Y) onto 2" stud (Z). Direction critical as toggle (Y) will fold onto stud (Z) when pushing into drywall.
4. Push toggle (Y) through hole until it's able to open. Pull stud (Z) back down until you feel toggle (Y) engage with backside of drywall.
5. Carefully thread hook (AA) onto stud (Z). Adjust length of stud in toggle so that stud doesn't stick through hook as that can scratch leather.
6. Raise leather strap, gently fold and install into hook (AA).

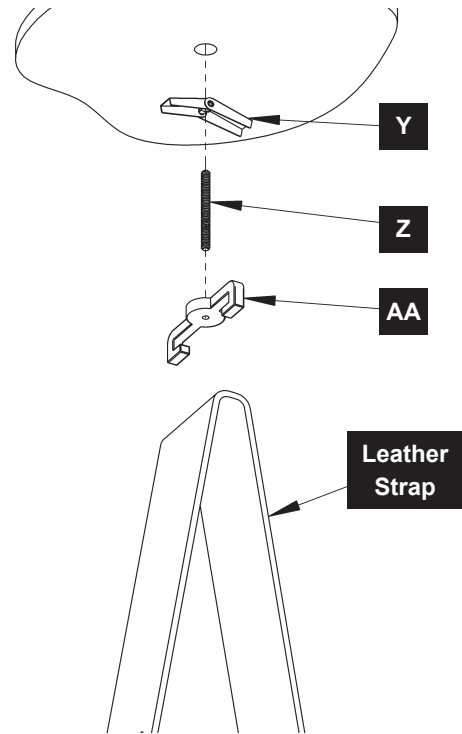

(Figure 6A)

To Mount in Wood - (Figure 6B)

1. Locate hook (AA) and wood stud (AB), found in kit bag.
2. Jam two nuts (provided in kit bag) together onto wood stud (AB). Thread into wood until only 5/16" of stud is left showing. Remove nuts.

Note: Nuts are to help install the stud without marking up threads.

3. Carefully thread hook (AA) onto wood stud (AB) until tight.
4. Raise leather strap, gently fold and install into hook (AA).

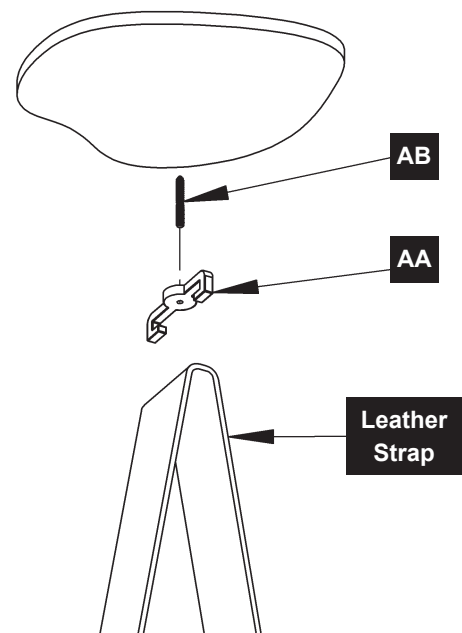

(Figure 6B)



Snaps Cone Pendant Large 401322

Optional Mounting - Adapter

To Mount in Drywall - (Figure 7)

1. Locate toggle anchor (Y), 2" stud (Z), adapter (AD), all found in kit bag.
2. Drill 1/2" hole in ceiling/wall in desired location.
3. Thread toggle (Y) onto 2" stud (Z). Direction critical as toggle (Y) will fold onto stud (Z) when pushing into drywall.
4. Push toggle (Y) through hole until it's able to open. Pull stud (Z) back down until you feel toggle (Y) engage with backside of drywall.
5. Thread knurled nut (Y) onto stud (Z) and tighten to drywall. Adjust stud (Z) until there is 3/8" of stud sticking through knurled nut (AD).
6. Carefully thread adapter (AC) onto stud (Z) and up to knurled nut (AD) until tight.
7. Remove one knob (N) from LED stud (M)
8. Slide LED stud (M) through glass cone (V), metal cone (U), hole in leather strap, and glass (S).

Note: Be careful not to harm LED boards when assembling.

9. Press glass (S) up to adapter (AC) and thread LED stud (M) into adapter (AC) until all parts are tight.

Note: Be careful not to overtighten as this could break glass.

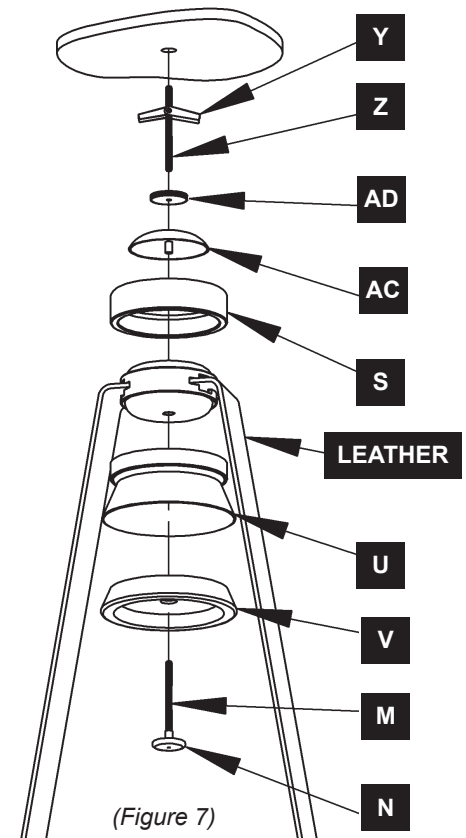

(Figure 7)

To Mount in Wood - (Figure 7B)

1. Locate adapter (AC) and wood stud (AB), found in kit bag.
2. Thread two nuts (provided in kit bag) together onto wood stud (AB) and jam together. Thread into wood until only 3/8" of stud is left showing. Remove nuts.

Note: Nuts are to help install the stud without marking up threads.

3. Carefully thread adapter (AC) onto wood stud (AB) until tight.
4. Remove one knob (N) from LED stud (M)
5. Slide LED stud (M) through glass cone (V), metal cone (U), hole in leather strap, and glass (S).

Note: Be careful not to harm LED boards when assembling.

6. Press glass (S) up to adapter (AC) and thread LED stud (M) into adapter (AC) until all parts are tight.

Note: Be careful not to overtighten as this could break glass.

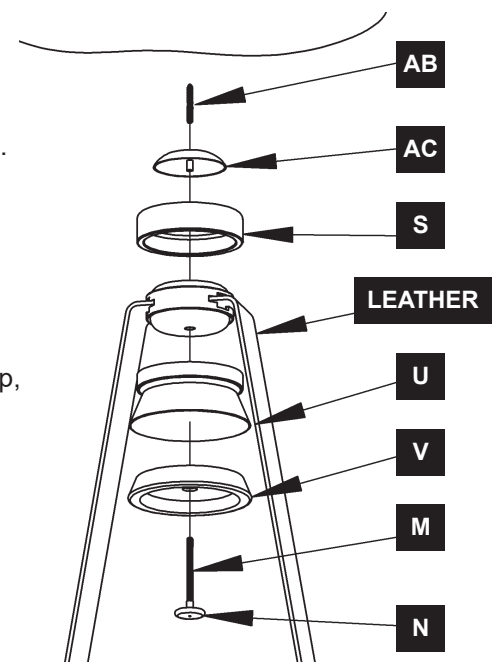

(Figure 7B)



HUBBARDTON FORGE.

ASSEMBLY & INSTALLATION INSTRUCTIONS

A1049

Snaps Cone Pendant Large 401322

IMPORTANT NOTES:

- Additional leather straps and LED modules can be ordered individually. Contact the dealer from which you purchased this product for more information.
- Due to electrical components included with this fixture, a max of (5) additional LED modules can be added.
- If more than the allowed LED modules are desired, please contact dealer about a custom fixture.
- Leather extension straps without LEDs can also be purchased.

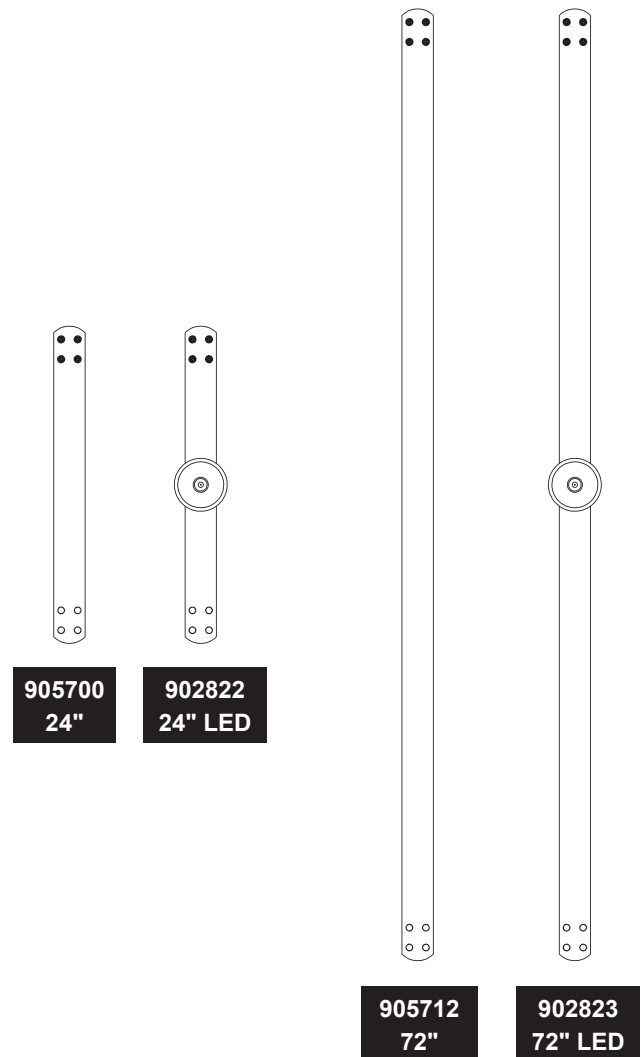

Product Care & Cleaning:

Leather: Leather is a natural product and straps can have variations in color and imperfections in the hides. This leather can be oiled or dyed to enhance the look. For cleaning, wipe entire surface with a soft cloth and cool water to even out any abrasions or stains. Do not spot rub, for it will darken only that area. Occasional use of Aniline Leather Cleaner, Conditioner, & Protector, or Aniline Leather Maintenance Kit is recommended. Other leather cleaners such as saddle soap or household cleaners that may contain harsh chemicals, alcohol, or ink removers should never be used.

If you need further assistance, or find that you are missing any parts, please contact the dealer from which you purchased this product. We hope you enjoy your fixture!

** Hubbardton Forge will not be liable for injury or damage caused by improper installation, lamping or use of this fixture.*



HUBBARDTON FORGE.