

Torso Table Lamp 37 & 57 by Krøyer-Sætter-Lassen

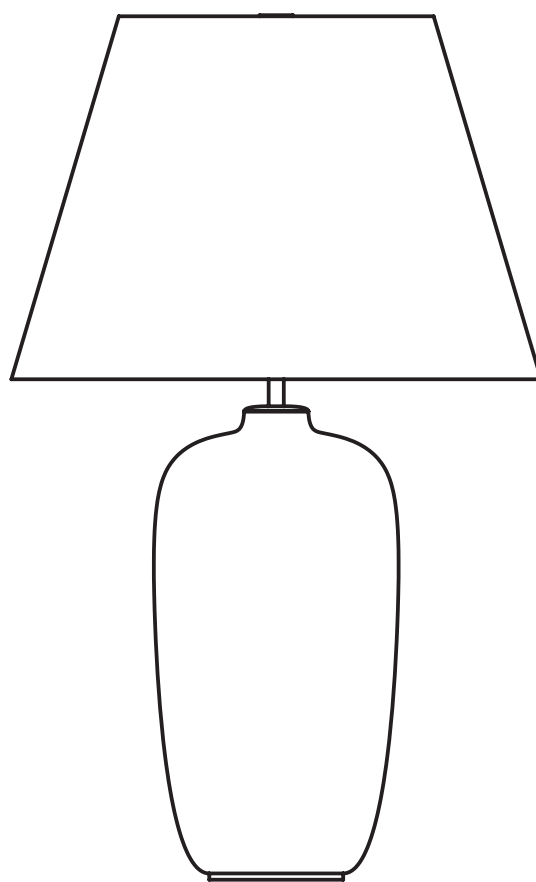
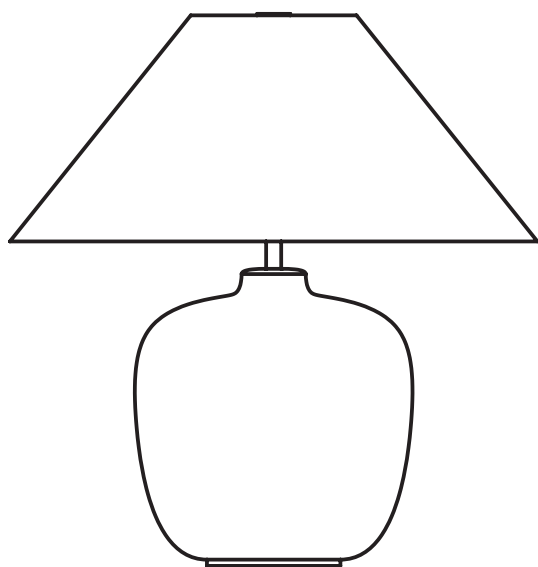

MENU

Congratulations

Congratulations on your new lamp designed by Krøyer-Sætter-Lassen. We hope you will enjoy using this lamp and follow these instructions to ensure correct installation. These instructions are provided for your safety. It is important that the instructions are read carefully and completely before assembling.

This Assembly Instruction cover below items

Torso Table Lamp 37

Torso Table Lamp 57

Component overview and technical details

1 pc. Torso Table Lamp 37, with unglazed ceramic base, linen shade with PC backing, 1 pc. lamp holder for E12 bulb (included), bronzed brass, touch dimmer (3 steps), 2 m black textile covered PVC cord with plug.

Bulb specification

E12, A++, 4 watt, dimanble (in case own bulb is purchased max 60 Watt)

Color temperature - 2700 K

RA > 90

Lumen - 350 lm

1 pc. Torso Table Lamp 57, with glazed ceramic base, linen shade with PC backing, 1 pc. lamp holder for E26 bulb (included), brushed brass, touch dimmer (3 steps), 2 m black textile covered PVC cord with plug.

Bulb specification

E26, A++, 6 watt, dimanble (in case own bulb is purchased max 60 Watt)

Color temperature - 2700 K

RA > 90

Lumen - 500 lm

All the electrical components are either UL or ETL certified.

Care and maintenance

Please see care instructions on www.menuspace.com

Environmental Guidelines

Menu A/S have chosen to use Polystyrene (PS) material to replace PVC material. The PS material is not as UV and heat resistant as PVC, but when LED bulbs are used the effect of UV emittance and heating levels will be minimized. Furthermore please note that if incandescent or halogen bulbs are used, the stronger UV emittance and heat can influence the original appearance of the PS shade by starting a yellowing process which cannot be reversed.

BE SURE THE ELECTRICITY TO THE WIRES YOU ARE WORKING ON IS SHUT OFF; EITHER THE FUSE IS REMOVED OR THE CIRCUIT BREAKER IS TURNED OFF.

Please check the specific rules for electrical installation work in your country.

Some countries may require an authorised electrical contractor.

IMPORTANT

If you have any problems regarding the electrical installation, contact a certified electrician. Always shut off power to the circuit before starting installation work.

The external flexible cable or cord of this luminaire cannot be replaced. If the cord is damaged, the luminaire shall be destroyed.

WARNINGS

Dispose of plastic bag from packaging and do not allow children to play with it.

- Keep product well out of children's reach.

- Do not attempt installation of product if you are not competent to do so yourself.

- Consult a professionally qualified electrician if in any doubt.

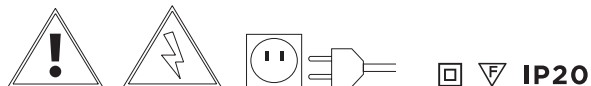

1

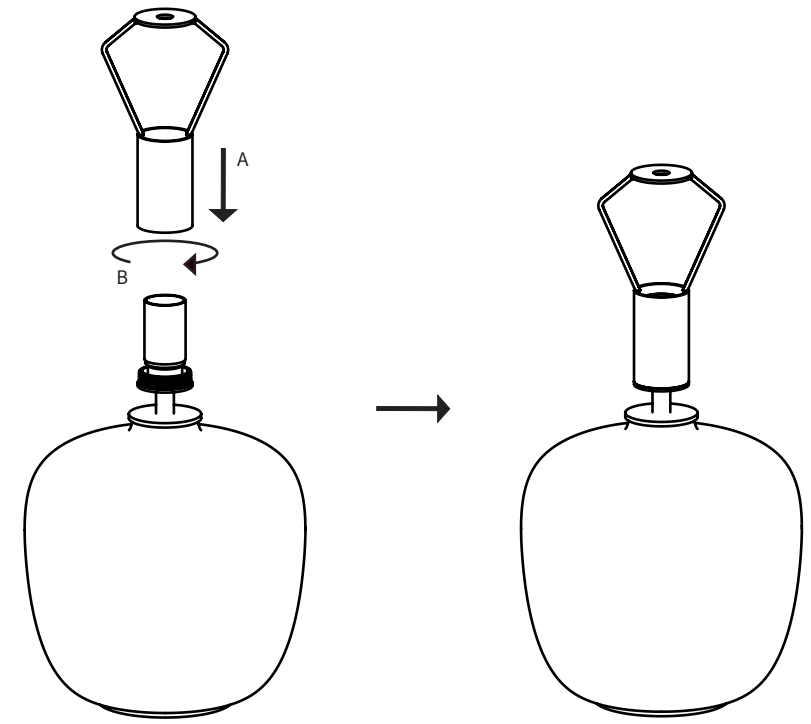

2

