

**PHILIPS**

hue personal  
wireless  
lighting

Slim Downlight



HUE serial number



User manual  
Notice d'emploi  
Manual de usuario

Incl.

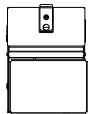
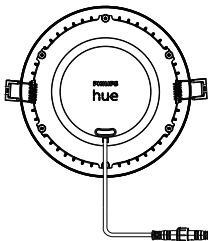

3x

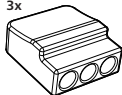

Excl.

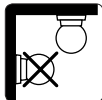
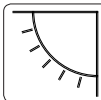
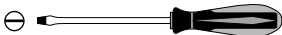
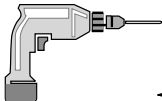

- EN** **WARNING-Risk of fire or electric shock. Slim Downlight installation requires knowledge of luminaire electrical systems. If not qualified, do not attempt installation. Contact a qualified electrician.**
- FR** **AVERTISSEMENT-Risque d'incendie ou de choc électrique. L'installation du plafonnier mince nécessite une connaissance des systèmes électriques des luminaires. Si vous n'êtes pas qualifié, ne tentez pas l'installation. Contactez un électricien qualifié.**
- ES** **ADVERTENCIA: Riesgo de incendio o descarga eléctrica. La instalación del empotrado delgado requiere conocimiento de los sistemas eléctricos de las luminarias. Si no está calificado, no intente realizar la instalación. Póngase en contacto con un electricista calificado.**

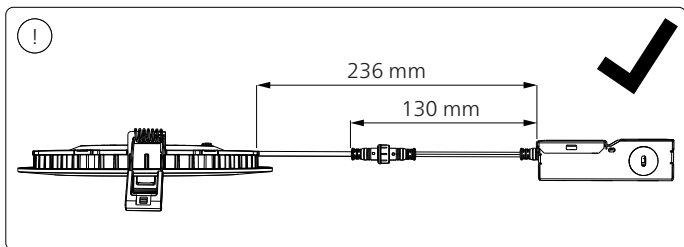
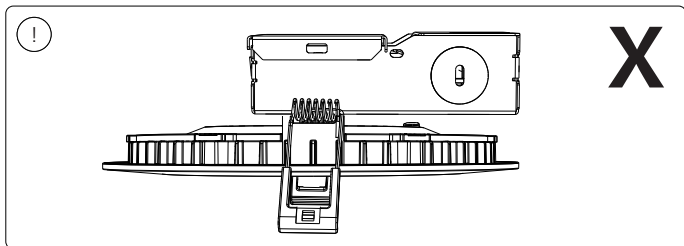
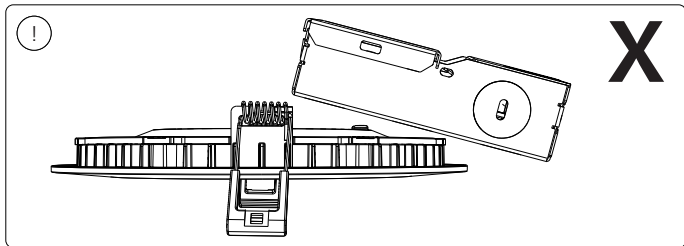

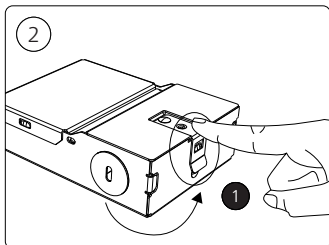
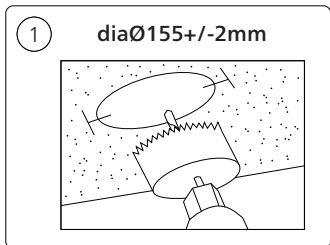
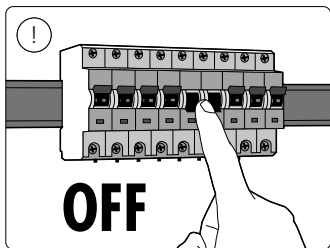
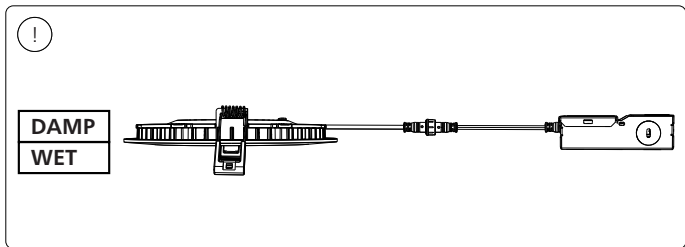

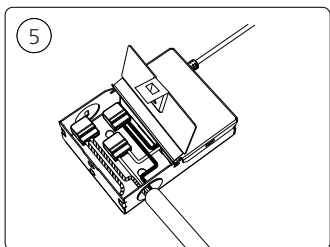
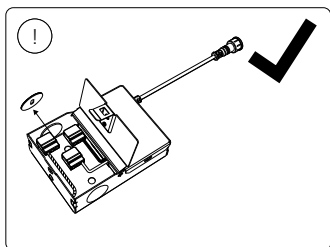
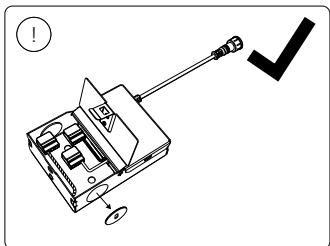
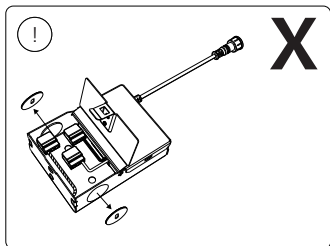
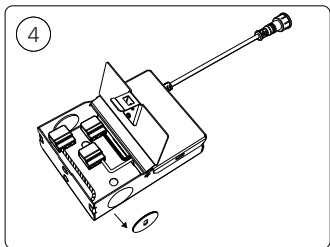
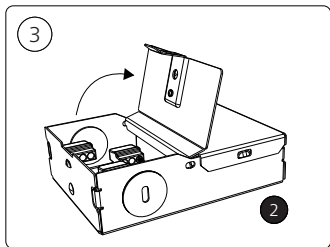

6

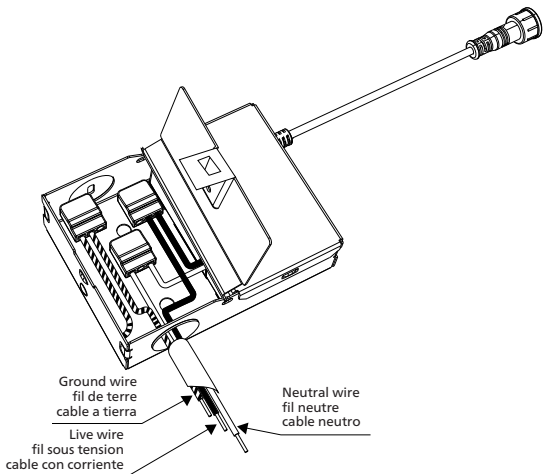

Neutral 18AWG input wire

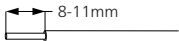

Live, 18AWG input wire

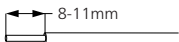

Ground, 18AWG input wire

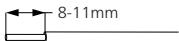

1. Insert ground wire into connector with green yellow wire;
2. Insert live wire into connector with black wire;
3. Insert neutral wire into connector with white wire

**FR**

Fil d'entrée neutre, 18 AWG

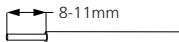

Fil d'entrée sous tension, 18 AWG

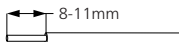

Fil d'entrée de terre, 18 AWG

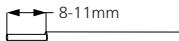

1. Insérez le fil de terre dans le connecteur avec le fil jaune vert.
2. Insérez le fil sous tension dans le connecteur avec le fil noir.
3. Insérez le fil neutre dans le connecteur avec le fil blanc.

**ES**

Neutro, cable de entrada de 18 AWG

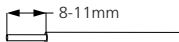

Cable de entrada con corriente de 18 AWG

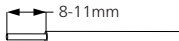

Cable de entrada a tierra de 18 AWG

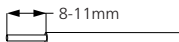

1. Inserte el cable a tierra en el conector con el cable verde y amarillo;
2. Inserte el cable con corriente en el conector con el cable negro;
3. Inserte el cable neutro en el conector con el cable blanco



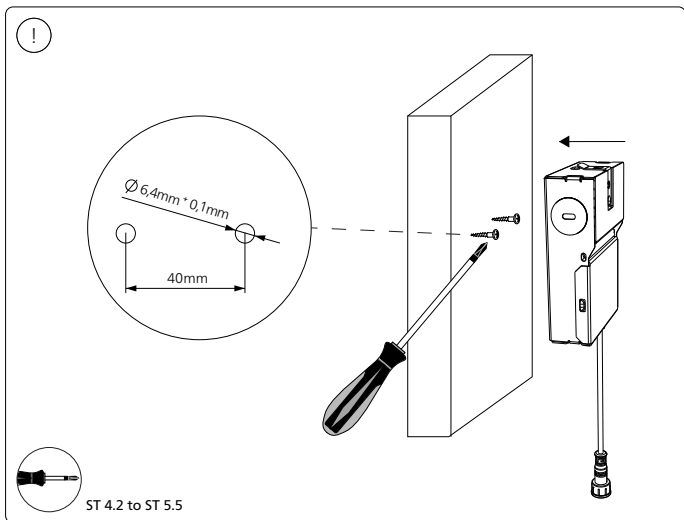
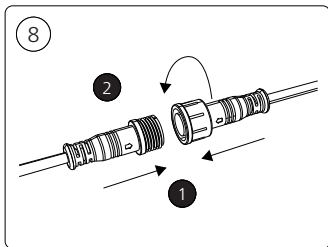
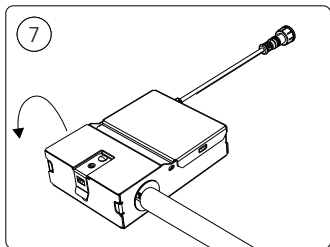

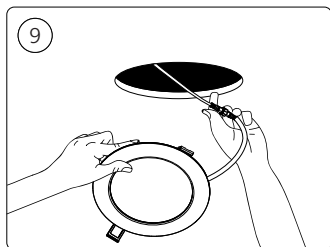
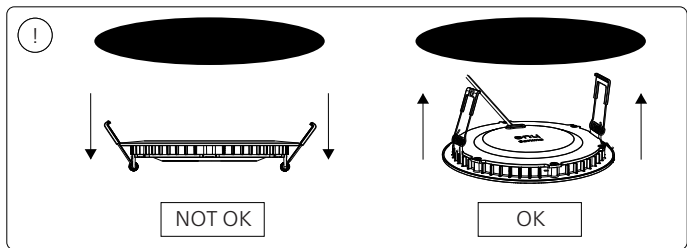

10

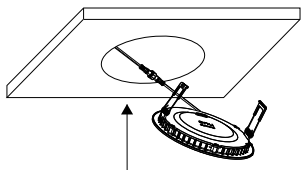

!

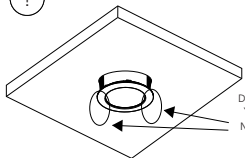

DO NOT PLACE  
YOUR HAND  
NE PAS POSER  
LA MAIN  
NO PONGA  
LA MANO

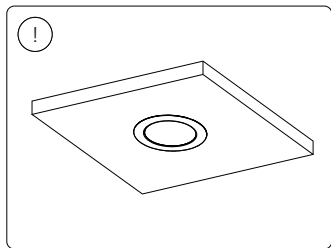
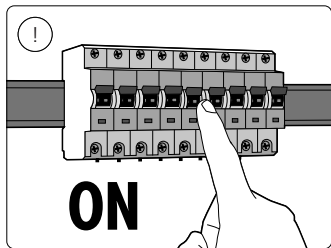

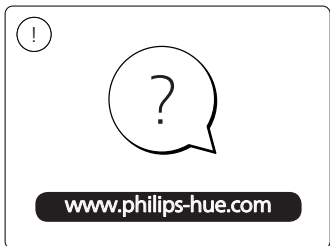
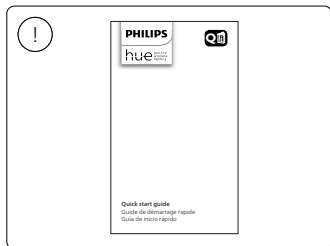
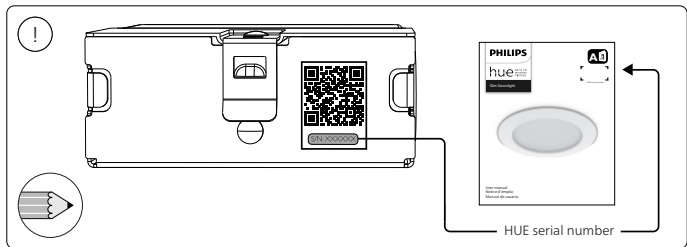







Signify North America Corporation  
400 Crossing Blvd, Suite 600  
Bridgewater, NJ 08807, USA

Signify Canada Ltd./Signify Canada Ltée.  
281 Hillmount Road,  
Markham, ON, Canada L6C 2S3

Questions or Comments / Questions ou commentaires :  
1-800-555-0050

© 2022 Signify Holding  
All rights reserved

[www.philips-hue.com](http://www.philips-hue.com)  
9290034792  
4422 956 32511  
Last update: 04/2022