

# ASSEMBLY INSTALLATION INSTRUCTIONS

---

Model #: DVSN523LACxxxx  
DVSN523LACxxxx-xx



#### Limited Factory Warranty

This product is manufactured by AFX Inc. AFX warrants this fixture is free from defects in materials and workmanship when installed and used under normal operating conditions for a period of 1 year Non-Electrical parts from date of purchase. This warranty covers all component parts and extends only to replacement of defective fixture or components; it does not cover failure due to improper installation, misuse, mishandling or damage incurred in transit. Limited lifetime for motor and 5 years for light source.

# Safety Instructions:

**READ ALL SAFETY INFORMATION AND INSTALLATION INSTRUCTIONS BEFORE YOU BEGIN INSTALLING THE FAN. IF YOU ARE NOT FAMILIAR WITH NATIONAL AND LOCAL ELECTRICAL CODES AND BASIC ELECTRICAL WIRING PROCEDURES WE RECOMMEND THAT YOU HAVE A QUALIFIED ELECTRICIAN INSTALL YOUR NEW CEILING FAN. SAVE INSTRUCTIONS.**

- To avoid the risk of electrical shock be sure to shut off power at the main fuse or circuit breaker box before installing or servicing this fixture.
- Make sure that all wiring conforms to national and local electrical codes. If you are in question obtain a copy of the codes and wire the fan accordingly. Never leave bare wire uncovered, use wire nuts to cap all connections. Plastic electrical tape is not recommended.
- Ceiling fans with integrated lighting must be installed on a 120V AC, 60Hz grounded circuit protected by a 15A breaker or fuse. This unit is designed for general indoor use in dry or damp locations. Verify that the electrical system and installation location comply with these requirements prior to installation.
- If the location where you plan to install your fan does not already have an electrical outlet, hire a licensed electrician to run the wiring and install an outlet box designed for ceiling fans or heavy fixtures. The outlet box should be able to support a minimum moving weight of 50 pounds and marked "Acceptable for Fan Support" (*Plastic outlet boxes are not recommended for ceiling fan installation*).
- If you plan to use an existing electrical location check to make sure that the outlet box is not PLASTIC, that it is securely attached and able to support at least 50 pounds of moving weight marked "Acceptable for Fan Support". If you have any questions, outlet boxes and support systems for ceiling fans are available at most hardware and do-it-yourself centers. In most cases your AFX dealer will have all the necessary products for the proper and safe installation of your ceiling fan.
- The location you choose should have a minimum clearance of 20 inches from any wall to the blade tip at any point in its rotation and a minimum of 8 feet from blade level to floor and 10 inches from the blades to the ceiling.
- This ceiling fan was not designed for installation in any location where it might be exposed to moisture or high humidity. Installation in this type of location could be UNSAFE, will most likely damage the fan and its finish...and will VOID YOUR WARRANTY.
- Every effort has been made to provide you with proper instructions for the safe installation of this ceiling fan. You could however, encounter situations or problems not covered in this manual. Should this occur, please refer to a do-it-yourself wiring handbook or hire a qualified electrician to install your fan.
- Lubrication of your new ceiling fan is not necessary. The ball bearings have been adequately charged with grease and permanently sealed at the factory so that, under normal conditions, further attention is not necessary.
- NOTE: The safeguards provided by these safety instructions and by any separate installation instructions are not meant to cover all possible conditions and situations that may occur. It must be understood that common sense, caution and care are factors which can not be built into this product. These factors must be supplied by the person(s) installing, caring for and operating fan.

## Warning:

- To reduce the risk of fire, electrical shock, or personal injury, mount this fan to an outlet box marked "Acceptable for Fan Support of 22.7 kg ( 50 lbs )" or less and use Mounting Screws provided with the outlet box. CAUTION: Install the primary mounting means and use only the hardware provided with the fan.
- To reduce the risk of personal injury take care not to bend the blade brackets when installing the brackets, balancing the blades or cleaning the fan. Be careful not to insert foreign objects in between rotating fan blades.
- To reduce the risk of fire or electrical shock, do not use this fan with any solid-state speed control device.
- The important safeguards and instructions appearing in this manual are not meant to cover all possible conditions and situations that may occur. It must be understood that common sense, caution and careful attention to detail are factors which cannot be built into this product. These factors must be supplied by the person or persons installing, caring for, and operating the unit.

## Exploded View:

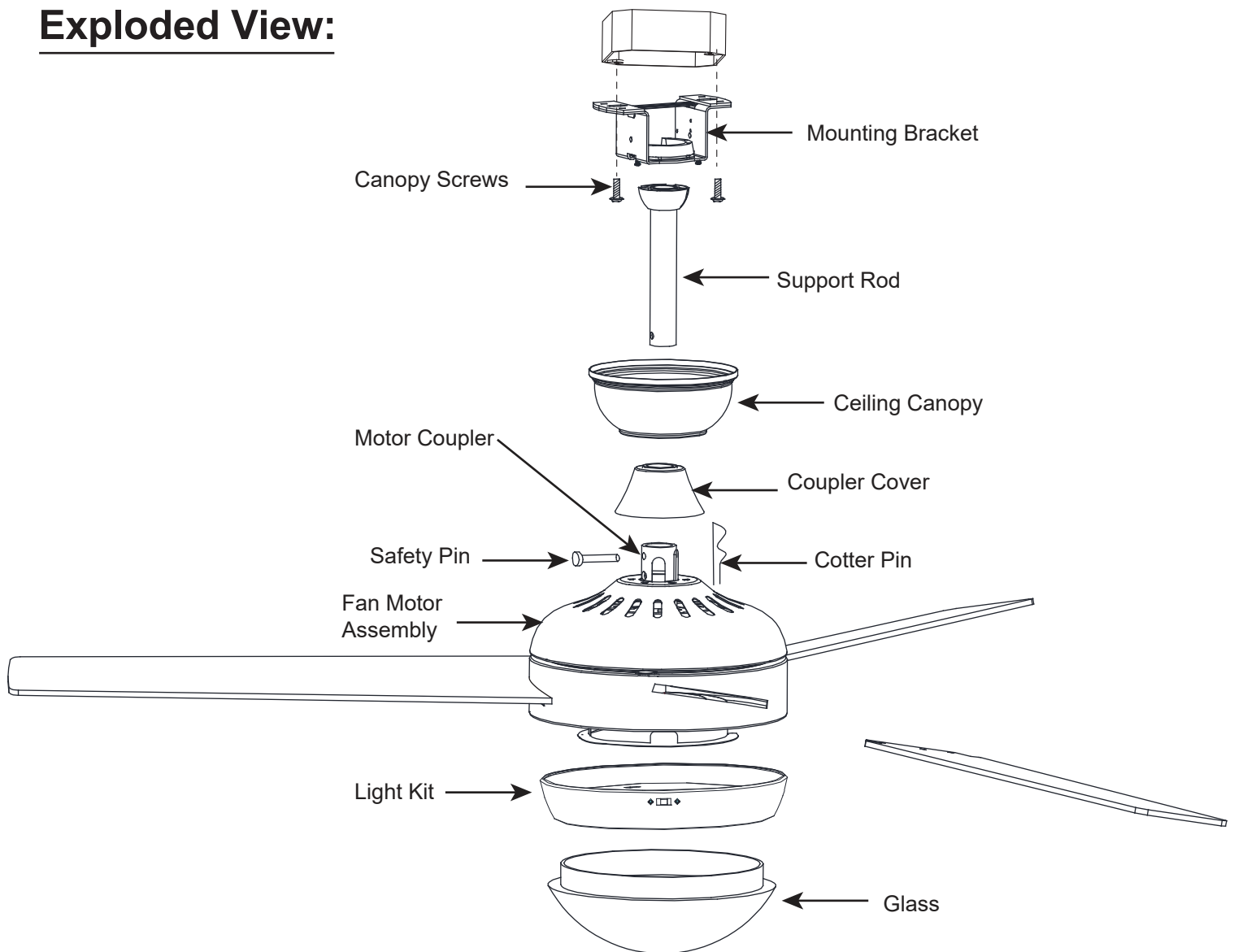

# Dimension Reference:

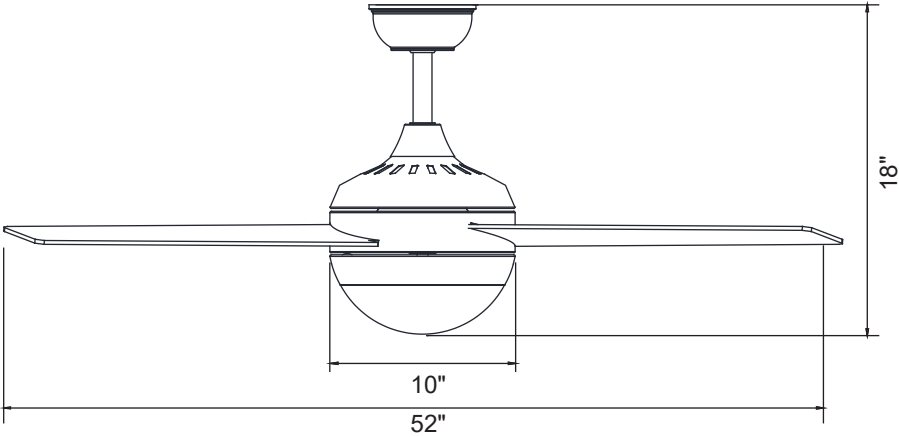

# Hardware Package Included:

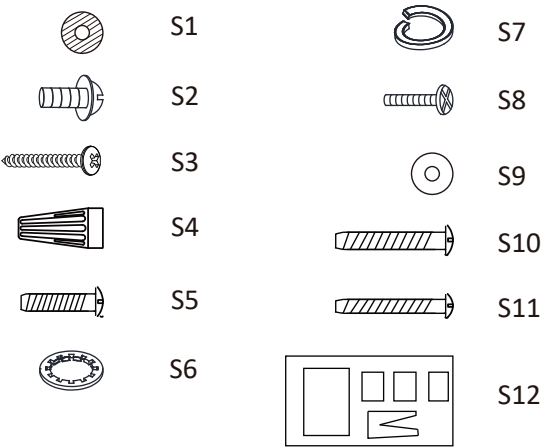

Hardware Package	Quantity
S1. $\phi$ 12x1mm ( $\phi$ 5mm inside) gasket (Red)	10
S2. #3/16x 1/2" Allen Head Screw (BN)	10
S3. #3/16x 1-1/2" round head Self-Tapping screw (SN)	4
S4. P3 Wire nut (Orange)	4
S5. #5/32x 3/4" Big Round head screw (SN)	2
S6. $\phi$ 5mm(inside) Serrated washer (SN)	2
S7. $\phi$ 5mm(inside) Spring washer (SN)	2
S8. #5/32x 1-1/2" Round head screw (SN)	2
S9. $\phi$ 15x1mm ( $\phi$ 5mm inside) flat washer	2
S10. #10/32x 1-1/8" Big Round head screw (SN)	2
S11. #8/32x 1-1/8" Big Round head screw (SN)	2
S12. Balance Kit	1

# Fan Parts Included:

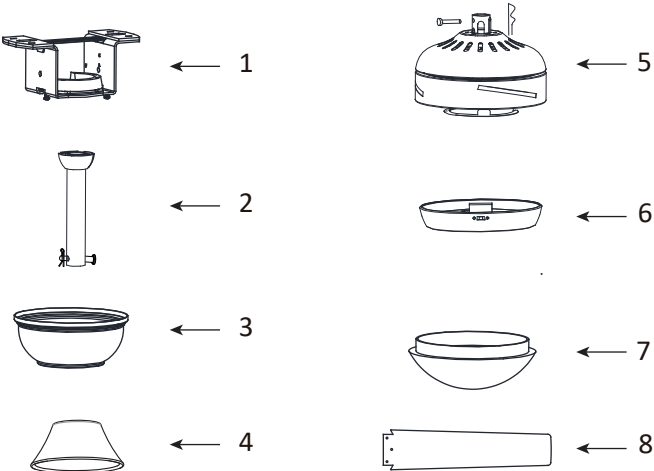

Hardware Package	Quantity
1. Mounting Bracket	1
2. Support Rod & Cotter Pin	1
3. Canopy	1
4. Coupler Cover	1
5. Fan Motor Assembly	1
6. Light Kit	1
7. Glass	1
8. Fan Blade	3

# Installation Instructions:

## Step 1 Assemble Fan Support Rod

**Note:** *If support rod is already assembled in the box, skip this step.*

Loosen the set screws in the support rod coupler until the screw tips are fully retracted from the channel interior. Remove and retain the safety pin and washer from the end of the support rod assembly. Slide the ceiling canopy (3) onto the support rod (2), followed by the support rod coupler cover (4) per Figure 1. Route the electrical wires from the fan motor housing (5) through the support rod.

Thread the support rod (2) into the fan motor assembly (5) until the safety pin holes in both components are aligned. Insert the safety pin through the aligned holes, attach the washer onto the safety pin, and secure it with the retaining clip on the opposite side. Tighten both set screws and the safety screw on the support rod coupler to complete the assembly.

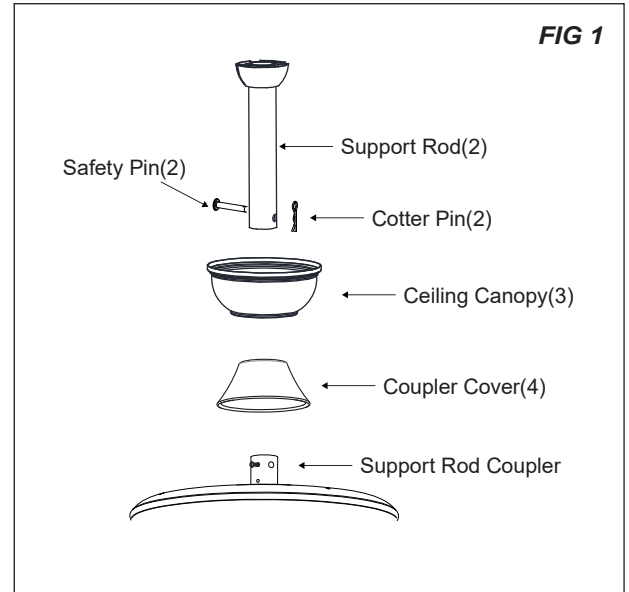

## Step 2 Assemble fan blade

Place all components on a smooth, flat work surface. Invert the fan motor assembly and position it securely in an upright and stable orientation.

Insert the fan blade (8) into the designated card slot of the fan motor assembly (5), then secure it in place using the gasket (S1) and blade arm screws (S2), as illustrated in Figure 2. Repeat until all blades are installed.

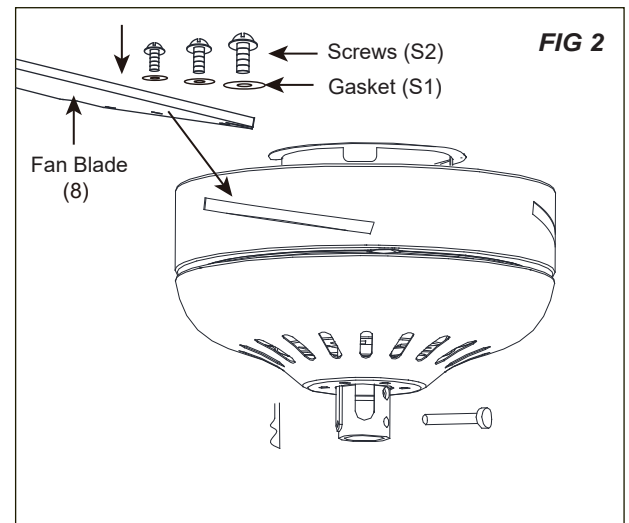

### Step 3 Assemble Fan light kit

Connect the wire terminal of the fan motor assembly (5) to the corresponding wire terminal of the light kit (6). Secure the light kit to the fan motor assembly by rotating it into position, then attach the glass (7) to the light kit (6) using the same rotational method. The light kit is available in multiple color temperature options (2700K, 3000K, 3500K, 4000K, 5000K) Preset to 3000K. per Figure 3.

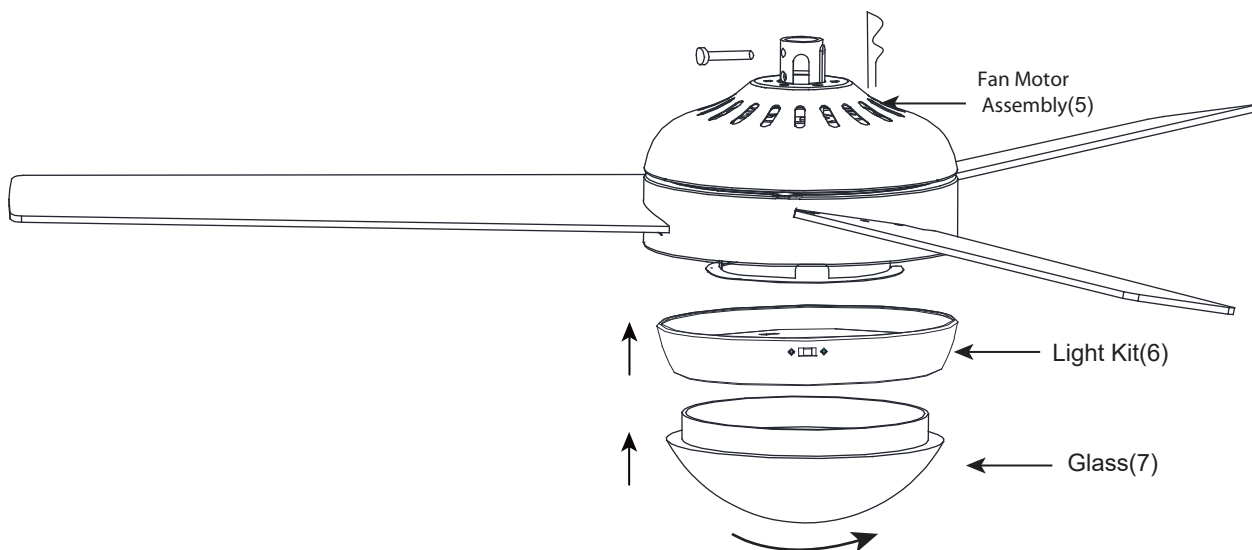

### Step 4 Install the mounting bracket

Turn off power at the circuit breaker and wall switch, and verify that power is fully disconnected before proceeding. Install the mounting bracket (1) to the junction box using two self-tapping screws (S3) to secure it.

### Step 5 Install the canopy

Install the fan assembly by inserting the end of the support rod (2) into the mounting bracket (1).

### Step 6 Wiring the fan assembly

Make all wire connections to appropriate wire. Secure with wire nuts (S4).

- Connect the green wire from the fan to the supply power source ground wire.
- Connect the white wire from the fan to the white (N) wire from the supply power source.
- Connect the black wire from the fan to the black (L) wire from the supply power source.
- Connect the blue wire from the fan to the switched hot lead for the light circuit. If a single wall control is utilized, the blue conductor may be connected to the black wire.

Do not mix wires. Pull on each wire lead to make sure connections are secure. Make certain no bare wires are exposed outside of wire connectors. Tuck all connections neatly into the junction box.

### Step 7 Install the canopy cover

Install the canopy cover (3) to the mounting bracket using two screws to secure it.

### Step 8 Restore power at the fuse or circuit breaker box

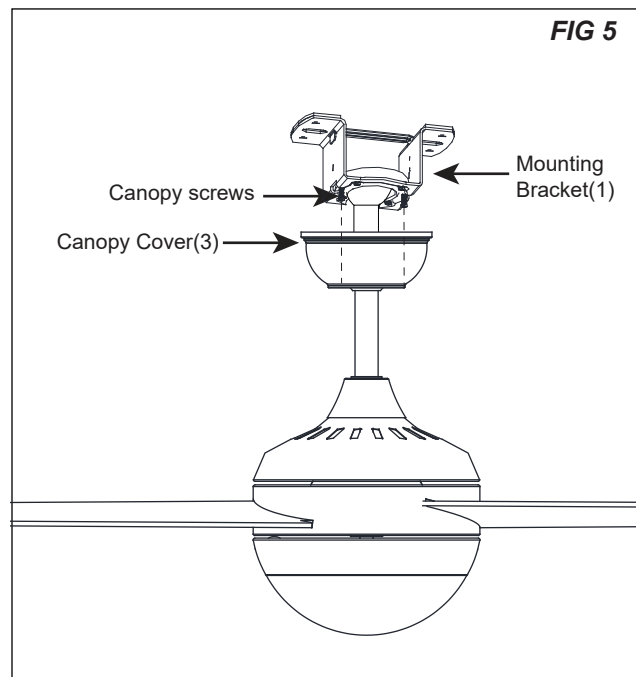
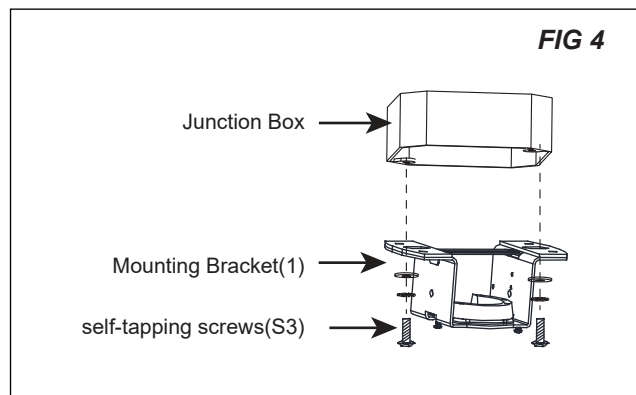

Optional Models with Pull Chain: DVS523LACxxxx-CN

FUNCTION:

- Fan Switch Pull Chain:

  - 1: POWER ON(HIGH SPEED)
  - 2: MEDIUM SPEED
  - 3: LOW SPEED
  - 4: POWER OFF
- Light Switch Pull Chain:

  - 1: POWER OFF
  - 2 : POWER ON



Optional Models with Wall Switch: DVS523LACxxxx-WS

Disconnect the power and remove the existing wall plate and switch.

- 1. Set all knobs on the dual slide wall-mounted control in the OFF position.
- 2. Installation of this control requires that a three-conductor cable with ground wire be run between the control wall box and the ceiling fan outlet box.
- 3. Make wire connections and secure with wire nuts supplied, refer to (FIG 7)
  - Connect black wire from A.C. power supply to black wire from the wall-mounted control.
  - Connect black or red wire from the ceiling fan to black wire from the wall-mounted control
  - Connect blue wire from the ceiling fan to blue wire the wall-mounted control.
- 4. Secure the wall-mounted control to the outlet box with two screws provided. (FIG 8)
- 5. The face plate clicks on the wall control.

NOTE

If your ceiling fan would be used with the original pull chain switch,please always have the fan switch set to high speed and the light switch set to on position before using the wall control. To avoid accidental pull chain use, shorten chain by cutting it 1’ below switch body.

<div></div> <div><b>WARNING</b></div>	<div></div> <div><b>WARNING</b></div>
To avoid possible fire or shock, make sure that the electrical wires are completely inside the outlet box and not pinched between the wall plate and the wall	Check to see that all connections are tight, including ground,and that no bare wire is visible at the wire connectors,except for the ground wire. Do not operate fan until the blades are in place. Noise and fan damage could result.

FUNCTION:

- Fan switch:

  - 0: POWER OFF
  - 1: HIGH SPEED
  - 2: MEDIUM SPEED
  - 3: LOW SPEED
- Light Switch:

  - 0: POWER OFF
  - 1 : POWER ON

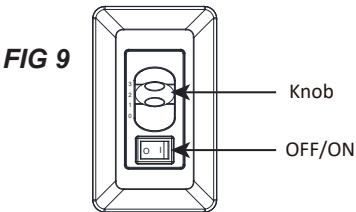
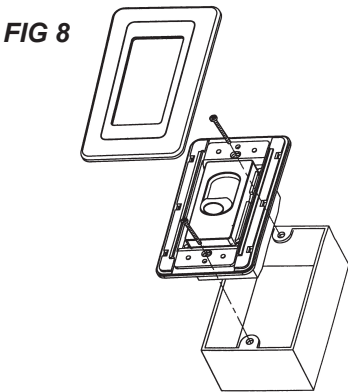
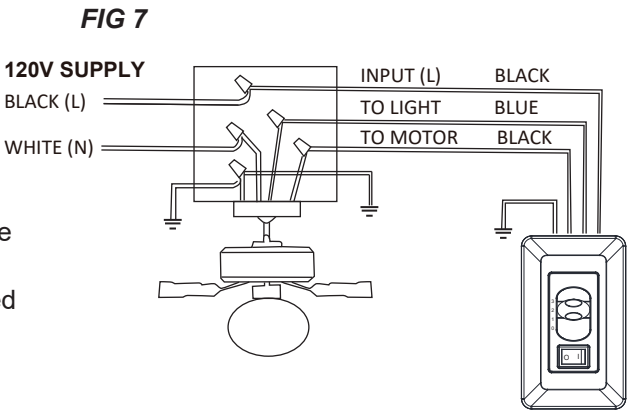
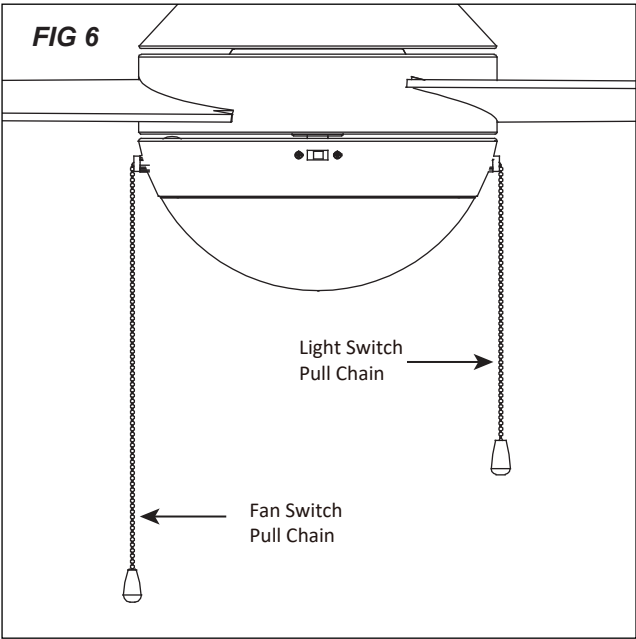

# Troubleshooting Guide:

If you have difficulty operating your new ceiling fan it may be the result of incorrect assembly, installation, or wiring. In some cases these installation errors may be mistaken for defects. If you experience any faults please check this troubleshooting guide.

## **Problem**

## **Suggested Remedy:**

### **1. If fan does not start:**

1. Check main and branch circuit fuses or circuit breakers.
2. Check line wire connections to fan and switch wire connections in switch housing. CAUTION: Make sure main power is turned off.
3. Make sure forward/reverse switch is firmly in up or down position. Fan will not operate when switch is in the middle.
4. Make sure that the wall controller is turned "ON".

### **2. If fan sounds noisy:**

1. Make sure all screws in motor housing are snug (not over tightened).
2. Make sure the screws which attach the fan blade holder to the motor are tight.
3. Make sure wire nut connectors in switch housing are not rattling against each other or against the interior wall of the switch housing.  
CAUTION: Make sure main power is turned off before entering switch housing.
4. If using an optional ceiling fan light kit check to be sure the screws securing the glass shade are tight. Check to be sure the light bulb is tight on the socket and not touching the glass shade.
5. Some fan motors are sensitive to signals from solid state variable speed controls. DO NOT USE a solid state variable speed control.
6. Your ceiling fan's "break in" period is 24 hours of operation. Most noises associated with a new fan will disappear after this period.

All blades are weighed and grouped by weight. Natural woods vary in density which could cause the fan to wobble even though all blades are weight-matched. The following procedures should eliminate most of the wobble. Check for wobble after each step.

### **3. If fan wobbles:**

1. Check that all blades are screwed firmly into blade holders.
2. Check that all blade holders are tightened securely to motor.
3. Make sure that canopy and mounting bracket are tightened securely to ceiling junction box and junction box is mounted firmly to ceiling joist.
4. Most fan wobble problems are caused when blade levels are unequal. Check this level by selecting a point on the ceiling above the tip of one of the blades keeping measure within 1/8 in. Rotate the fan until the next blade is positioned for measurement. Repeat for each blade. If all blade levels are not equal you can adjust blade levels by the following procedure. To adjust a blade tip down insert a washer (not supplied) between the blade and blade holder at the screw closest to the motor. To adjust a blade tip up insert washer (not supplied) between the blade and blade holder at the two screws farthest from the motor.
5. If blade wobble is still noticeable interchanging two adjacent (side by side) blades can redistribute the weight and possibly result in smoother operation.

### **4. If light does not work:**

1. Check blue wire from fan to make sure it is connected to hot wire from the house.
2. Check for loose or disconnected wires in fan switch housing.
3. Check for loose or disconnected wires in light kit.
4. Check for faulty light bulbs. CAUTION: Make sure main power is turned off before entering switch housing.
5. If the fan light shuts off shortly after being switched on it may be due to excessive current demand. Turn off power to the fan and replace the light bulbs with lower wattage bulbs. Turn on power to the fan using the pull chain, wall switch, or remote control (whichever is installed on the particular fan).