



1718 W. Fullerton Chicago, IL 60614  
 Ph: 773.770.1195 • Fax: 773.935.5613  
 www.PureEdgeLighting.com • info@PureEdgeLighting.com  
 © 2016 PureEdge Lighting. All Rights Reserved.

## Installation Instructions for TruCurve 1 or TruArch 1 L-Picture Frame Channel Connector

TACS1-L

### IMPORTANT INFORMATION

- This instruction must be used concurrently with other TruCurve 1 or TruArch 1 DIY installation instructions.
- This product is wall or ceiling mount.
- This instruction shows a typical installation.
- This product must be installed by a qualified electrician and in accordance with local electrical codes.

**SAVE THESE INSTRUCTIONS!**



## Section One: Install the L-Picture Frame Channel

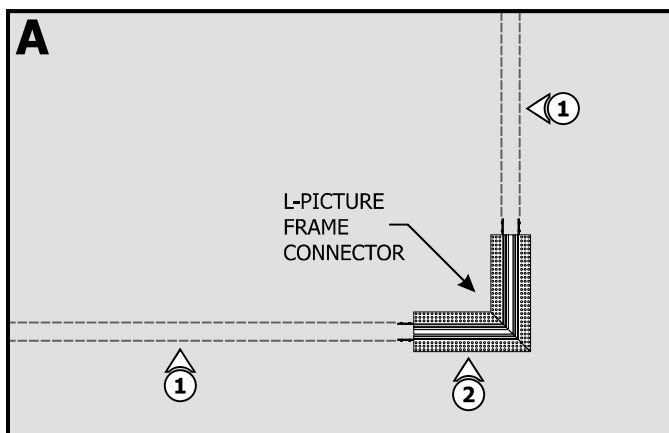

- 1: Place the L-Picture Frame Connector against the wall. Ensure the L-Picture Frame Connector is aligned with the TruCurve or TruArch Channel installation location.
- 2: Mark the installation location of the L-Picture Frame Connector on the drywall using a pencil or chalk line before cutting.

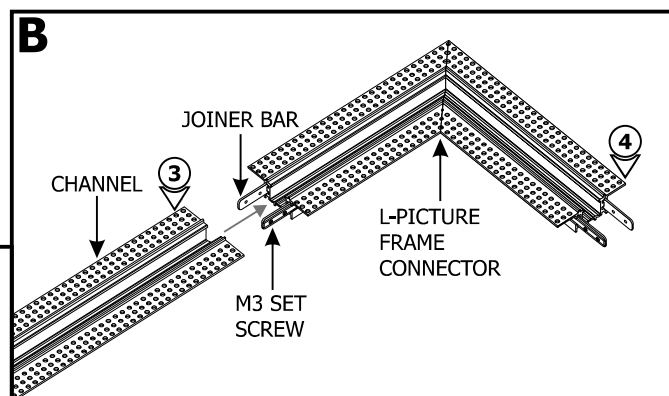

- 3: Slide a channel into the joiner bars and tighten the remaining M3 set screws using a 1.5mm Allen wrench.

- 4: Repeat step 3 for the other end of the L-Picture Frame Connector.

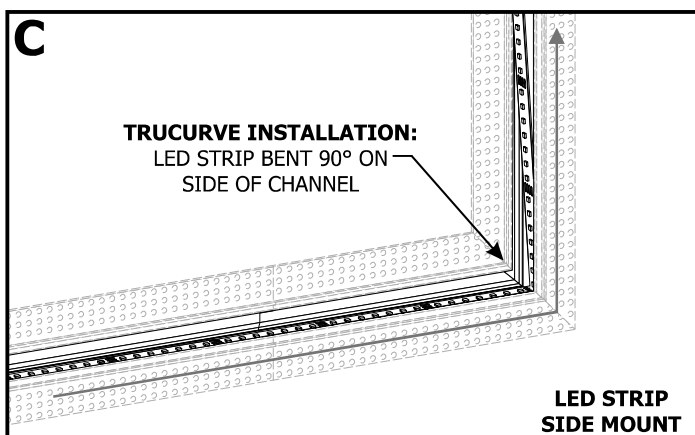

**TRUARCH INSTALLATION:**  
 LED STRIP ON BOTTOM  
 OF CHANNEL

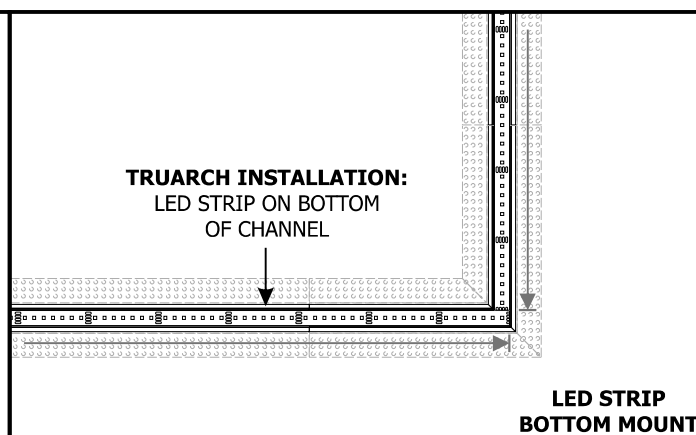

- 5: Follow steps described in the TruCurve or TruArch Channel and Lens installation instructions to continue the installation.

## Section Two: Lenses

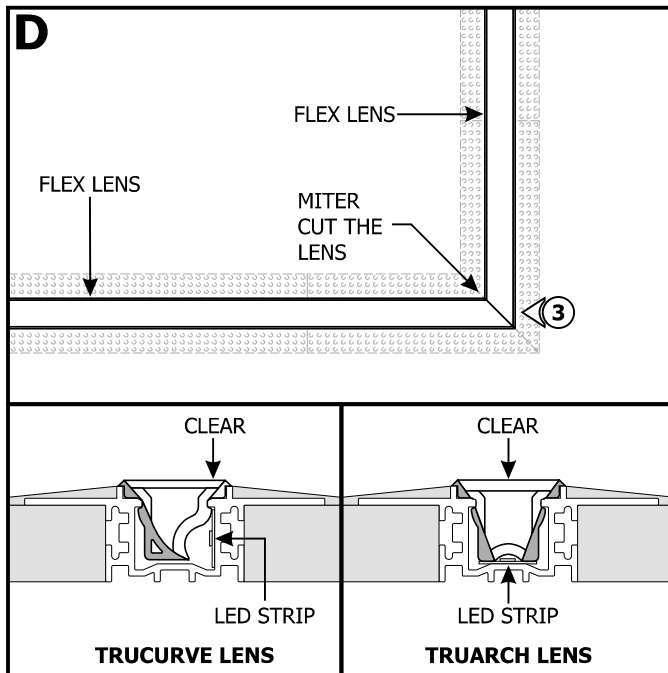

**1:** Determine the length of the lenses. Allow the total length to be 1/2" longer to avoid light leaks.

**2:** Use a razor to miter cut one end of the lenses to match the corner angle.

**NOTE:** For TruCurve lens, align the clear side of the lens with the LED Strip.

**3:** Starting at corner of the installation, squeeze the lenses against each other and push the lenses completely inside the channel.