



1718 W. Fullerton Chicago, IL 60614
 Ph: 773.770.1195 • Fax: 773.935.5613
www.PureEdgeLighting.com • info@PureEdgeLighting.com
 © 2016 PureEdge Lighting. All Rights Reserved.

Installation Instructions for TruLine 1.6A Channel and Lens

TL1.6A-CHLN-__

IMPORTANT INFORMATION

- This instruction must be used concurrently with other TruLine 1.6A DIY installation instructions.
- This product is wall or ceiling mount.
- This instruction shows a typical installation.
- This product must be installed by a qualified electrician and in accordance with local electrical codes.

SAVE THESE INSTRUCTIONS!

INSTALLATION VIDEO



Scan with your mobile device to watch a typical installation video or visit
www.pureedgelighting.com/pure/pure-videos/truline_1_6a_room_wrap/index.php

Section One: Lay the Drywall and Cut the Drywall for the Channel

A



REMOTE POWER SUPPLY

Install the Remote Power Supply:

- 1:** Remote power supplies must be installed within 40ft of the junction box. Refer to the instructions and wiring diagram provided with the remote power supplies.

B

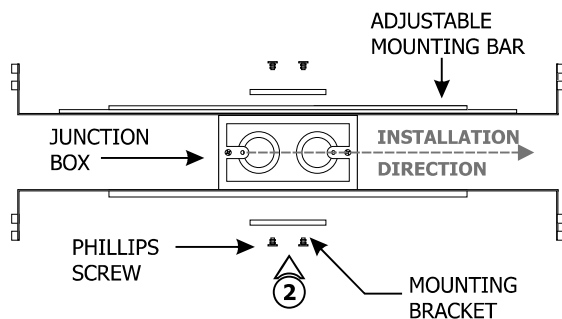
HORIZONTAL ORIENTATION



VERTICAL ORIENTATION

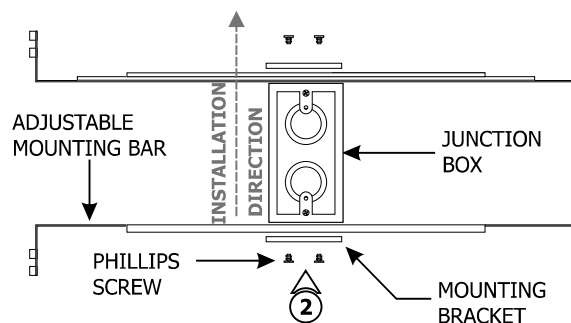

NOTE: Refer to the instructions provided with the TL1.6A Power Feed Channel Connectors or the TL1.6A Plenum Power Feed Channel Connectors to install the junction box.

Install the Junction Box and Wires (Test Power to the LED Strip):

- 2:** Mount each adjustable mounting bar to one side of the junction box and secure them with the mounting brackets and two Phillips screws provided.

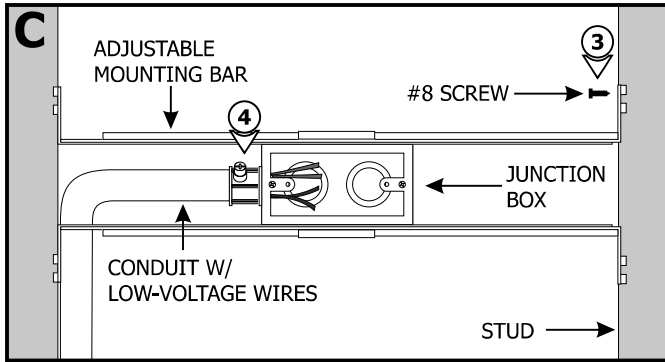

NOTE: The adjustable mounting bars mount to studs that are spaced 15" to 24" apart. If the span needs to be shorter than 15", then break the bar arms from dedicated lines.

3: Place the lips on the adjustable mounting bars against the studs. Secure the adjustable bars to the studs with the #8 screws.

4: Install conduit(s) (if required by local electrical code) and run the 24VDC low voltage wires coming from the power supply to the junction box. Refer to the instructions provided with the power supply.

5: Cut the end of the power connector that is going to be connected to power. Discard the unused connector. Strip the ends of the wires.

NOTE: Note the alignment of the +24VDC connection of the power connector to ensure proper alignment when installing the LED Strip in later steps.

NOTE: If installation requires RGB, RGB+W, or Tunable White, refer to wiring diagrams on pages 9 through 11.

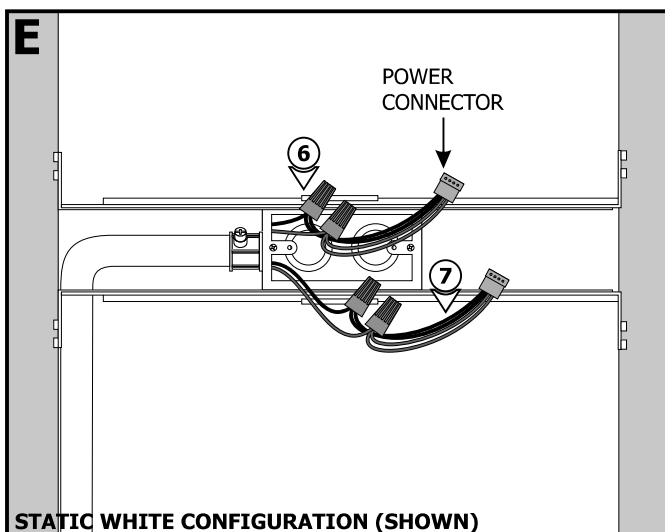
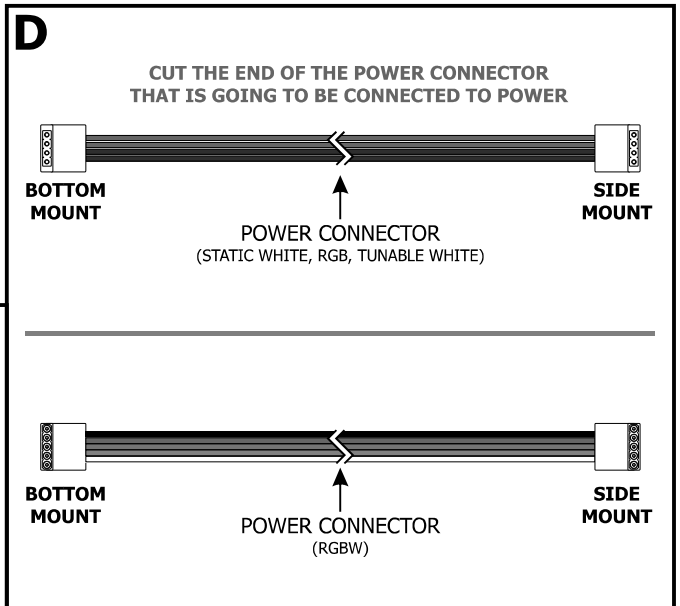

NOTE: Remote power supply wires must be present in junction box. Refer to instructions provided with power supply.

6: Connect the red +24VDC low voltage wire of the power supply to the red wires of the power connector using a wire nut. Connect the black -24VDC low voltage wire of the same power supply to the black wires of the connector using a wire nut.

7: Repeat step 6 for the other connector and power supply.

8: Place all wire nut connections inside the junction box.

CAUTION: Unroll the entire LED strip from the reel and use the power connector to power the strip making sure there is no outage before continuing with the installation. Afterwards, carefully roll the LED strip loosely back into the reel.

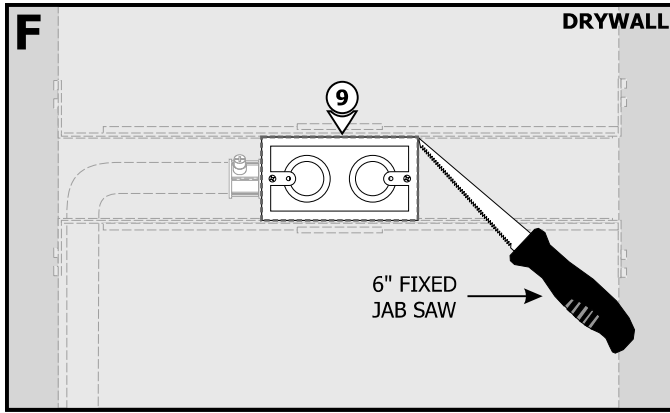

9: Cut a section of drywall using a 6" fixed jab saw or other appropriate tool to expose the mounting plate area. Install the drywall.

NOTE: Drywall must be installed first before installing the channel.

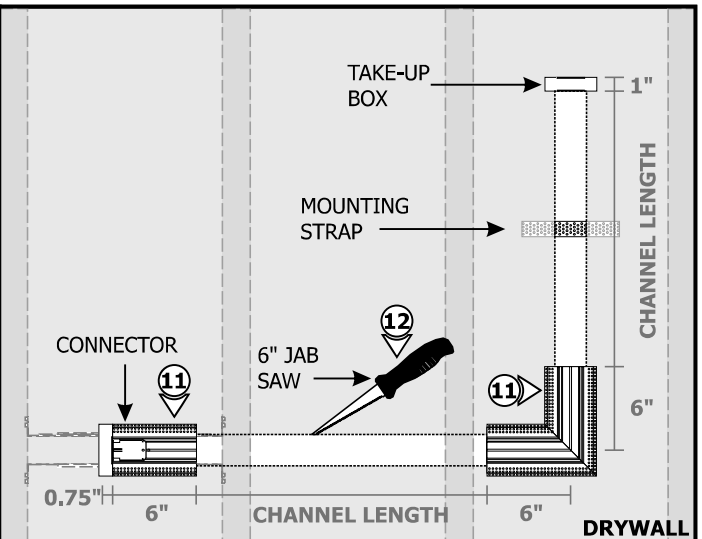
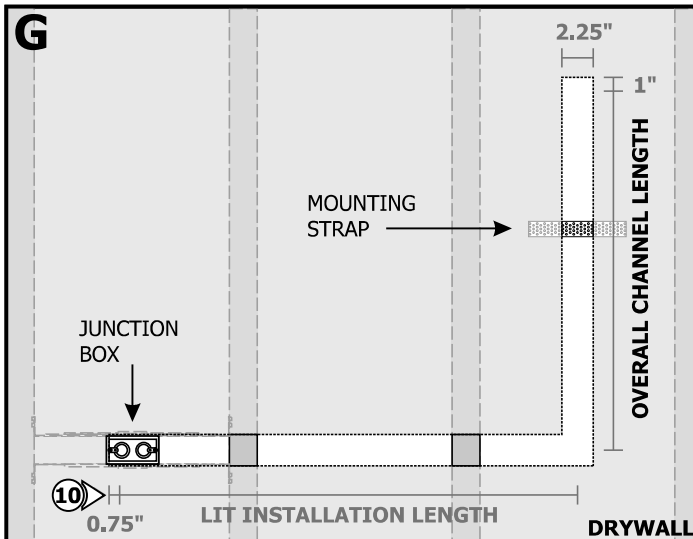

10: Mark the area where the installation will be located on the drywall using the junction box opening as a guide (**MIN** 2.25"). Allow for 0.75" extra space at junction box for power end caps (if any) and 1" at the end of the installation for the Take-Up Box.

11: Place the desired DIY Channel Connectors against the wall. Ensure the connector is aligned with the installation location. Mark the location of each DIY Channel Connector to determine the cut length of the channel and lens.

12: Cut out the marked area using a "Dremel Multi-Max" or a 6" Fixed Jab Saw. Mark the location of the studs on the drywall.

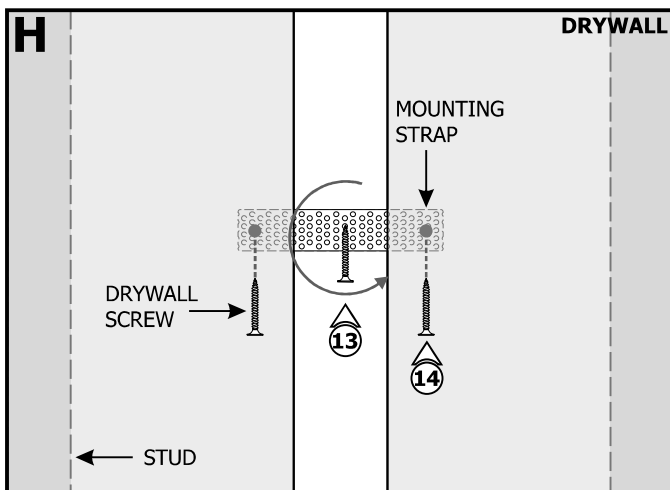

NOTE: To install channel in a wall without standard-spaced studs, install perforated mounting straps every 32" behind drywall and secure using two drywall screws. Mark the location of any mounting straps to the drywall (see steps below).

NOTE: For areas with lots of vibrations, it is suggest to install 2X4 support braces (suggested spacing is every 32") before installing and finishing drywall to avoid cracking of plaster. Refer to step 15.

13: Thread a drywall screw into the perforated material. Place the mounting strap behind the drywall and rotate into place using the drywall screw.

14: Secure the mounting strap to the drywall using two drywall screws. Mark the location of the mounting strap on the drywall.

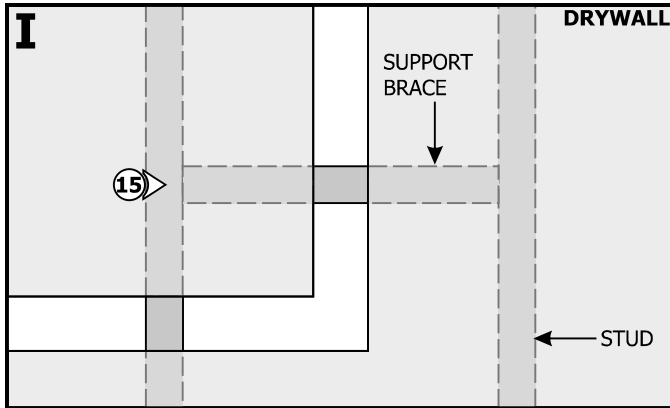

Alternate Installation Option:

15: Install 2x4 support braces (suggested spacing is every 32") before installing and finishing drywall.

Section Two: Install the Channel

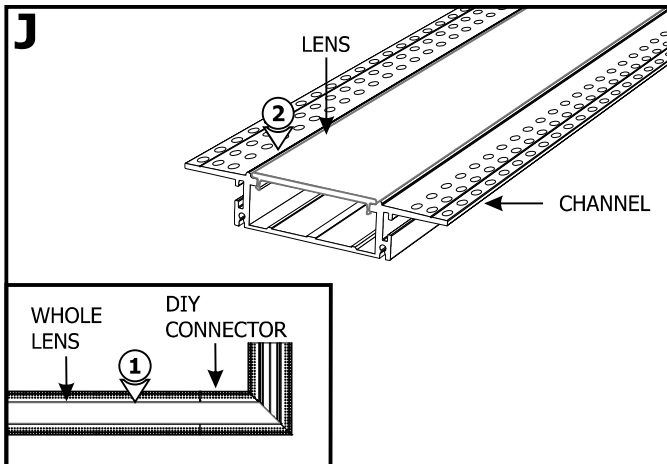

1: If necessary, consider attaching the DIY connectors to the channel before cutting to length.

2: Snap the whole lens into the channel, and DIY connectors, **BEFORE** cutting to length. This ensures a proper fit after installation.

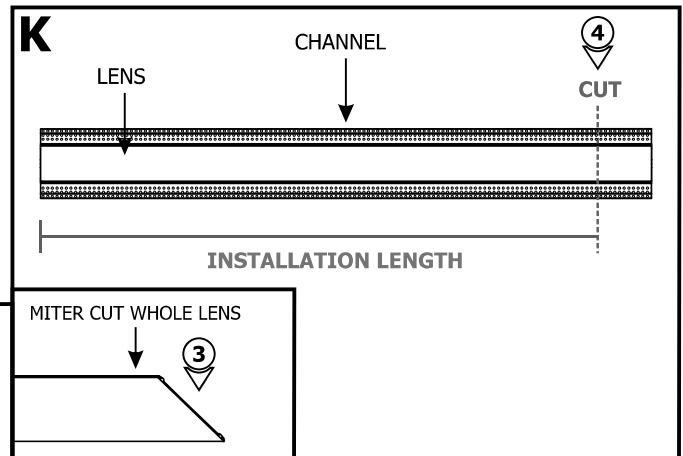

3: Depending on the design, use the precut lenses provided with the DIY connectors as a guide to miter cut the lenses. Discard precut lenses.

4: Cut the channel and lense to match the installation length.

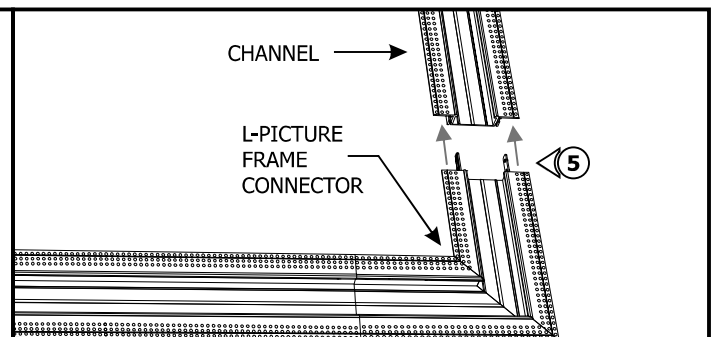
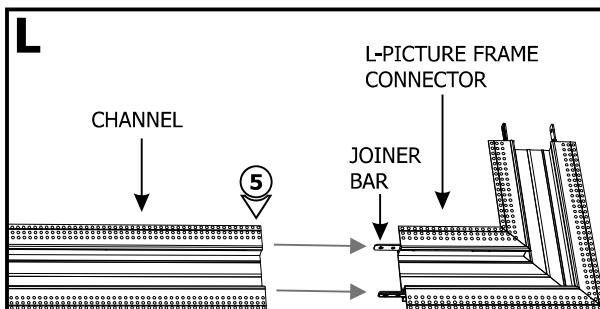

NOTE: TL1.6A L-Picture Frame connector is shown for demonstration purposes.

NOTE: If using the TL1.6A Power Feed Channel Connectors with Chicago Plenum Rated Junction Box, fill the connecting seams with plenum rated sealants.

5: Install channel connector(s) to the channels. Refer to the instructions provided with the desired DIY connector.

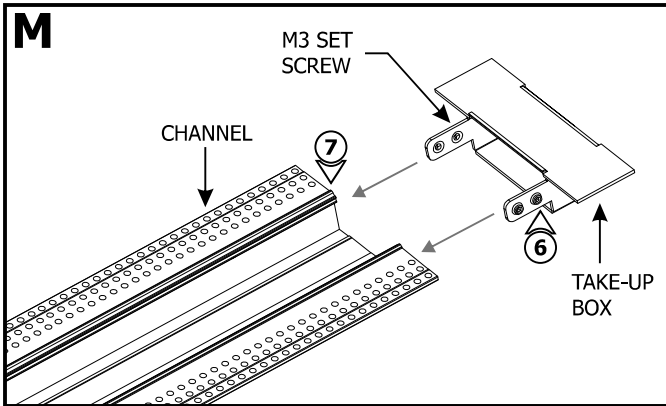

6: Loosen (**Do Not Remove**) the four M3 set screws on the Take-Up Box using a 1.5mm Allen wrench.

7: Install the Take-Up Box at the end of an installation run. Slide the Take-Up Box into the channel and tighten the four M3 set screws using a 1.5mm Allen wrench to secure in place.

8: Refer to the instructions provided with the DIY Power Feed Connectors to connect the channels.

9: Secure the assembled DIY Power Feed Connectors to the junction box with the provided screw.

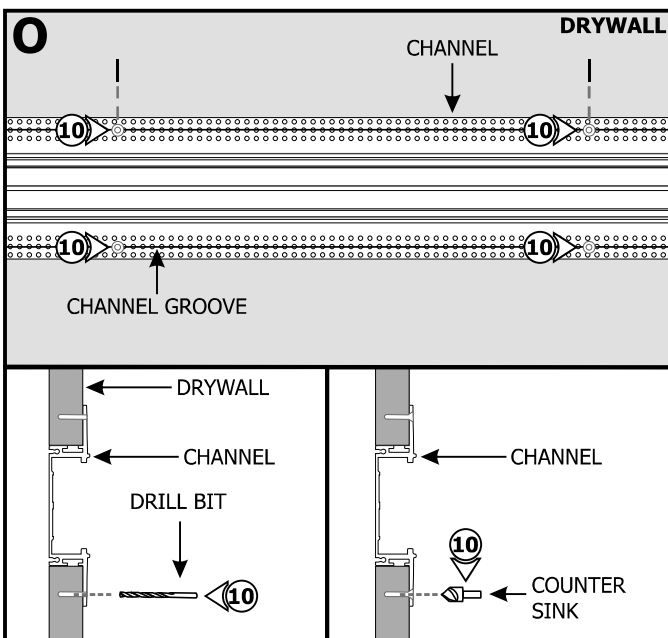
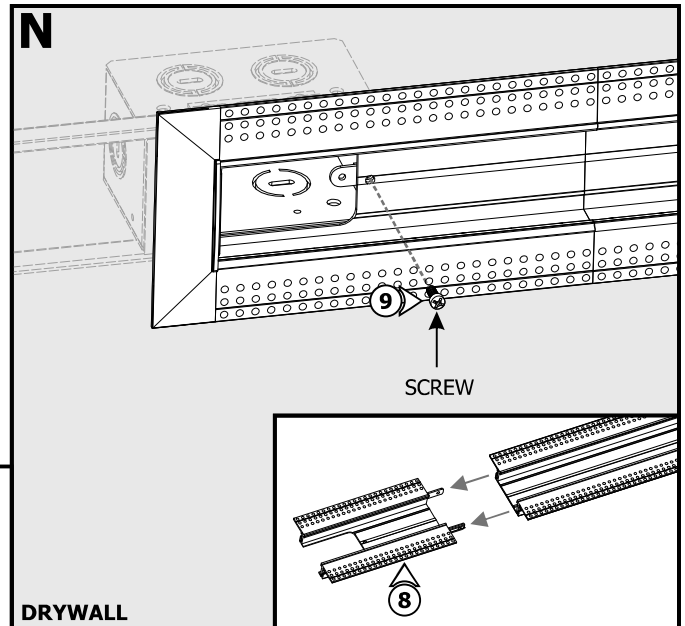

10: Using the marked locations on the drywall, drill and countersink along the channel grooves using the provided square drill with countersink bit.

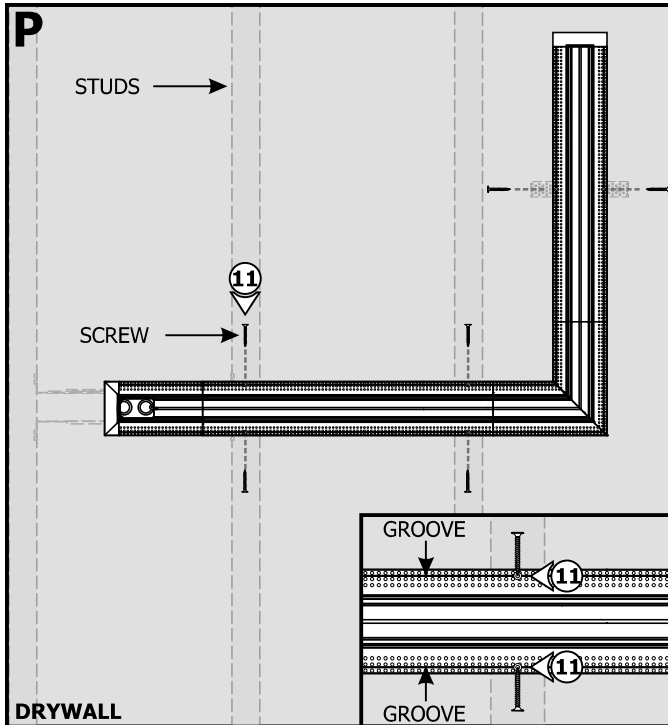

11: Properly secure the channel to the wall using drywall screws (**DO NOT over tighten**). Ensure all screw heads are flush with the channel surface.

Section Three: Plaster, Sand and Paint

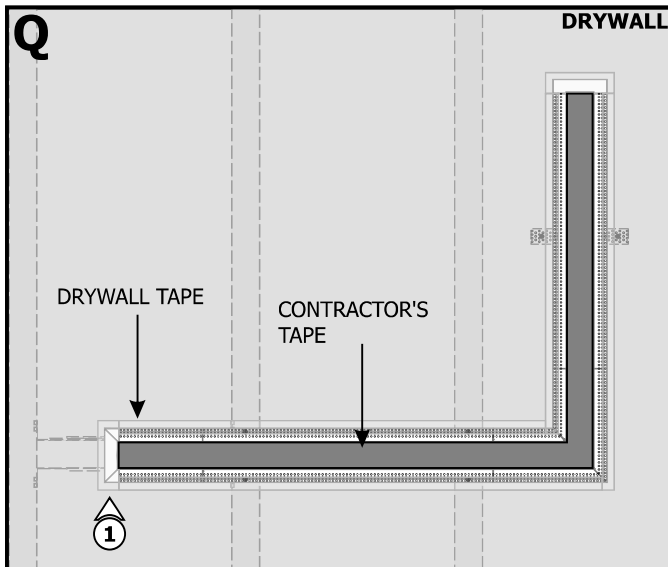

NOTE: Cover the channel opening with blue contractor's tape before plastering.

NOTE: For areas with lots of vibration, it is suggested to use Durabond to avoid cracking of plaster.

NOTE: **Do Not** use premixed joint compound "Soft Mud." No use compuesto para juntas premezclado "Soft Mud."

1: Must apply drywall tape (Ultra-Thin drywall tape suggested) along edges of channel up to the groove to prevent cracking of plaster after installation. **DO NOT** overlap strips of drywall tape.

NOTE: Recommended plaster method: 1st coat - Durabond 45 with 8" Blade, 2nd Coat - Easy Sand 45 with 10" Blade, 3rd Coat skim coat- with 12" Blade. Taper the plaster to blend with the surface.

2: Use a compound knife for a smooth compound spread. Sand, paint, and finish the plaster and drywall before removing the blue contractor's tape.

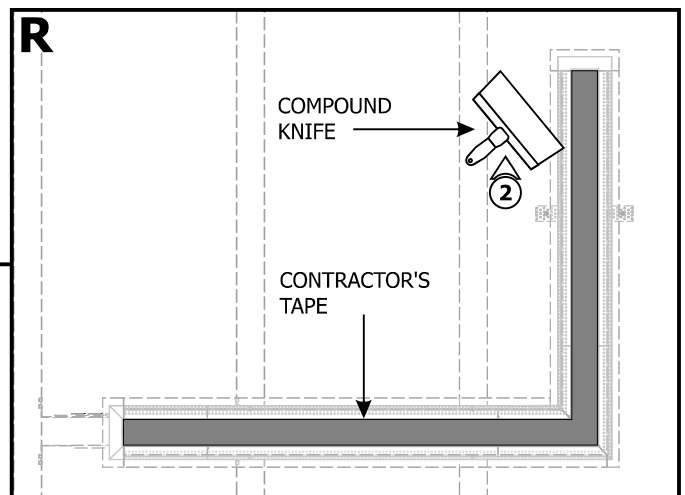

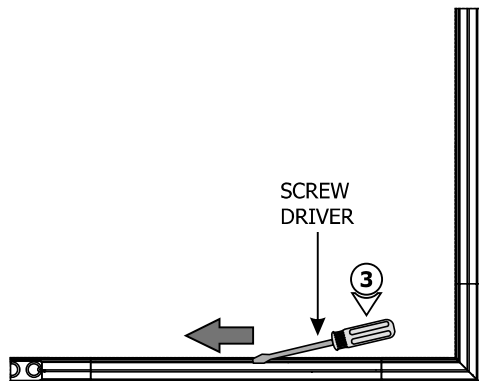
S

3: Carefully use a flathead screwdriver to remove excess drywall from the internal bevel/edge.

Section Four: Install LED Strip

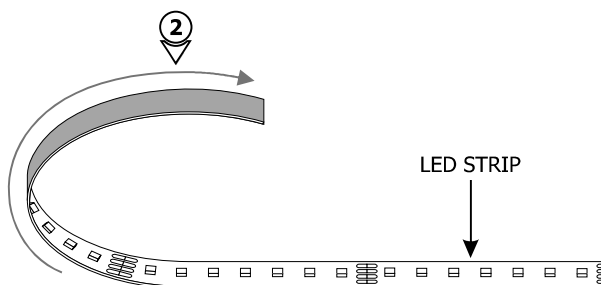
T

1: Remove the blue contractor's tape from the inside of the channel. Clean the channel surface with alcohol to remove any dust or debris before continuing.

IMPORTANT: LED strip may not properly adhere to channel surface unless the channel is cleaned with alcohol prior to application.

NOTE: If installation requires RGB, RGB+W, or Tunable White, refer to wiring diagrams on pages 9 through 11.

2: Gently uncoil the LED Strip before applying to the channel otherwise the strip may lift off of the surface.

LED Strip Installation: Bottom Mount

3: Connect the LED Strips to the power connectors. Refer to instructions provided with the DIY Power Channel Connectors to connect the LED Strips to the power connectors.

4: Carefully remove the backing from each LED Strip, making sure not to remove the tape. Firmly press down the adhesive portion of the LED Strip onto the channel surface while removing the rest of the backing, making sure there are no air bubbles that can cause surface irregularities.

NOTE: Refer to page 12 for important information regarding installation and rework of the LED Strip.

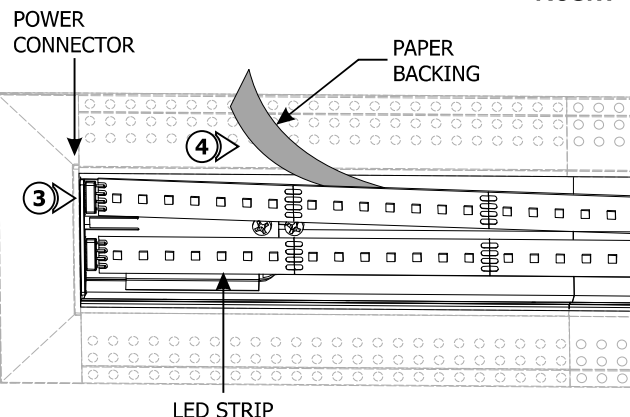
U**BOTTOM MOUNT**

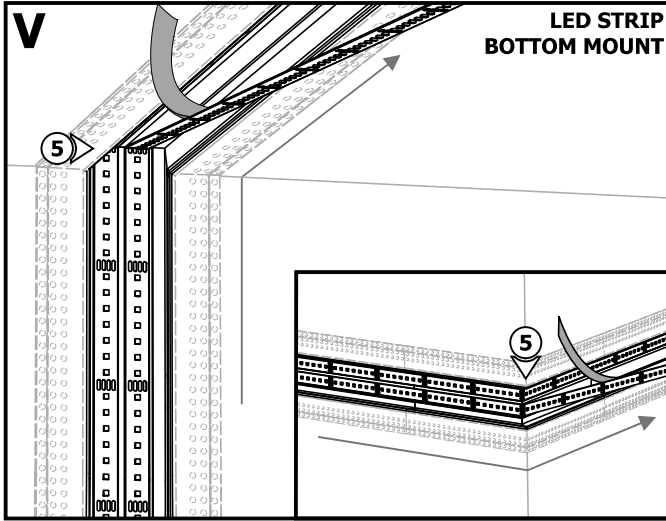

5: For Room Wrapping configurations, bend the LED Strips 90° on the **bottom** of the channel to match the corners. Ensure the entire length of the channel is covered with LED Strips to avoid unlit areas.

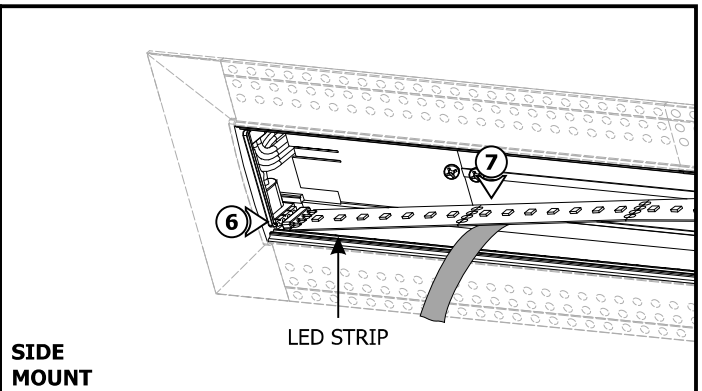
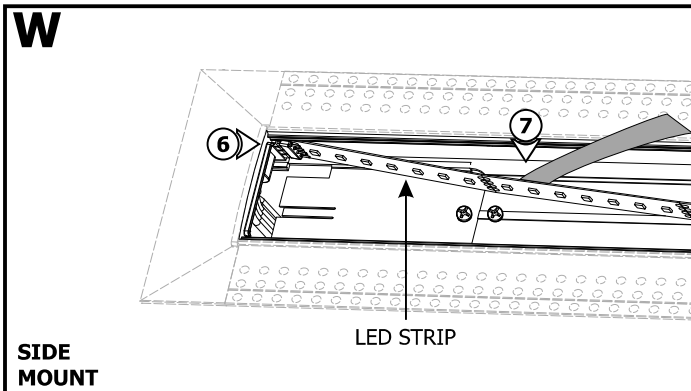

LED Strip Installation: Side Mount

6: Connect the LED Strips to the power connectors.

7: Repeat step 4 to properly install the LED Strips on the sides of the channel.

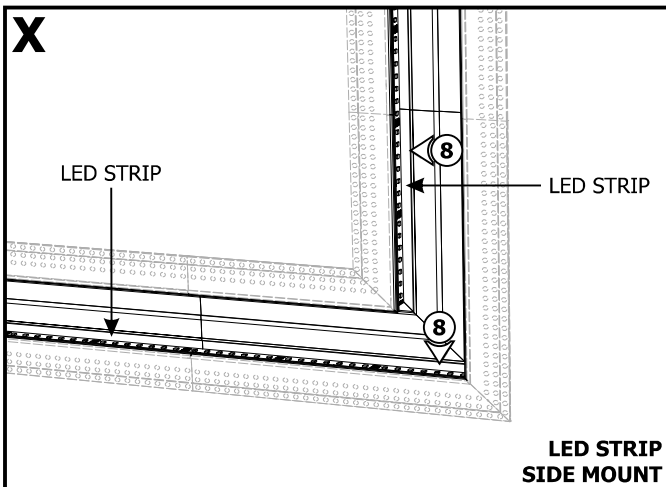

8: For Picture Frame configurations, bend the LED Strips 90° on the **sides** of the channel to match the installation corner. Ensure the entire length of the channel is covered with LED Strip to avoid unlit areas.

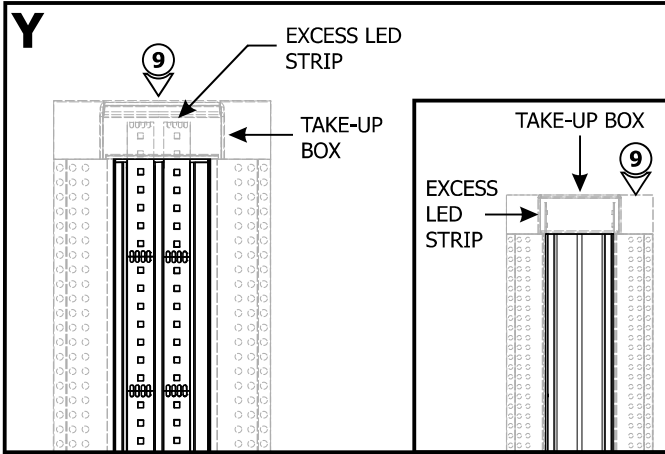

9: If required, trim the LED strips on the dashed cuttable section, place the excess LED strips inside the Take-Up Box. Ensure the entire length of the channel is covered with LED strips to avoid unlit areas.

Section Five: Install LED Strip

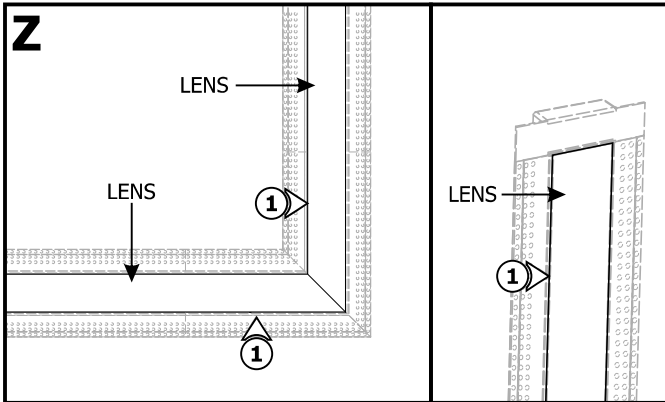

1: To avoid seams and light leaks, use the whole lens to cover the power connectors and the rest of the installed channels. Snap the lens onto the channel and connectors. Ensure the lenses are fully seated.

General Wiring Diagrams

Static White

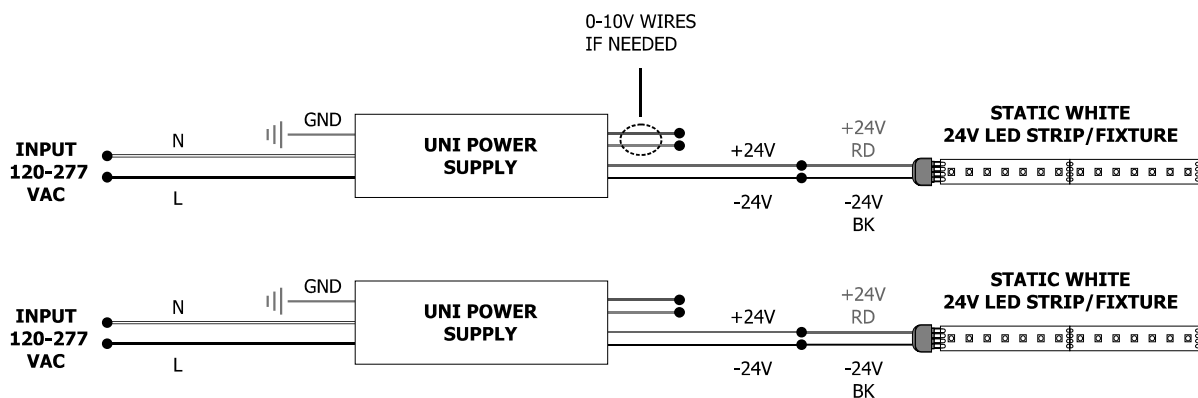

RGB Configuration: Using LED Power Supply with RGB Strip & CDP, CTP or CDMX Control

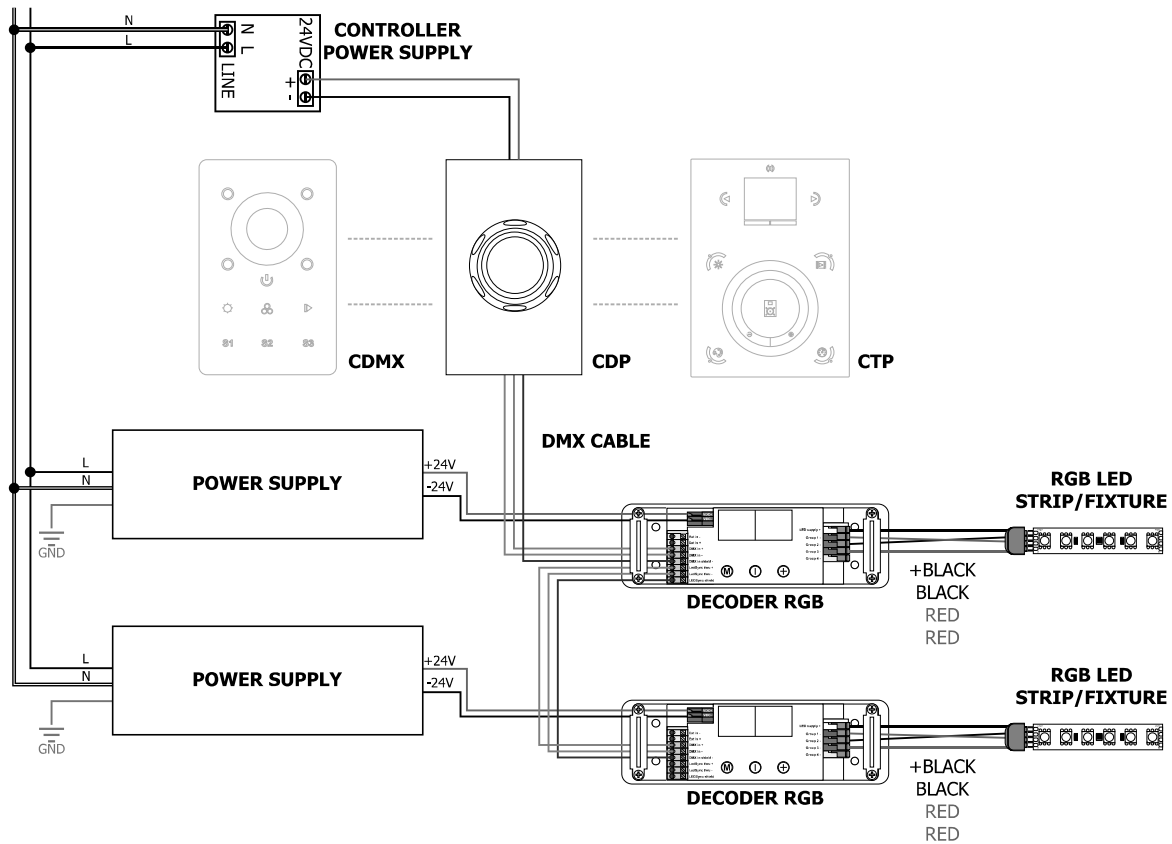

RGB+W Configuration: Using LED Power Supply with RGB Strip & CDP, CTP or CDMX Control

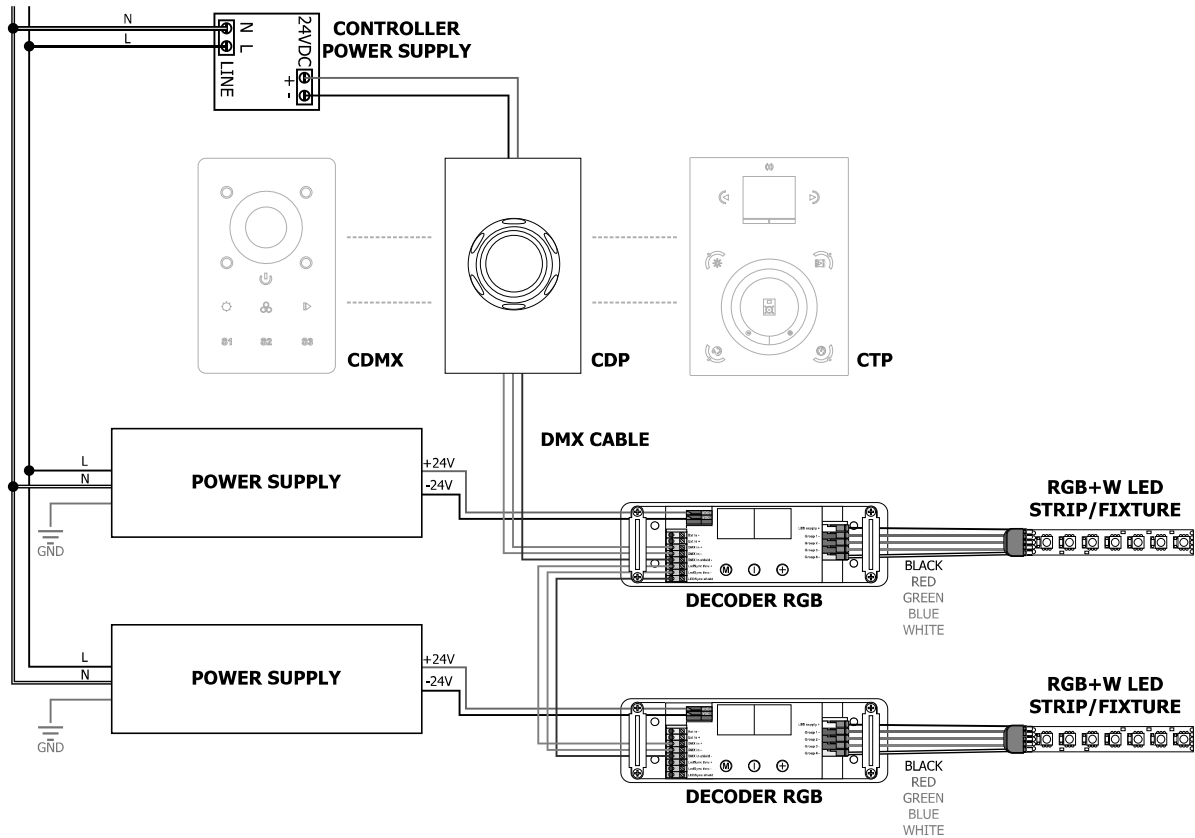

Tunable White: 2XK Power Supply with CDMX Controller

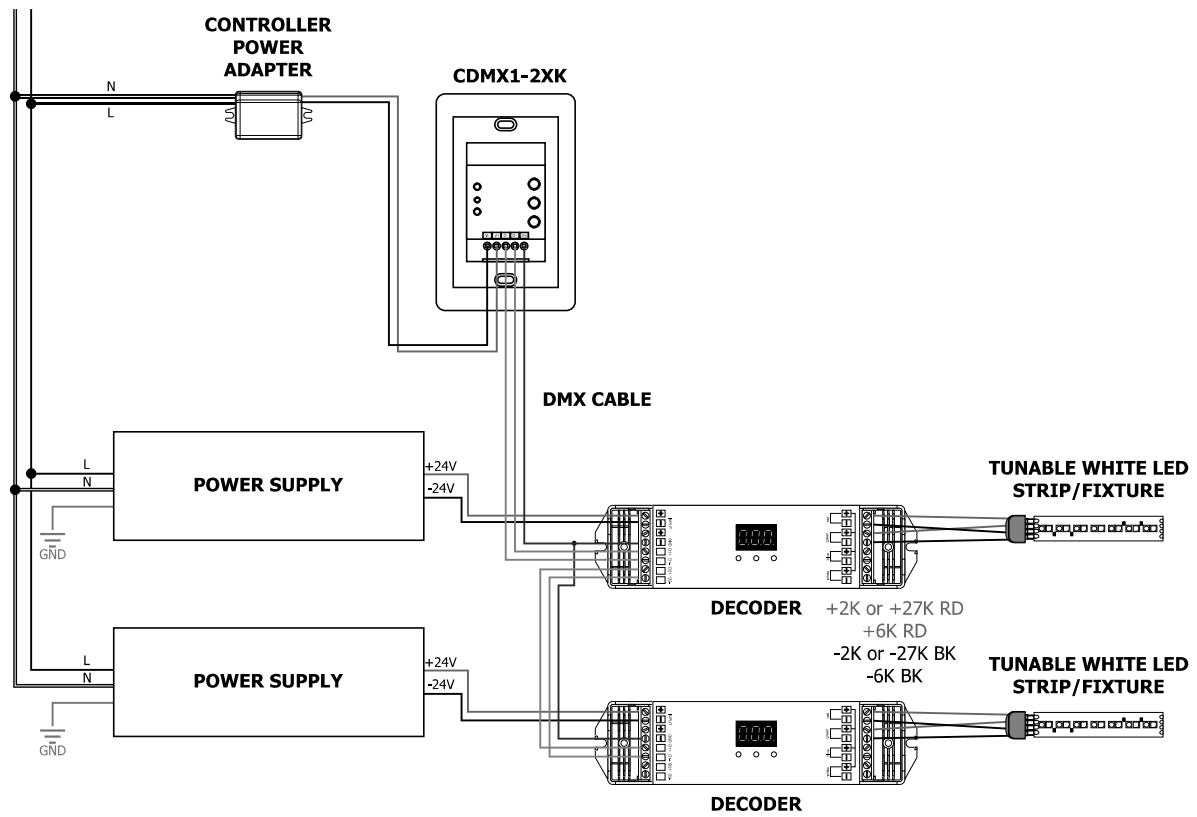

IMPORTANT INFORMATION REGARDING INSTALLATION AND REWORK OF SOFT STRIP LED

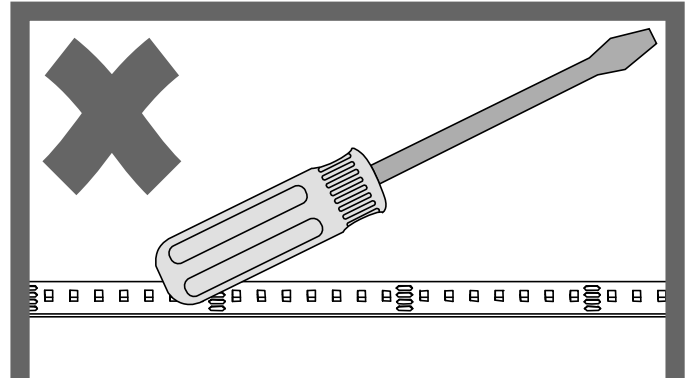
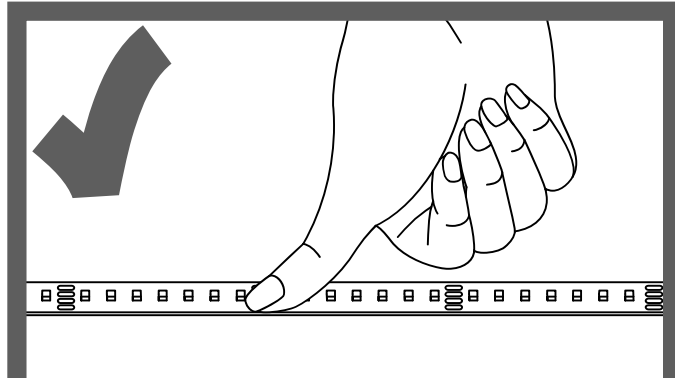
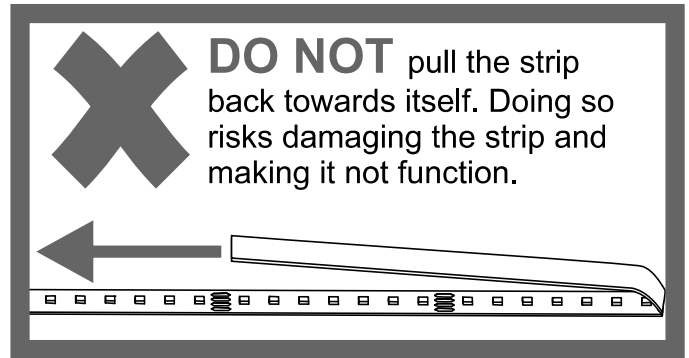
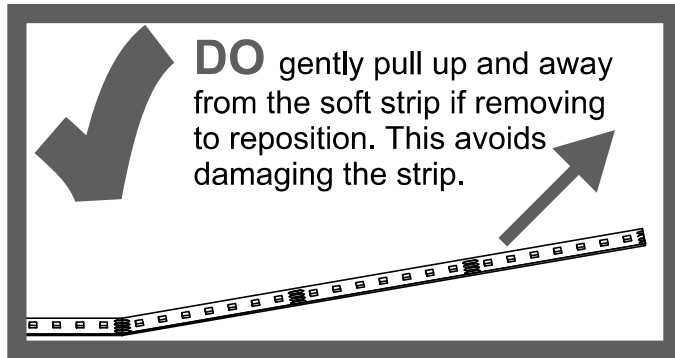

Relocating LED Strip (Optional)

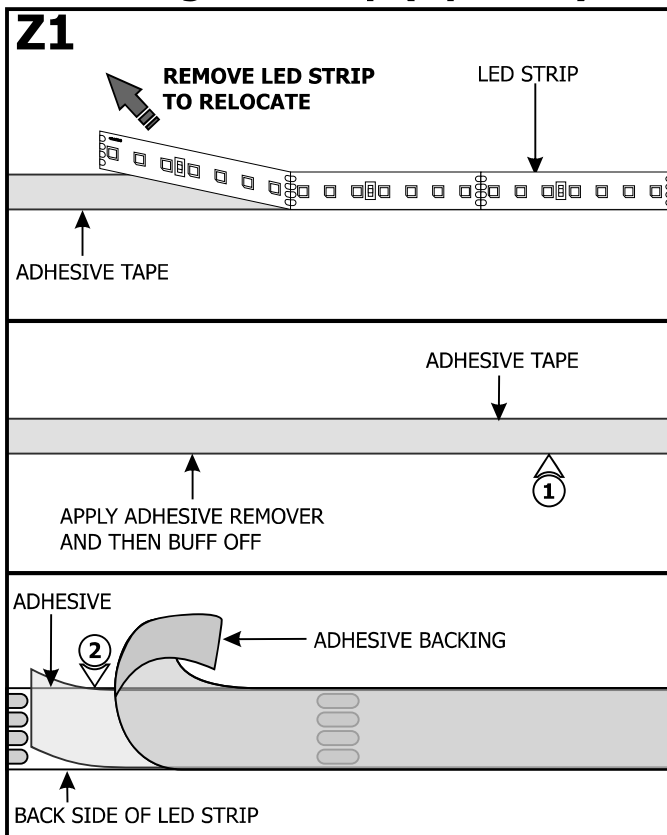

NOTE: If relocating the installed LED strip, make sure that the adhesive tape on back of the LED strip covers the entire strip. The adhesive tape isolates the strip from the installation surface. Damaged or inconsistent adhesive tape may cause the contacts on the back of the strip to come in contact with the conductive heat sink which will cause the strip to short and burn. Call PureEdge Lighting to get replacement adhesive tape and/or optional aluminum heat sink tape (SS-HR-F).

- 1:** To remove tape residue from back of the strip, apply WD-40, Goo Gone, or a mixture of warm water and lemon oil to the corner of a clean, dry towel. Gently buff the area containing the adhesive residue until it is completely removed.
- 2:** Gently remove a few inches from one side of the tape backing. Attach the adhesive tape to the back of the LED strip and apply moderate pressure to affix the tape. Continue this step a few inches at a time until the entire adhesive tape is attached to back of the LED strip.
- 3:** Refer to Section Four to reinstall the LED Strip.