



1718 W. Fullerton Chicago, IL 60614  
 Ph: 773.770.1195 • Fax: 773.935.5613  
[www.PureEdgeLighting.com](http://www.PureEdgeLighting.com) • [info@PureEdgeLighting.com](mailto:info@PureEdgeLighting.com)  
 © 2016 PureEdge Lighting. All Rights Reserved.

## Installation Instructions for **Reveal Channel**

**RV-CH-8FT**

### IMPORTANT INFORMATION

- Reveal is used for toe kick or cove lighting.
- This instruction must be used concurrently with other Reveal BIY installation instructions.
- It is recommended more than one person to install the Reveal.
- This instruction shows a typical installation.

**SAVE THESE INSTRUCTIONS!**

### INSTALLATION VIDEO



Scan with your mobile device to watch a typical installation video or visit  
[www.pureedgelighting.com/pure/pure-videos/reveal\\_install/index.php](http://www.pureedgelighting.com/pure/pure-videos/reveal_install/index.php)

## Section One: Prepare and Cut the Channel

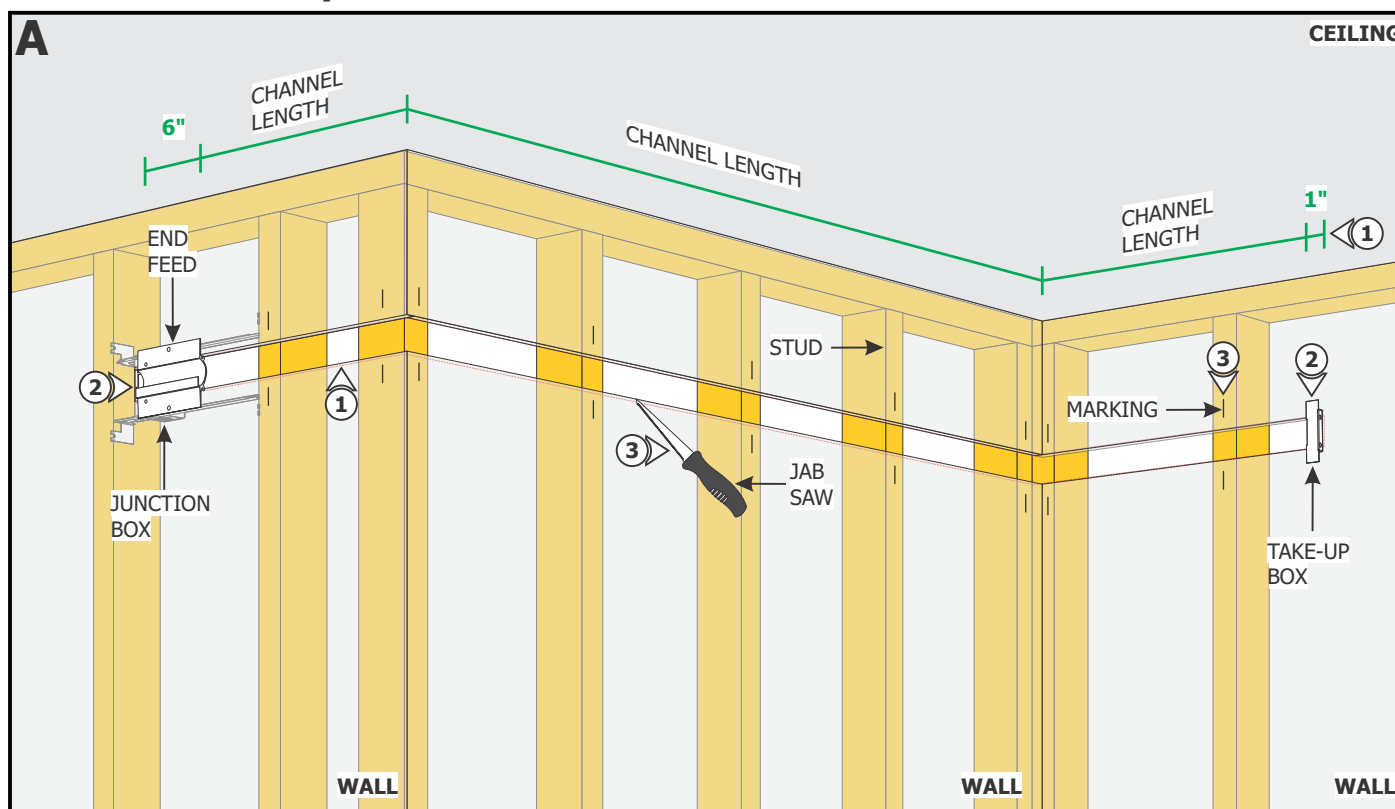

**NOTE:** Refer to the instructions provided with the Reveal End Feed Channel Power Connector to install the junction box.

- 1:** Mark the area where the installation will be located on the wall using the drywall cutout template as a guide (MIN 2.25"). Allow for **1"** extra space at the end of the installation for the Take-Up Box.
- 2:** Place the desired BIY Channel Connectors against the wall. Ensure the connector is aligned with the installation location. Mark the location of each BIY Channel Connector to determine the cut length of the channels.
- 3:** Cut out the marked area using a "Dremel Multi-Max" or a 6" Fixed Jab Saw. Mark the location of the studs on the drywall.

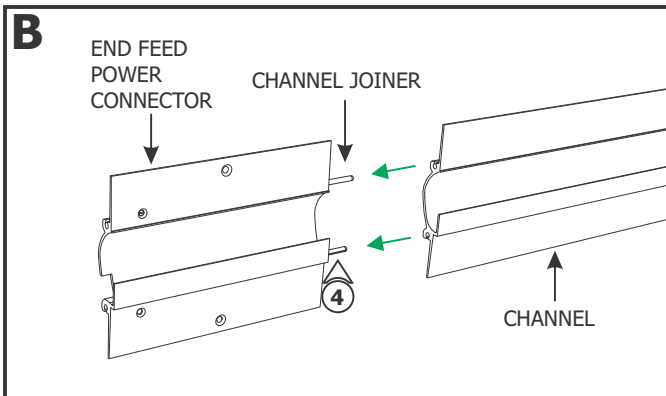

**NOTE:** Channel may be cut in the field. For installation over 120" join two or more Reveal channels together.

**4:** Slide a channel onto the channel joiners on the End Feed Power Connector.

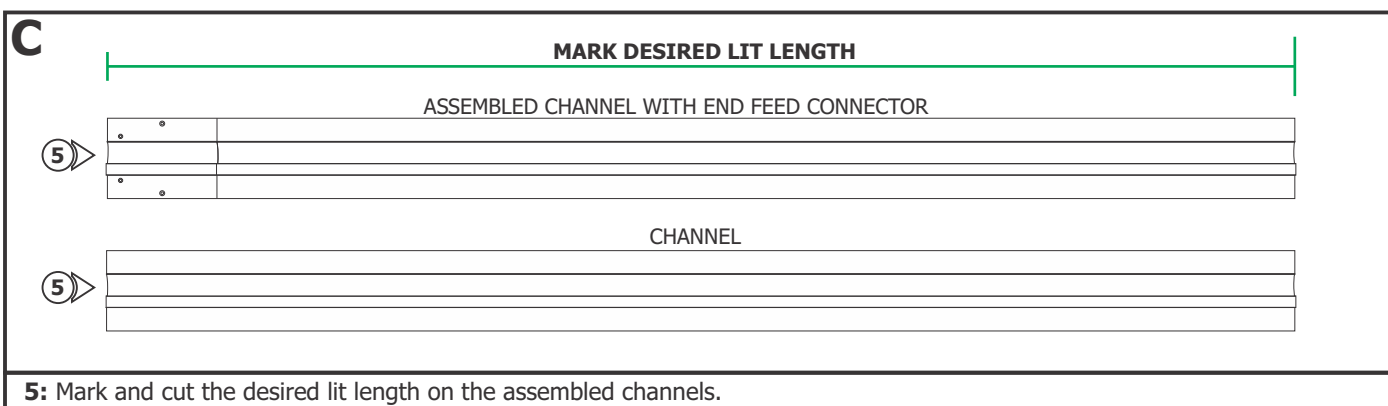

**5:** Mark and cut the desired lit length on the assembled channels.

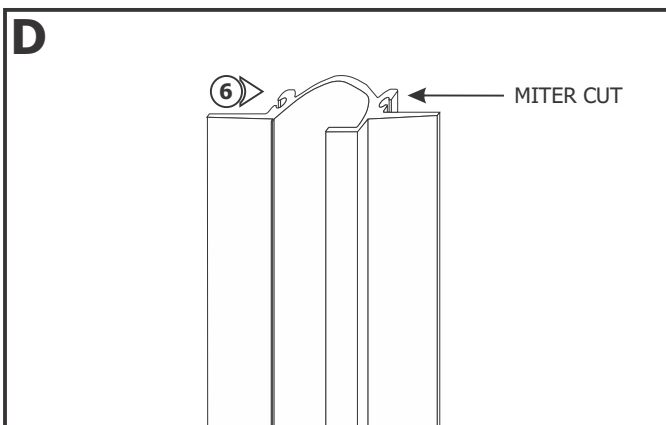

**6:** Miter cut each section of channel to match the corner angles. In a 90° corner installation, each channel section is cut at a 45° angle to form a complete corner.

## Section Two: Install Channels and Connectors

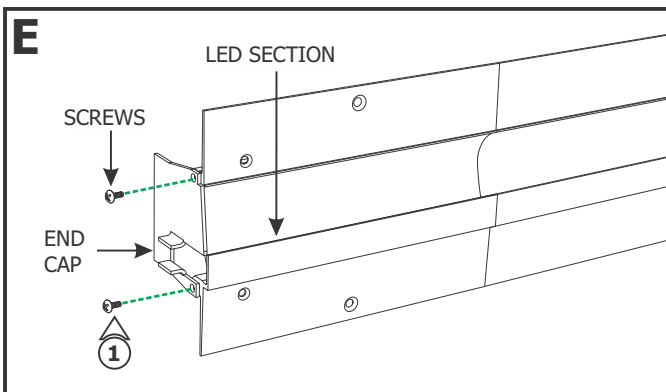

**1:** Attach the power feed end cap to the end of the End Feed Power Connector using the two Phillips screws. Align the slot with the LED section of the channel.

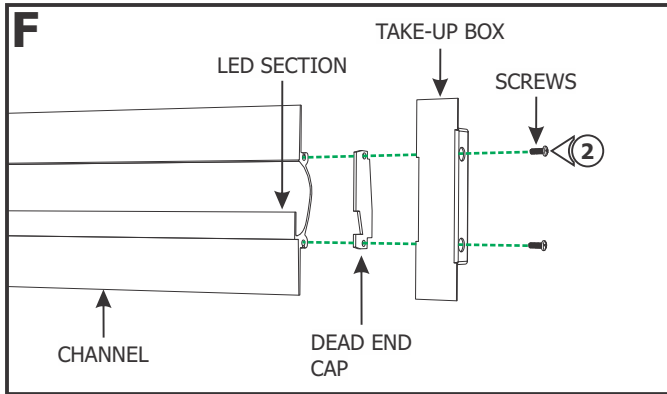

**2:** Install the dead end cap and take up box to the end of the channel opposite of the junction box using the supplied screws. Ensure the slot of the dead end cap aligns with the LED section of the channel.

**3:** Align the power feed end cap with the junction box opening slot and push the channel into the drywall cutout.

**4:** Make sure the channel is aligned straight using a level.

**5:** Secure the channel using the two #4-40 screws to the junction box. Fasten the drywall screws through the pre-drilled holes onto the studs. **If necessary drill new holes on channel flange where they line up with the studs using the #6 X 1-5/8" square trim screw with the square recess bit provided.**

**NOTE:** Ensure screw heads sit flush with the channel.

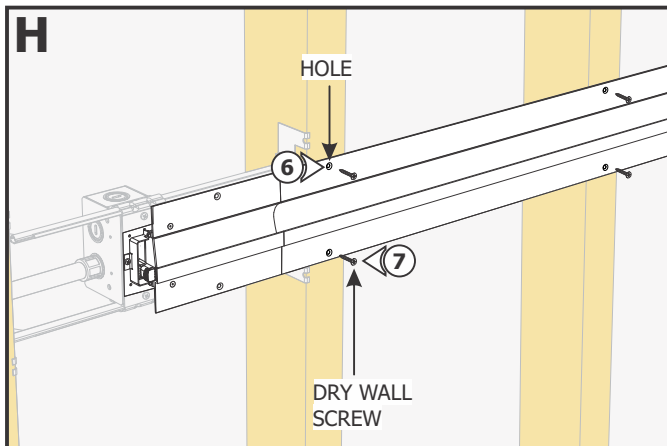
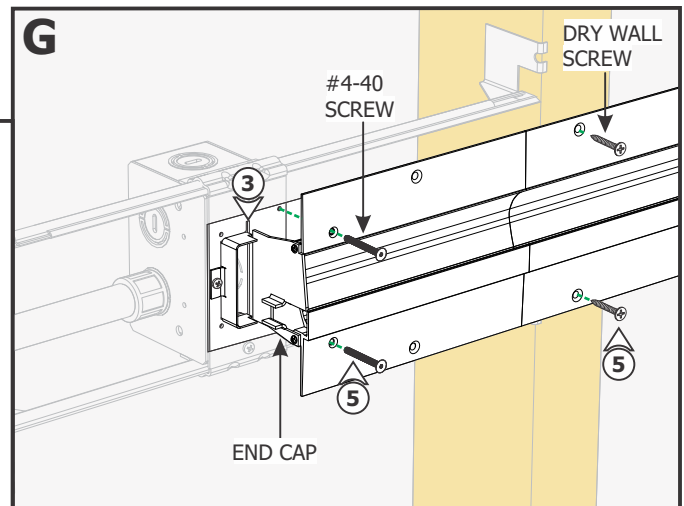

**6:** Drill and countersink holes to the channel at marked stud positions.

**7:** Secure the channel to the studs using drywall screws.

## Section Three: Install the LED Soft Strip

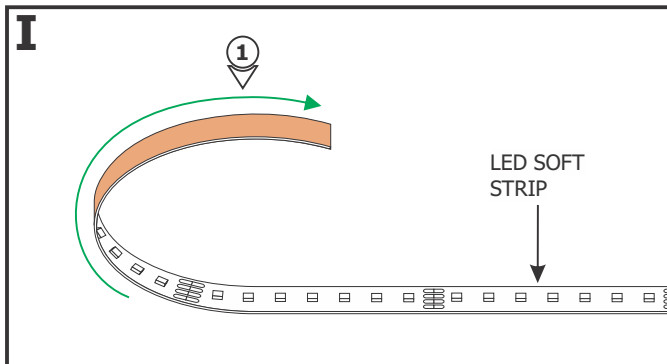

**1:** Gently uncoil the LED Soft Strip before applying to the channel surface otherwise the strip may lift off of the surface.

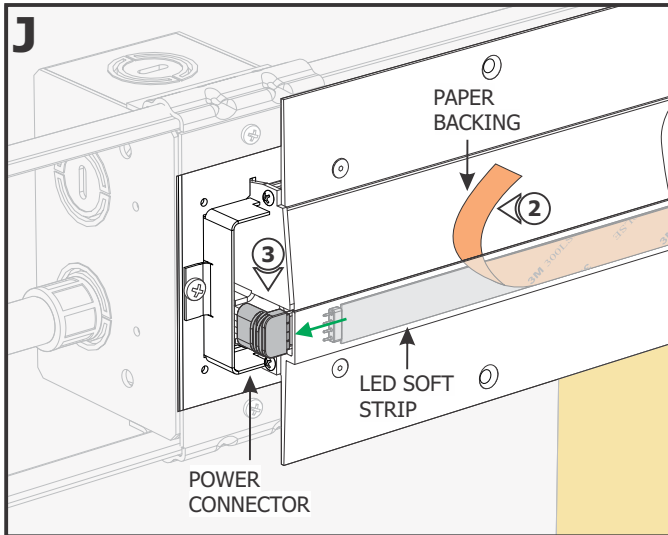

**NOTE:** If installation requires RGB, RGB+W, or Tunable White, refer to wiring diagrams on pages 7 and 8.

- 2:** Carefully remove the backing from the LED Soft Strip, making sure not to remove the tape from the LED Soft Strip.
- 3:** Refer to the installation instructions provided with the BIY Power Connector to connect the LED Soft Strip to the power connector.
- 4:** Firmly press down the adhesive portion of the LED strip onto the channel surface while removing the rest of the backing, making sure there are no air bubbles that can cause surface irregularities.

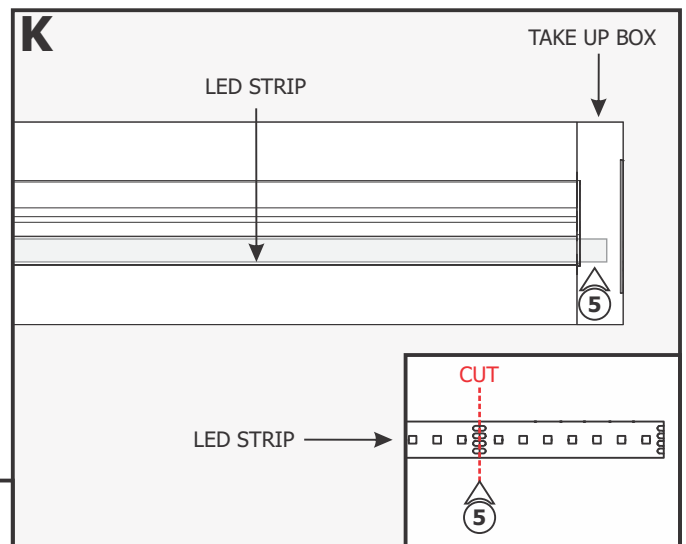

- 5:** Trim excess LED strip ONLY at the indicated trim lines (see inset). Insert excess LED strip into the take-up box.

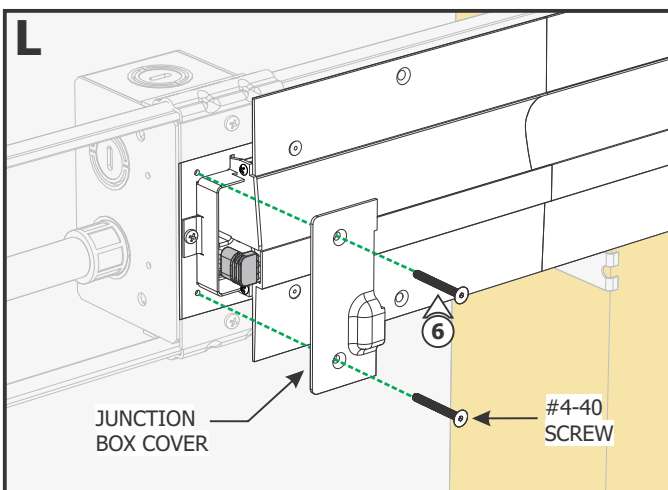

- 6:** Install the junction box cover onto the junction box using the #4-40 screws using a 1/16" Allen wrench.

## Section Four: Tape and Plaster

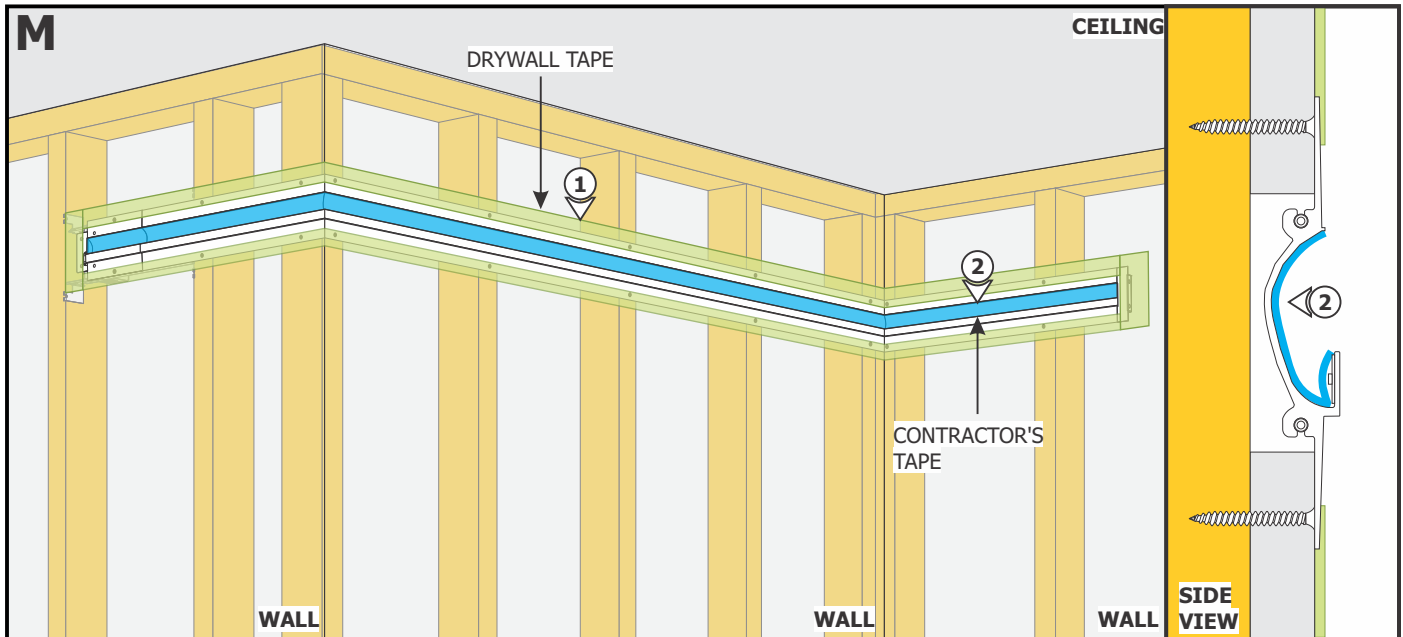

**NOTE:** Do Not use premixed joint compound "Soft Mud." No use compuesto para juntas premezclado "Soft Mud."

**NOTE:** For areas with lots of vibration, it is suggested to use Durabond to avoid cracking of plaster.

**NOTE:** Recommended plaster method: 1st Coat - Durabond 45 with 8" Blade, 2nd Coat - Easy Sand 45 with 10" Blade, 3rd Coat - with 12" Blade.

**1:** Must apply drywall tape (Ultra-Thin drywall tape suggested) along edges of channel to prevent cracking of plaster after installation. **DO NOT** overlap strips of drywall tape.

**2:** Cover up the opening section of the Reveal channel with contractor's tape to prevent plaster and dust entering inside the channel.

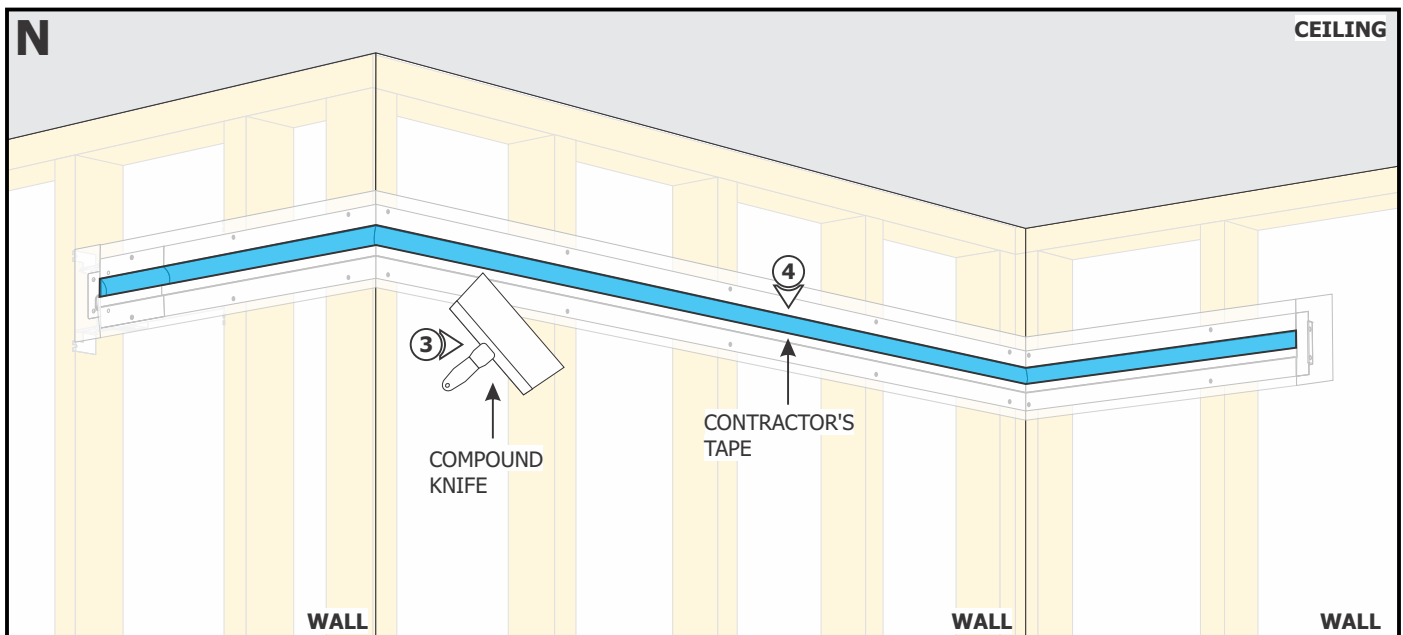

**3:** Plaster the channel flange edge to the wall and fill screw holes. Use a compound knife for a smooth compound spread. Sand, paint, and finish the wall properly.

**4:** Remove the contractor's tape and clean the inside of the channel.

## IMPORTANT INFORMATION REGARDING INSTALLATION AND REWORK OF SOFT STRIP LED



**DO** gently pull up and away from the soft strip if removing to reposition. This avoids damaging the strip.

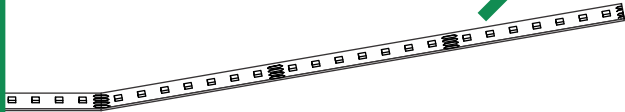

**DO NOT** pull the strip back towards itself. Doing so risks damaging the strip and making it not function.

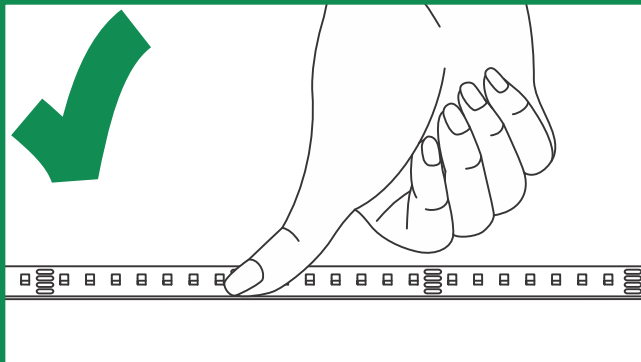
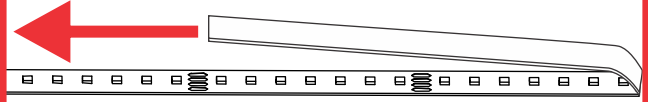

**DO** only ever use fingers to gently install soft strip to a surface **AFTER** cleaning the surface with alcohol.

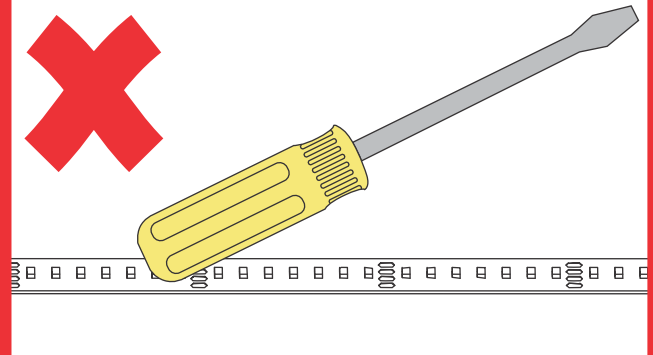

**DO NOT** use any tool to install soft strip to a surface. This will damage the soft strip component.

### Relocating Soft Strip (Optional)

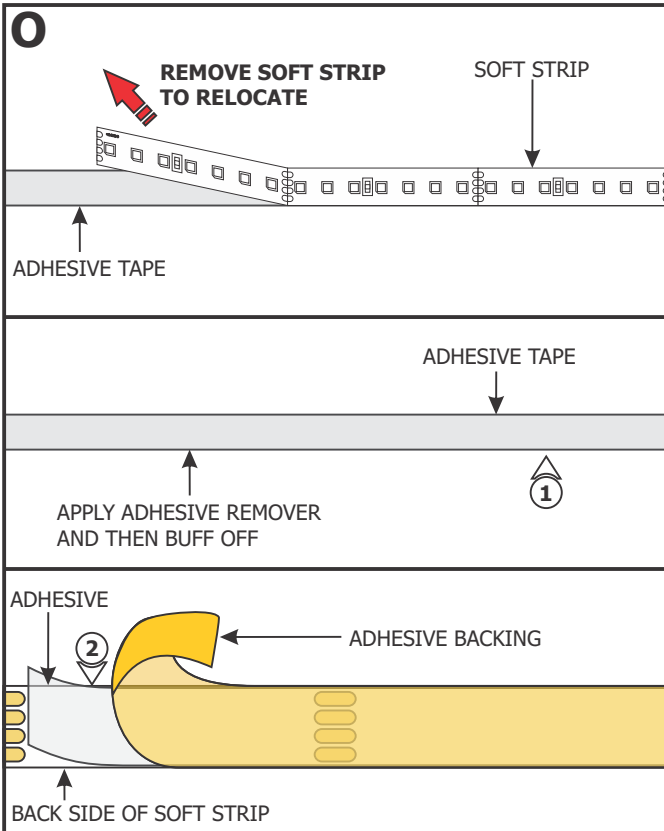

**NOTE:** If relocating the installed soft strip, make sure that the adhesive tape on back of the soft strip covers the entire strip. The adhesive tape isolates the strip from the installation surface. Damaged or inconsistent adhesive tape may cause the contacts on the back of the strip to come in contact with the conductive heat sink which will cause the strip to short and burn. Call PureEdge Lighting to get replacement adhesive tape and/or optional aluminum heat sink tape (SS-HR-F).

- 1:** To remove tape residue from back of the strip, apply WD-40, Goo Gone, or a mixture of warm water and lemon oil to the corner of a clean, dry towel. Gently buff the area containing the adhesive residue until it is completely removed.
- 2:** Gently remove a few inches from one side of the tape backing. Attach the adhesive tape to the back of the soft strip and apply moderate pressure to affix the tape. Continue this step a few inches at a time until the entire adhesive tape is attached to the back of the soft strip.
- 3:** Refer to Section Three to reinstall the LED Soft Strip.

# General Wiring Diagrams

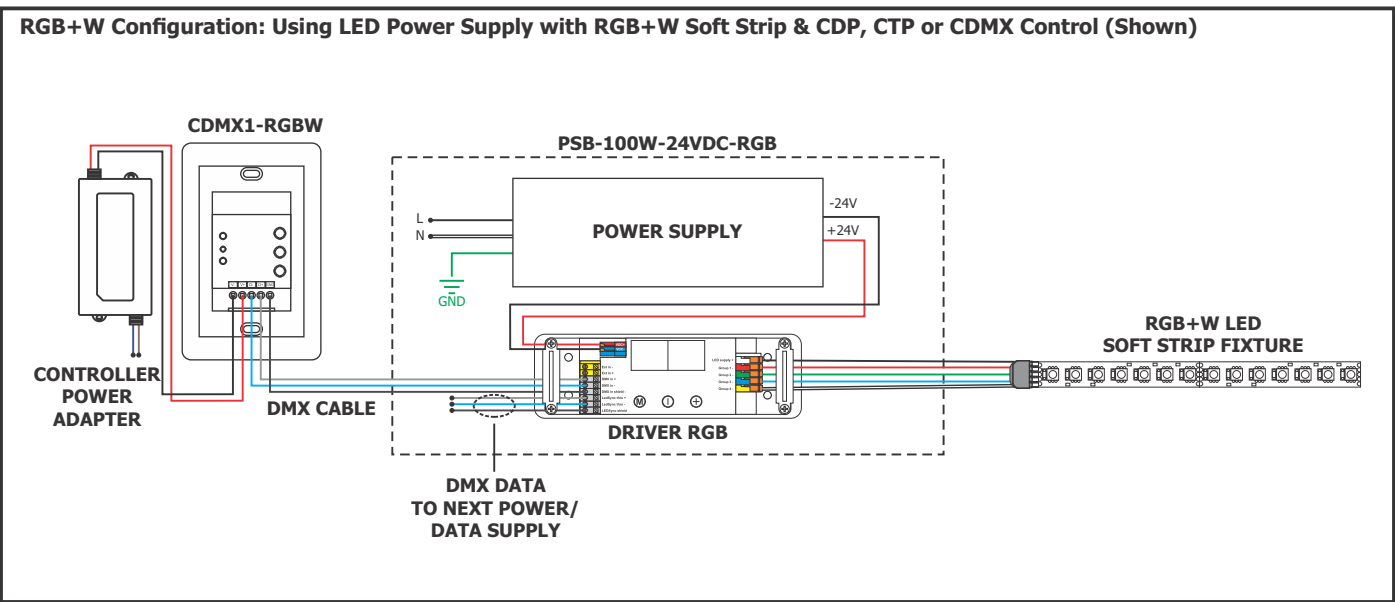
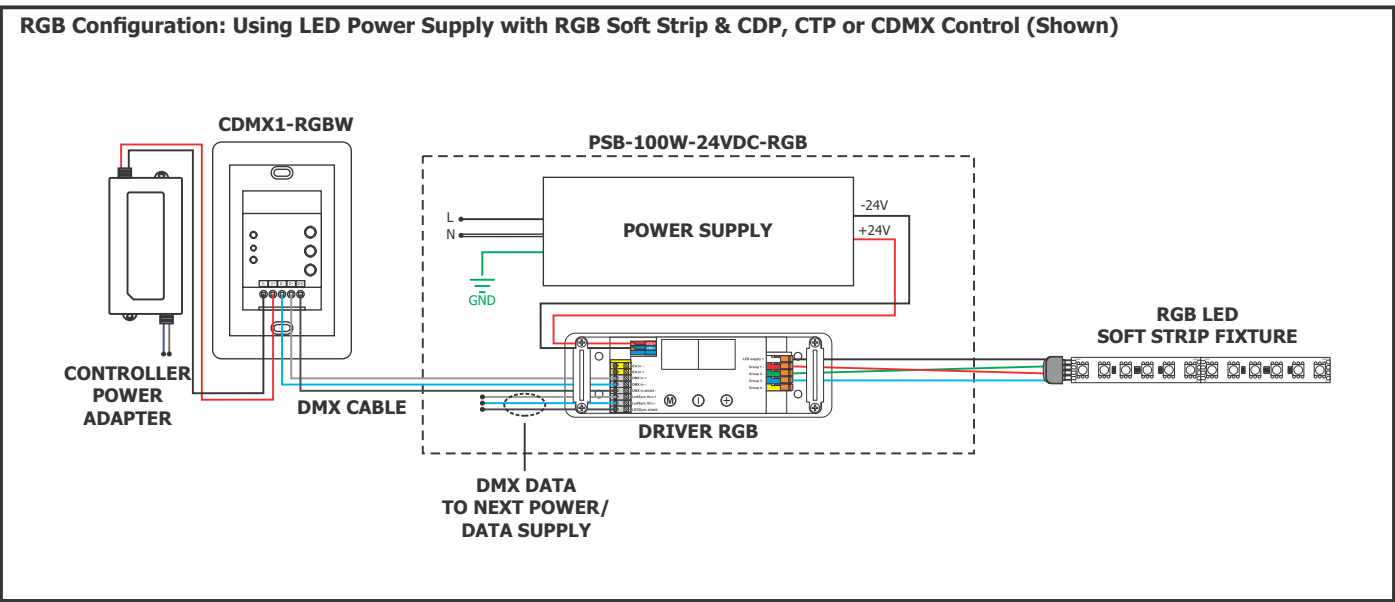
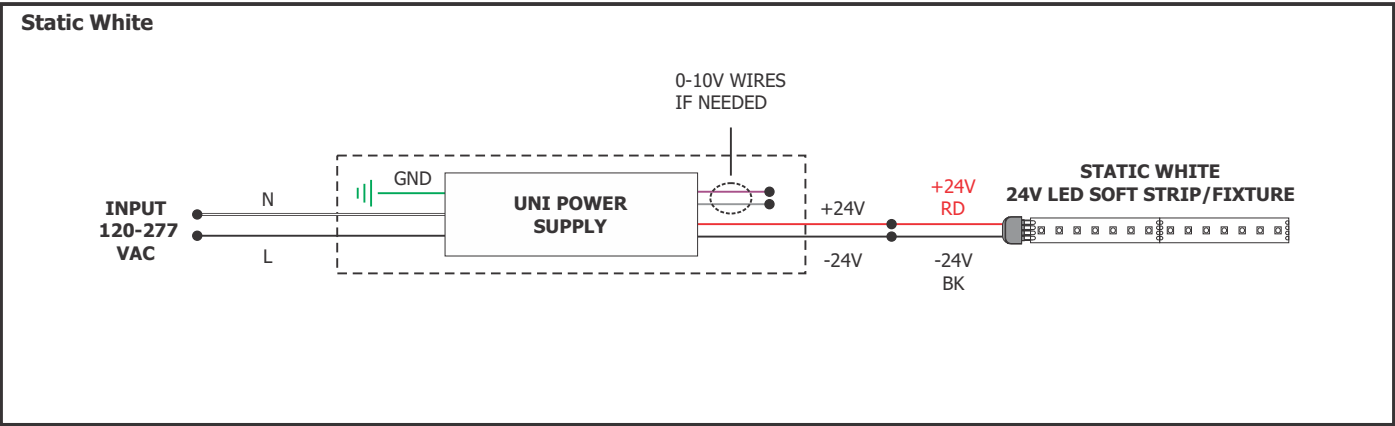

### Tunable White: Dual Power Supplies Controlled Via Individual Dimmers

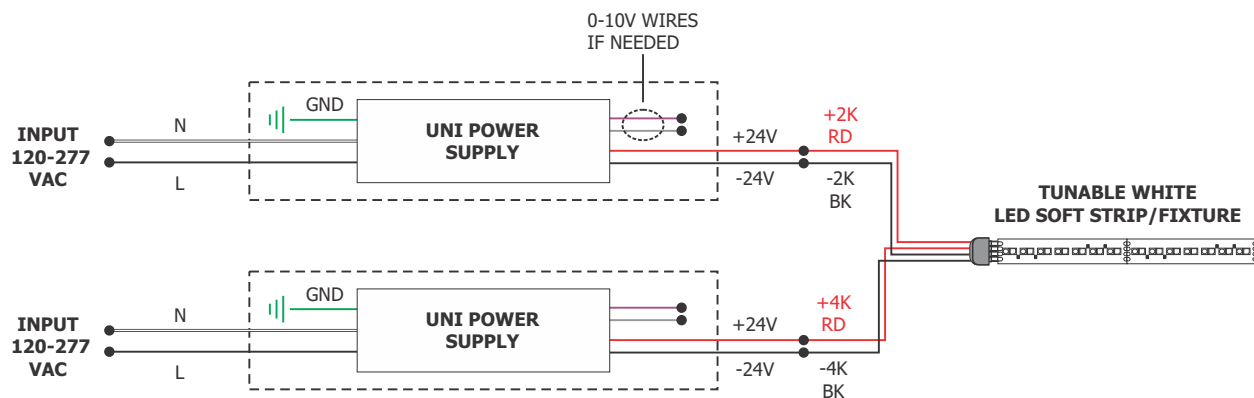

### Tunable White: 2XK Power Supply with CDMX Controller

