



1718 W. Fullerton Chicago, IL 60614
 Ph: 773.770.1195 • Fax: 773.935.5613
 www.PureEdgeLighting.com • info@PureEdgeLighting.com
 © 2016 PureEdge Lighting. All Rights Reserved.

Installation Instructions for **Reveal End Feed Power Channel Connector**

RV-EP-__



IMPORTANT INFORMATION

- Reveal is used for toe kick or cove lighting.
- This instruction must be used concurrently with other Reveal BIY installation instructions.
- It is recommended more than one person to install the Reveal.
- This instruction shows a typical installation.

SAVE THESE INSTRUCTIONS!

Section One: Install the Junction Box

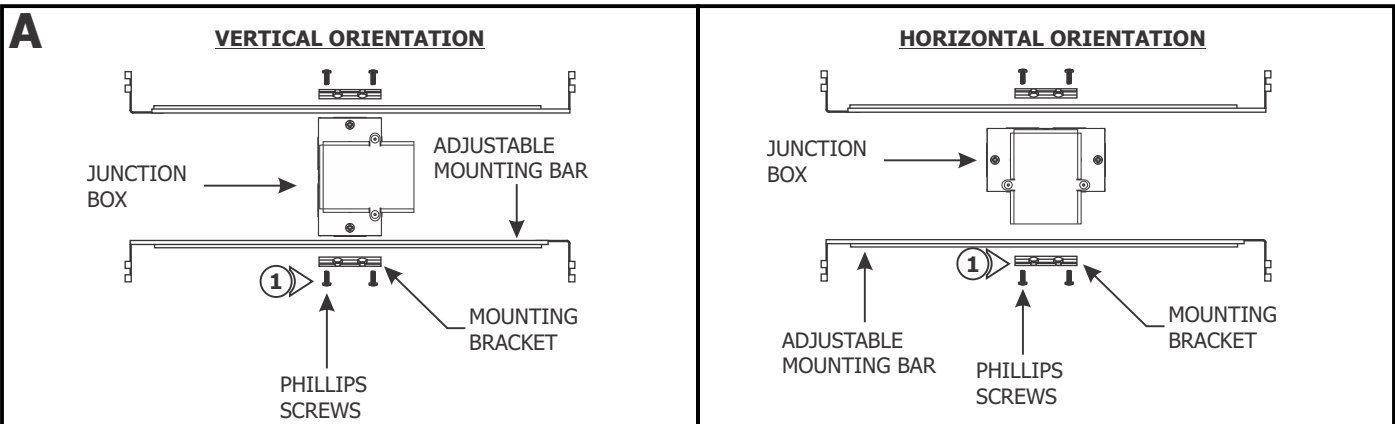

NOTE: Before beginning any electrical work, ensure that power to the electrical box is turned off.

- 1:** Mount each adjustable mounting bar to one side of the junction box (mounts to any side of the housing depending on the orientation of the channel) and secure them with the mounting brackets and two Phillips screws provided.

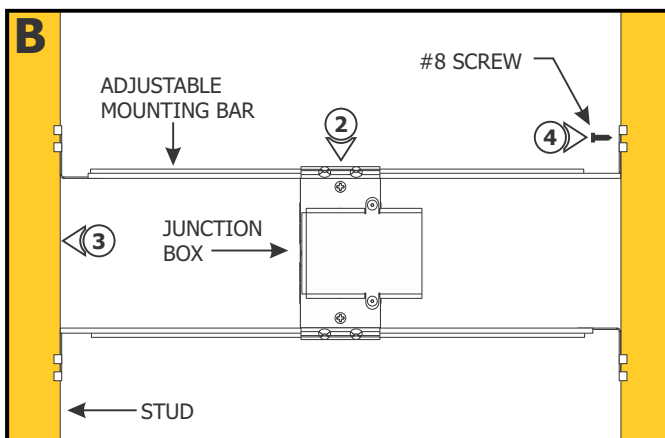

NOTE: The adjustable mounting bars mount to studs that are spaced 15"-24" apart. If the span needs to be shorter than 15", then break the bar arms from dedicated lines.

- 2:** Select the location between the two studs for the junction box to be mounted.
- 3:** Place the adjustable mounting bars between the studs.
- 4:** Make sure the lips on the adjustable mounting bars are against the studs. Secure the adjustable bars to the studs with the #8 screws.

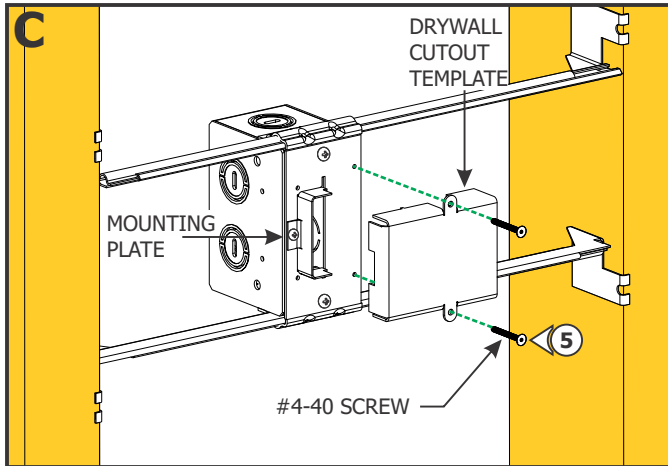

5: Remove the two #4-40 screws using a 1/16" Allen wrench to pull the drywall cutout template completely off the junction box mounting plate. Save the template and screws for later use.

- 6:** Remove a knockout on the junction box to install conduit into the power feed electrical box.
- 7:** Install the conduit and run the low voltage 24VDC power wires.

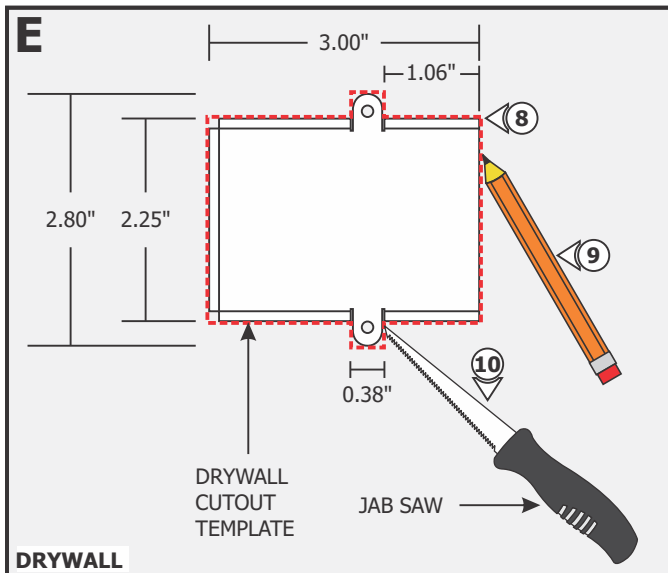
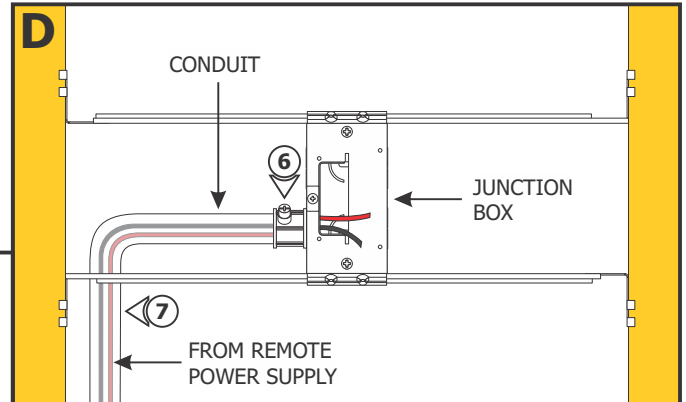

8: Mark a location on the drywall where the junction box will be located.

9: Trace the drywall cutout template onto the drywall at the junction box location.

10: Remove drywall cutout template and cut out the marked area using a jab saw or other appropriate tool to expose the junction box.

11: Install the drywall.

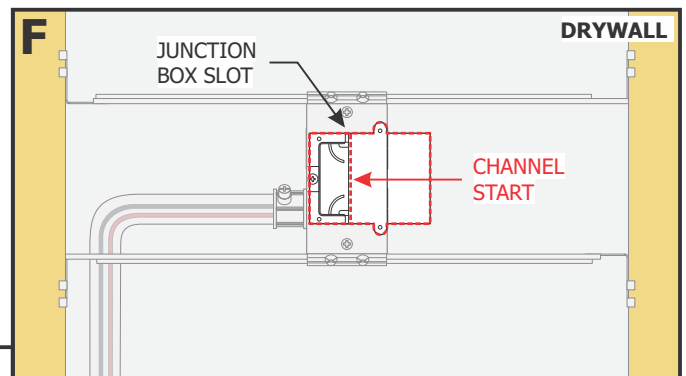

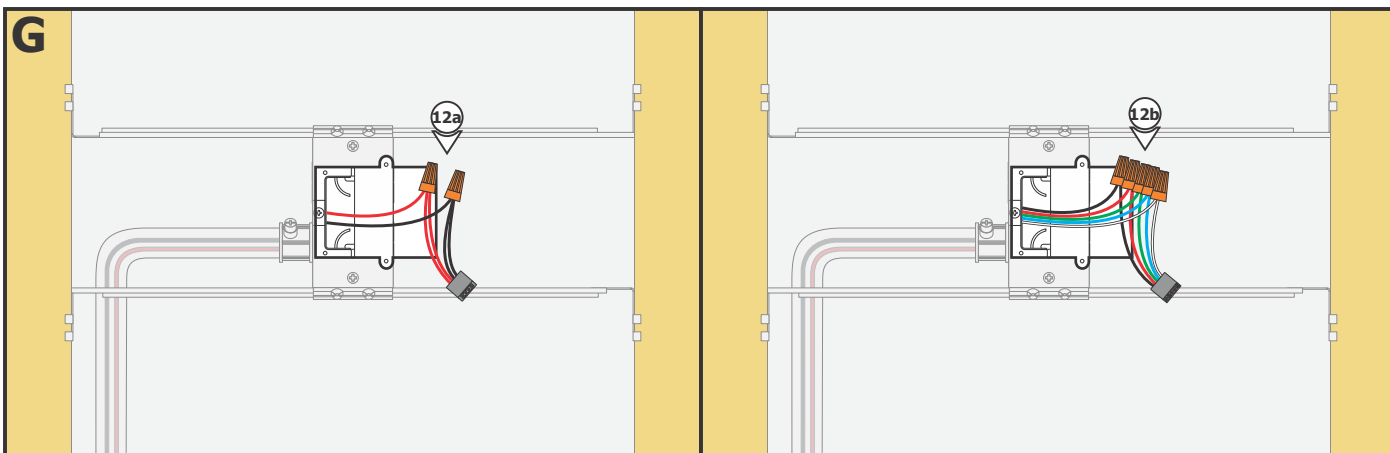

NOTE: Remote power supply wires must be present in junction box. Refer to instructions provided with power supply.

12a: Connect the red low voltage wire of the power supply to the red wires of the power connector with a wire nut. Connect the black low voltage wire of the power supply to the black wires of the power connect with a wire nut.

12b: For RGBW Configurations, connect the black, red, green, blue, and white wires of the DMX controller respectively to the black, red, green, blue, and white wires of the power connector with wire nuts.

13: Place all wire nut connections inside the junction box.

CAUTION: Unroll the entire LED strip from the reel and use the power connector to power the strip making sure there is no outage before continuing with the installation. Afterwards, carefully roll the LED strip loosely back into the reel.

Section Two: Prepare and Install the End Feed Power Connector

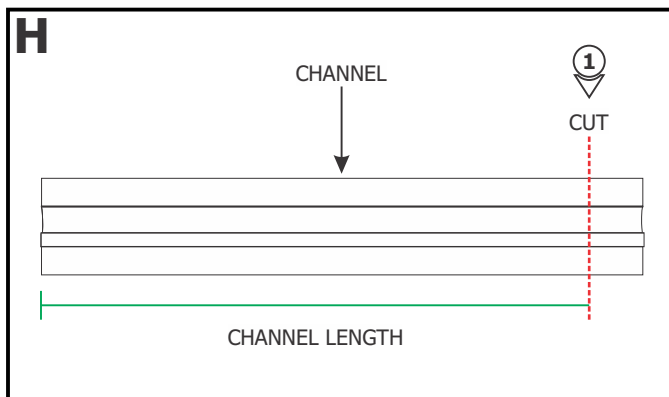

1: Refer to Section One in the Reveal Channel instructions to measure and cut the channel before continuing.

2: Attach the power feed end cap to the end of the End Feed Power Connector using the two Phillips screws. Align the slot with the LED section of the channel.

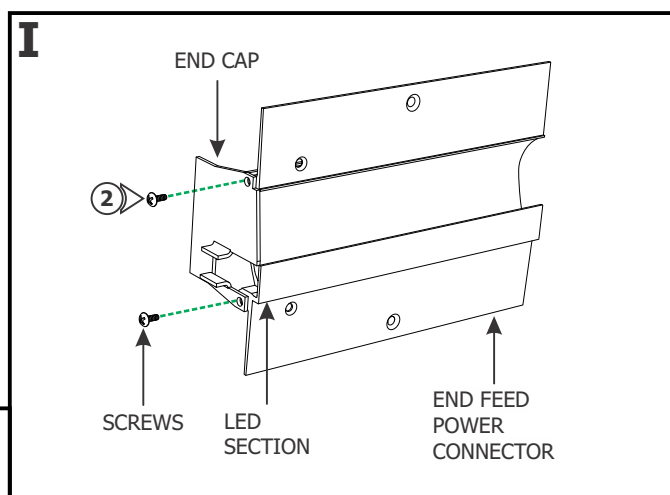

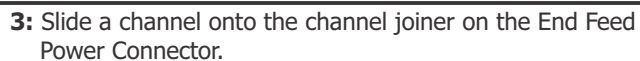

- NOTE:** Ensure screw heads sit flush with the channel.

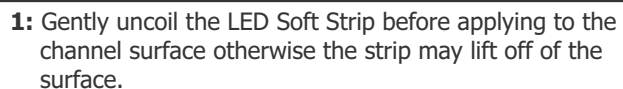

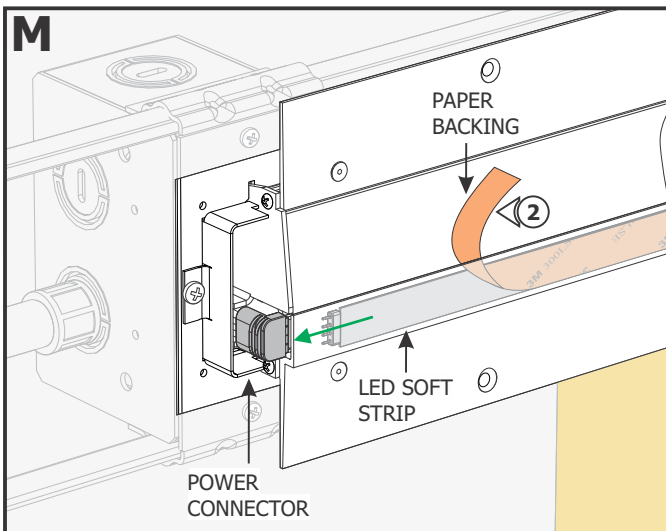

2: Carefully remove the backing from the LED Soft Strip, making sure not to remove the tape from the LED Soft Strip.

3a: Line up the red wire side of the power connector with the "24VDC" marking on the LED Soft Strip. Push the male connector of the strip into the power connector.

3b: For RGBW Configurations, align the RGBW markings on the LED Soft Strip with the corresponding wires of the power connector. Push the male connector of the LED Soft Strip into the power connector.

4: Firmly press down the adhesive portion of the LED Soft Strip onto the channel surface while removing the rest of the backing, making sure there are no air bubbles that can cause surface irregularities.

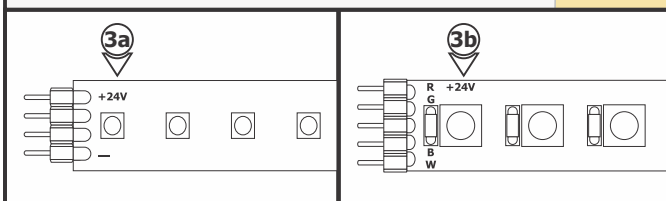

5: Install the junction box cover onto the junction box using the #4-40 screws using a 1/16" Allen wrench.

NOTE: Refer to Section Four in the Reveal Channel instructions to tape and plaster.

