



1718 W. Fullerton Chicago, IL 60614
 Ph: 773.770.1195 • Fax: 773.935.5613
 www.PureEdgeLighting.com • info@PureEdgeLighting.com
 © 2016 PureEdge Lighting. All Rights Reserved.

Installation Instructions for TruLine Trim 1.6A L-Picture Frame Power Channel Connector

TLT1.6A-LP-___

IMPORTANT INFORMATION

- This instruction shows a typical installation.
- This fixture is wall or ceiling mount.
- This instruction must be used concurrently with other TruLine Trim 1.6A DIY installation instructions.
- This product must be installed by a qualified electrician and in accordance with local electrical codes.

SAVE THESE INSTRUCTIONS!

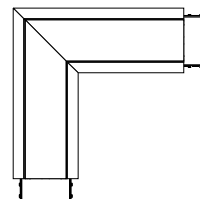

Section One: Install the Junction Box

A

VERTICAL ORIENTATION

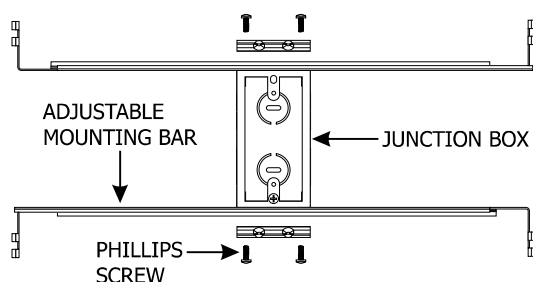

HORIZONTAL ORIENTATION

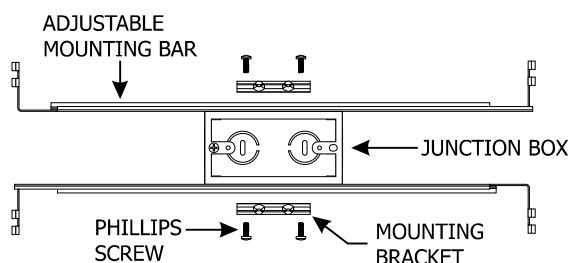

- 1:** Mount each adjustable mounting bar to one side of the junction box (mounts to any side of the housing depending on the orientation of the channel) and secure them with the mounting brackets and two Phillips screws provided.

NOTE: The adjustable mounting bars mount to studs that are spaced 15" to 24" apart. If the span needs to be shorter than 15", then break the bar arms from dedicated lines.

- 2:** Select the location between the two studs for the junction box to be mounted.
- 3:** Place the adjustable mounting bars between the studs.
- 4:** Make sure the lips on the adjustable mounting bars are against the studs. Secure the adjustable bars to the studs with screws.

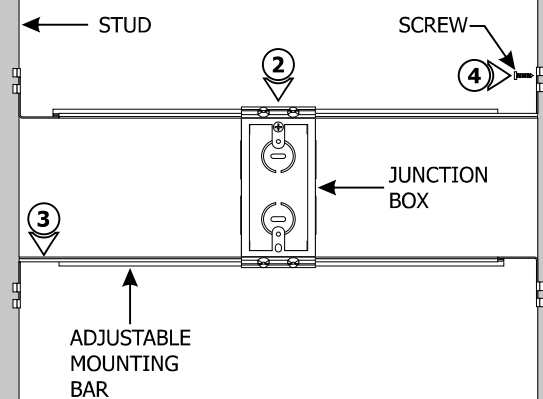
B

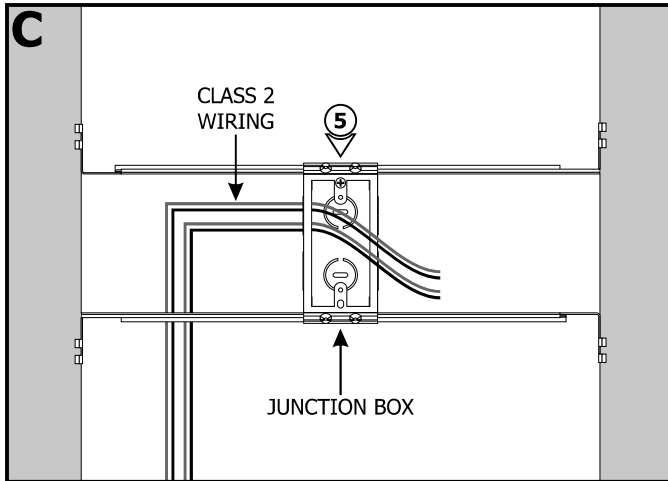

5: Run the Class 2 low voltage wires coming from the remote power supply to the junction box. Only install conduit if required by local electrical codes.

6: Refer to the instruction provided with the power supply along with the wiring diagram for proper wiring.

7: Cut a section of drywall using a 6" fixed jab saw or other appropriate tool to expose the mounting plate area. Install the drywall.

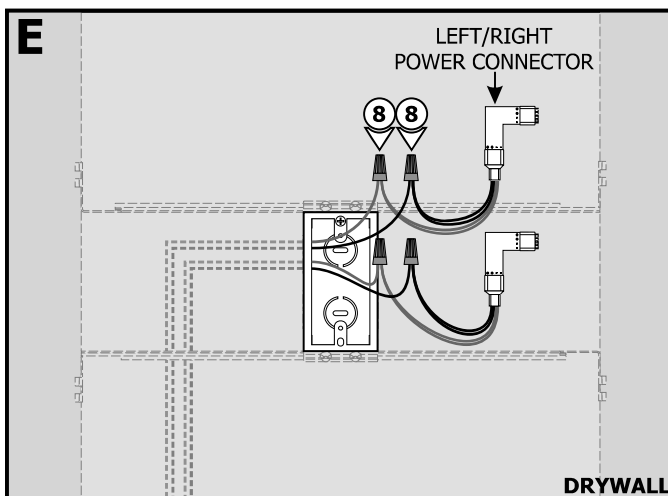
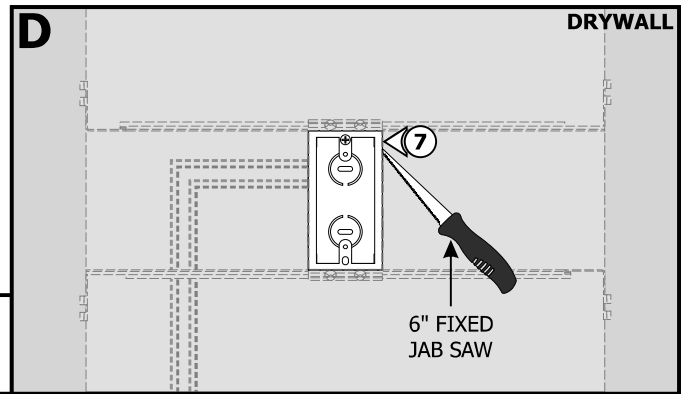

8: Connect the +24VDC power supply wire to the red "+" wires of the power connector using a wire nut. Connect the -24VDC power supply wire to the black wires of the power connector using a wire nut.

9: Repeat step 8 to connect the other power connector to the power supply.

10: Place all wire nut connections inside the junction box.

CAUTION: Unroll the entire LED strip from the reel and use the power connector to power the strip making sure there is no outage before continuing with the installation. Afterwards, carefully roll the LED strip loosely back into the reel.

Section Two: Prepare and Install the L-Picture Frame Power Connector

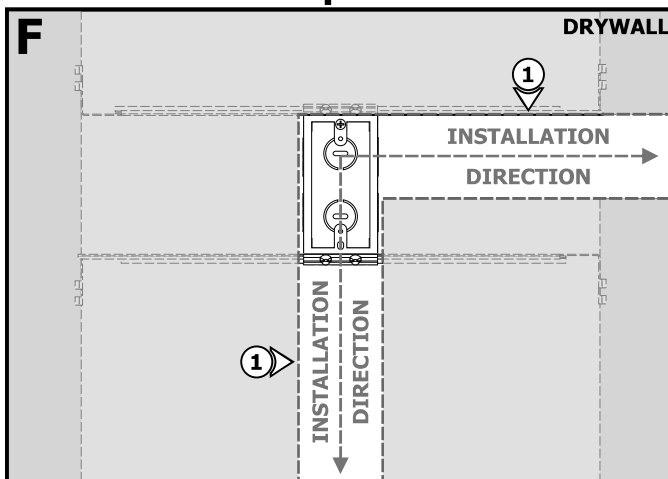

1: Mark and cut out the area where the installation will be located using the junction box opening as a guide (MIN. 2-1/4").

2: Refer to the TruLine Trim 1.6A instruction to measure and cut the channel and lens before continuing.

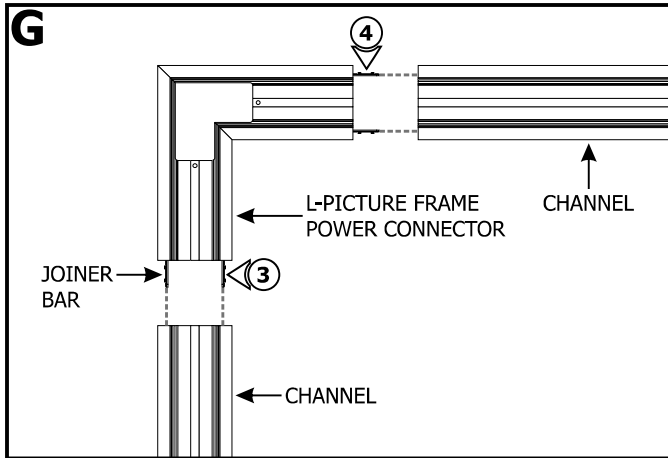

3: Slide a channel onto the joiner bars of the L-Picture Frame Power Connector and tighten the remaining M3 set screws using a 1.5mm Allen wrench.

4: Repeat step 3 for the other end of the L-Picture Frame Power Connector.

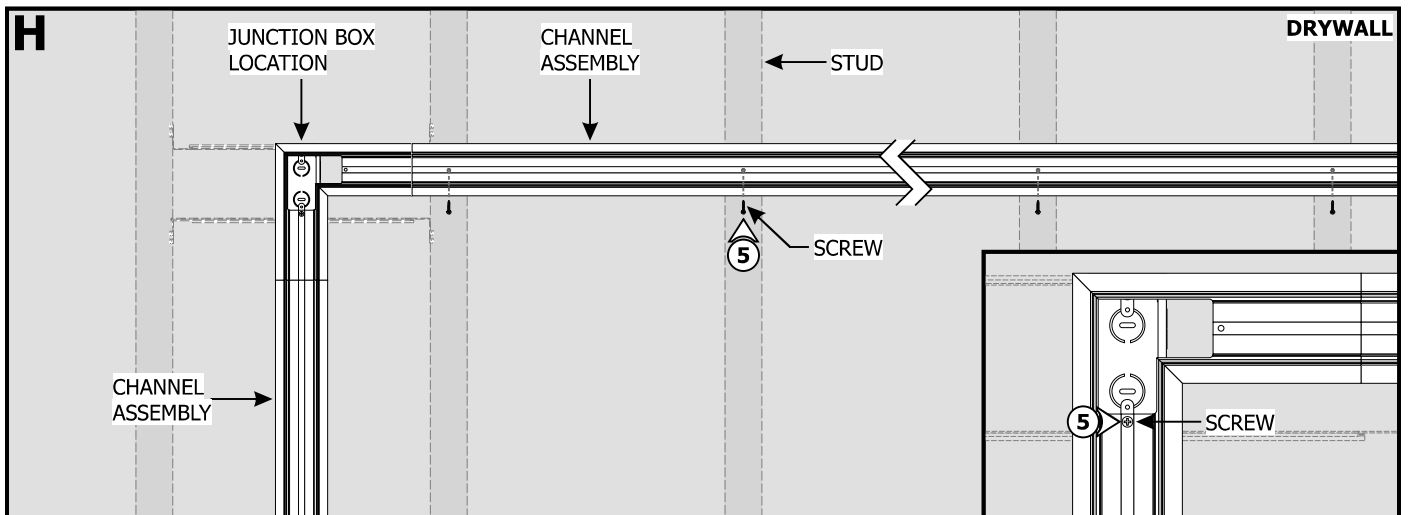

5: Place the channel assembly into the drywall cut out. If necessary, carefully make holes on the center of the channel. Using the marked locations on the drywall, secure the channel to the studs with the #6 drywall screws. Secure the channel assembly to the junction box using the provided screw.

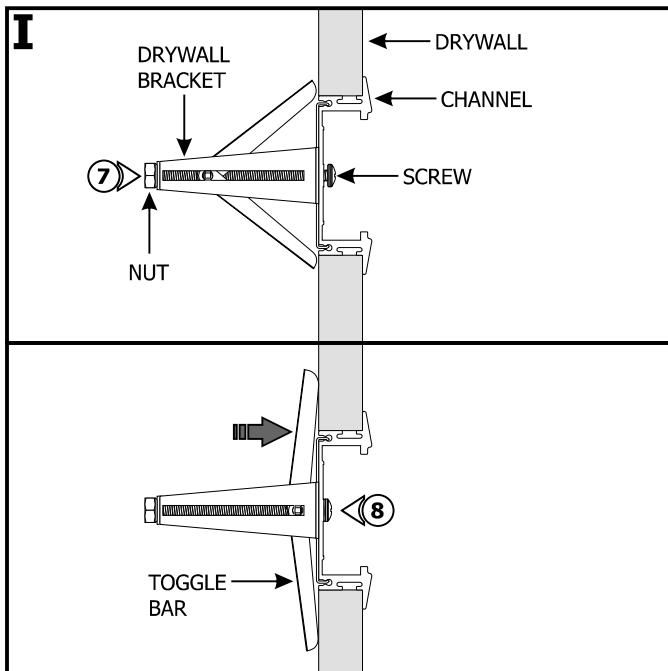

6: If the channel does not line up with a stud, use the provided Drywall Bracket to install the channel to the drywall.

7: Snap the Drywall Bracket to the back of the channel. Feed the screw through the channel, toggle bar, and nut.

8: Place the channel assembly into the drywall cutout. Tighten the screw to secure in place. The screw will stop when the toggle bar is tight and secure behind the wall.

Section Three: Install the LED Strip

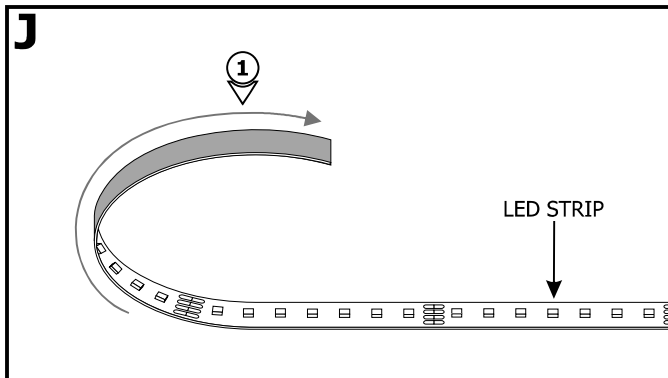

1: Gently uncoil the LED Strip before applying to the channel otherwise the strip may lift off of the surface.

2: Carefully remove the backing from the power connector making sure not to remove the tape.

3: Place the outer corner power connector into the channel where the LED Strip will be installed.

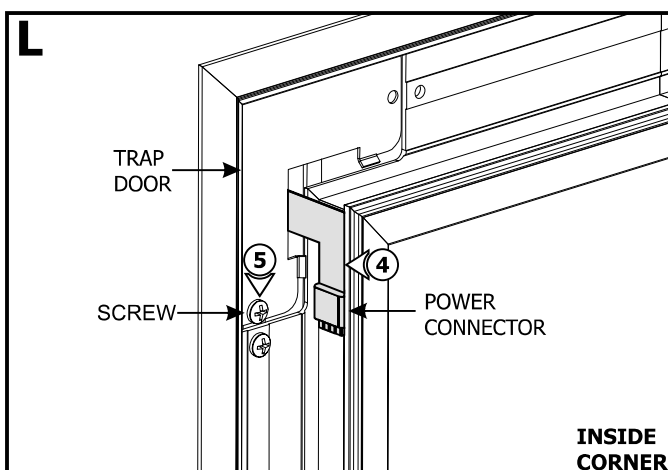
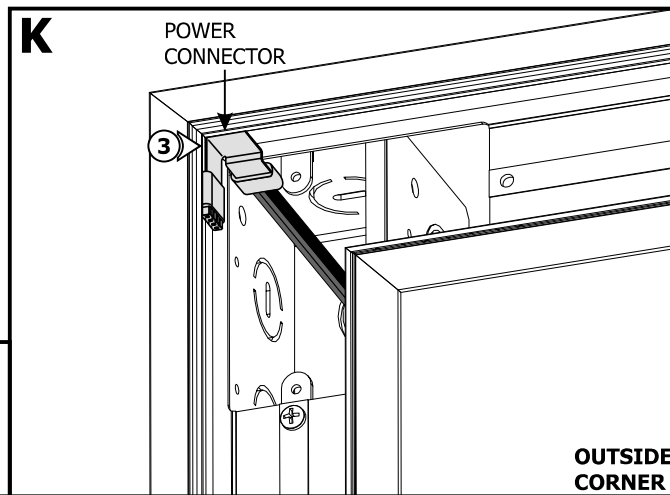

4: Place the inner corner power connector into the channel where the LED Strip will be installed.

5: Replace the trap door and secure using the screw.

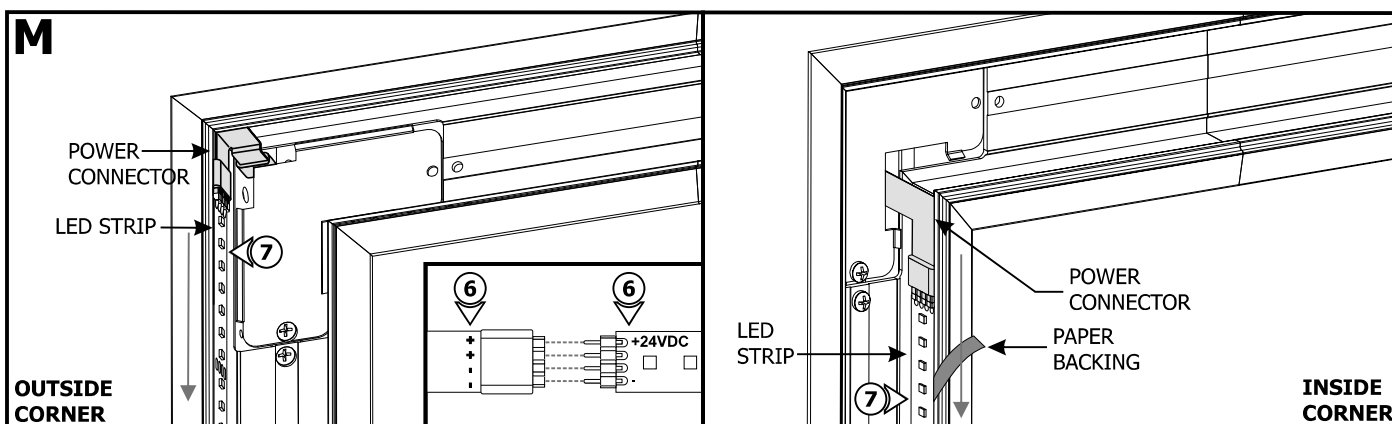

6: Carefully remove the backing from the LED Strips, making sure not to remove the tape. Line up the "+" marking on the power connectors with the "+" marking on each LED Strip. Push the pins of the LED Strips into the power connectors.

7: Firmly press down the adhesive portion of the LED Strips onto the channel surface while removing the rest of the backing, making sure there are no air bubbles that can cause surface irregularities.

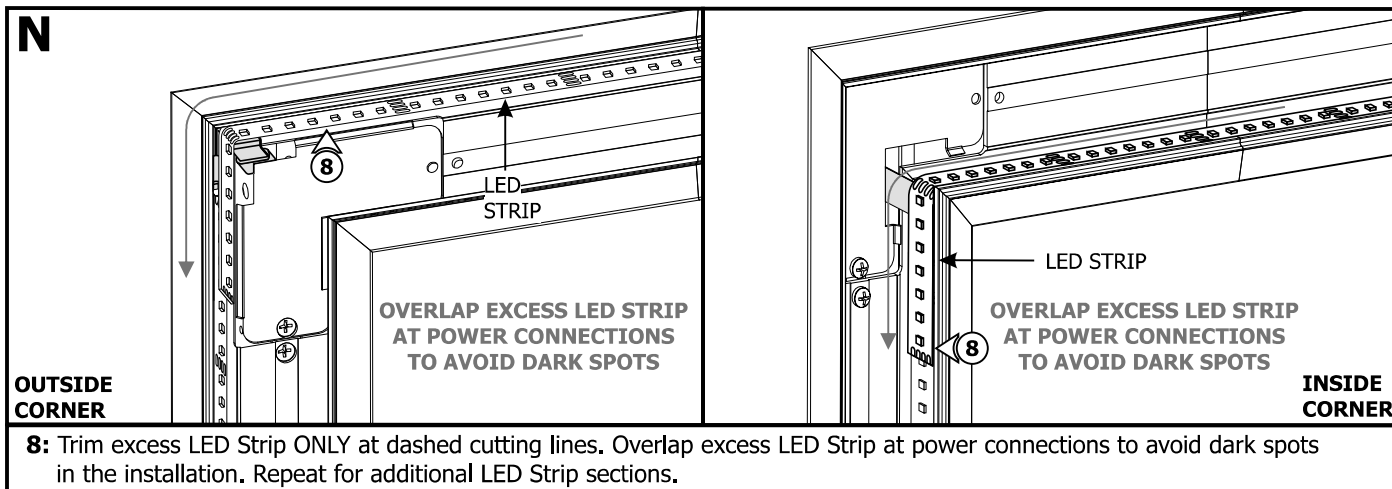

Section Four: Install the Lenses

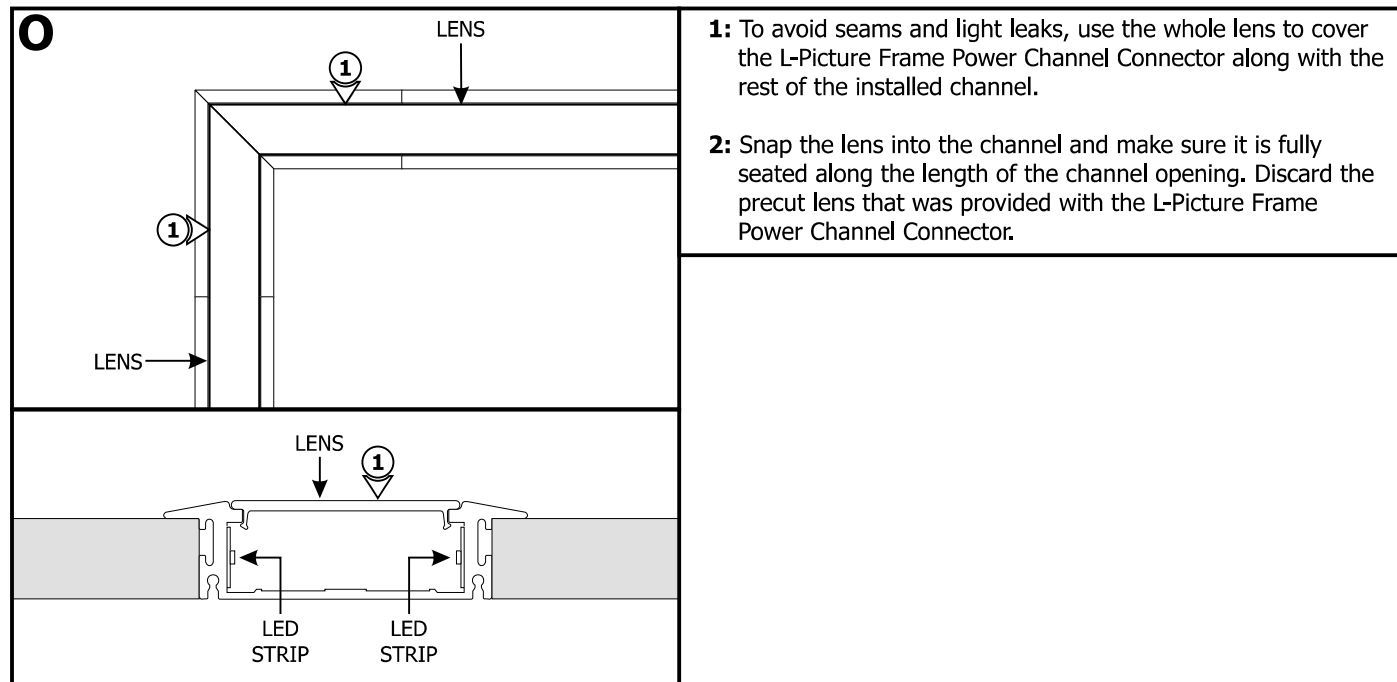

General Wiring Diagrams

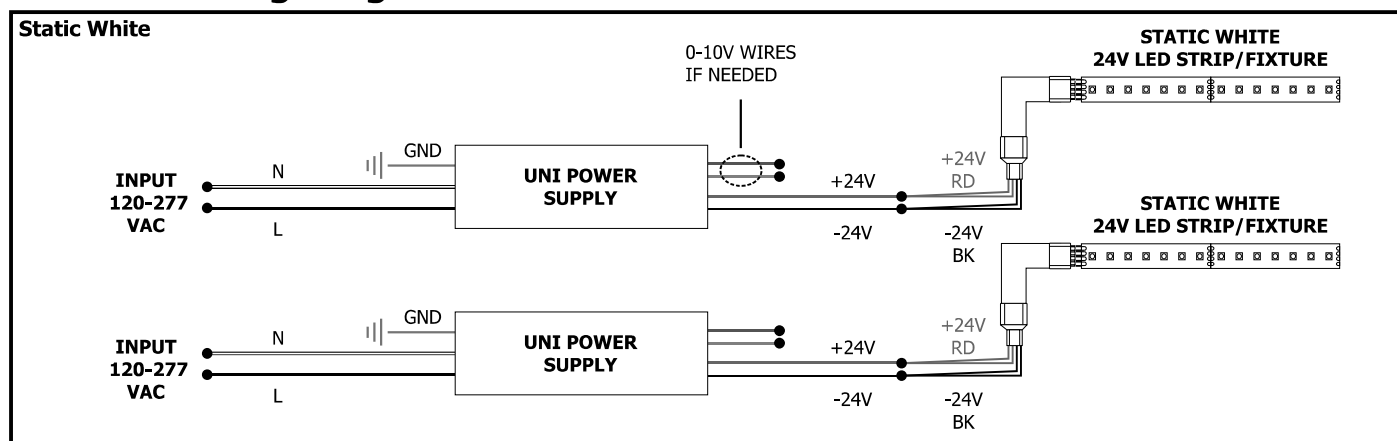

RGB Configuration: Using LED Power Supply with RGB Soft Strip & CDP, CTP or CDMX Control

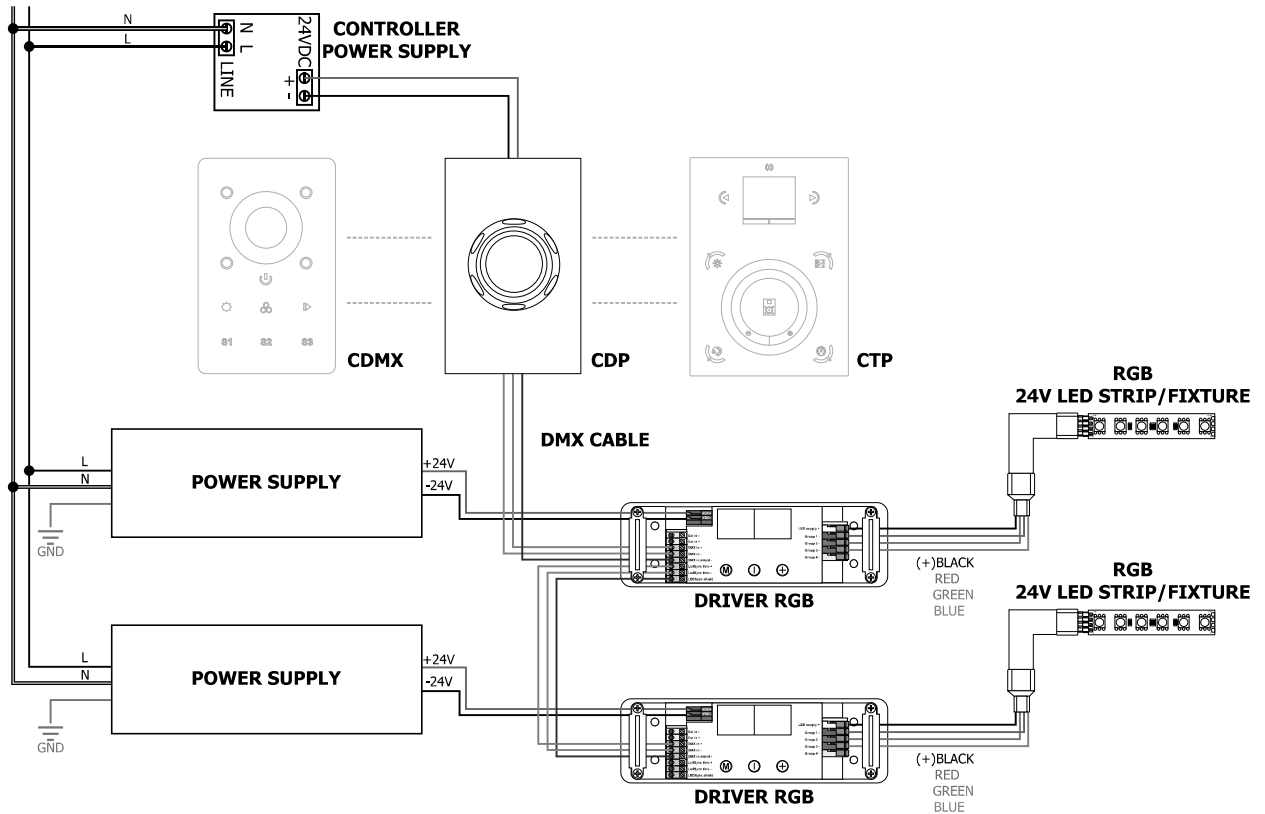

Tunable White: 2XK Power Supply with CDMX Controller

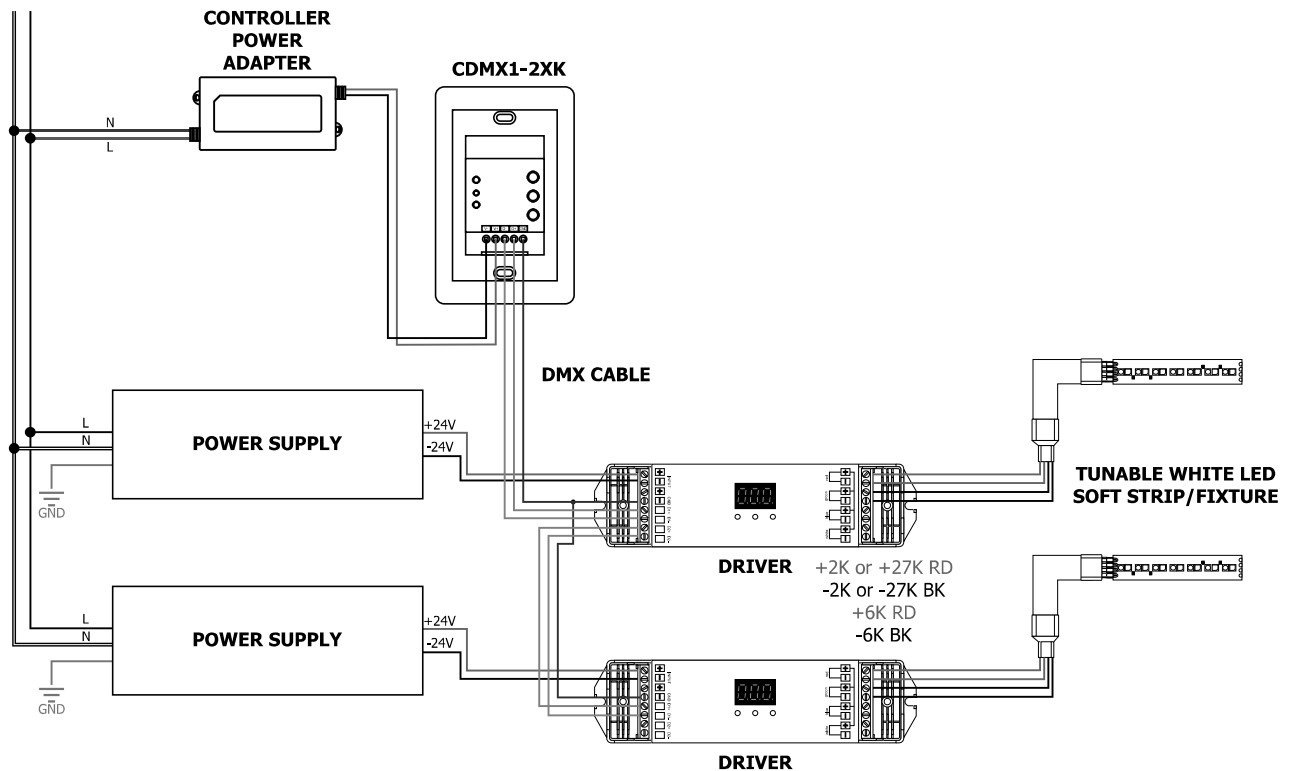

Tunable White: Two Channel Controls, for Intensity and Color Temperature

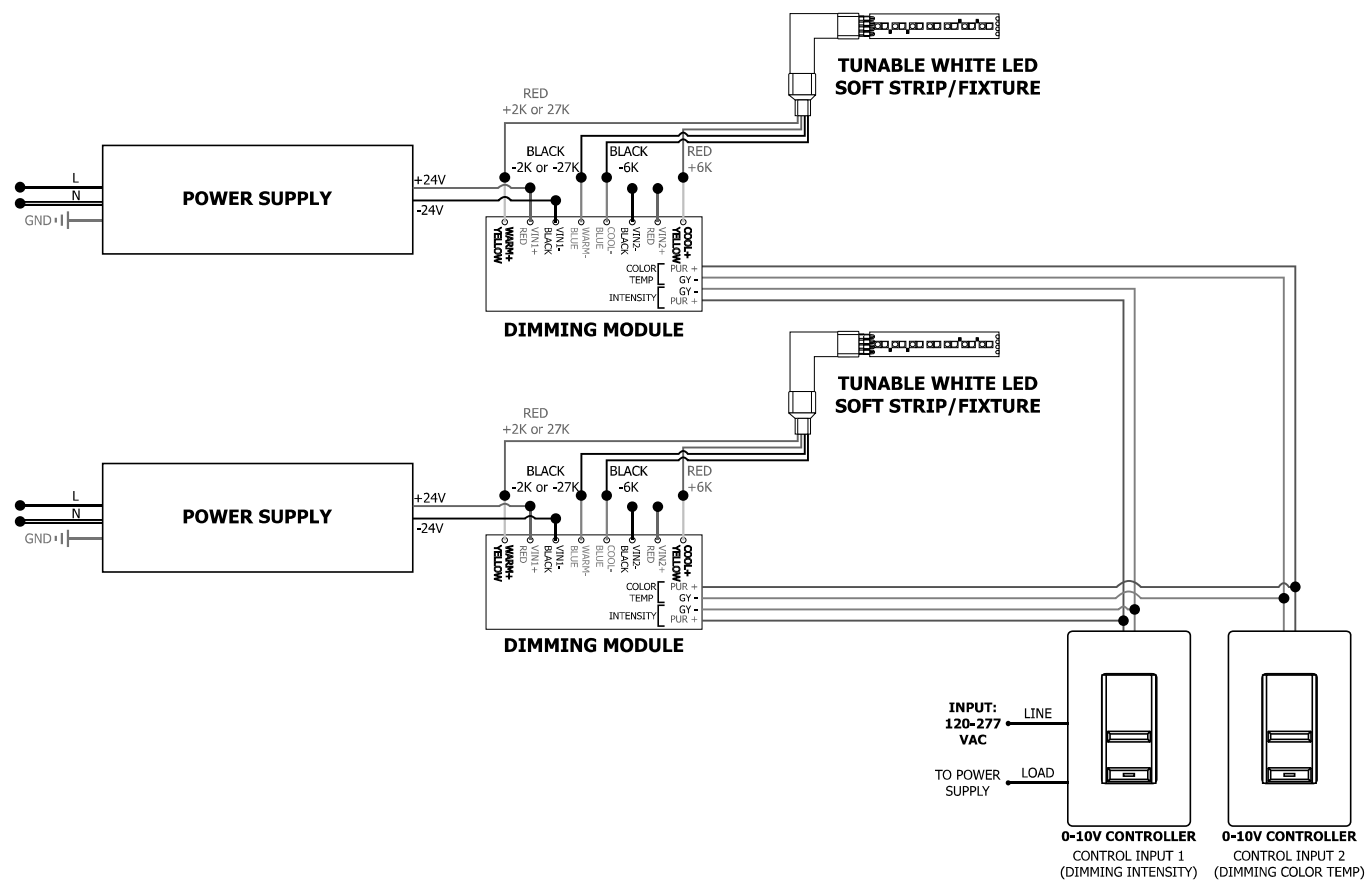

IMPORTANT INFORMATION REGARDING INSTALLATION AND REWORK OF SOFT STRIP LED

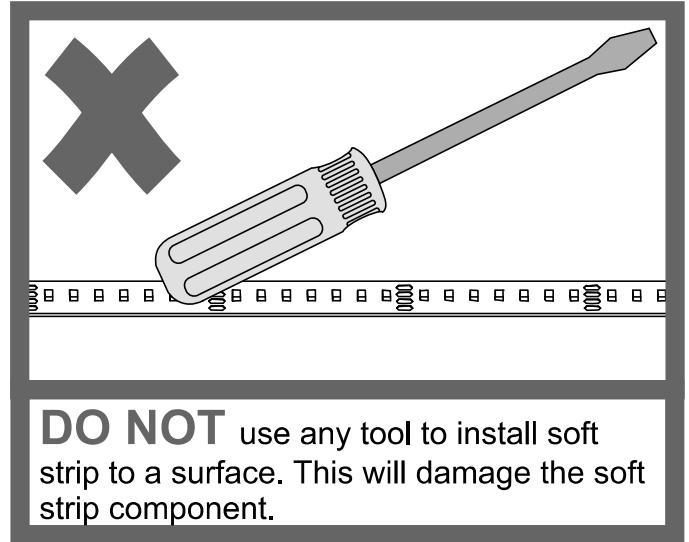
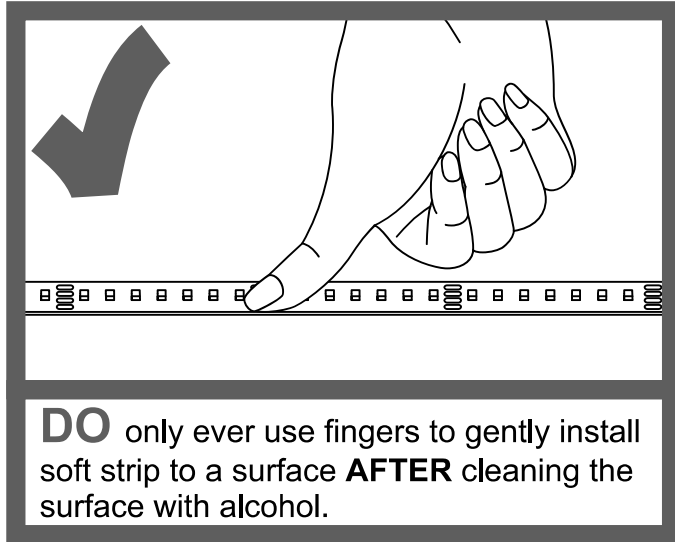
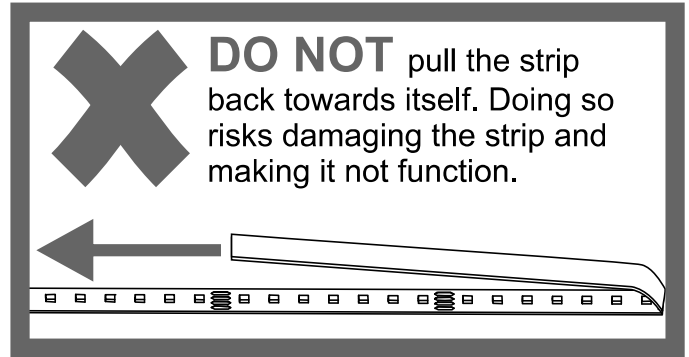
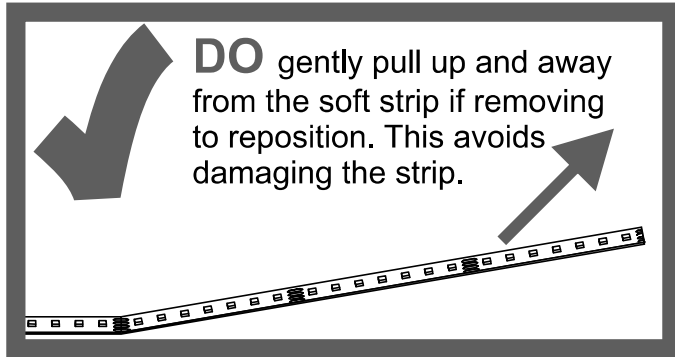

Section Five: Relocating LED Strip (Optional)

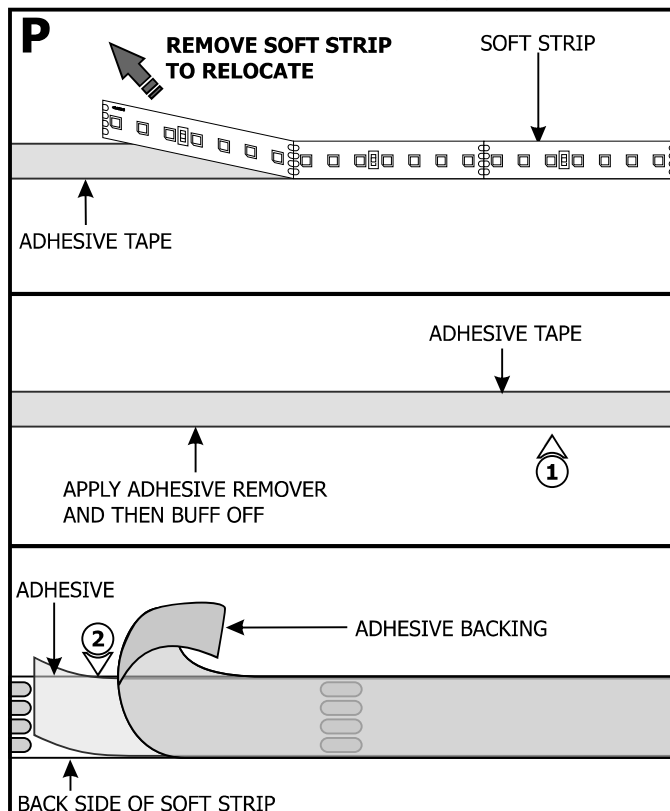

NOTE: If relocating the installed soft strip, make sure that the adhesive tape on back of the soft strip covers the entire strip. The adhesive tape isolates the strip from the installation surface. Damaged or inconsistent adhesive tape may cause the contacts on the back of the strip to come in contact with the conductive heat sink which will cause the strip to short and burn. Call Edge Lighting to get replacement adhesive tape and/or optional aluminum heat sink tape (SS-HR-F).

- 1:** To remove tape residue from back of the strip, apply WD-40, Goo Gone, or a mixture of warm water and lemon oil to the corner of a clean, dry towel. Gently buff the area containing the adhesive residue until it is completely removed.
- 2:** Gently remove a few inches from one side of the tape backing. Attach the adhesive tape to the back of the soft strip and apply moderate pressure to affix the tape. Continue this step a few inches at the time until the entire adhesive tape is attached to back of the soft strip.
- 3:** Refer to Sections Three to reinstall the LED strip.