



1718 W. Fullerton Chicago, IL 60614  
 Ph: 773.770.1195 • Fax: 773.935.5613  
 www.PureEdgeLighting.com • info@PureEdgeLighting.com  
 © 2016 PureEdge Lighting. All Rights Reserved.

## Installation Instructions for Luca 2.7" TruColor™ RGBTW, 24V Recessed Fixed, Adjustable, & Wall Wash Downlights Trimless

L27L-\_\_-WZ-TC-\_\_L

### IMPORTANT INFORMATION

- This instruction shows a typical installation.
- Suitable for wet locations.
- Use only with PureEdge Lighting specified trims.
- This product must be installed by a qualified electrician and in accordance with local electrical codes.
- Before beginning any electrical work, ensure that power is turned OFF.

**SAVE THESE INSTRUCTIONS!**

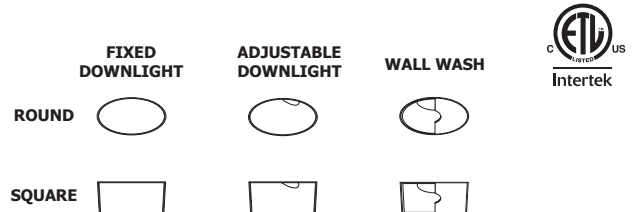

### Section One: Install the Remote Power Supply

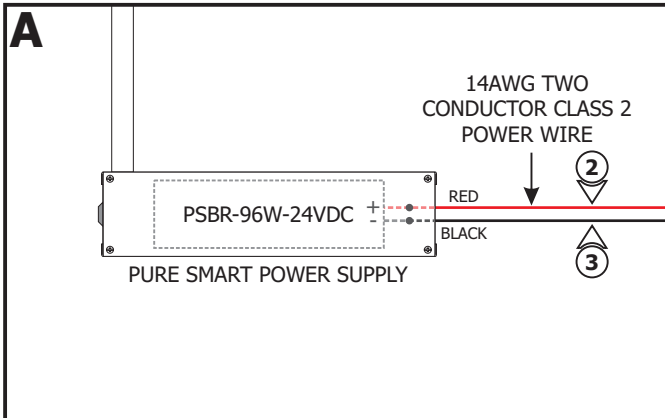

- 1: Remote power supplies must be installed within 60ft of the fixtures to avoid voltage drop.
- 2: Connect the 14AWG red wire to the +24VDC power supply wire using a wire nut.
- 3: Connect the 14AWG black wire to the -24VDC power supply wire using a wire nut.
- 4: Refer to the instructions and wiring diagram provided with the remote power supply.

### Section Two: Retro Fit Non-Insulation Contact (Remodeling)

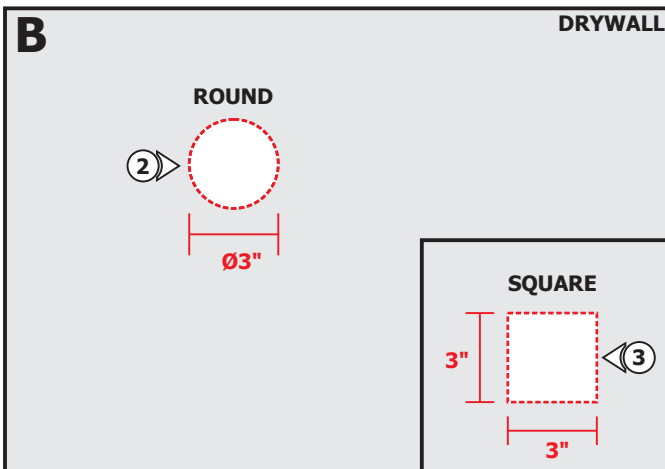

**NOTE:** Do not install insulation within 76mm (3in) of any part of the luminaire.

- 1: Determine the location of the Luca Downlights. Mark the locations on the ceiling.
- 2: **Round:** Use a Ø3" hole saw to cut out a hole on the drywall.
- 3: **Square:** Use a fixed jab saw to cut out a 3x3" square on the drywall.

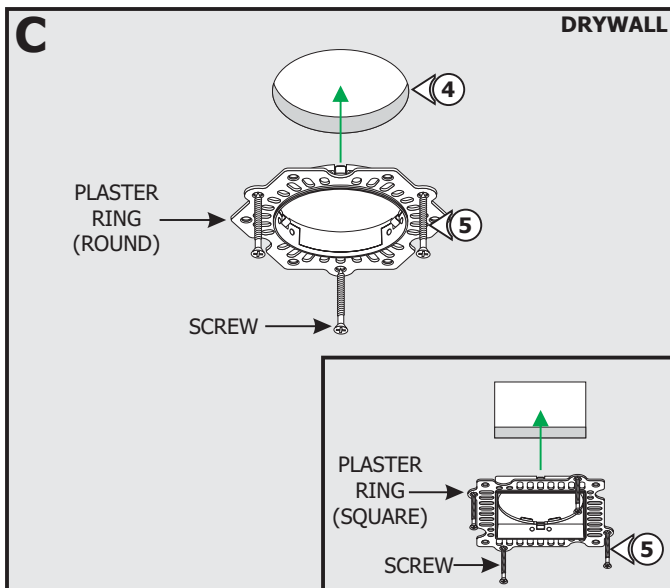

**4:** Insert the plaster ring into the drywall cutout.

**5:** Secure the plaster ring to the drywall using screws.

**6:** Plaster, sand, and paint the surface.

**NOTE:** For areas with lots of vibration, it is suggested to use Durabond to avoid cracking of plaster.

**NOTE: Do Not use premixed joint compound "Soft Mud."**  
**No use compuesto para juntas premezclado "Soft Mud."**

**NOTE:** Recommended plaster method: 1st Coat - Durabond 45 with 8" Blade, 2nd Coat - Easy Sand 45 with 10" Blade, 3rd Coat - skim coat with 12" Blade

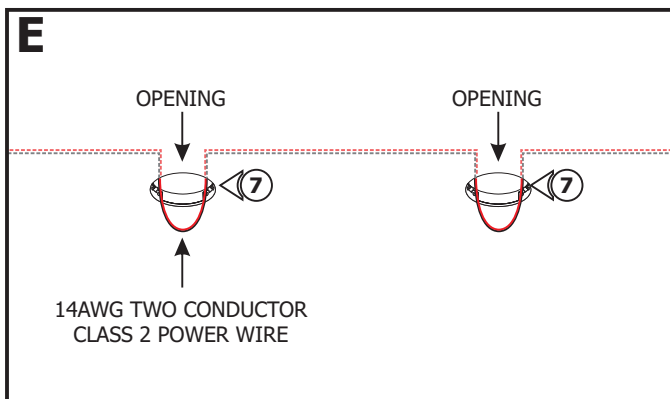
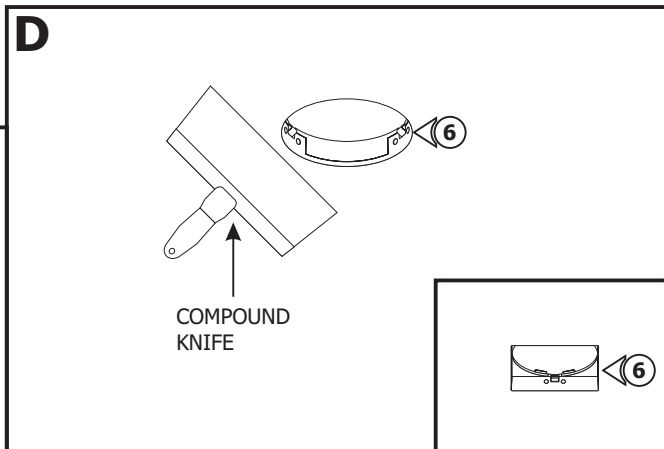

**7:** Run the 14AWG red and black wires coming from the remote power supply to each opening.

**8:** Continue to Section Five to complete installation.

## Section Three: Install the New Construction Frame Non-Insulation Contact

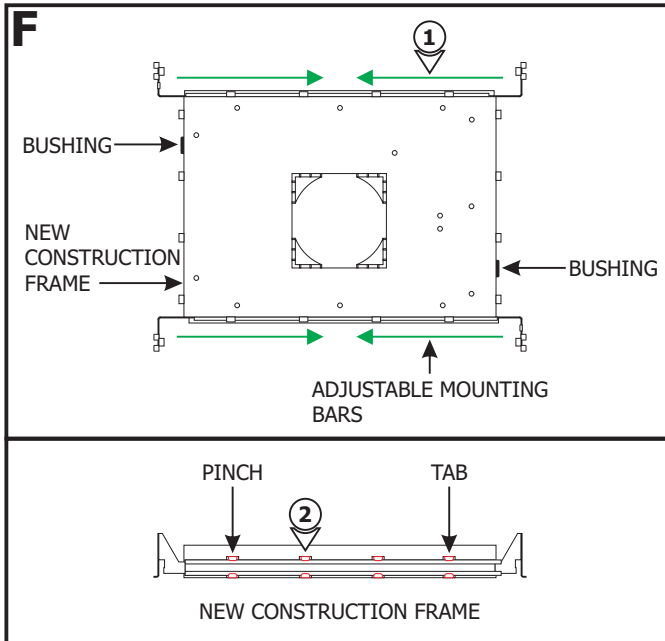

**NOTE:** Do not install insulation within 76mm (3in) of any part of the luminaire.

**NOTE:** Omit this section if using New Construction Housing Insulation Contact. Refer to Section Four.

**1:** Slide the adjustable mounting bars through the tabs on the sides of the frame. Ensure the mounting bars do not block the bushings.

**2:** Pinch the tabs to lock in place.

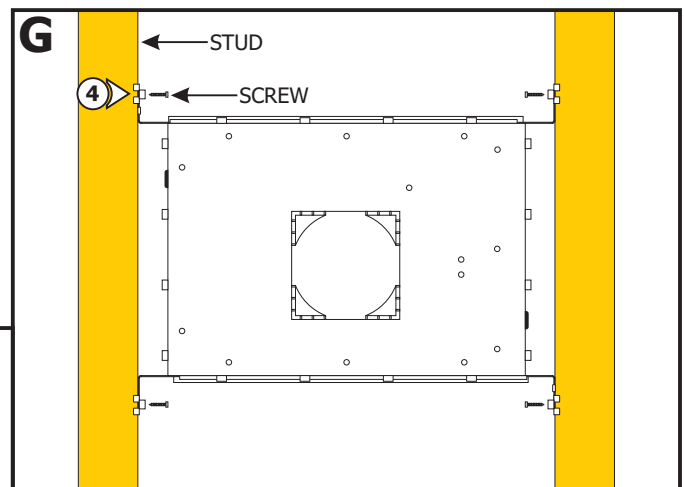

**3:** Select the location between the two studs for the frame to be mounted.

**4:** Place the adjustable mounting bar tabs between the studs. Secure the adjustable bars to the studs with the #8 screws.

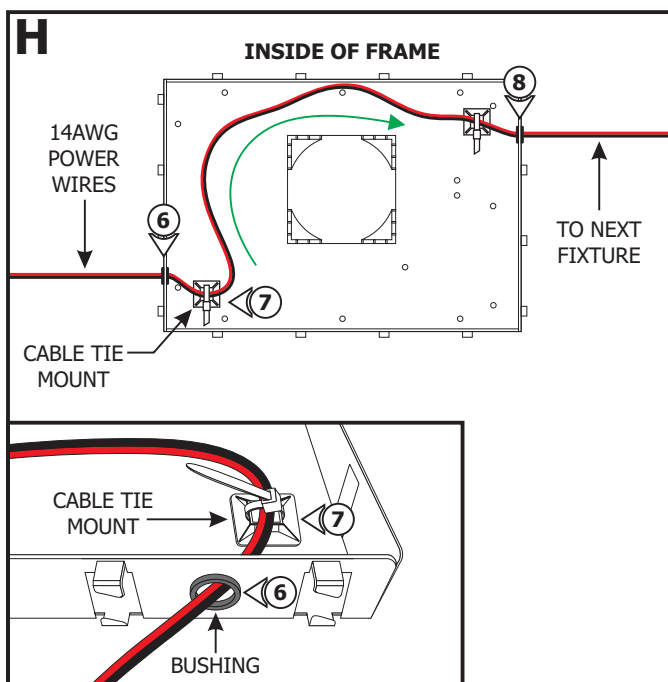

**5:** Run the 14AWG red and black wires coming from the remote power supply to the frame.

**6:** Feed the 14AWG red and black wires through the bushing.

**7:** Use the cable tie mount to secure the 14AWG red and black wires.

**8:** Loop the wires around inside of the frame and through the other cable tie mount and bushing. Ensure to leave enough wires inside to pull the wires out for wire connections in later steps.

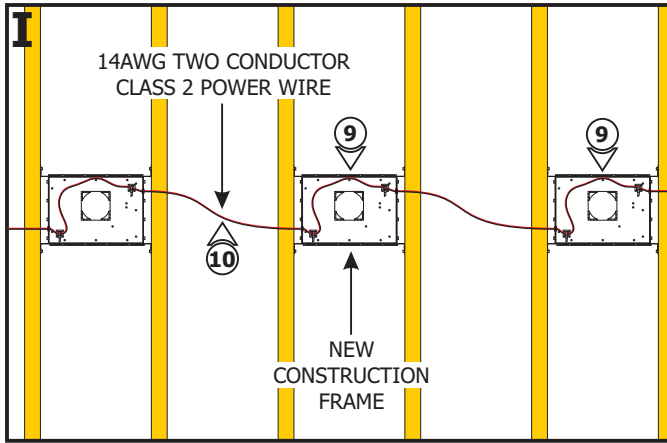

**9:** Repeat steps 1 through 8 to install additional New Construction Frames for multiple fixtures.

**10:** Run the 14AWG red and black wires to each New Construction Frame, leaving enough wires inside each frame for wire connections.

**NOTE:** Ensure not to cut the wires.

**11: Round:** Use a Ø3" hole saw to cut out the drywall section where the frame opening is located.

**12: Square:** Use a fixed jab saw to cut out a 3x3" square on the drywall where the frame opening is located.

**13:** Install the drywall.

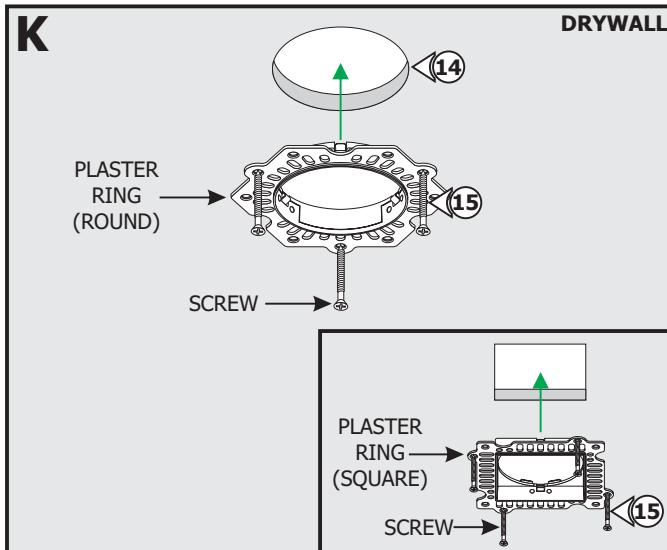
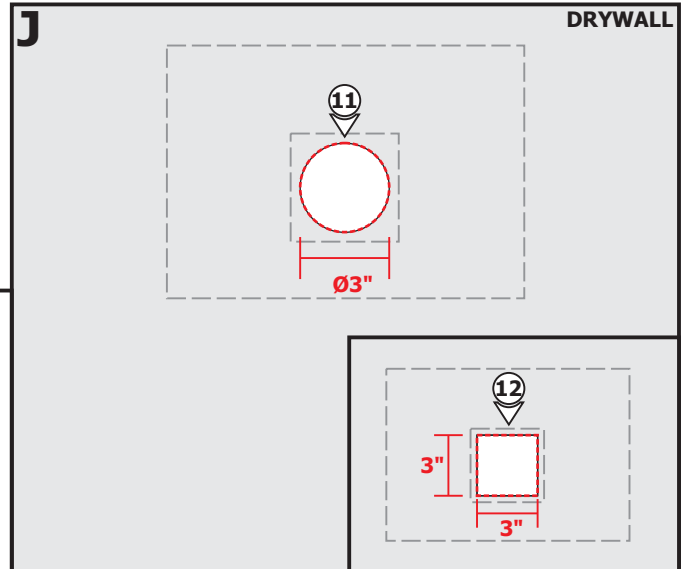

**14:** Insert the plaster ring into the drywall cutout.

**15:** Secure the plaster ring to the drywall using screws.

**16:** Plaster, sand, and paint the surface.

**17:** Continue to Section Five to complete installation.

**NOTE:** For areas with lots of vibration, it is suggested to use Durabond to avoid cracking of plaster.

**NOTE:** Do Not use premixed joint compound "Soft Mud." No use compuesto para juntas premezclado "Soft Mud."

**NOTE:** Recommended plaster method: 1st Coat - Durabond 45 with 8" Blade, 2nd Coat - Easy Sand 45 with 10" Blade, 3rd Coat - skim coat with 12" Blade

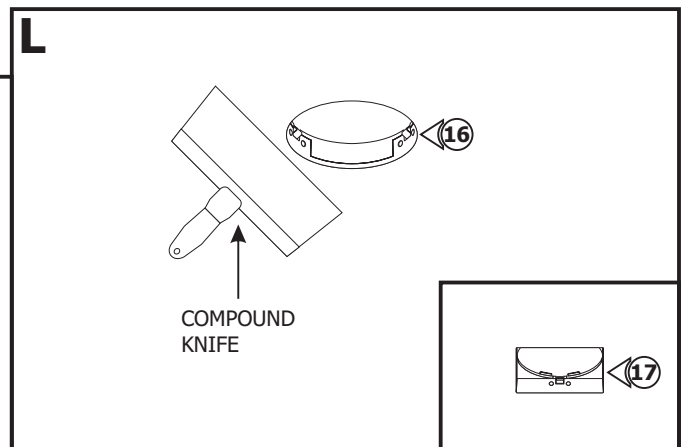

## Section Four: Install the New Construction Housing Insulation Contact

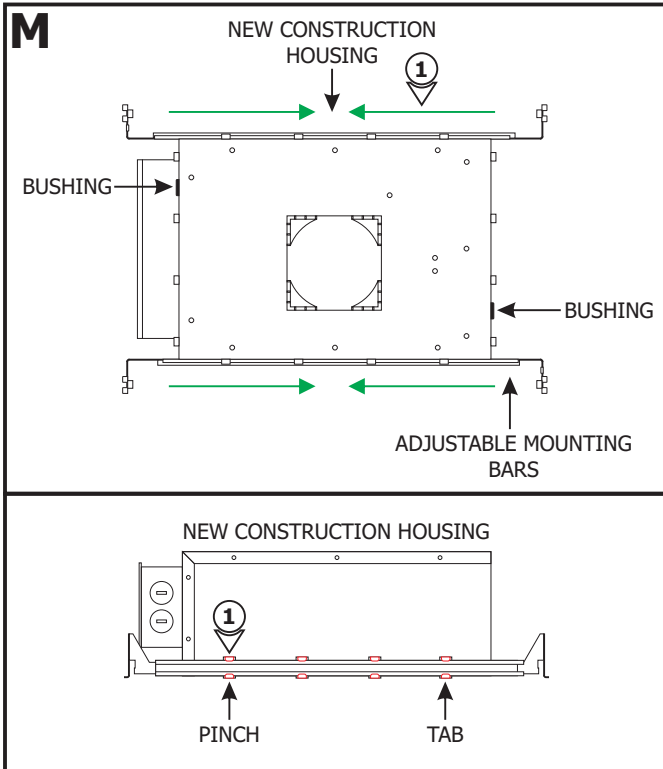

**1:** Slide the adjustable mounting bars through the tabs on the sides of the housing. Ensure the mounting bars do not block the bushings.

**2:** Pinch the tabs to lock in place.

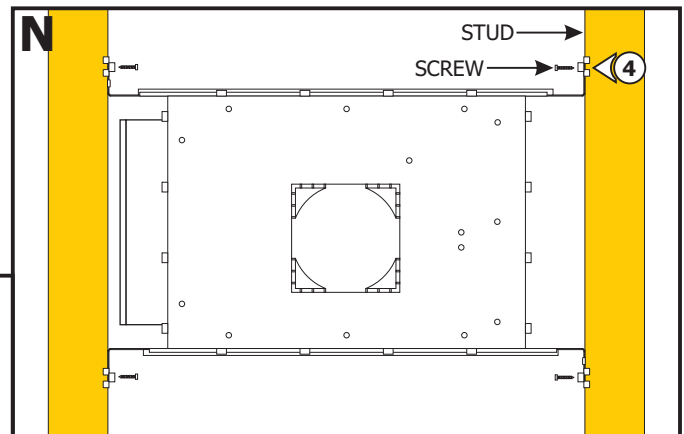

**3:** Select the location between the two studs for the housing to be mounted.

**4:** Place the adjustable mounting bar tabs between the studs. Secure the adjustable bars to the studs with the #8 screws.

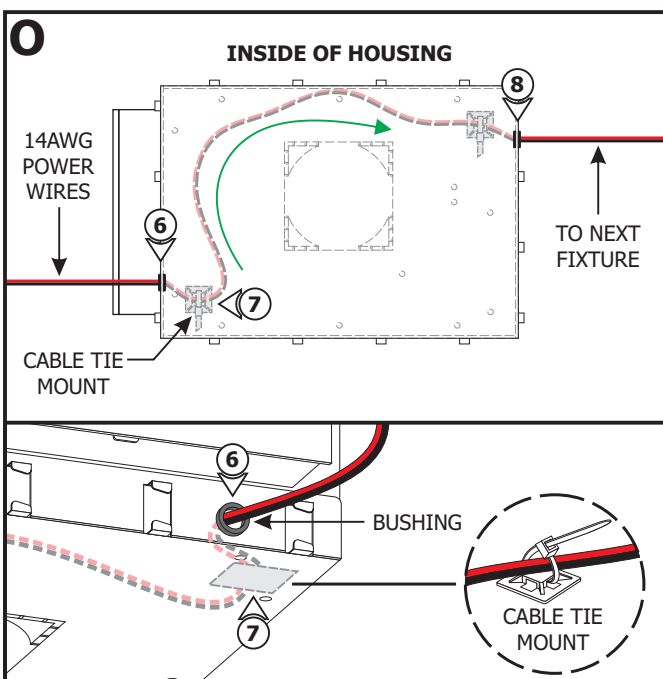

**5:** Run the 14AWG red and black wires coming from the remote power supply to the housing.

**6:** Feed the 14AWG red and black wires through the bushing.

**7:** Use the cable tie mount to secure the 14AWG red and black wires.

**8:** Loop the wires around inside of the housing and through the other cable tie mount and bushing. Ensure to leave enough wires inside to pull the wires out for wire connections in later steps.

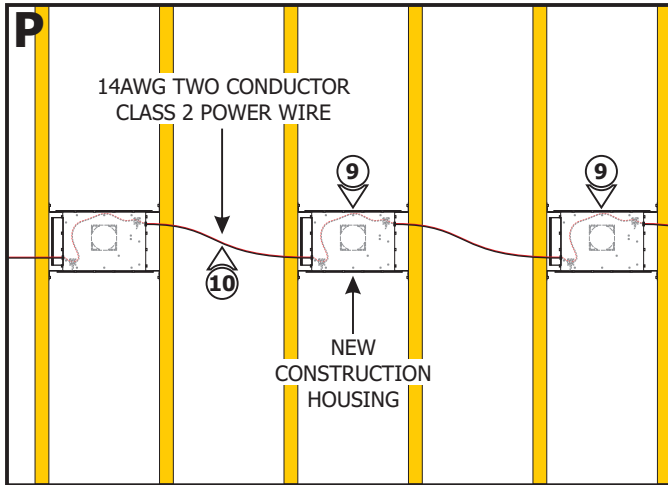

**9:** Repeat steps 1 through 8 to install additional New Construction Housings for multiple fixtures.

**10:** Run the 14AWG red and black wires through each New Construction Housing, leaving enough wires inside each housing for wire connections.

**NOTE:** Ensure not to cut the wires.

**11: Round:** Use a  $\varnothing 3"$  hole saw to cut out the drywall section where the housing opening is located.

**12: Square:** Use a fixed jab saw to cut out a 3x3" square on the drywall where the housing opening is located.

**13:** Install the drywall.

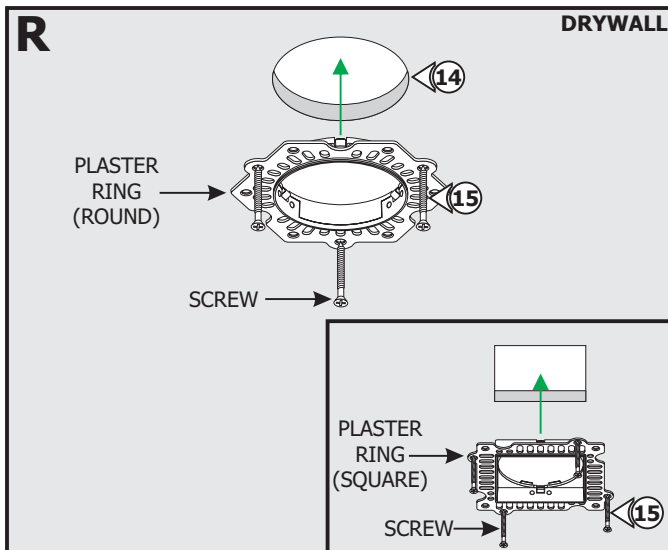
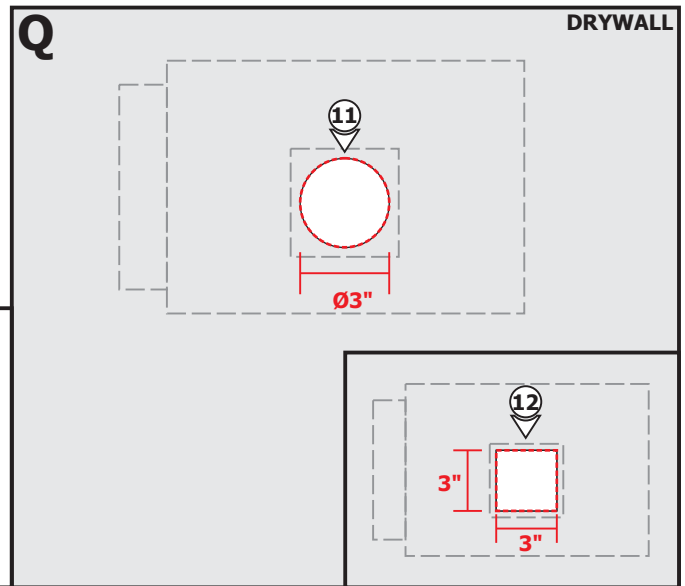

**14:** Insert the plaster ring into the drywall cutout.

**15:** Secure the plaster ring to the drywall using screws.

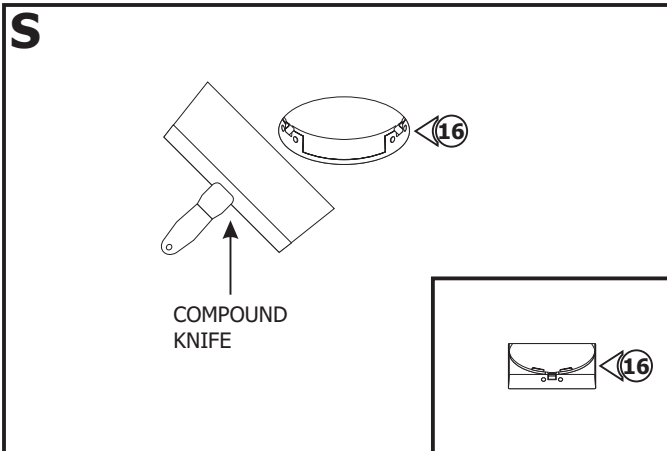

**16:** Plaster, sand, and paint the surface.

**NOTE:** For areas with lots of vibration, it is suggested to use Durabond to avoid cracking of plaster.

**NOTE:** Do Not use premixed joint compound "Soft Mud."  
No use compuesto para juntas premezclado "Soft Mud."

**NOTE:** Recommended plaster method: 1st Coat - Durabond 45 with 8" Blade, 2nd Coat - Easy Sand 45 with 10" Blade, 3rd Coat - skim coat with 12" Blade

## Section Five: Install the WiZ Smart Driver Quick Connector

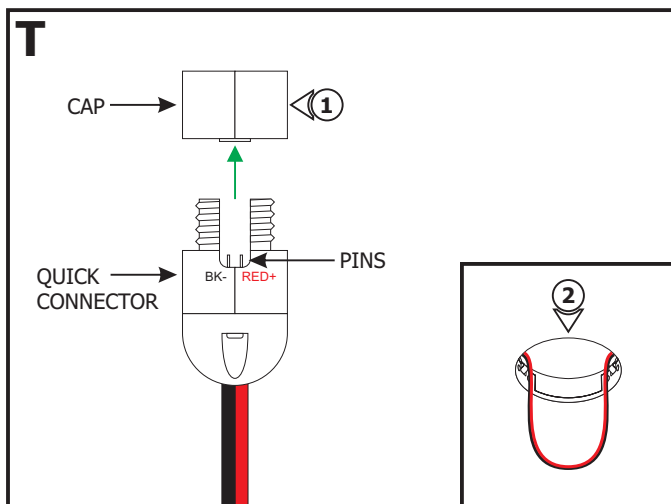

**1:** Unscrew the cap and remove from the Quick Connector.

**2:** Pull the 14AWG black and red wires out of the opening.

**NOTE:** Use only a 14AWG Black and Red zipped wire with the Quick Connector.

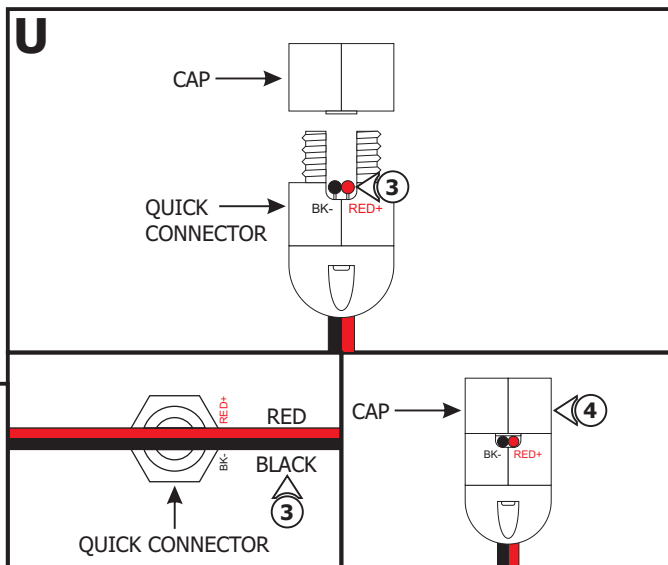
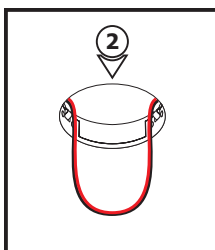

**3:** Align the 14AWG red and black wires with the RED+ and BK- markings on the Quick Connector respectively.

**4:** Insert the 14AWG red and black wires through the Quick Connector and set into place over the pins. Replace and tighten the cap.

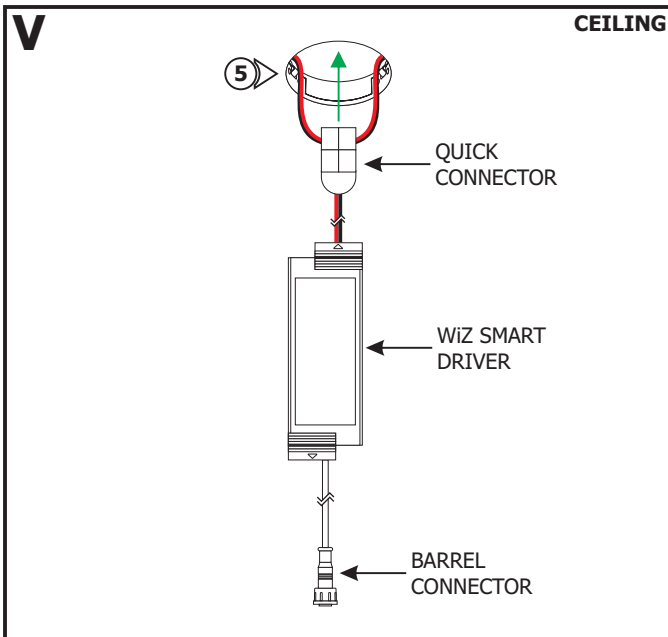

**5:** Place the Quick Connector and WiZ Smart Driver inside the frame or housing.

**6:** Repeat for additional fixtures.

## Section Six: Install the Luca Downlight

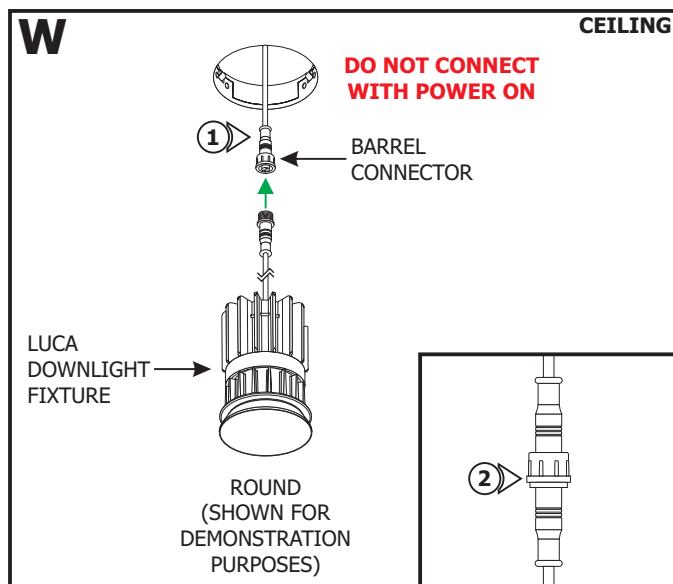

**NOTE:** Blinking light of this thermally protected luminaire may indicate overheating.

**WARNING:** Ensure that power is turned OFF before connecting the fixture to the WiZ Smart Driver. DO NOT CONNECT WITH POWER ON.

**1:** Align and push the barrel connector of the Luca Downlight into the barrel connector of the WiZ Smart Driver.

**2:** Twist the connector nut to lock in place.

**3:** Place the barrel connectors inside the opening.

**4:** For the Adjustable and Wall Wash Downlights, ensure the downlights are in the desired position before placing them inside the opening. The Adjustable Downlight tilts up to 30 degrees.

**5:** Push the Luca Downlight inside the opening until it locks into place.

**6:** To remove the fixture, use fingers to carefully pull the fixture out of the opening. Push the fixture back inside until it snaps in place.

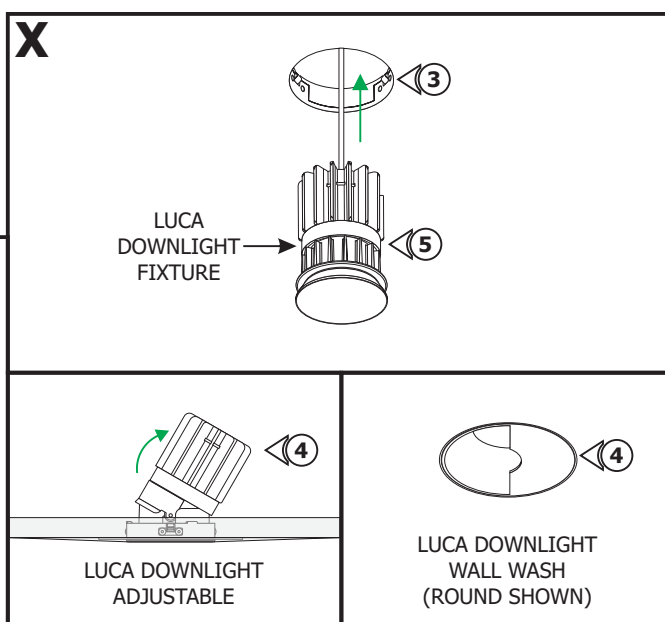



## Section Seven: Pure Smart Room Controller and WiZ Connected App

Y



PURE SMART  
ROOM CONTROLLER  
CWW-TW-SCENE-WH

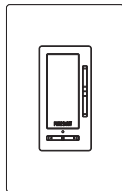

PURE SMART  
REMOTE ROOM CONTROLLER  
CWR-TW-SCENE-WH

**NOTE:** Download the "WiZ Connected" app from either Google Play or the Apple App Store.



**1:** Refer to the instructions provided with the optional controller and the WiZ App for complete set up.

## General Wiring Diagram

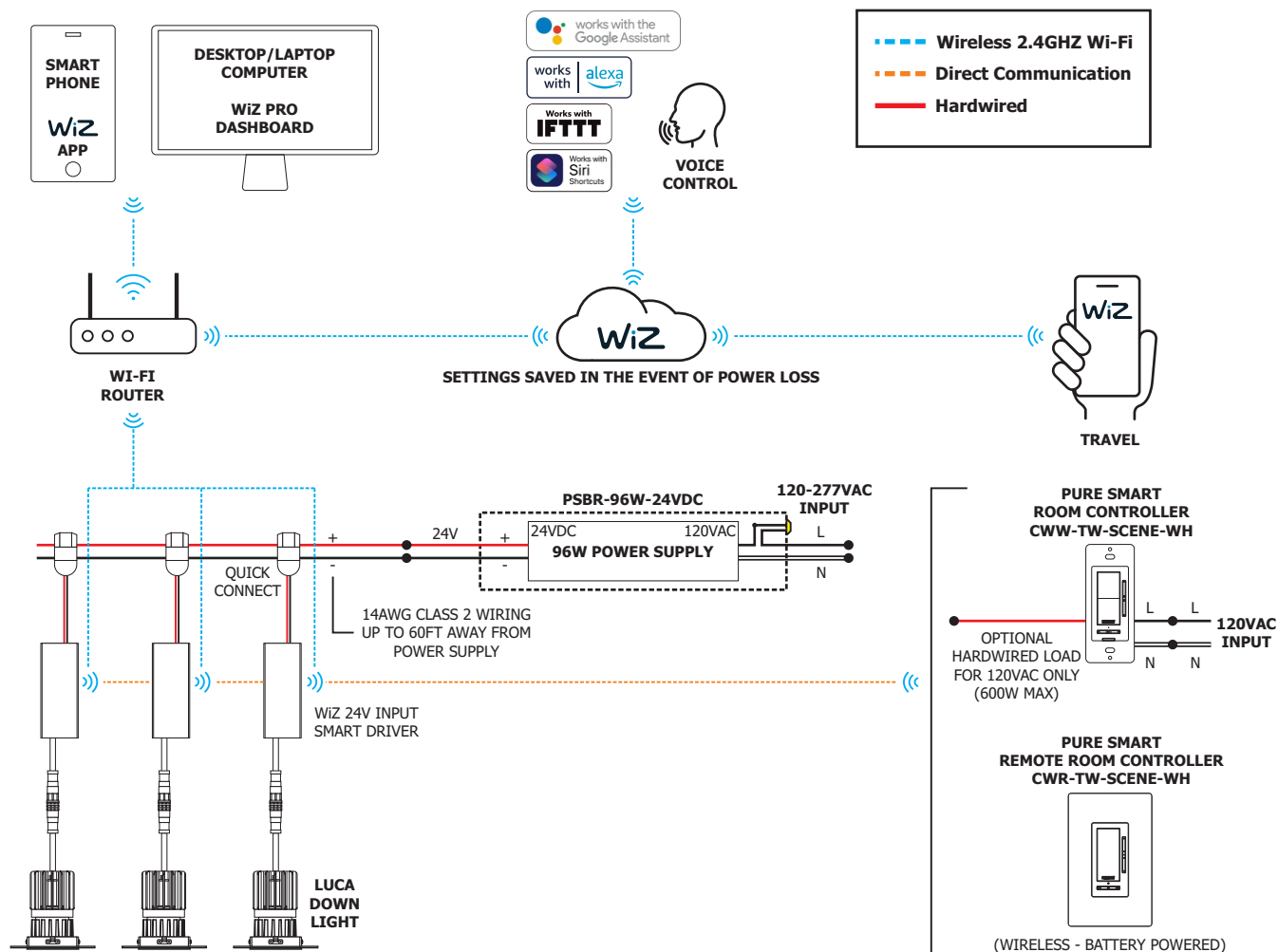

<https://faq.wizconnected.com/hc/en/7-wiz-v2/faq/527-adding-wiz-lights-in-your-home/>



**1. Download the Free App**  
Search "WiZ Connected" in the App Store.



**2. Install a Pure Smart™ Downlight**  
Install the Pure Smart™ Downlight.



**3. Pair the Downlight with App**  
Follow the pairing directions in the app to complete the setup.



**4. Enjoy the Possibilities**  
Endless color combinations with Red, Green, Blue, and Tunable White are now ready for all moods and occasions.

If you have any questions, please contact WiZ Support at  
Toll Free Number: **1-800-223-9477 - WiZ Pro [B2B]: Press 2 and then press 2 (Pro Installer support only)**  
Web: <https://faq.wizconnected.com/hc/en/7-wiz-v2/>