



1718 W. Fullerton Chicago, IL 60614  
 Ph: 773.770.1195 • Fax: 773.935.5613  
 www.PureEdgeLighting.com • info@PureEdgeLighting.com  
 © 2016 PureEdge Lighting. All Rights Reserved.

## Installation Instructions for **Lazer Line Up + Down with 2" Round Canopy**

LZUD-\_\_\_

### IMPORTANT INFORMATION

- This instruction shows a typical installation.
- This product is ETL listed.
- It is recommended more than one person assist in this installation.
- This product must be installed by a qualified electrician and in accordance with local electrical codes.

**SAVE THESE INSTRUCTIONS!**

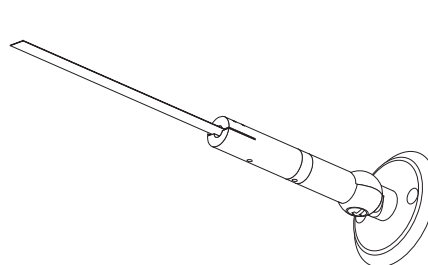

### Section One: Install the Power Feed Turnbuckle

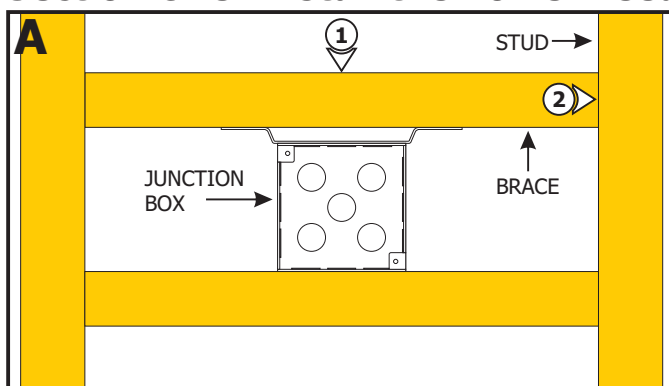

**NOTE:** Ensure the junction box is mounted to a solid structure such as brick, cement, or wood studs.

- 1:** Cut a 16" long 2x4 brace and secure the junction box to the brace (scabs) with screws. If necessary, place a second brace under the junction box for more stability.
- 2:** Locate and secure the brace (scabs) between the studs where the turnbuckles will be mounted.

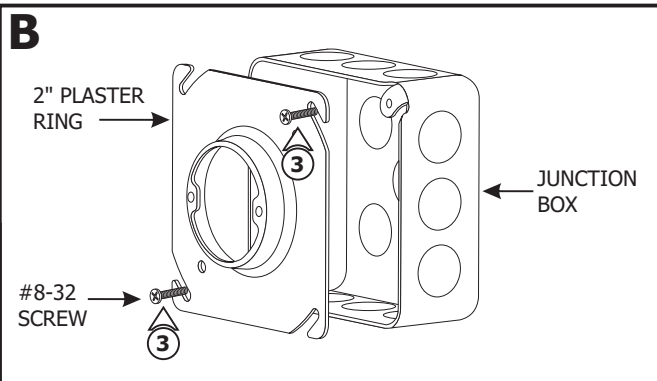

**NOTE:** To replace the existing plaster ring, some modification of drywall around the junction box is necessary.

- 3:** Install 2" plaster ring to junction box and secure with two provided #8-32 screws. Install drywall and finish.

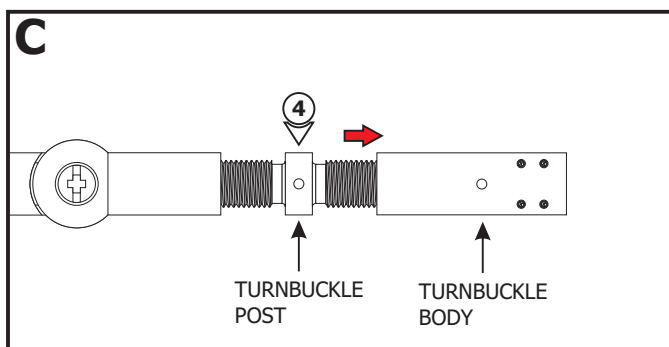

- 4:** Unscrew the turnbuckle body and post to its full extension for maximum adjustments and to feed the power connectors through easily.

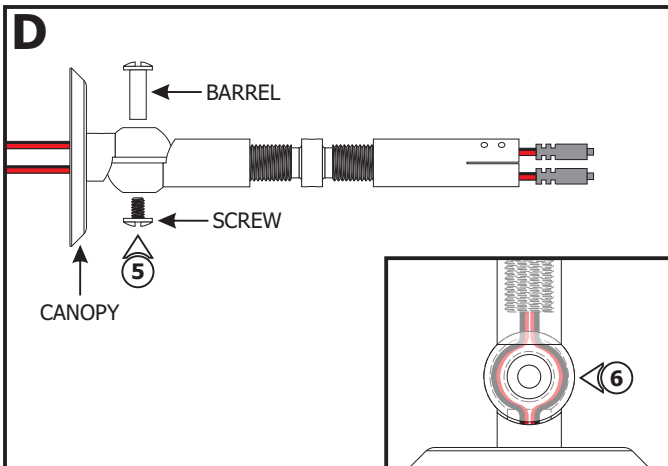

**5:** Remove the screw and barrel to separate the swivel pieces.

**6:** Feed the power connector through the opening of the power feed turnbuckle and loop the wires around the swivel through the canopy.

**7:** For **RGBTW** power connectors, split the cable in half and overlap the wires to fit around the swivel and through the canopy.

**8:** Replace the barrel through the swivel holes and secure in place by tightening the screw.

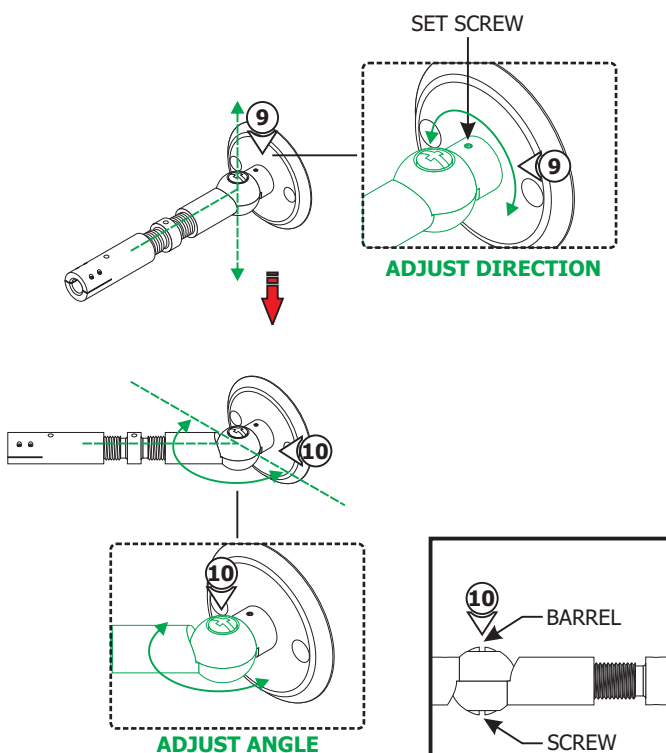
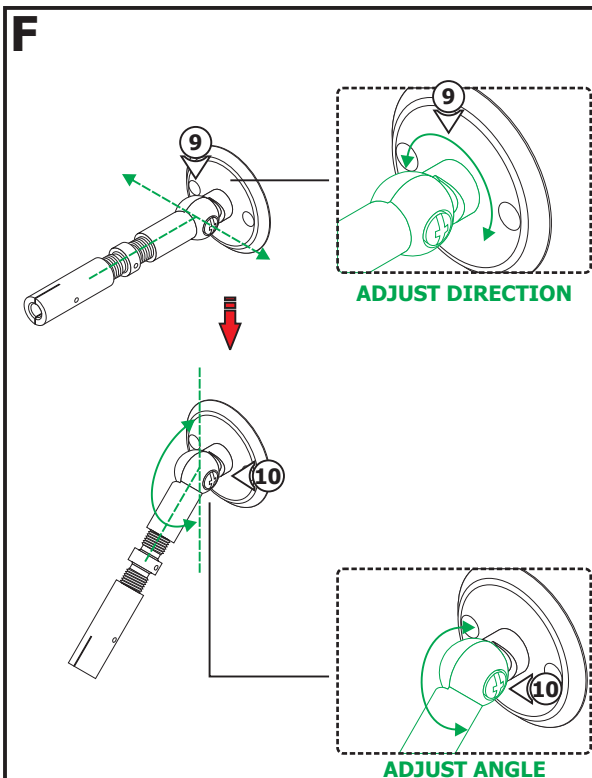
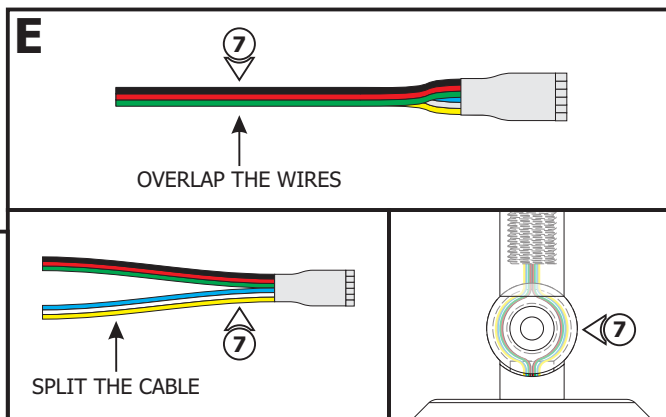

**NOTE:** The turnbuckle rotates around the canopy to adjust the direction and swivels at the base to adjust the angle of the Lazer Line.

**9:** To adjust the direction, loosen (**Do Not Remove**) the set screw on the turnbuckle and slightly rotate the turnbuckle around the canopy. Tighten the set screw using an Allen wrench.

**10:** To adjust the angle, slightly loosen (**Do Not Remove**) the screw on the swivel connector from the barrel, adjust it to the desired angle and tighten the screw.

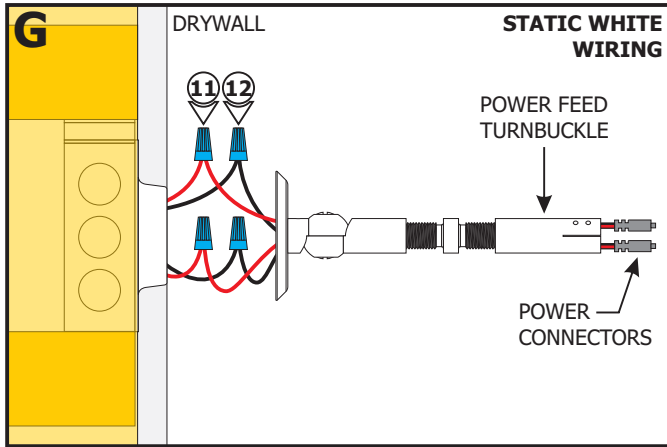

**NOTE:** The low voltage wires should be present in the electrical box. Refer to the instructions provided with the power supply to install the low voltage wires before proceeding with the steps below.

**Static White and Monochromatic Color Strip:**

**11:** Connect the red power connector wire to the +24VDC power supply wire using a wire nut.

**12:** Connect the black power connector wire to the -24VDC power supply wire using a wire nut.

**NOTE:** Refer to the instructions and wiring diagrams provided with the power supplies and controls for RGB, RGB+W, Tunable White, and RGBTW and run the proper size wires to the fixture.

**RGB and RGB+W Strip:**

**13:** Connect the "+" black power connector wire to the LED Output "+" decoder terminal.

**14:** Connect the red power connector wire to the LED Output "1/R-" decoder terminal.

**15:** Connect the green power connector wire to the LED Output "2/G-" decoder terminal.

**16:** Connect the blue power connector wire to the LED Output "3/B-" decoder terminal.

**17: RGB+W:** Connect the white power connector wire to the LED Output "4/W-" decoder terminal.

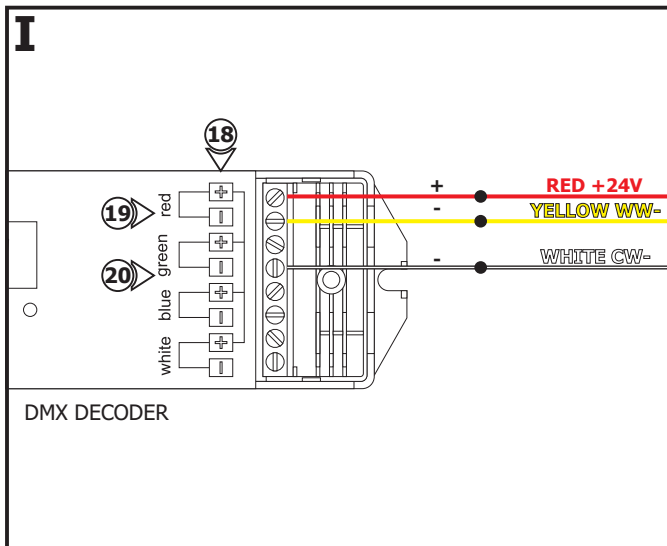
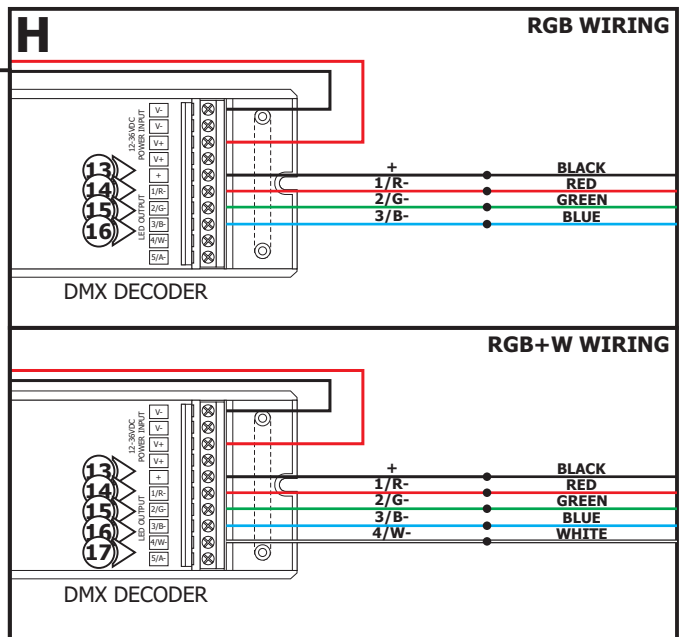

**Tunable White Strip with DMX Control:**

**18:** Connect the red +24V power connector wire to the red "+" DMX terminal.

**19:** Connect the yellow WW- power connector wire to the red "-" DMX terminal.

**20:** Connect the white CW- power connector wire to the green "-" DMX terminal.

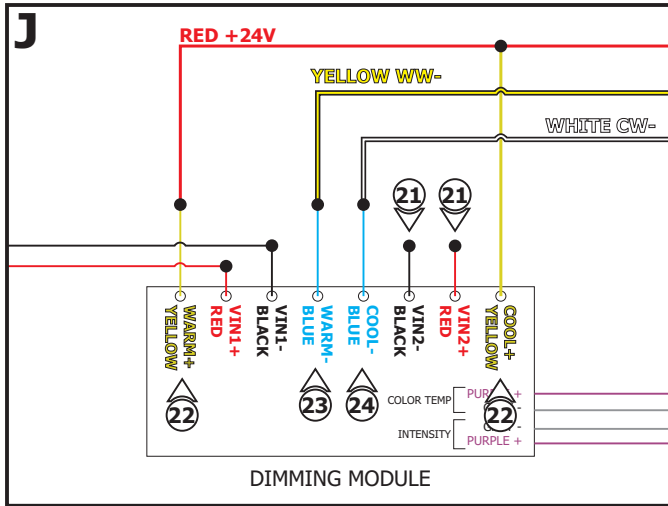

#### Tunable White Strip with Two Channel Controls:

- 21:** The Vin2+ Red and Vin2- Black wires are not used in this procedure. Cap the Vin2+ Red and Vin2- Black wires using wire nuts.
- 22:** Connect the red +24V power connector wire to the Warm+ Yellow and Cool+ Yellow dimming module wires.
- 23:** Connect the yellow WW- power connector wire for -2000K to the Warm- Blue dimming module wire.
- 24:** Connect the white CW- power connector wire to the Cool- Blue dimming module wire.

#### RGBTW with Pure Smart WiZ Pro Power Supply Controls:

- 25:** Connect the black "+" power connector wire to the "Vo+" red wire of the Bridgebox.
- 26:** Connect the red power connector wire to the "R-" black wire of the Bridgebox.
- 27:** Connect the green power connector wire to the "G-" black wire of the Bridgebox.
- 28:** Connect the blue power connector wire to the "B-" black wire of the Bridgebox using a wire nut.
- 29:** Connect the white power connector wire to the "CW-" black wire of the Bridgebox using a wire nut.
- 30:** Connect the yellow power connector wire to the "WW-" black wire of the Bridgebox using a wire nut.

**K**

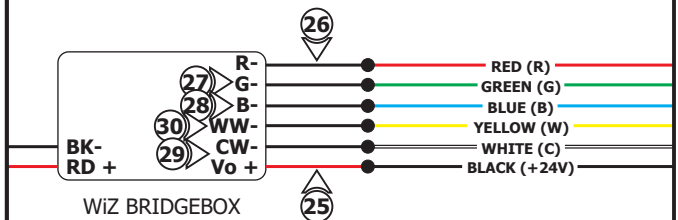

**L**

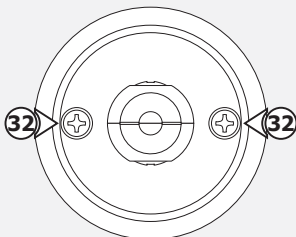

- 31:** Place all wires inside the electrical box.

- 32:** Secure the power feed turnbuckle to the electrical box by tightening the two provided screws.

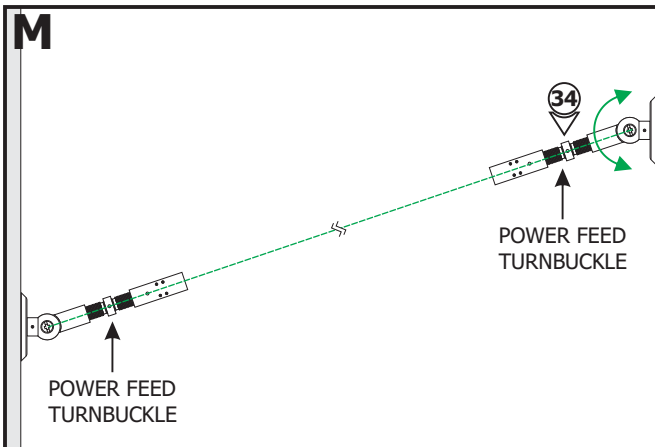

**33:** Determine the location for the other power feed turnbuckle, either face to face with the first turnbuckle (up to 60 feet away) or diagonal from the power feed turnbuckle.

**34:** If necessary, rotate the turnbuckle to be in line with the opposite turnbuckle.

**35:** Repeat steps 1 through 34 for any additional Power Feed Turnbuckles.

**CAUTION:** Carefully unroll the entire LED strip from the reel and use the power connector to power the strip making sure there is no outage before continuing with the installation. Afterwards, carefully roll the LED strip loosely back into the reel.

## Section Two: Install the Non-Power Feed Turnbuckle

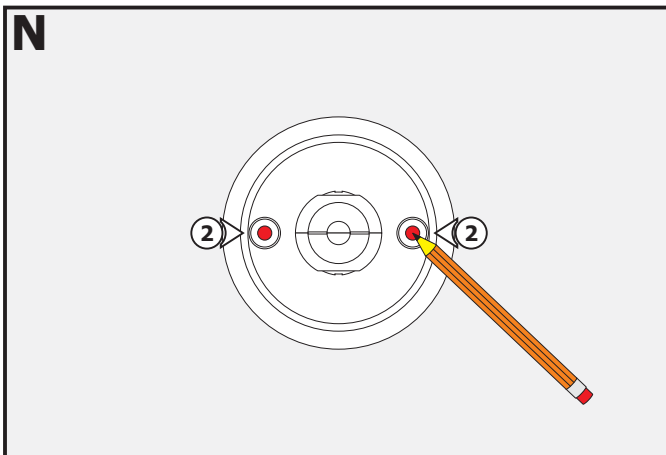

**NOTE:** Omit this section if Non-Power Feed Turnbuckles are not used. Discard the anchors.

**NOTE:** Discard the 2RD plaster ring for non-power feed turnbuckles.

**1:** Determine the location for the non-power feed turnbuckle, either face to face with the power feed turnbuckle (up to 60 feet away) or diagonal from the power feed turnbuckle.

**2:** Place the turnbuckle against the surface and mark the two screw holes.

**NOTE:** For other masonry applications, use the appropriate wall anchors.

**NOTE:** Step 3 is for drywall mounting. Omit this step if mounting directly to a wood surface.

**3:** Using a Phillips screwdriver, press the anchor tip slightly into the drywall. Turn the anchor until flush with the drywall. Do not over tighten.

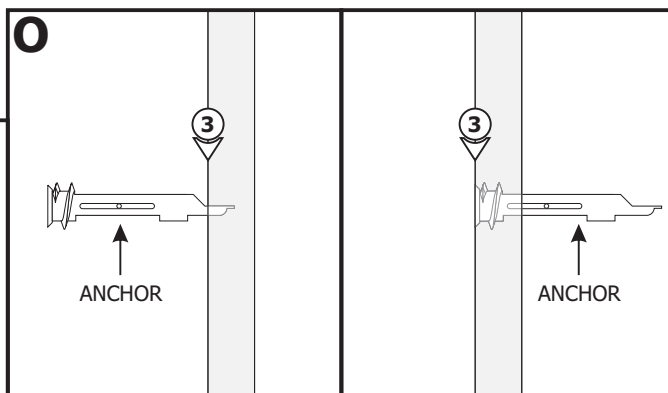

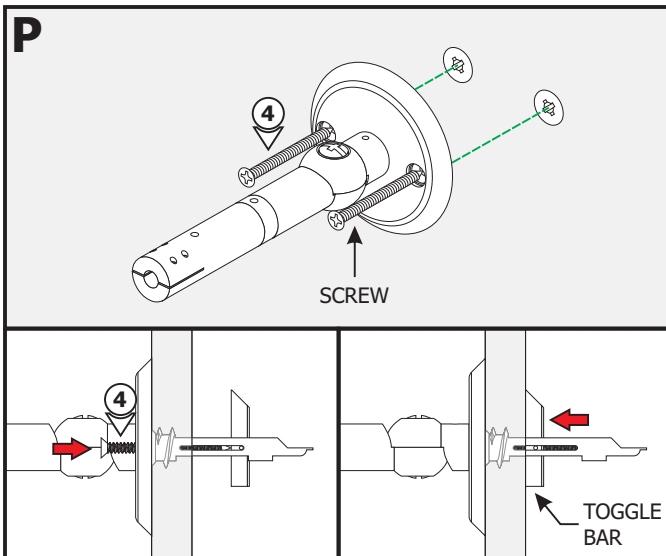

**4:** Align the canopy holes with the turnbuckle and secure in place by tightening the screws. The screw will stop when the toggle bar is tight and secure behind the wall.

**5:** Unscrew the turnbuckle body and post to its full extension for maximum adjustments.

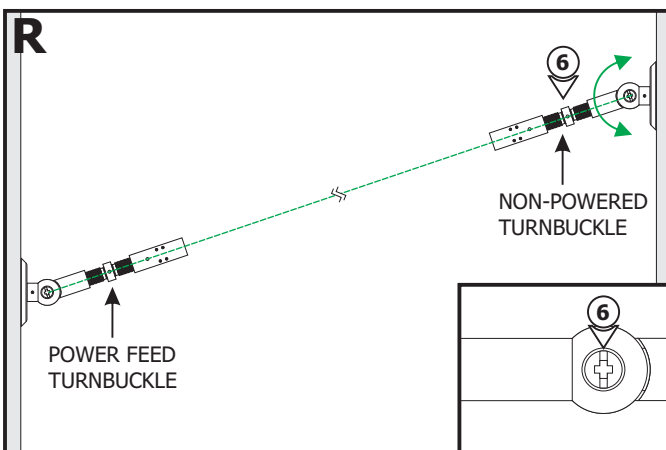
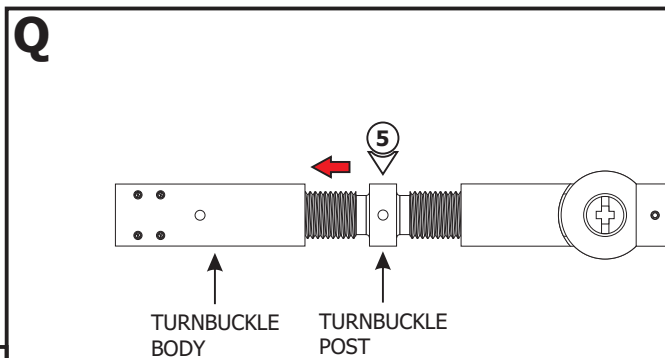

**6:** If necessary, refer to Drawing F and Steps 9 and 10 to properly rotate the turnbuckle. Ensure the turnbuckle is in line with the opposite turnbuckle.

## Section Three: Install the Steel Line Strap

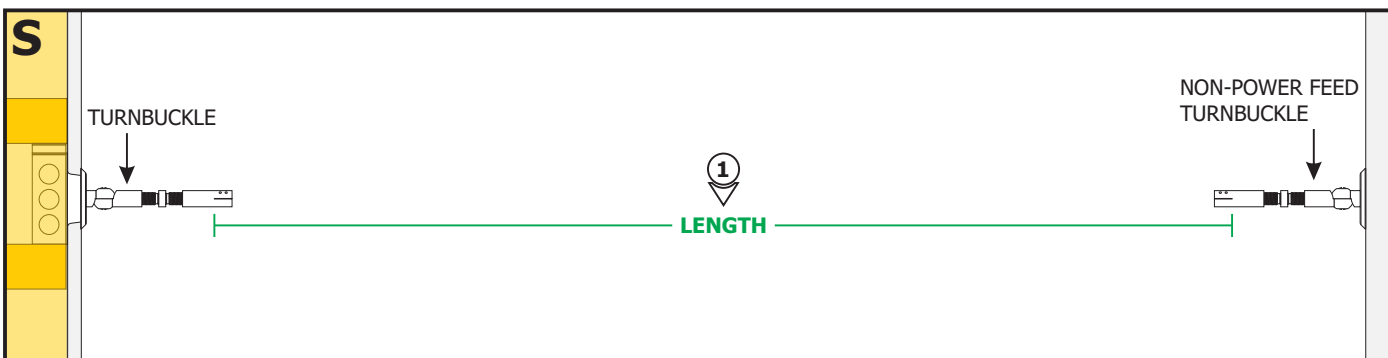

**1:** Measure the distance between the opening slots on the two turnbuckles to determine the Steel Line Strap length.

**2:** Cut the Steel Line Strap to determined length.

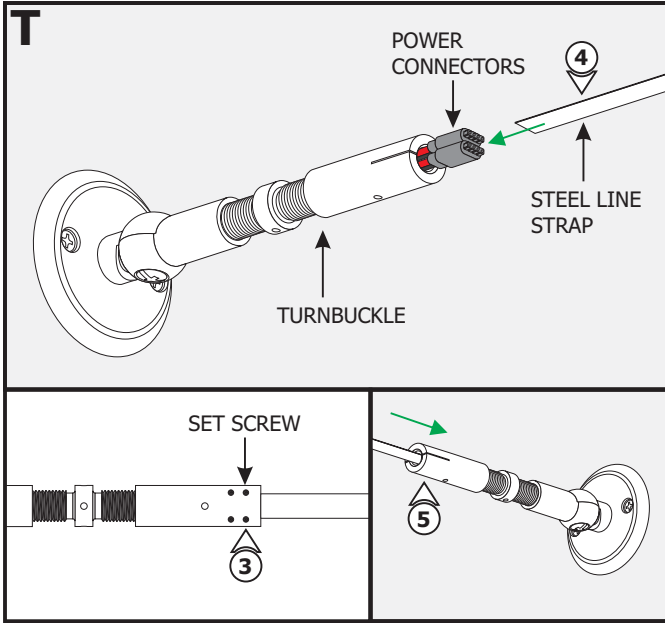

**NOTE:** The Steel Line Strap must be inserted completely in line with turnbuckles to hold the tension.

**3:** Loosen (**Do Not Remove**) the four set screws on the turnbuckle using an Allen wrench.

**4:** Carefully insert the Steel Line Strap between the two power connectors, with the power connectors exposed, into the power feed turnbuckle. Tighten the four set screws very tight using the provided Allen wrench.

**5:** Insert the other end of the Steel Line Strap into the opposite turnbuckle and tighten the set screws.

**NOTE: DO NOT** put any other tool in the turnbuckle holes but the spanners to prevent damage to the cable.

**6:** Place the spanners on the holes on the turnbuckle post and turnbuckle body. Rotate the turnbuckle post clockwise with one hand while holding the turnbuckle body with the other hand. **Do not overtighten.**

**7:** Tighten the post on the other turnbuckle for the Lazer Line to stay taut. **Do not overtighten.**

**NOTE:** Ensure the Steel Line Strap is very taut to avoid sagging.

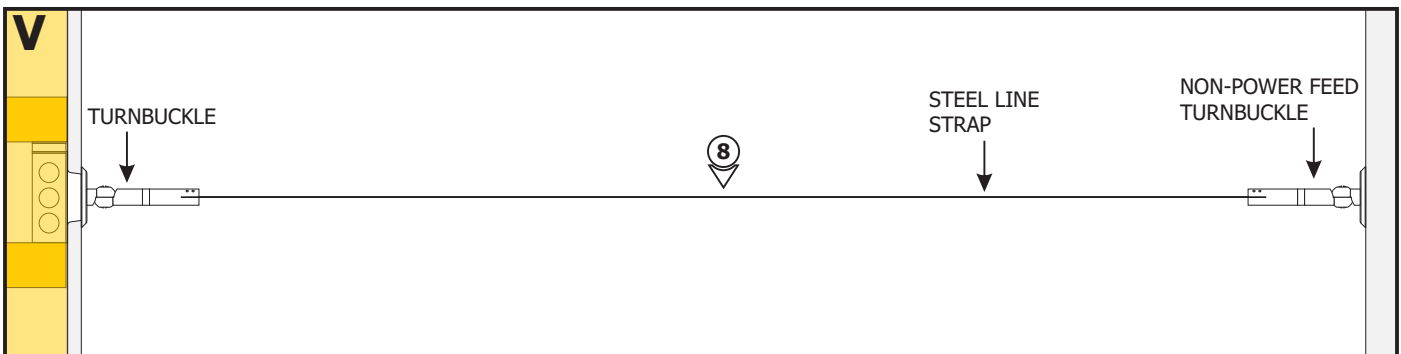
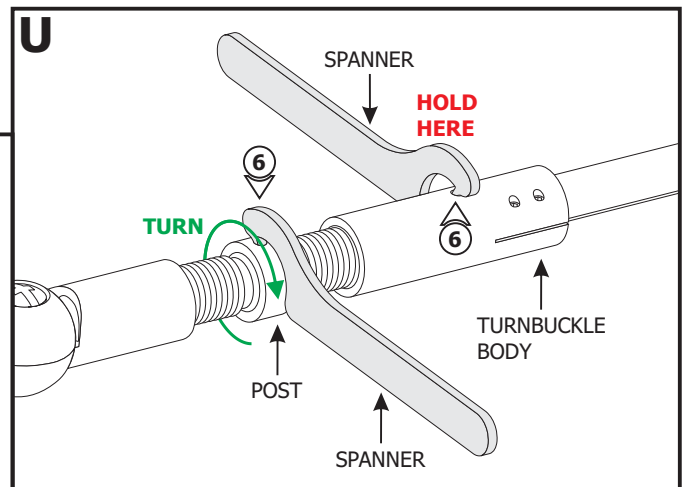

**8:** Ensure the Steel Line Strap is taut/no sag before continuing.

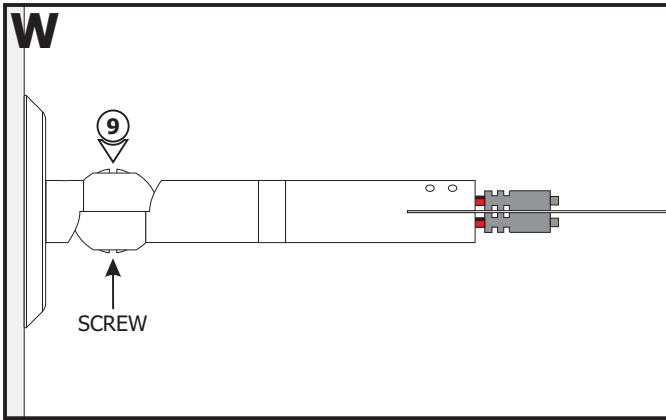

**9:** Tighten the screw on the turnbuckle bushing to secure the position in place.

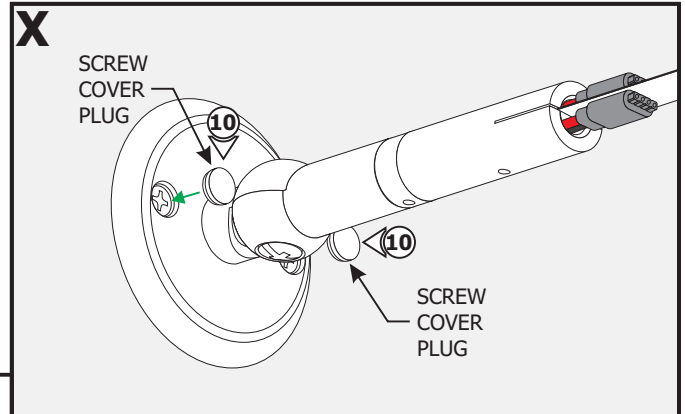

**10:** Insert the cover plugs over the screws on the canopy.

## Section Four: Install the LED Lazer Strip - Power on One End

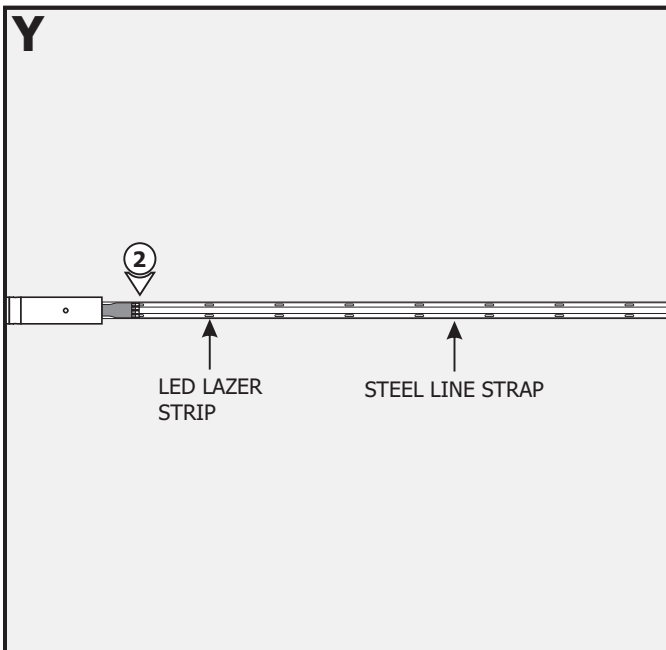

**NOTE:** Omit this section if powering both ends of the Lazer Line. Refer to Section Five.

- 1:** Clean the Steel Line Strap thoroughly with alcohol (pads provided) where the LED Lazer Strip will be installed.
- 2:** Align the +24V marking on the LED Lazer Strip with the (+) wire of the power connector. Push the pins of the LED Lazer Strip into the power connector. Remove the backing from the strip and firmly press down onto the Steel Line Strap.
- 3:** If necessary, trim excess LED Lazer Strip **ONLY** on the cuttable section from the non-powered side.
- 4:** Repeat steps 1 through 3 for the other Lazer Strip, RGB, RGB+W, Tunable White or RGBTW Strip.

**NOTE:** Repeat step 6 in Section Three so that the Steel Line Strap stays taut. After energizing the LEDs, firmly press down onto the Steel Strap removing all air bubbles from the initial heat if any.



## Section Five: Install the LED Lazer Strip - Power on Both Ends

Z

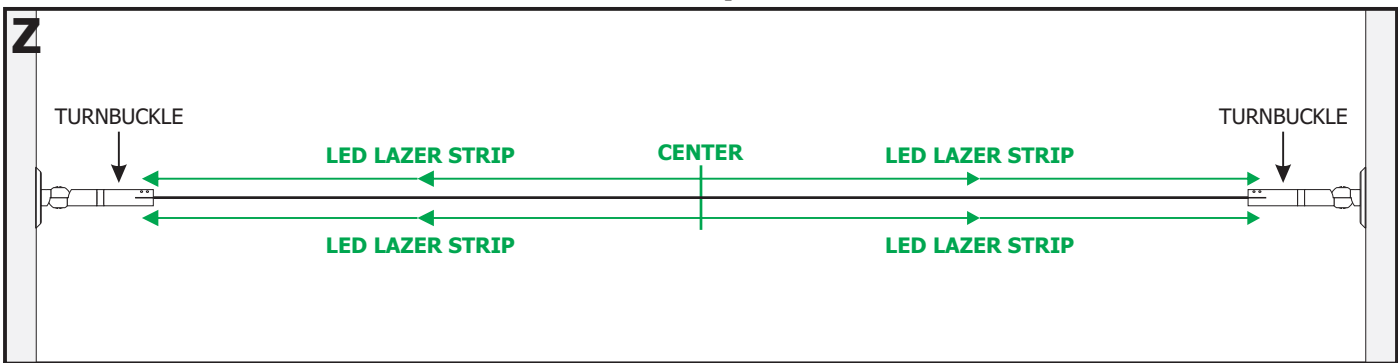

1:

2:

1: Clean the Steel Line Strap thoroughly with alcohol (pads provided) where the LED Lazer Strips will be installed.

2: To avoid gaps, start at the center of the Steel Line Strap. Align and place both LED Lazer Strips on the center of the Steel Line Strap after measuring to ensure any length changes. Cut excess LEDs at cuttable sections on the non-powered sides if necessary.

Z1

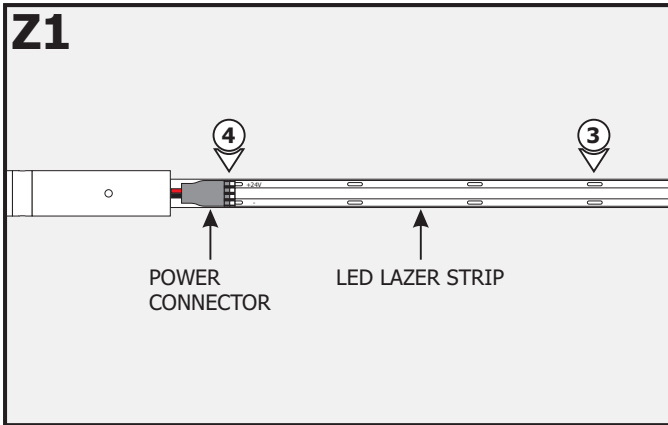

3:

4:

5:

3: Remove the backing from the LED Lazer Strip and firmly press down onto the Steel Line Strap.

4: Align the +24V marking on the LED Lazer Strip with the (+) wire of the power connector. Push the pins of the LED Lazer Strip into the power connector. All light gaps should be at the power connector, not in the middle.

5: Repeat steps 3 and 4 for the remaining LED Lazer Strips.

NOTE:

Repeat step 6 in Section Three so that the Steel Line Strap stays taut. After energizing the LEDs, firmly press down onto the Steel Strap removing all air bubbles from the initial heat if any.

## General Wiring Diagram

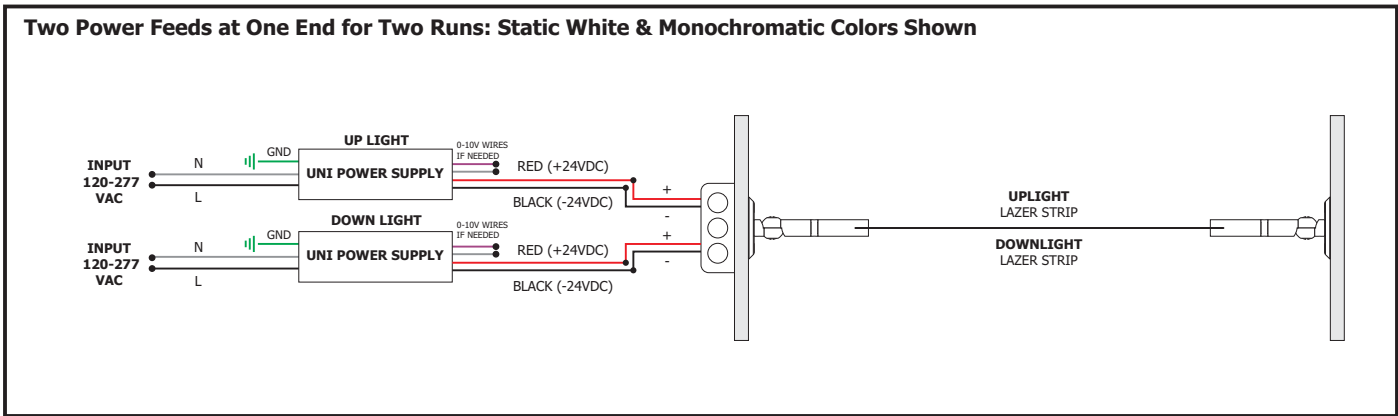

## Two Power Feeds at Both Ends for Four Runs: Static White & Monochromatic Colors Shown

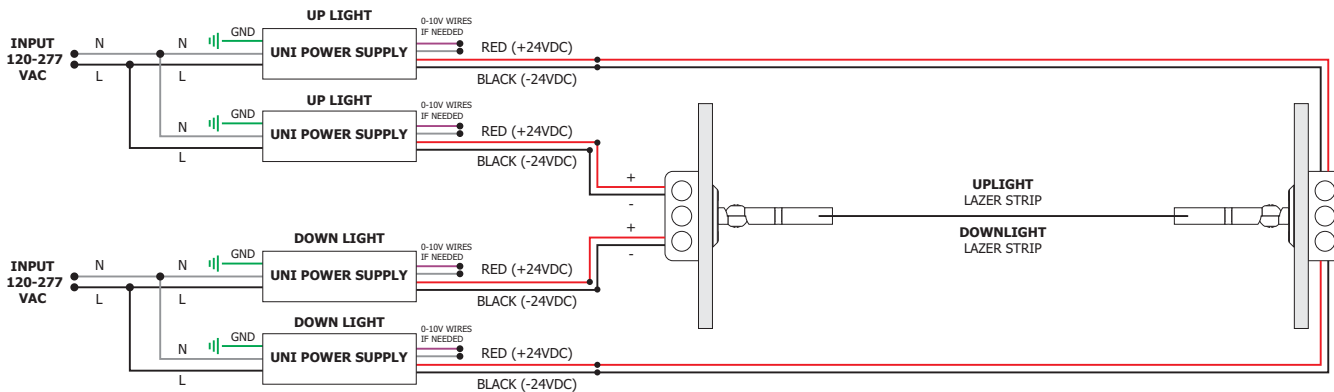

## RGB Wiring

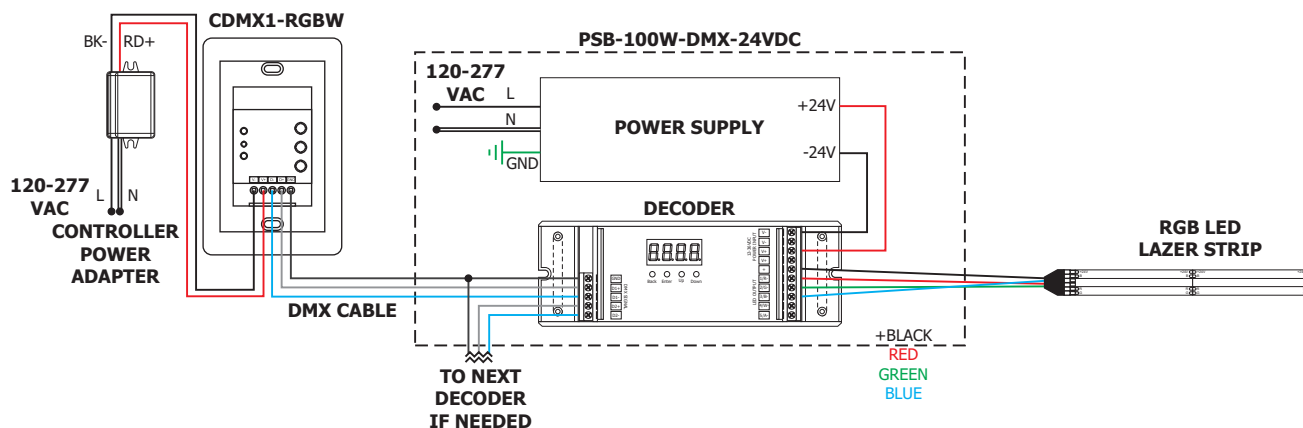

## RGB+W Wiring

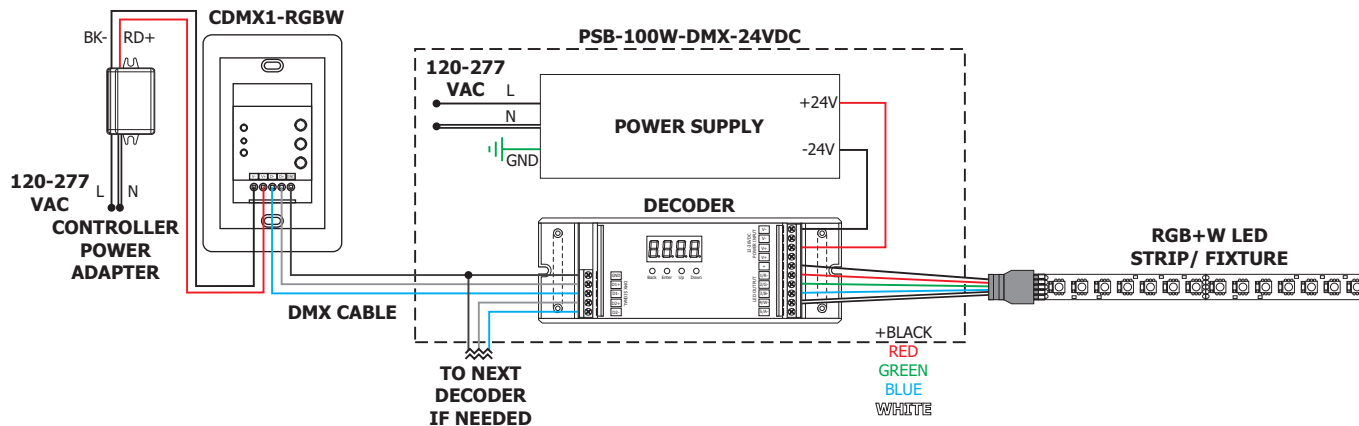

### Tunable White: DMX Controls

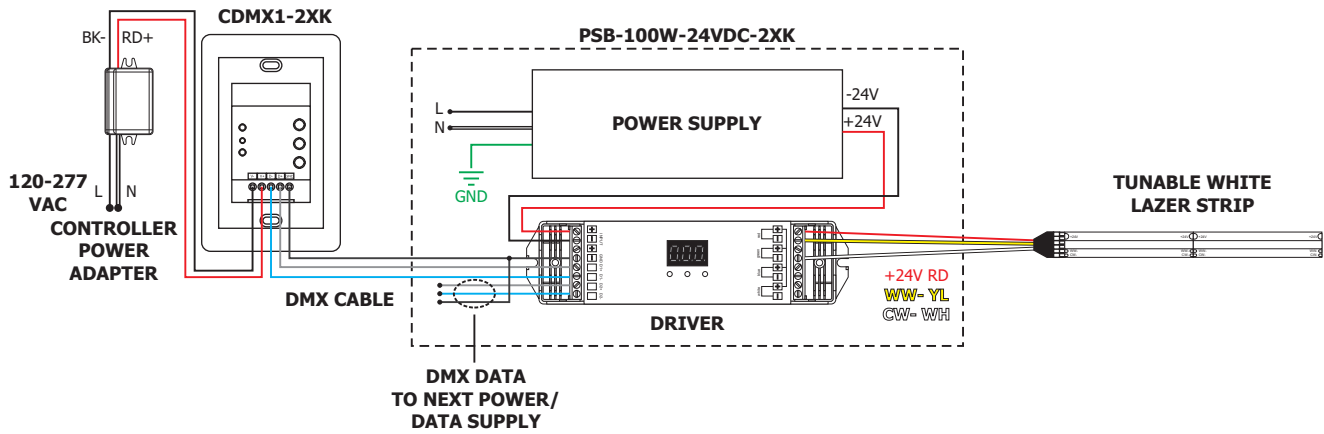

### Tunable White: Two Channel Controls, for Intensity and Color Temperature

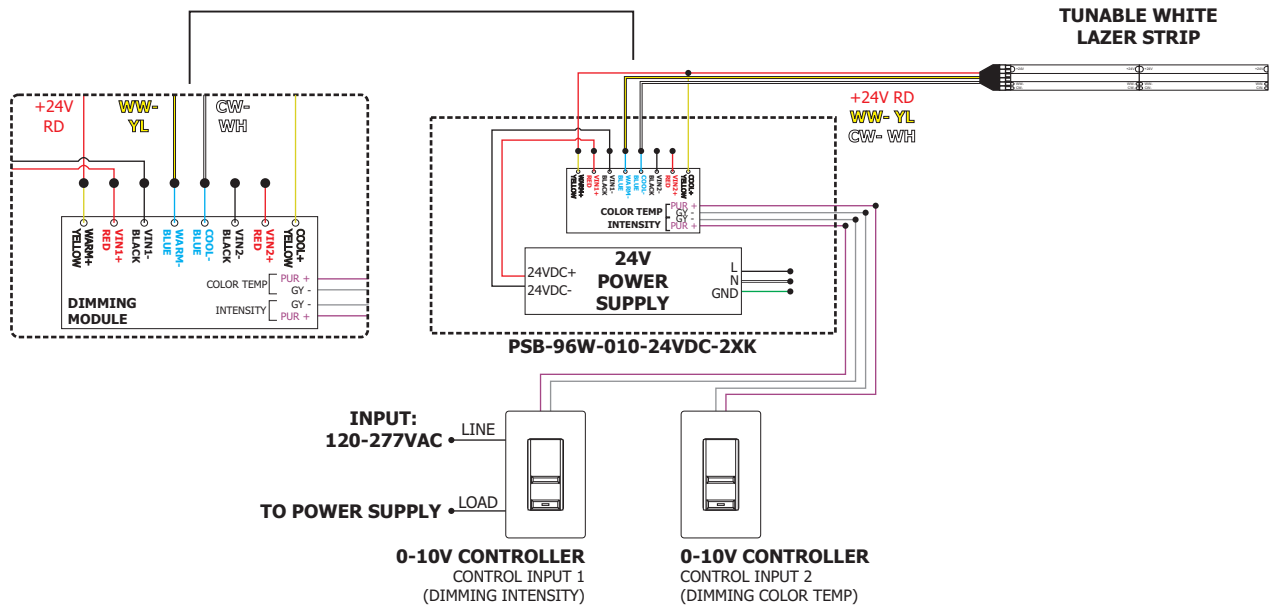

## Section Six: Pure Smart Room Controller and WiZ Connected App

22



PURE SMART  
ROOM CONTROLLER  
CWW-TW-SCENE-WH

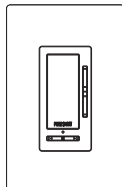

PURE SMART  
REMOTE ROOM CONTROLLER  
CWR-TW-SCENE-WH

**NOTE:** Download the "WiZ Connected" app from either Google Play or the Apple App Store.



1: Refer to the instructions provided with the optional controller and the WiZ App for complete set up.

## RGBTW: Pure Smart WiZ Pro Power Supply Controls

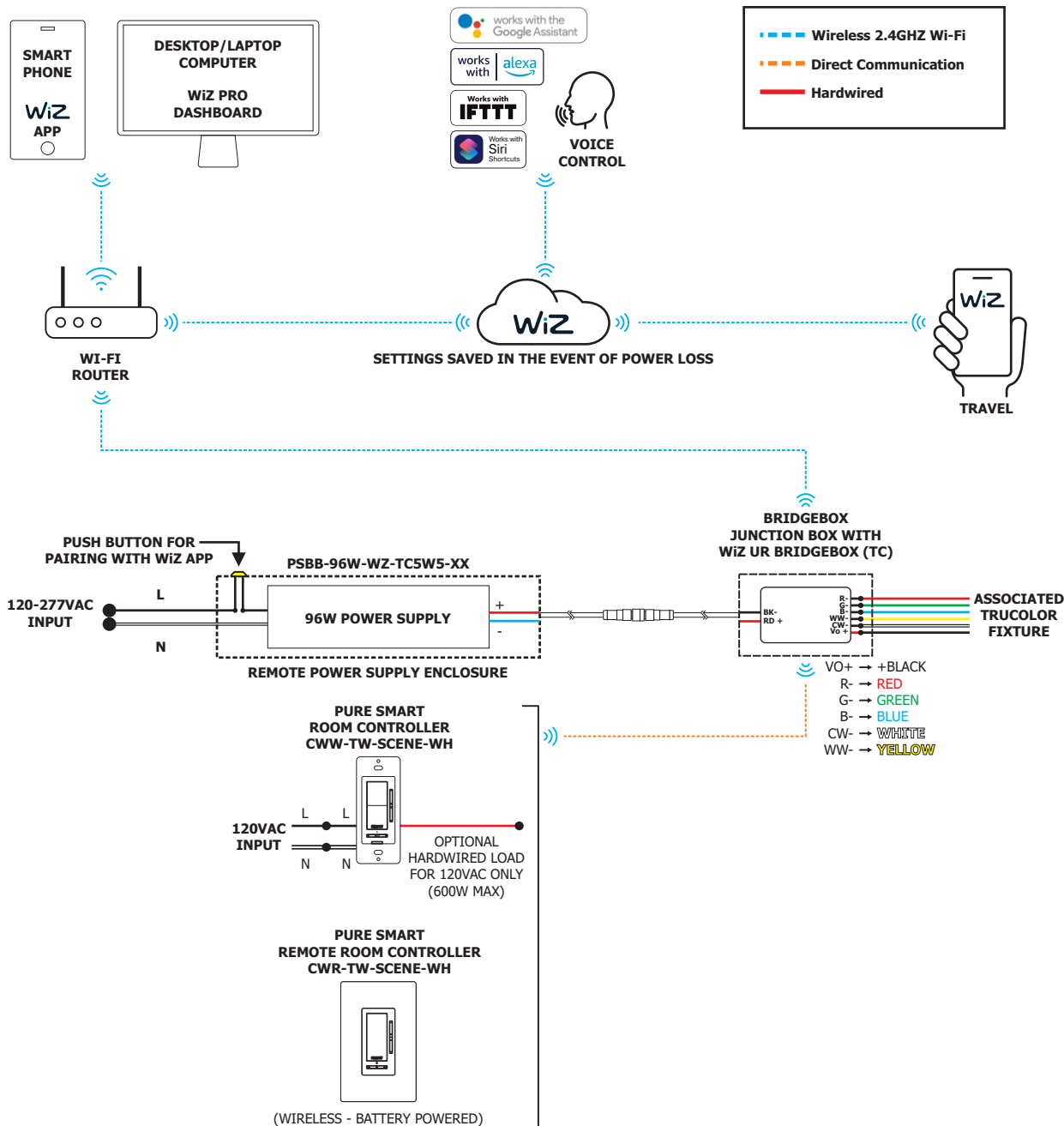

<https://faq.wizconnected.com/hc/en/7-wiz-v2/faq/527-adding-wiz-lights-in-your-home/>



### 1. Download the Free App

Search "WiZ Connected" in the App Store.



### 3. Pair the Lazer Line with App

Follow the pairing directions in the app to complete the setup.



### 2. Install the Lazer Line

Install the Lazer Line Suspended LED Lighting System.



### 4. Enjoy the Possibilities

Endless color combinations with Red, Green, Blue, and Tunable White are now ready for all moods and occasions.

If you have any questions, please contact WiZ Support at

Toll Free Number: **1-800-223-9477 - WiZ Pro [B2B]: Press 2 and then press 2 (Pro Installer support only)**

Web: <https://faq.wizconnected.com/hc/en/7-wiz-v2/>