



1718 W. Fullerton Chicago, IL 60614  
 Ph: 773.770.1195 • Fax: 773.935.5613  
 www.PureEdgeLighting.com • info@PureEdgeLighting.com  
 © 2016 PureEdge Lighting. All Rights Reserved.

## Installation Instructions for **ST2A Stomp Strip 2.5W/FT Tunable White, ST5A Stomp Strip 4.6W/FT Tunable White, ST7A Stomp Strip 7.3W/FT Tunable White, ST10A Stomp Strip 9.6W/FT Tunable with 6FT Soldered Leads**

ST\_A-SE\_--\_--

### IMPORTANT INFORMATION

ETL LISTED

Intertek  
3028534

- Conforms to UL STD 1598 & UL STD 2108 Certified to CAN/CSA STD C22.2 NO 250.0
- Suitable for Under-Cabinet Mount
- Dry Location Only
- Use Only With Class 2 Power Unit
- Peut être fixé Sous Une Armoire
- Pour Emplacements Secs Seulement
- Utiliser Seulement Avec Classe 2 Unité d'alimentation électrique



**SAVE THESE INSTRUCTIONS!**

### Section One: Install the Stomp Strip

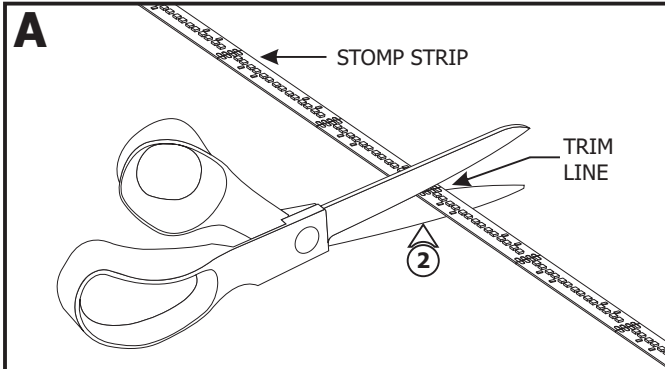

- 1: Determine the amount of LED strip needed.
- 2: If necessary trim the LED strip at the marked line above the contact (every 2.4" apart) with a sharp scissor to fit the design.

**NOTE:** Do not trim the strip at unmarked sections which may cause that section of the strip not to light up.

**NOTE:** It is recommended to use the provided heat sink tape with ST7A and ST10A.

**NOTE:** Use Aluminum Heat Sink Tape to extend potential LED life expectancy.

**NOTE:** The LEDs are rated for 40,000 hours when using the aluminum heat sink tape.

**NOTE:** The adhesive tape of the aluminum heat sink needs to be affixed to smooth, clean surfaces (2" minimum). The tape adhesive does not work well with porous, textured, or unfinished wood surfaces. For these surfaces, soft strip clips are required (sold separately).

3: Clean the surface thoroughly where the LED strip will be installed.

4: Remove the backing from the Aluminum Heat Sink Tape and firmly press down onto the surface where the LED strip will be mounted.

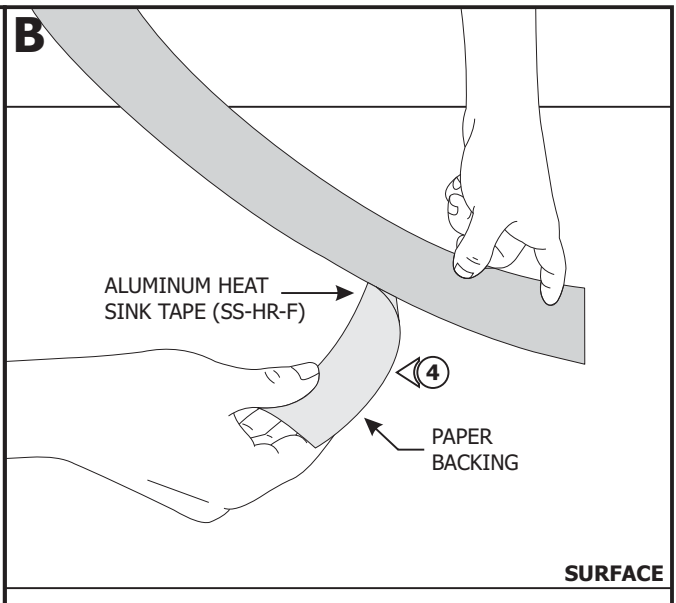

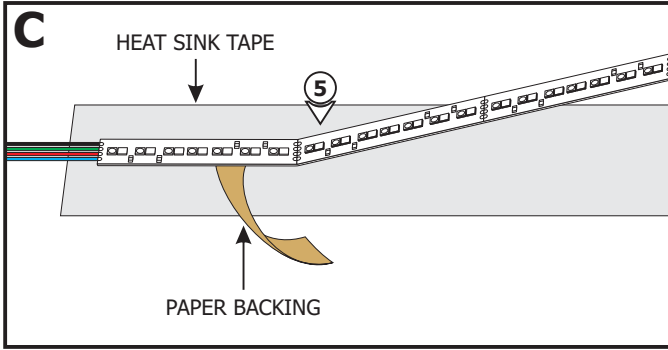

**5:** Carefully remove the backing from the LED strip, make sure not to remove the tape from the LED strip. Firmly press down the adhesive portion of the LED strip onto the mounting surface while removing the rest of the backing, making sure there are no air bubbles that can cause surface irregularities.

**Soldered Leads, 2 ends (SE2)**

**6:** To join multiple LED strips, connect the black, green, red, and blue wires from one end of an LED strip to the black, green, red and blue wires from one end of the next LED strip respectively using wire nuts.

**7:** Repeat step 6 for additional sections.

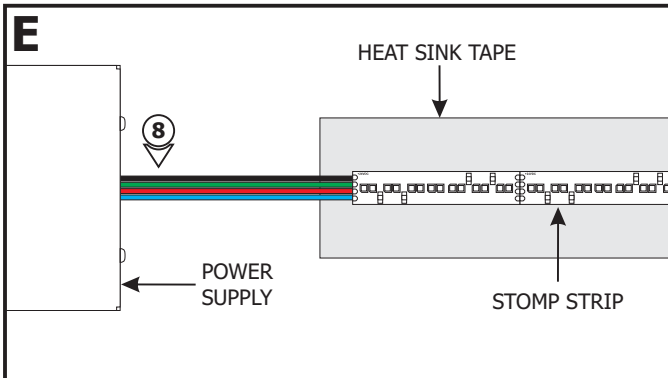
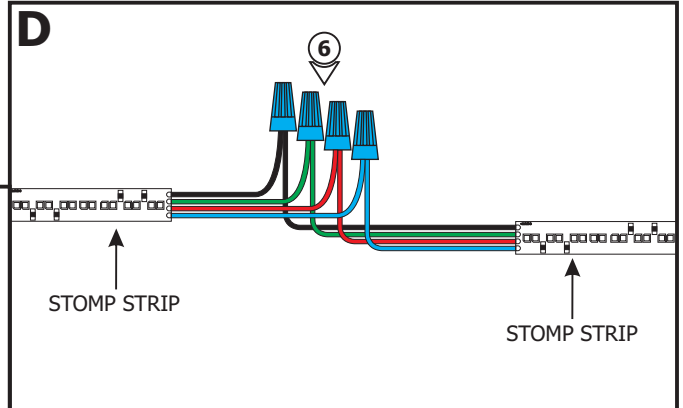

**8:** Route the wires on the other end of the LED strip that are going to be connected to power to the power supply.

**NOTE:** ST2A Stomp Strip consumes on average 2.5W per foot.

**NOTE:** ST5A Stomp Strip consume on average 4.6W per foot.

**NOTE:** ST7A Stomp Strip consumes on average 7.3W per foot.

**NOTE:** ST10A Stomp Strip consume on average 9.6W per foot.

**NOTE:** Omit steps 9 through 12 if using two channel controls. Refer to the instructions provided with the power supply and wiring diagram on page 3.

- 9:** Connect the black wire to the red "+" DMX terminal and tighten the screw.
- 10:** Connect the green wire to the green "+" DMX terminal and tighten the screw.
- 11:** Connect the red wire to the red "-" DMX terminal and tighten the screw.
- 12:** Connect the blue wire to the green "-" DMX terminal and tighten the screw.
- 13:** Refer to the wiring diagrams on pages 3 and the instructions provided with the power supply to complete the installation.

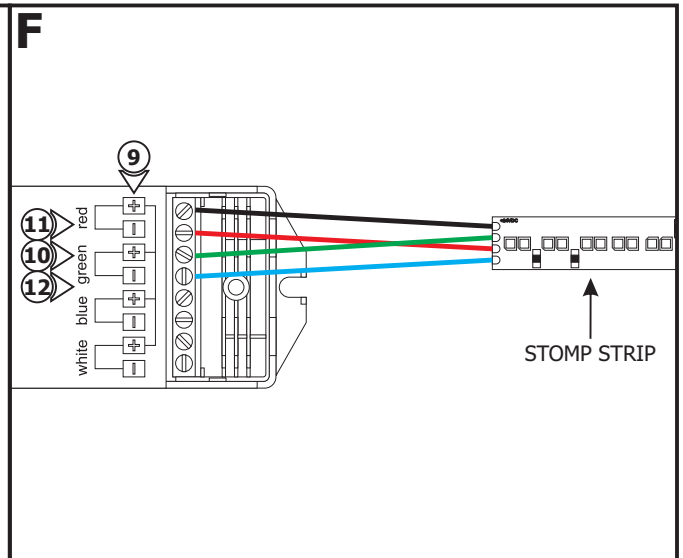

# General Wiring Diagrams

Using LED Power Supply with CDP, CTP, or CDMX Control (shown for demonstration purposes)

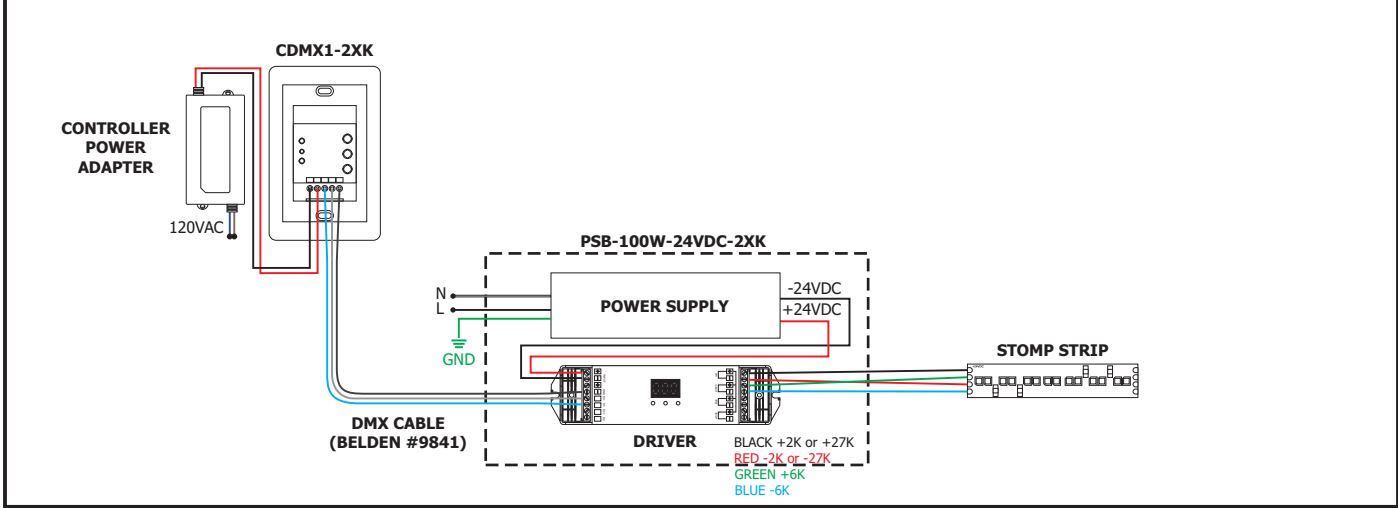

Using LED Power Supply with Two Channel Controls, for Intensity and Color Temperature

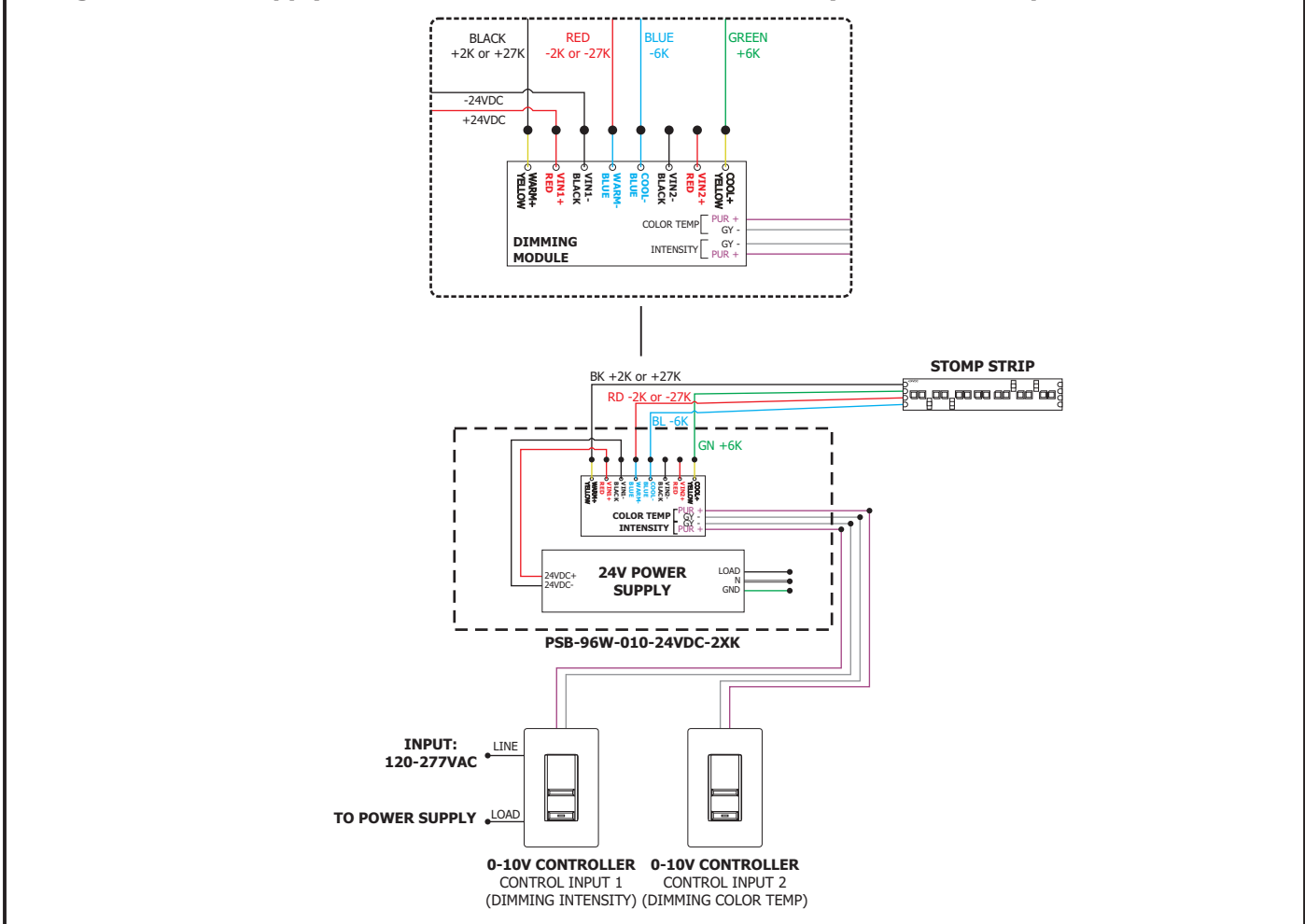

## IMPORTANT INFORMATION REGARDING INSTALLATION AND REWORK OF SOFT STRIP LED

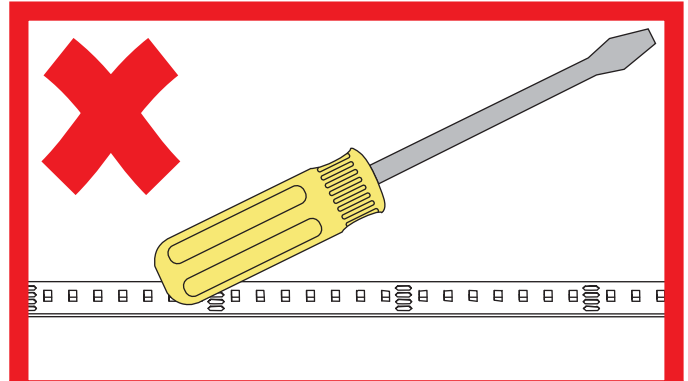
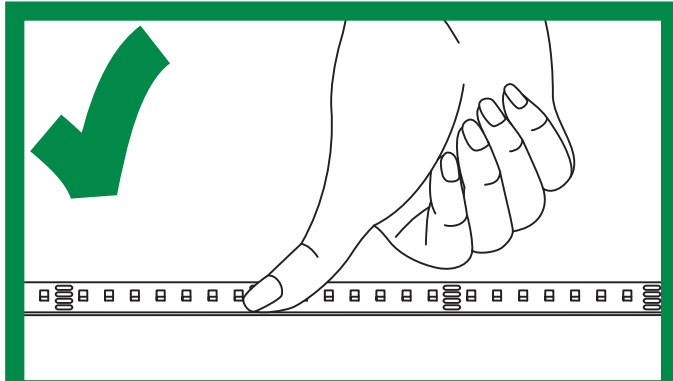
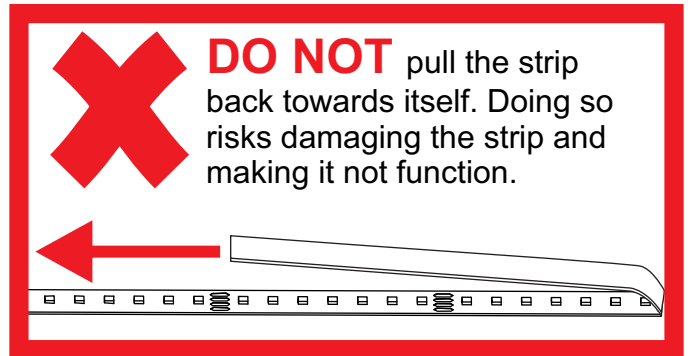
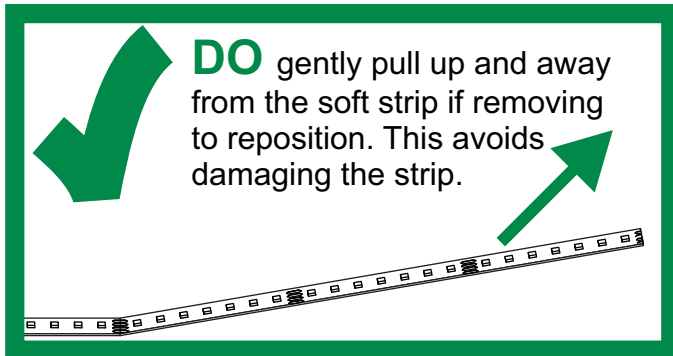

### Relocating Soft Strip (Optional)

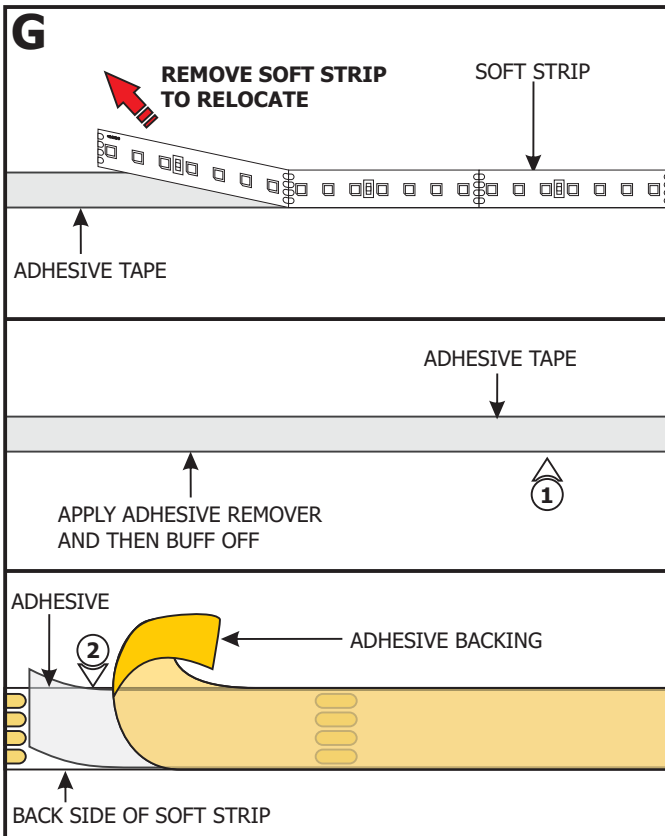

**NOTE:** If relocating the installed soft strip, make sure that the adhesive tape on back of the soft strip covers the entire strip. The adhesive tape isolates the strip from the installation surface. Damaged or inconsistent adhesive tape may cause the contacts on the back of the strip to come in contact with the conductive heat sink which will cause the strip to short and burn. Call PureEdge Lighting to get replacement adhesive tape and/or optional aluminum heat sink tape (SS-HR-F).

- 1:** To remove tape residue from back of the strip, apply WD-40, Goo Gone, or a mixture of warm water and lemon oil to the corner of a clean, dry towel. Gently buff the area containing the adhesive residue until it is completely removed.
- 2:** Gently remove a few inches from one side of the tape backing. Attach the adhesive tape to the back of the soft strip and apply moderate pressure to affix the tape. Continue this step a few inches at a time until the entire adhesive tape is attached to the back of the soft strip.
- 3:** Refer to step 5 to reinstall the LED strip.