



1718 W. Fullerton Chicago, IL 60614
 Ph: 773.770.1195 • Fax: 773.935.5613
 www.PureEdgeLighting.com • info@PureEdgeLighting.com
 © 2016 PureEdge Lighting. All Rights Reserved.

Installation Instructions for TruTrack Dual Source with Integral LED Strip

TR24-DS-_-WH

IMPORTANT INFORMATION

- This product is for indoor dry locations only.
- This instructions shows a typical installation.
- Before beginning any electrical work, ensure that the power to the electrical box is off.

SAVE THESE INSTRUCTIONS!

Section One: Install the Remote Power Supply

A



REMOTE POWER SUPPLY

- 1:** Remote power supplies must be installed within 40ft of the junction box. Refer to the instructions and wiring diagram provided with the remote power supplies.

Section Two: Install the Junction Box

B

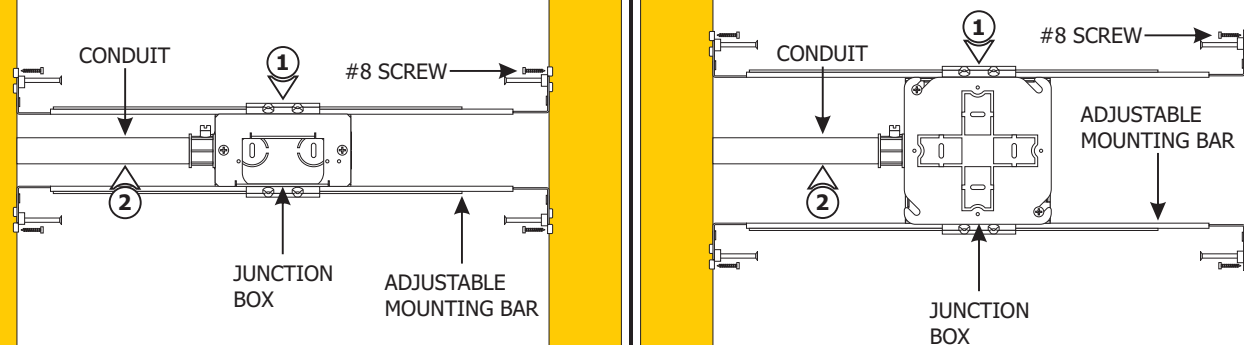

NOTE: Refer to the instructions provided with any of the TruTrack Power Feeds to install the junction box.

- 1:** Mount each adjustable bar to one side of the junction box and secure them with the mounting brackets and two Phillips screws provided.
- 2:** Run the Class 2 24VDC low voltage wires coming from the remote power supplies to the junction box. Only install conduit if required by local electrical codes.

Section Three: Install and Cut Drywall for the Track Channel

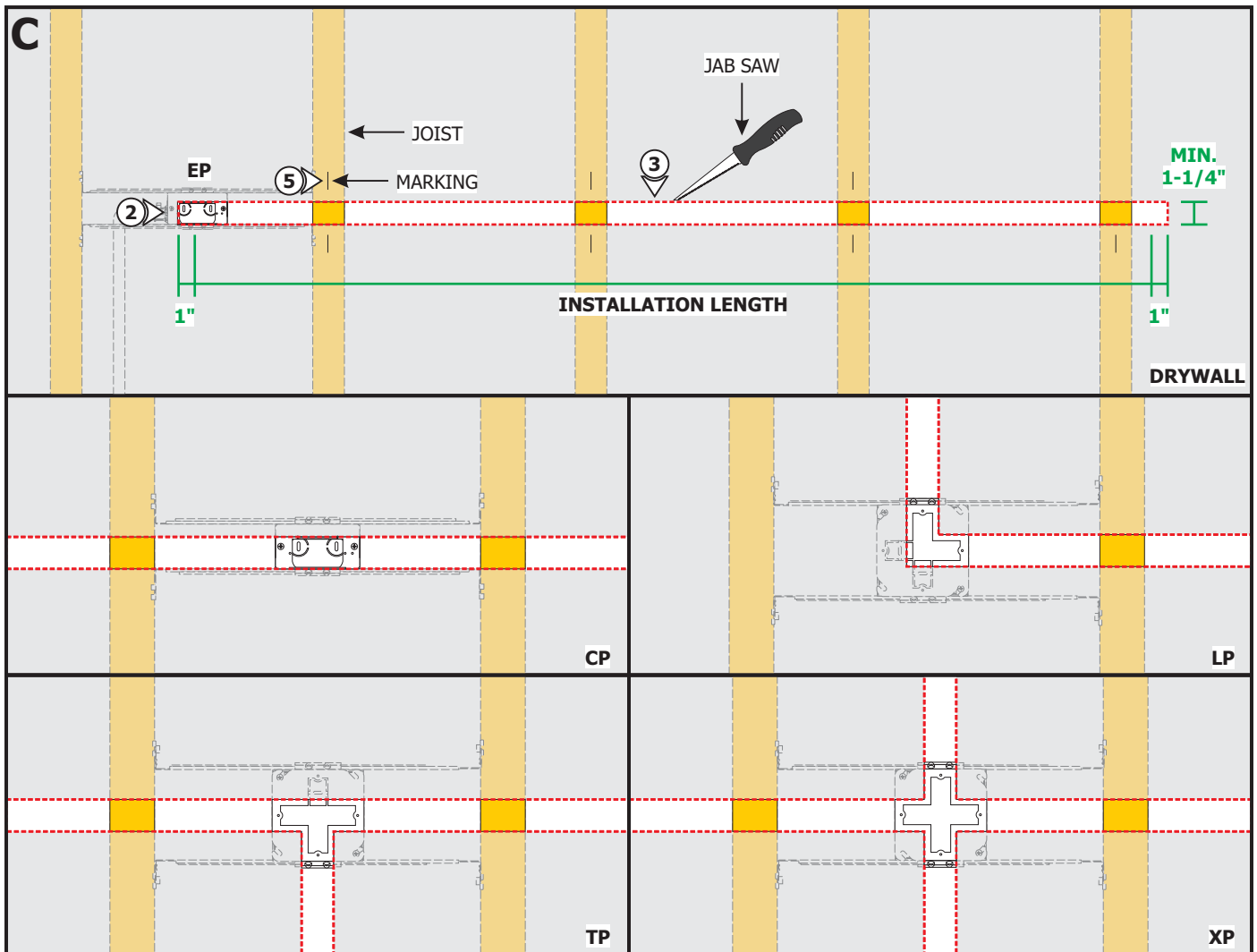

- 1:** Cut a section of drywall to expose the junction box area.
- 2:** Mark the area where the TruTrack will be located on the ceiling using the junction box opening as a guide (MIN. 1-1/4"). Allow 1" at the beginning and end of the installation for the End Caps (if any).
- 3:** Cut out the marked area on the drywall using a jab saw or other appropriate tool.
- 4:** Install the drywall aligning it with the junction box.
- 5:** Mark the location of the joists and mounting straps (**MBAR**) to the drywall for future reference.

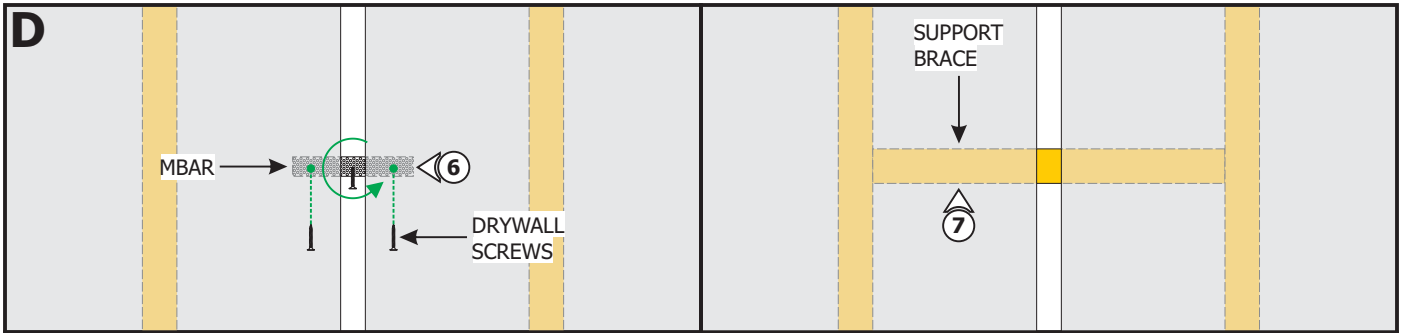

NOTE: To install the track in a wall without standard-spaced studs/joists, install perforated mounting straps (MBAR) every 32" behind drywall.

NOTE: For areas with lots of vibrations, it is suggested to install 2X4 support braces (suggested spacing is every 32") before installing and finishing drywall to avoid cracking of plaster. Refer to the step 7, Alternate Installation Option.

Additional Mounting Support:

6: Thread a drywall screw into the perforated material. Use the screw to hold and place the mounting strap (**MBAR**) behind the drywall, and then rotate it in place. Secure the mounting strap to the drywall using two drywall screws. Mark the location of the mounting strap on the drywall.

Alternate Installation Option:

7: Install 2X4 support braces (suggested spacing is every 32") before installing and finishing drywall.

Section Four: Install Track Channel and Connectors

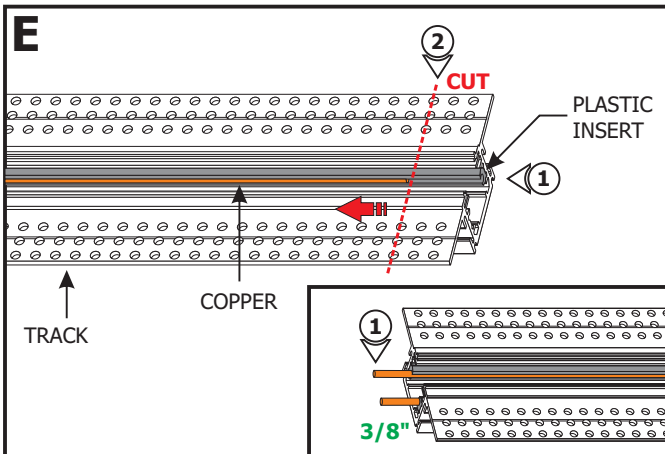

NOTE: The copper conductor must be exposed for 3/8" on one or both ends (depending on design) for a power connection. In events when the channel has to be cut to size or the copper conductors are not exposed, then follow the steps below.

1: Copper must be removed **BEFORE** cutting the track. Use a combination of screw driver and hammer to carefully tap **ONLY** the copper out 3/8" on the other side.

2: Measure and cut the end of the track on a flat surface. Use a miter circular saw to cut the channel.



3: To make another connection on the other end of the track, tap the copper out 3/8" on the same side leaving 3/4" of copper on the other side. Cut the end of the track on a flat surface.

4: Tap the copper back leaving 3/8" of copper exposed on both ends.

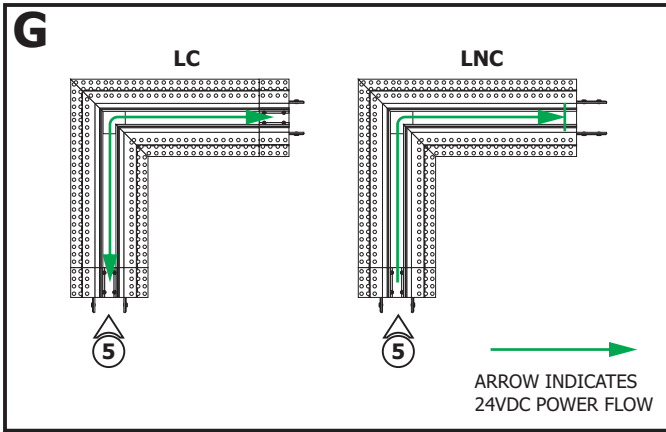

5: L-Connectors join two track sections together in a 90 degree angle and either conduct the power from one track to the other (**LC**) or isolate the power from one track to the other respectively (**LNC**).

6: Refer to the instructions provided with the L-Connector.

7: The Straight Seamless Connector joins two track sections end to end and either conduct the power from one track to the other (**SC**) or isolate the power from one track to the other respectively (**SNC**).

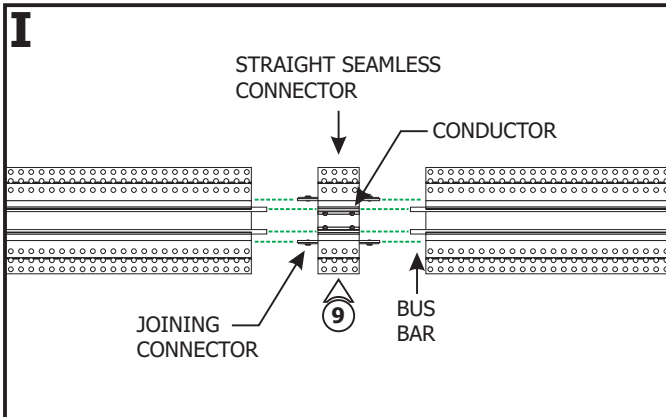
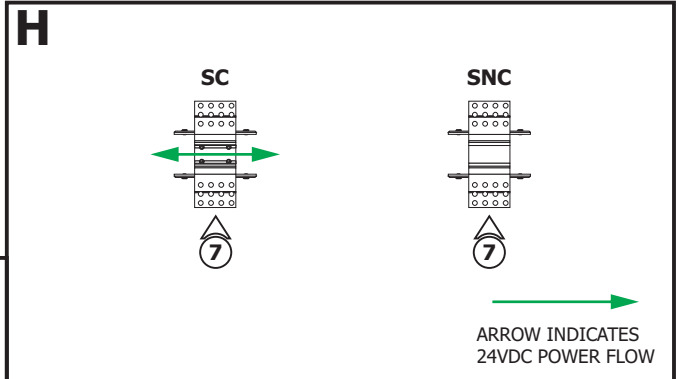

8: Slide the track over the joining connectors on the Conductive or Non Conductive Connectors.

9: Insert the bus bars into the conductor or connector. Tighten the set screws on the joining connectors and the set screws on the conductors using the provided Allen wrenches.

10: Loosen (**Do Not Remove**) the two screws on the End Cap.

11: Slide the End Cap into the non-power end of the track and tighten the two set screws to secure in place.

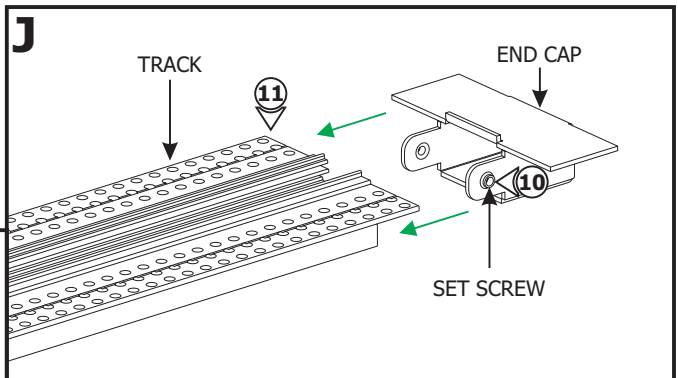

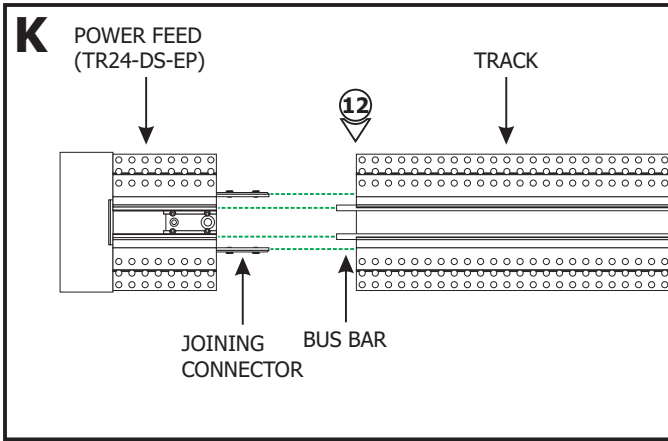

NOTE: End Power Feed (TR24-DS-EP) is shown for demonstration purposes.

12: Refer to the instructions provided with the TruTrack Power Feeds to connect to the tracks.

13: Strip 3/8" off of the fixture wire and the low voltage power supply wires.

14: Pull up the levers of one lever nut, and insert the red +24VDC power supply wire and the red fixture wire. Push the lever down to connect and lock into place.

15: Pull up the levers of the other lever nut and insert the black -24VDC wire from the same power supply and the black fixture wire. Push the lever down to connect and lock into place.

16: Lightly tug on the wires to ensure they are secured in place.

17: Place the lever nuts inside the junction box.

18: Feed the wires from the second power supply for the LED Soft Strip through the Power Feed opening.

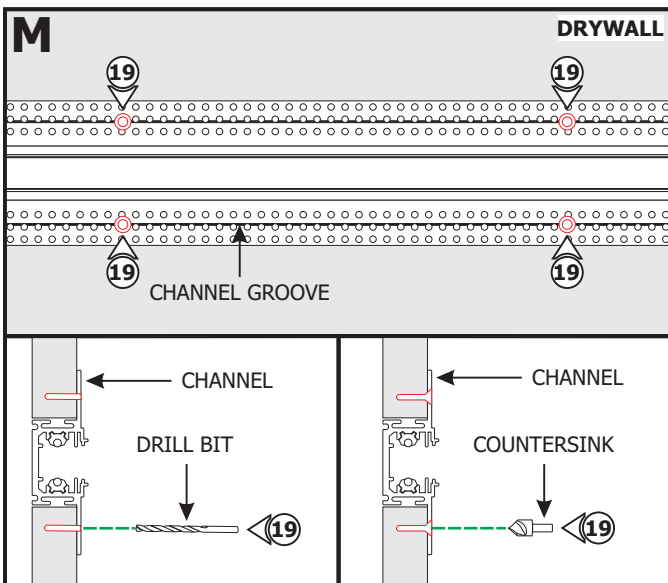
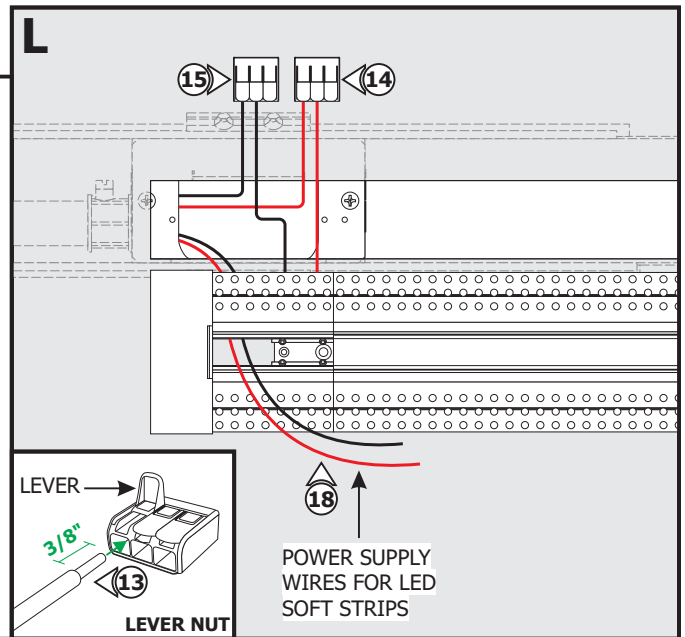

19: Place the assembled channel in the drywall cutout. Using the marked joist and mounting strap locations on the drywall, drill and countersink the channel along the groove lines using the provided square drill with countersink bit.

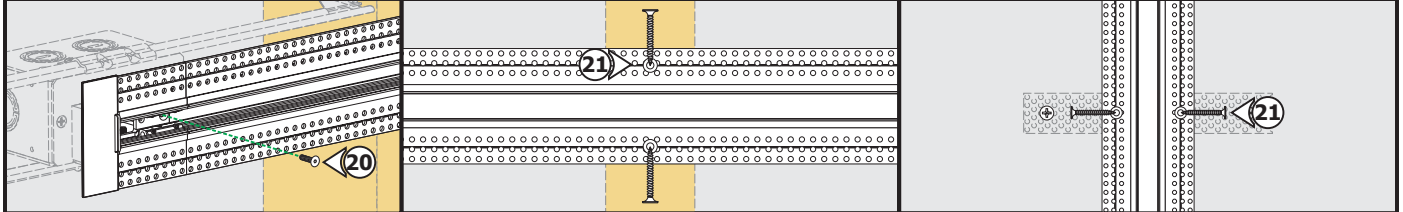
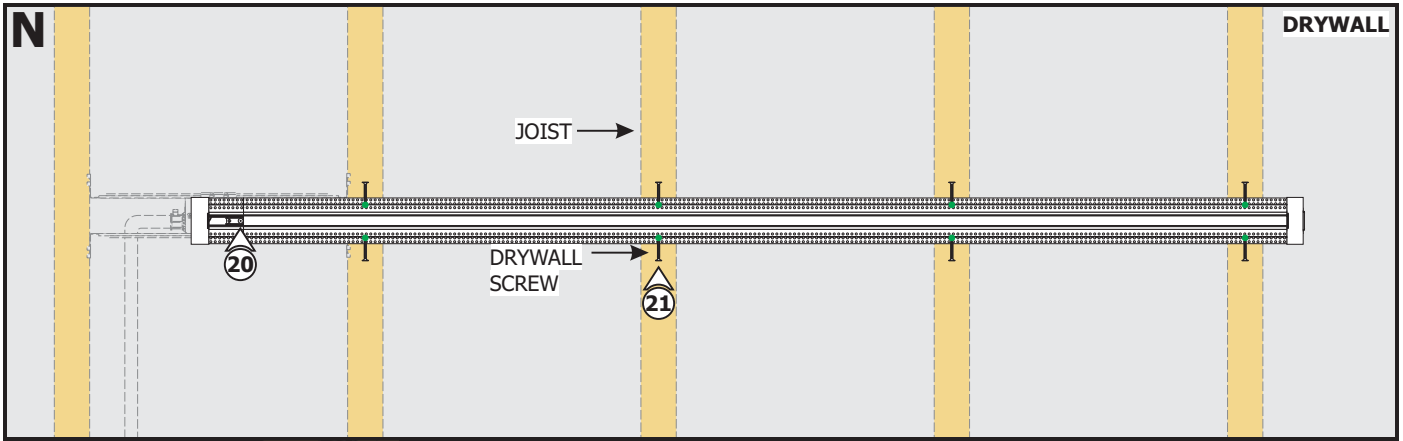

20: Secure the TruTrack Power Feed to the junction box using the provided screw(s).

21: Properly secure the channel to the marked joists and mounting straps using drywall screws (**DO NOT over tighten**). Ensure all screw heads are flush with the channel surface.

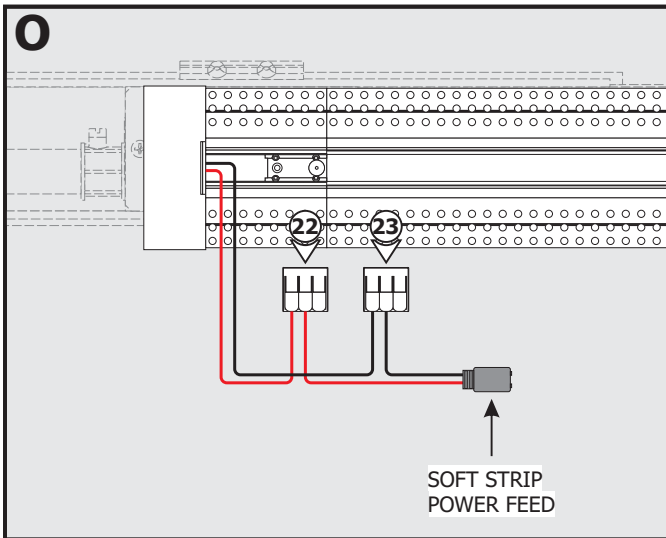

22: Connect the red wire of the Soft Strip Power Feed to the red +24VDC wire of the second power supply using a lever nut.

23: Connect the black wire of the Soft Strip Power Feed to the black -24VDC wire of the same power supply using a lever nut.

24: Place the lever nuts inside the junction box.

CAUTION: Unroll the entire LED strip from the reel and use the power connector to power the strip making sure there is no outage before continuing with the installation. Afterwards, carefully roll the LED strip loosely back into the reel.

CAUTION: Test the circuit using a track head before plastering.

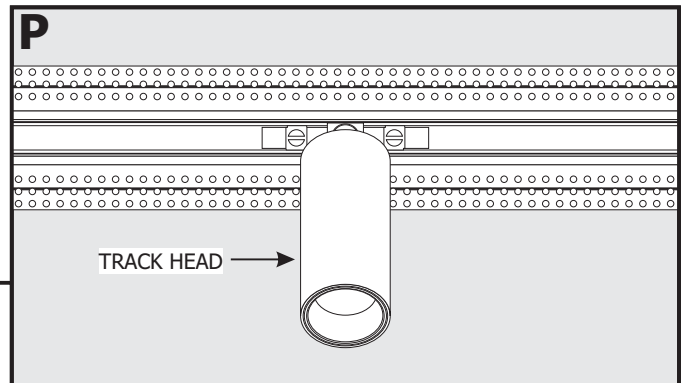

Section Five: Plaster, Sand and Paint

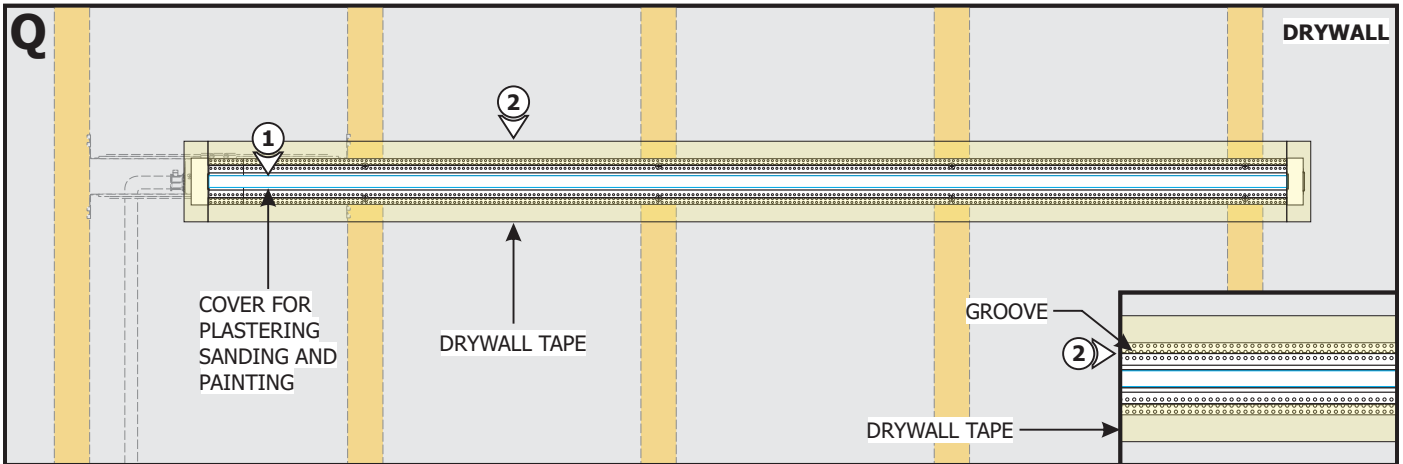

NOTE: For areas with lots of vibrations, it is suggested to use Durabond to avoid cracking of plaster.

NOTE: Do Not use premixed joint compound "Soft Mud." No use compuesto para juntas premezclado "Soft Mud."

NOTE: Recommended plaster method: 1st Coat - Durabond 45 with 8" Blade, 2nd Coat - Easy Sand 45 with 10" Blade, 3rd Coat - with 12" Blade

NOTE: Three covers are provided. Cover with no black backing for plastering and painting (T24-COV-8FT-WH), diffused lens for light (T24-SCT-8FT-DW), and cover with black backing for light blocking purposes (T24-SCO-8FT-WH).

1: Snap the cover for plastering and painting onto the track.

2: Must apply drywall tape (Ultra-Thin drywall tape suggested) along edges of the track up to the groove to prevent cracking of plaster after installation. **DO NOT** overlap strips of drywall tape.

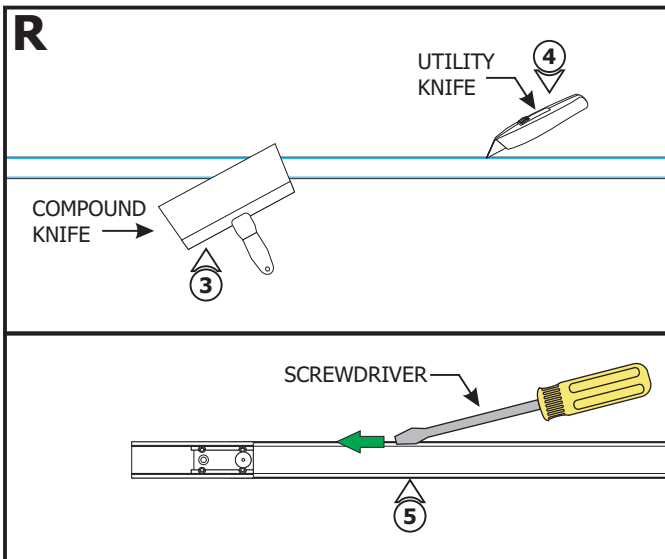

3: Use a 12" compound knife for a smooth compound spread. Plaster and sand the drywall.

4: Use a utility knife to cut along the track gutter. This will avoid plaster damage during cover removal.

5: Remove the cover. Carefully use a small flathead screwdriver to clean and remove excess drywall from the internal bevel/edge along the track.

6: Clean the channel surface with alcohol to remove any dust or debris.

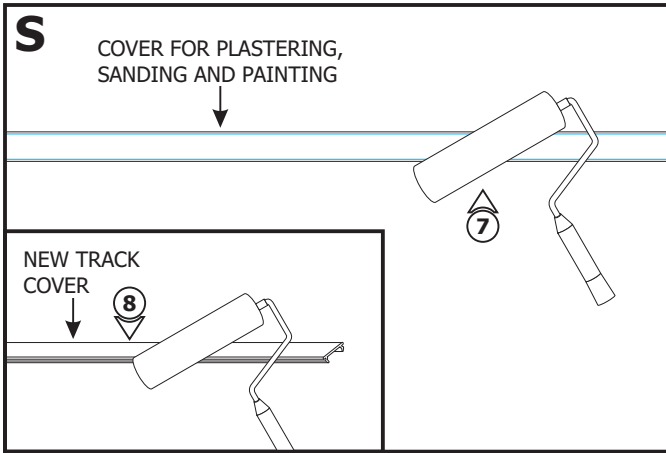

7: Replace the removed track cover back (using it as masking tape) and finish painting the drywall. After painting, wait 1 hour and remove the track cover before the paint dries and discard it.

8: If necessary, cut and paint the new track cover to match the drywall paint.

9: After plastering, sanding and painting clean the inside of the track with a cloth.

Section Six: Install the LED Soft Strip

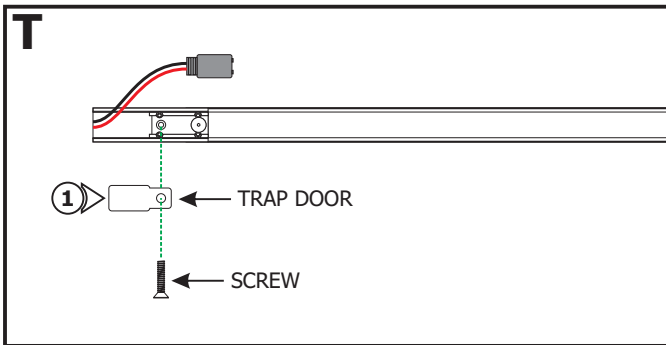

1: Attach the trap door to the junction box using the provided screw.

2: Gently uncoil the LED soft strip before applying to the channel otherwise the strip may lift off of the surface.

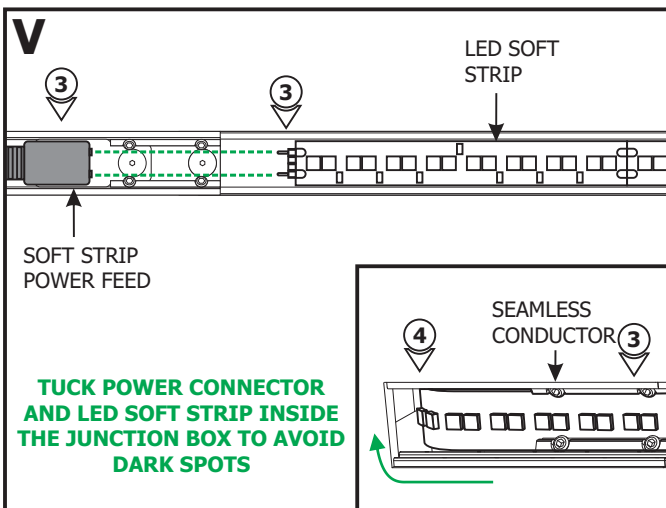
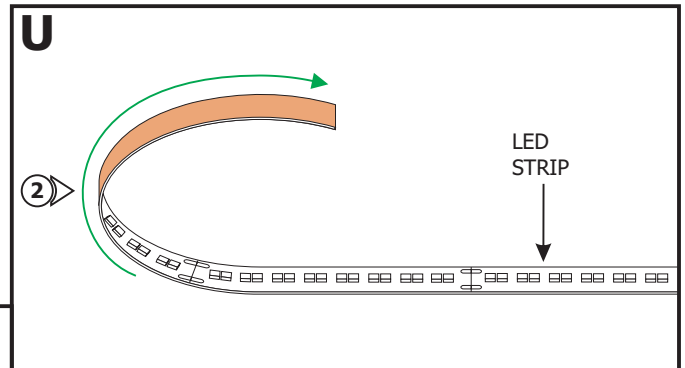

NOTE: LED Strip may not properly adhere to channel surface unless the channel is cleaned with alcohol prior to application.

3: Carefully remove the backing from the LED soft strip, making sure not to remove the tape. Place or slide the soft strip through the seamless conductor and push the soft strip pins into the Soft Strip Power Feed.

4: Place the Soft Strip Power Feed inside the junction box to avoid dark spots.

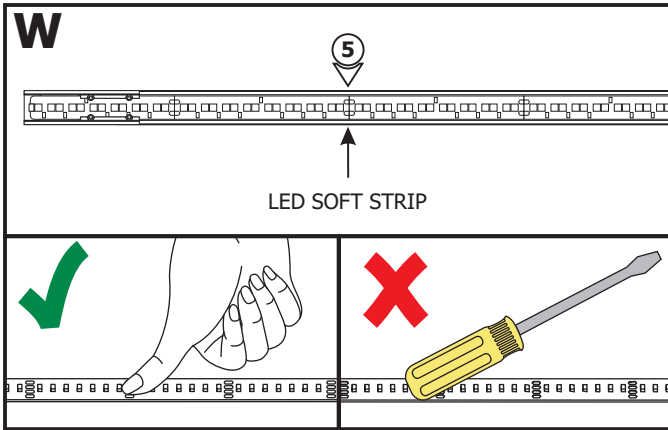

5: Firmly press down the adhesive portion of the LED soft strip onto the track surface while removing the rest of the backing, making sure there are no air bubbles that can cause surface irregularities.

6: If required, trim the soft strip on the dashed cuttable section, place the excess strip inside the end cap. Ensure the entire length of the track is covered with strip to avoid unlit areas.

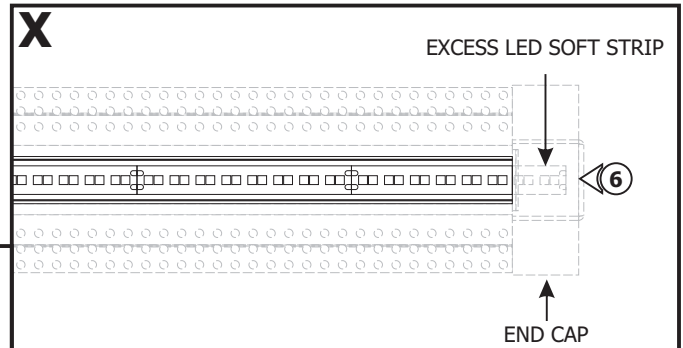

Section Seven: Install Track Heads

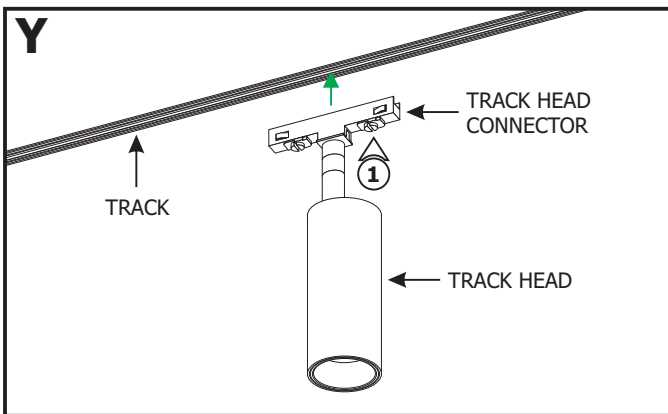

1: Place the track head fixtures to the desired location (refer to the instructions provided with the track head fixture).

2: Use the Opaque Slot Covers to avoid light leaks. If necessary, paint the slot covers to match the drywall paint.

3: Snap the slot covers onto the track on both sides of the track head connector.

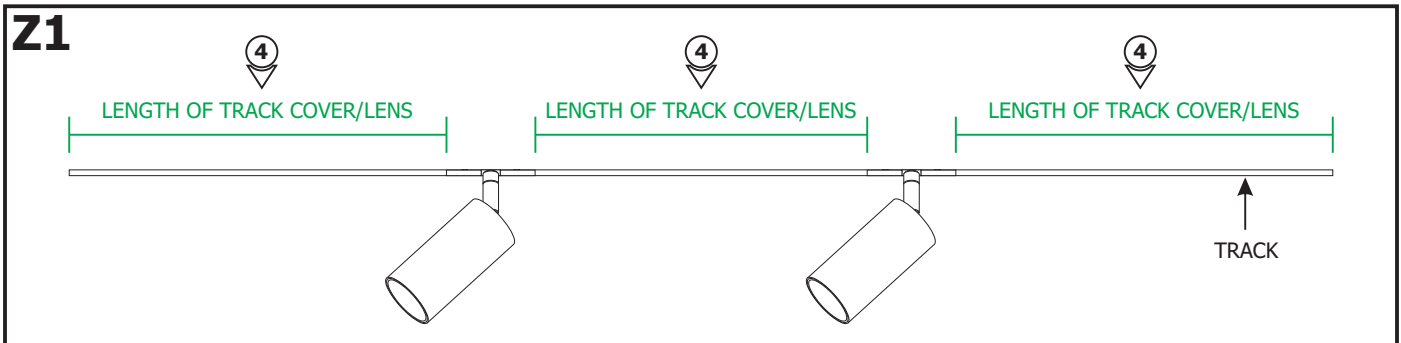
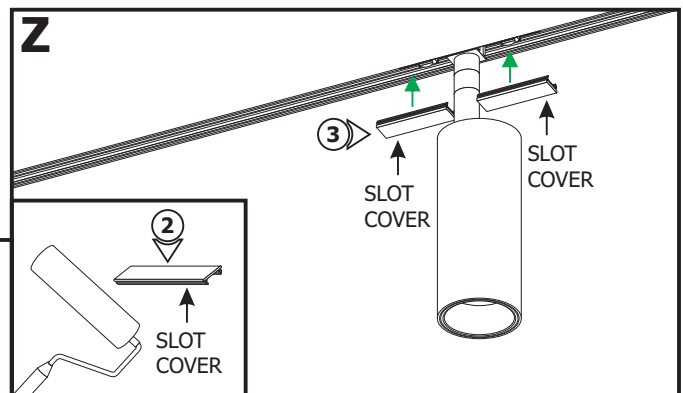

4: Measure the distance between each track head and cut the track cover or lens (optional) to desired length. Snap the covers or lenses onto the track.

IMPORTANT INFORMATION REGARDING INSTALLATION AND REWORK OF SOFT STRIP LED

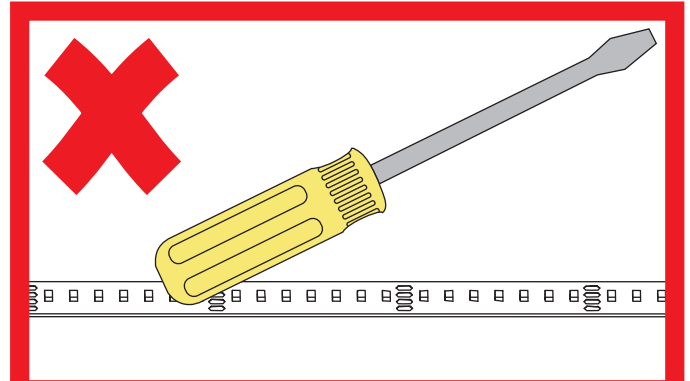
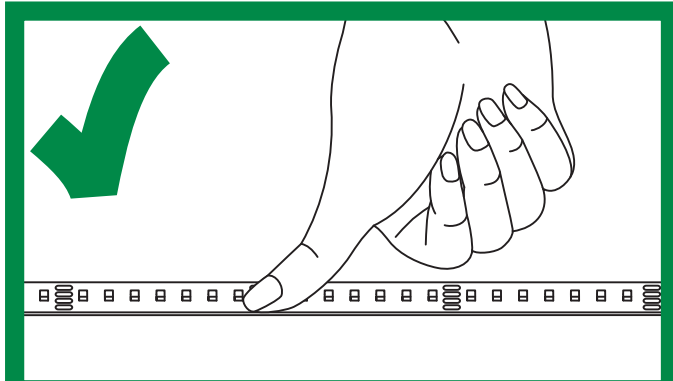
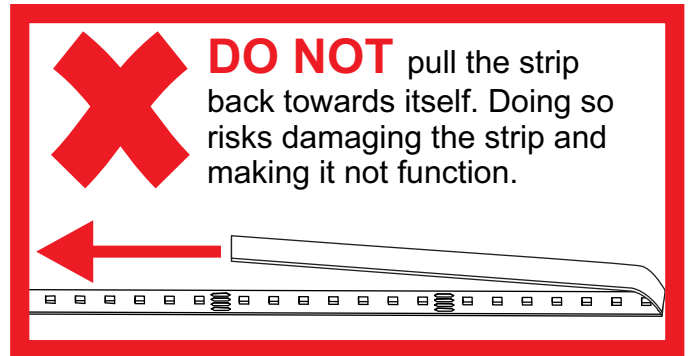
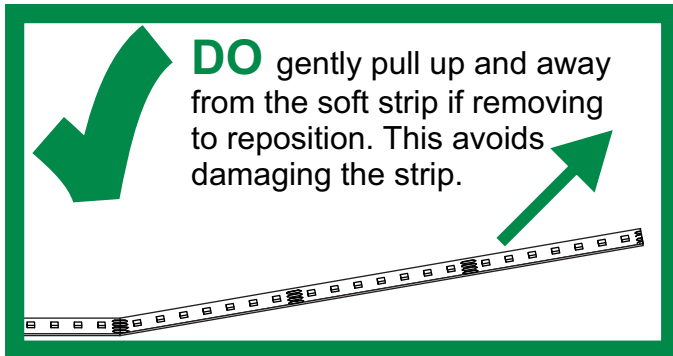

Relocating Soft Strip (Optional)

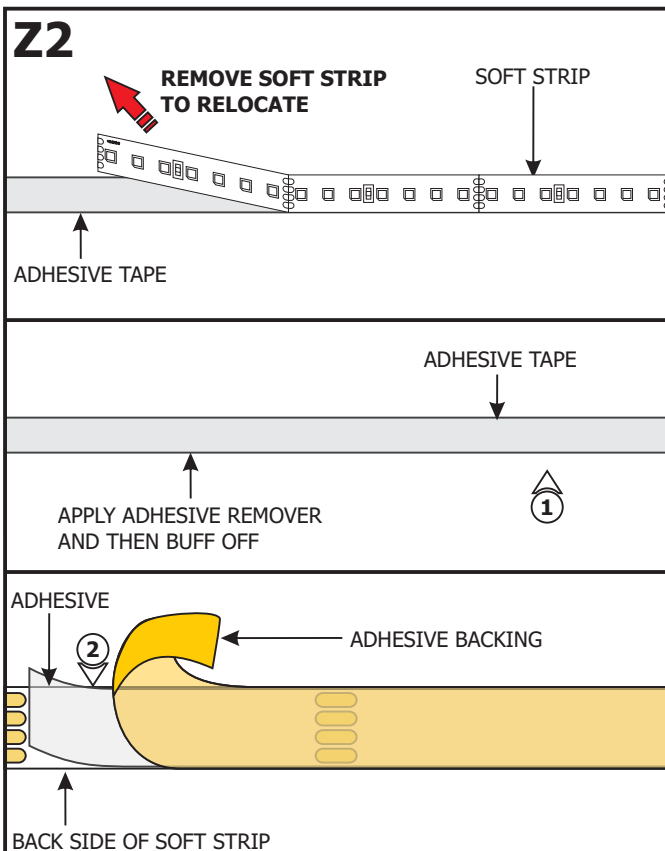

NOTE: If relocating the installed soft strip, make sure that the adhesive tape on back of the soft strip covers the entire strip. The adhesive tape isolates the strip from the installation surface. Damaged or inconsistent adhesive tape may cause the contacts on the back of the strip to come in contact with the conductive heat sink which will cause the strip to short and burn. Call Edge Lighting to get replacement adhesive tape and/or optional aluminum heat sink tape (SS-HR-F).

- 1:** To remove tape residue from back of the strip, apply WD-40, Goo Gone, or a mixture of warm water and lemon oil to the corner of a clean, dry towel. Gently buff the area containing the adhesive residue until it is completely removed.
- 2:** Gently remove a few inches from one side of the tape backing. Attach the adhesive tape to the back of the soft strip and apply moderate pressure to affix the tape. Continue this step a few inches at the time until the entire adhesive tape is attached to back of the soft strip.
- 3:** Refer to Section Six reinstall the LED soft strips.