



1718 W. Fullerton Chicago, IL 60614
 Ph: 773.770.1195 • Fax: 773.935.5613
 www.PureEdgeLighting.com • info@PureEdgeLighting.com
 © 2016 PureEdge Lighting. All Rights Reserved.

Installation Instructions for TruTrack Magnetic Two Circuit, Recessed 24VDC - L-Connector

TR24M-2C-L_C

IMPORTANT INFORMATION

- This product is for indoor dry locations only.
- This instructions shows a typical installation.
- Before beginning any electrical work, ensure that the power to the electrical box is off.

SAVE THESE INSTRUCTIONS!

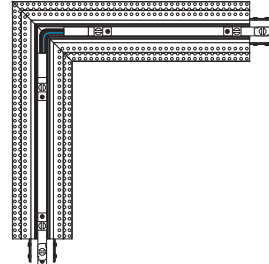

Install the L-Connector

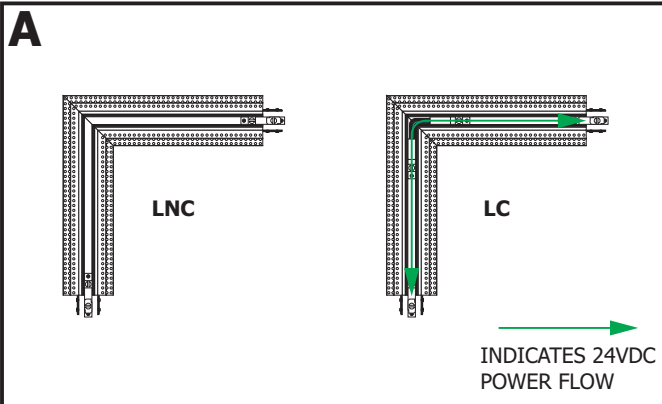

- 1:** L-Connectors join two track sections together in a 90 degree angle and either isolate the power from one track to the other (**LNC**) or conduct the power from one track to the other (**LC**).

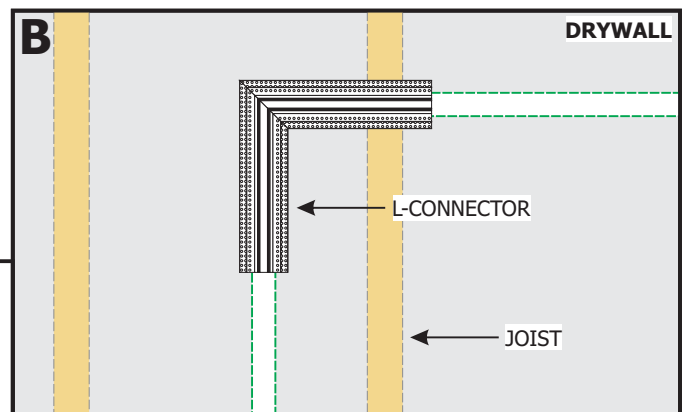

- 2:** Place the L-Connector against the ceiling. Ensure the L-Connector is aligned with the TruTrack installation location.

- 3:** Mark the installation location of the L-Connector on the drywall using a pencil or chalk line before cutting.

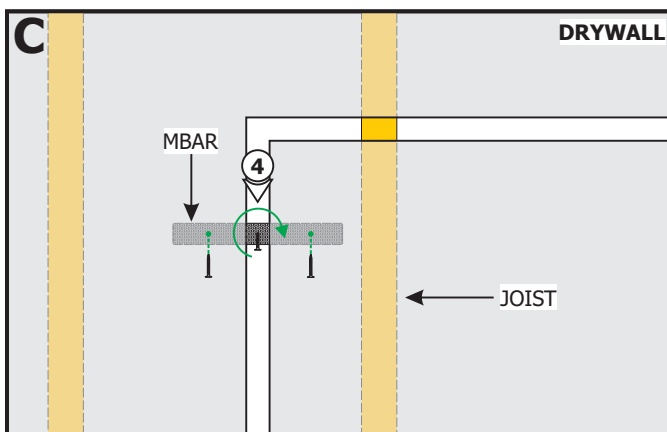

NOTE: Ensure both ends of the connector are supported with either a joist or mounting strap. To install the track without standard-spaced joists, install perforated mounting straps.

- 4:** For each mounting strap (**MBAR**), thread a drywall screw into the perforated material. Use the screw to hold and place the mounting strap behind the drywall, and then rotate it in place.

- 5:** Secure the mounting straps to the drywall on each side using two drywall screws. Mark the location of the mounting straps on the drywall.

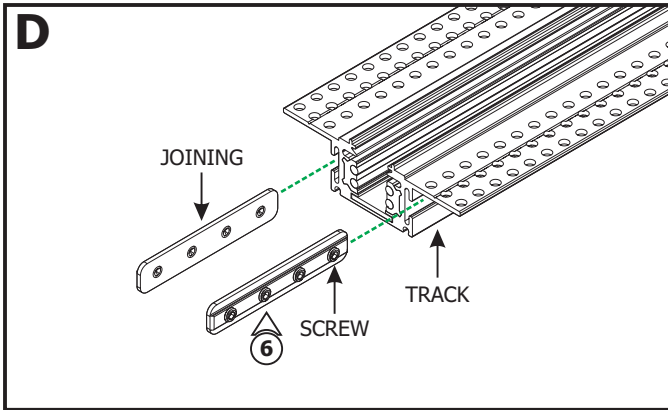

6: Insert the joining connectors of the straight connectors half way into the track and tighten the screws.

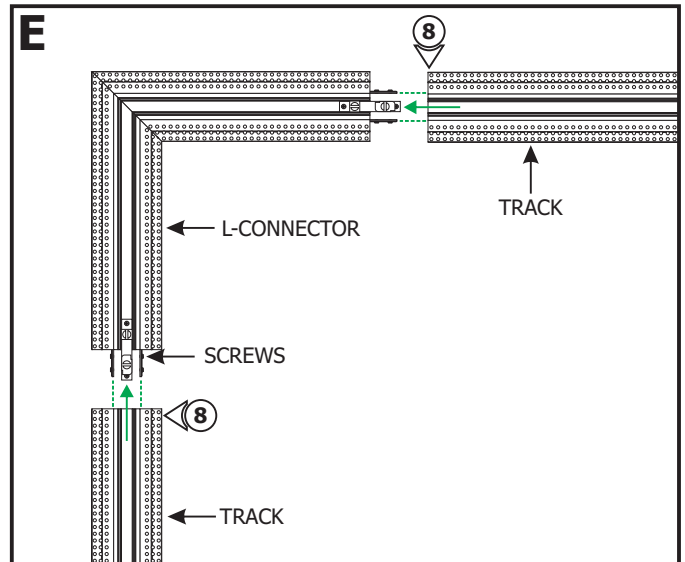

7: Insert the conductive joiner half way into the end of the L-Connector. Tighten the slotted screw using a flat-head screw driver.

8: Slide a track over the joining connectors and conductive joiner. Tighten the remaining screws and slotted screw.

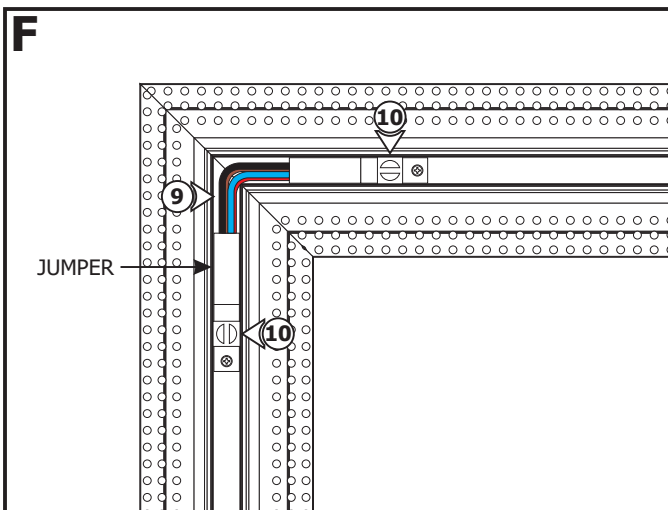
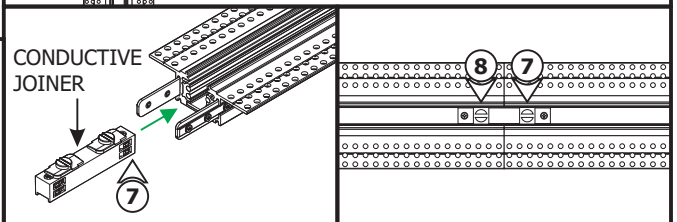

9: For the L-Connector Conductive (LC), place the Jumper Connector in the corner of the L-Connector.

10: Tighten the slotted screws to secure in place.

11: Place the assembled channel in the drywall cutout. Using the marked locations on the drywall, drill and countersink the channel using the provided square drill with countersink bit.

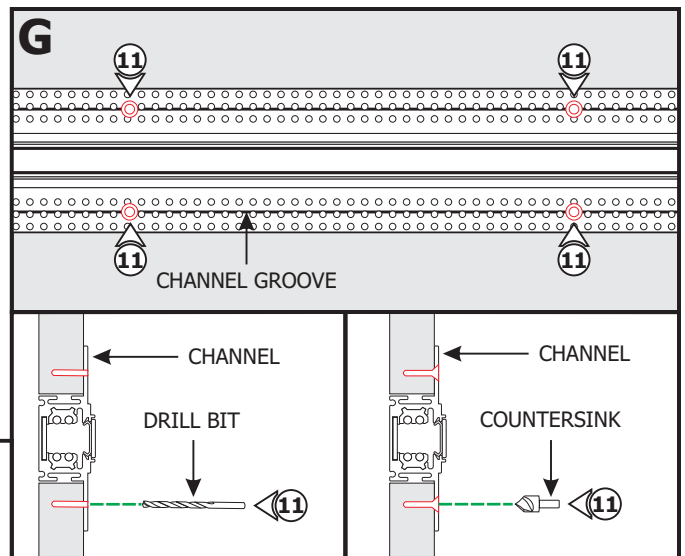

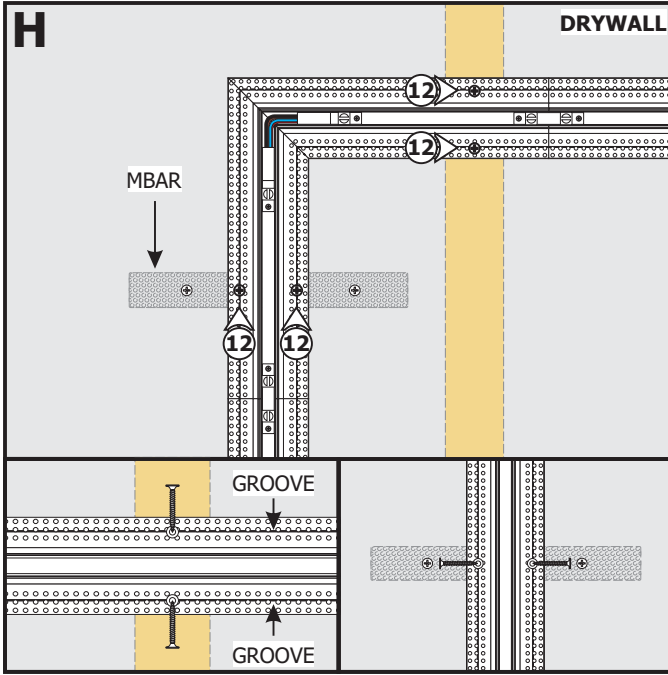

12: Place the L-Connector assembly inside the installation cut out and secure to the marked joists and mounting straps using drywall screws (**DO NOT over tighten**). Ensure all screw heads are flush with the channel surface.

NOTE: Refer to the TruTrack Recessed Channel instructions to complete the installation.