



1718 W. Fullerton Chicago, IL 60614  
 Ph: 773.770.1195 • Fax: 773.935.5613  
 www.PureEdgeLighting.com • info@PureEdgeLighting.com  
 © 2016 PureEdge Lighting. All Rights Reserved.

# Installation Instructions for Zipp Wave Suspension Downlight with Remote Power and 2" Canopy

**WSD-2\_\_-\_\_**

## IMPORTANT INFORMATION

- This product is suitable for indoor locations.
- This instruction shows a typical installation.
- It is recommended more than one person to assist in this installation.

**SAVE THESE INSTRUCTIONS!**



## Section One: Install the 2" Plaster Ring

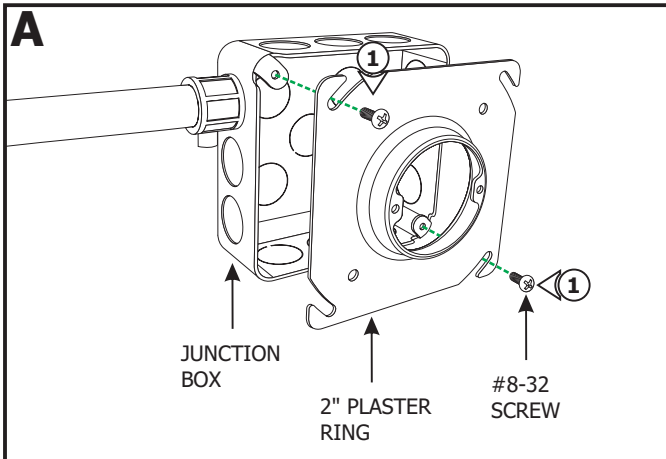

**NOTE:** Junction box must be mounted to allow clearance of 1/2" between the face of the junction box and the drywall surface.

**NOTE:** Ensure that the remote 24VDC power supply wires are present inside the junction box before continuing. Refer to the installation instructions provided with power supply.

### For New Construction:

- 1: Install the 2" plaster ring to the junction box using two #8-32 screws.

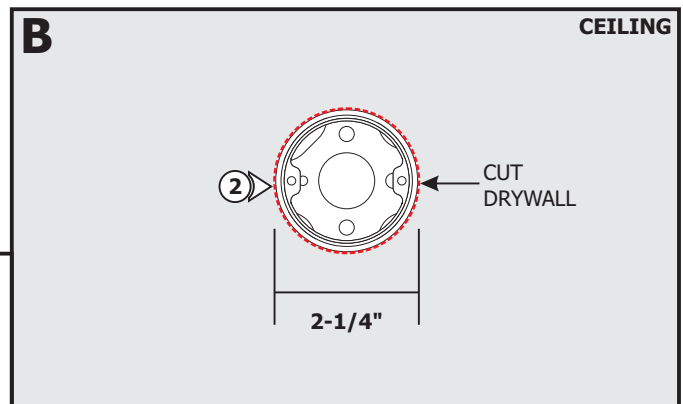

- 2: Use a circular saw to cut out the drywall section where the plaster ring is located.
- 3: Install the drywall. If necessary plaster, and finish the drywall.

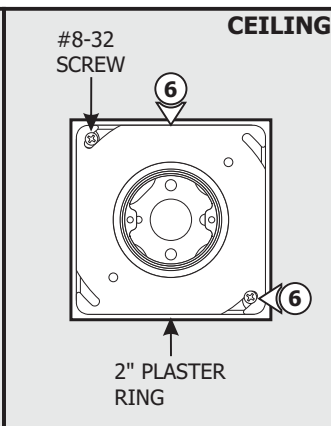
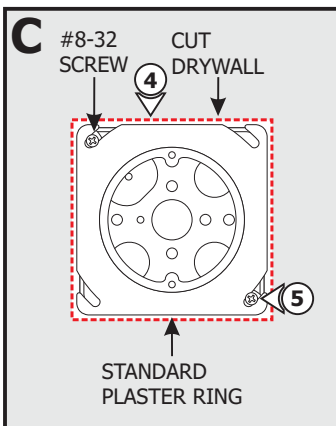

### For Remodeling:

- 4: Cut away the drywall where the junction box is located.
- 5: Uninstall the existing plaster ring by removing the #8-32 screws.
- 6: Install the 2" Plaster Ring to the junction box using two #8-32 screws.
- 7: Plaster and finish around the junction box opening.

## Section Two: Adjusting Cable Position

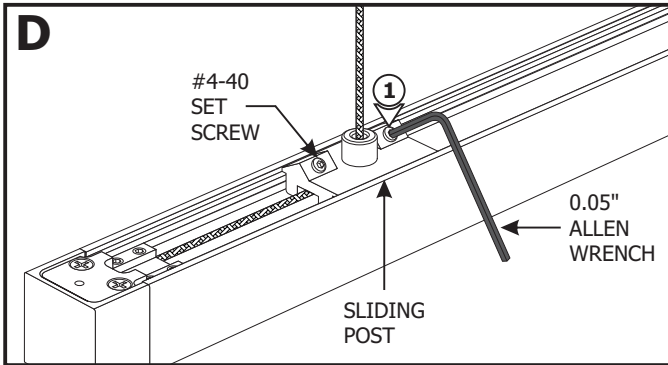

**1:** Loosen (**DO NOT REMOVE**) the two #4-40 set screws on the sliding post with a 0.05" Allen wrench.

**WARNING:** To avoid damaging the coaxial cable electrical connection, make sure that the end of the coaxial cable coming out of the fixture is held with thumb before relocating sliding posts.

**2:** Remove the sliding post from the channel. Carefully rotate and move the sliding post to the predetermined location on the channel.

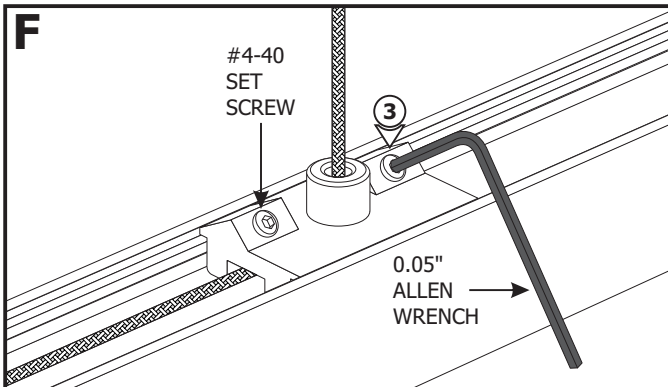
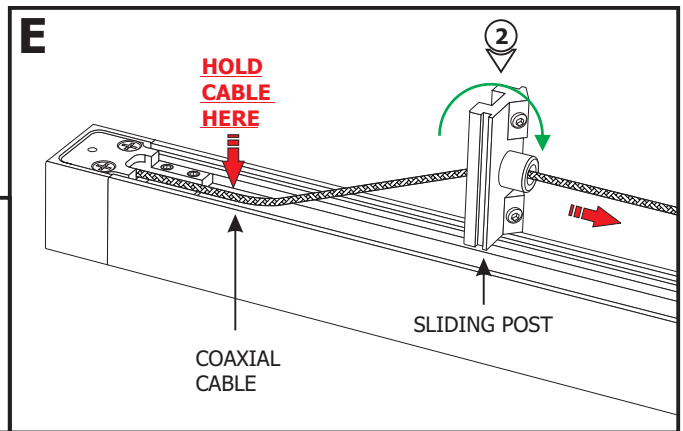

**3:** Place the sliding post back onto the channel and secure it by tightening the two #4-40 set screws with the 0.05" Allen wrench.

**4:** Repeat Steps 1 through 3 for aircraft cables.

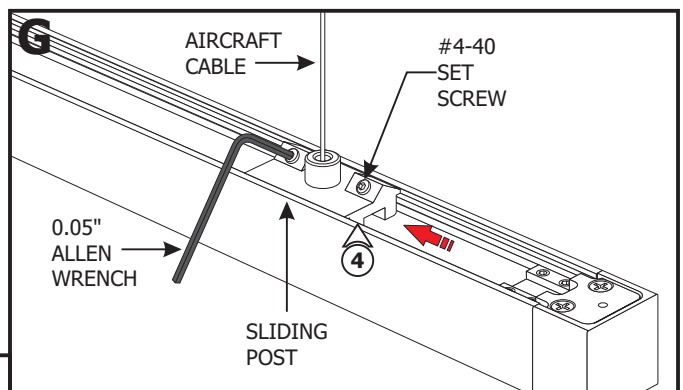

## Section Three: Install the Standoff or Support Canopy

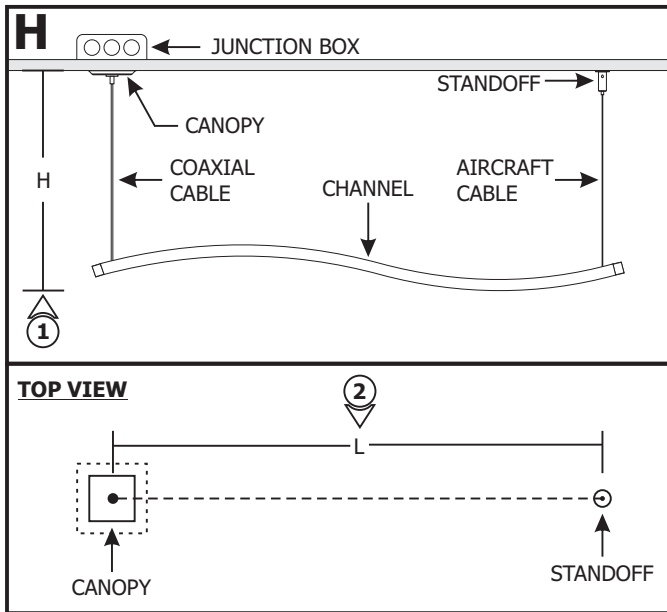

**NOTE:** Run the proper size wires between the 24VDC power supply to the electrical box. Refer to the instructions provided with the power supply for additional information.

**NOTE:** Omit Section Five if the channel is made out of a single piece.

- 1: Determine the fixture height (H) from the bottom of the channel to the top of the canopy.
- 2: Determine the fixture length (L). Measure the distance between the coaxial cable and the aircraft cable on the channel. Mark the standoff location on the ceiling from the center of the junction box.

**NOTE:** Steps 3 and 4 are for drywall mounting. Omit these steps if mounting directly to a wood surface.

- 3: Tap the anchor onto the marked point up to the threaded portion with a hammer.
- 4: Screw in the threaded portion of the anchor with a Phillips screwdriver.

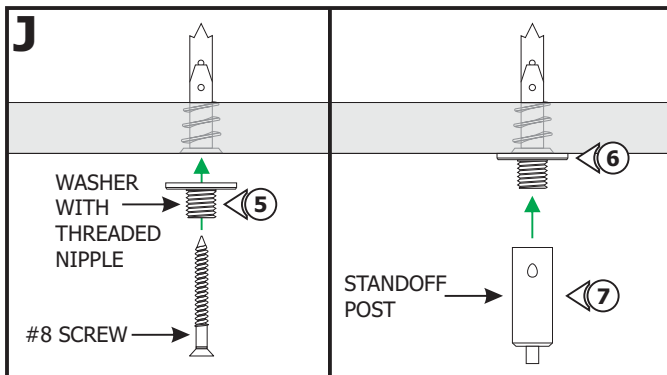
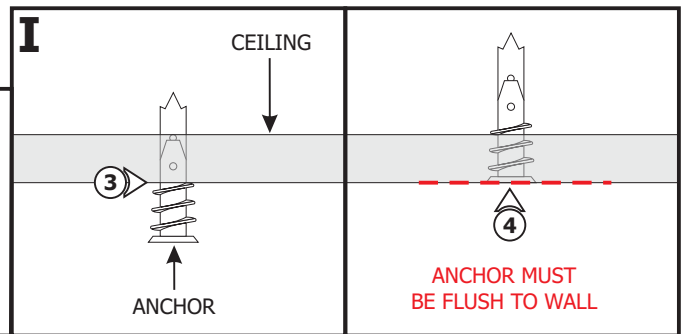

**NOTE:** Omit steps 5 through 10 if using support canopy. Refer to steps 11 through 17.

### Support Standoff:

- 5: Feed the #8 screw through the washer with threaded nipple into the anchor.
- 6: Tighten the #8 screw completely into the anchor.
- 7: Tighten the standoff post completely onto the threaded nipple.

- 8: Feed the aircraft cable coming from the channel through the standoff post.
- 9: Adjust the fixture height by pushing the tab and pulling the aircraft cable out of the side of the standoff post. Release the tab to secure the cable in place.
- 10: If necessary, trim excess aircraft cable using sharp cutters.

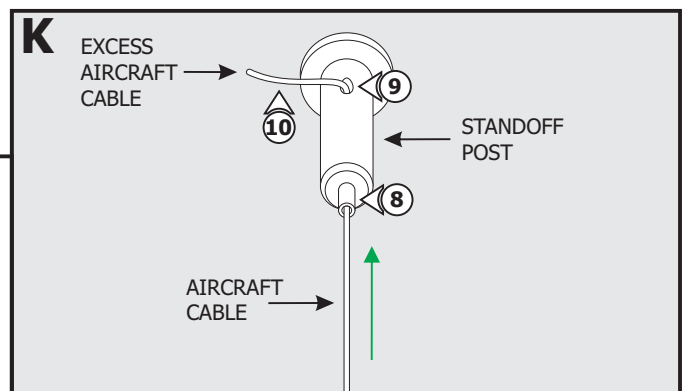

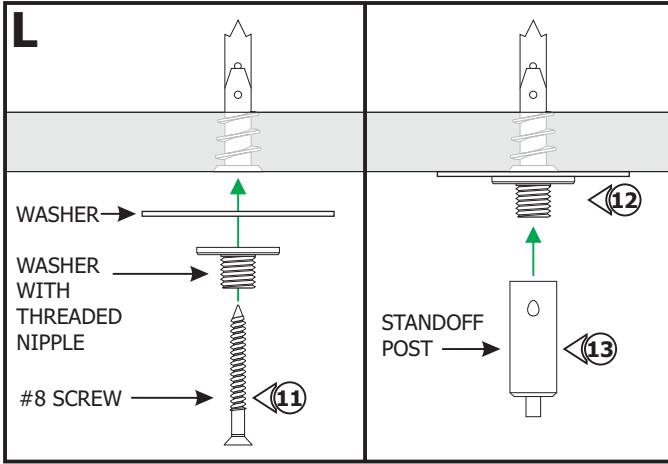

**Support Canopy:**

**11:** Feed the #8 screw through the washer with threaded nipple and 2" washer respectively into the anchor.

**12:** Tighten the #8 screw completely into the anchor.

**13:** Tighten the standoff post completely onto the threaded nipple.

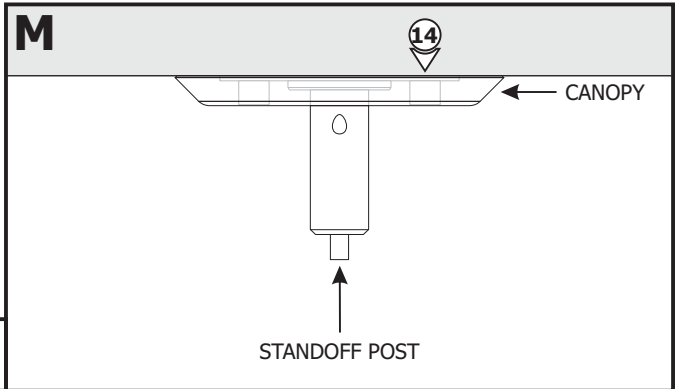

**14:** Place the canopy over the standoff post and magnetically attach the canopy to the washer.

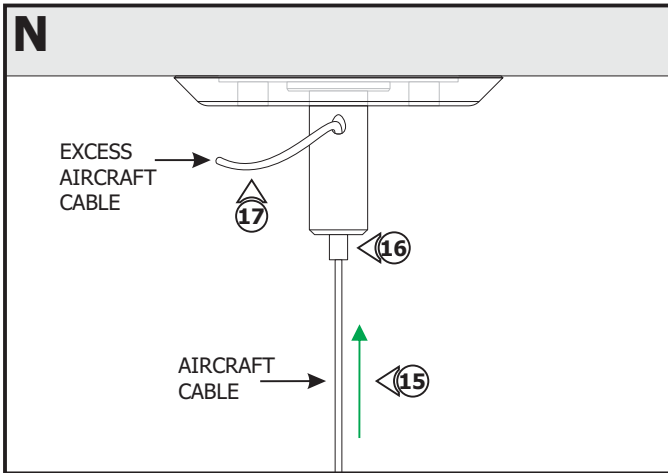

**15:** Feed the aircraft cable coming from the channel through the standoff post.

**16:** Adjust the fixture height by pushing the tab and pulling the aircraft cable out of the side of the standoff post. Release the tab to secure the cable in place.

**17:** If necessary, trim excess aircraft cable using sharp cutters.

**NOTE:** Support cables are provided in the middle of the channels if the fixture is 60" and longer.

**Additional Support**

**18:** If necessary, loosen the #4-40 set screws using a 0.05" Allen wrench and adjust the location of the post on the channel. Tighten the set screws to secure in place.

**19:** Lift the end of the aircraft cable coming from the sliding post against the ceiling to mark the location of the standoff or support canopy.

**20:** Refer to the steps 3 through 17 to install the Support Standoff or Support Canopy.

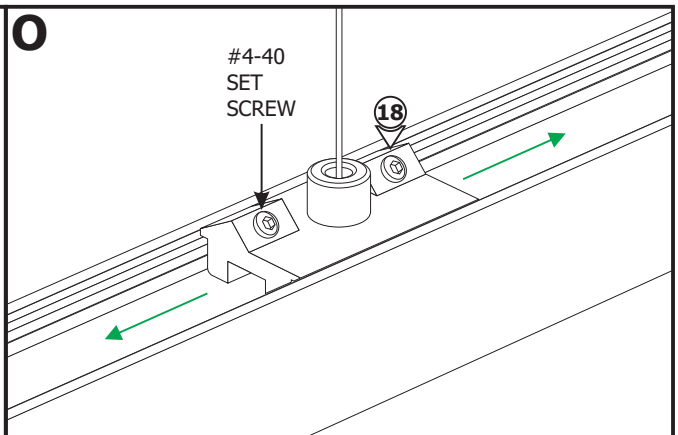

## Section Four: Power the Fixture

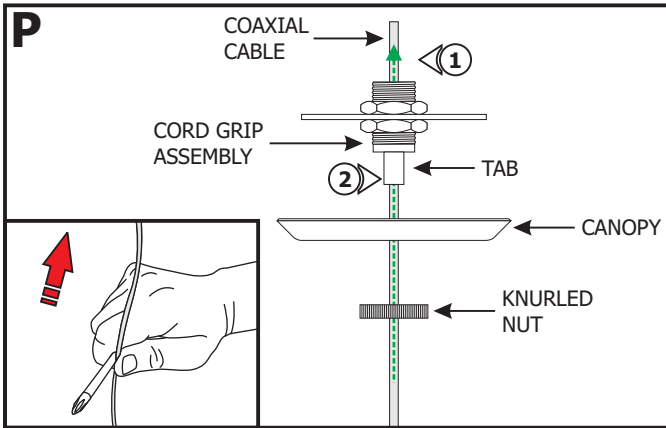

**1:** Feed the coaxial cable through the knurled nut, 2" canopy and cord grip assembly respectively.

**2:** Adjust the fixture height by pushing the cord grip tabs to slide the cables up and down until the desired height is achieved. Release the tabs to lock the cables in place.

**NOTE:** If cable is curled or kinked, straighten by holding between the shaft of a screwdriver and thumb and pulling the cable through (see inset).



**NOTE:** Scan the QR Code to watch the video clip of the following steps or visit [www.PureEdgeLighting.com/video\\_feed/installation\\_cxc\\_connector](http://www.PureEdgeLighting.com/video_feed/installation_cxc_connector)

**3:** Use the 18AWG hole of the wire stripper to remove 1-3/8" of the outer insulation to expose the braided wire.

**4:** Use the 18AWG hole of the wire stripper to remove 1" of the braided wire making sure not to nick the inner wire insulation.

**5:** Use the 20AWG hole of the wire stripper to remove 1/8" of the inner insulated wire.

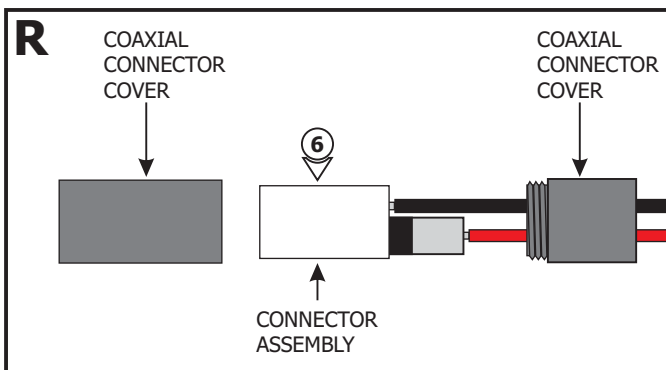
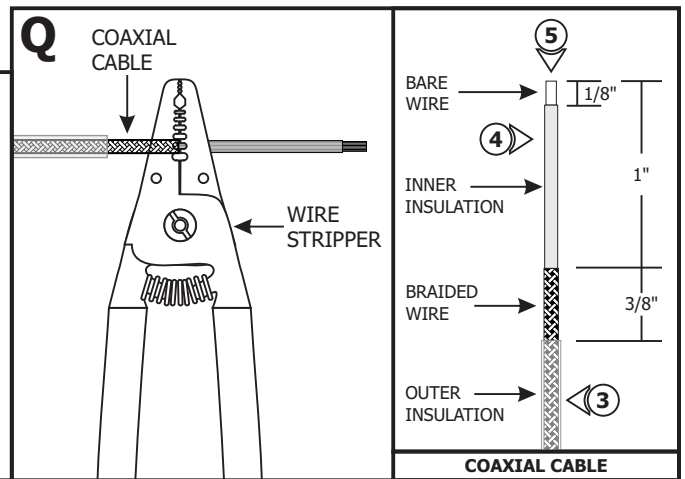

**6:** Unscrew the coaxial connector covers and remove from the connector assembly.

**7:** Using the provided 1.5mm Allen wrench, remove the M3 set screw from the coaxial connector assembly.

**8:** Using the provided 2mm Allen wrench to loosen (**Do Not Remove**) the M4 set screw.

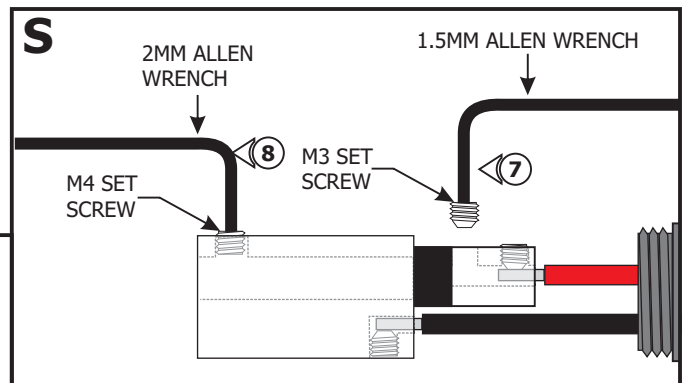

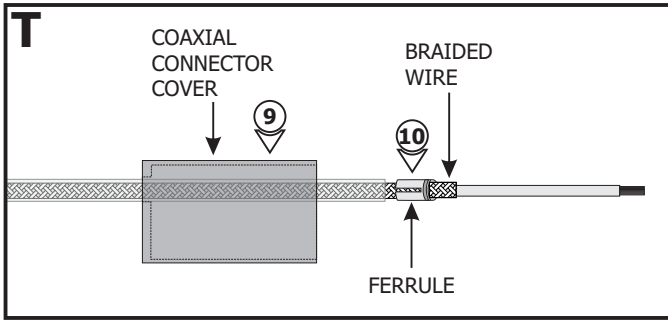

**9:** Slide the connector cover over the coaxial cable.

**10:** Place the ferrule over the 3/8" braided wire of the coaxial cable.

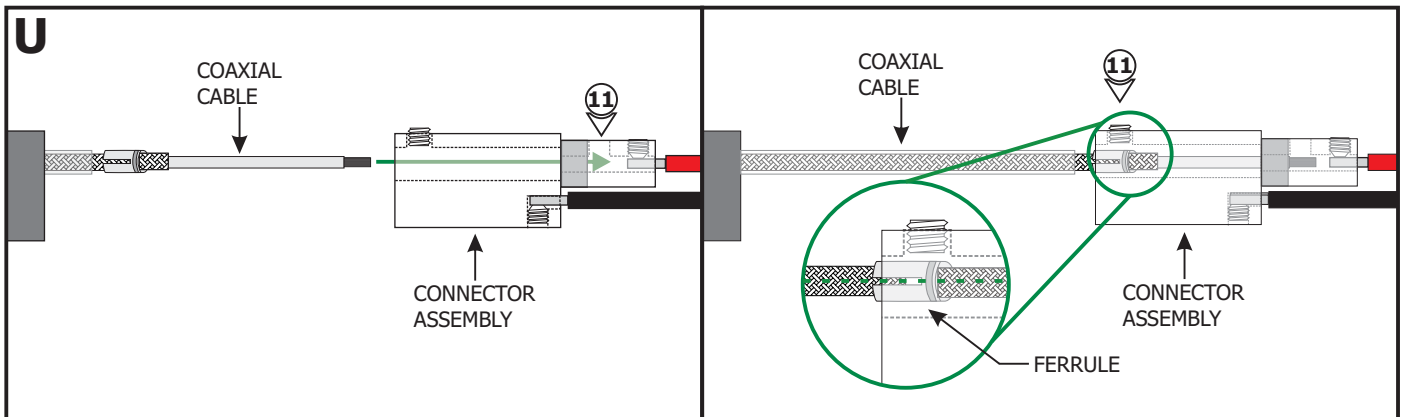

**11:** Insert the coaxial cable into the coaxial connector until the wires of the center conductor are visible through the M3 set screw hole.

**NOTE:** Ensure that the split in the ferrule is aligned 90° from the M4 set screw (see inset).

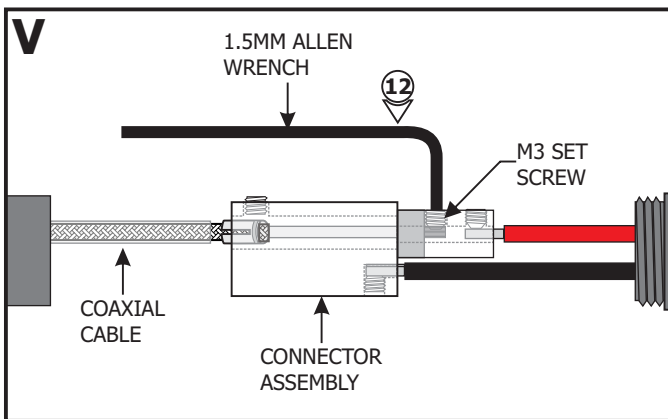

**12:** Use the provided 1.5mm Allen wrench to replace and securely tighten the M3 set screw.

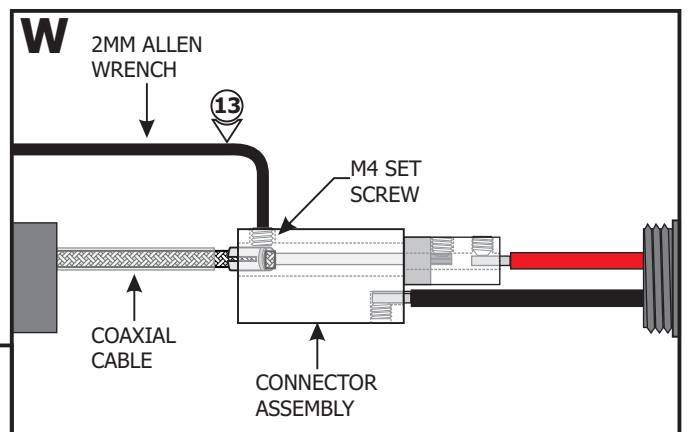

**13:** Use the provided 2mm Allen wrench to securely tighten the M4 set screw until it squeezes the wire ferrule tightly to the coaxial cable.

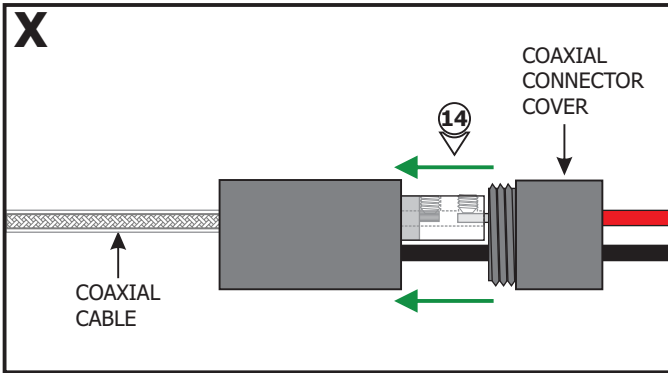

**14:** Replace the coaxial connector cover and tighten into place.

- 15:** Connect the red coaxial connector wire to the +24VDC power supply wire using a wire nut.
- 16:** Connect the black coaxial connector wire to the -24VDC power supply wire using a wire nut.
- 17:** Place all connections inside the junction box.

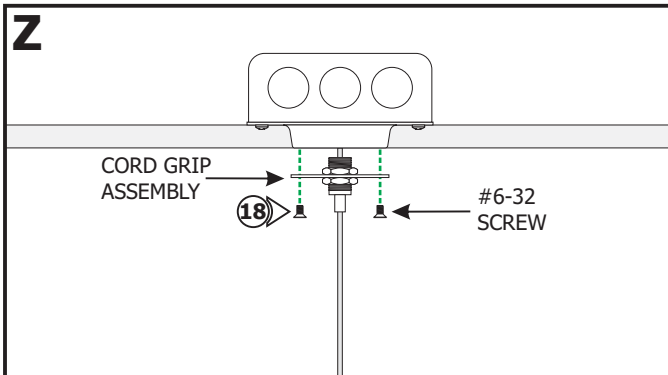
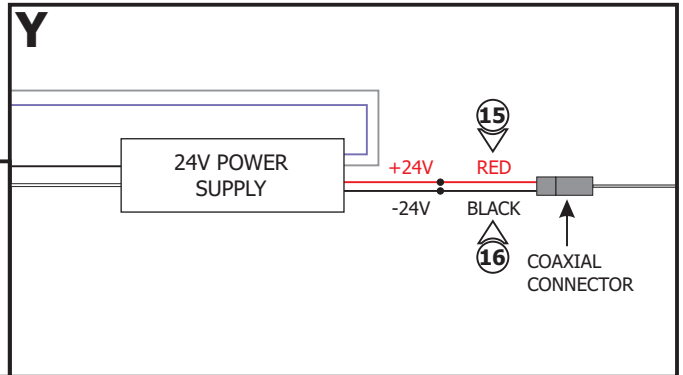

**18:** Mount the cord grip assembly to the 2" plaster ring using two #6-32 screws.

- 19:** Place the canopy over the cord grip against the ceiling. Secure it in place by tightening the knurled nut to the cord grip. **Make sure the knurled cap is not cross threaded.**
- 20:** If necessary, press the tab on the cord grip to adjust the cable height.

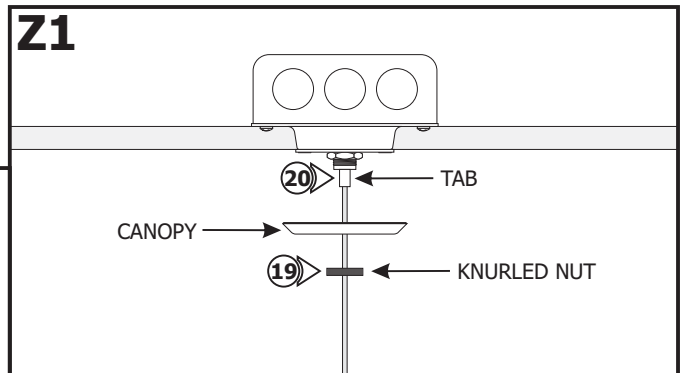

## Section Five: Connecting Channel Sections

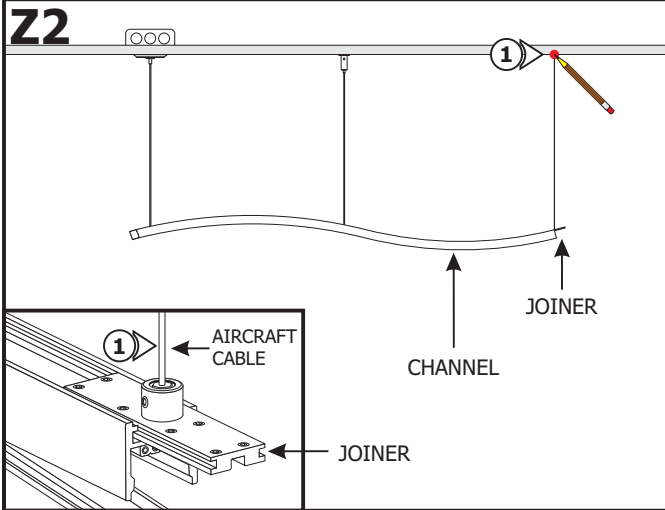

**NOTE:** If applicable, multiple channels must be installed one by one.

**NOTE:** Omit this section if the joiner did not come with the fixture depending on the overall fixture length.

**NOTE:** Omit steps 1 and 2 if the joiner did not come with aircraft cable depending on the overall fixture length.

**1:** Lift the other end of the aircraft cable on the joiner against the ceiling to mark the location of the standoff.

**2:** Refer to Section Three to install the support standoff or support canopy.

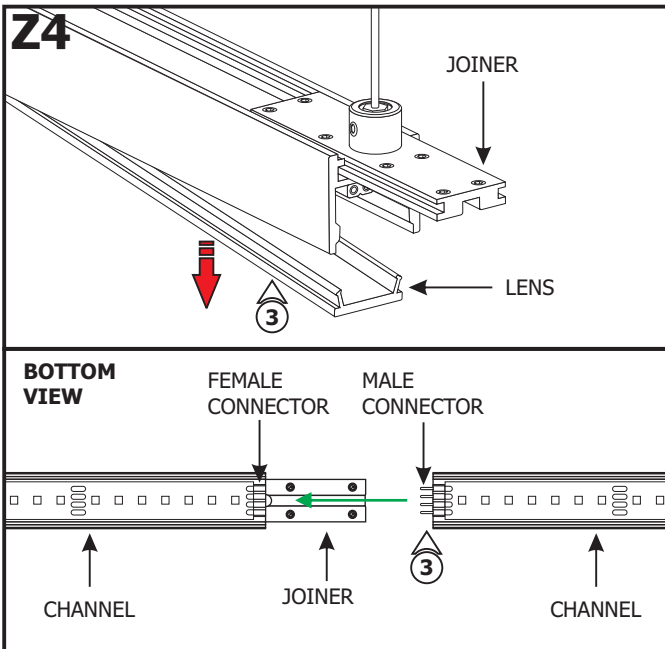
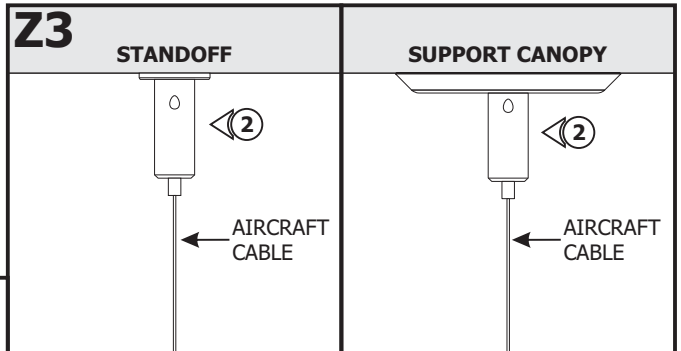

**3:** Lift a section of the lens or louver at the end of the channels where the connectors are visible. Slide the channel over the joiner and ensure the male & female connectors mate properly.

**4:** Push the lens or louver back into the channel.

**5:** Tighten the four #4-40 set screws using the 0.05" Allen wrench.

**6:** Refer to Section Three to install remaining supports.

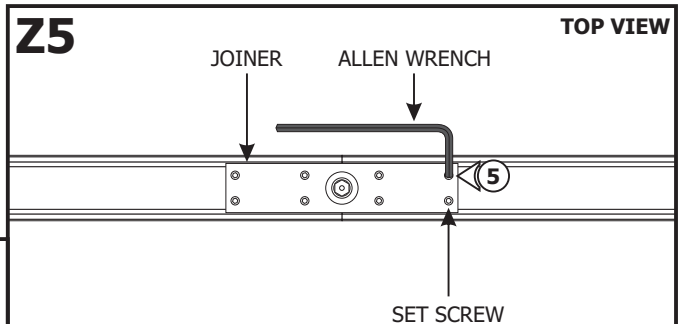



# General Wiring Diagram

