



1718 W. Fullerton Chicago, IL 60614  
 Ph: 773.770.1195 • Fax: 773.935.5613  
 www.PureEdgeLighting.com • info@PureEdgeLighting.com  
 © 2016 PureEdge Lighting. All Rights Reserved.

# Installation Instructions for Zipp Wave Suspension Downlight with Remote Power and 4" Canopy

WSD-4\_\_-\_\_

## IMPORTANT INFORMATION

- This product is suitable for indoor locations.
- This instruction shows a typical installation.
- It is recommended more than one person to assist in this installation.

**SAVE THESE INSTRUCTIONS!**



## Section One: Adjusting Cable Position

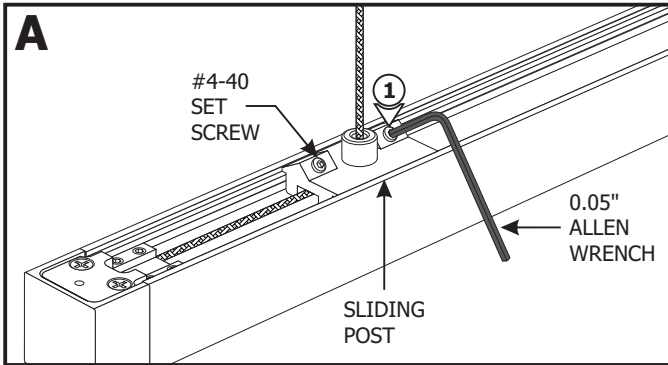

**1:** Loosen (**DO NOT REMOVE**) the two #4-40 set screws on the sliding post with a 0.05" Allen wrench.

**WARNING:** To avoid damaging the coaxial cable electrical connection, make sure that the end of the coaxial cable coming out of the fixture is held with thumb before relocating sliding posts.

**2:** Remove the sliding post from the channel. Carefully rotate and move the sliding post to the predetermined location on the channel.

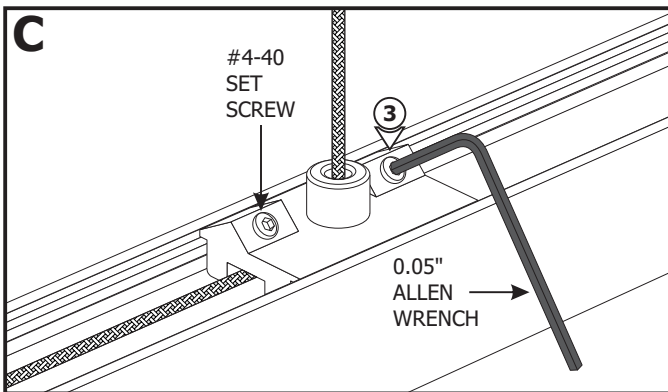
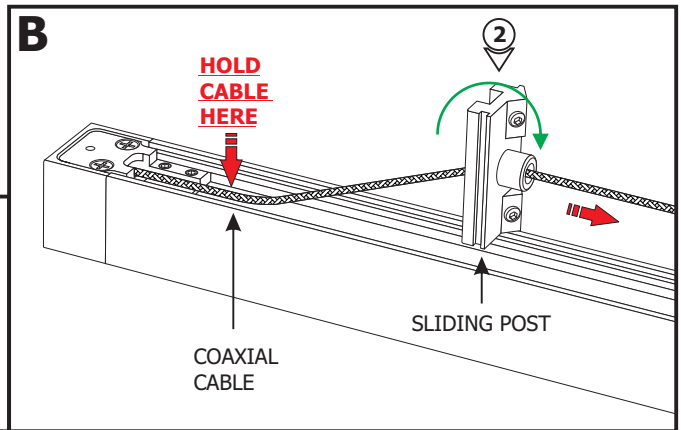

**3:** Place the sliding post back onto the channel and secure it by tightening the two #4-40 set screws with the 0.05" Allen wrench.

**4:** Repeat Steps 1 through 3 for aircraft cables.

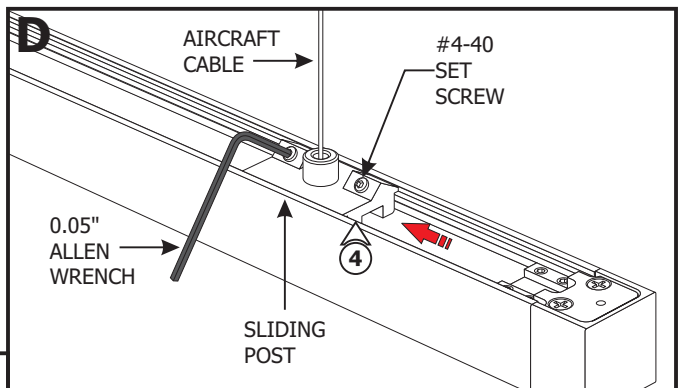

## Section Two: Install the Standoff or Support Canopy

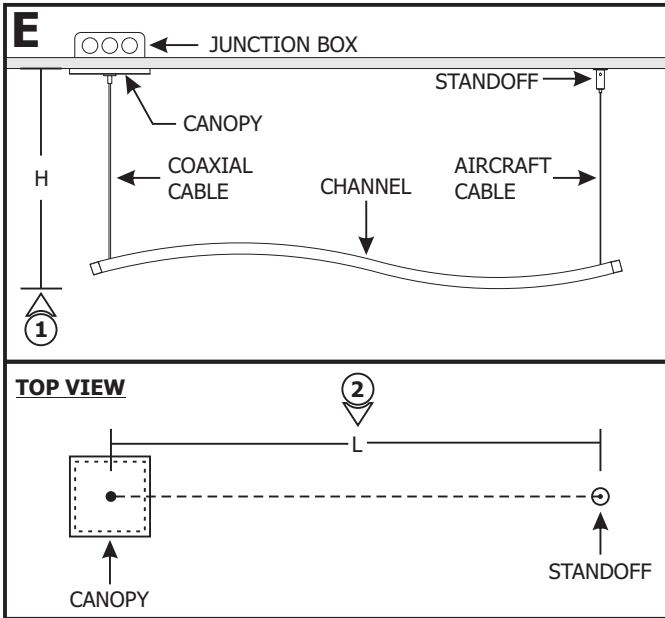

**NOTE:** Run the proper size wires between the 24VDC power supply to the electrical box. Refer to the instructions provided with the power supply for additional information.

**NOTE:** Omit Section Four if the channel is made out of a single piece.

**1:** Determine the fixture height (H) from the bottom of the channel to the top of the canopy.

**2:** Determine the fixture length (L). Measure the distance between the coaxial cable and the aircraft cable on the channel. Mark the standoff location on the ceiling from the center of the junction box.

**NOTE:** Omit steps 3 through 10 if using support canopy. Refer to steps 11 through 18.

**NOTE:** Steps 3 and 4 are for drywall mounting. Omit these steps if mounting directly to a wood surface.

### Support Standoff:

**3:** Tap the anchor onto the marked point up to the threaded portion with a hammer.

**4:** Screw in the threaded portion of the anchor with a Phillips screwdriver.

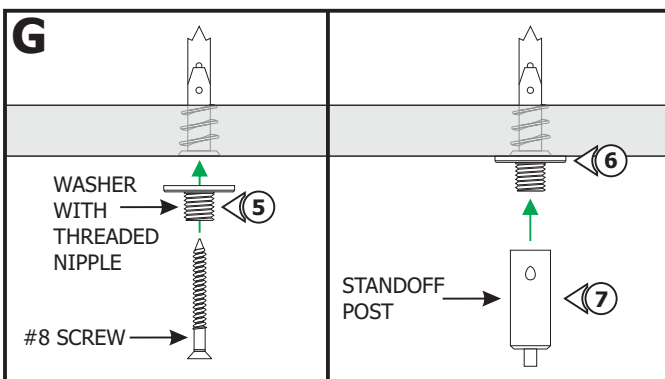
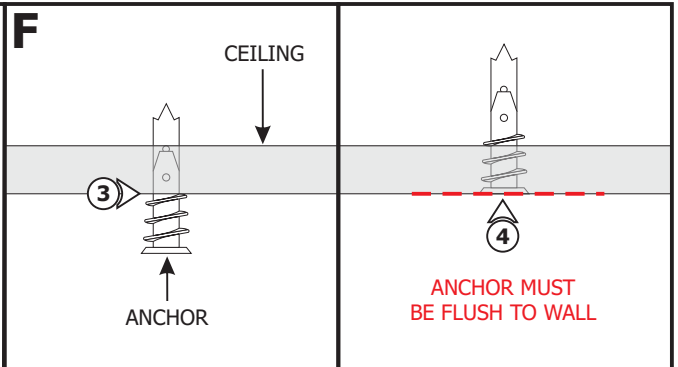

**5:** Feed the #8 screw through the washer with threaded nipple into the anchor.

**6:** Tighten the #8 screw completely into the anchor.

**7:** Tighten the standoff post completely onto the threaded nipple.

**8:** Feed the aircraft cable coming from the channel through the standoff post.

**9:** Adjust the fixture height by pushing the tab and pulling the aircraft cable out of the side of the standoff post. Release the tab to secure the cable in place.

**10:** If necessary, trim excess aircraft cable using sharp cutters.

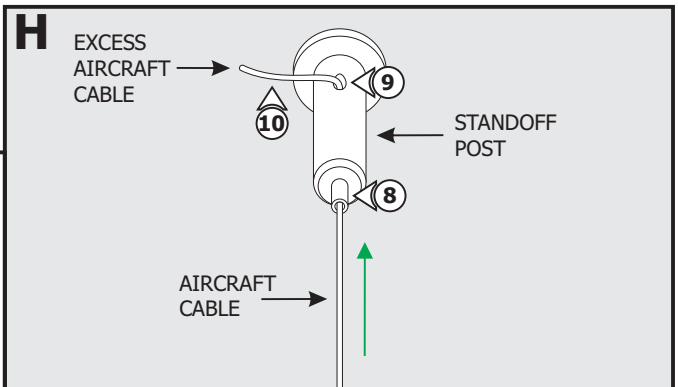

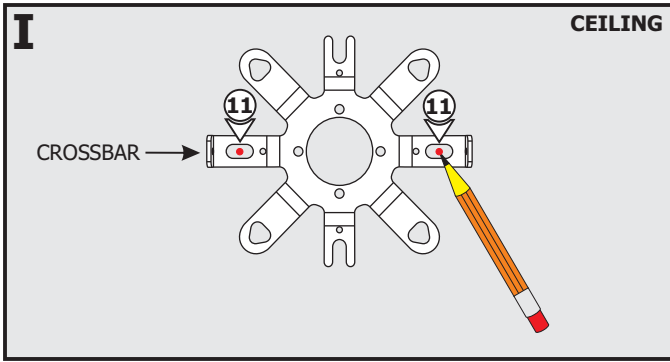

**Support Canopy:**

**11:** Mark two points through the crossbar holes onto the ceiling.

**NOTE:** Steps 12 and 13 are for drywall mounting. Omit these steps if mounting onto a wood surface directly.

**12:** Tap the anchors onto the marked points up to the threaded portion with a hammer.

**13:** Screw in the threaded portion of the anchors with a Phillips screwdriver.

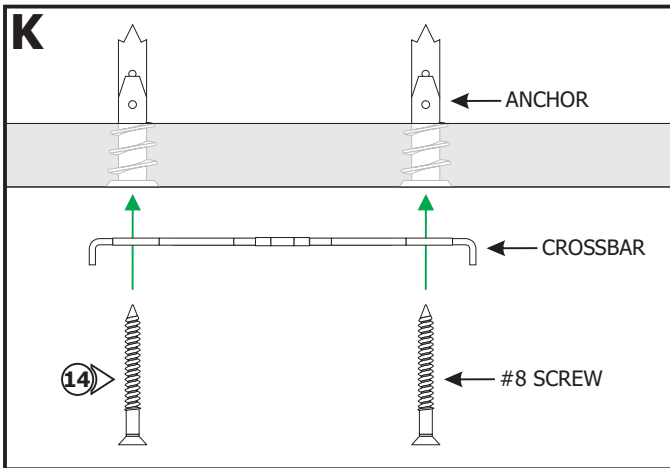
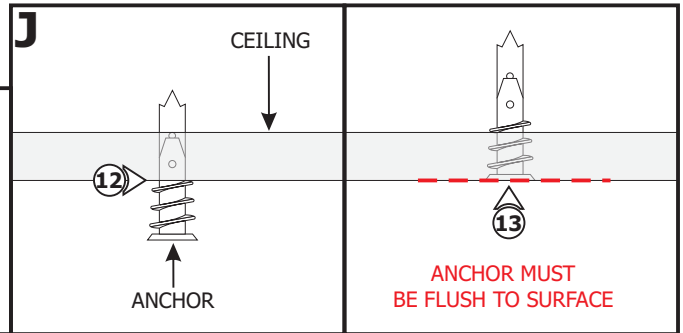

**14:** Secure the crossbar to the anchors using the two #8 screws.

**15:** Align the canopy with the crossbar and secure it using the two #4-40 screws using a 1/16" Allen wrench.

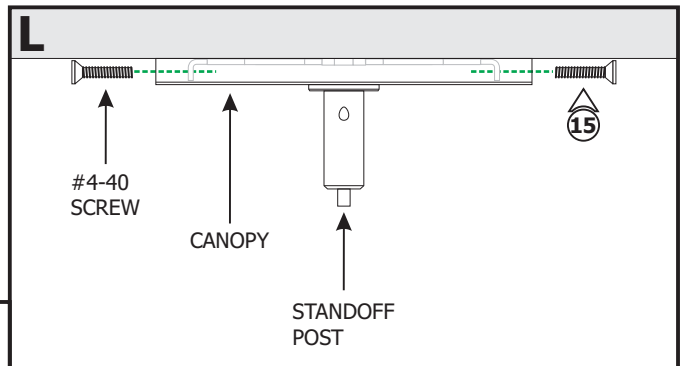

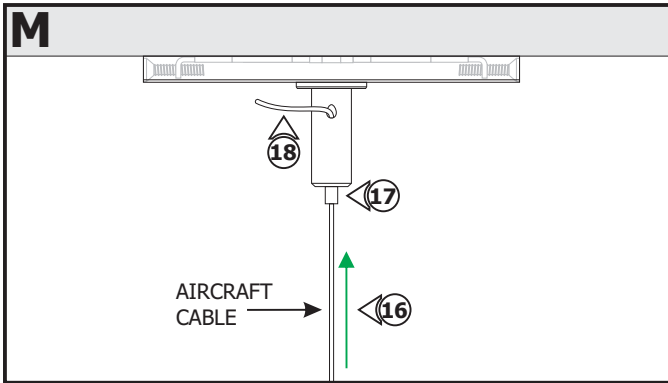

- 16:** Feed the aircraft cable coming from the channel through the standoff post.
- 17:** Adjust the fixture height by pushing the tab and pulling the aircraft cable out of the side of the standoff post. Release the tab to secure the cable in place.
- 18:** If necessary, trim excess aircraft cable using sharp cutters.

**NOTE:** Support cables are provided in the middle of the channels if the fixture is 60" and longer.

#### Additional Support

- 19:** If necessary, loosen the #4-40 set screws using a 0.05" Allen wrench and adjust the location of the post on the channel. Tighten the set screws to secure in place.
- 20:** Lift the end of the aircraft cable coming from the sliding post against the ceiling to mark the location of the standoff or support canopy.
- 21:** Refer to the steps 3 through 18 to install the Support Standoff or Support Canopy.

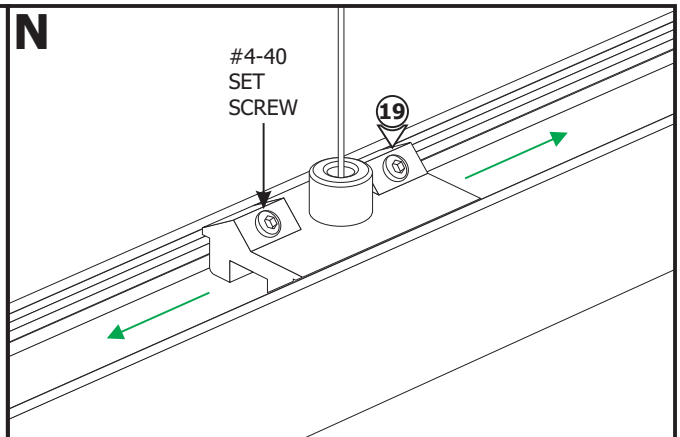

## Section Three: Power the Fixture

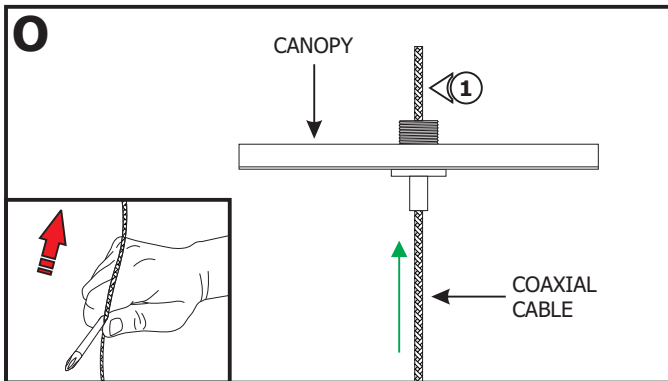

- 1:** Feed the coaxial cable through the canopy.
- 2:** Adjust the fixture height by pushing the cord grip tab to slide the cable up and down until the desired height is achieved. Release the tab to lock the cable in place.

**NOTE:** If cable is curled or kinked, straighten by holding between the shaft of a screwdriver and thumb and pulling the cable through (see inset).



**NOTE:** Scan the QR Code to watch the video clip of the following steps or visit [www.PureEdgeLighting.com/video\\_feed/installation\\_cxc\\_connector](http://www.PureEdgeLighting.com/video_feed/installation_cxc_connector)

- 3:** Use the 18AWG hole of the wire stripper to remove 1-3/8" of the outer insulation to expose the braided wire.
- 4:** Use the 18AWG hole of the wire stripper to remove 1" of the braided wire making sure not to nick the inner wire insulation.
- 5:** Use the 20AWG hole of the wire stripper to remove 1/8" of the inner insulated wire.

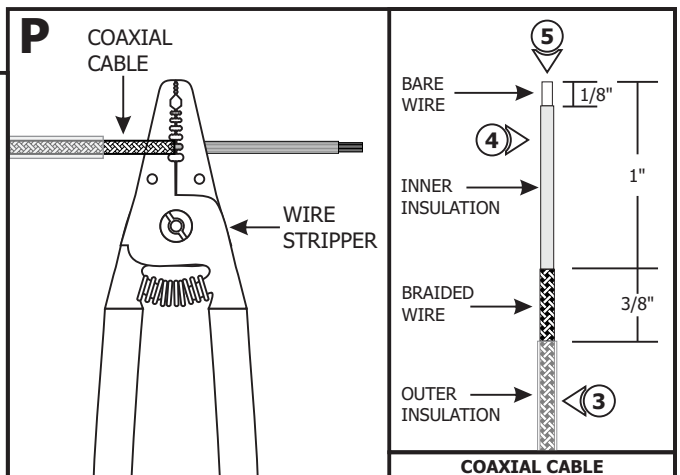

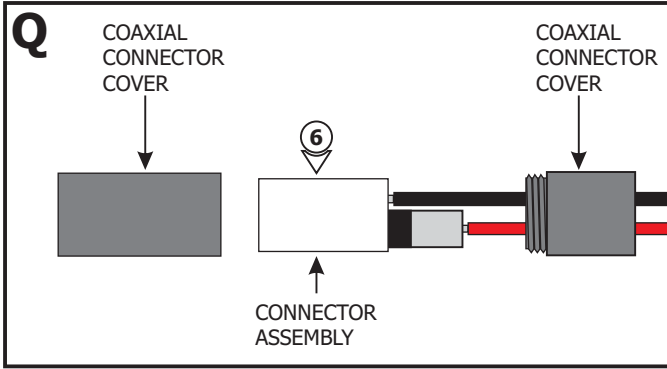

**6:** Unscrew the coaxial connector covers and remove from the connector assembly.

**7:** Using the provided 1.5mm Allen wrench, remove the M3 set screw from the coaxial connector assembly.

**8:** Using the provided 2mm Allen wrench to loosen (**Do Not Remove**) the M4 set screw.

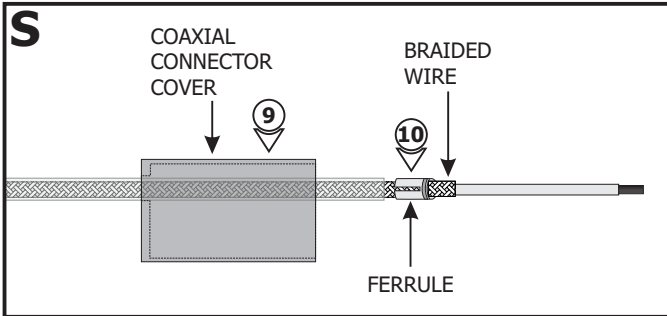
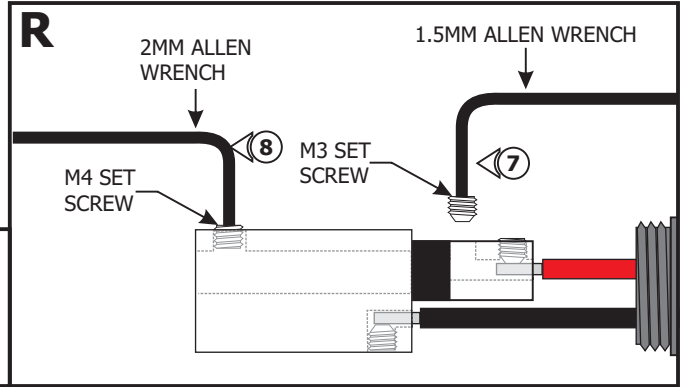

**9:** Slide the connector cover over the coaxial cable.

**10:** Place the ferrule over the 3/8" braided wire of the coaxial cable.

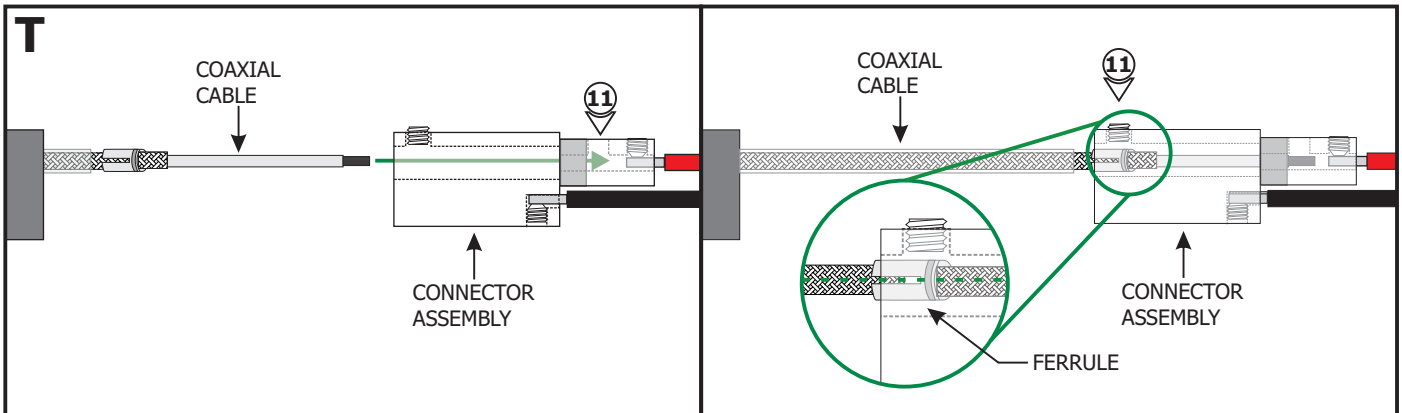

**11:** Insert the coaxial cable into the coaxial connector until the wires of the center conductor are visible through the M3 set screw hole.

**NOTE:** Ensure that the split in the ferrule is aligned 90° from the M4 set screw (see inset).

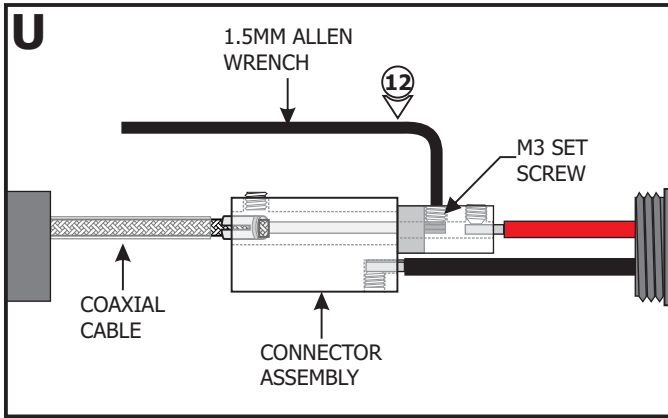

**12:** Use the provided 1.5mm Allen wrench to replace and securely tighten the M3 set screw.

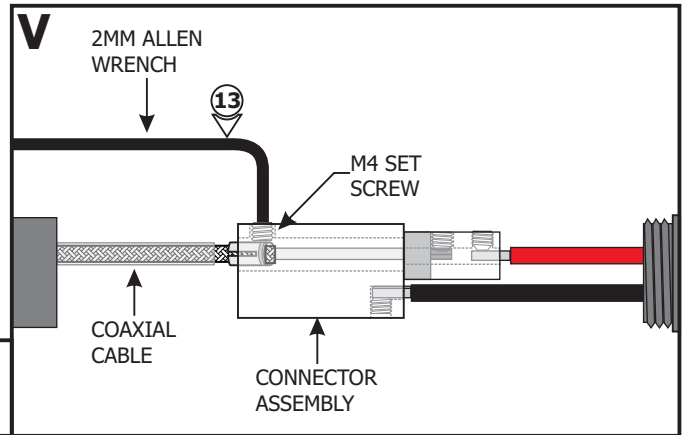

**13:** Use the provided 2mm Allen wrench to securely tighten the M4 set screw until it squeezes the wire ferrule tightly to the coaxial cable.

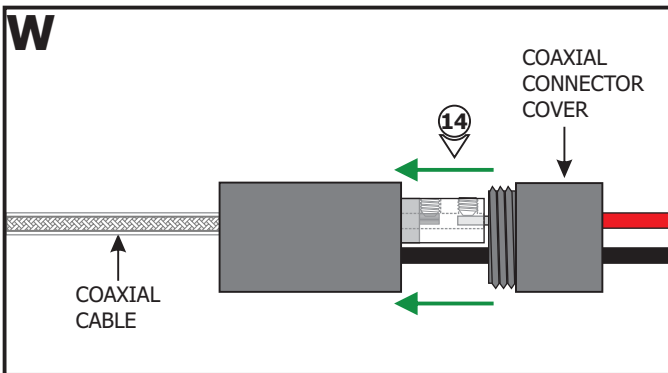

**14:** Replace the coaxial connector cover and tighten into place.

**NOTE:** Ensure remote power supply wires are present in the junction box. Refer to instructions provided with the power supply.

**15:** Feed the low voltage 24VDC wires from the power supply through the crossbar center hole.

**16:** Mount the crossbar to the junction box holes with two #8-32 screws.

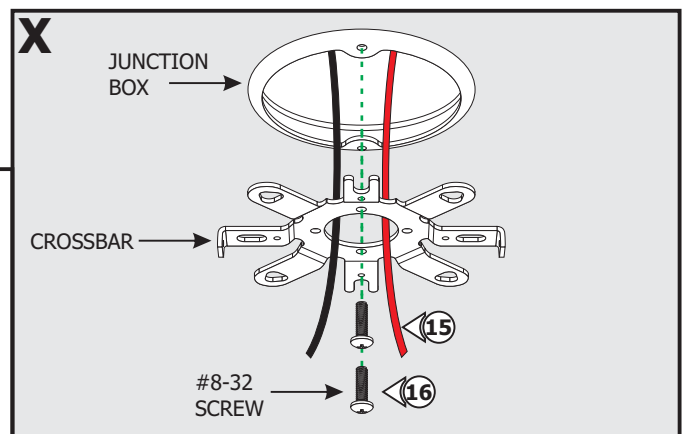

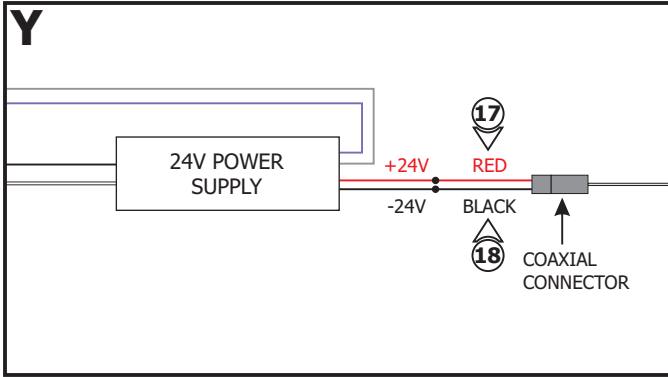

**17:** Connect the red coaxial connector wire to the +24VDC power supply wire using a wire nut.

**18:** Connect the black coaxial connector wire to the -24VDC power supply wire using a wire nut.

**19:** Place all connections inside the junction box.

**20:** Align the canopy with the crossbar and secure it using the two #4-40 screws using a 1/16" Allen wrench.

**21:** If necessary, press the tab on the cord grip to adjust the cable height.

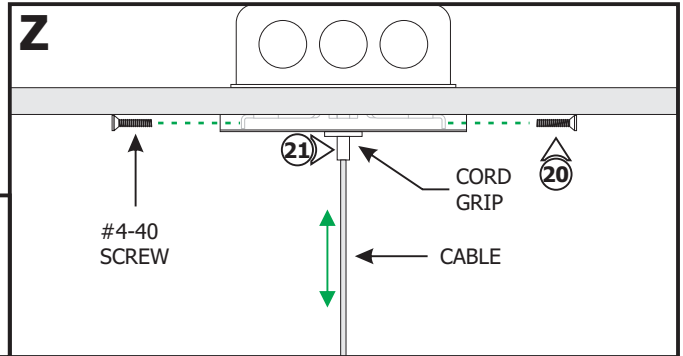

## Section Four: Connecting Channel Sections

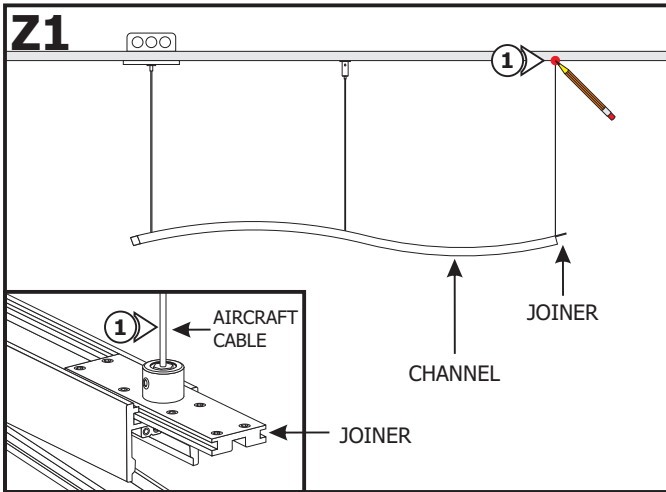

**NOTE:** If applicable, multiple channels must be installed one by one.

**NOTE:** Omit this section if the joiner did not come with the fixture depending on the overall fixture length.

**NOTE:** Omit steps 1 and 2 if the joiner did not come with aircraft cable depending on the overall fixture length.

**1:** Lift the other end of the aircraft cable on the joiner against the ceiling to mark the location of the standoff.

**2:** Refer to Section Two to install the support standoff or support canopy.

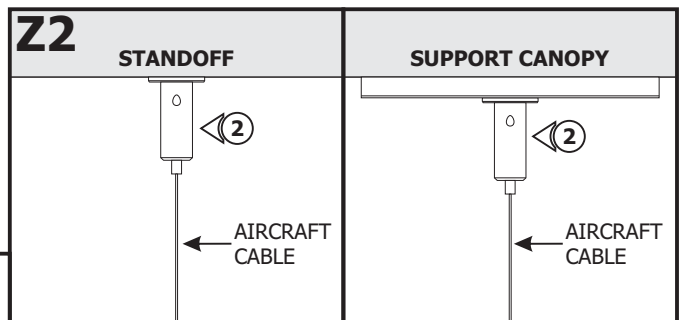

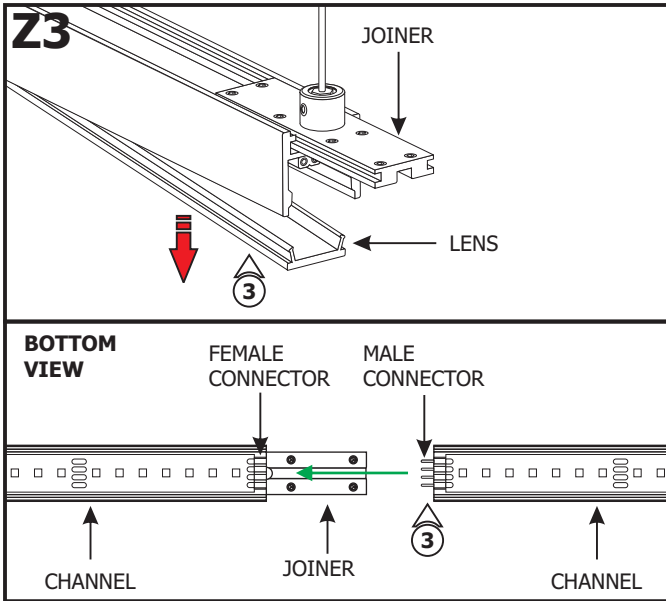

**3:** Lift a section of the lens or louver at the end of the channels where the connectors are visible. Slide the channel over the joiner and ensure the male & female connectors mate properly.

**4:** Push the lens or louver back into the channel.

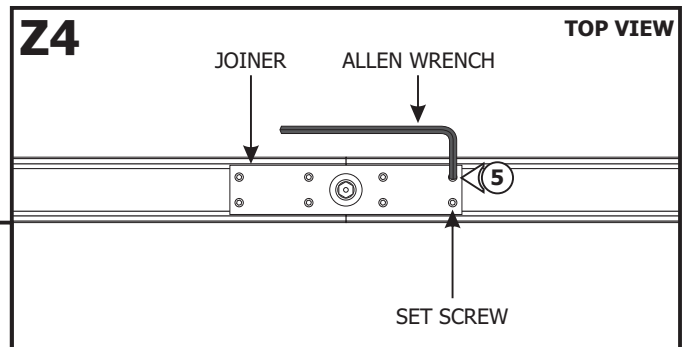

**5:** Tighten the four #4-40 set screws using the 0.05" Allen wrench.

**6:** Refer to Section Two to install remaining supports.

## General Wiring Diagram

