

Assembly and Installation Instructions for Model's

501050DW

CAUTION - RISK OF FIRE

Installation of this fixture should be done by a licensed electrician or by a person familiar with local electrical codes and the construction and operation of this fixture.

Warning please make sure the electrical breaker is shut off before commencing with this installation

Package Contents		
Part	Description	
A	Mounting bracket	1
B	Mounting bracket screws	2
C	Electrical connectors	3
D	Fixture assembly	1
E	Allen screws	2
F	Washers	5
G	Allen key	1
H	Fixture mounting screws	3
I	Curved shade	1

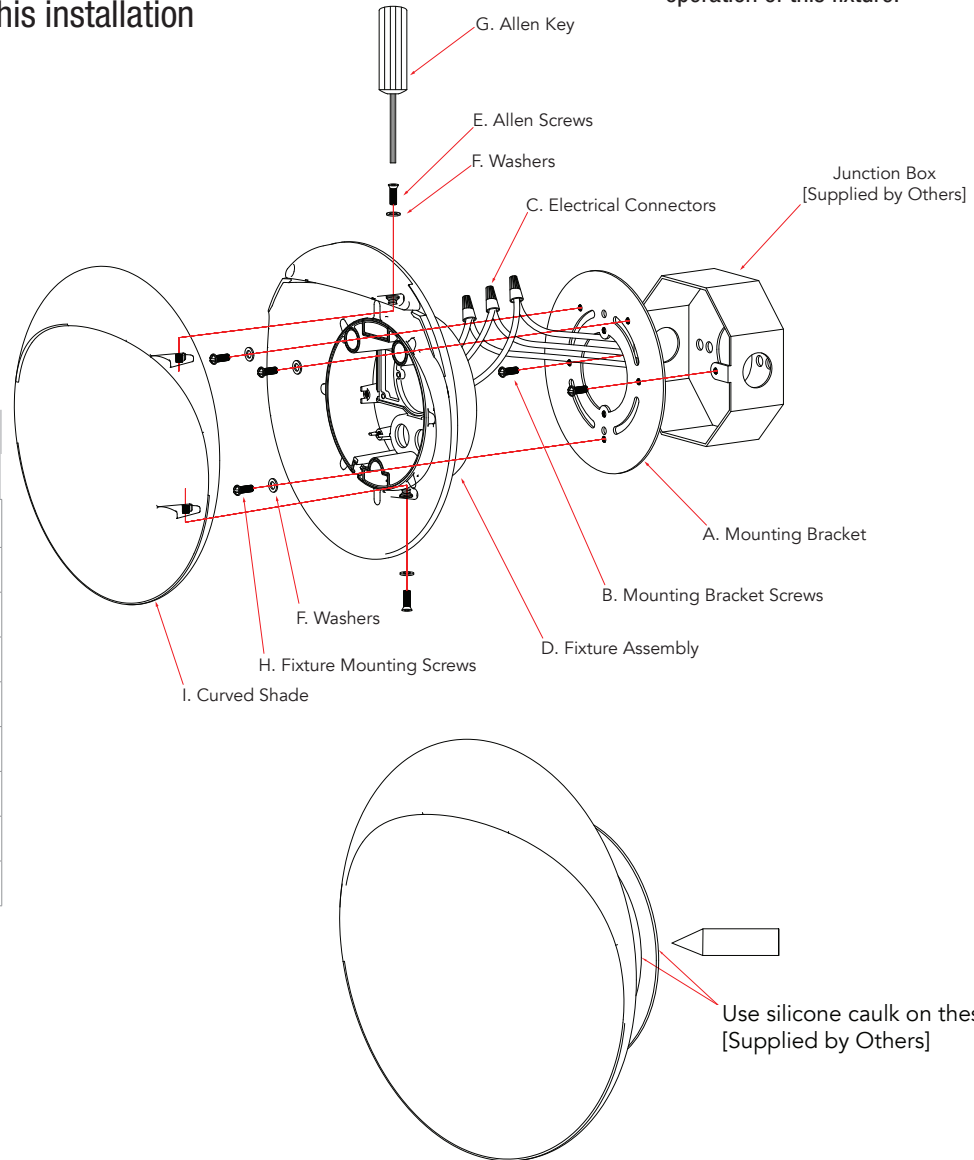

Use silicone caulk on these two areas
[Supplied by Others]

Installing the fixture

please ensure the electrical breaker is in the Off position before commencing

- 1 Attach the Mounting bracket (**A**) to the Junction Box [Supplied by Others] using the Mounting bracket screws (**B**).
- 2 Connect the supply wires to the fixture wires using the supplied electrical wire connectors (**C**). White supply wire to the White fixture wire, Black supply wire to Black fixture wire and the ground Bare Copper or Green wire to the Green fixture wire. Once the electrical wire connectors are securely fastened it is recommended to tape these connectors with electrical tape.
- 3 Attach the Fixture assembly (**D**) to the Mounting bracket (**A**) using the Fixture mounting screws (**H**) and 3 of the Washers (**F**) provided.
- 4 Secure the Curved shade (**I**) to the Fixture assembly (**D**) using the remaining Washers (**F**), Allen screws (**E**) and Allen key (**G**) provided.
- 5 Use a waterproof silicon caulk [Supplied by Others] to seal the Fixture.
- 6 Switch on the electrical breaker switch and your new fixture is ready for many years of trouble free use.