

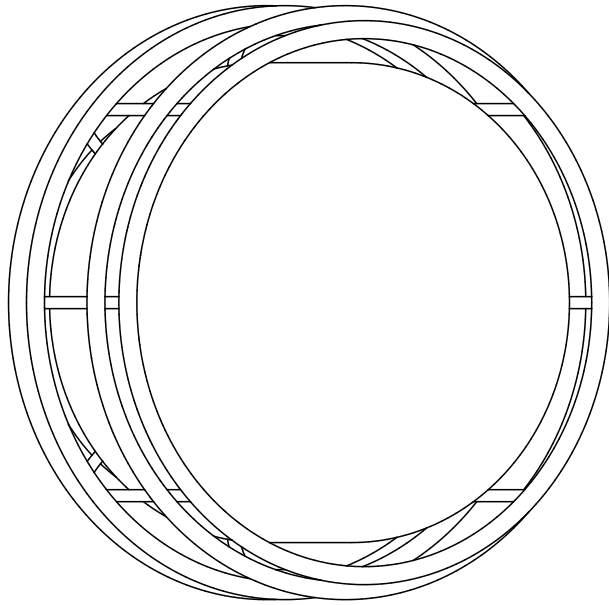

# Cape

19491 rC

Low Voltage Input



## CAUTION:

Before starting, turn off power at main circuit panel.

## ADVERTENCIA:

Antes de comenzar la instalación, apague la corriente en el tablero principal.

## ATTENTION:

Coupez l'alimentation avant de procéder à l'installation.



Calling for backup? Scan above to contact our team.

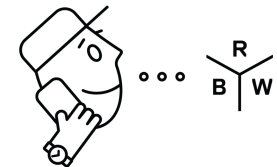

[www.RBW.com](http://www.RBW.com)  
+1 212 388 0399  
[support@RBW.com](mailto:support@RBW.com)  
© 2023, RBW Studio LLC

## What's Included: Part Configurations May Vary

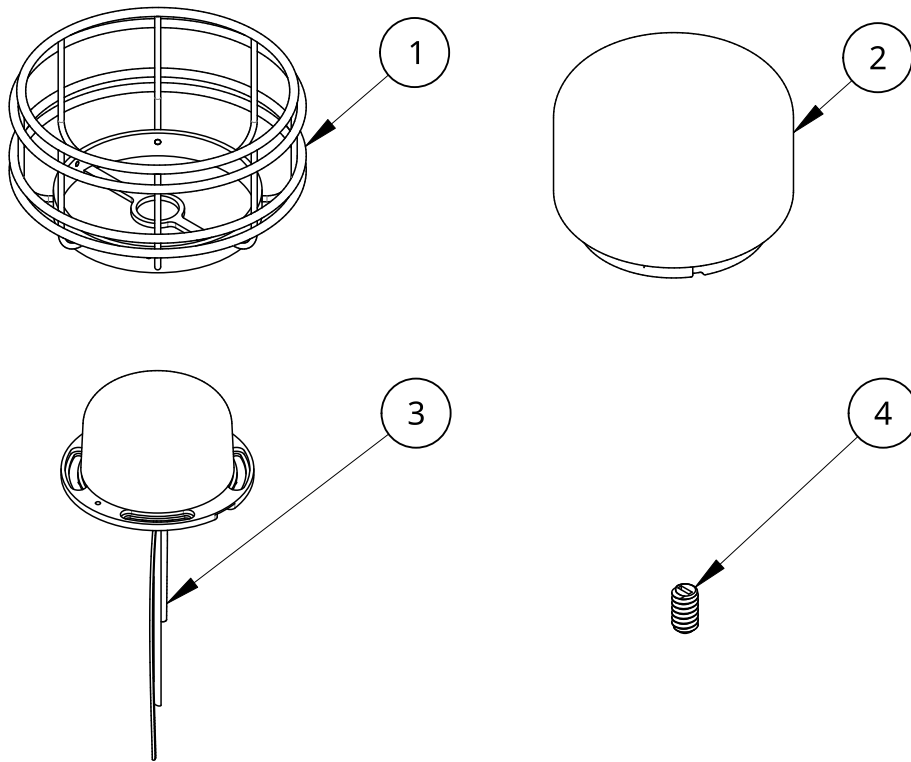

Item	Qty	Part number	Description
1	1	19102-PC94	Package: Cage. Small. Jet Black
2	1	19222	Package: Cape Glass. Small
3	1	19505-27	Package: Cape Sconce LED Module. RBW Standard DC LED. 2700K
4	3	010632G025	#6-32 x 0.25" Nylon Plastic Flat-Tip Slotted Set Screw

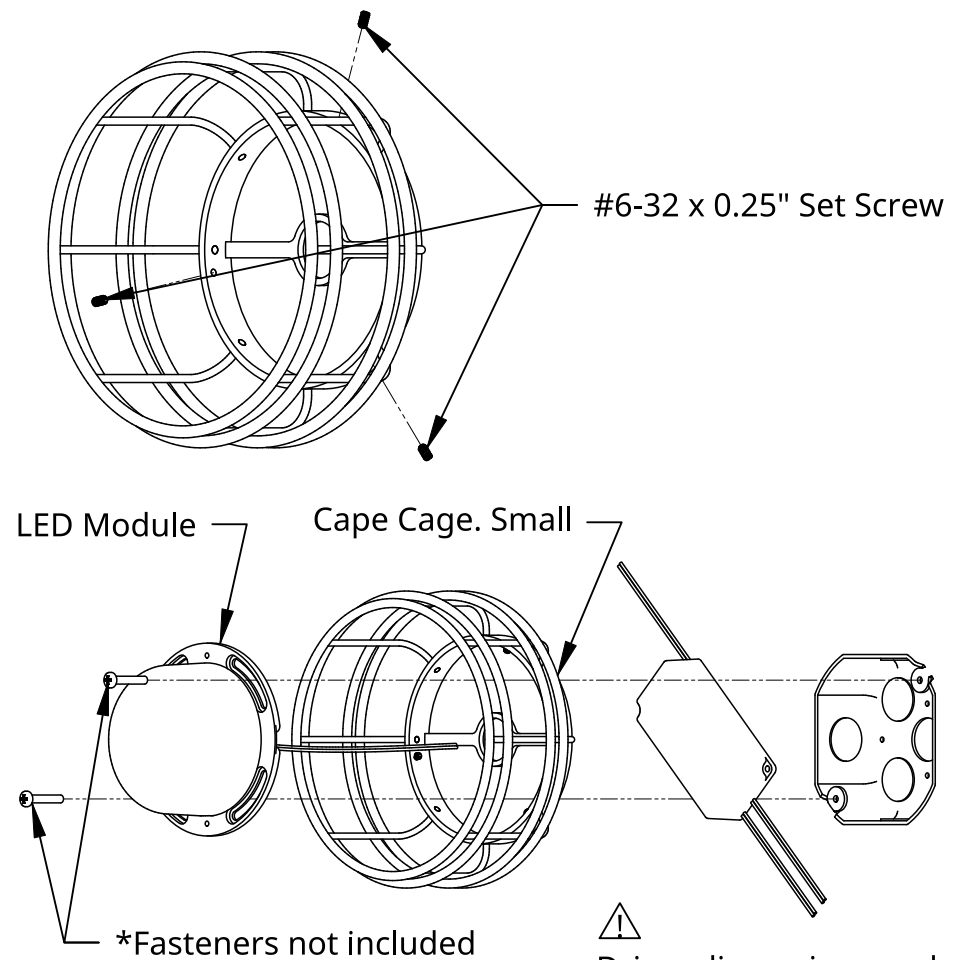

## Installation - Cage and LED Module

1. Partially insert Set Screws into Cage.
2. Connect Red (+) and Black (-) Sconce wires to low voltage leads from externally located driver through center hole of Cage.
3. Seat LED Module onto Cage and fix LED Module Assembly to desired mounting surface with appropriate fasteners.

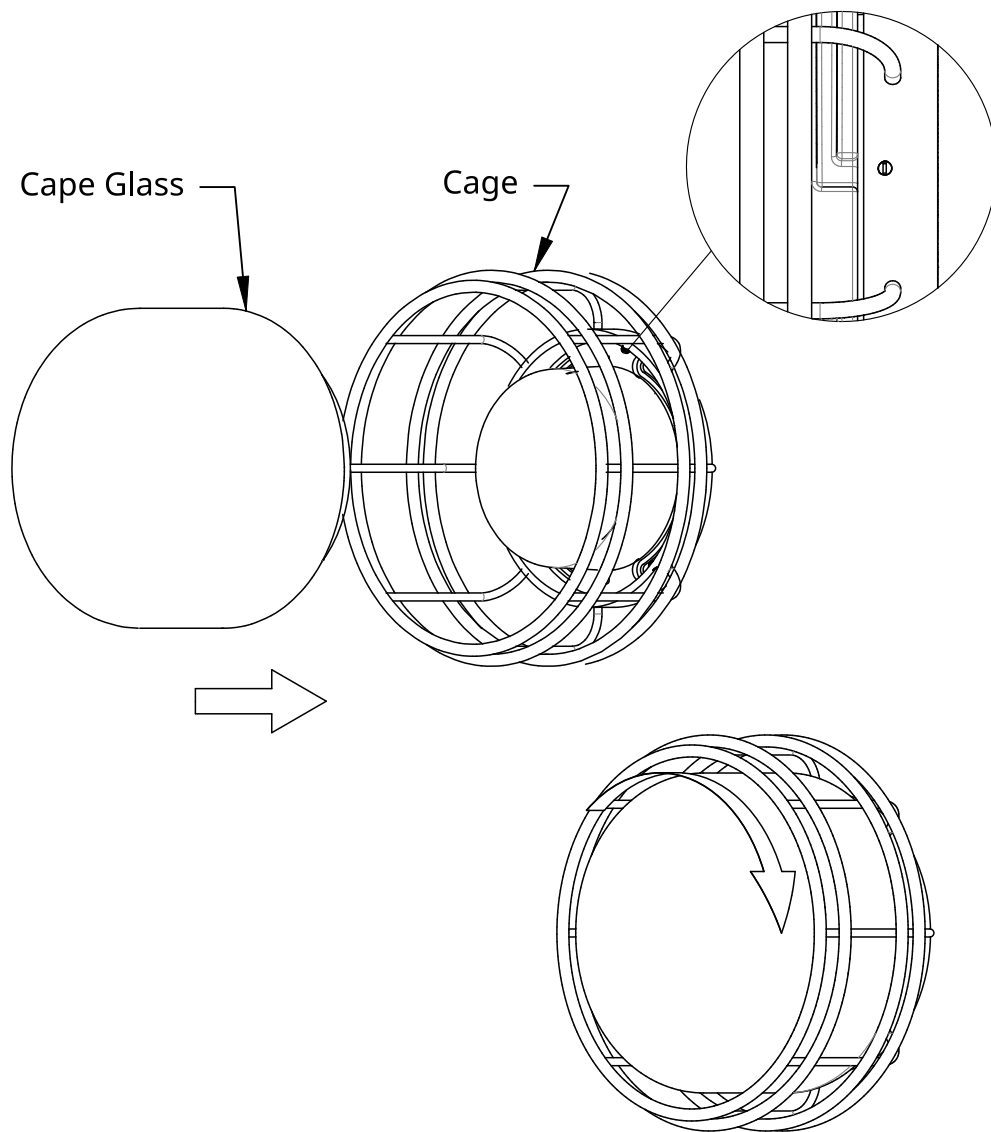

Page Intentionally Left Blank

### Installation - Glass

4. Insert Glass into Cage so Set Screws can enter open channel in Glass.
5. Rotate Glass clockwise no more than 85 degrees and fully tighten all set screws.
6. Set screw depths can be adjusted individually to ensure Glass is centered inside Cage.
7. Congratulations! End of guide.

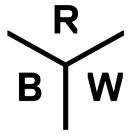

# Cape

19492 rB

AC Input

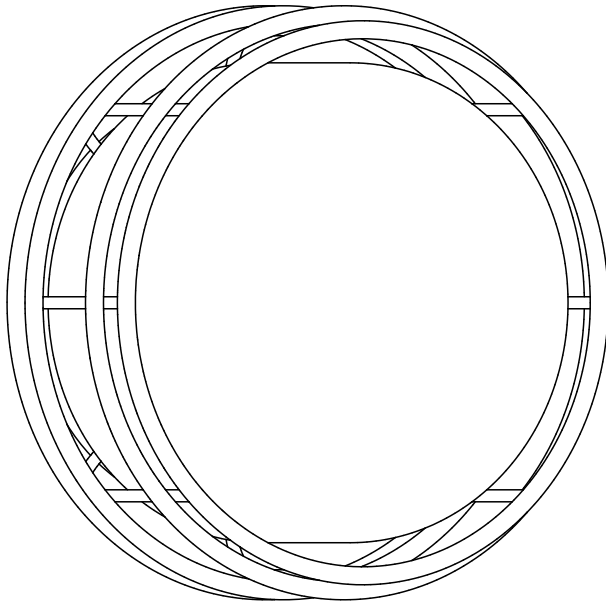

## CAUTION:

Before starting, turn off power at main circuit panel.

## ADVERTENCIA:

Antes de comenzar la instalación, apague la corriente en el tablero principal.

## ATTENTION:

Coupez l'alimentation avant de procéder à l'installation.



Calling for backup? Scan above to contact our team.

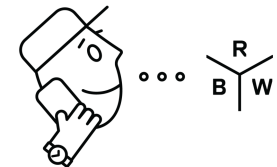
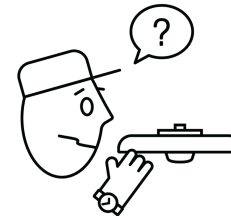

[www.RBW.com](http://www.RBW.com)  
+1 212 388 0399  
[support@RBW.com](mailto:support@RBW.com)  
© 2023, RBW Studio LLC

What's Included: Part Configurations May Vary

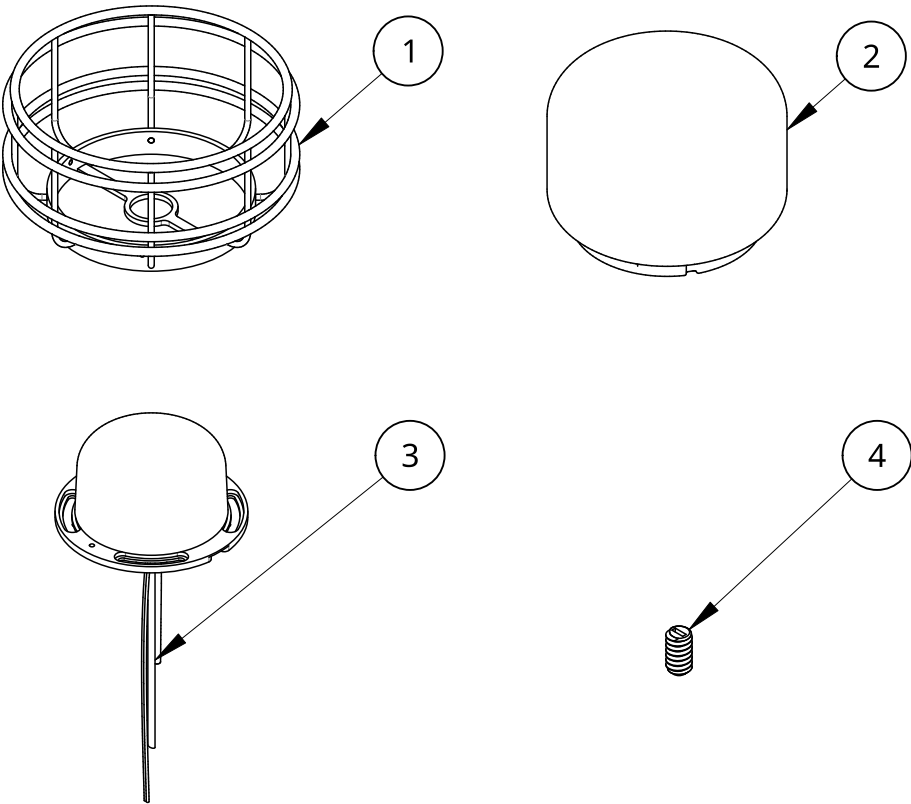

Item	Qty	Part number	Description
1	1	19102-PC94	Package: Cage. Small. Jet Black
2	1	19222	Package: Cape Glass. Small
3	1	19507-27	Package: Cape Sconce LED Module. RBW Standard AC LED. 2700K
4	3	010632G025	#6-32 x 0.25" Nylon Plastic Flat-Tip Slotted Set Screw

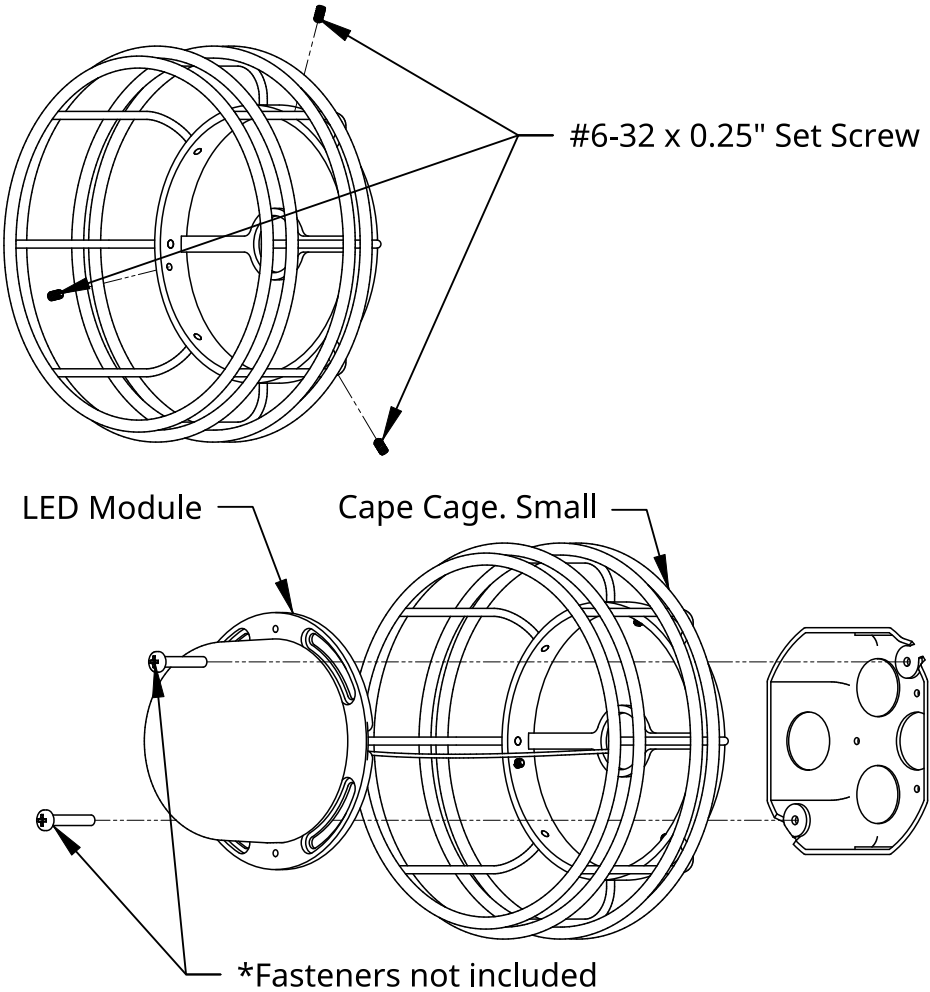

Installation - Cage and LED Module

1. Partially insert Set Screws into Cage.
2. Connect Black (L) and White (N) Sconce wires to power feed, and connect ground strap through center hole of Cage.
3. Seat LED Module onto Cage and fix LED Module Assembly to desired mounting surface with appropriate fasteners.

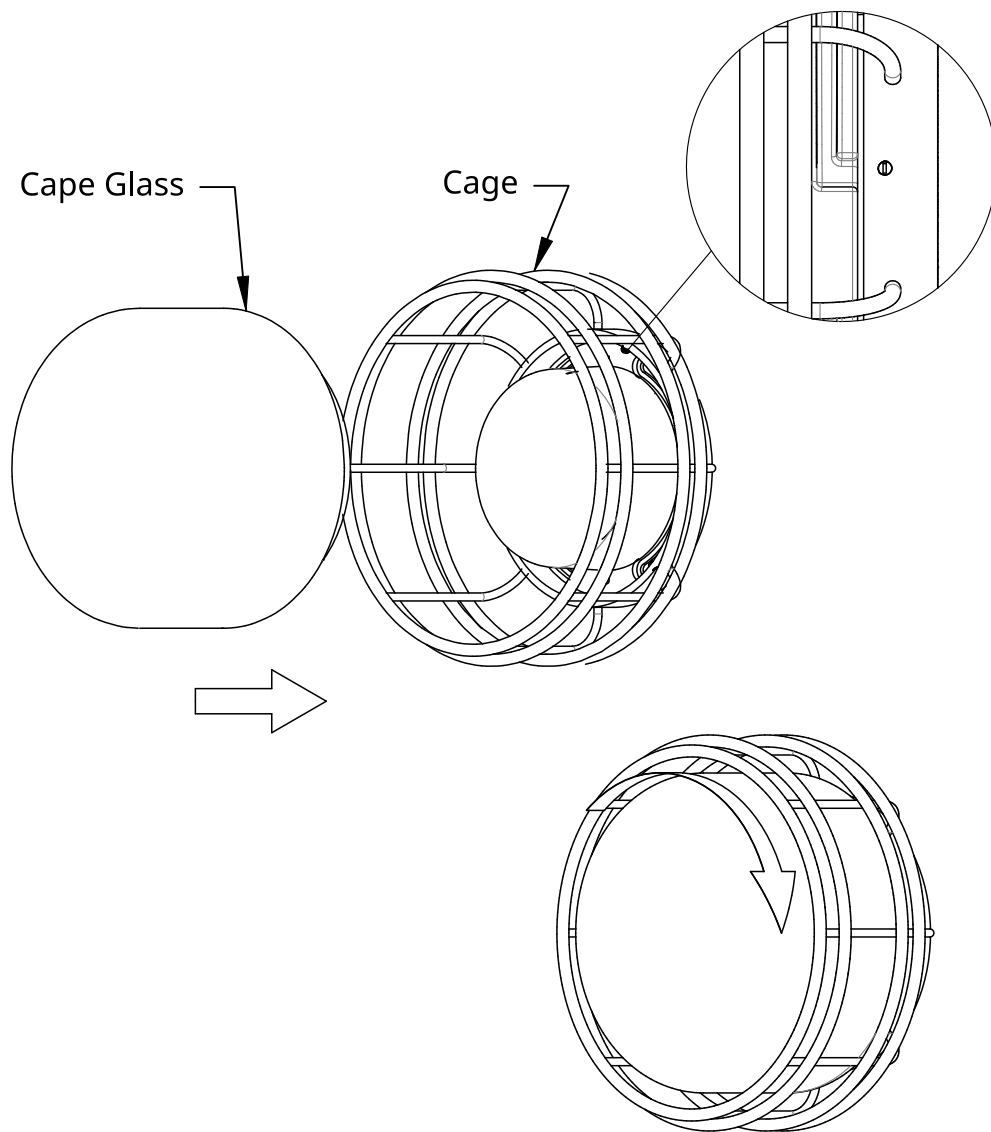

Page Intentionally Left Blank

### Installation - Glass

4. Insert Glass into Cage so Set Screws can enter open channel in Glass.
5. Rotate Glass clockwise no more than 85 degrees and fully tighten all set screws.
6. Set screw depths can be adjusted individually to ensure Glass is centered inside Cage.
7. Congratulations! End of guide.