

# CUBE ARCHITECTURAL DC-WD05

## LED Wall Mounts

# WAC LIGHTING®

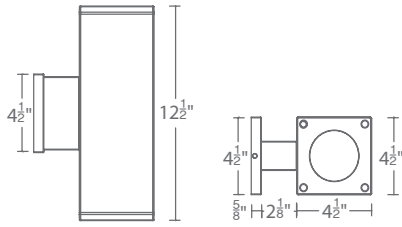

Fixture Type:

Catalog Number:

Project:

Location:

### PRODUCT DESCRIPTION

The latest energy efficient LED technology in an appealing cubical profile delivers accent and wall wash lighting. Comes in various light distribution and beam angle options.

### FEATURES

- Single light extended body high performance exterior rated LED wall mount
- Fixture can install upside down to alter light distribution
- Solid aluminum construction
- 5 year warranty

### SPECIFICATIONS

- Input:** Universal voltage 120V - 277VAC, 50/60Hz
- Dimming:** Electronic low voltage (ELV) : 100% - 5%  
0-10V: 100% - 1%
- Light Source:** High output 3 Step Mac Adam Ellipse COB  
Rated life of 60,000 hours at L70
- Finish:** Electrostatically powder coated, white, black, bronze and graphite
- Standards:** IP65 rated, UL & cUL wet location listed, Title 24 JA8 Compliant
- Operating Temp:** -13°F to 122°F (-25°C to 50°C)

### ORDERING NUMBER

| Diameter  | Watt  | Beam | Beam Angle                | Color | Temp | CRI   | Reference Lumen | Output <sup>1</sup> CBCP | Efficacy (lm/w) | Light Distribution | Finish |  |      |    |  |
|-----------|-------|------|---------------------------|-------|------|-------|-----------------|--------------------------|-----------------|--------------------|--------|--|------|----|--|
| DC-WD05   | 5"    | 25W  | S<br>Straight up and down | 16°   | 927S | 2700K | 90              | 1825                     | 10050           | 73                 |        | <b>BK</b> Black<br><b>WT</b> White<br><b>BZ</b> Bronze<br><b>GH</b> Graphite |      |    |  |
|           |       |      |                           |       | 827S | 2700K | 85              | 2190                     | 12057           | 88                 |        |  |      |    |  |
|           |       |      |                           |       | 930S | 3000K | 90              | 1895                     | 10427           | 76                 |        |  |      |    |  |
|           |       |      |                           |       | 830S | 3000K | 85              | 2300                     | 12644           | 92                 |        |  |      |    |  |
|           |       |      |                           |       | 835S | 3500K | 85              | 2350                     | 12937           | 94                 |        |  |      |    |  |
|           |       |      | 840S                      | 4000K | 85   | 2375  | 13062           | 95                       |                 |                    |        |  |      |    |  |
|           |       |      | DC-WE0517                 | 5"    | 17W  | N     | 25°             | 927S                     | 2700K           | 90                 | 1810   |  | 5280 | 72 |  |
|           |       |      |                           |       |      |       |                 | 827S                     | 2700K           | 85                 | 2170   |  | 6335 | 87 |  |
|           |       |      |                           |       |      |       |                 | 930S                     | 3000K           | 90                 | 1880   |  | 5478 | 75 |  |
|           |       |      |                           |       |      |       |                 | 830S                     | 3000K           | 85                 | 2275   |  | 6643 | 91 |  |
| 835S      | 3500K | 85   |                           |       |      |       |                 | 2330                     | 6797            | 93                 |        |  |      |    |  |
| 840S      | 4000K | 85   | 2350                      | 6863  | 94   |       |                 |                          |                 |                    |        |  |      |    |  |
| DC-WD05   | 5"    | 25W  | F                         | 33°   | 927S | 2700K | 90              | 1900                     | 4515            | 76                 |        |  |      |    |  |
|           |       |      |                           |       | 827S | 2700K | 85              | 2280                     | 5417            | 91                 |        |  |      |    |  |
|           |       |      |                           |       | 930S | 3000K | 90              | 1970                     | 4685            | 79                 |        |  |      |    |  |
|           |       |      |                           |       | 830S | 3000K | 85              | 2390                     | 5681            | 96                 |        |  |      |    |  |
|           |       |      |                           |       | 835S | 3500K | 85              | 2445                     | 5812            | 98                 |        |  |      |    |  |
|           |       |      | 840S                      | 4000K | 85   | 2470  | 5870            | 99                       |                 |                    |        |  |      |    |  |
|           |       |      | DC-WE0517                 | 5"    | 17W  | F     | N/A             | 927A                     | 2700K           | 90                 | 2000   | N/A  | 80   |    |  |
|           |       |      |                           |       |      |       |                 | 827A                     | 2700K           | 85                 | 2400   | N/A  | 96   |    |  |
|           |       |      |                           |       |      |       |                 | 930A                     | 3000K           | 90                 | 2075   | N/A  | 83   |    |  |
|           |       |      |                           |       |      |       |                 | 830A                     | 3000K           | 85                 | 2520   | N/A  | 101  |    |  |
| 835A      | 3500K | 85   |                           |       |      |       |                 | 2575                     | N/A             | 103                |        |  |      |    |  |
| 840A      | 4000K | 85   | 2600                      | N/A   | 104  |       |                 |                          |                 |                    |        |  |      |    |  |
| DC-WE0517 | 5"    | 17W  | F                         | N/A   | 927B | 2700K | 85              | 2000                     | N/A             | 80                 |        |  |      |    |  |
|           |       |      |                           |       | 827B | 2700K | 90              | 2400                     | N/A             | 96                 |        |  |      |    |  |
|           |       |      |                           |       | 930B | 3000K | 85              | 2075                     | N/A             | 83                 |        |  |      |    |  |
|           |       |      |                           |       | 830B | 3000K | 90              | 2520                     | N/A             | 101                |        |  |      |    |  |
|           |       |      |                           |       | 835B | 3500K | 85              | 2575                     | N/A             | 103                |        |  |      |    |  |
| 840B      | 4000K | 85   | 2600                      | N/A   | 104  |       |                 |                          |                 |                    |        |  |      |    |  |

DC-WD05-\_\_\_\_\_ - \_\_\_\_\_

<sup>1</sup>Reference output shows 25W output. Multiply by 0.7 to determine output for 17W combinations

Example: DC-WD05-F930A-WT

wacighting.com

Phone (800) 526.2588

Fax (800) 526.2585

Headquarters, East Manufacturing Facility

44 Harbor Park Drive

Port Washington, NY 11050

South East Manufacturing Facility

1600 Distribution Ct

Lithia Springs, GA 30122

Central Manufacturing Facility

1700 South J Elmer Freeway, Ste 100

Cedar Hill, TX 75104

West Manufacturing Facility

1750 S Archibald Ave

Ontario, CA 91761

# CUBE ARCHITECTURAL DC-WS05

# WAC LIGHTING®

## LED Wall Mounts

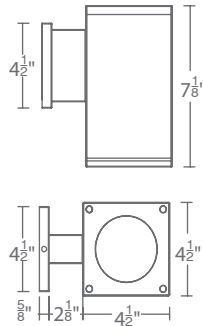

Fixture Type:

Catalog Number:

Project:

Location:

### PRODUCT DESCRIPTION

The latest energy efficient LED technology in an appealing cubical profile delivers accent and wall wash lighting. Comes in various light distribution and beam angle options.

### FEATURES

- High performance exterior rated LED wall mount light
- Fixture can install upside down to alter light distribution
- Solid aluminum construction
- 5 year warranty

### SPECIFICATIONS

|                        |  |
|------------------------|--|
| <b>Input:</b>          | Universal voltage 120V - 277VAC, 50/60Hz                                     |
| <b>Dimming:</b>        | Electronic low voltage (ELV) : 100% - 5%<br>0-10V: 100% - 1%                 |
| <b>Light Source:</b>   | High output 3 Step Mac Adam Ellipse COB<br>Rated life of 60,000 hours at L70 |
| <b>Finish:</b>         | Electrostatically powder coated, white, black, bronze and graphite           |
| <b>Standards:</b>      | IP65 rated, UL & cUL wet location listed,<br>Title 24 JA8 Compliant          |
| <b>Operating Temp:</b> | -13°F to 122°F (-25°C to 50°C)   |

### ORDERING NUMBER

| Diameter  | Watt                  | Beam  | Beam Angle               | Color Temp               | CRI   | Reference Lumen | Output <sup>1</sup> CBCP | Efficacy (lm/w) | Light Distribution | Finish |    |  |  |
|-----------|-----------------------|-------|--------------------------|--------------------------|-------|-----------------|--------------------------|-----------------|--------------------|--------|----|--|--|
| DC-WS05   | 5"                    | 25W   | S<br>Straight up or down | 16°                      | 927S  | 2700K           | 90                       | 1825            | 10050              | 73     |    | <b>BK</b> Black<br><b>WT</b> White<br><b>BZ</b> Bronze<br><b>GH</b> Graphite |  |
|           |                       |       |                          |                          | 827S  | 2700K           | 85                       | 2190            | 12057              | 88     |    |  |  |
|           |                       |       |                          |                          | 930S  | 3000K           | 90                       | 1895            | 10427              | 76     |    |  |  |
|           |                       |       |                          |                          | 830S  | 3000K           | 85                       | 2300            | 12644              | 92     |    |  |  |
|           |                       |       |                          |                          | 835S  | 3500K           | 85                       | 2350            | 12937              | 94     |    |  |  |
|           |                       |       |                          | 840S                     | 4000K | 85              | 2375                     | 13062           | 95                 |        |    |  |  |
|           |                       |       |                          | N<br>Straight up or down | 25°   | 927S            | 2700K                    | 90              | 1810               | 5280   | 72 |  |  |
|           |                       |       |                          |                          | 827S  | 2700K           | 85                       | 2170            | 6335               | 87     |    |  |  |
|           |                       |       |                          |                          | 930S  | 3000K           | 90                       | 1880            | 5478               | 75     |    |  |  |
|           |                       |       |                          |                          | 830S  | 3000K           | 85                       | 2275            | 6643               | 91     |    |  |  |
|           | 835S                  | 3500K | 85                       |                          | 2330  | 6797            | 93                       |                 |                    |        |    |  |  |
|           | 840S                  | 4000K | 85                       | 2350                     | 6863  | 94              |                          |                 |                    |        |    |  |  |
| DC-WS0517 | 5"                    | 17W   | F<br>Straight up or down | 33°                      | 927S  | 2700K           | 90                       | 1900            | 4515               | 76     |    |  |  |
|           |                       |       |                          |                          | 827S  | 2700K           | 85                       | 2280            | 5417               | 91     |    |  |  |
|           |                       |       |                          |                          | 930S  | 3000K           | 90                       | 1970            | 4685               | 79     |    |  |  |
|           |                       |       |                          |                          | 830S  | 3000K           | 85                       | 2390            | 5681               | 96     |    |  |  |
|           |                       |       |                          |                          | 835S  | 3500K           | 85                       | 2445            | 5812               | 98     |    |  |  |
|           |                       |       |                          | 840S                     | 4000K | 85              | 2470                     | 5870            | 99                 |        |    |  |  |
|           |                       |       |                          | F<br>Away from the wall  | N/A   | 927A            | 2700K                    | 90              | 2000               |        | 80 |  |  |
|           |                       |       |                          |                          | 827A  | 2700K           | 85                       | 2400            |                    | 96     |    |  |  |
|           |                       |       |                          |                          | 930A  | 3000K           | 90                       | 2075            | N/A                | 83     |    |  |  |
|           |                       |       |                          |                          | 830A  | 3000K           | 85                       | 2520            |                    | 101    |    |  |  |
|           | 835A                  | 3500K | 85                       |                          | 2575  |                 | 103                      |                 |                    |        |    |  |  |
|           | 840A                  | 4000K | 85                       | 2600                     |       | 104             |                          |                 |                    |        |    |  |  |
|           | F<br>Towards the wall | N/A   | 927B                     | 2700K                    | 90    | 2000            |                          | 80              |                    |        |    |  |  |
|           |                       | 827B  | 2700K                    | 85                       | 2400  |                 | 96                       |                 |                    |        |    |  |  |
|           |                       | 930B  | 3000K                    | 90                       | 2075  | N/A             | 83                       |                 |                    |        |    |  |  |
|           |                       | 830B  | 3000K                    | 85                       | 2520  |                 | 101                      |                 |                    |        |    |  |  |
|           |                       | 835B  | 3500K                    | 85                       | 2575  |                 | 103                      |                 |                    |        |    |  |  |
|           | 840B                  | 4000K | 85                       | 2600                     |       | 104             |                          |                 |                    |        |    |  |  |

DC-WS05-\_\_\_\_\_ - \_\_\_\_\_

<sup>1</sup>Reference output shows 25W output. Multiply by 0.7 to determine output for 17W combinations.

Example: DC-WS05-F930A-WT

wacighting.com

Phone (800) 526.2588

Fax (800) 526.2585

Headquarters, East Manufacturing Facility

44 Harbor Park Drive

Port Washington, NY 11050

South East Manufacturing Facility

1600 Distribution Ct

Lithia Springs, GA 30122

Central Manufacturing Facility

1700 South J Elmer Freeway, Ste 100

Cedar Hill, TX 75104

West Manufacturing Facility

1750 S Archibald Ave

Ontario, CA 91761