



Monorail Canopy Mount LED Kit with 60W 12V electronic transformer includes everything you need for a complete system — just add fixtures. Kit includes electronic 60 watt 12 volt transformer, Monorail, appropriate quantities of 1" standoffs for every 3 feet of rail and 2 pairs of end caps. Fast acting circuit breaker on low voltage side of transformer will shut the system off in case of overload or short and can be easily reset. Satin nickel, polished nickel or antique bronze finish.

Length:

4, 8, 12, 16, 20, 24, 28 or 32 feet
 1.2, 2.4, 3.7, 4.9, 6.1, 7.3, 8.5 or 9.8 meters

Dimming:

With low voltage electronic dimmer - Lutron Diva DVELV-300P recommended

Standard Mounting:

Rail mounts 1" (2.5cm) from ceiling.

Finish:

Satin Nickel, Polished Nickel or Antique Bronze

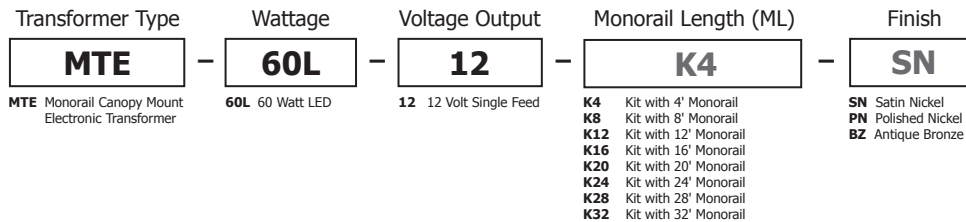
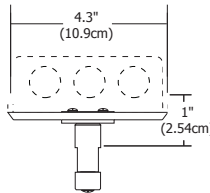

PROJECT: _____ FIXTURE TYPE: _____ DATE: _____