

Instructions:

GrowOn attachment on the wall

For each product purchase: one screw+ raw/ dowel plug for the wall, where you want to hang the product. The screw + raw/ dowel plug has to be selected according to the wall construction and carry the weight of min. 8kg. Make sure that you chose the right type and size of the rawplug. The screw head needs to be bigger than 8mm and have a distance of 15 mm between the plug and the head of the screw

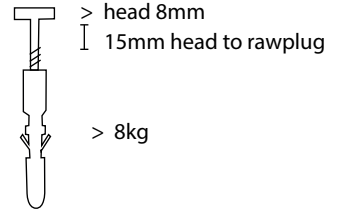

1. Drill a hole in the wall according to the size of the rawplug
2. Place the rawplug inside the hole

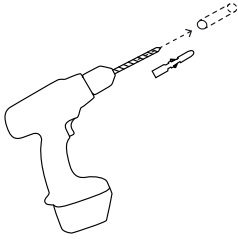

3. Remove the upper plastic container from the SQUARELY product. On the back side there is a pre-made hole.

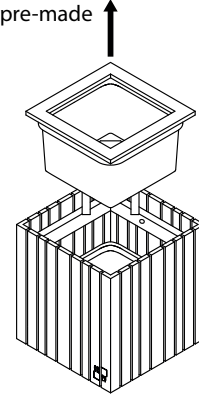

4. Place GrowON on the wall, match the hole in the back side of SQUARELY product with the drilled hole. Place the screw through the hole and further to the raw/ dowel plug.

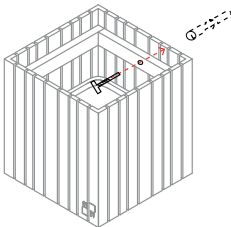

5. Use a drill-driver or a screwdriver to place the length of screw entirely in the rawplug.

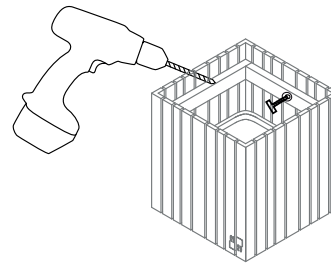

5. Make sure that the product is well fixed to the wall. The screw with the raw-plug needs to carry the weight of min. 8kg.

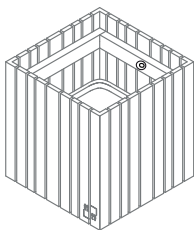

6. Plant the plant in the plastic container and place it in the planter.

