

INSTALLATION INSTRUCTION

AETHER 2" - REMODEL HOUSING

HR-2LED-R10A, HR-2LED-R15A

WAC

SAFETY INSTRUCTION

IMPORTANT: NEVER attempt any work without shutting off the electricity.

- Read all instructions before installing.
- System is intended for installation by a qualified electrician in accordance with the National Electrical Code and local regulations.
- Place the wall switch in the "OFF" position.
- Go to the main fuse box or circuit breaker. Unscrew the fuse(s) or switch "OFF" the circuit breaker switch(es) that control the power to the space that you are working on.

CAUTION:

All parts must be used as indicated in these instructions. Do not substitute any parts, leave parts out, or use any parts that are worn out or broken. Failure to follow these instructions could invalidate the UL/cUL listing of this fixture.

AVERTISSEMENT:

IMPORTANT : COUPEZ L'ÉLECTRICITÉ AVANT TOUTE MANIPULATION.

- Lisez toutes les instructions avant d'installer.
- Système est destiné à être installé par un électricien qualifié en conformité avec le code national de l'électricité et les règlements locaux.
- Placez l'interrupteur mural en position d'arrêt (« OFF »).
- Accédez au panneau central de disjoncteurs ou de fusibles de votre demeure et placez l'interrupteur principal en position d'arrêt (« OFF »).

MISE EN GARDE:

Toutes les pièces doivent être utilisées tel qu'il est indiqué dans ces instructions. Ne remplacez pas les pièces, n'en laissez pas de côté et ne les utilisez pas si elles sont usées ou brisées. Le non-respect de ces instructions peut annuler l'homologation UL/cUL du luminaire.

OVERVIEW:

This housing is new construction IC Rated and Airtight. Housing requires a trim for finished look. Refer to specification sheets for compatible trim options.

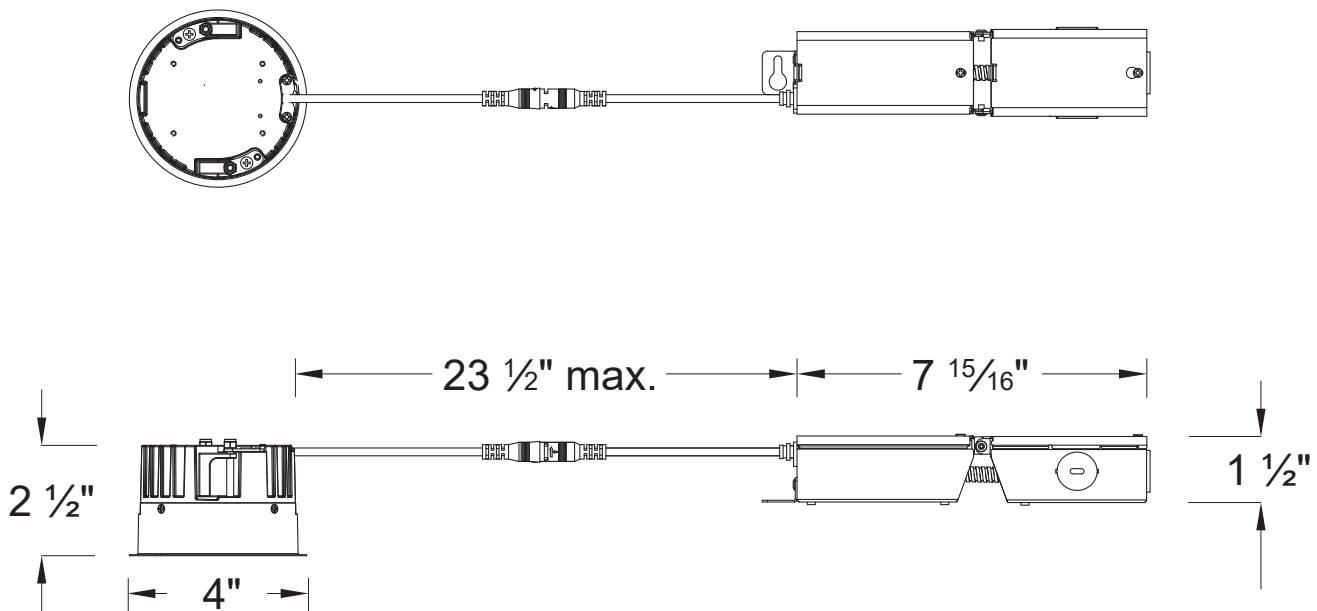

wacighting.com
Phone (800) 526.2588
Fax (800) 526.2585

Headquarters, East Manufacturing Facility
44 Harbor Park Drive
Port Washington, NY 11050

South East Manufacturing Facility
1600 Distribution Ct
Lithia Springs, GA 30122

Central Manufacturing Facility
1700 South J Elmer Freeway, Ste 100
Cedar Hill, TX 75104

West Manufacturing Facility
1750 S Archibald Ave
Ontario, CA 91761

INSTALLATION INSTRUCTION

AETHER 2" - REMODEL HOUSING

HR-2LED-R10A, HR-2LED-R15A

WAC

REMODEL HOUSING INSTALLATION:

1. At the point of installation, cut a 3-³/₄" round hole (See **FIG.1**)

FIG. 1

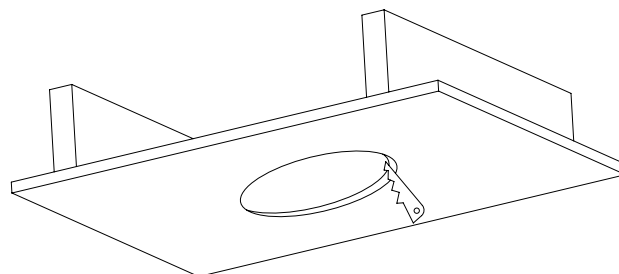

Cutout: 3-³/₄" Dia.

2. Pull building supply wires through ceiling cutout and open fixture junction box door (See **FIG. 2**).

Remove desired housing knockout and feed building wires into housing using appropriate connector.

FIG. 2

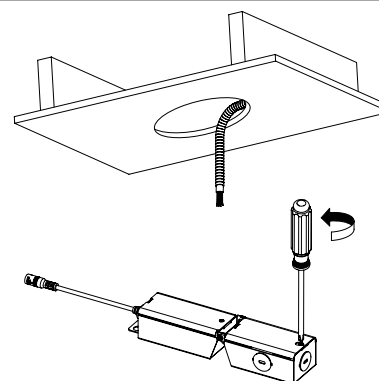

3. Insert each supply wire into appropriate junction box connector. Connect black fixture wire to hot, white fixture wire to neutral, green fixture wire to ground, gray or pink fixture wire to Dim (-), and purple fixture wire to Dim (+) (See **FIG. 3**).

For ELV dimming, wire black (line hot) and white (line neutral) in accordance to dimmer specifications.

For 0-10V dimming, wire purple (dim+), gray or pink (dim-), black (line hot), and white (line neutral) in accordance to dimmer specifications.

When not using a dimmer, connect black fixture wire to hot, white fixture wire to neutral and green fixture wire to ground. Leave all other wires capped individually. Place all wiring and connectors back in junction box and replace the junction box cover.

FIG. 3

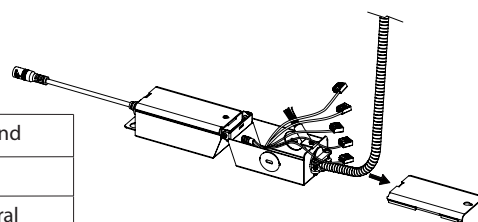

| | |
|--------------|--------------|
| Green | Ground |
| Black | Hot |
| White | Neutral |
| Gray or Pink | 0-10V Dim(-) |
| Purple | 0-10V Dim(+) |

INSTALLATION INSTRUCTION
AETHER 2" - REMODEL HOUSING
HR-2LED-R10A, HR-2LED-R15A

WAC

4. Place all wiring and connectors back in junction box and replace the junction box's cover (See **FIG. 4**).

FIG. 4

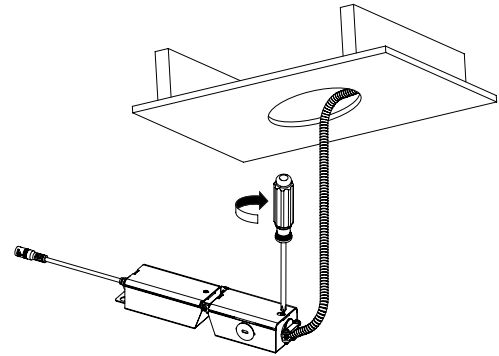

5. Guide junction box through the cut hole, bending at the hinge if necessary (See **FIG. 5**).

FIG. 5

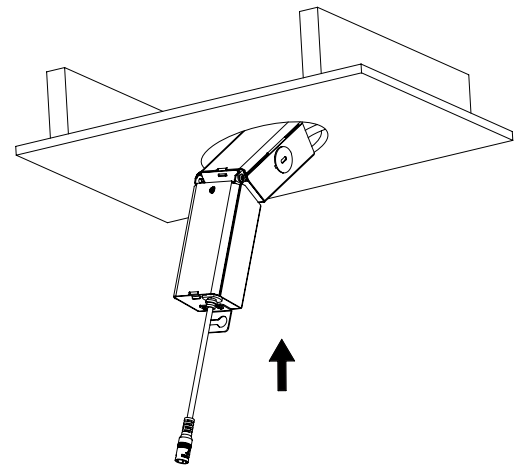

6. Secure appropriately (See **FIG. 6**).

FIG. 6

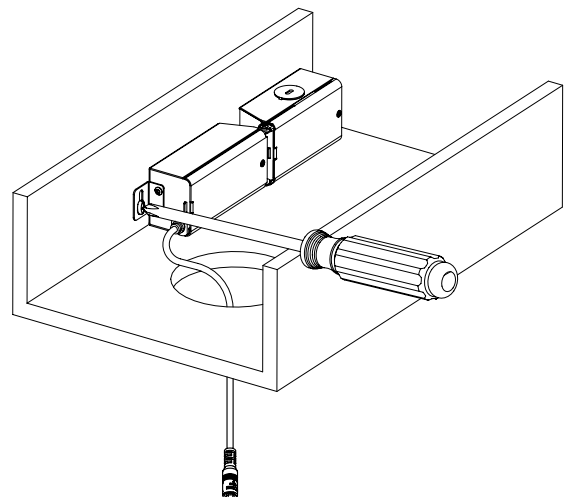

INSTALLATION INSTRUCTION
AETHER 2" - REMODEL HOUSING
HR-2LED-R10A, HR-2LED-R15A

WAC

7. Twist to connect the fixture wire to the driver wire (See **FIG. 7**).

FIG. 7

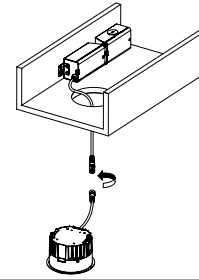

8. Push excess wire up into the plenum space and raise fixture into the cut hole (See **FIG. 8**).

FIG. 8

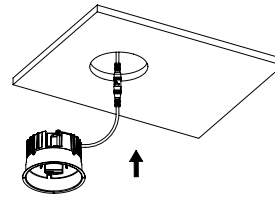

9. **IMPORTANT:** when using a square trim OR any wall wash trim, the housing needs to be aligned at this step. The white marks on the rim of the housing should be aligned parallel to the nearest wall (See **FIG. 9**).

FIG. 9

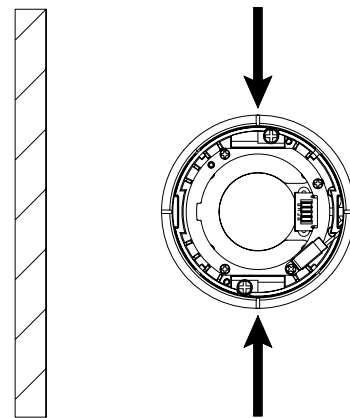

Markings aligned parallel to nearest wall

10. Secure the fixture to the ceiling using the two screws found inside the housing at either side. A low-torque, electric screwdriver is recommended (See **FIG. 10**).

FIG. 10

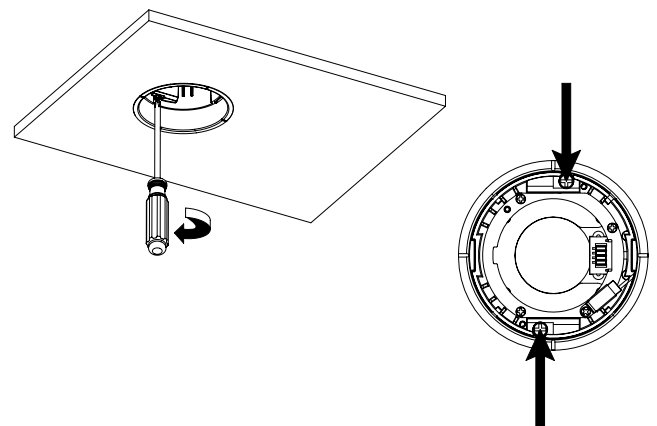

INSTALLATION INSTRUCTION

AETHER 2" - REMODEL HOUSING

HR-2LED-R10A, HR-2LED-R15A

WAC

DOWNLIGHT INSTALLATION

1. Once housing is installed, place the downlight light engine into the housing by aligning the base with the slots in the housing receptacle. The light engine will magnetically click into place (**FIG. 11** and **FIG. 12**). The included handle is to aid with installation and removal of the light engine.

FIG. 11

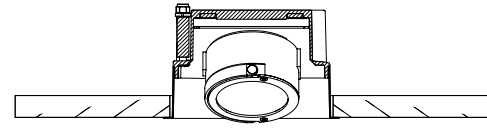
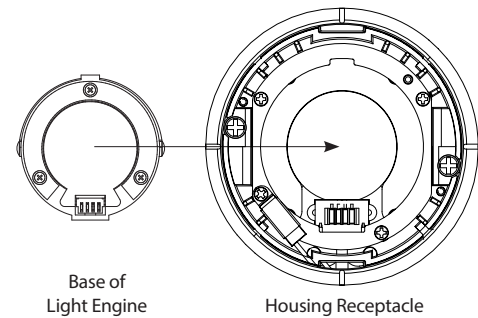
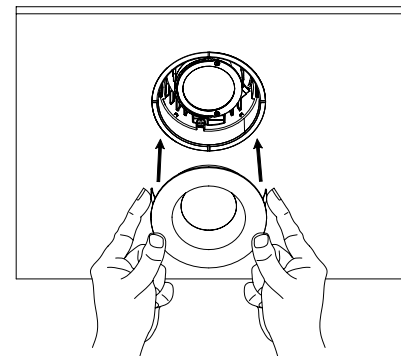

FIG. 12



2. Locate the narrow slots at either side of the housing, just inside the white marks on the rim. Raise the trim to the housing, depress trim spring clips and slide them into the slots. Push the trim assembly up until the trim is flush with the ceiling (See **FIG. 13**).

FIG. 13



ADJUSTABLE DOWNLIGHT INSTALLATION

1. Once housing is installed, place the adjustable downlight light engine into the housing by aligning the base with the slots in the housing receptacle. The light engine will magnetically click into place (**FIG. 14** and **FIG. 15**). The included handle is to aid with installation, adjustment and removal of the light engine.

FIG. 14

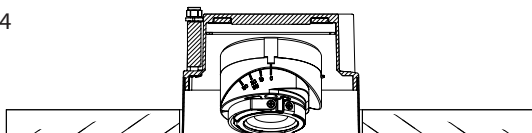
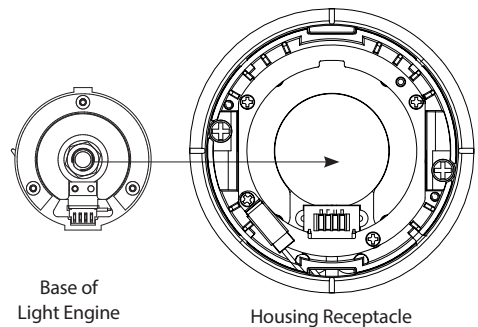
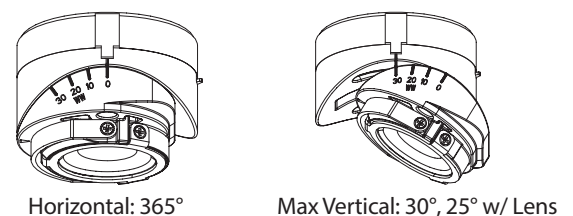

FIG. 15



2. The adjustable downlight light engine has a max horizontal rotation of 365° and a max vertical tilt of 30° (**FIG. 16**).
Note: if using a trim with lens installed, max vertical tilt is 25°.
3. Adjust the vertical tilt to desired angle.

FIG. 16



wacighting.com
Phone (800) 526.2588
Fax (800) 526.2585

Headquarters, East Manufacturing Facility
44 Harbor Park Drive
Port Washington, NY 11050

South East Manufacturing Facility
1600 Distribution Ct
Lithia Springs, GA 30122

Central Manufacturing Facility
1700 South J Elmer Freeway, Ste 100
Cedar Hill, TX 75104

West Manufacturing Facility
1750 S Archibald Ave
Ontario, CA 91761

INSTALLATION INSTRUCTION

AETHER 2" - REMODEL HOUSING

HR-2LED-R10A, HR-2LED-R15A

WAC

4. Locate the narrow slots at either side of the housing, just inside the white marks on the rim. Raise the trim to the housing, depress trim spring clips and slide them into the slots. Push the trim assembly up until the trim is flush with the ceiling (See **FIG. 17**).

FIG. 17

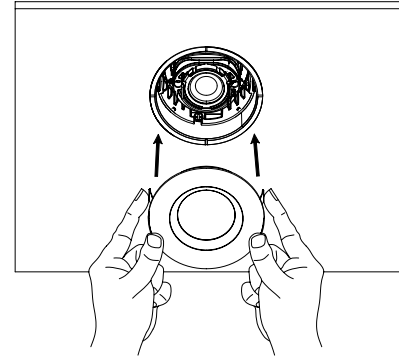

WALL WASH INSTALLATION

1. Once housing is installed, place the wall wash light engine into the housing by aligning the base with the slots in the housing receptacle. The light engine will magnetically click into place (**FIG. 18** and **FIG. 19**). The included handle is to aid with installation, adjustment and removal of the light engine.
2. Set the tilt angle to 20°. Be sure to adjust the horizontal aiming to the desired direction as the light engine will also dictate the direction of the trim.
3. Locate the narrow slots at either side of the housing, just inside the white marks on the rim. Raise the trim to the housing, depress trim spring clips and slide them into the slots. Push the trim assembly up until the trim is flush with the ceiling (See **FIG. 20**).

FIG. 18

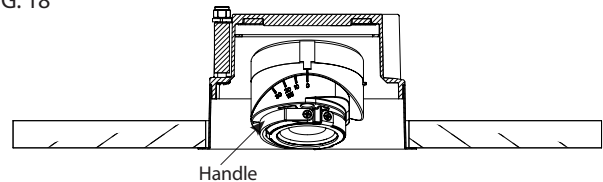

FIG. 19

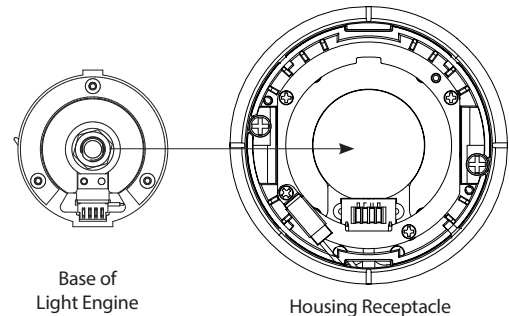

FIG. 20

