

Hoist Sconce

13093 rD

Low Voltage Input

Note: External power supply may be required

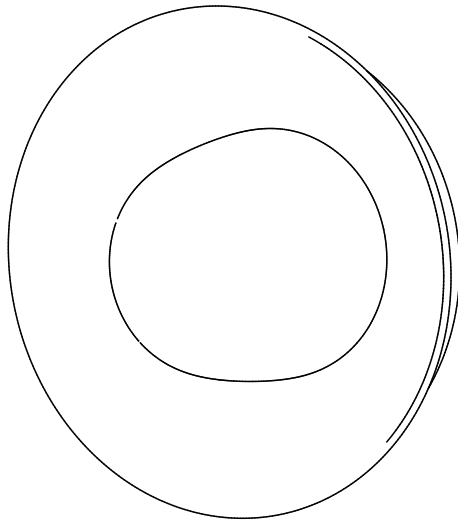

CAUTION:

Before starting, turn off power at main circuit panel.

ADVERTENCIA:

Antes de comenzar la instalación, apague la corriente en el tablero principal.

ATTENTION:

Coupez l'alimentation avant de proceder à l'installation.



Calling for backup? Scan above to contact our team.

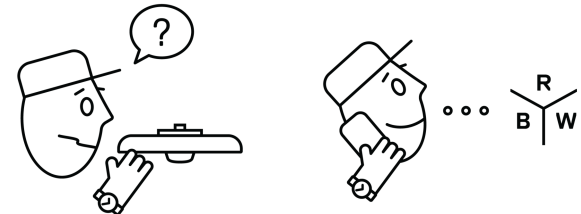

www.RBW.com
+1 212 388 0399
support@RBW.com
© 2023, RBW Studio LLC

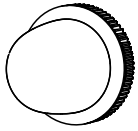

Bare

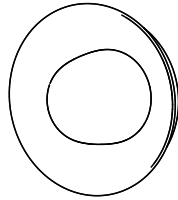

Small Shade

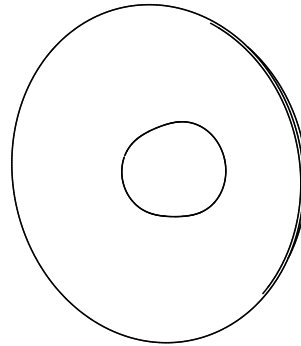

Medium Shade

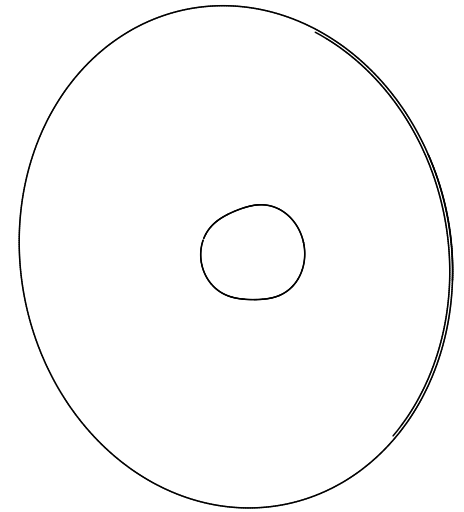

Large Shade

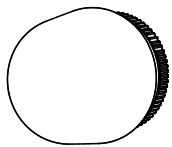

Bare

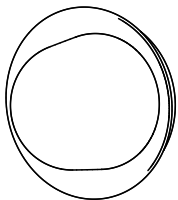

Small Shade

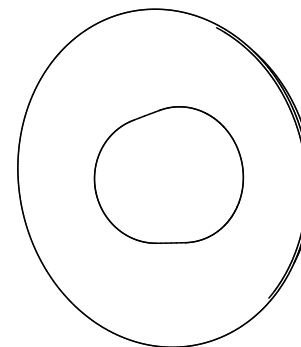

Medium Shade

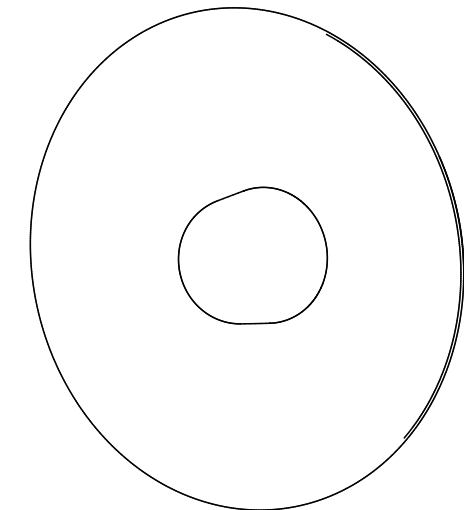

Large Shade

What's Included: Part Configurations May Vary

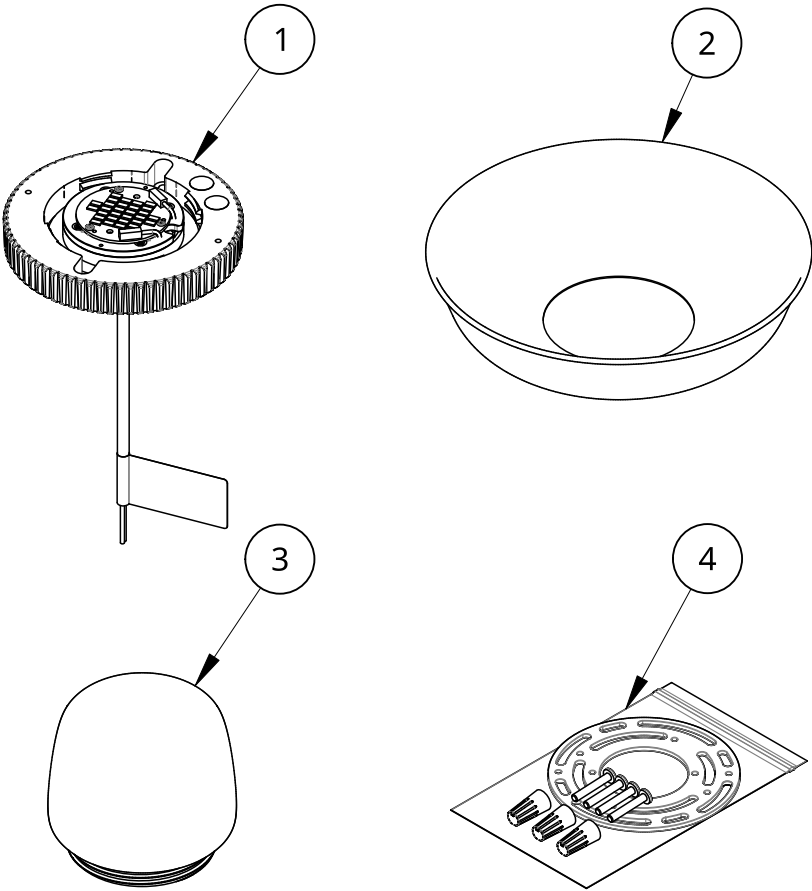

Item	QTY	Description
1	1	Hoist Sconce Module
2	1	Hoist Shade
3	1	Hoist Glass
4	1	Hardware Kit

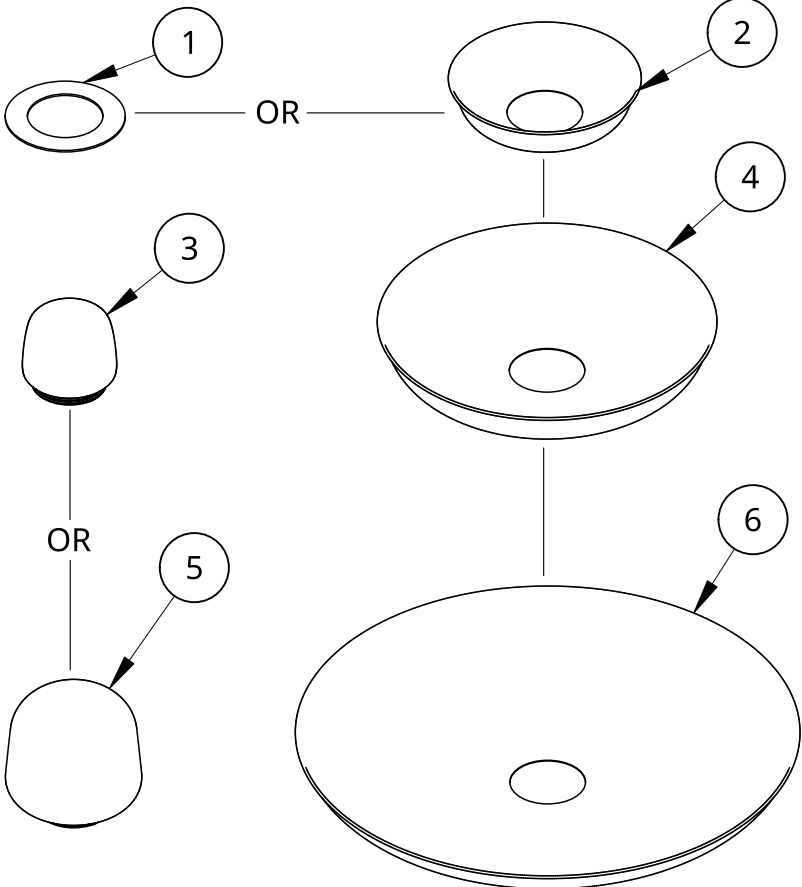

NOTE: Sconce Plate included when a shade is not used.

Item	QTY	Description
1	1	Hoist Sconce Plate
2	1	Hoist Small Shade
3	1	Hoist Glass Small
4	1	Hoist Shade Medium
5	1	Hoist Glass Large
6	1	Hoist Shade Large

⚠ Driver dimensions and location may vary,
consult your order confirmation for details.

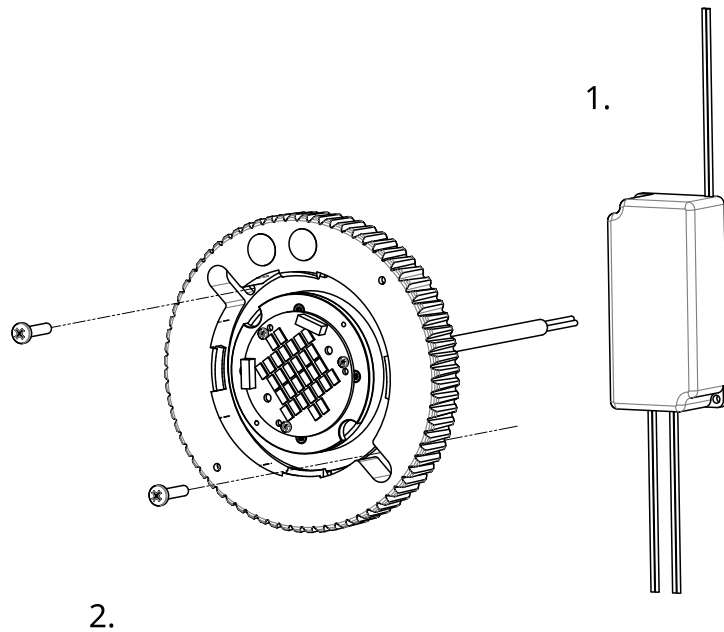

Installation - LED Mount Module Assembly

1. Connect Red (+) and Black (-) Sconce wires to low voltage leads from externally located driver.
2. Fix the Module to desired mounting surface with appropriate fasteners.

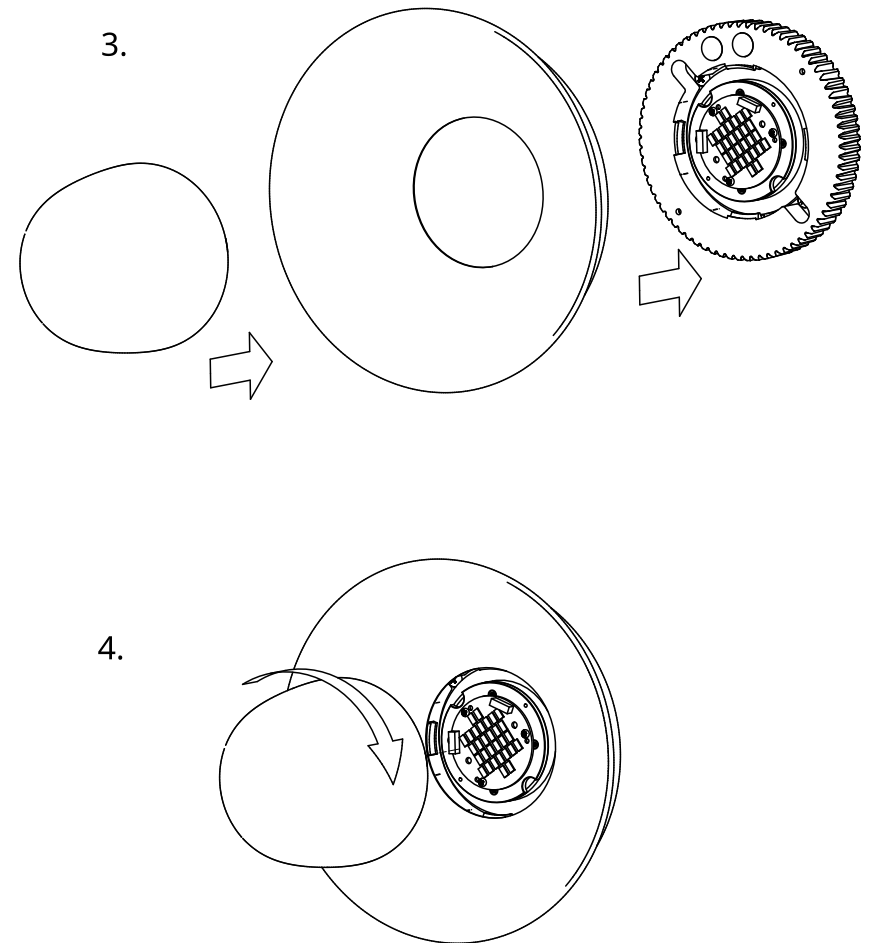

Installation - Shade and Globe

3. Place the Shade w/ Gasket on LED Mount Module and thread Hoist Globe through Shade.
4. Securely fasten Hoist Globe to LED Mount Module to ensure a tight seal.
5. Congratulations! End of guide.

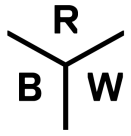

Hoist Sconce

12741 rE

AC Input

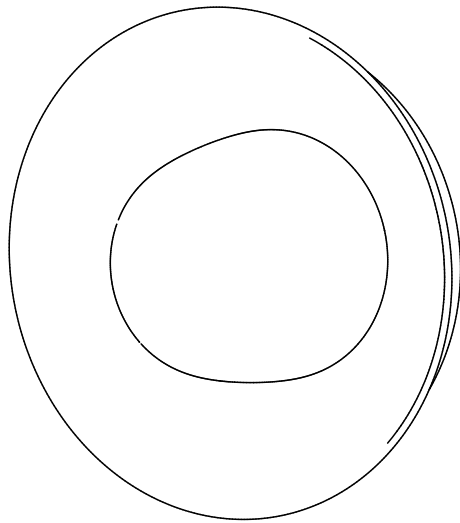

CAUTION:

Before starting, turn off power at main circuit panel.

ADVERTENCIA:

Antes de comenzar la instalación, apague la corriente en el tablero principal.

ATTENTION:

Coupez l'alimentation avant de procéder à l'installation.



Calling for backup? Scan above to contact our team.

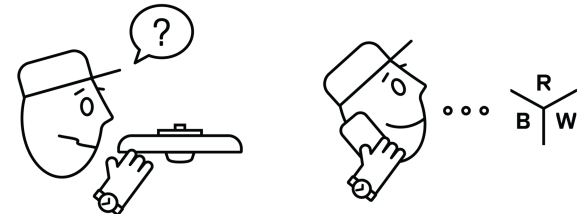

www.RBW.com
+1 212 388 0399
support@RBW.com
© 2023, RBW Studio LLC

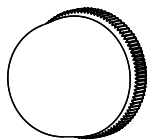

Bare Shade

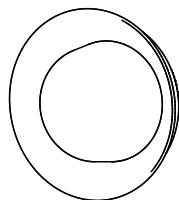

Small Shade

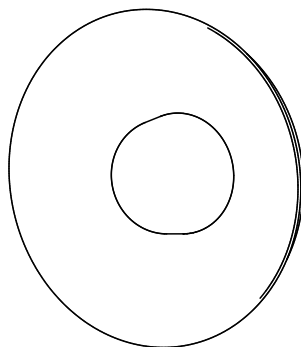

Medium Shade

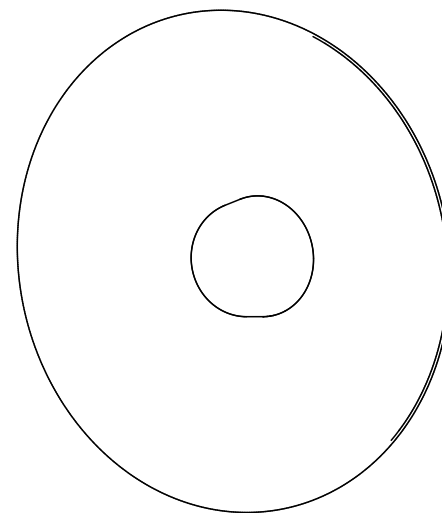

Large Shade

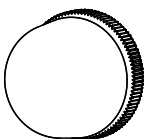

Bare Shade

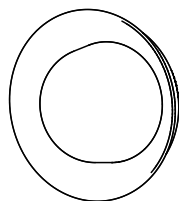

Small Shade

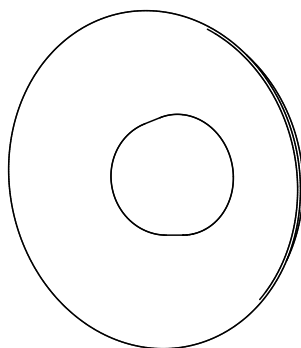

Medium Shade

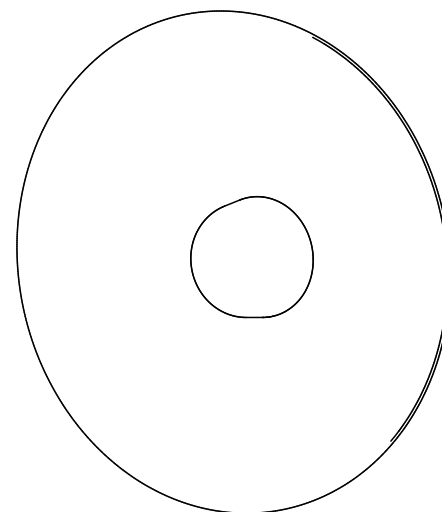

Large Shade

What's Included: Part Configurations May Vary

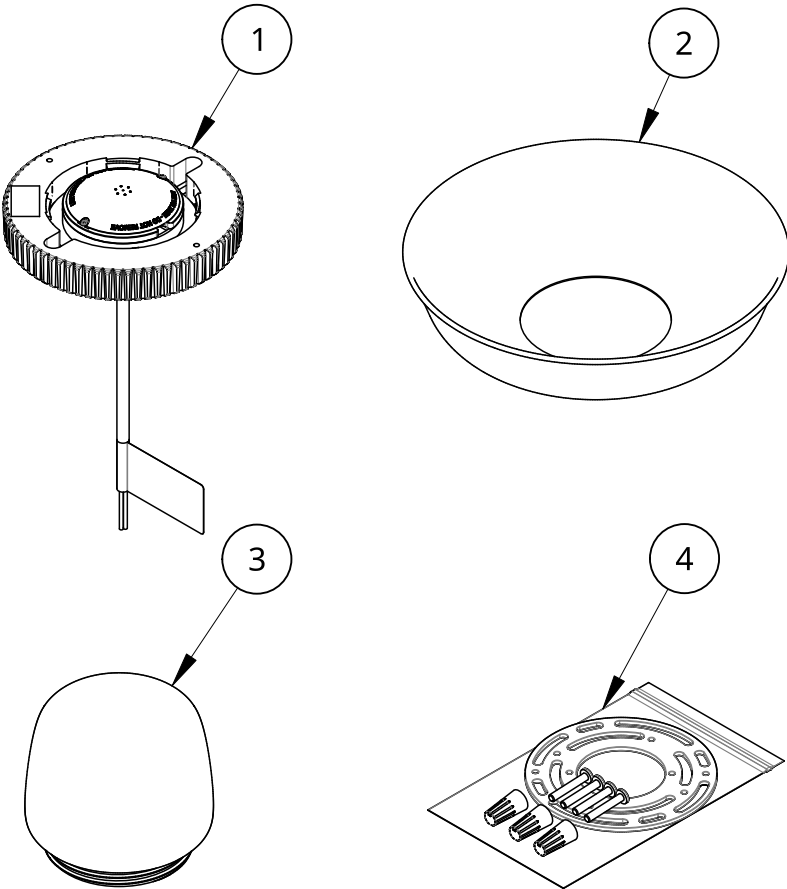

Item	QTY	Description
1	1	Hoist Sconce Module
2	1	Hoist Shade
3	1	Hoist Glass
4	1	Hardware Kit

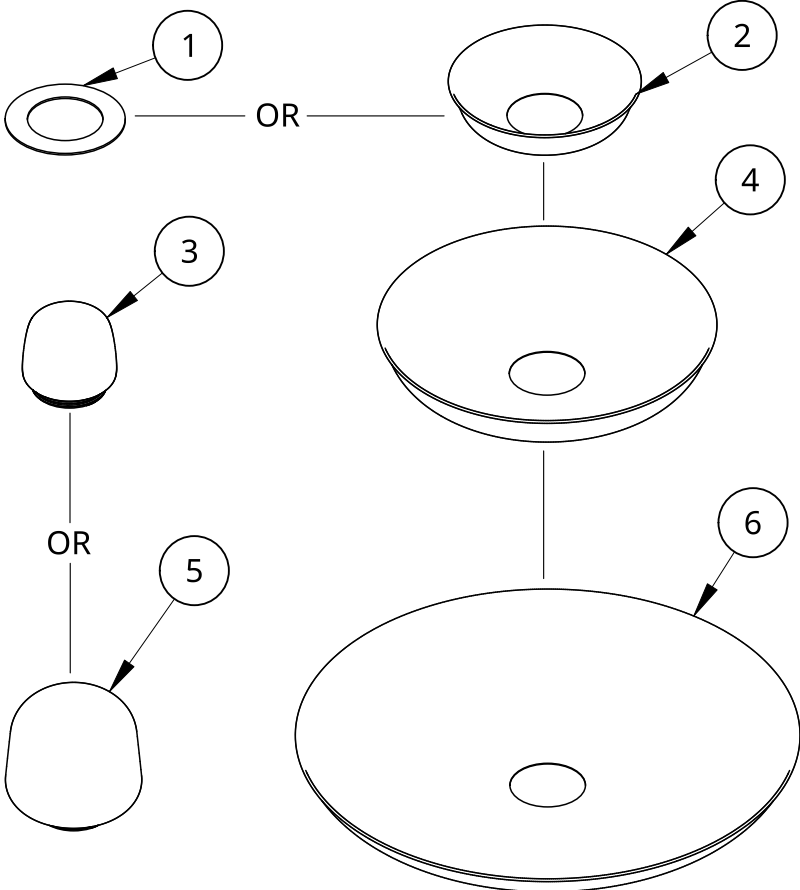

NOTE: Sconce Plate included when a shade is not used.

Item	QTY	Description
1	1	Hoist Sconce Plate
2	1	Hoist Small Shade
3	1	Hoist Glass Small
4	1	Hoist Shade Medium
5	1	Hoist Glass Large
6	1	Hoist Shade Large

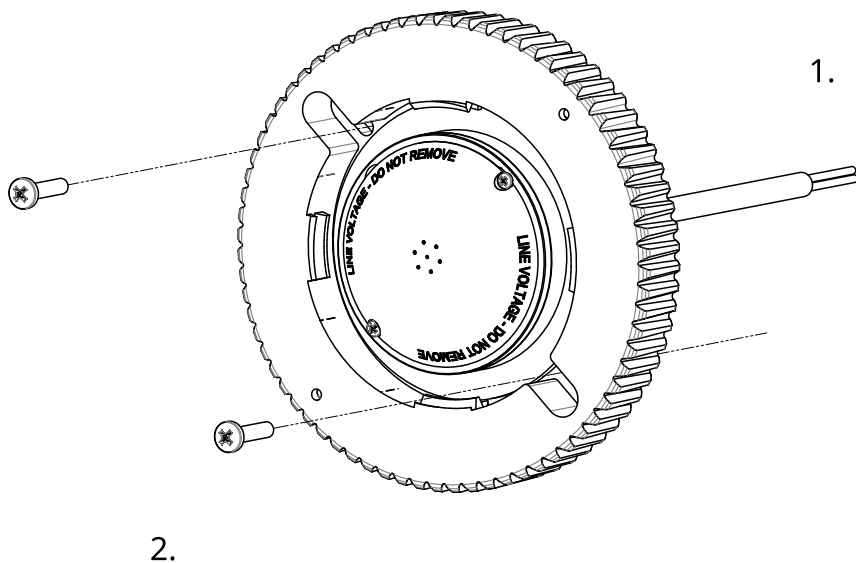

Installation - LED Mount Module Assembly

1. Connect White (L) and Black (N) Sconce wires to power feed.
2. Fix the Module to desired mounting surface with appropriate fasteners.

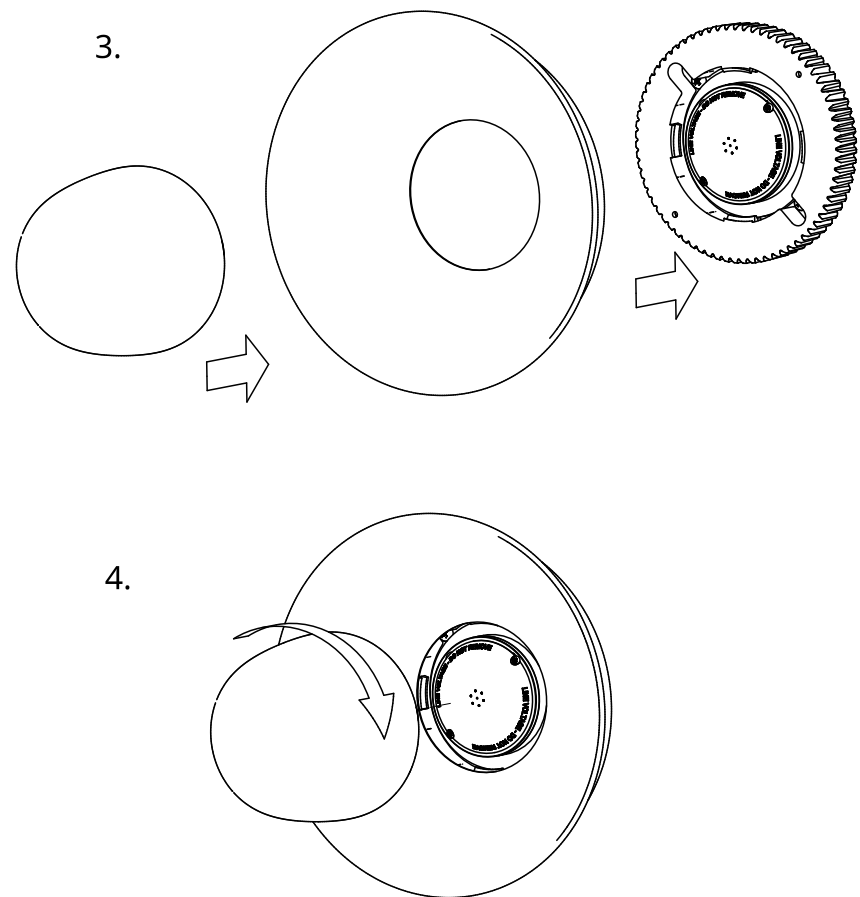

Installation - Shade and Globe

3. Place the Shade w Gasket on LED Mount Module and thread Hoist Globe through Shade.
4. Securely fasten Hoist Globe to LED Mount Module to ensure a tight seal.
5. Congratulations! End of guide.