

Hoist Pendant

12742 rE

AC Input

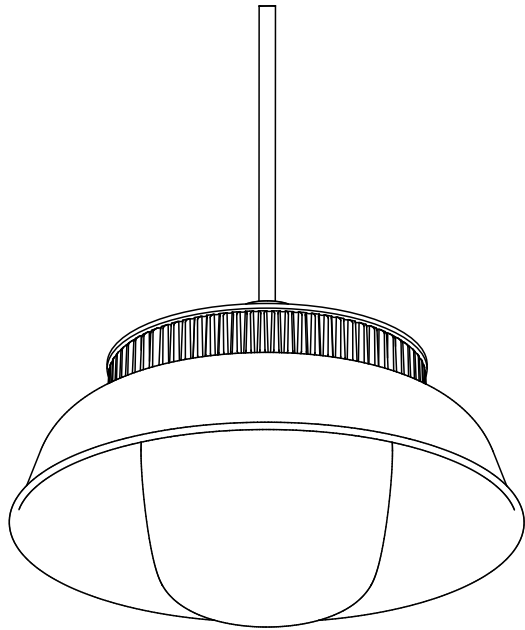

CAUTION:

Before starting, turn off power at main circuit panel.

ADVERTENCIA:

Antes de comenzar la instalación, apague la corriente en el tablero principal.

ATTENTION:

Coupez l'alimentation avant de proceder à l'installation.



Calling for backup? Scan above to contact our team.

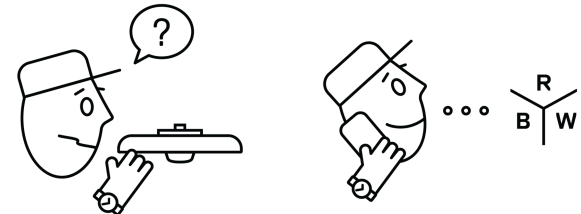

www.RBW.com
+1 212 388 0399
support@RBW.com
© 2023, RBW Studio LLC

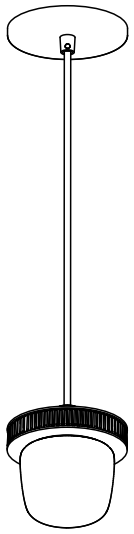

Bare

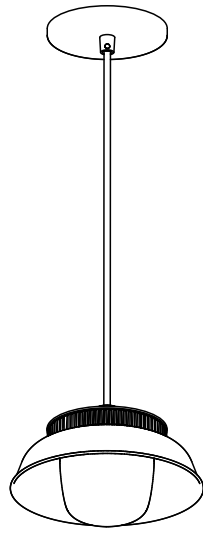

Small

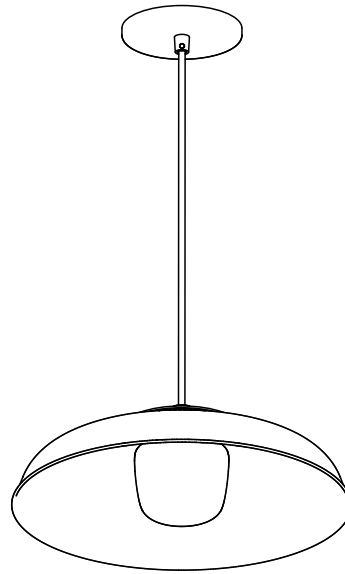

Medium

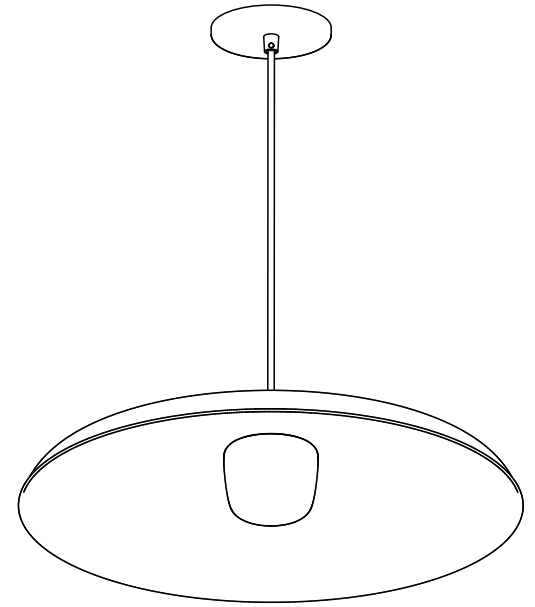

Large

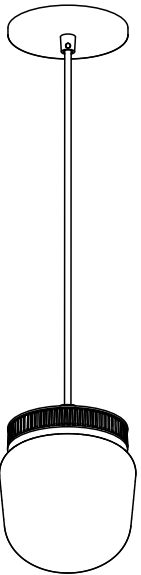

Bare

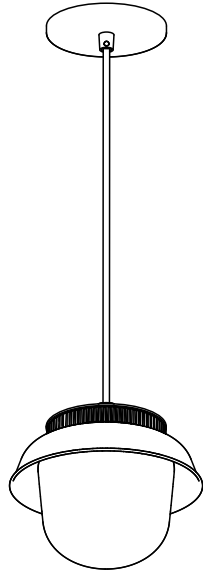

Small

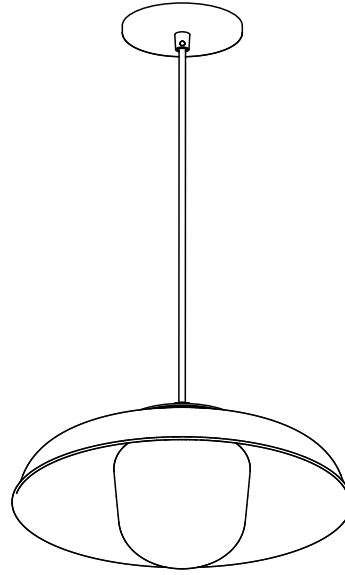

Medium

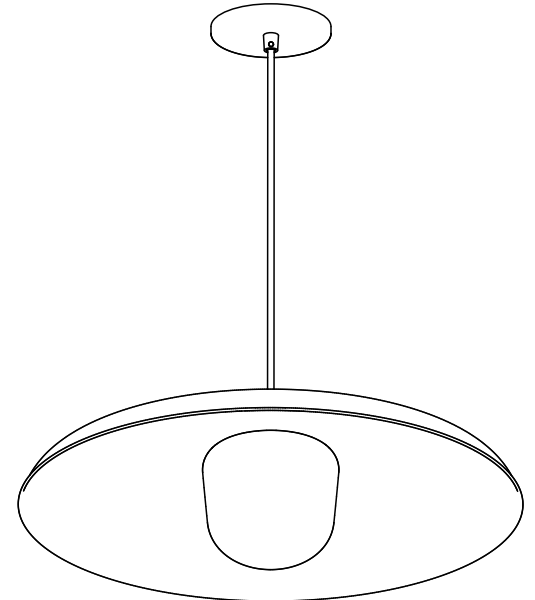

Large

What's Included: Part Configurations May Vary

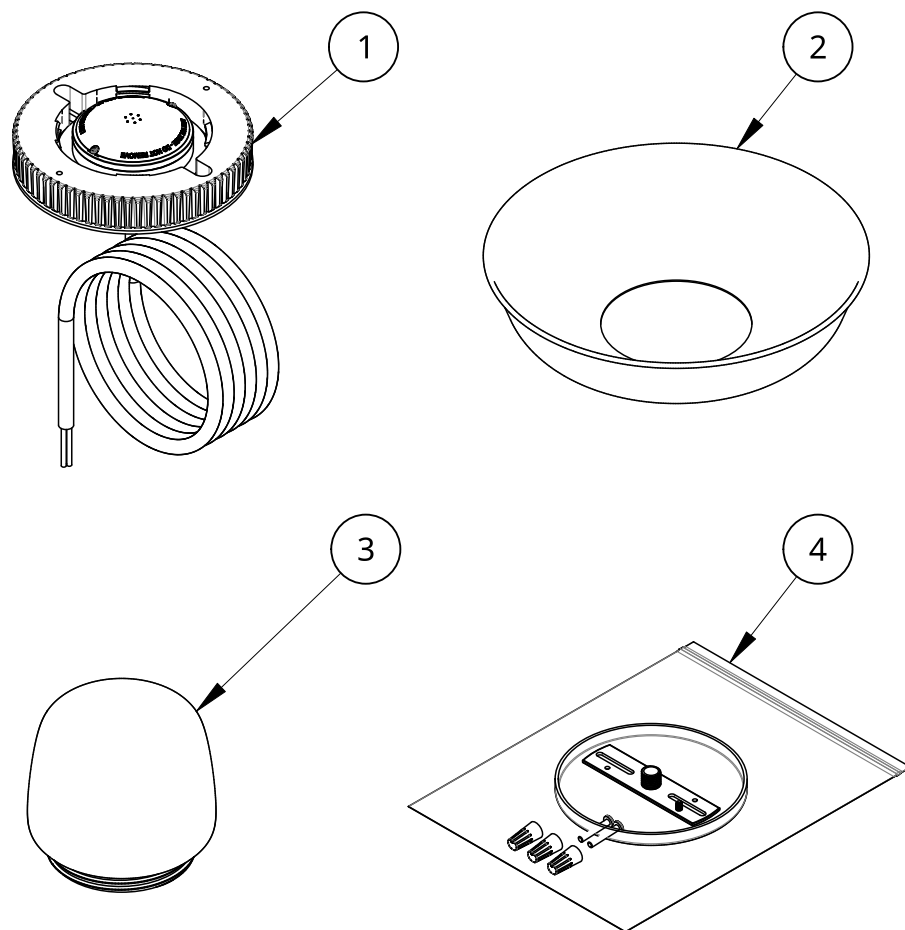

Item	QTY	Description
1	1	Hoist Pendant Module
2	1	Hoist Shade
3	1	Hoist Glass
4	1	Canopy Kit

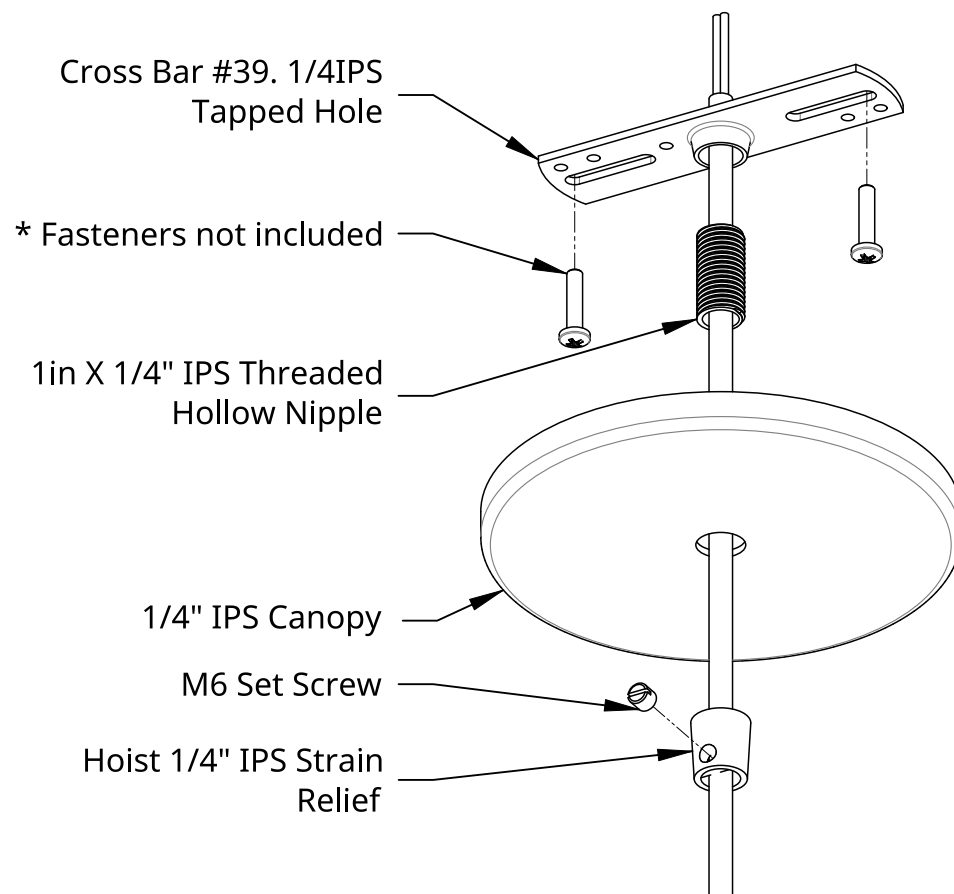

Installation - Hoist Canopy

1. Use appropriate fasteners to secure Crossbar to desired mounting location.
2. Feed Power Cord through Strain Relief, Canopy and 1/4" IPS Nipple.
3. Connect White (N) and Black (L) leads to power feed, and connect Green Lead (GND).
4. Thread Nipple into Crossbar.
5. Raise Canopy to ceiling and secure by threading on Strain Relief.
6. Fasten M6 Set Screw in Strain Relief to secure Power Cord at desired hang height.

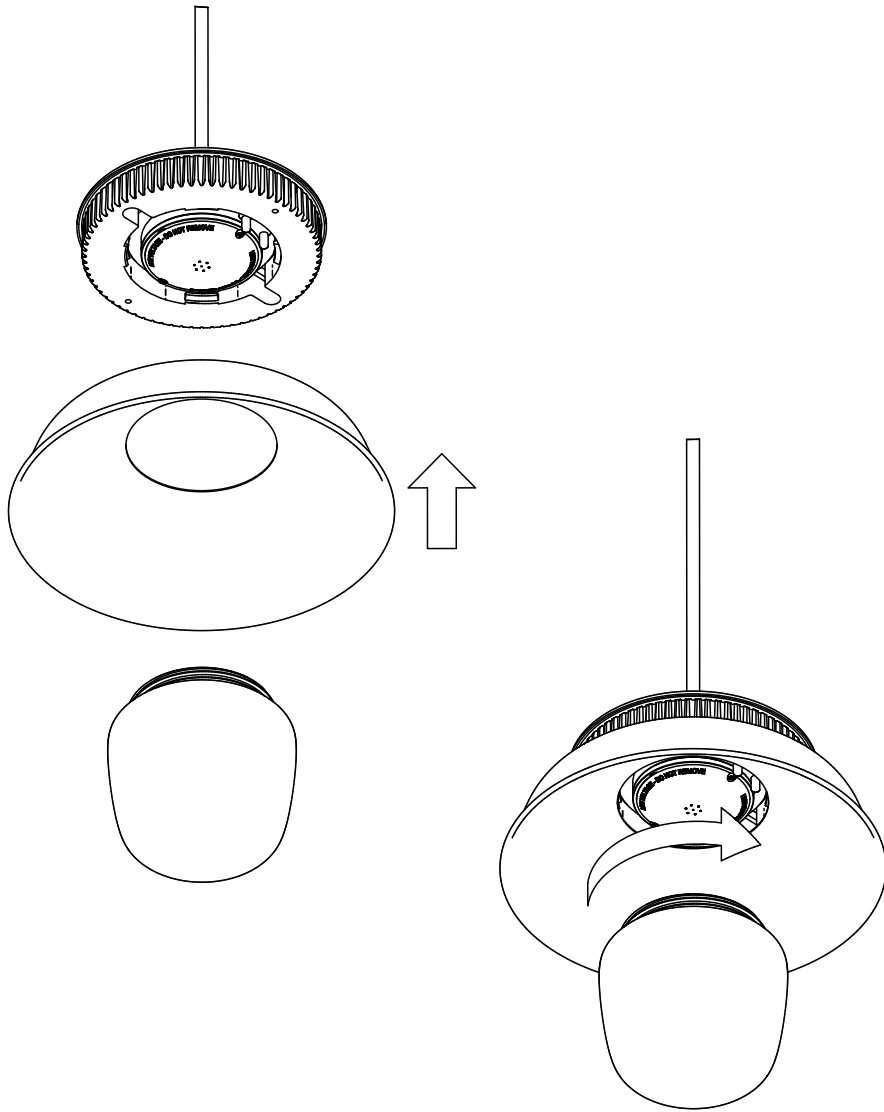

Page intentionally left blank

Installation - Shade and Glass

1. Raise Hoist Shade and Hoist Glass to Hoist Pendant LED Module.
2. Thread Hoist Glass clockwise into Hoist Pendant LED Module to secure Hoist Shade.
3. Congratulations! End of guide.

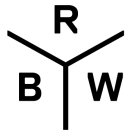

Hoist Pendant

13094 rD

Low Voltage Input

Note: External power supply may be required.

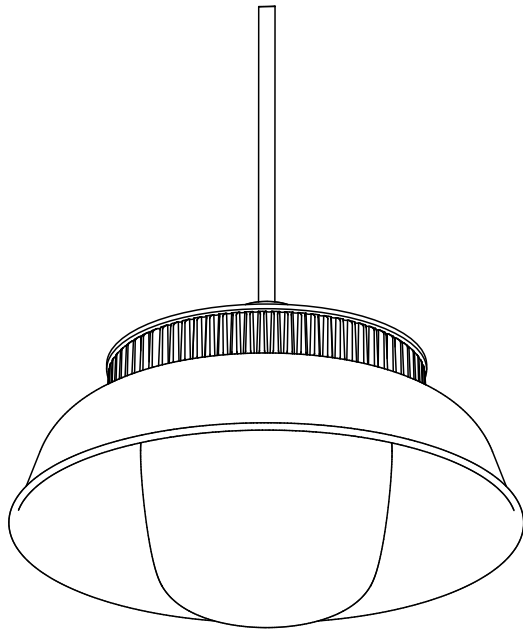

CAUTION:

Before starting, turn off power at main circuit panel.

ADVERTENCIA:

Antes de comenzar la instalación, apague la corriente en el tablero principal.

ATTENTION:

Coupez l'alimentation avant de procéder à l'installation.



Calling for backup? Scan above to contact our team.

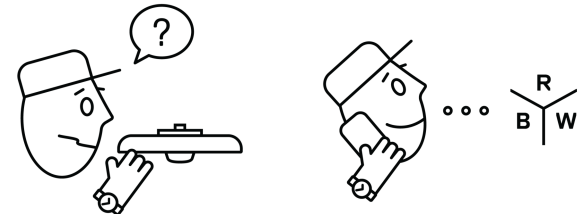

www.RBW.com
+1 212 388 0399
support@RBW.com
© 2023, RBW Studio LLC

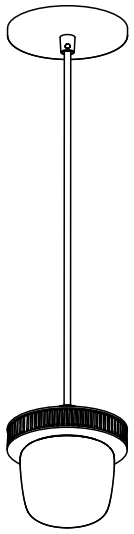

Bare

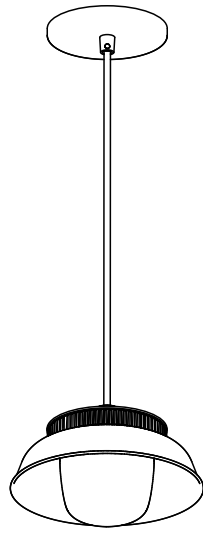

Small

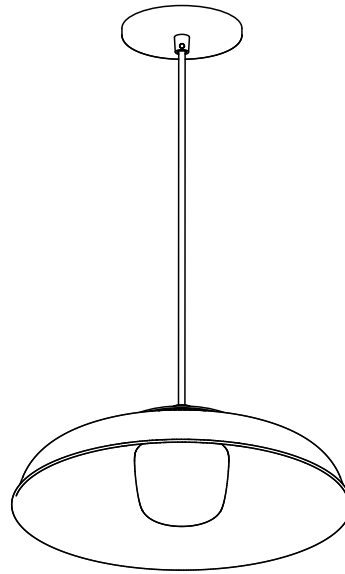

Medium

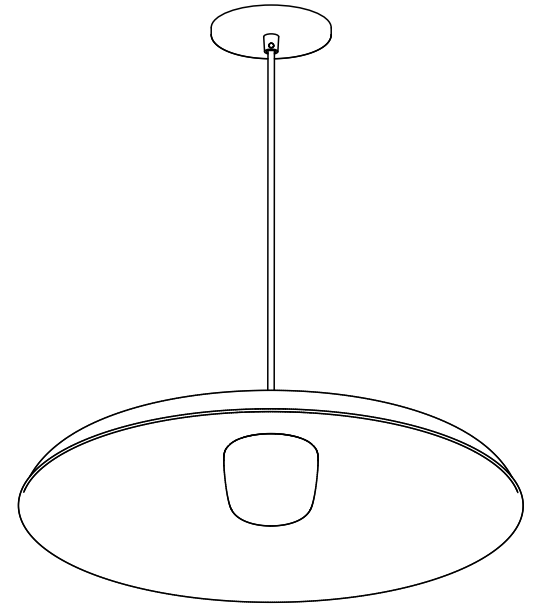

Large

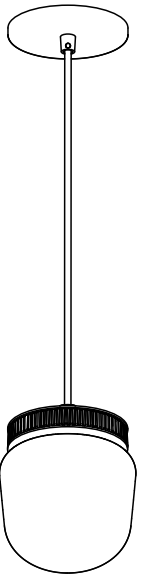

Bare

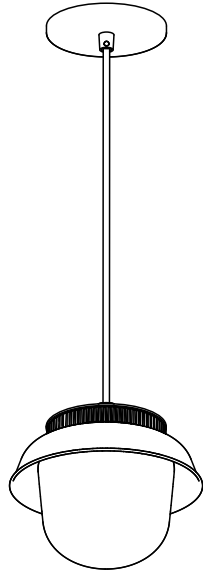

Small

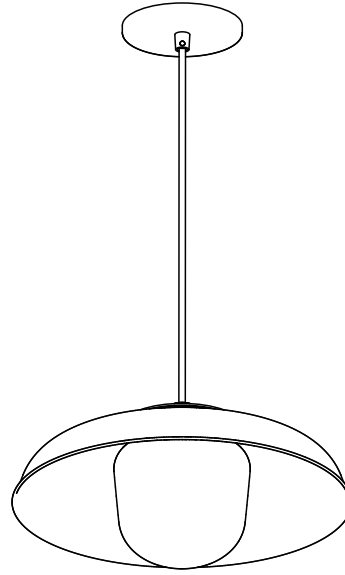

Medium

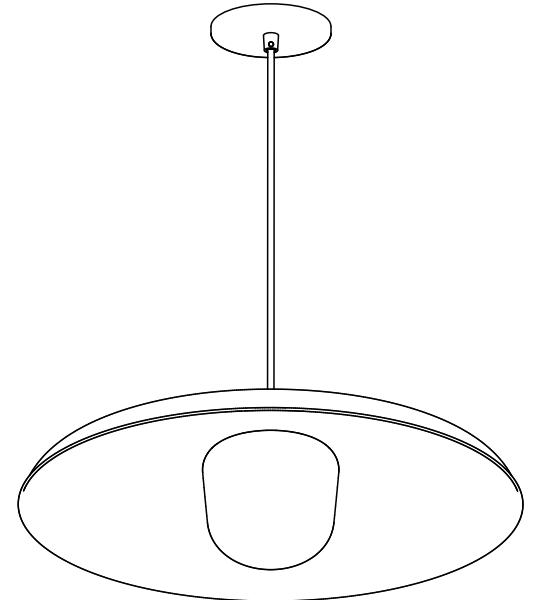

Large

What's Included: Part Configurations May Vary

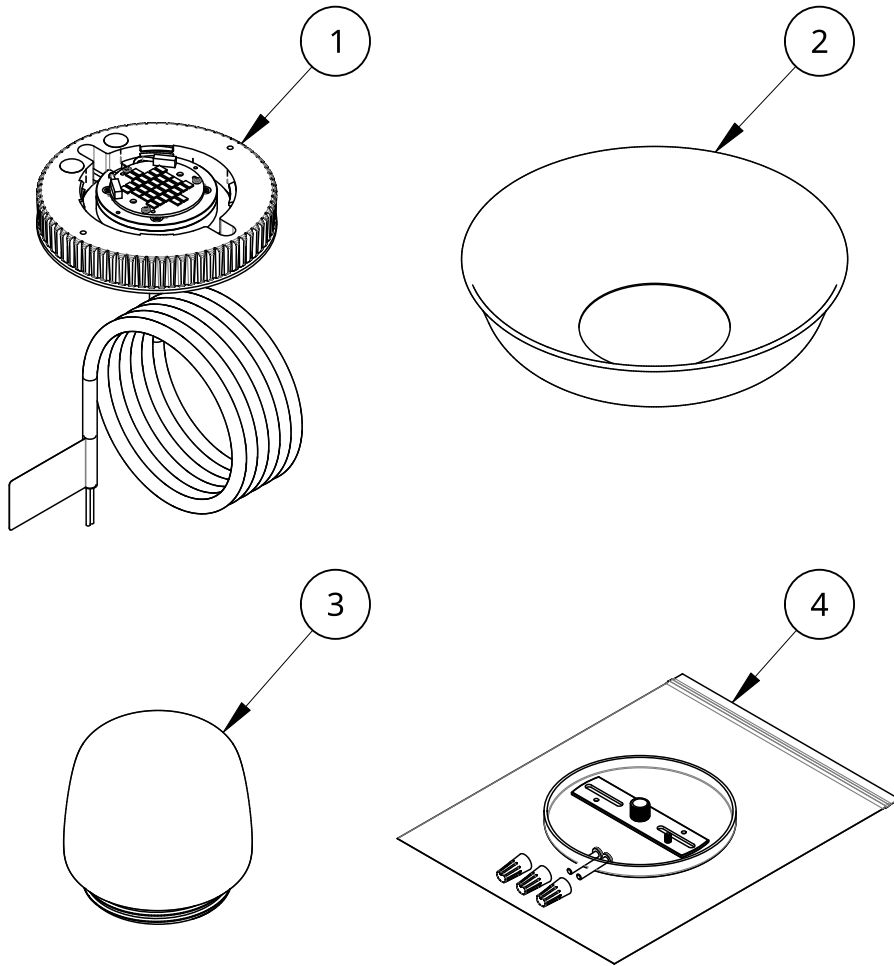

Item	QTY	Description
1	1	Hoist Pendant Module
2	1	Hoist Shade
3	1	Hoist Glass
4	1	Canopy Kit

⚠ Driver dimensions and location may vary, consult your order confirmation for details.

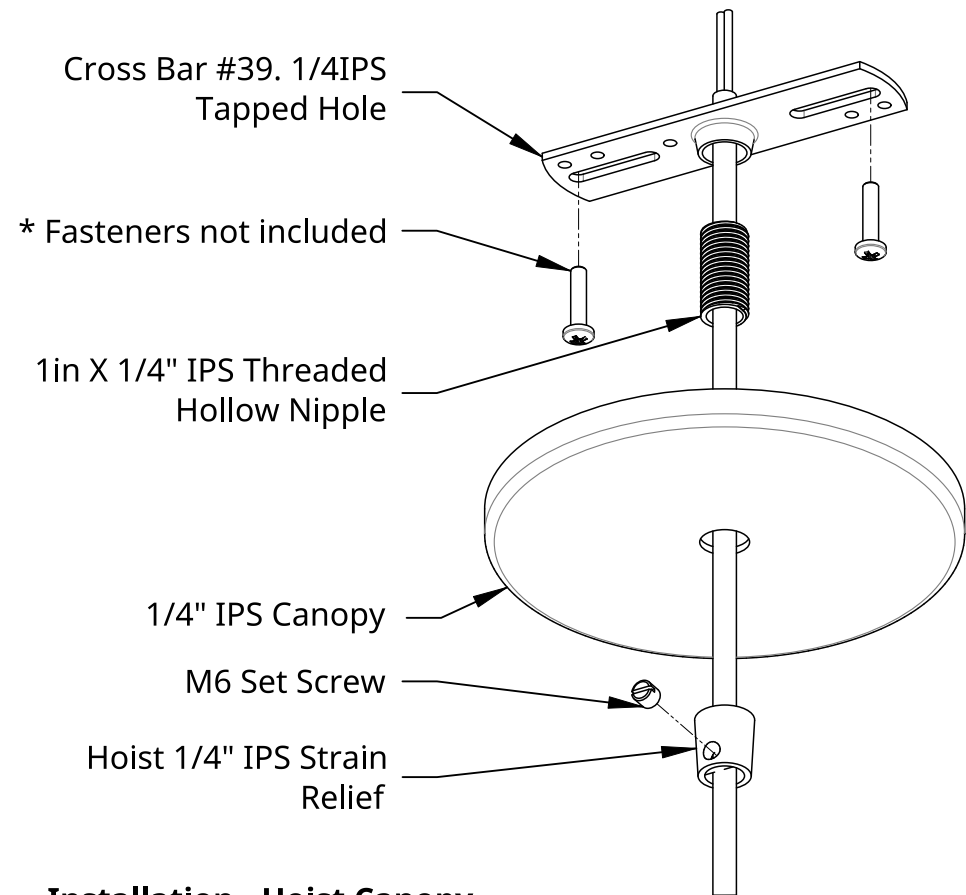

Installation - Hoist Canopy

1. Use appropriate fasteners to secure Crossbar to desired mounting location.
2. Feed Power Cord through Strain Relief, Canopy and 1/4" IPS Nipple.
3. Connect Red (+) and Black (-) leads to low voltage leads from externally located driver.
4. Thread Nipple into Crossbar.
5. Raise Canopy to ceiling and secure by threading on Strain Relief.
6. Fasten M6 Set Screw in Strain Relief to secure Power Cord at desired hang height.

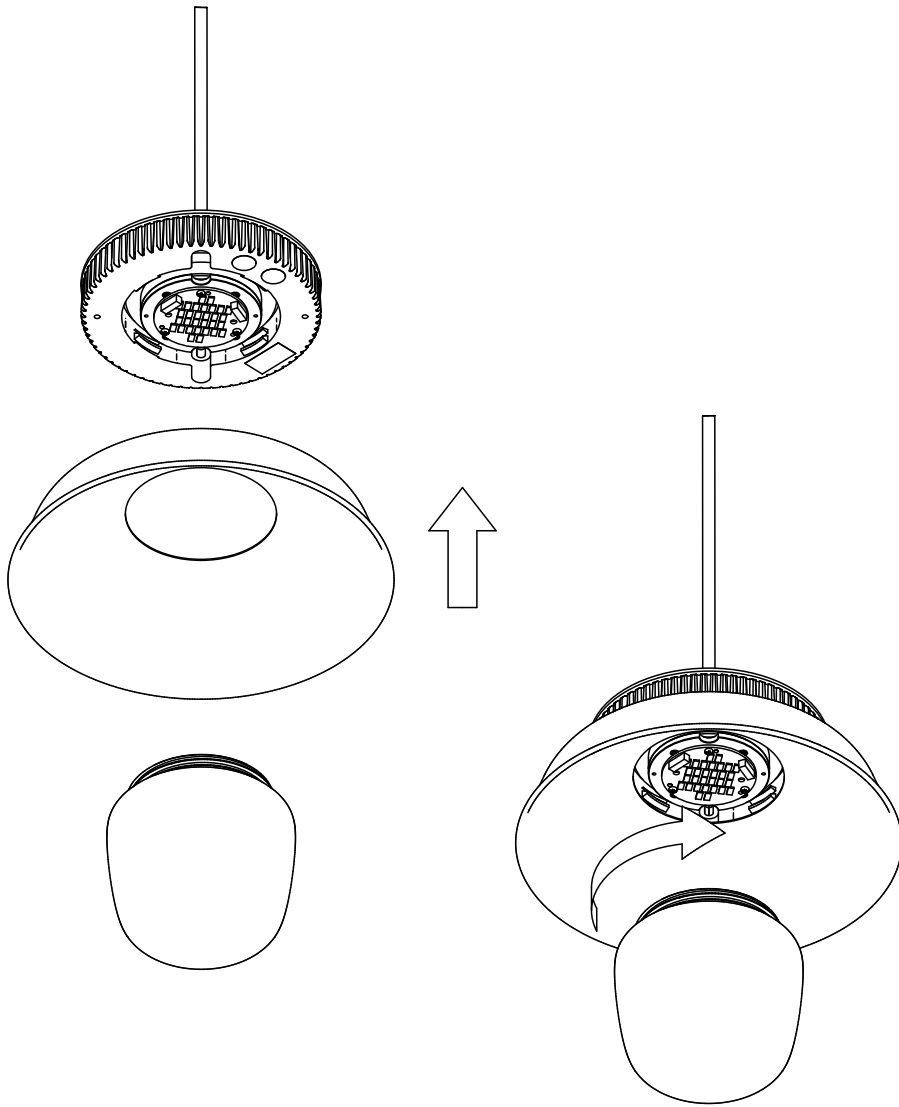

Page intentionally left blank

Installation - Shade and Glass

7. Raise Hoist Shade and Hoist Glass to Hoist Pendant LED Module.
8. Thread Hoist Glass clockwise into Hoist Pendant LED Module to secure Hoist Shade.
9. Congratulations! End of guide.