

## Wall Spot Light with PURE LED

PROJECT:
TYPE:
SOURCE:
NOTES:

### SPECIFICATIONS

IP66



LED Chip	Cree XHP-50-2 Plug and Play field replaceable LED board
Luminaire Output*	600 Lumens @ 1050mA (6 watts), 420 Lumens @ 700mA (4 watts), 240 Lumens @ 350mA (2 watts)
Lumens Per Watt*	100 Lumens @ 6 watts minimum
LED Life Expectancy	50,000 hours L70
CRI (3000K)	90+
Colour Temperatures	2700K, 3000K, 4000K
Beam Angles	15, 25, 38, 60
Ingress Protection	IP66
Warranty	Electronics = 5 years Aluminium = 5 years Body Cop/ SS = 10 years
Standards	AS/NZS 61046, EN60598 cUL 1838, 2108, 1598 CSA C22.2 No. 250.7, No. 250.0-08, No. 250.0 CE

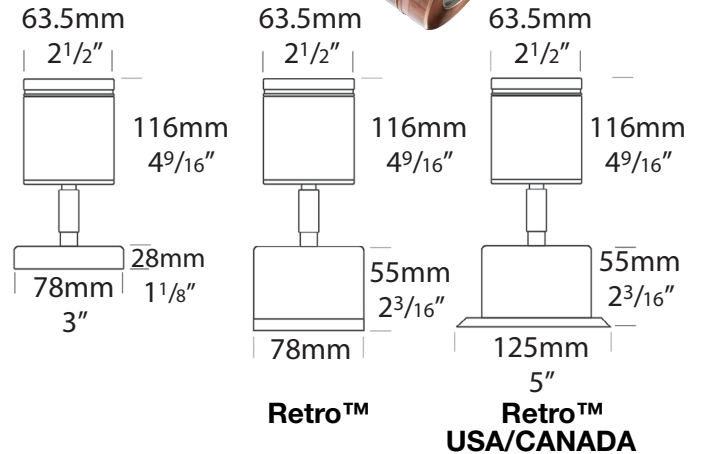

\*Delivered from the Luminaire with unobstructed beam

### PRODUCT CONFIGURATION

Please fill in appropriate codes into boxes provided

#### Cat. No. WS/L

Luminaire	Power	Material/Finish	Beam	Colour	Accessories	
WS/L						
S	1050mA Input, Series Wired 6W	ALUMINIUM	EBK BLACK	15 15°	2 2700K	CJK Cable Joint Kit
D3	12VAC Input, Parallel Wired 2W		EBZ BRONZE	30 25°	3 3000K	LF Frosted Lens
D7	12VAC Input, Parallel Wired 4W		EOGR OLIVE GREEN	38 38°	4 4000K	HCL Hex Cell Louvre
D10	12VAC Input, Parallel Wired 6W		EWH WHITE	60 60°		GG Glare Guard
R	RETRO, 110/240V Input, Parallel Wired		EWB WHITE BIRCH			SNT Snoot
			EDG DARK GREY			LKN Locking Knuckle
			ESTAR SILVER STAR			WBAP Wall Box Adaptor
			ECT CORTEN			
			I			
			COP Copper			
		SS Stainless Steel				

#### S - Series Driver

Power Supply: Constant current driver  
REQUIRED - NOT SUPPLIED  
Wiring Method: Wired in series  
Fixture Input: Individual fixtures require 6Vf @ 1050mA maximum 6 Watts

#### D3 D7 D10 - 12VAC Input

Power Supply: Line/Mains to 12VAC  
Transformer REQUIRED - NOT SUPPLIED  
Wiring Method: Parallel  
Fixture Input: 9-15VAC,  
Fixture Output: D3 = 6Vf @ 350mA 2W  
D7 = 6Vf @ 700mA 4W  
D10 = 6Vf @ 1050mA 6W  
(1050mA limited to ≤ 40°C (104°F) ambient temperature in stainless steel)

#### R - 110/240VAC RETRO DRIVER:

Input: 120/240vac, 5 watt total (driver included)  
Output: 6vdc, 700mA (non dimming)

#### OTHER LAMP OPTIONS:

WS/H - MR16 Halogen 12V Lamp  
WS/SL - MR16 LED Retrofit 12V Lamp (lamps vary by market - please refer to supplier for details)  
WS/GUH - GU10 120/240V Halogen Lamp (body length increases for all GU10 lamps)  
WS/GUSL - GU10 LED Retrofit 120/240V Lamp (lamps vary by market - please refer to supplier for details)

#### Additional Comments:

\*Due to continued product enhancements, specifications may change without notification.

# LUMINAIRE CONSTRUCTION

**CNC machined from one of the following metals:**

**Aluminium:**

Body: high corrosion resistant 63.5mm (2 1/2") x 10mm (3/8") aluminium.

End cap: solid aluminium 63.5mm (2 1/2") rod.

Base and Mounting Plate (Retro™): handspun 2mm (5/64") aluminium. Base cast from virgin CC401 low copper aluminium alloy chromate substrate and high UV resistant polyester powder coat.

Colours:

Black, Bronze, Silver Star, White, White Birch, Olive Green, Dark Grey, Corten.

**Copper:**

Body: 63.5mm (2 1/2") x 10mm (3/8").

End cap: solid copper 63.5mm (2 1/2") rod.

Base and Mounting Plate (Retro™): handspun 2mm (5/64") copper disk and forged brass.

**316 Stainless Steel:**

Body: 63.5mm (2 1/2") x 10mm (3/8").

End cap: solid 316 stainless steel 63.5 (2 1/2") rod.

Base and Mounting Plate (Retro™): investing cast and CNC machined 316 stainless steel.

**Knuckles:**

Aluminium and Copper luminaires - 360° rotation and 0-90° elevation, solid brass with anti rust spring.

Stainless Steel luminaires - 360° rotation and 0-90° elevation, full stainless steel construction.

**Step Lens:**

10mm (3/8") Extra clear, low iron, shatter resistant glass. Lifetime warranty

**Gaskets:**

Silicone, iron impregnated 220°C (428°F)

**Mounting:**

12 volt: the luminaire is mounted to the wall using two 316 stainless screws through a shallow base 28mm (1 1/8") in depth.

Retro™ (110/240-12volt): a mounting plate is fixed to the wall using two screws and the luminaire is fitted to the mounting plate.

**Luminaire Weight:**

Low voltage

Alum: 0.495kg (1lb 1oz)

Cop: 1.300kg (2lb 13oz)

SS: 1.080kg (2lb 6oz)

Retro™

Alum: 0.900kg (1lb 15oz)

Cop: 1.710kg (3lb 12oz)

SS: 1.500kg (3lb 4oz)



## ACCESSORIES

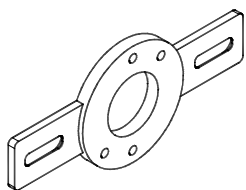

Wall Box Adaptor

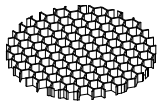

Hex Cell Louvre

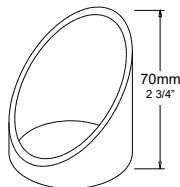

Glare Guard

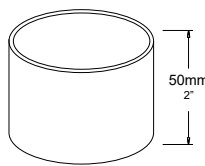

Snoot

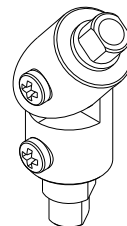

Locking Knuckle

## BEAM ANGLES

High efficiency PMMA TIR lenses. Field replaceable

IES files available for download: [hunzalighting.com/downloads](http://hunzalighting.com/downloads)

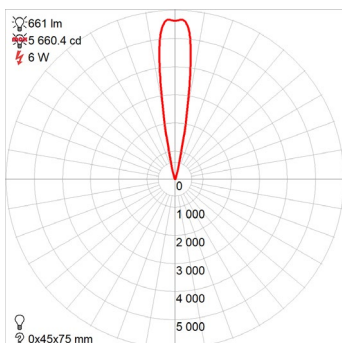

15° FWHM TIR

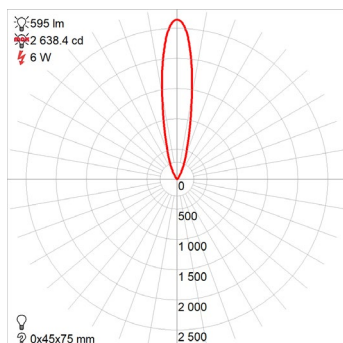

25° FWHM TIR

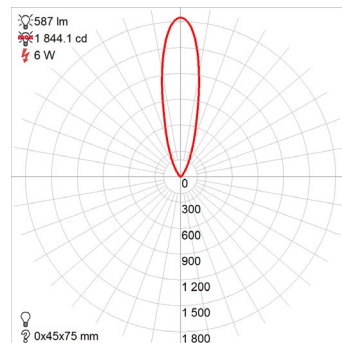

38° FWHM TIR

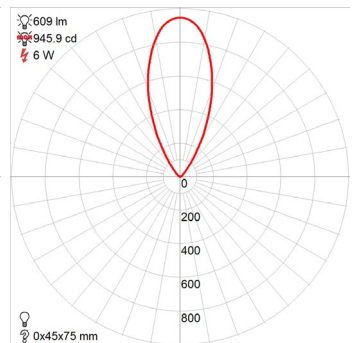

60° FWHM TIR

## WIRING GUIDE

Available for download: [hunzalighting.com/downloads](http://hunzalighting.com/downloads)

**NOTE:** Diagrams are a guide only, wire colours and polarity may change depending on fixture and country.

**Series/Remote Driver**

**12VAC Integral Driver**

**110/240V Retro Driver**

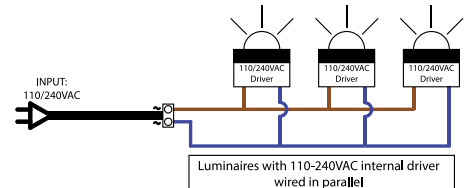
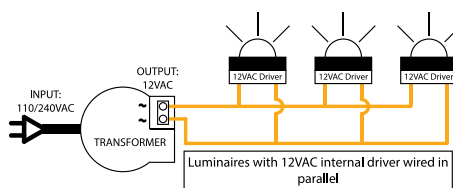
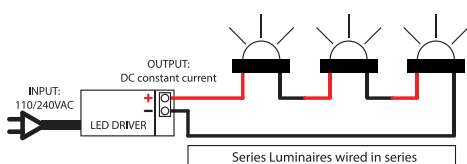

\*Due to continued product enhancements, specifications may change without notification.



**HUNZA LIGHTING**  
130 Felton Mathew Ave  
Saint Johns  
Auckland 1072  
New Zealand

Ph: +64-9-528 9471  
Fax: +64-9-528 9471  
hunza@hunza.co.nz  
www.hunzalighting.com

**INTERNATIONAL CONTACTS:**  
[www.hunzalighting.com/contact](http://www.hunzalighting.com/contact)

This document contains proprietary information of Hunza™. Its receipt or possession does not convey any rights to reproduce or disclose its content.