

Ripple Sconce
Assembly Guide



Thank you for choosing In Common With. Please confirm that you received all of the components pictured in this guide, and reach out to us if anything is missing. It's rare, but it happens. We hope you enjoy your fixture. With proper care, it should last a lifetime.

Have questions? Please contact us at support@incommonwith.com.



CAUTION!

This product must be installed in accordance with the applicable installation code by a person familiar with the construction and operation of the product and the hazards involved. Consult a qualified electrician to ensure correct branch circuit conductor.

ATTENTION!

Ce produit doit être installé selon le code d'installation pertinent, par une personne qui connaît bien le produit et son fonctionnement ainsi que les risques inhérents.

Components

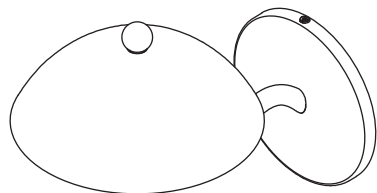

Ripple Sconce Assembly

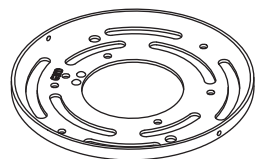

Slim Canopy Backplate



Canopy Screws with Silicone (2)



Class 2 Power Unit

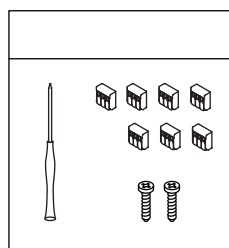

Hardware Pack

Step 1

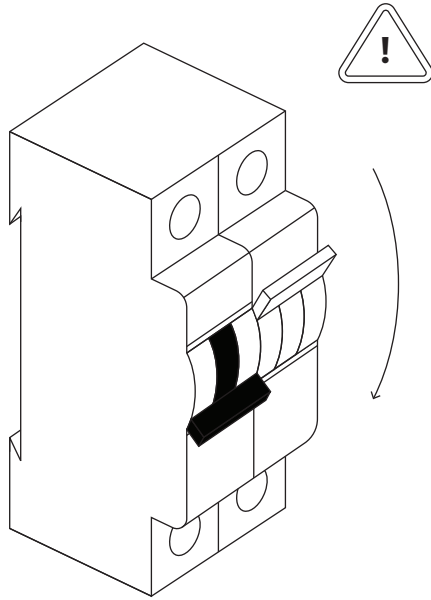

Before beginning installation, turn off electrical power at the main fuse box or circuit panel.

Step 2

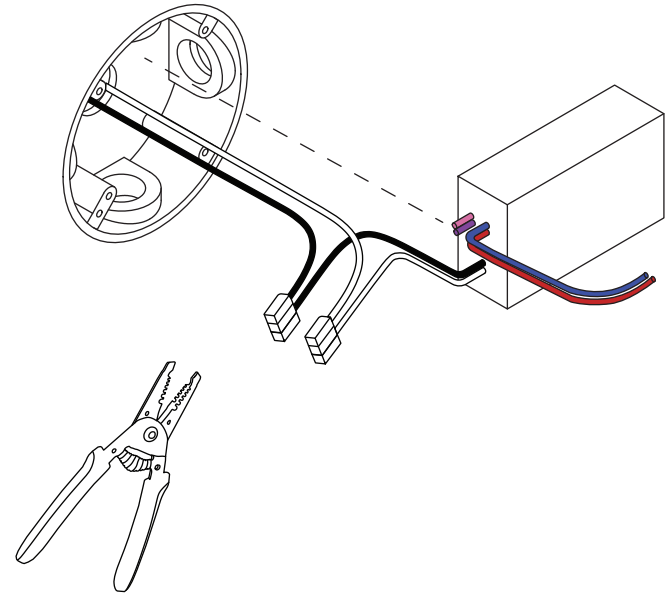

Use only with Class 2 Power Unit with output DC24V constant voltage.
Connect the junction box wires to the Class 2 Power Unit with Wago clips:

White → Neutral

Black → Live

For 0-10V Dimming: Connect pink and purple wires to the same colors dimming system. For TRIAC or ELV Dimming: Cap the pink and purple wires with Wago clips. If needed, strip 3/8" of insulation from each wire before connecting.

If you are using a remote driver, move on to step 4.

Step 3

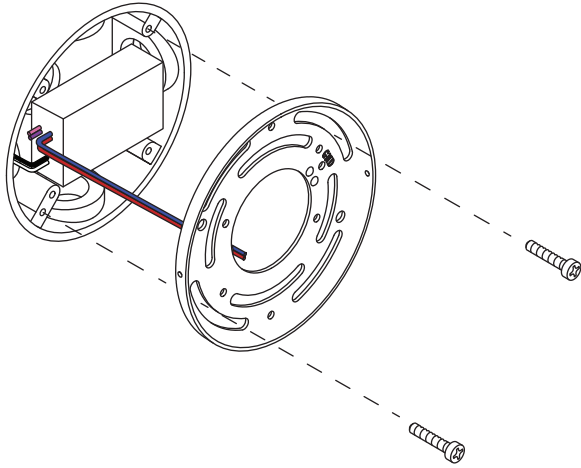

Nest the Class 2 Power Unit into the junction box with the red and blue wires accessible. Ensure easy access to the wires by feeding them through the central opening in the Slim Canopy Backplate. Mount the Slim Canopy Backplate to the junction box using a Phillips head screwdriver to tighten the mounting screws.

Step 4

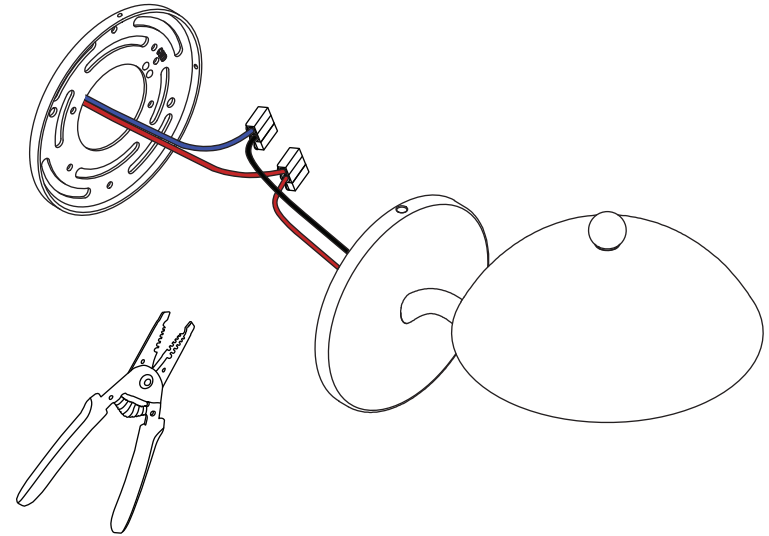

Use Wago clips to connect the Class 2 Power Unit wires to the fixture:

Blue/Black → Neutral

Red → Live

Green/Yellow → Ground

If needed, strip 3/8" of insulation from each wire before connecting.

Step 5

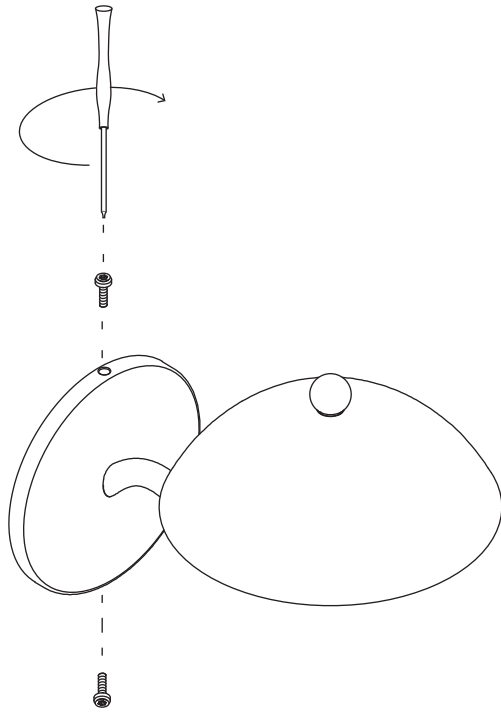

Align the holes of the Slim Canopy Backplate with the holes of the canopy cover. Secure the fixture in place using the Canopy Screws with Silicone and the screwdriver found in the hardware pack. Make sure everything is tightly fixed to ensure the connection is water

Step 6

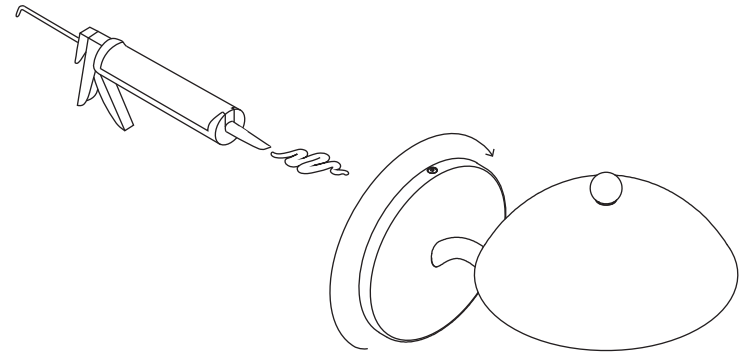

If you are planning to install your Sconce in an outdoor or wet location, it's essential to apply a bead of silicone caulk between the Ripple Sconce Assembly and the wall outside. After applying the silicone, smooth it around the light using your finger that has been dipped in a bowl of water.

However, if you are installing the fixture indoors or in a dry or damp location, you can skip this step.

Step 7

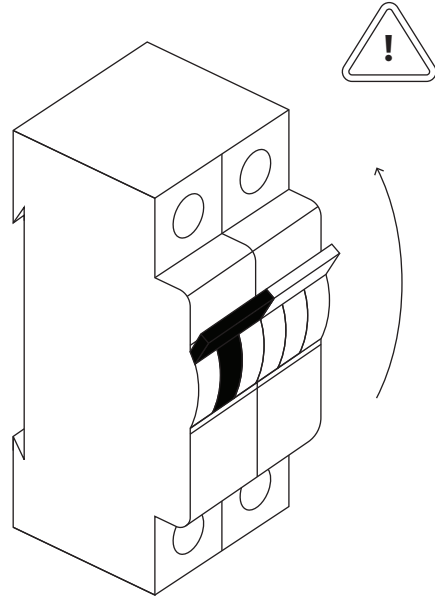

Turn the power back on at the main fuse box or circuit panel you disabled before installation. Turn on the light :)

Care Instructions

Never use scouring pads or abrasive cleaning solutions. If it comes in a bottle, it is bad for your fixture. Instead, we recommend using soft microfiber cloths, which are gentler on our products and the planet.

For Metal: Wipe with a damp or dry microfiber cloth. Please note that our brass is unlaquered, and will darken naturally over time.

For Glass: Wipe clear or colored glass with a damp microfiber cloth. For sandblasted or etched glass, use a dry microfiber cloth. Removable glass shades can be washed carefully in a sink using warm or hot water.

For Ceramic: Wipe with a damp microfiber cloth. Do not submerge in water.

Return Policy

We accept returns for store credit only, minus a 15% restocking fee. We do not accept returns on pieces from the Handmade, Disc, Terra, or Flora series, on the Ceramic or Colored Glass Up Down Sconces, or on items that are not in their original condition. Custom and Rush orders are final sale. Please note that shipping charges are non-refundable.

To request a return, email sales@incommonwith.com within ten days of receiving your order. Requests must be approved before a return can be processed. Requests made after ten days will not be accepted.

All products that come in their own box, including but not limited to light bulbs and accessories, must be returned in their original, undamaged box as this is considered part of the product. Once installed, products are no longer eligible for return.

We reserve the right to reject any returned items that do not meet the above requirements. If your return is rejected you will be notified via email.