

CONTENTS

Sconce

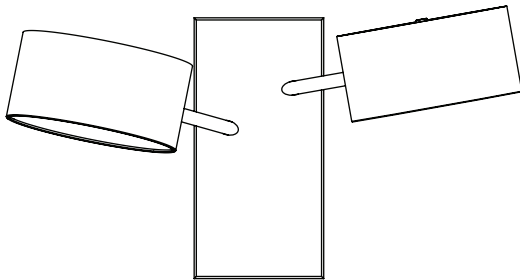

Crossbar



Screws (7)



Allen Key



Top Diffuser

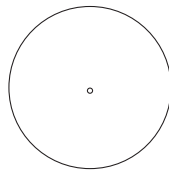

Wire Nuts (2)



Finial Cap



Shade Bracket

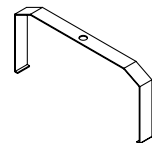

SAFETY INFORMATION

Only one light bulb per socket.

Only suitable for direct mounting on non-combustible surfaces.

Under no circumstances can Excel fixtures be mounted on normally flammable surfaces.

Suitable for dry, indoor use only.

Maximum ambient temperature: 25° C

EXCEL SCONCE INSTALLATION

Note: Please contact a licensed electrician.
Note: Do not use bulbs that exceed 60 watts.
Note: Fixture wire color Brown = White (L)
Blue = Black (N)

1. Connect the wires using wire nuts (A).
2. Install the crossbar (B) and affix the ground strap with the ground screw (C).
3. Affix Crossbar (B) to junction box with screws (D).
4. Register wooden sconce backplate (E) to crossbar (B) and secure with screws (F).
5. Install light bulbs (G) Light bulbs provided by customer.
6. Place bracket (H) onto existing shade bracket so that both form a cross.
7. Place metal diffuser (I) on top of brackets and affix by screwing down cap finial (J).

