

KRISTINA DAM
Studio

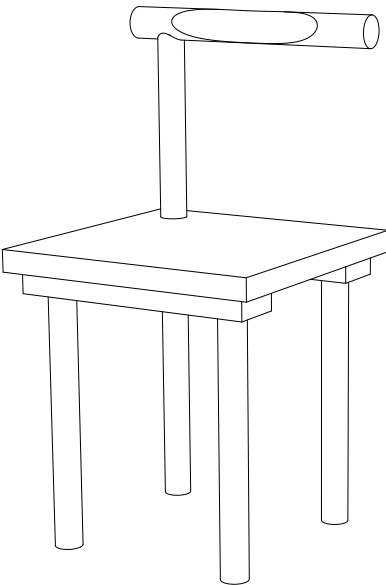

SCULPTURAL CHAIR

Solid Oak
42 L x 42 B x 80 H cm

4 x Felt stickers



Wood glue (not included)



Rubber hammer (not included)



1.

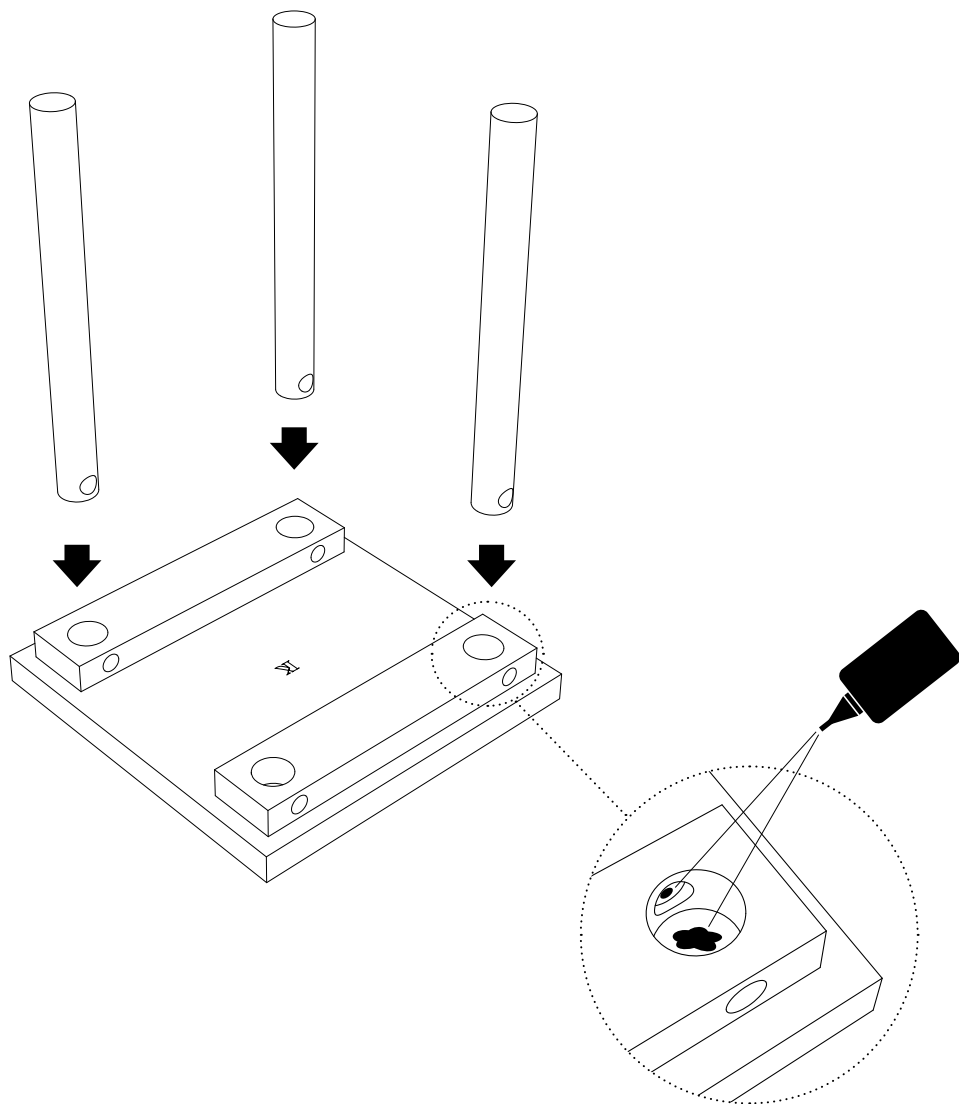

Place a small amount of wood glue in the three closed legholes as shown. Place legs in holes. Make sure that the holes in the legs are parallel with the small holes in the seat. Remove any visible glue with damp cloth.

Wood glue (recommended)



Rubber hammer (if needed)



2.

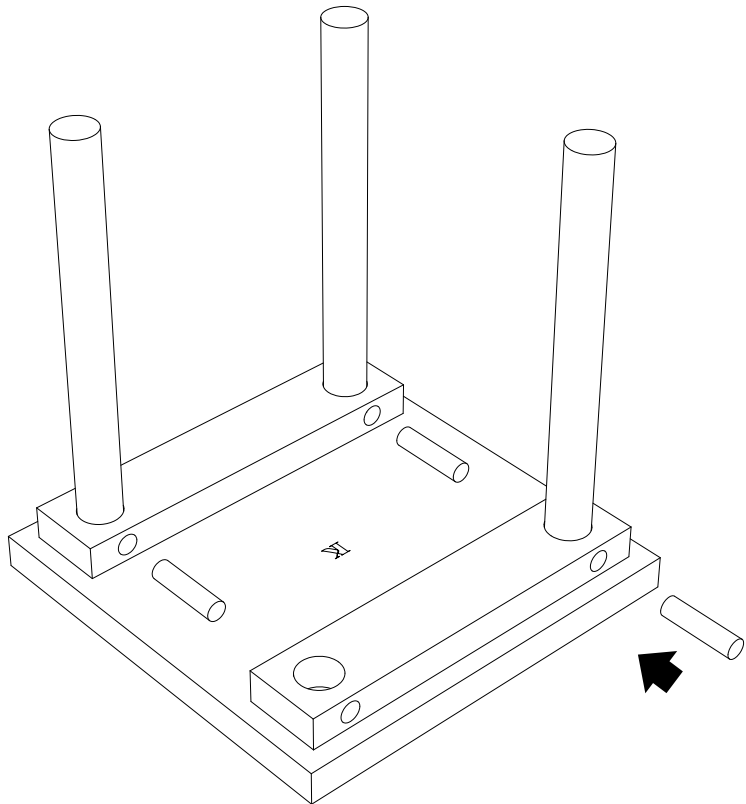

Secure the legs by placing the dowels in the small holes. Hammer them into place. Make sure that only 1 cm of the dowel is visible. Put a cloth between the hammer and the chair, to avoid the hammer from leaving marks.

Rubber hammer (if needed)



3.

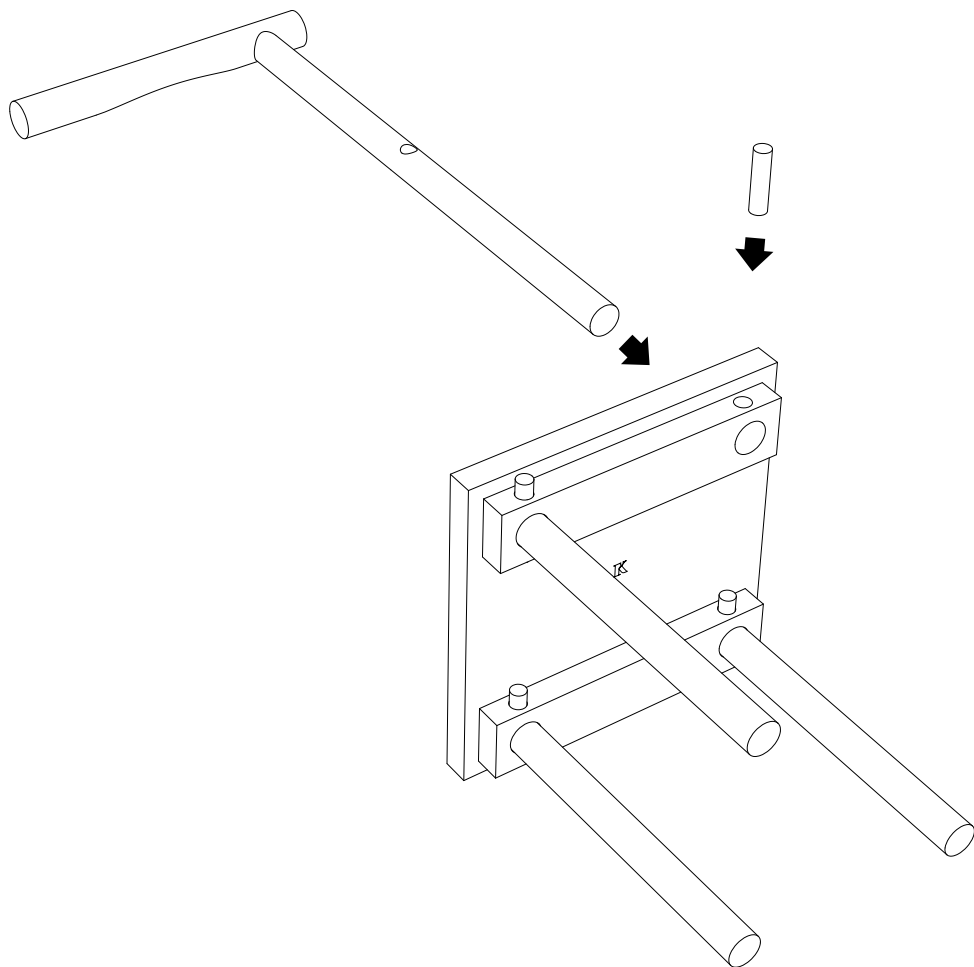

Place the backrest in the last hole and secure it with the final dowel. Hammer it into place. Make sure that it is hammered all the way through. Put a cloth between the hammer and the chair, to avoid the hammer from leaving marks. Put felt stickers underneath all four legs.

4 x Felt stickers



Rubber hammer (if needed)

