

LUNA A SERIES

DESK LAMP
INSTALLATION GUIDE

GABRIEL SCOTT
EST. 2012



IMPORTANT: Please contact the Gabriel Scott technical support for assistance regarding malfunctions and damaged parts.

**+1 (212) 837-2923
support@gabriel-scott.com**

ATTENTION!

The light source contained in this luminaire shall only be replaced by the manufacturer or his service agent or a similar qualified person. Contact manufacturer for service.

For controllable luminaires, the classification of insulation that has been maintained between LV supply and control conductors shall be provided.... basic insulation, reinforced insulation etc.

PROVIDED SUPPLIES

Desk Lamp and glass

INSTRUCTIONS

STEP 1

Carefully slide the provided glass bead on the glass tube.

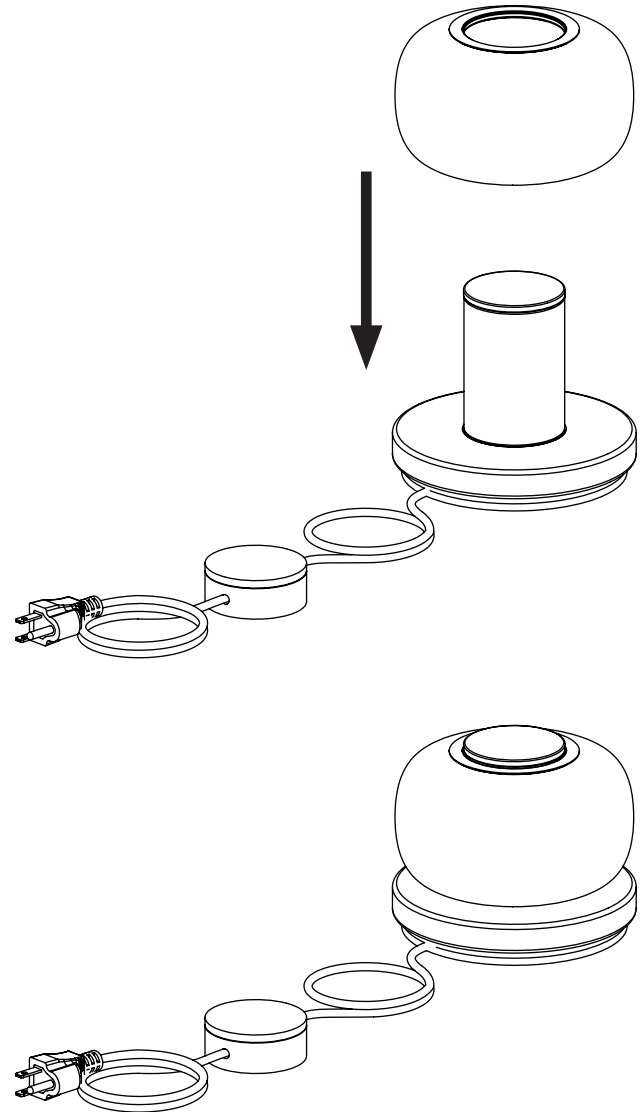

CARE GUIDE

METAL

Wipe with a clean water-dampened cloth. Cleaning with any solvents or chemicals is not recommended as it may cause tarnishing.

GLASS

Use a lint free cloth with a glass cleaner and gently wipe the glass surfaces. Any generic glass cleaner is suitable. It is best to spot test the product in an inconspicuous area before proceeding.

MARBLE

Wipe with a clean water-dampened cloth.

NOTE:

The marble does not come sealed and is therefore susceptible to stains. Do not use any chemicals or solvents as this will stain the marble.

