

INSTALLATION INSTRUCTION

LED Deck Light

LC-253603/LC-253703

WAC

SAFETY INSTRUCTION

IMPORTANT: NEVER attempt any work without shutting off the electricity.

- Read all instructions before installing.
- System is intended for installation by a qualified electrician in accordance with the National Electrical Code and local regulations.
- Place the wall switch in the "OFF" position.
- Go to the main fuse box, or circuit breaker. Unscrew the fuse(s) or switch "OFF" the circuit breaker switch(es) that control the power to the space that you are working on.

WARNING: Risk of electric shock. Install all luminaires 10 feet (3.05 m) or more from a pool, spa, or fountain.

CAUTION:

All parts must be used as indicated in these instructions. Do not substitute any parts, leave parts out, or use any parts that are worn out or broken. Failure to follow this instruction could invalidate the UL listing of this fixture.

AVERTISSEMENT

IMPORTANT : COUPEZ L'ÉLECTRICITÉ AVANT TOUTE MANIPULATION.

- Lisez toutes les instructions avant d'installer.
- Système est destiné à être installé par un électricien qualifié en conformité avec le code national de l'électricité et les règlements locaux.
- Placez l'interrupteur mural en position d'arrêt (« OFF »).
- Accédez au panneau central de disjoncteurs ou de fusibles de votre demeure et placez l'interrupteur principal en position d'arrêt (« OFF »).

MISE EN GARDE:

Toutes les pièces doivent être utilisées tel qu'il est indiqué dans ces instructions. Ne remplacez pas les pièces, n'en laissez pas de côté et ne les utilisez pas si elles sont usées ou brisées. Le non-respect de ces instructions peut annuler l'homologation UL du luminaire.

*Note: Transformer is required to power the fixture. (sold separately)

THESE INSTRUCTIONS APPLY TO THE MODELS BELOW:

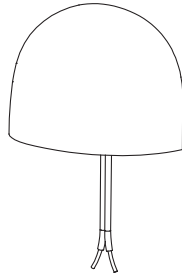

LC-253603

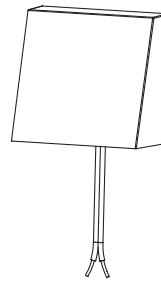

LC-253703

Mounting Accessories

A



Outdoor Rated Wire Connector
Qty: 3pcs

B



Wood Screw
Qty: 3pcs

C



Plastic Anchor
Qty: 3pcs

Waclighting.com
Phone (800) 526.2588
Fax (800) 526.2585

Headquarters, East Manufacturing Facility
44 Harbor Park Drive
Port Washington, NY 11050

South East Manufacturing Facility
1600 Distribution Ct
Lithia Springs, GA 30122

Central Manufacturing Facility
1700 South J Elmer Freeway, Ste 100
Cedar Hill, TX 75104

West Manufacturing Facility
1750 S Archibald Ave
Ontario, CA 91761

INSTALLATION INSTRUCTION

LED Deck Light

LC-253603/LC-253703

WAC

PREPARATION

1. Carefully unpack your new fixture and lay out all the parts on a clear area. Be careful not to lose any parts necessary for installation.
2. Shut off the power at the circuit breaker and remove existing fixture, including the crossbar.

MOUNTING THE FIXTURE

3. Drill holes in the wall aligned with the key holes located on the mounting bracket. Insert the plastic anchor (C).
4. Secure the mounting bracket to the wall using the wood screw(B) in the parts package.(FIG.1)
Note: using any other non-original-manufacturer provided wood screw may result in safety issue.
5. The lamp can switch between five color temperatures (2700K-3000K -3500K-4000K-5000K) which can be adjusted to your preference with the switch on the fixture. (FIG.2)

- Note:** Fixture must be powered off to adjust the CCT setting, after each CCT adjustment cycle power on, off then on to show new CCT setting.
6. Align the groove at the back of the fixture with the mounting bracket. push the fixture forward until it fits against the wall. (FIG.3)

CONNECTING THE WIRES (FIG. 4)

*Note: Transformer is required to power the fixture. (sold separately)

7. Connect the fixture input wires to the transformer by fastening the screw at the output end of the transformer.
8. If it is necessary to extend the wiring distance, take another two-core power wire and connect the wire with transformer.
9. Cut the power wire at the desired location. Separate the power supply wire into two individual wires by lightly pulling on each side so that a couple inches are separated.
10. Strip off ½ inch of the insulating material from each wire and connect one to each of the wires from the fixture using the outdoor rated wire connectors(A) provided.

FIG.1

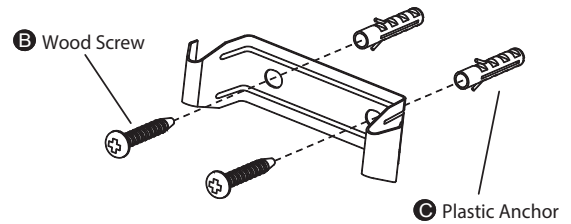

FIG.2

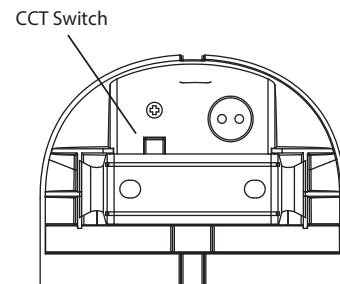

FIG.3

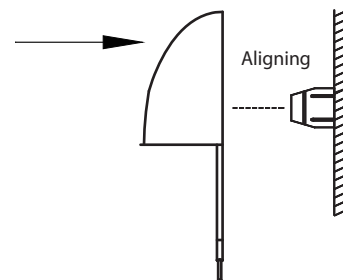

FIG.4

