



1718 W. Fullerton Chicago, IL 60614  
 Ph: 773.770.1195 • Fax: 773.935.5613  
 www.PureEdgeLighting.com • info@PureEdgeLighting.com  
 © 2016 PureEdge Lighting. All Rights Reserved.

## Installation Instructions for Cirrus Suspension Wall Wash with Glare Shield, Remote Power and 2" Canopy

CSWSH\_\_-2\_-\_\_

### IMPORTANT INFORMATION

- This product is suitable for indoor locations.
- This instruction shows a typical installation.
- It is recommended more than one person to assist in this installation.

**SAVE THESE INSTRUCTIONS!**



### Section One: Install the 2" Plaster Ring

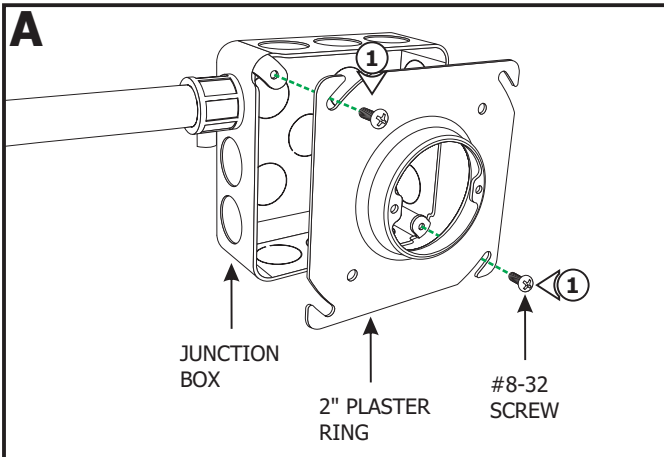

**NOTE:** Junction box must be mounted to allow clearance of 1/2" between the face of the junction box and the drywall surface.

**NOTE:** Ensure that the remote 24VDC power supply wires are present inside the junction box before continuing. Refer to the installation instructions provided with power supply.

#### For New Construction:

- 1:** Install the 2" plaster ring to the junction box using two #8-32 screws.

- 2:** Use a circular saw to cut out the drywall section where the plaster ring is located.

- 3:** Install the drywall. If necessary plaster, and finish the drywall.

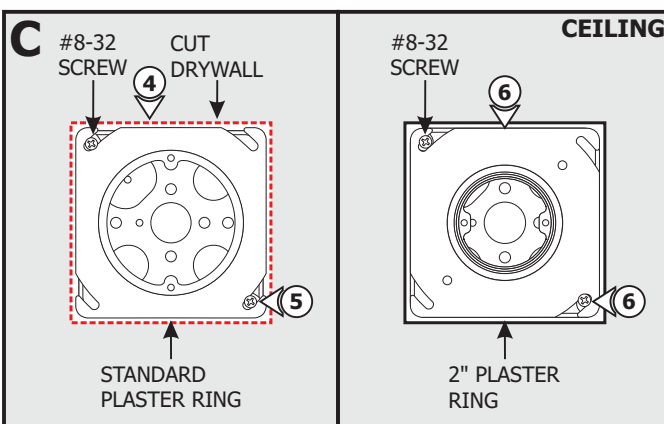
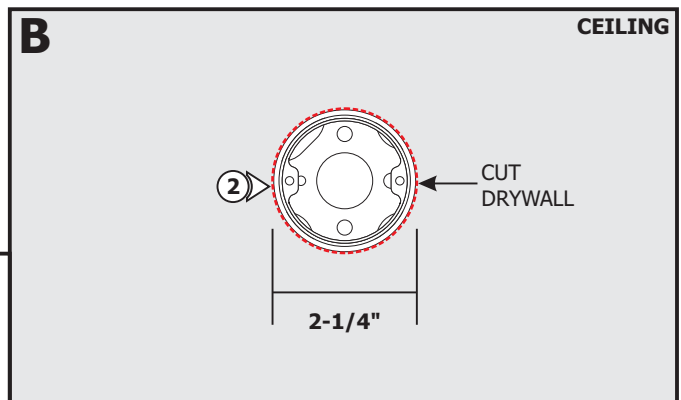

#### For Remodeling:

- 4:** Cut away the drywall where the junction box is located.
- 5:** Uninstall the existing plaster ring by removing the #8-32 screws.
- 6:** Install the 2" Plaster Ring to the junction box using two #8-32 screws.
- 7:** Plaster and finish around the junction box opening.

## Section Two: Adjusting Cable Position

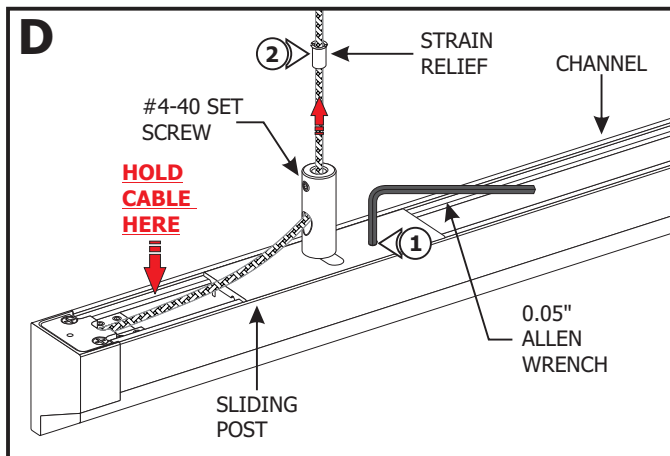

**WARNING:** To avoid damaging the coaxial cable electrical connection, make sure that the end of the coaxial cable coming out of the fixture is held with thumb before relocating sliding posts.

### Power Cable:

- 1:** Loosen (**DO NOT REMOVE**) the #4-40 set screws on the sliding post cord grip post and bed with a 0.05" Allen wrench.
- 2:** Slide the strain relief tube out of the sliding post using a pair of needle-nose pliers.

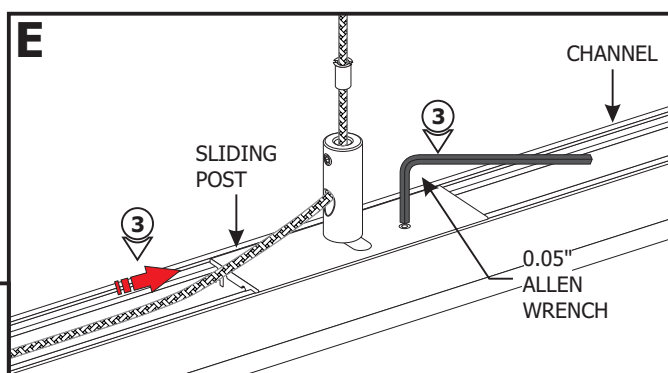

- 3:** Carefully move the sliding post to the predetermined location on channel and tighten the #4-40 set screw on the sliding post bed with the 0.05" Allen wrench.

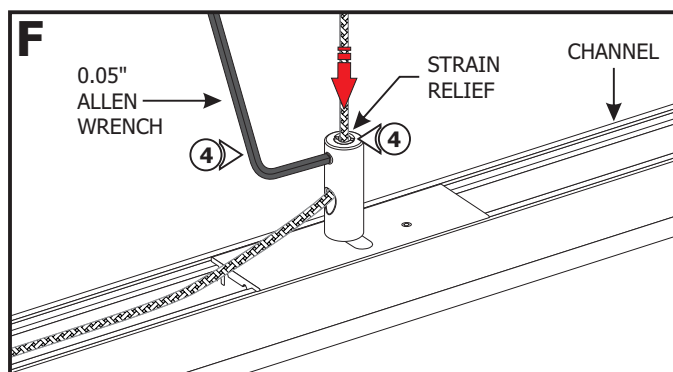

**CAUTION!** Tightening the strain relief set screw **CANNOT BE REVERSED**. Only tighten the set screw **AFTER** the cable location is set properly.

- 4:** Insert the strain relief tube back inside the cord grip post and tighten the #4-40 set screws with the 0.05" Allen wrench.

### Aircraft Cable:

- 5:** Loosen (**DO NOT REMOVE**) the #4-40 set screw on the sliding post using a 0.05" Allen wrench.
- 6:** Adjust the position by moving the sliding post across the channel. Tighten the set screw to secure in place.
- 7:** Repeat step 5 and 6 for remaining supports.

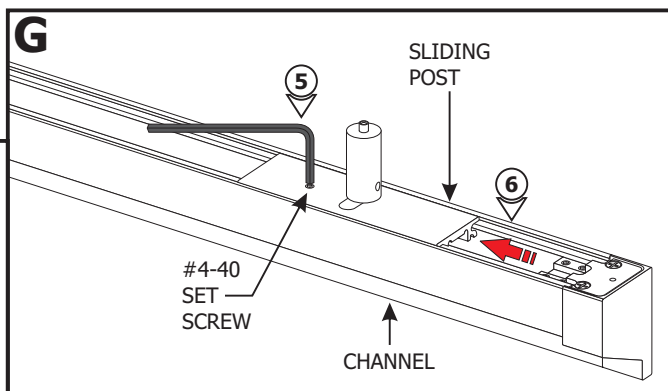

## Section Three: Install the Support Standoff or Support Canopy

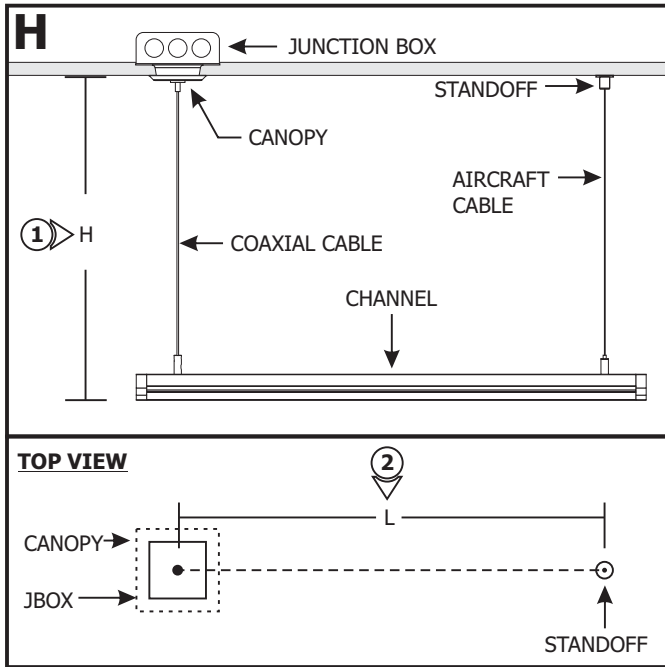

**NOTE:** Run the proper size wires between the 24VDC power supply to the electrical box. Refer to the instructions provided with the power supply for additional information.

**NOTE:** Omit Section Five if the channel is made out of a single piece.

**1:** Determine the fixture height (H) from the bottom of the channel to the top of the canopy.

**2:** Determine the fixture length (L). Measure the distance between the coaxial cable and the aircraft cable on the channel. Mark the standoff location on the ceiling from the center of the junction box.

**NOTE:** Steps 3 and 4 are for drywall mounting. Omit these steps if mounting directly to a wood surface.

**3:** For each provided standoff, tap the anchor onto the marked location up to the threaded portion with a hammer.

**4:** Screw in the threaded portion of the anchors with a Phillips screwdriver.

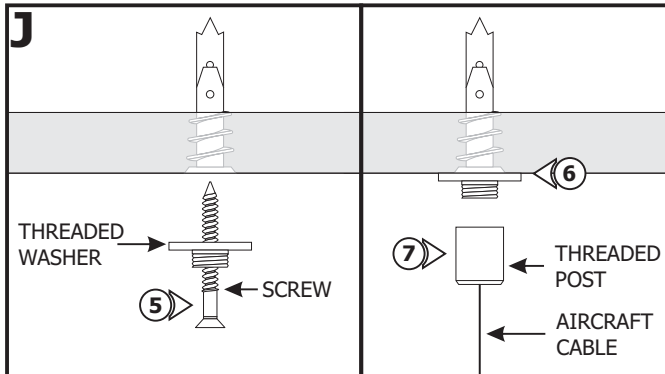
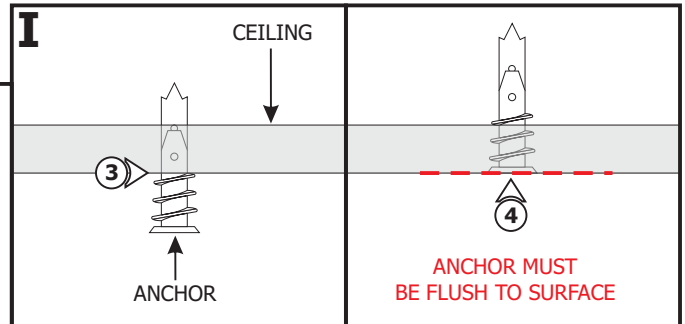

**NOTE:** Omit steps 5 through 7 if using support canopy. Refer to steps 8 through 11.

**Support Standoff:**

**5:** Feed the #8 screw through the threaded washer.

**6:** Tighten the #8 screw completely into the anchor.

**7:** Feed the aircraft cable through the threaded post. Tighten the threaded post completely onto the threaded washer.

**Support Canopy:**

**8:** Feed the #8 screw through the threaded washer and 2" washer respectively into the anchor.

**9:** Tighten the #8 screw completely into the anchor.

**10:** Feed the aircraft cable through the threaded post. Tighten the threaded post completely onto the threaded washer.

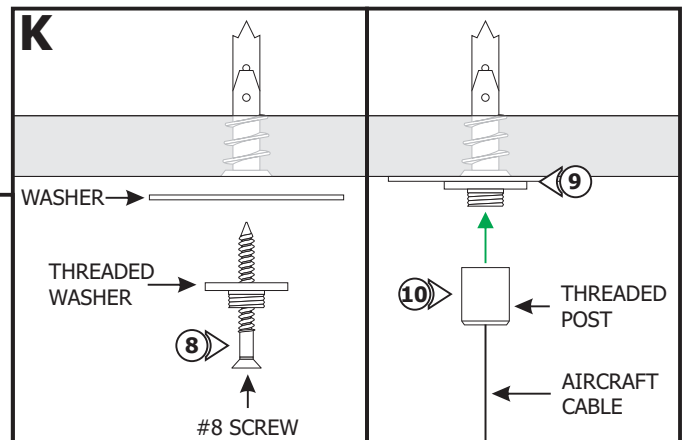

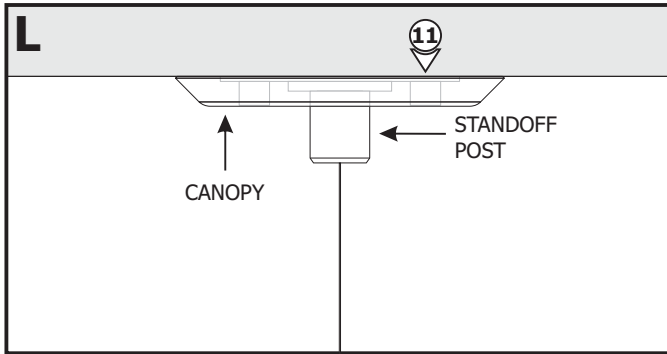

**11:** Place the canopy over the standoff post and magnetically attach the canopy to the washer.

**12:** Insert the aircraft cable through the top of the tab on the sliding post.

**13:** Adjust the height of the fixture by pushing the tab and pulling the aircraft cable out of the side of the sliding post. Release the tab to secure the cable in place.

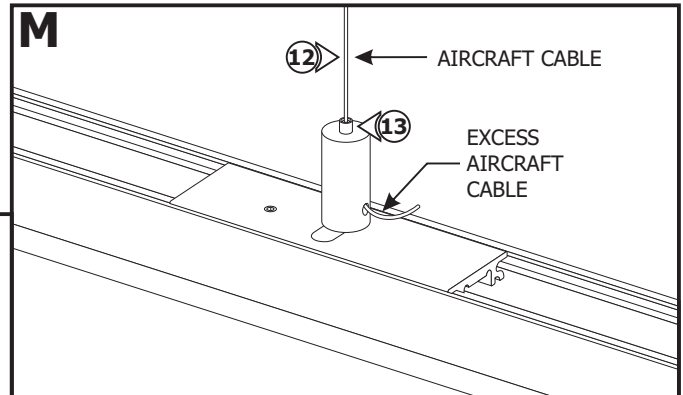

## Section Four: Power the Fixture

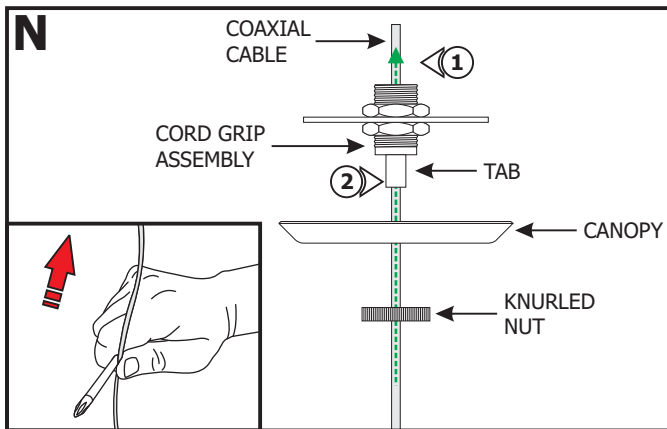

**1:** Feed the coaxial cable through the knurled nut, 2" canopy and cord grip assembly respectively.

**2:** Adjust the fixture height by pushing the cord grip tab to slide the cable up and down until the desired height is achieved. Release the tab to lock the cable in place.

**NOTE:** If cable is curled or kinked, straighten by holding between the shaft of a screwdriver and thumb and pulling the cable through (see inset).



**NOTE:** Scan the QR Code to watch the video clip of the following steps or visit [www.PureEdgeLighting.com/video\\_feed/installation\\_cxc\\_connector](http://www.PureEdgeLighting.com/video_feed/installation_cxc_connector)

**3:** Use the 18AWG hole of the wire stripper to remove 1-3/8" of the outer insulation to expose the braided wire.

**4:** Use the 18AWG hole of the wire stripper to remove 1" of the braided wire making sure not to nick the inner wire insulation.

**5:** Use the 20AWG hole of the wire stripper to remove 1/8" of the inner insulated wire.

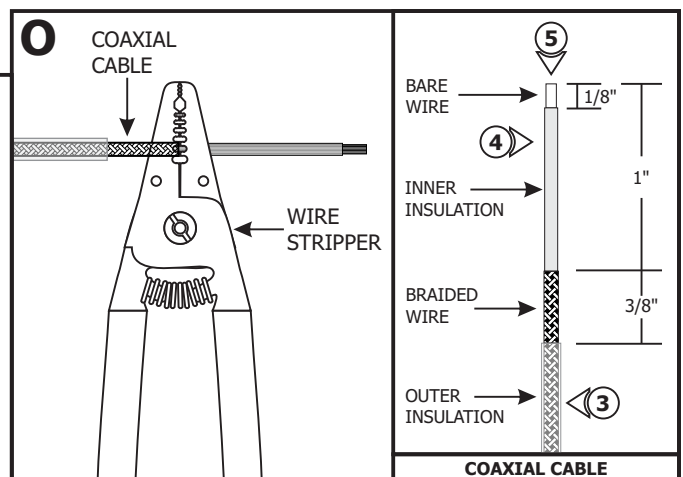

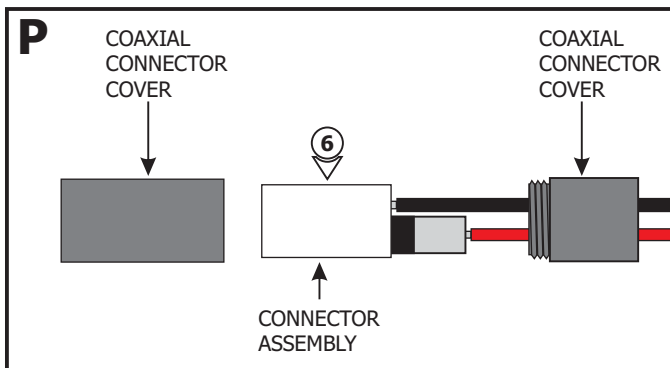

**6:** Unscrew the coaxial connector covers and remove from the connector assembly.

**7:** Using the provided 1.5mm Allen wrench, remove the M3 set screw from the coaxial connector assembly.

**8:** Using the provided 2mm Allen wrench to loosen (**Do Not Remove**) the M4 set screw.

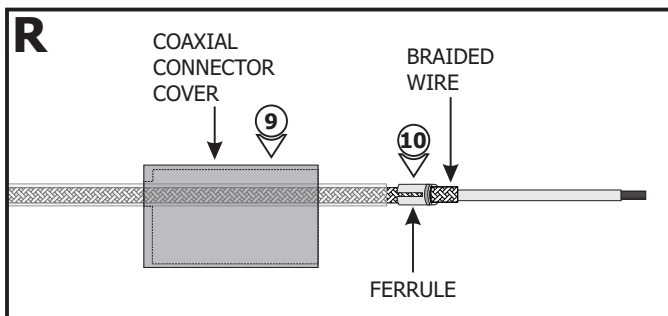
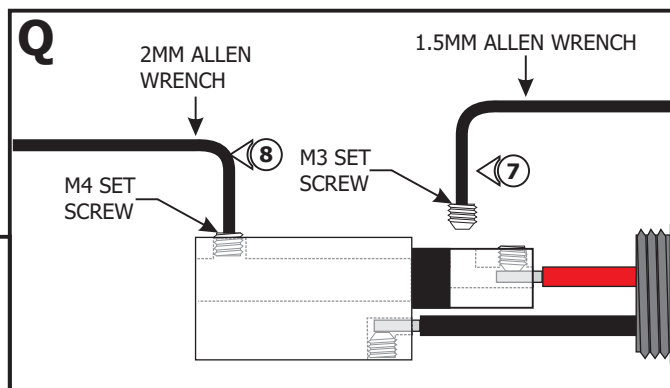

**9:** Slide the connector cover over the coaxial cable.

**10:** Place the ferrule over the 3/8" braided wire of the coaxial cable.

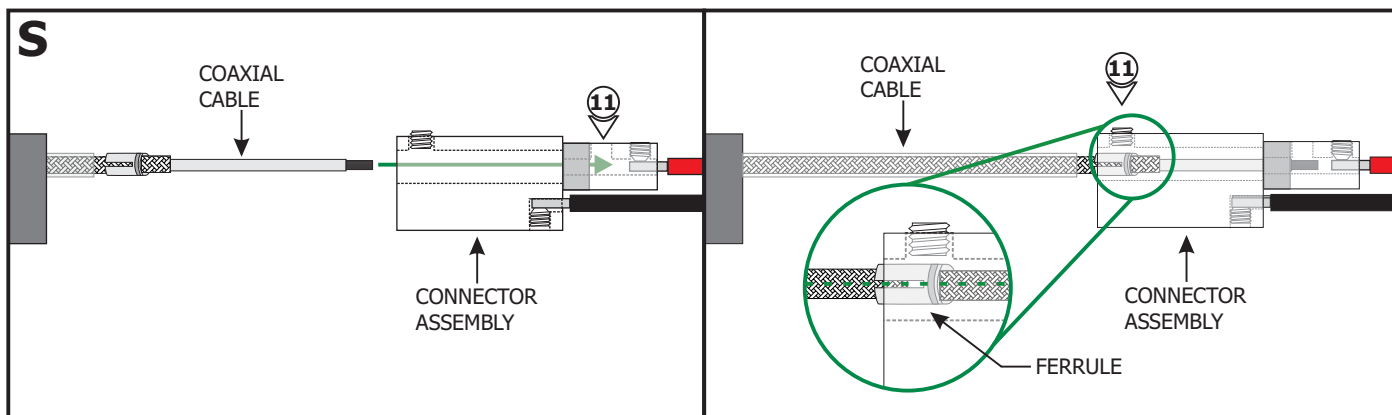

**11:** Insert the coaxial cable into the coaxial connector until the wires of the center conductor are visible through the M3 set screw hole.

**NOTE:** Ensure that the split in the ferrule is aligned 90° from the M4 set screw (see inset).

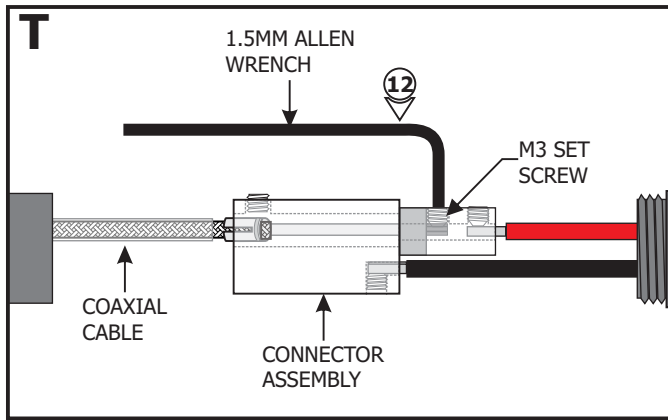

**12:** Use the provided 1.5mm Allen wrench to replace and securely tighten the M3 set screw.

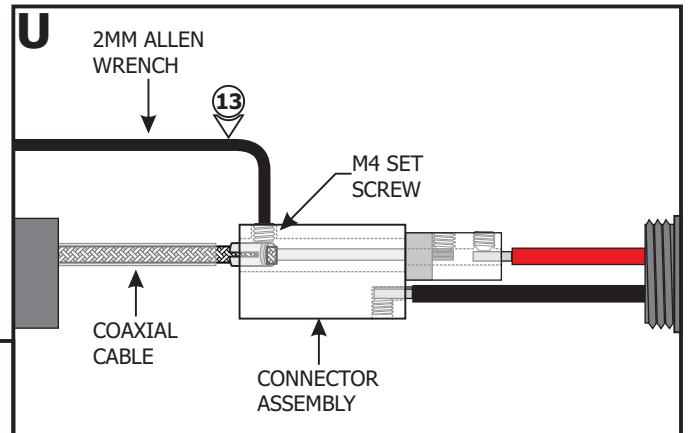

**13:** Use the provided 2mm Allen wrench to securely tighten the M4 set screw until it squeezes the wire ferrule tightly to the coaxial cable.

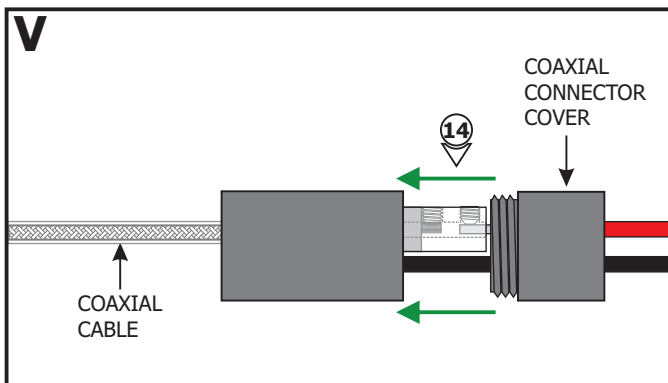

**14:** Replace the coaxial connector cover and tighten into place.

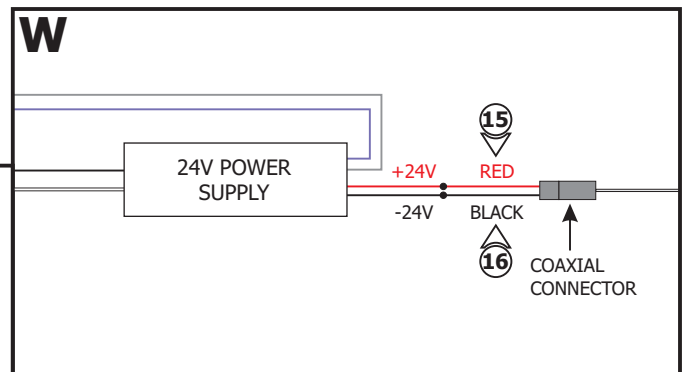

**15:** Connect the red coaxial connector wire to the +24VDC power supply wire using a wire nut.

**16:** Connect the black coaxial connector wire to the -24VDC power supply wire using a wire nut.

**17:** Place all connections inside the junction box.

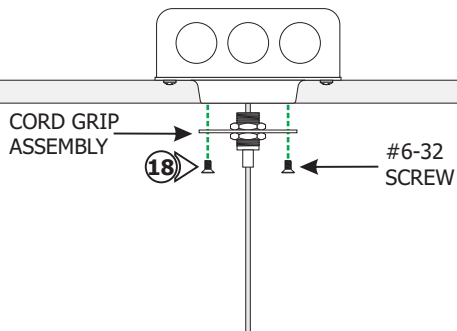
**X**

**18:** Mount the cord grip assembly to the 2" plaster ring using two #6-32 screws.

**19:** Place the canopy over the cord grip against the ceiling. Secure it in place by tightening the knurled nut to the cord grip. **Make sure the knurled cap is not cross threaded.**

**20:** If necessary, press the tab on the cord grip to adjust the cable height.

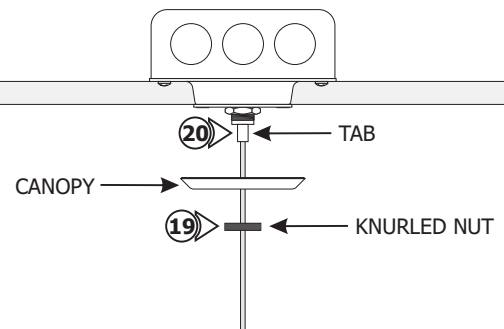
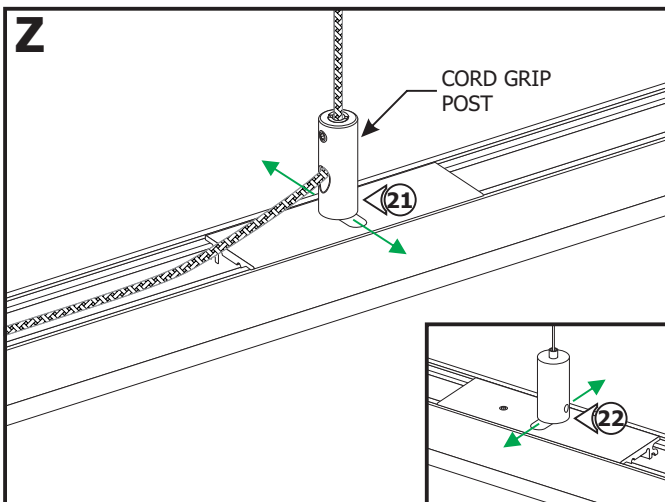
**Y****Z**

**21:** If necessary, slightly loosen (**DO NOT REMOVE**) the cord grip post by rotating it counter clockwise; balance the fixture by adjusting the position on the sliding post back and forth. Ensure the channel is straight then tighten the post clockwise to secure in place.

**22:** Repeat step 21 for each sliding post.

## Section Five: Connecting Channel Sections

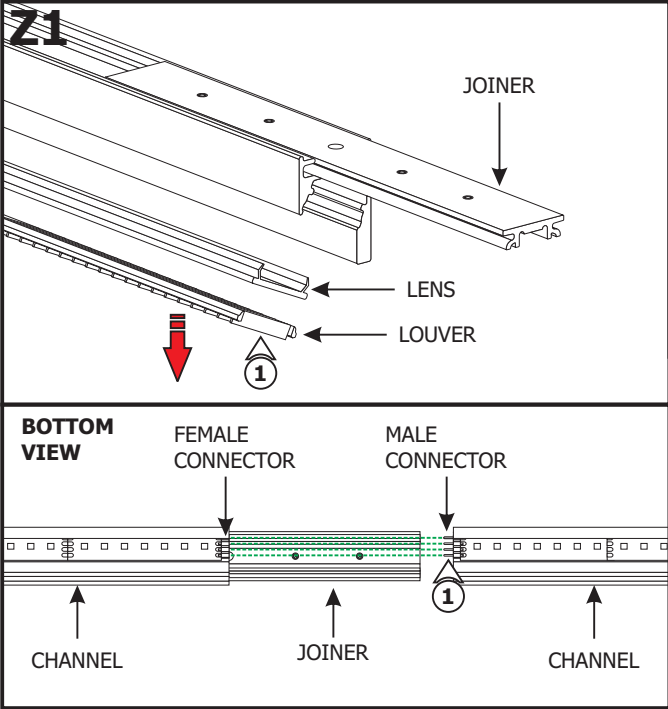

**NOTE:** Omit this section if the joiner did not come with the fixture depending on the overall fixture length.

**NOTE:** If applicable, multiple channels must be installed one by one.

**1:** Lift a section of the lens and louver at the end of the channels where the connectors are visible. Slide the channel over the joiner and ensure the male & female connectors mate properly.

**2:** Push the lens and louver back into the channel.

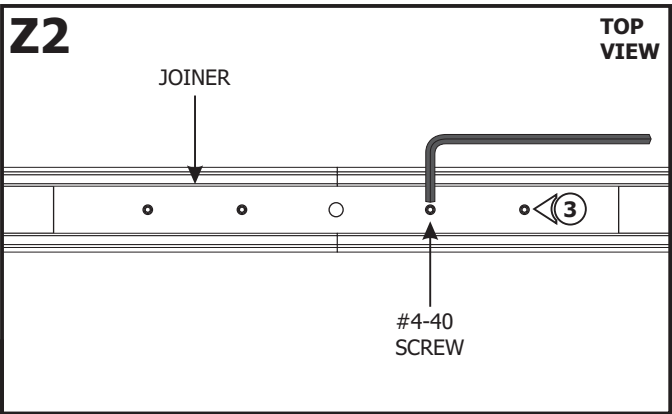

**3:** Tighten the remaining #4-40 set screws using the 0.05" Allen wrench.

## General Wiring Diagram

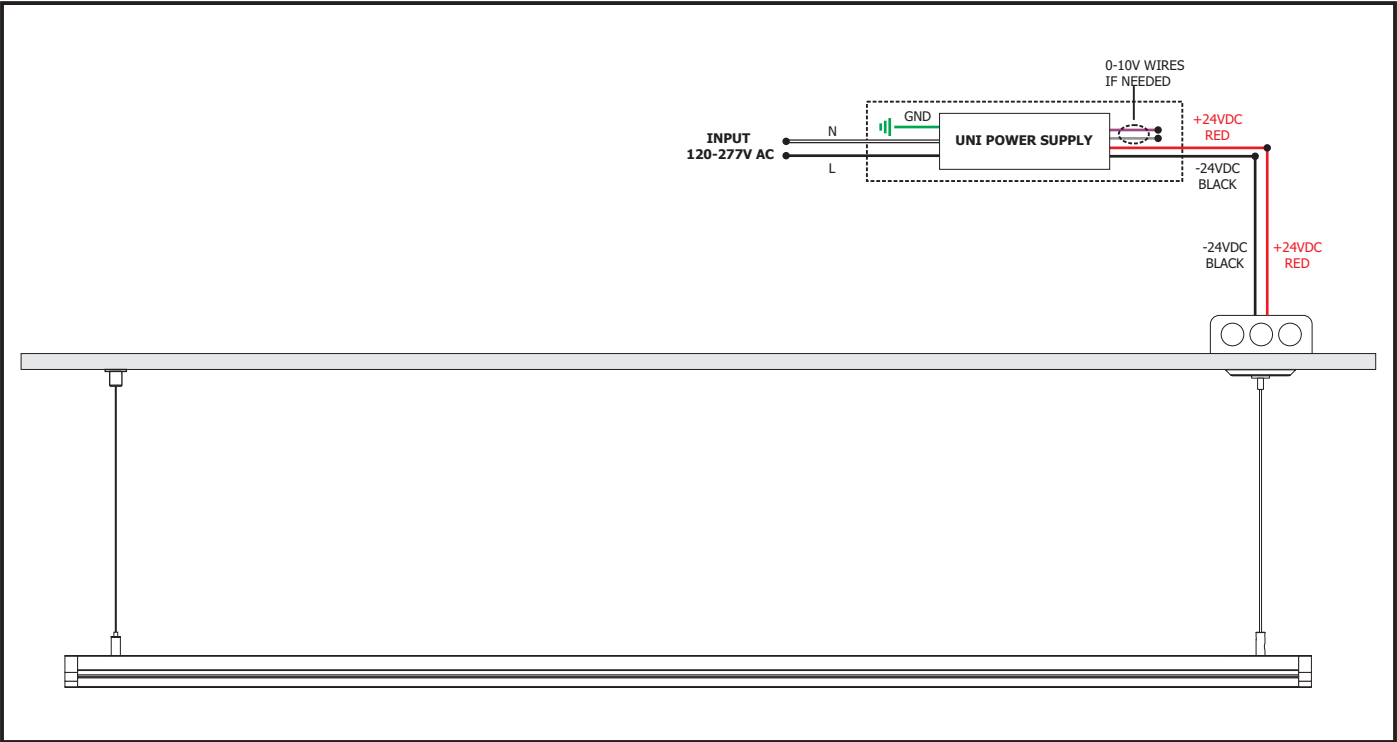





1718 W. Fullerton Chicago, IL 60614  
 Ph: 773.770.1195 • Fax: 773.935.5613  
 www.PureEdgeLighting.com • info@PureEdgeLighting.com  
 © 2016 PureEdge Lighting. All Rights Reserved.

## Installation Instructions for Cirrus Suspension Wall Wash with Glare Shield, Remote Power and 4" Canopy

CSWSH \_\_-4\_-\_\_

### IMPORTANT INFORMATION

- This product is suitable for indoor locations.
- This instruction shows a typical installation.
- It is recommended more than one person to assist in this installation.

**SAVE THESE INSTRUCTIONS!**



### Section One: Adjusting Cable Position

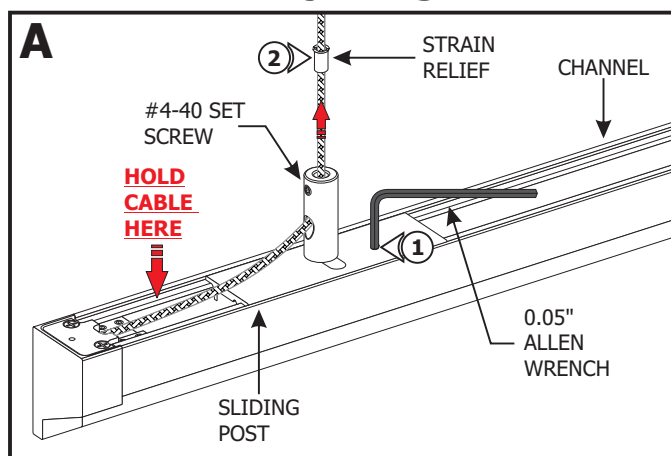

**WARNING:** To avoid damaging the coaxial cable electrical connection, make sure that the end of the coaxial cable coming out of the fixture is held with thumb before relocating sliding posts.

#### Power Cable:

- 1: Loosen (**DO NOT REMOVE**) the #4-40 set screws on the sliding post cord grip post and bed with a 0.05" Allen wrench.
- 2: Slide the strain relief tube out of the sliding post using a pair of needle-nose pliers.

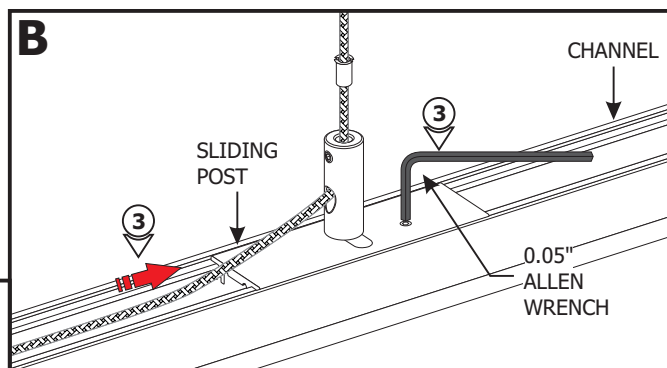

- 3: Carefully move the sliding post to the predetermined location on channel and tighten the #4-40 set screw on the sliding post bed with the 0.05" Allen wrench.

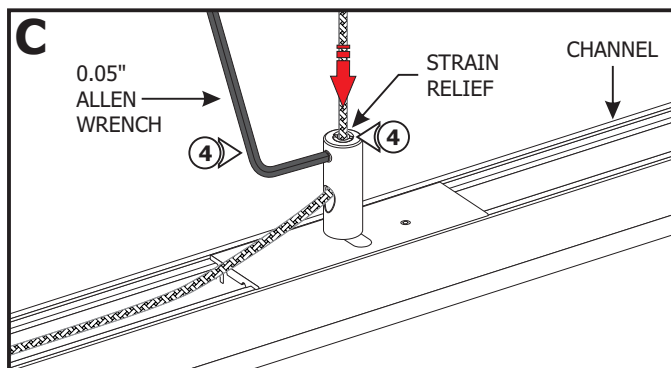

**CAUTION!** Tightening the strain relief set screw **CANNOT BE REVERSED**. Only tighten the set screw **AFTER** the cable location is set properly.

- 4: Insert the strain relief tube back inside the cord grip post and tighten the #4-40 set screws with the 0.05" Allen wrench.

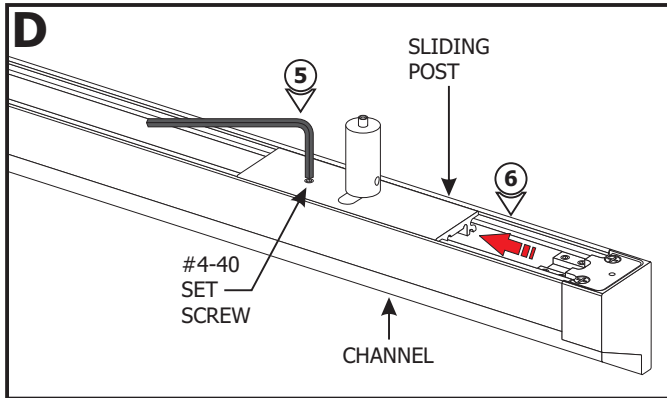

#### Aircraft Cable:

**5:** Loosen (**DO NOT REMOVE**) the #4-40 set screw on the sliding post using a 0.05" Allen wrench.

**6:** Adjust the position by moving the sliding post across the channel. Tighten the set screw to secure in place.

**7:** Repeat step 5 and 6 for remaining supports.

## Section Two: Install the Support Standoff or Support Canopy

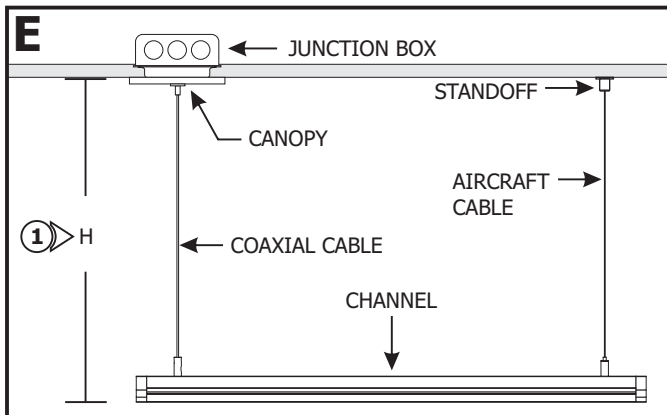

**NOTE:** Run the proper size wires between the 24VDC power supply to the electrical box. Refer to the instructions provided with the power supply for additional information.

**NOTE:** Omit Section Four if the channel is made out of a single piece.

**1:** Determine the fixture height (H) from the bottom of the channel to the top of the canopy.

**2:** Determine the fixture length (L). Measure the distance between the coaxial cable and the aircraft cable on the channel. Mark the standoff location on the ceiling from the center of the junction box.

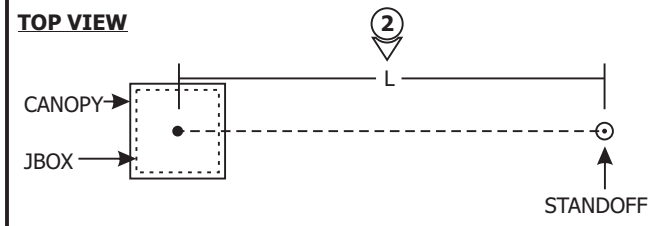

**NOTE:** Omit steps 3 through 7 if using support canopy. Refer to steps 8 through 12.

**NOTE:** Steps 3 and 4 are for drywall mounting. Omit these steps if mounting directly to a wood surface.

#### Support Standoff:

**3:** For each provided standoff, tap the anchor onto the marked location up to the threaded portion with a hammer.

**4:** Screw in the threaded portion of the anchors with a Phillips screwdriver.

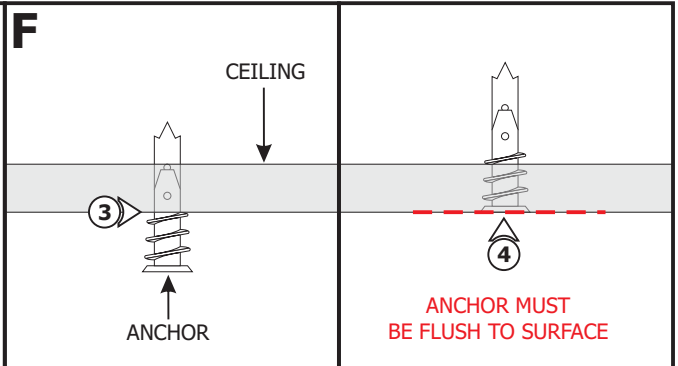

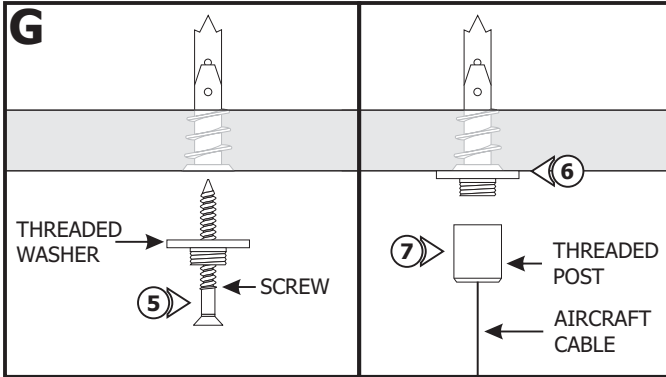

**5:** Feed the #8 screw through the threaded washer.

**6:** Tighten the #8 screw completely into the anchor.

**7:** Feed the aircraft cable through the threaded post. Tighten the threaded post completely onto the threaded washer.

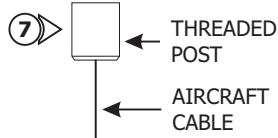

**Support Canopy:**

**8:** Mark two points through the crossbar holes onto the ceiling.

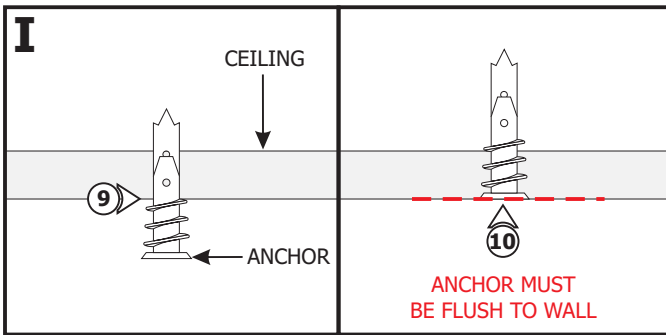
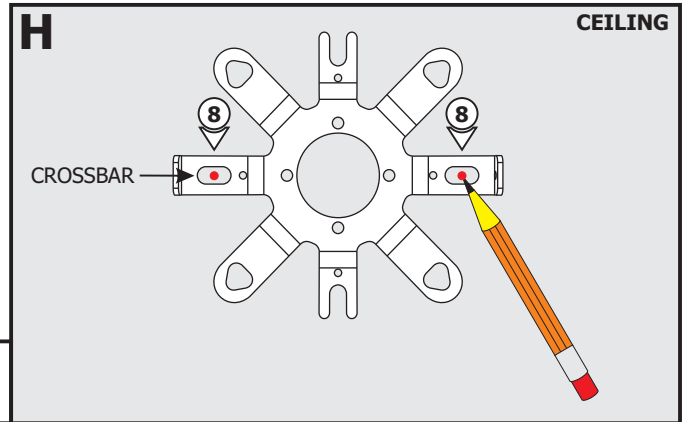

**NOTE:** Steps 9 and 10 are for drywall mounting. Omit these steps if mounting directly to a wood surface.

**9:** Tap the anchors onto the marked points up to the threaded portion with a hammer.

**10:** Screw in the threaded portion of the anchors with a Phillips screwdriver.

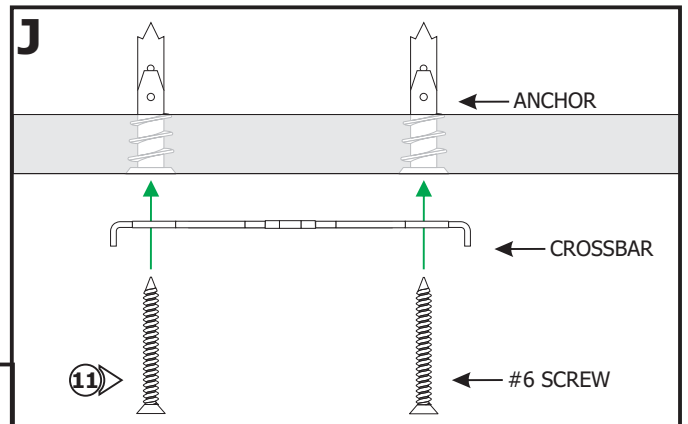

**11:** Secure the crossbar to the anchors using the two #6 screws.

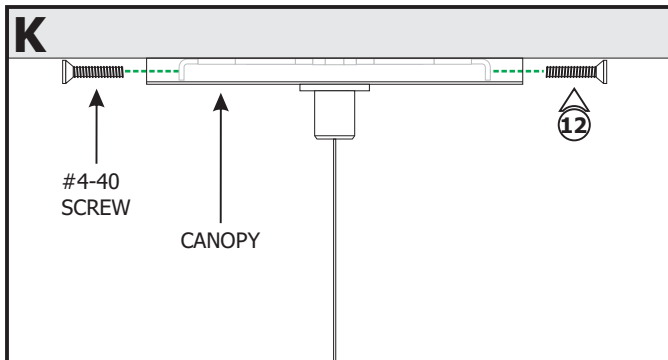

**12:** Align the canopy with the crossbar and secure it using the two #4-40 screws using a 1/16" Allen wrench.

**13:** Insert the aircraft cable through the top of the tab on the sliding post.

**14:** Adjust the height of the fixture by pushing the tab and pulling the aircraft cable out of the side of the sliding post. Release the tab to secure the cable in place.

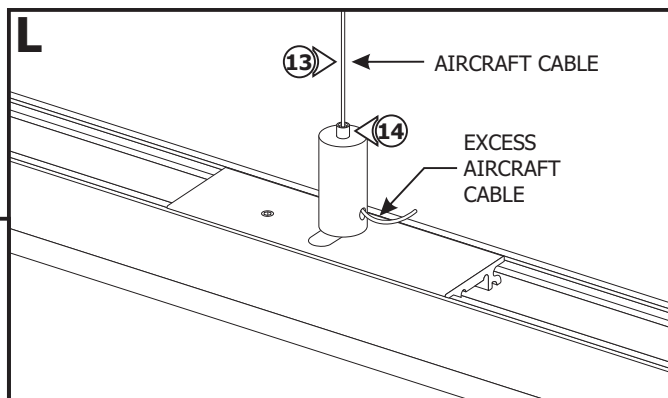

## Section Three: Power the Fixture

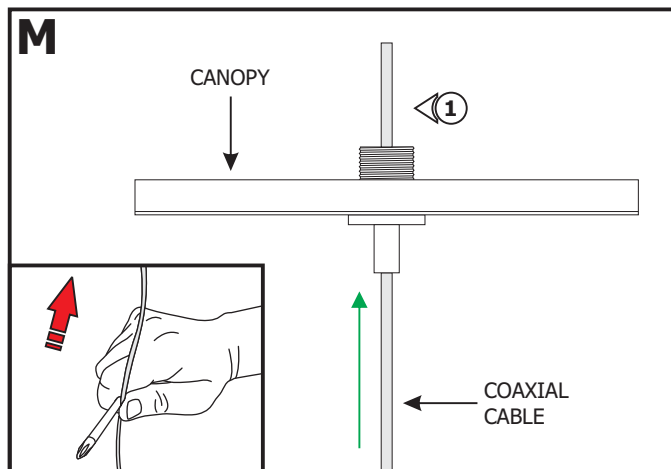

**1:** Feed the coaxial cable through the canopy.

**NOTE:** If cable is curled or kinked, straighten by holding between the shaft of a screwdriver and thumb and pulling the cable through (see inset).



**NOTE:** Scan the QR Code to watch the video clip of the following steps or visit [www.PureEdgeLighting.com/video\\_feed/installation\\_cxc\\_connector](http://www.PureEdgeLighting.com/video_feed/installation_cxc_connector)

**2:** Use the 18AWG hole of the wire stripper to remove 1-3/8" of the outer insulation to expose the braided wire.

**3:** Use the 18AWG hole of the wire stripper to remove 1" of the braided wire making sure not to nick the inner wire insulation.

**4:** Use the 20AWG hole of the wire stripper to remove 1/8" of the inner insulated wire.

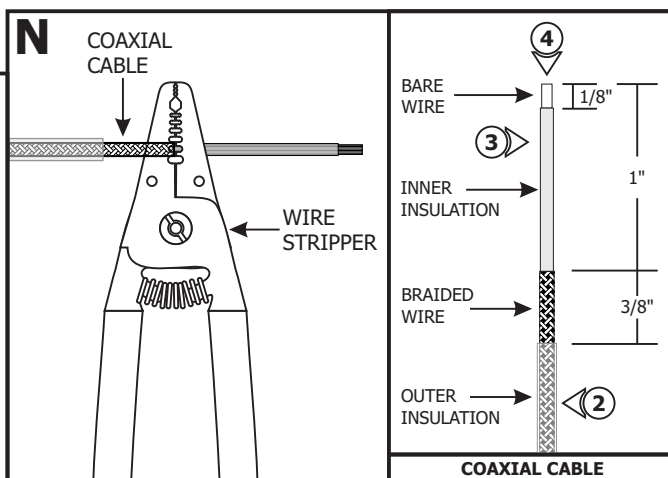

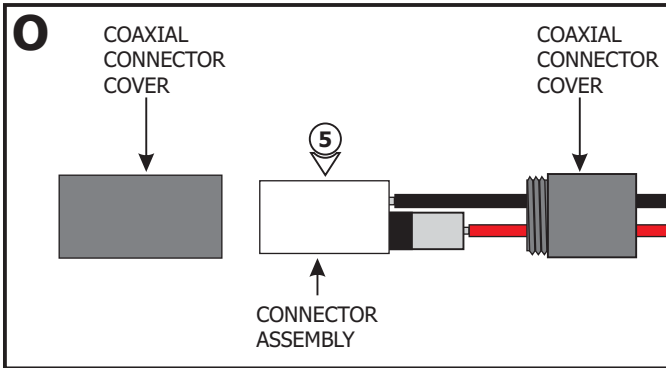

**5:** Unscrew the coaxial connector covers and remove from the connector assembly.

**6:** Using the provided 1.5mm Allen wrench, remove the M3 set screw from the coaxial connector assembly.

**7:** Using the provided 2mm Allen wrench to loosen (**Do Not Remove**) the M4 set screw.

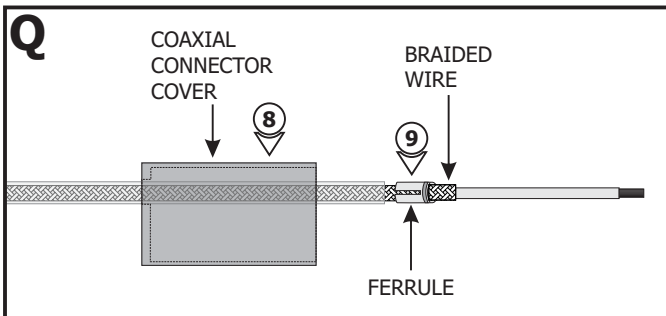
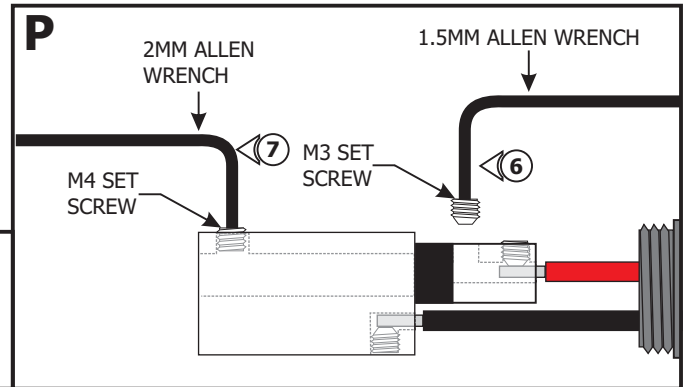

**8:** Slide the connector cover over the coaxial cable.

**9:** Place the ferrule over the 3/8" braided wire of the coaxial cable.

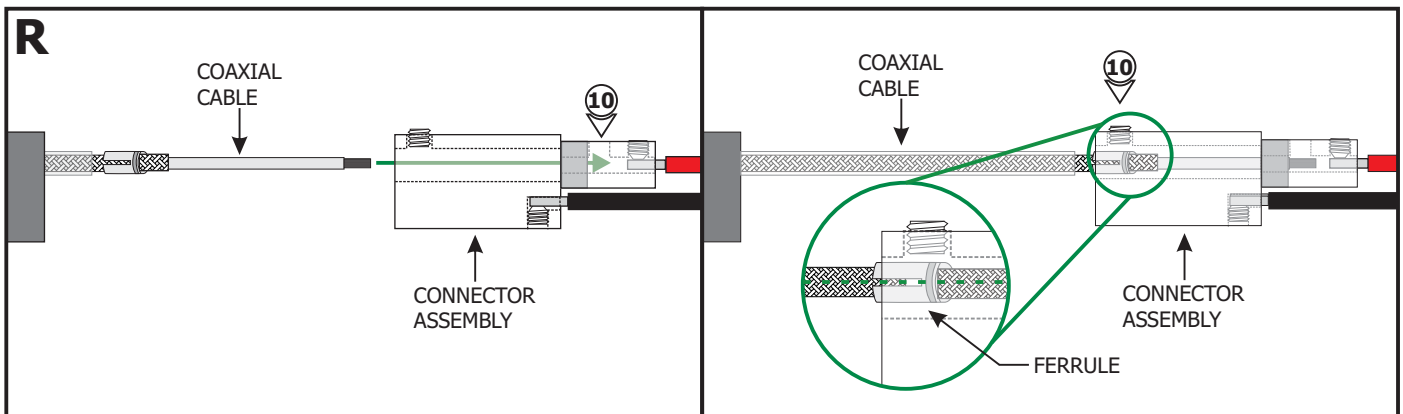

**10:** Insert the coaxial cable into the coaxial connector until the wires of the center conductor are visible through the M3 set screw hole.

**NOTE:** Ensure that the split in the ferrule is aligned 90° from the M4 set screw (see inset).

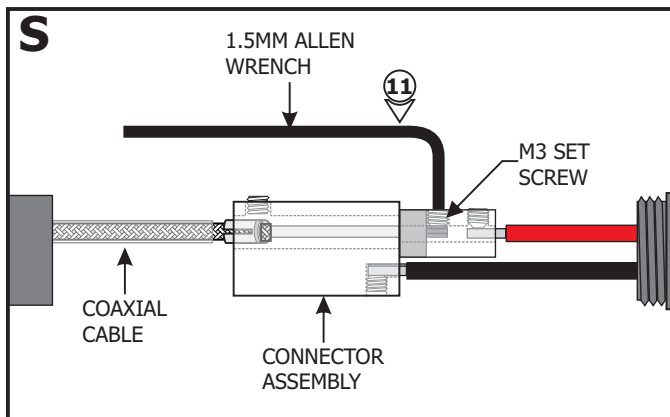

**11:** Use the provided 1.5mm Allen wrench to replace and securely tighten the M3 set screw.

**12:** Use the provided 2mm Allen wrench to securely tighten the M4 set screw until it squeezes the wire ferrule tightly to the coaxial cable.

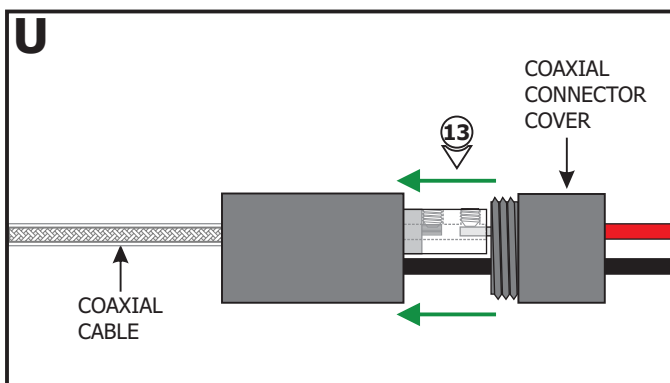
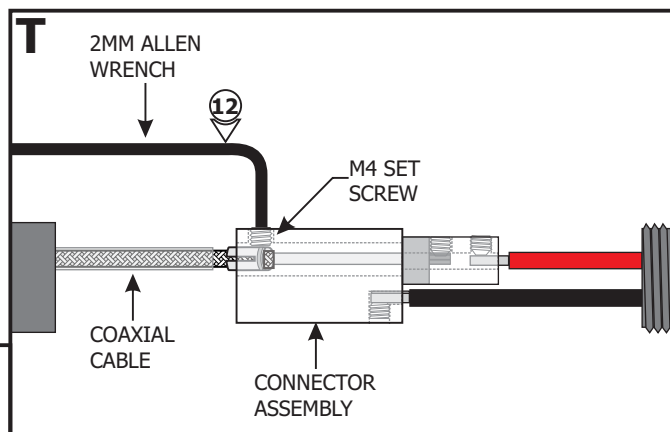

**13:** Replace the coaxial connector cover and tighten into place.

**NOTE:** Ensure remote power supply wires are present in the junction box. Refer to instructions provided with the power supply.

**14:** Feed the low voltage wires from the power supply through the crossbar center hole.

**15:** Mount the crossbar to the junction box holes with two #8-32 screws.

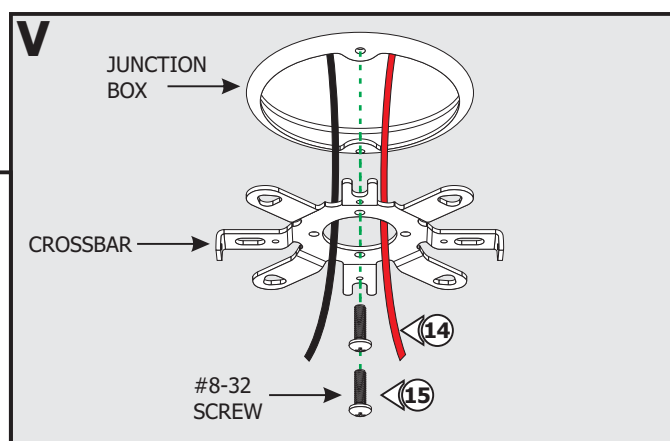

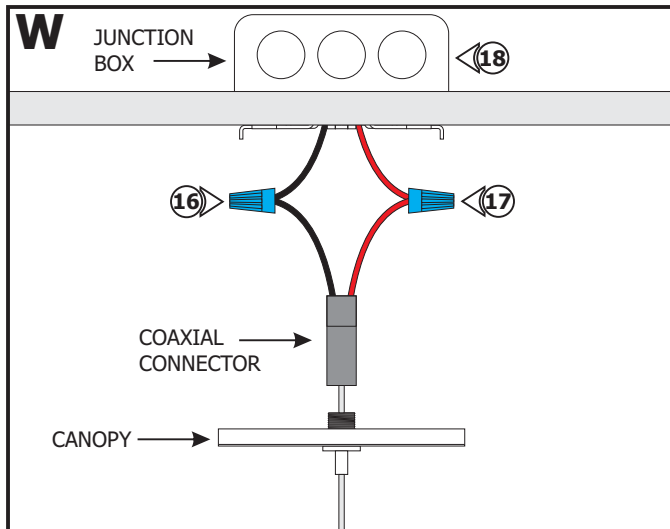

**16:** Connect the black wire of the coaxial connector to the -24VDC power supply wire using a wire nut.

**17:** Connect the red wire of the coaxial connector to the +24VDC power supply wire using a wire nut.

**18:** Place all connections inside the junction box.

**19:** Align the canopy with the crossbar and secure it using the two #4-40 screws using a 1/16" Allen wrench.

**20:** Adjust the fixture height by pushing the cord grip to slide the fixture up and down until the desired height is achieved. Release the tab to lock the coaxial cable in place.

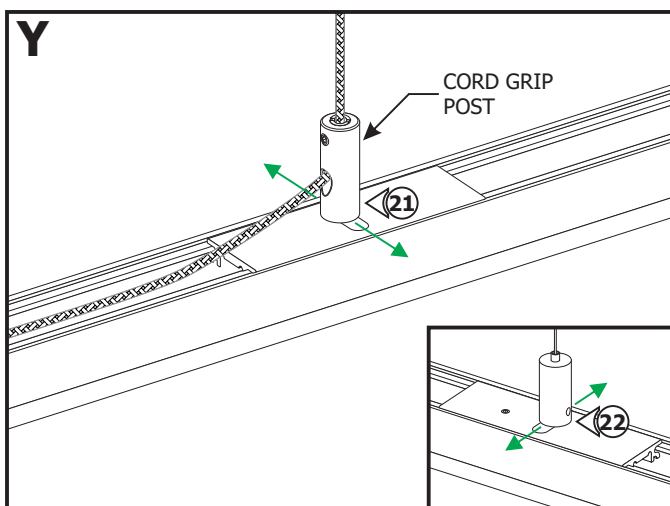
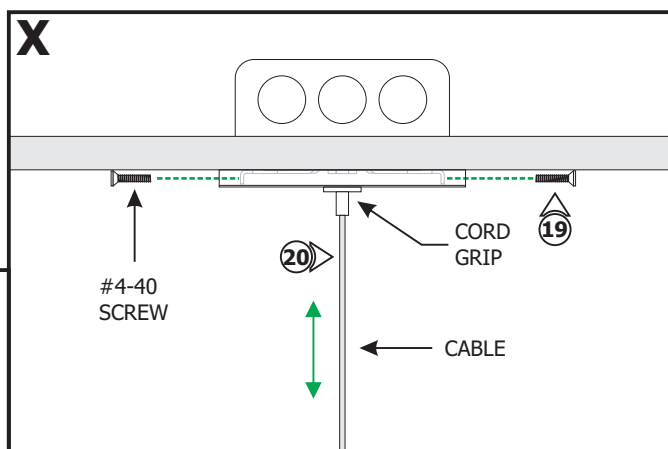

**21:** If necessary, slightly loosen (**DO NOT REMOVE**) the cord grip post by rotating it counter clockwise; balance the fixture by adjusting the position on the sliding post back and forth. Ensure the channel is straight then tighten the post clockwise to secure in place.

**22:** Repeat step 21 for each sliding post.

# Section Four: Connecting Channel Sections

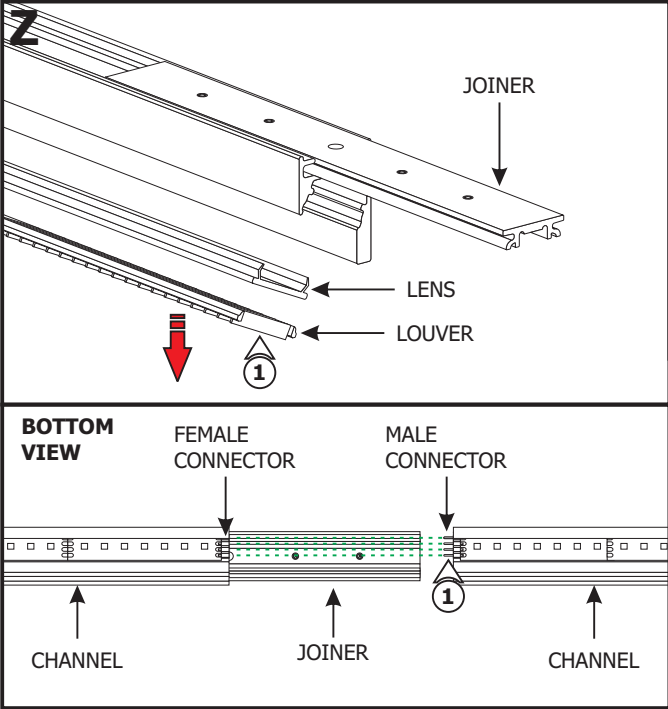

**NOTE:** Omit this section if the joiner did not come with the fixture depending on the overall fixture length.

**NOTE:** If applicable, multiple channels must be installed one by one.

**1:** Lift a section of the lens and louver at the end of the channels where the connectors are visible. Slide the channel over the joiner and ensure the male & female connectors mate properly.

**2:** Push the lens and louver back into the channel.

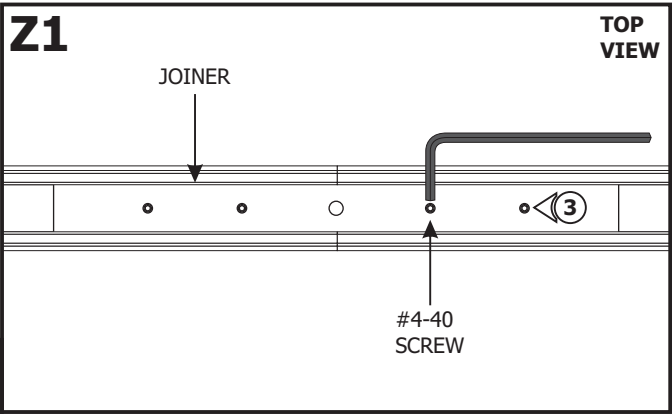

**3:** Tighten the remaining #4-40 set screws using the 0.05" Allen wrench.

## General Wiring Diagram

