



1718 W. Fullerton Chicago, IL 60614  
 Ph: 773.770.1195 • Fax: 773.935.5613  
 www.PureEdgeLighting.com • info@PureEdgeLighting.com  
 © 2016 PureEdge Lighting. All Rights Reserved.

## Installation Instructions for **Cirrus Suspension Wall Wash with Glare Shield, Remote Power and 2" Canopy, Tunable White**

CSWSH \_\_-2\_-\_\_

### IMPORTANT INFORMATION

- This product is suitable for indoor locations.
- This instruction shows a typical installation.
- It is recommended more than one person to assist in this installation.

**SAVE THESE INSTRUCTIONS!**



### Section One: Install the 2" Plaster Ring

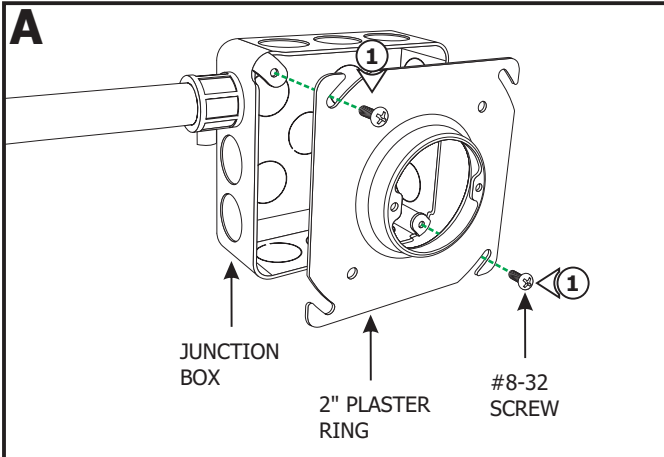

**NOTE:** Junction box must be mounted to allow clearance of 1/2" between the face of the junction box and the drywall surface.

**NOTE:** Ensure that the remote 24VDC power supply wires are present inside the junction box before continuing. Refer to the installation instructions provided with power supply.

#### For New Construction:

- 1:** Install the 2" plaster ring to the junction box using two #8-32 screws.

- 2:** Use a circular saw to cut out the drywall section where the plaster ring is located.

- 3:** Install the drywall. If necessary plaster, and finish the drywall.

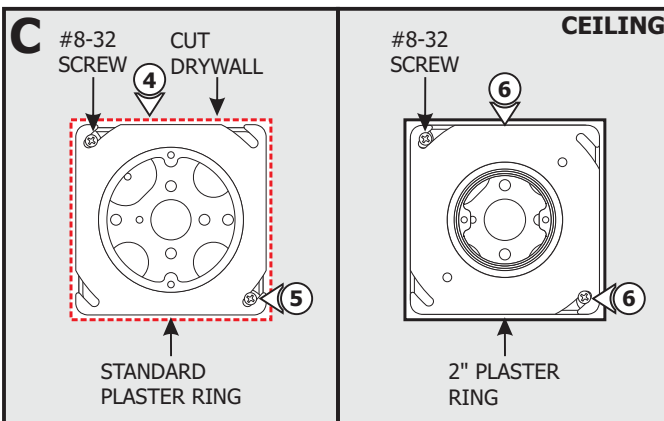
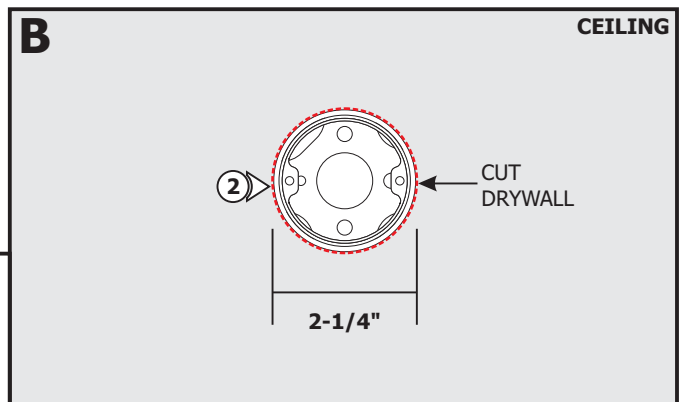

#### For Remodeling:

- 4:** Cut away the drywall where the junction box is located.
- 5:** Uninstall the existing plaster ring by removing the #8-32 screws.
- 6:** Install the 2" Plaster Ring to the junction box using two #8-32 screws.
- 7:** Plaster and finish around the junction box opening.

## Section Two: Adjusting Cable Position

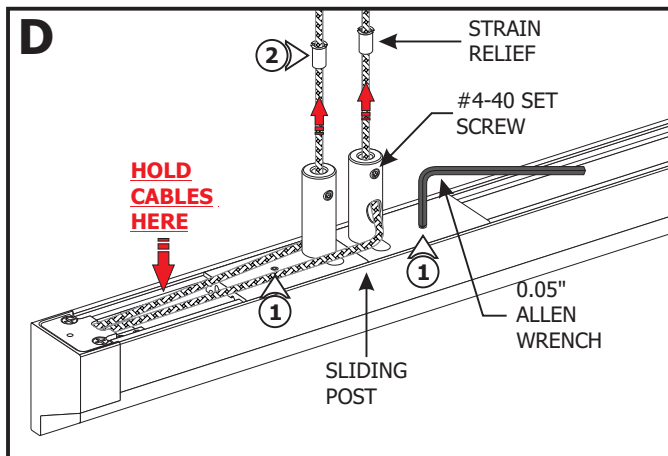

**WARNING:** To avoid damaging the coaxial cable electrical connection, make sure that the end of the coaxial cable coming out of the fixture is held with thumb before relocating sliding posts.

### Power Cables:

- 1:** Loosen (**DO NOT REMOVE**) the #4-40 set screws on the sliding post cord grip post and bed using a 0.05" Allen wrench.
- 2:** Slide the strain relief tubes out of the sliding post using a pair of needle-nose pliers.

- 3:** Carefully move the sliding post to the predetermined location on the channel and tighten the #4-40 set screws on the sliding post bed using the 0.05" Allen wrench.

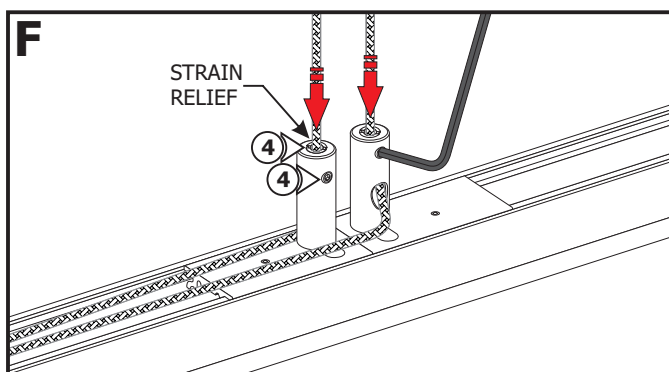
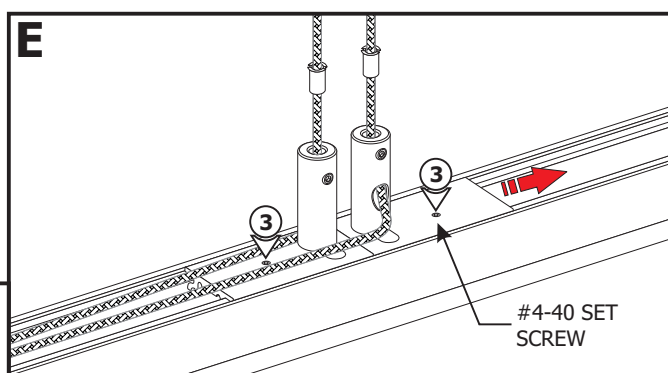

**CAUTION!** Tightening the strain relief set screw **CANNOT BE REVERSED**. Only tighten the set screw **AFTER** the cable location is set properly.

- 4:** Insert the strain relief tubes back inside the cord grip posts and tighten the #4-40 set screws using the 0.05" Allen wrench.

### Aircraft Cable:

- 5:** Loosen (**DO NOT REMOVE**) the #4-40 set screw on the sliding post using a 0.05" Allen wrench.
- 6:** Adjust the position by moving the sliding post across the channel. Tighten the set screw to secure in place.
- 7:** Repeat step 5 and 6 for remaining supports.

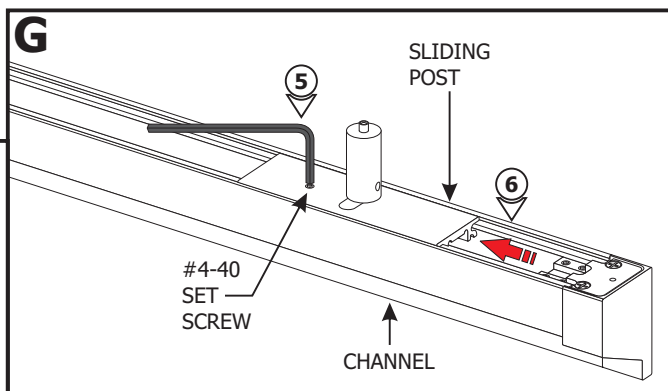

## Section Three: Install the Support Standoff or Support Canopy

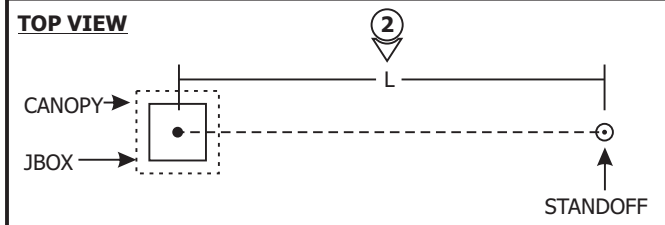
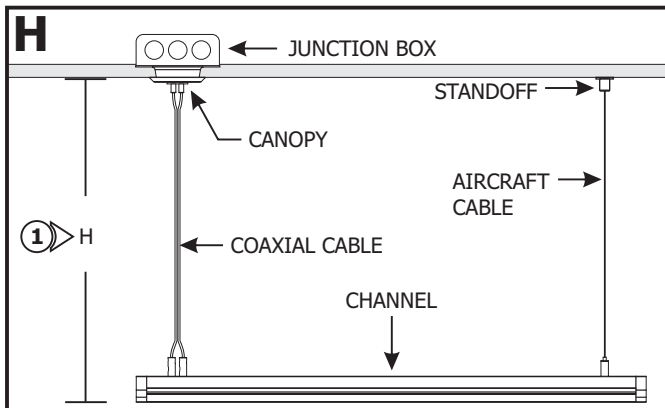

**NOTE:** Steps 3 and 4 are for drywall mounting. Omit these steps if mounting directly to a wood surface.

**3:** For each provided standoff, tap the anchor onto the marked location up to the threaded portion with a hammer.

**4:** Screw in the threaded portion of the anchors with a Phillips screwdriver.

**NOTE:** Run the proper size wires between the 24VDC power supply to the electrical box. Refer to the instructions provided with the power supply for additional information.

**NOTE:** Omit Section Five if the channel is made out of a single piece.

**1:** Determine the fixture height (H) from the bottom of the channel to the top of the canopy.

**2:** Determine the fixture length (L). Measure the distance between the coaxial cable and the aircraft cable on the channel. Mark the standoff location on the ceiling from the center of the junction box.

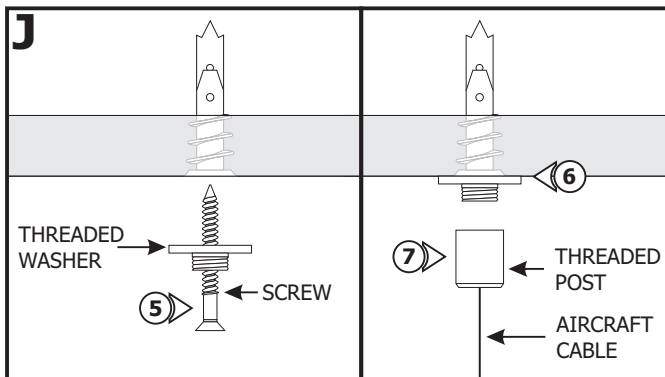
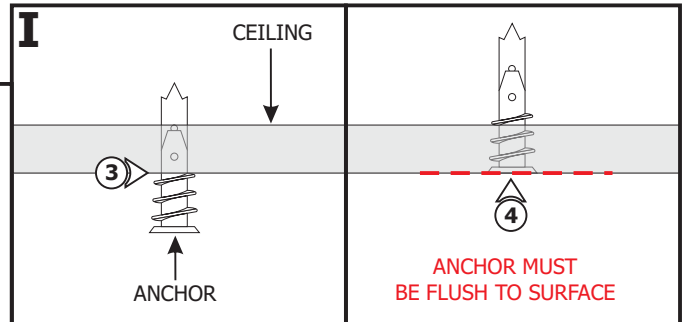

**NOTE:** Omit steps 5 through 7 if using support canopy. Refer to steps 8 through 11.

**Support Standoff:**

**5:** Feed the #8 screw through the threaded washer.

**6:** Tighten the #8 screw completely into the anchor.

**7:** Feed the aircraft cable through the threaded post. Tighten the threaded post completely onto the threaded washer.

**Support Canopy:**

**8:** Feed the #8 screw through the threaded washer and 2" washer respectively into the anchor.

**9:** Tighten the #8 screw completely into the anchor.

**10:** Feed the aircraft cable through the threaded post. Tighten the threaded post completely onto the threaded washer.

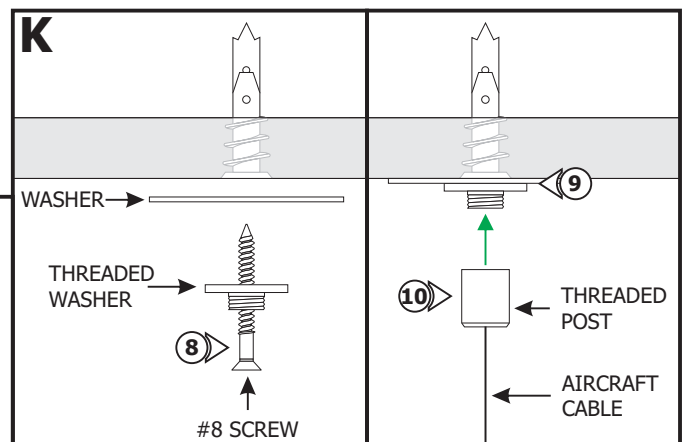

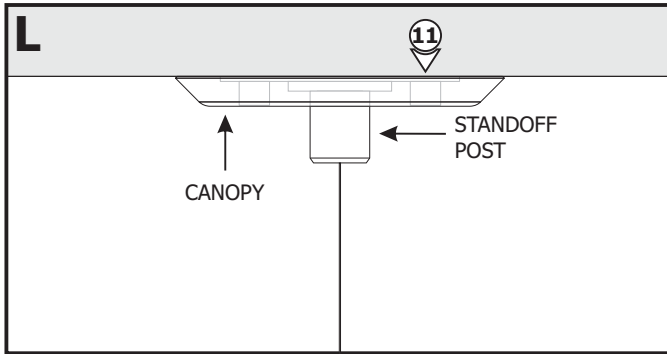

**11:** Place the canopy over the standoff post and magnetically attach the canopy to the washer.

**12:** Insert the aircraft cable through the top of the tab on the sliding post.

**13:** Adjust the height of the fixture by pushing the tab and pulling the aircraft cable out of the side of the sliding post. Release the tab to secure the cable in place.

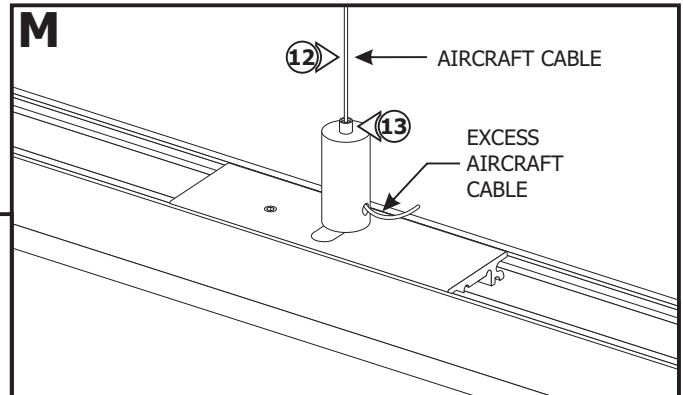

## Section Four: Power the Fixture

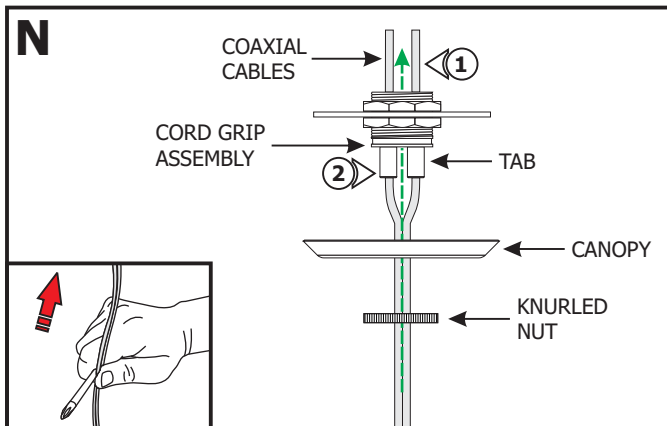

**1:** Split the end of the coaxial cable and feed the cables through the knurled nut, 2" canopy and cord grip assembly respectively.

**2:** Adjust the fixture height by pushing the cord grip tabs to slide the cables up and down until the desired height is achieved. Release the tabs to lock the cables in place.

**NOTE:** If cable is curled or kinked, straighten by holding between the shaft of a screwdriver and thumb and pulling the cable through (see inset).



**NOTE:** Scan the QR Code to watch the video clip of the following steps or visit [www.PureEdgeLighting.com/video\\_feed/installation\\_cxc\\_connector](http://www.PureEdgeLighting.com/video_feed/installation_cxc_connector)

**3:** Use the 18AWG hole of the wire stripper to remove 1-3/8" of the outer insulation to expose the braided wire.

**4:** Use the 18AWG hole of the wire stripper to remove 1" of the braided wire making sure not to nick the inner wire insulation.

**5:** Use the 20AWG hole of the wire stripper to remove 1/8" of the inner insulated wire.

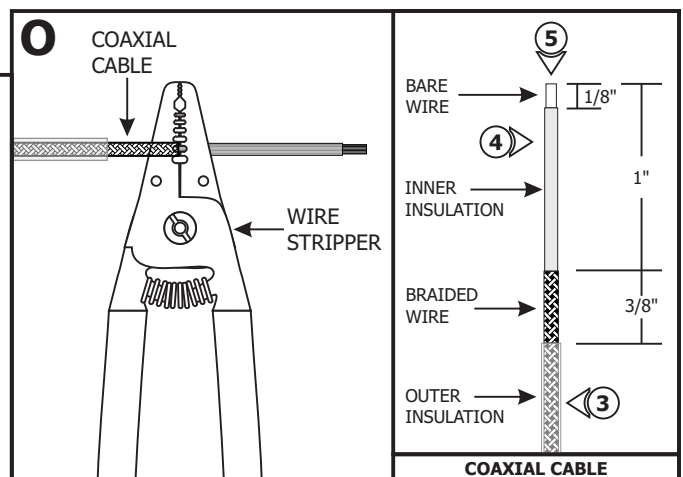

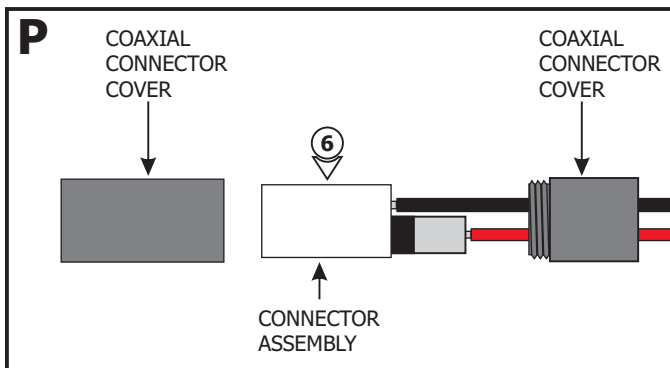

**6:** Unscrew the coaxial connector covers and remove from the connector assembly.

**7:** Using the provided 1.5mm Allen wrench, remove the M3 set screw from the coaxial connector assembly.

**8:** Using the provided 2mm Allen wrench to loosen (**Do Not Remove**) the M4 set screw.

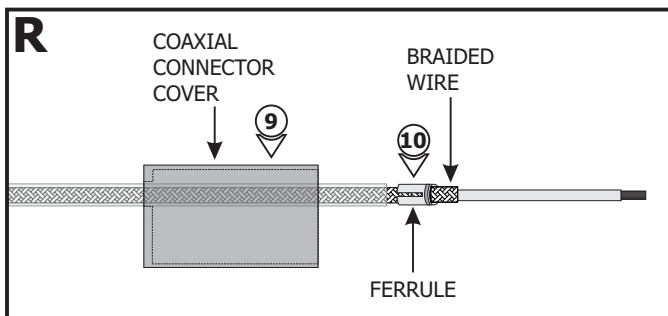
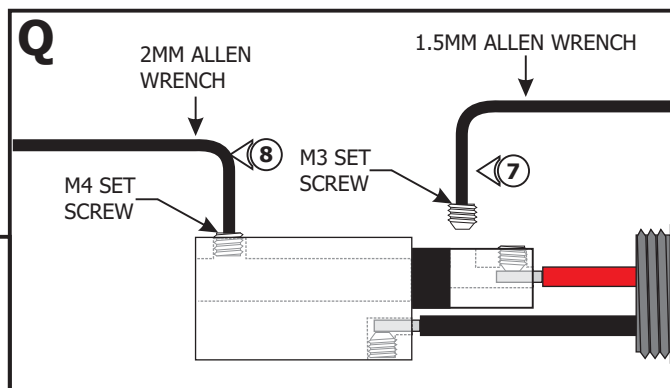

**9:** Slide the connector cover over the coaxial cable.

**10:** Place the ferrule over the 3/8" braided wire of the coaxial cable.

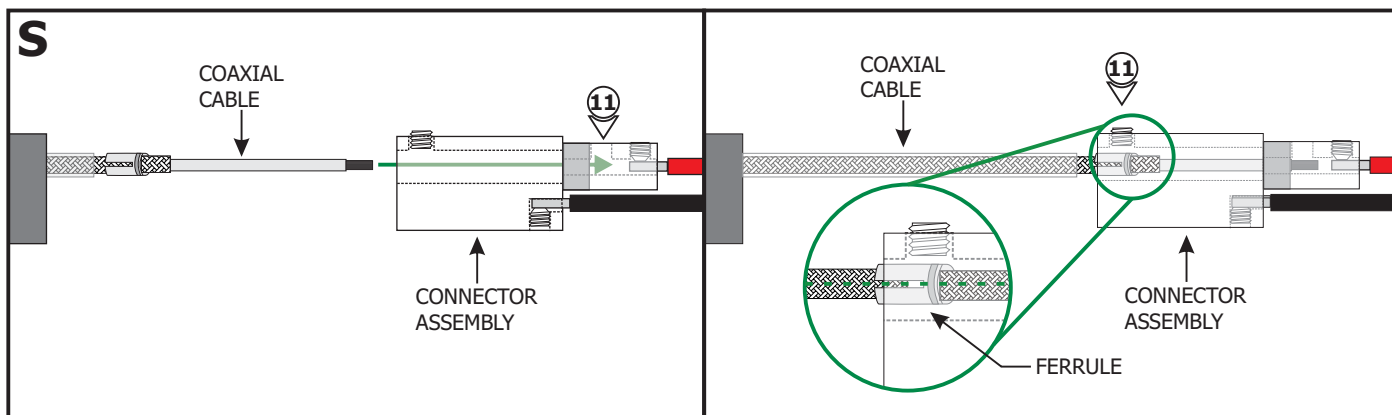

**11:** Insert the coaxial cable into the coaxial connector until the wires of the center conductor are visible through the M3 set screw hole.

**NOTE:** Ensure that the split in the ferrule is aligned 90° from the M4 set screw (see inset).

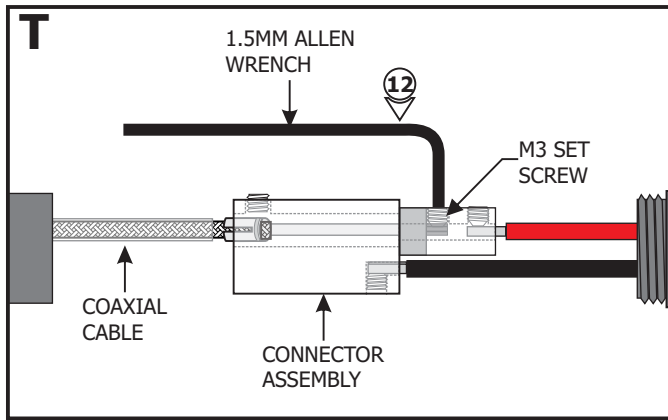

**12:** Use the provided 1.5mm Allen wrench to replace and securely tighten the M3 set screw.

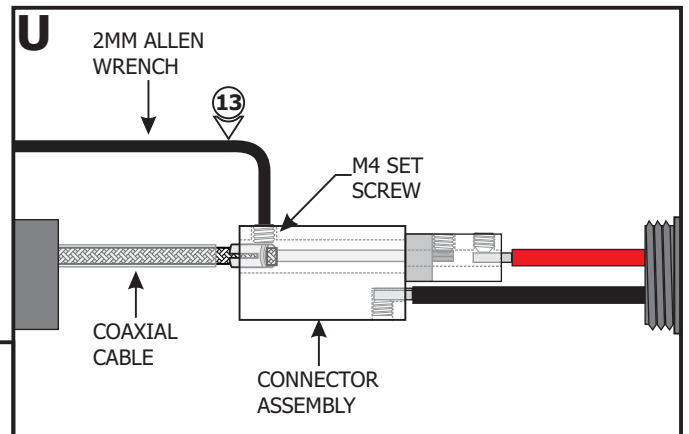

**13:** Use the provided 2mm Allen wrench to securely tighten the M4 set screw until it squeezes the wire ferrule tightly to the coaxial cable.

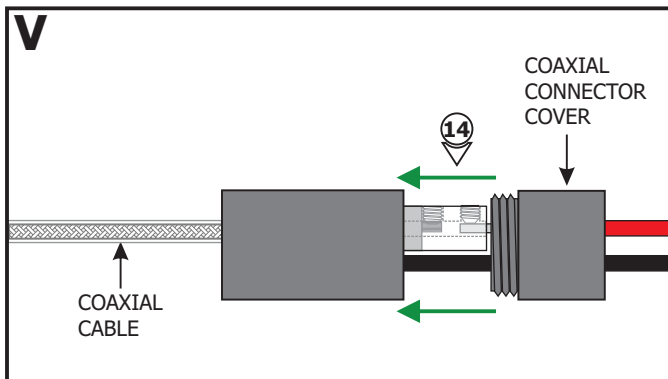

**14:** Replace the coaxial connector cover and tighten into place.

**15:** Repeat steps 3 through 14 for the other coaxial cable and connector.

**NOTE:** Omit steps 16 through 20 if using two channel controls. Refer to wiring diagram on page 9.

**Tunable White with DMX Control:**

- 16:** Connect the red wire for +2000K or +2700K to the red "+" DMX terminal and tighten the screw.
- 17:** Connect the red wire for +6500K to the green "+" DMX terminal and tighten the screw.
- 18:** Connect the black wire for -2000K or -2700K to the red "-" DMX terminal and tighten the screw.
- 19:** Connect the black wire for -6500K to the green "-" DMX terminal and tighten the screw.
- 20:** Refer to the wiring diagram on page 8 and the instructions provided with the power supply to complete the installation.

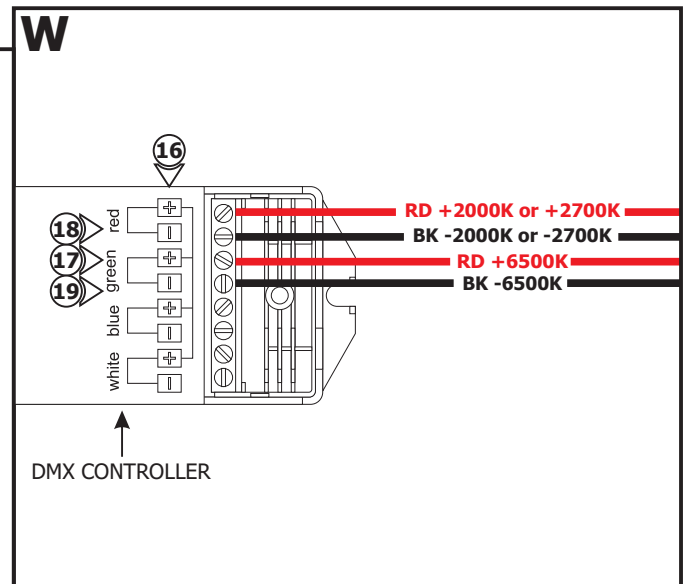

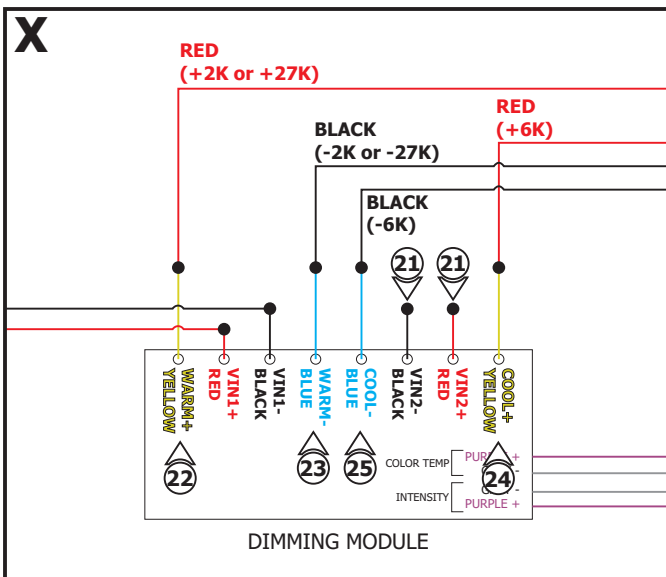

### Tunable White with Two Channel Controls:

- 21:** The Vin2+ Red and Vin2- Black wires are not used in this procedure. Cap the Vin2+ Red and Vin2- Black wires using wire nuts.
- 22:** Connect the red wire for +2000K or +2700K to the Warm+ Yellow dimming module wire using a wire nut.
- 23:** Connect the black wire for -2000K or -2700K to the Warm- Blue dimming module wire using a wire nut.
- 24:** Connect the red wire for +6500K to the Cool+ Yellow dimming module wire using a wire nut.
- 25:** Connect the black wire for -6500K to the Cool- Blue dimming module wire using a wire nut.
- 26:** Refer to the wiring diagram on page 9 and the instructions provided with the power supply to complete the installation.

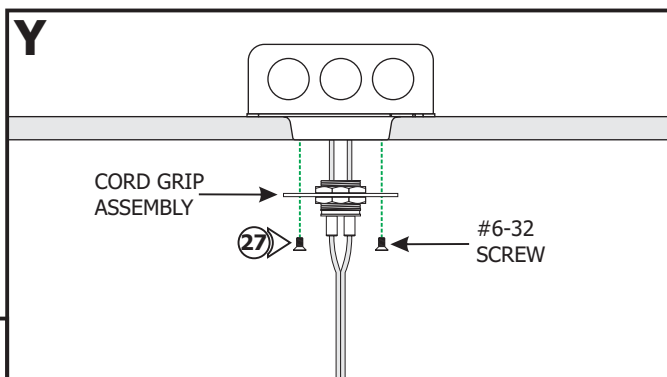

- 27:** Mount the cord grip assembly to the 2" plaster ring using two #6-32 screws.

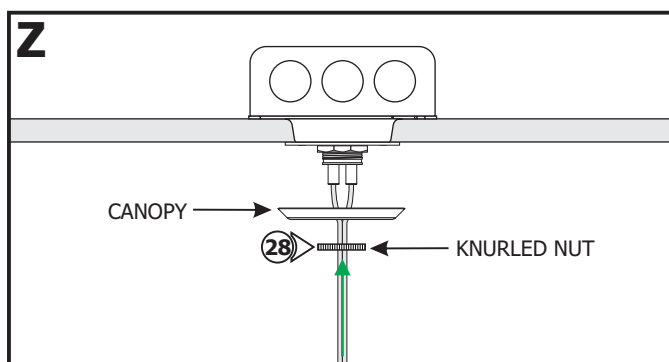

- 28:** Place the canopy over the cord grip against the ceiling. Secure it in place by tightening the knurled nut to the cord grip. **Make sure the knurled cap is not cross threaded.**
- 29:** If necessary, press the tabs on the cord grip to adjust the cable height.

- 30:** If necessary, slightly loosen (**DO NOT REMOVE**) the cord grip post by rotating it counter clockwise; balance the fixture by adjusting the position on the sliding post back and forth. Ensure the channel is straight then tighten the post clockwise to secure in place.

- 31:** Repeat step 30 for each sliding post.

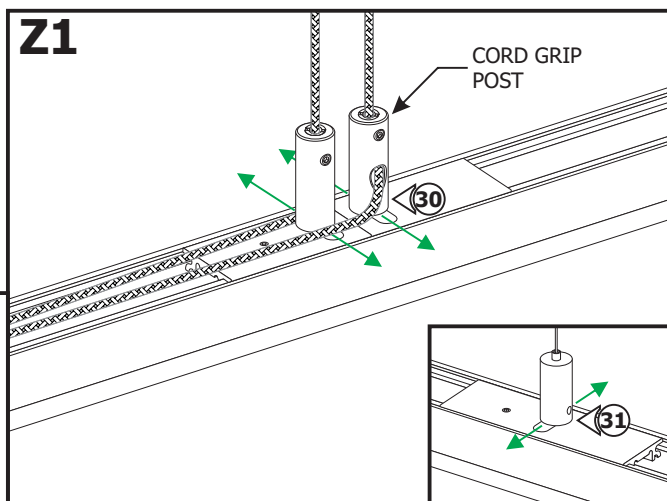

**Z2**



FEMALE  
CONNECTOR

MALE  
CONNECTOR

CHANNEL

## JOINER

CHANNEL

**3:** Tighten the remaining #4-40 set screws using the 0.05" Allen wrench.

**NOTE:** If applicable, multiple channels must be installed one by one.

- 1:** Lift a section of the lens and louver at the end of the channels where the connectors are visible. Slide the channel over the joiner and ensure the male & female connectors mate properly.

**2:** Push the lens and louver back into the channel.

**Z3**

## TOP VIEW

JOINER

#4-40  
SCREW

## Tunable White with DMX Control

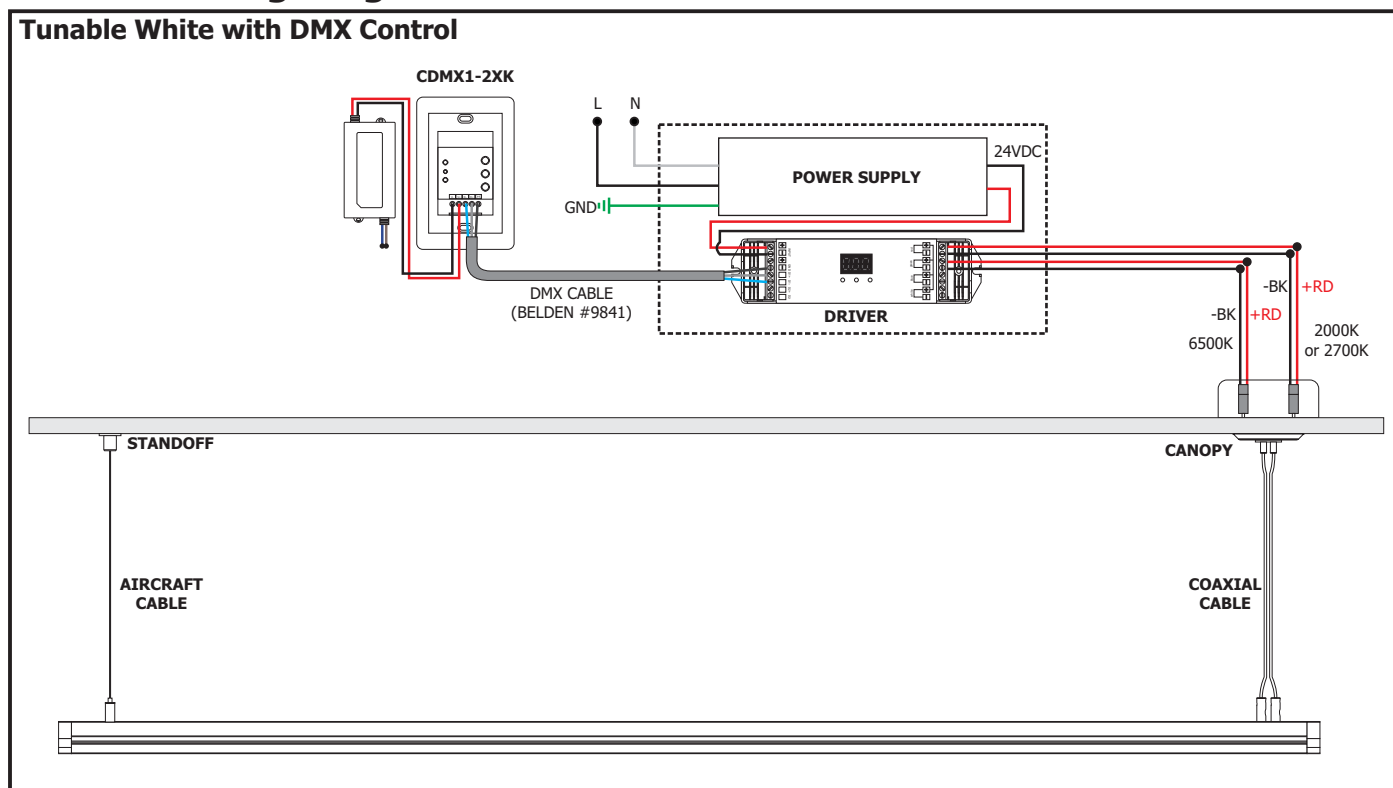

**Tunable White with Two Channel Controls, for Intensity and Color Temperature**

PSB-96W-010-24VDC-2XK

24V+  
24V-  
24V POWER SUPPLY  
LOAD  
N  
GND

INPUT: 120-277 VAC  
LINE  
LOAD  
TO POWER SUPPLY

0-10V CONTROLLER  
CONTROL INPUT 1  
(DIMMING INTENSITY)

0-10V CONTROLLER  
CONTROL INPUT 2  
(DIMMING COLOR TEMP)

STANDOFF

AIRCRAFT CABLE

CANOPY

COAXIAL CABLE

-BK  
6500K

+RD  
2000K or 2700K



1718 W. Fullerton Chicago, IL 60614  
 Ph: 773.770.1195 • Fax: 773.935.5613  
 www.PureEdgeLighting.com • info@PureEdgeLighting.com  
 © 2016 PureEdge Lighting. All Rights Reserved.

## Installation Instructions for **Cirrus Suspension Wall Wash with Glare Shield, Remote Power and 4" Canopy, Tunable White**

CSWSH\_\_-4\_-\_\_

### IMPORTANT INFORMATION

- This product is suitable for indoor locations.
- This instruction shows a typical installation.
- It is recommended more than one person to assist in this installation.

**SAVE THESE INSTRUCTIONS!**



### Section One: Install the Support Standoff or Support Canopy

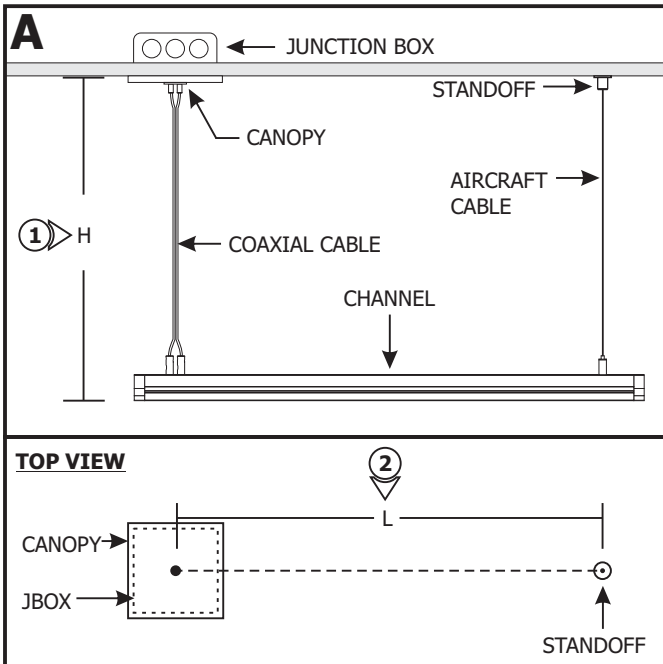

**NOTE:** Run the proper size wires between the 24VDC power supply to the electrical box. Refer to the instructions provided with the power supply for additional information.

**NOTE:** Omit Section Five if the channel is made out of a single piece.

- 1:** Determine the fixture height (H) from the bottom of the channel to the top of the canopy.
- 2:** Determine the fixture length (L). Measure the distance between the coaxial cable and the aircraft cable on the channel. Mark the standoff location on the ceiling from the center of the junction box.

**NOTE:** Omit steps 3 through 7 if using the support canopy. Refer to steps 8 through 12.

#### Support Standoff:

- 3:** For each provided standoff, tap the anchor onto the marked location up to the threaded portion with a hammer.
- 4:** Screw in the threaded portion of the anchors with a Phillips screwdriver.

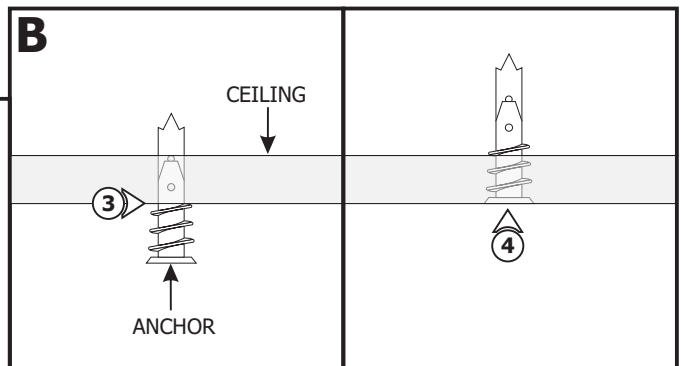

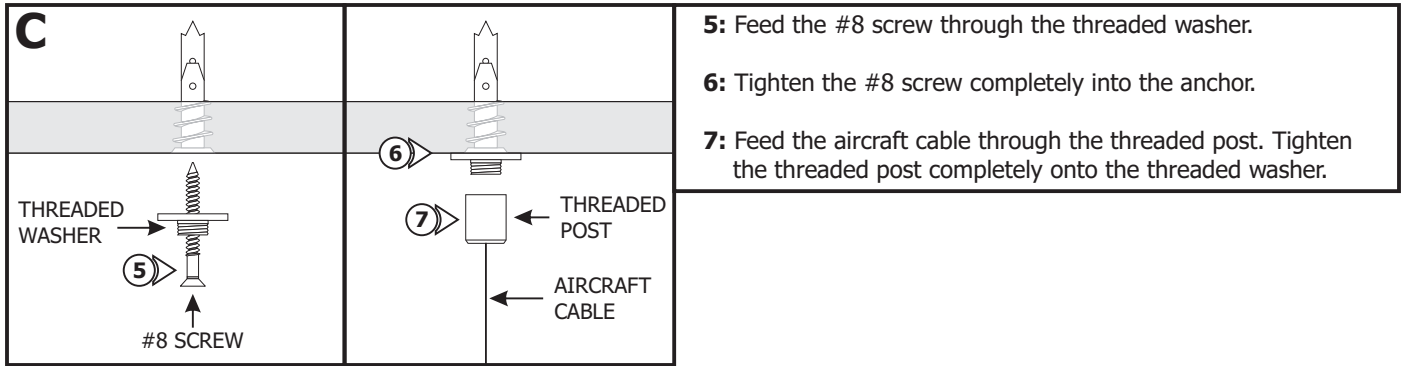

**Support Canopy:**

**8:** Mark the points through the crossbar holes onto the ceiling.

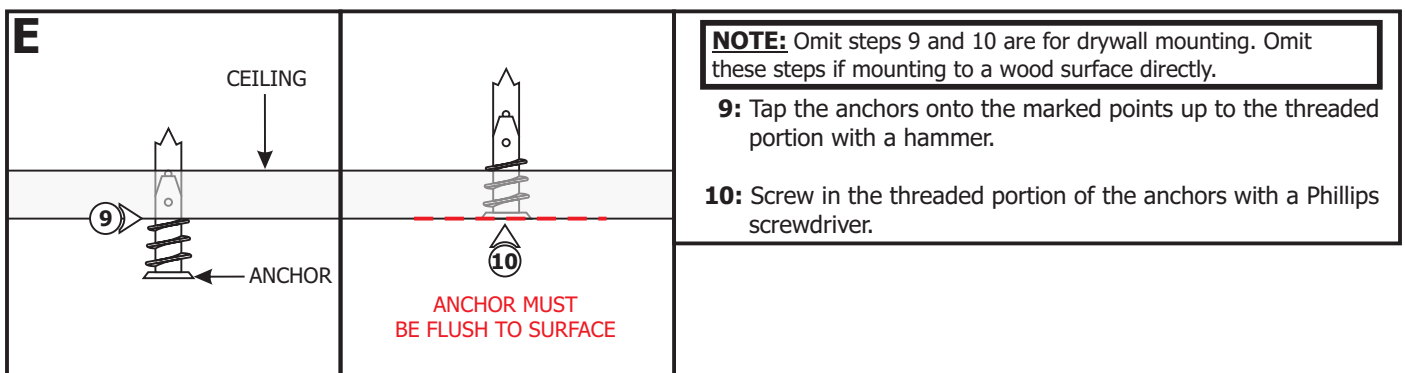
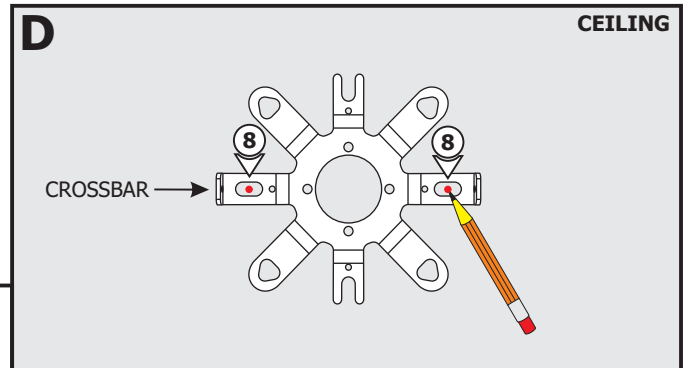

**11:** Secure the crossbar to the anchors using the two #6 screws.

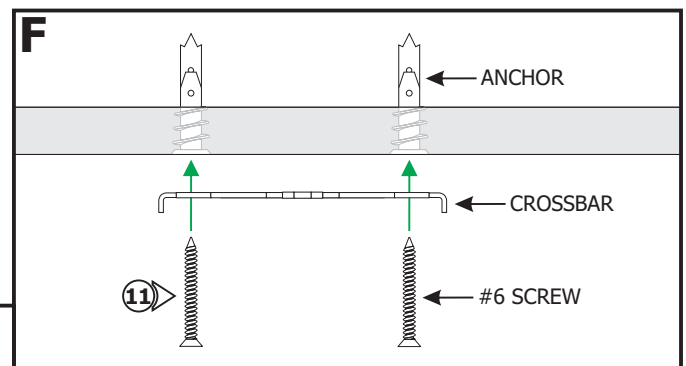

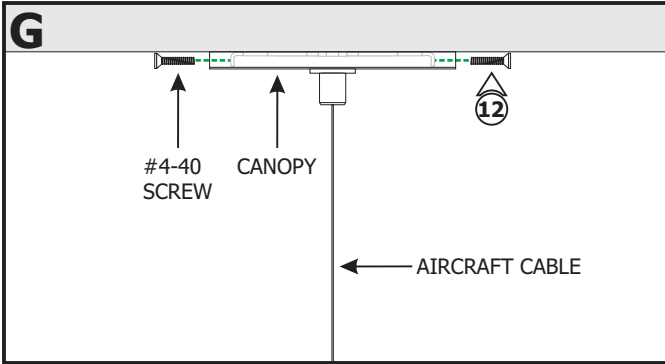

**12:** Align the canopy with the crossbar and secure it using the two #4-40 screws using a 1/16" Allen wrench.

**13:** Insert the aircraft cable through the top of the tab on the sliding post.

**14:** Adjust the height of the fixture by pushing the tab and pulling the aircraft cable out of the side of the sliding post. Release the tab to secure the cable in place.

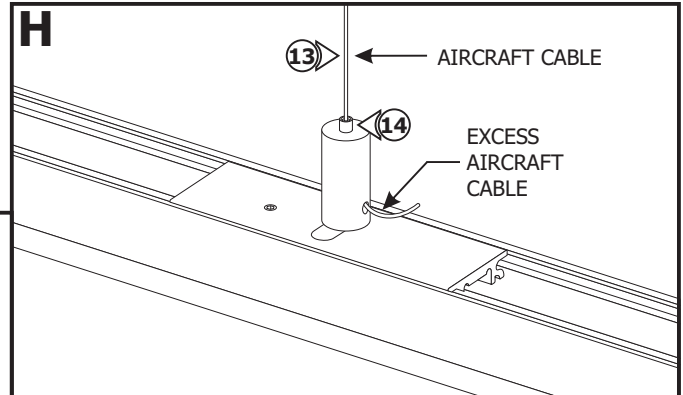

## Section Two: Adjusting Cable Position

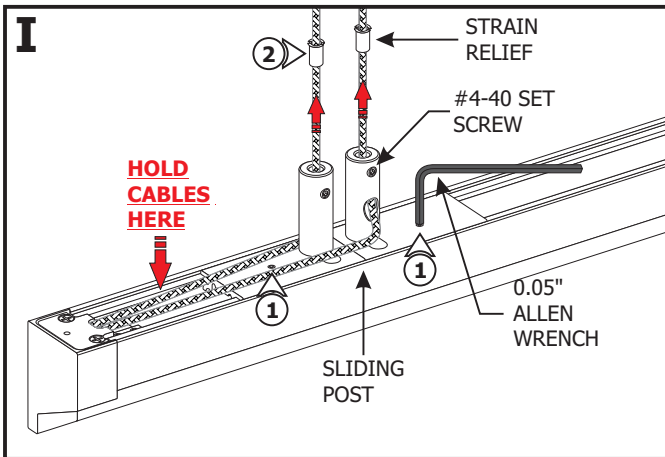

**WARNING:** To avoid damaging the coaxial cable electrical connection, make sure that the end of the coaxial cable coming out of the fixture is held with thumb before relocating sliding posts.

### Power Cables:

**1:** Loosen (**DO NOT REMOVE**) the #4-40 set screws on the sliding post cord grip post and bed using a 0.05" Allen wrench.

**2:** Slide the strain relief tubes out of the sliding post using a pair of needle-nose pliers.

**3:** Carefully move the sliding post to the predetermined location on the channel and tighten the #4-40 set screws on the sliding post bed using the 0.05" Allen wrench.

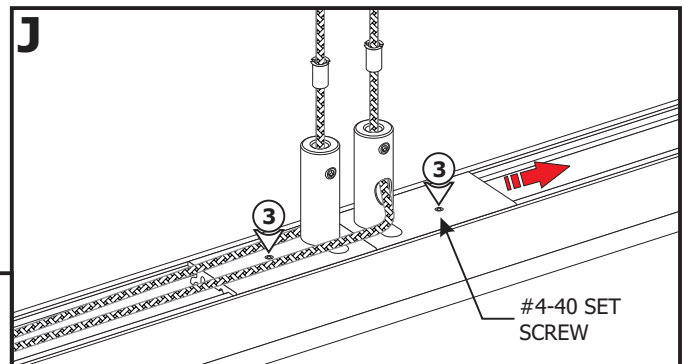

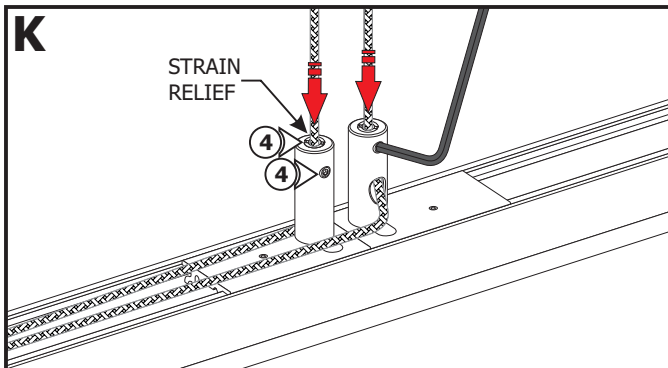

**!CAUTION!** Tightening the strain relief set screw **CANNOT BE REVERSED**. Only tighten the set screw **AFTER** the cable location is set properly.

- 4:** Insert the strain relief tubes back inside the cord grip posts and tighten the #4-40 set screws using the 0.05" Allen wrench.

#### Aircraft Cable:

- 5:** Loosen (**DO NOT REMOVE**) the #4-40 set screw on the sliding post using a 0.05" Allen wrench.

- 6:** Adjust the position by moving the sliding post across the channel. Tighten the set screw to secure in place.

- 7:** Repeat step 5 and 6 for remaining supports.

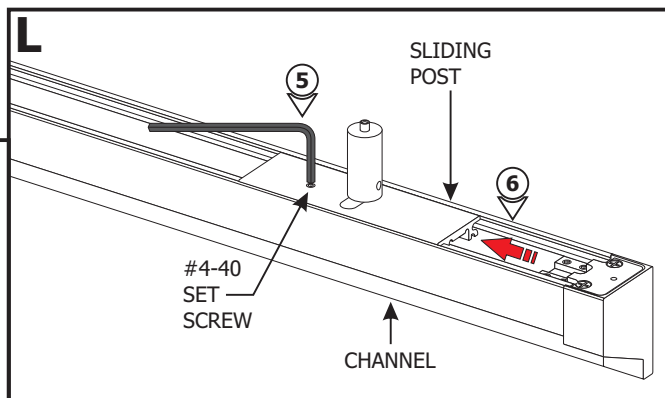

## Section Three: Install the Coaxial Connector

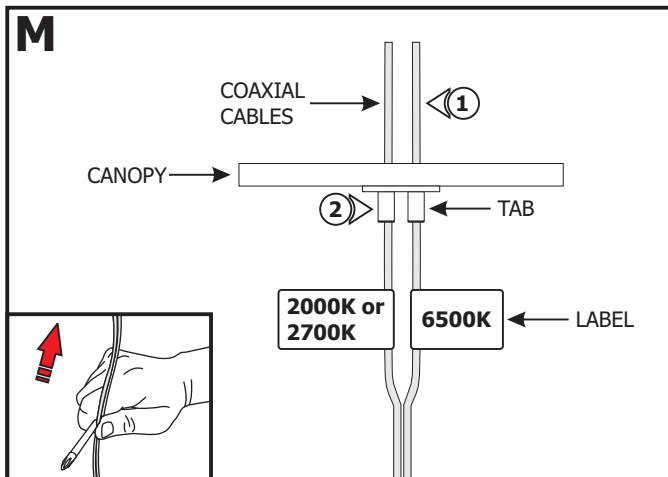

- 1:** Split the end of the coaxial cable and feed the cables through the canopy.

- 2:** Adjust the fixture height by pushing the cord grip tabs to slide the cables up and down until the desired height is achieved. Release the tabs to lock the cables in place.

**NOTE:** If cable is curled or kinked, straighten by holding between the shaft of a screwdriver and thumb and pulling the cable through (see inset).



**NOTE:** Scan the QR Code to watch the video clip of the following steps or visit [www.PureEdgeLighting.com/video\\_feed/installation\\_cxc\\_connector](http://www.PureEdgeLighting.com/video_feed/installation_cxc_connector)

- 3:** Use the 18AWG hole of the wire stripper to remove 1-3/8" of the outer insulation to expose the braided wire.

- 4:** Use the 18AWG hole of the wire stripper to remove 1" of the braided wire making sure not to nick the inner wire insulation.

- 5:** Use the 20AWG hole of the wire stripper to remove 1/8" of the inner insulated wire.

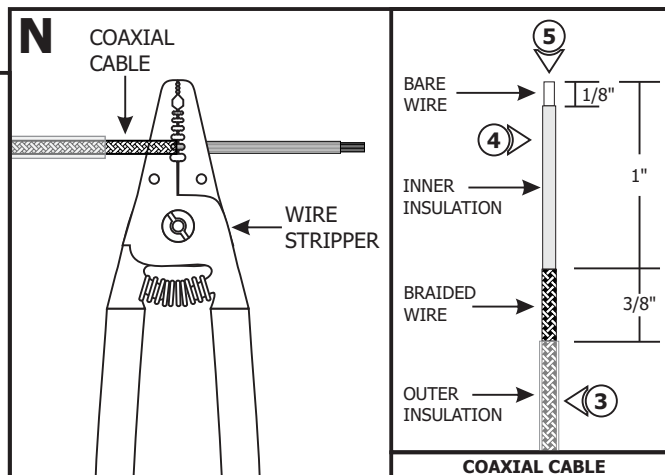

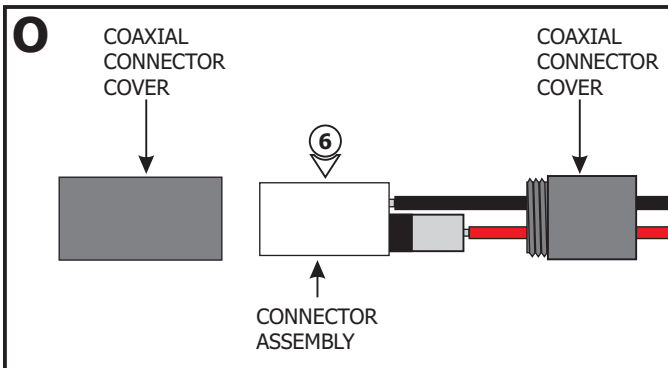

**6:** Unscrew the coaxial connector covers and remove from the connector assembly.

**7:** Using the provided 1.5mm Allen wrench, remove the M3 set screw from the coaxial connector assembly.

**8:** Using the provided 2mm Allen wrench to loosen (**Do Not Remove**) the M4 set screw.

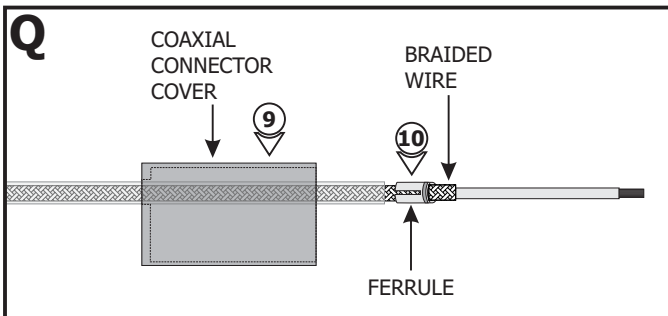
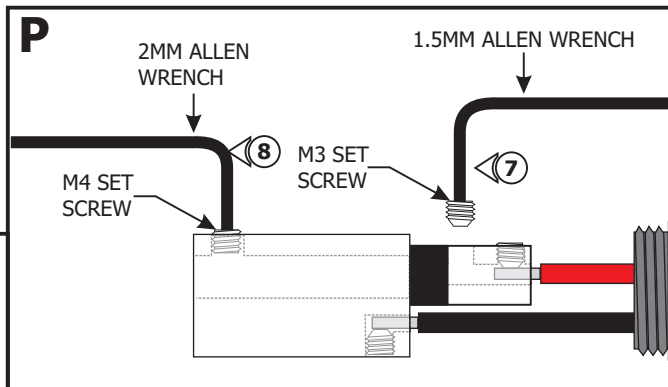

**9:** Slide the connector cover over the coaxial cable.

**10:** Place the ferrule over the 3/8" braided wire of the coaxial cable.

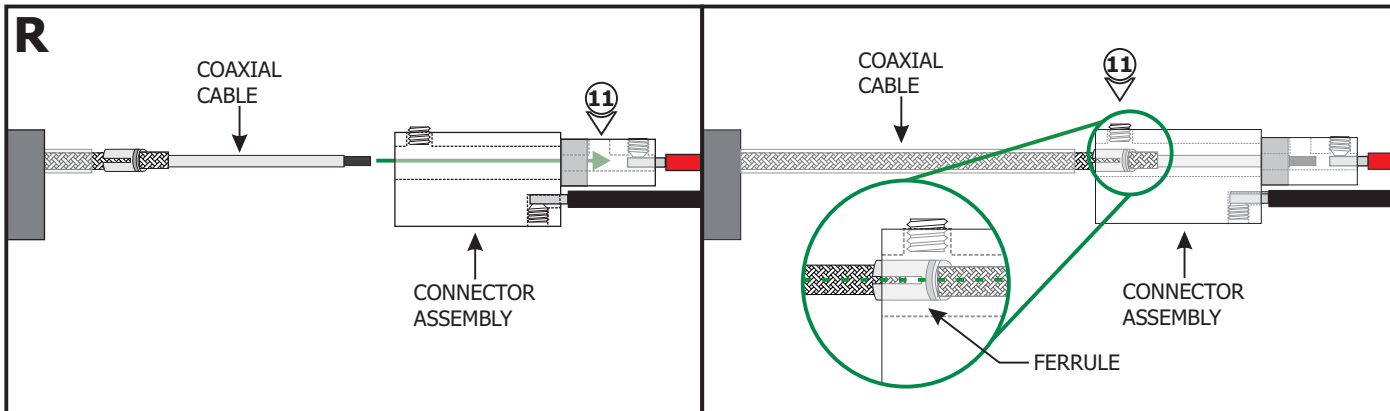

**11:** Insert the coaxial cable into the coaxial connector until the wires of the center conductor are visible through the M3 set screw hole.

**NOTE:** Ensure that the split in the ferrule is aligned 90° from the M4 set screw (see inset).

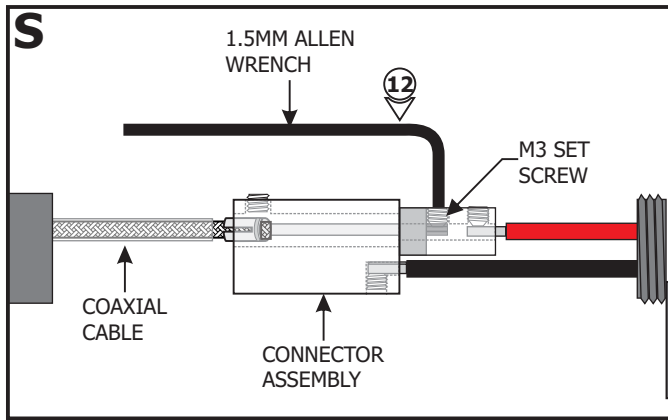

**12:** Use the provided 1.5mm Allen wrench to replace and securely tighten the M3 set screw.

**13:** Use the provided 2mm Allen wrench to securely tighten the M4 set screw until it squeezes the wire ferrule tightly to the coaxial cable.

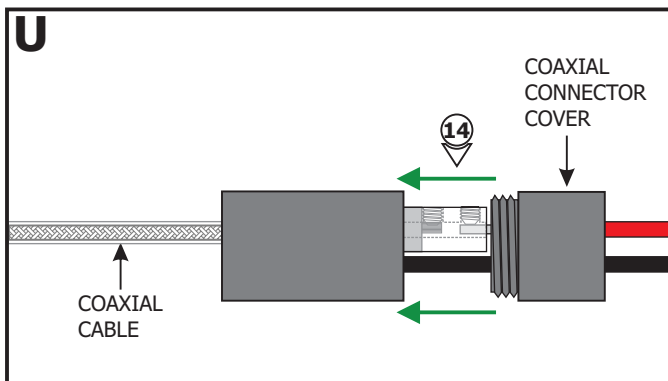
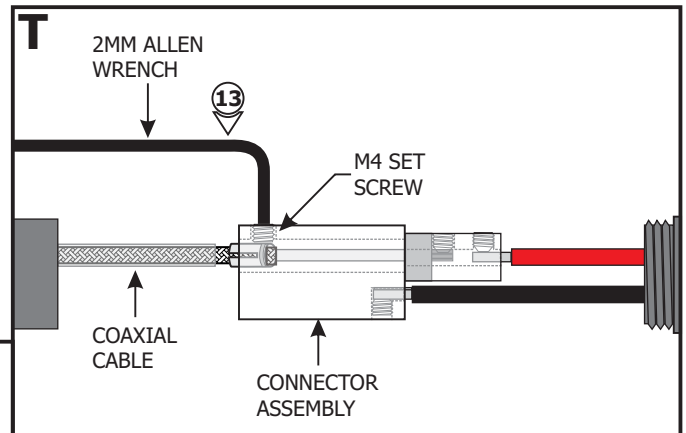

**14:** Replace the coaxial connector cover and tighten into place.

**15:** Repeat steps 3 through 14 to connect the remaining coaxial connector to the other cable.

## Section Four: Power the Fixture

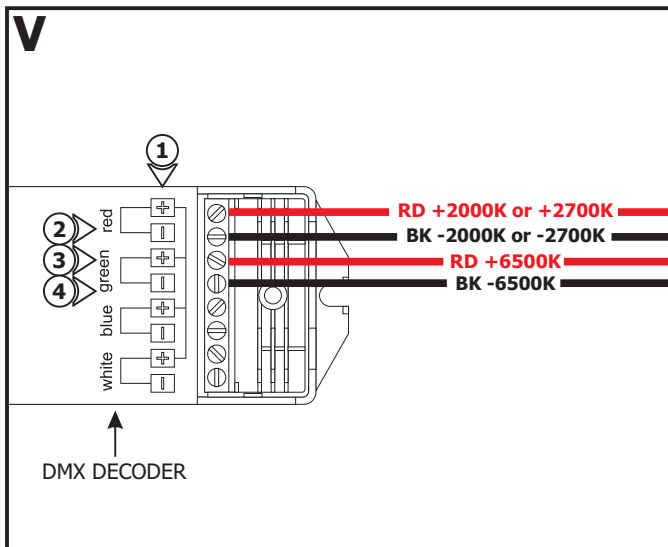

**NOTE:** Omit steps 1 through 5 if using two channel controls. Refer to steps 6 through 11.

### Tunable White with DMX Control:

- 1:** Connect the red wire for +2000K or +2700K to the red "+" DMX terminal and tighten the screw.
- 2:** Connect the black wire for -2000K or -2700K to the red "-" DMX terminal and tighten the screw.
- 3:** Connect the red wire for +6500K to the green "+" DMX terminal and tighten the screw.
- 4:** Connect the black wire for -6500K to the green "-" DMX terminal and tighten the screw.
- 5:** Refer to the wiring diagram on page 9 and the instructions provided with the power supply to complete the installation.

**W**

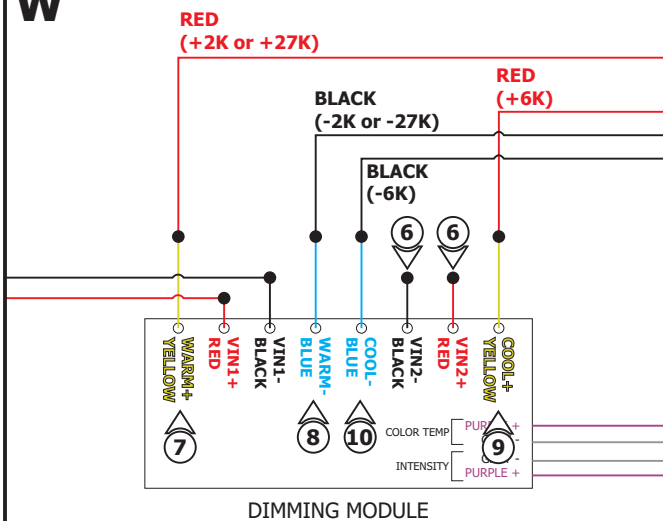

### Tunable White with Two Channel Controls:

- 6:** The Vin2+ Red and Vin2- Black wires are not used in this procedure. Cap the Vin2+ Red and Vin2- Black wires using wire nuts.
- 7:** Connect the red wire for +2000K or +2700K to the Warm+ Yellow dimming module wire using a wire nut.
- 8:** Connect the black wire for -2000K or -2700K to the Warm- Blue dimming module wire using a wire nut.
- 9:** Connect the red wire for +6500K to the Cool+ Yellow dimming module wire using a wire nut.
- 10:** Connect the black wire for -6500K to the Cool- Blue dimming module wire using a wire nut.
- 11:** Refer to the wiring diagram on page 9 and the instructions provided with the power supply to complete the installation.

**NOTE:** Ensure remote power supply wires are present in the junction box. Refer to instructions provided with the power supply.

- 12:** Feed the low voltage wires from the power supply through the crossbar center hole.
- 13:** Mount the crossbar to the junction box holes with two #8-32 screws.

**X**

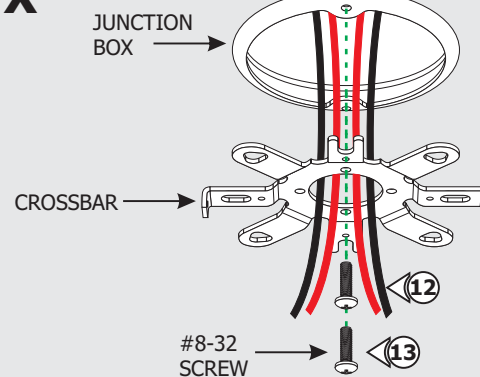

**Y**

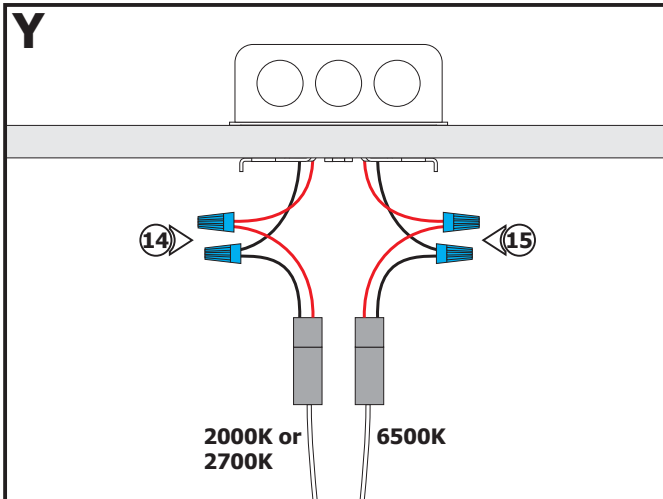

- 14:** Connect the red and black coaxial connector wires to the red and black power supply wires for 2000K or 2700K respectively using wire nuts.
- 15:** Repeat step 14 to connect the other coaxial connector and remaining power supply wires for 6500K.
- 16:** Refer to wiring diagram on page 9.

**CAUTION:** Test the fixture before removing the labels.

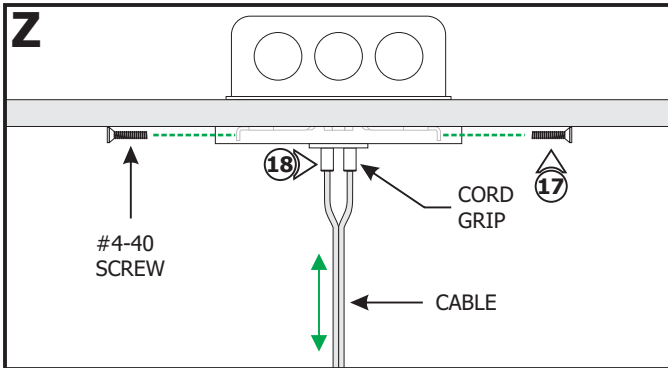

**17:** Align the canopy with the crossbar and secure it using the two #4-40 screws using a 1/16" Allen wrench.

**18:** If necessary, press the tabs on the cord grip to adjust the cable height.

**19:** If necessary, slightly loosen (**DO NOT REMOVE**) the cord grip post by rotating it counter clockwise; balance the fixture by adjusting the position on the sliding post back and forth. Ensure the channel is straight then tighten the post clockwise to secure in place.

**20:** Repeat step 19 for each sliding post.

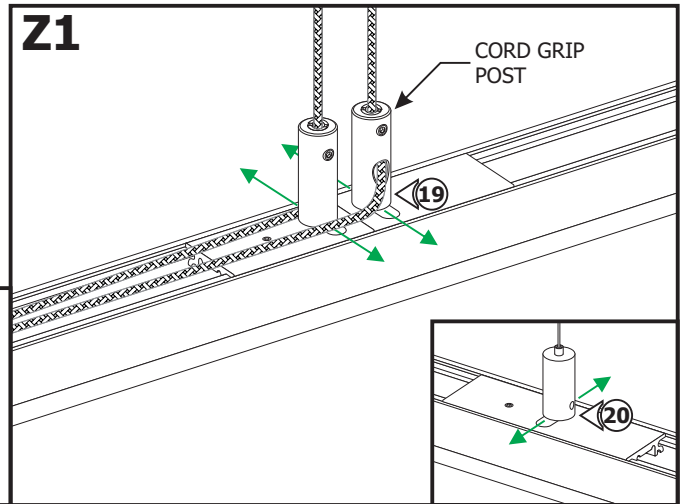

## Section Five: Connecting Channel Sections

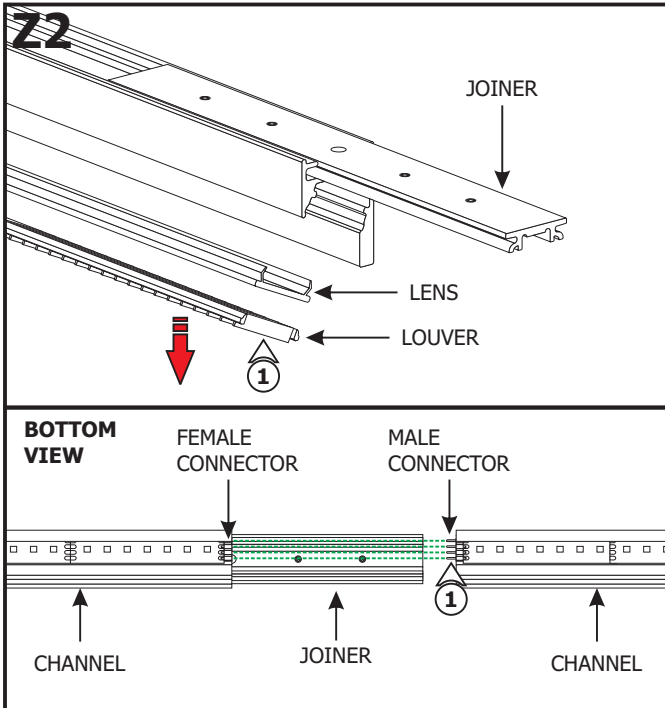

**NOTE:** Omit this section if the joiner did not come with the fixture depending on the overall fixture length.

**NOTE:** If applicable, multiple channels must be installed one by one.

**1:** Lift a section of the lens and louver at the end of the channels where the connectors are visible. Slide the channel over the joiner and ensure the male & female connectors mate properly.

**2:** Push the lens and louver back into the channel.

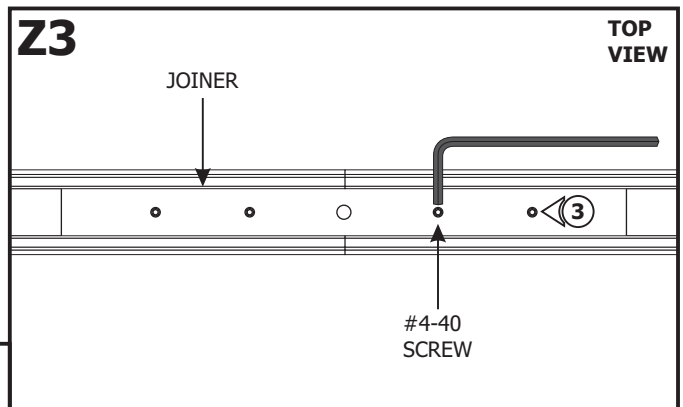

**3:** Tighten the remaining #4-40 set screws using the 0.05" Allen wrench.

# General Wiring Diagram

## Tunable White with DMX Control

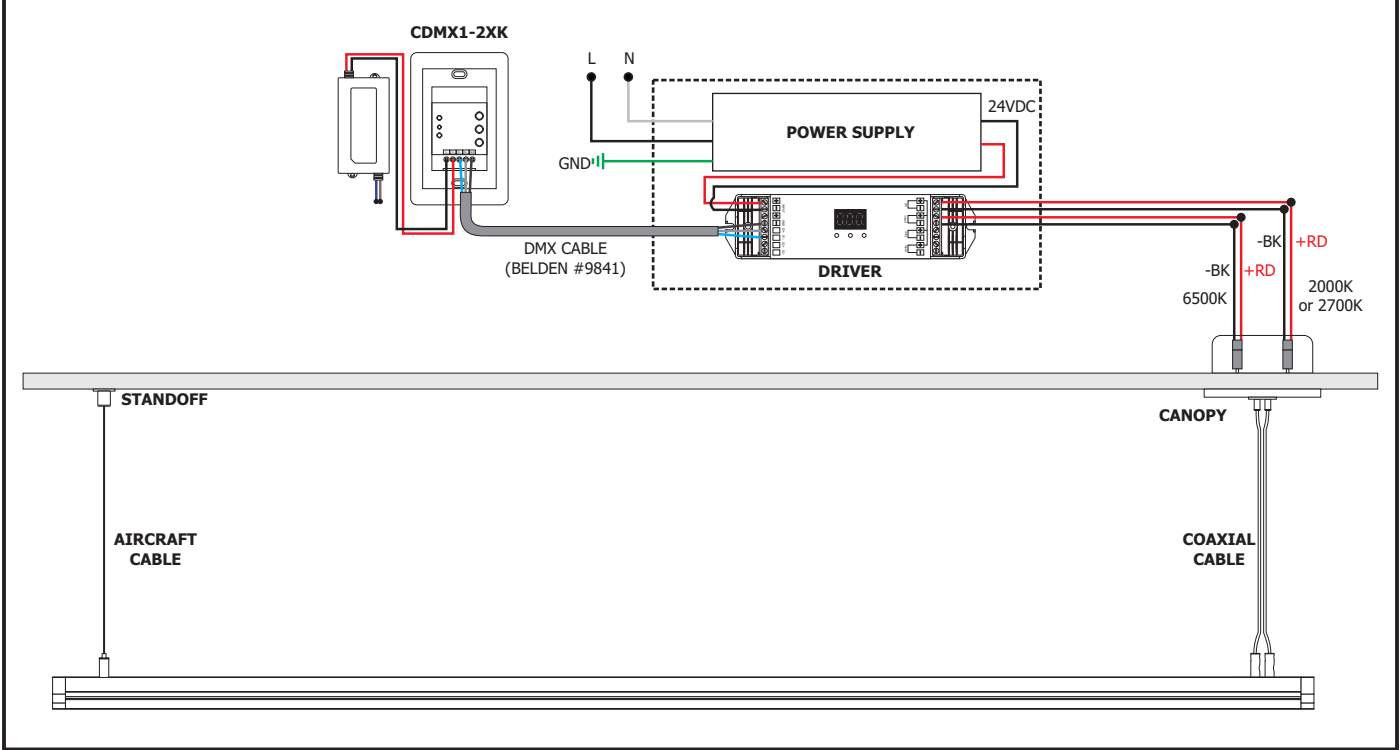

## Tunable White with Two Channel Controls, for Intensity and Color Temperature

