



1718 W. Fullerton Chicago, IL 60614
 Ph: 773.770.1195 • Fax: 773.935.5613
 www.PureEdgeLighting.com • info@PureEdgeLighting.com
 © 2016 PureEdge Lighting. All Rights Reserved.

Installation Instructions for Cirrus Suspension Wall Wash with Glare Shield, with Power - End Feed

CSWSH_P-E_-__

IMPORTANT INFORMATION

- This product is suitable for indoor locations.
- This instruction shows a typical installation.
- It is recommended more than one person to assist in this installation.

SAVE THESE INSTRUCTIONS!



Section One: Adjusting Cable Position

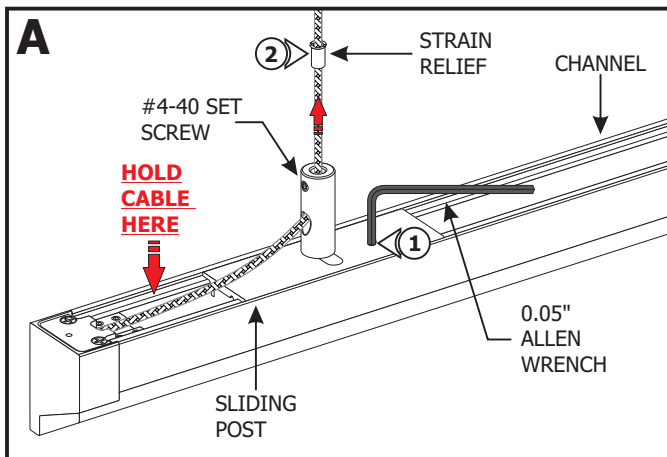

WARNING: To avoid damaging the coaxial cable electrical connection, make sure that the end of the coaxial cable coming out of the fixture is held with thumb before relocating sliding posts.

Power Cable:

- 1: Loosen (**DO NOT REMOVE**) the #4-40 set screws on the sliding post cord grip post and bed with a 0.05" Allen wrench.
- 2: Slide the strain relief tube out of the sliding post using a pair of needle-nose pliers.

- 3: Carefully move the sliding post to the predetermined location on channel and tighten the #4-40 set screw on the sliding post bed with the 0.05" Allen wrench.

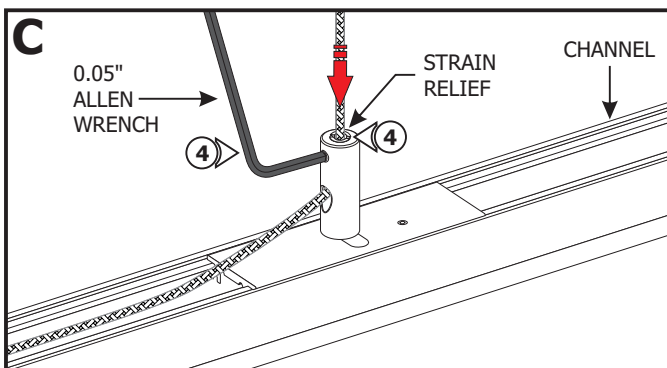
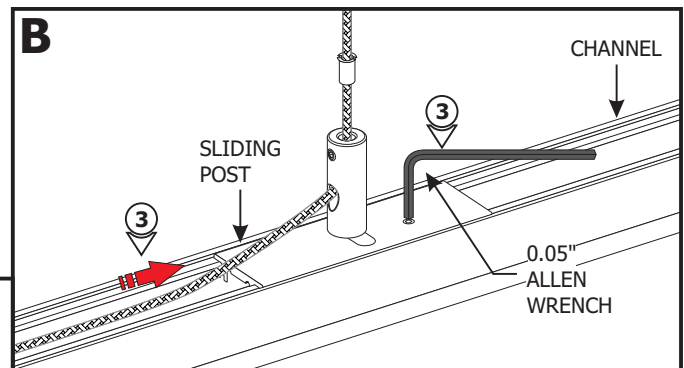

CAUTION! Tightening the strain relief set screw **CANNOT BE REVERSED**. Only tighten the set screw **AFTER** the cable location is set properly.

- 4: Insert the strain relief tube back inside the cord grip post and tighten the #4-40 set screws with the 0.05" Allen wrench.

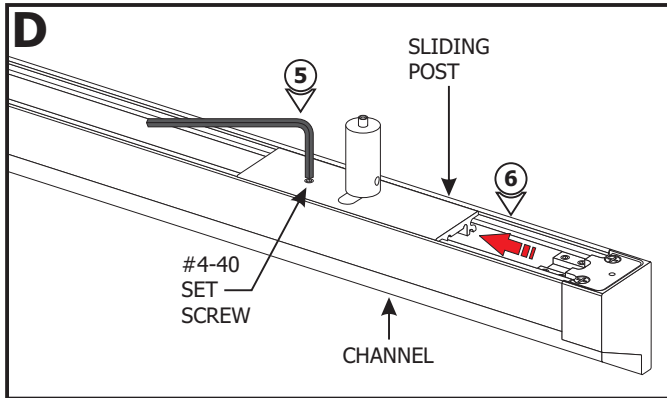

Aircraft Cable:

5: Loosen (**DO NOT REMOVE**) the #4-40 set screw on the sliding post using a 0.05" Allen wrench.

6: Adjust the position by moving the sliding post across the channel. Tighten the set screw to secure in place.

7: Repeat steps 5 and 6 for remaining supports.

Section Two: 4" Flush Canopy Version

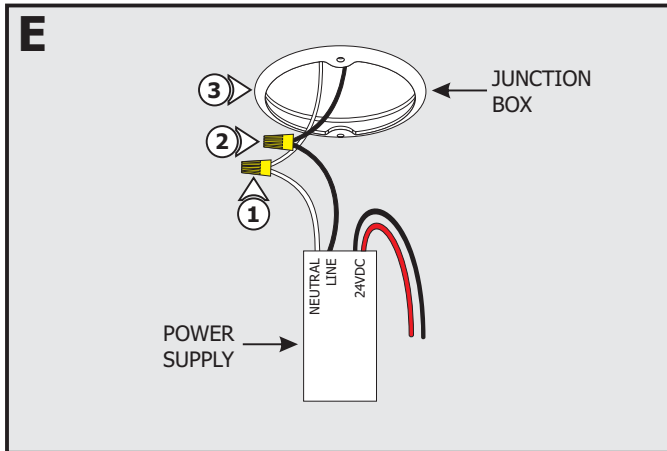

NOTE: Before beginning any electrical work, ensure that power to the junction box is turned off.

NOTE: Omit this section if using the 5" and 6" Surface Mount Canopy. Refer to Section Three.

1: Connect the white wire of the power supply to the 120VAC neutral wire using a wire nut.

2: Connect the black wire of the power supply to the 120VAC line wire using a wire nut.

3: Place the power supply and wires inside the junction box.

4: Feed the low voltage wires from the power supply through the crossbar center hole.

5: Mount the crossbar to the junction box holes with two #8-32 screws.

6: Make sure that the crossbar is grounded in accordance with local electrical codes.

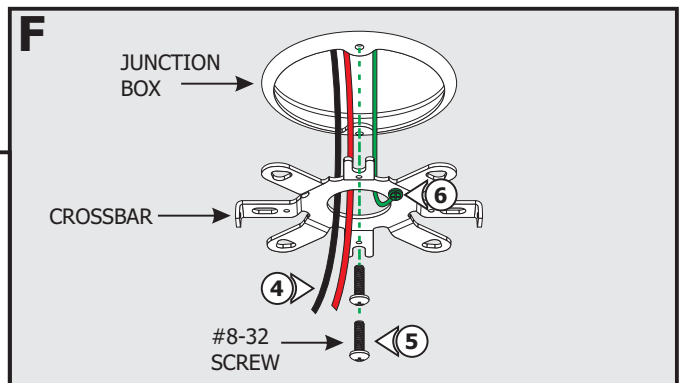

Section Three: 5" and 6" Surface Mount Canopy Version

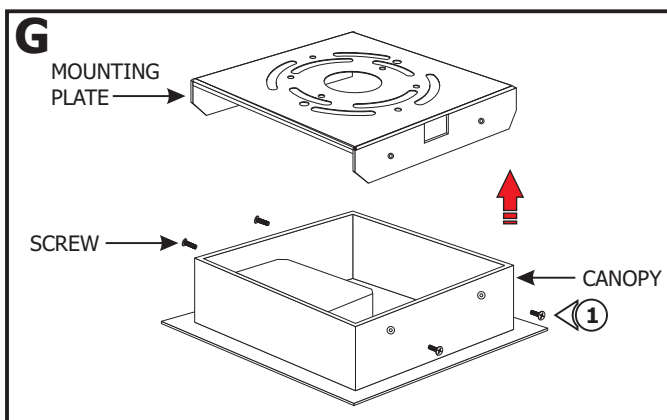

1: Remove the four screws from the canopy to remove the mounting plate.

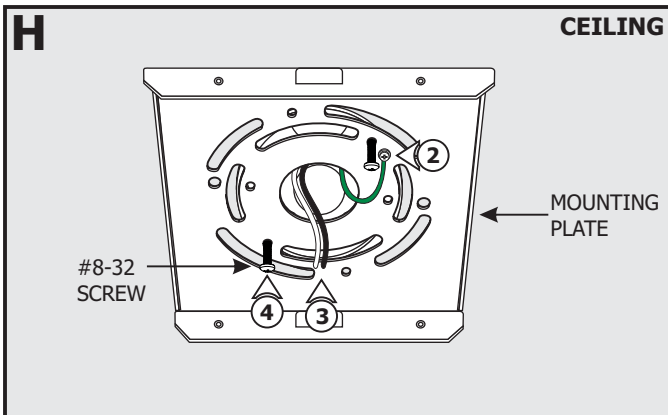

- 2:** Make sure the mounting plate is grounded in accordance with local electrical codes.
- 3:** Feed the 120VAC power wires through the mounting plate center hole.
- 4:** Secure the mounting plate to the junction box using the #8-32 screws.

Section Four: Install the Support Standoff or Support Canopy

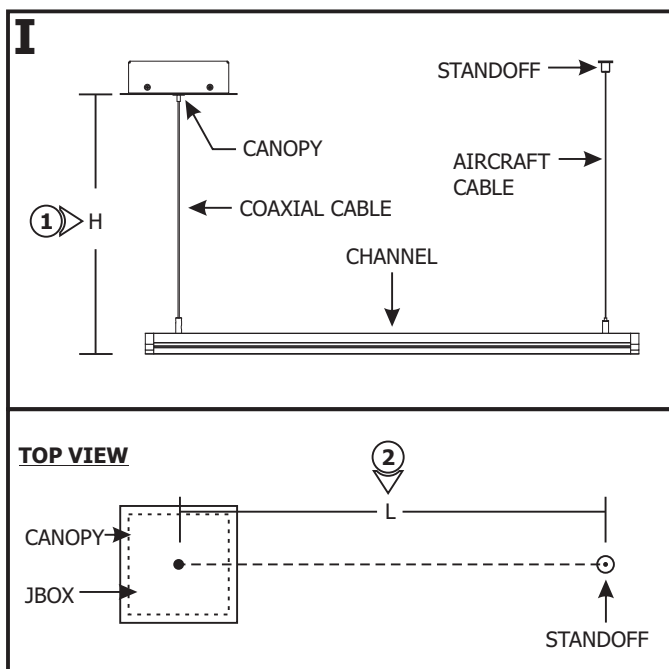

NOTE: Omit Section Seven if the channel is made out of a single piece.

- 1:** Determine the fixture height (H) from the bottom of the channel to the top of the canopy.
- 2:** Determine the fixture length (L). Measure the distance between the coaxial cable and the aircraft cable on the channel. Mark the standoff location on the ceiling from the center of the junction box.

NOTE: Omit steps 3 through 8 if using a support canopy.

NOTE: Steps 3 and 4 are for drywall mounting. Omit these steps if mounting directly to a wood surface.

Support Standoff:

- 3:** Tap the anchor onto the marked location up to the threaded portion with a hammer.
- 4:** Screw in the threaded portion of the anchor with a Phillips screwdriver.

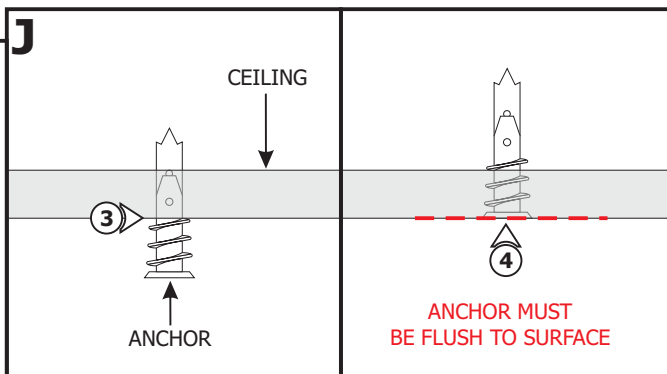

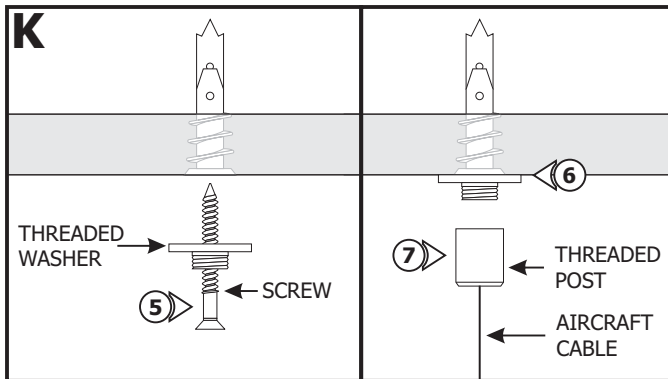

5: Feed the #8 screw through the threaded washer.

6: Tighten the #8 screw completely into the anchor.

7: Feed the aircraft cable through the threaded post. Tighten the threaded post completely onto the threaded washer.

8: Adjust the fixture height by following steps 23 and 24 on page 6.

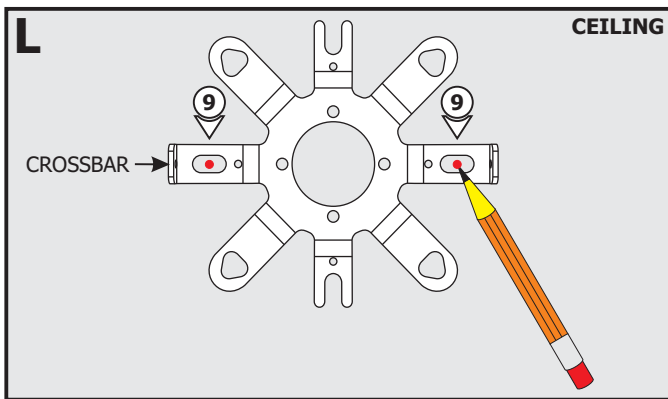

NOTE: Omit steps 9 through 15 if using 5" or 6" Surface Mount Support Canopy.

4" Support Canopy:

9: Mark two points through the crossbar holes onto the ceiling.

NOTE: Step 10 is for drywall mounting. Omit this step if mounting directly to a wood surface.

10: Tap the anchors onto the marked points up to the threaded portion with a hammer. Screw in the threaded portion of the anchors with a Phillips screwdriver.

11: Secure the crossbar to the anchors using the two #8 screws.

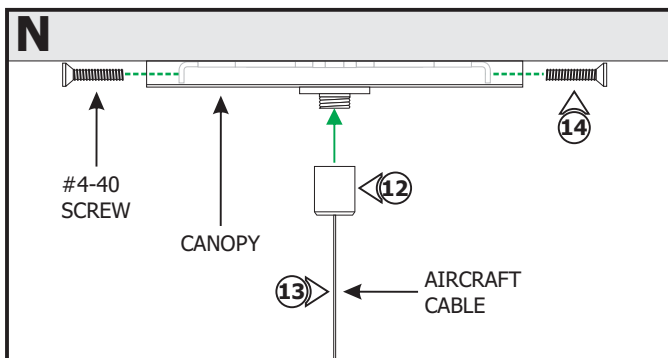
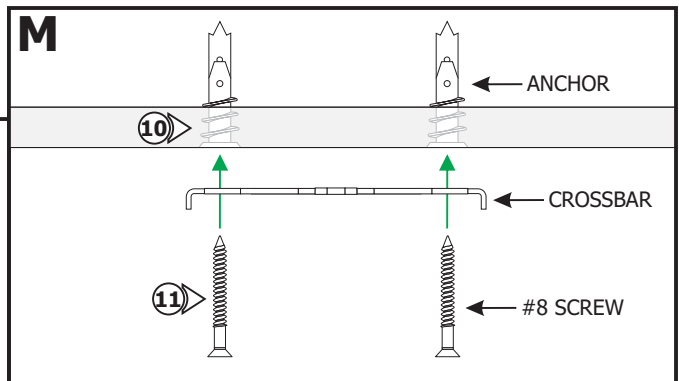

12: Unscrew the threaded post on the canopy.

13: Feed the aircraft cable through the threaded post. Tighten the post completely back onto the canopy.

14: Align the canopy with the crossbar and secure it with the two #4-40 screws using a 1/16" Allen wrench.

15: Adjust the fixture height by following steps 23 and 24 on page 6.

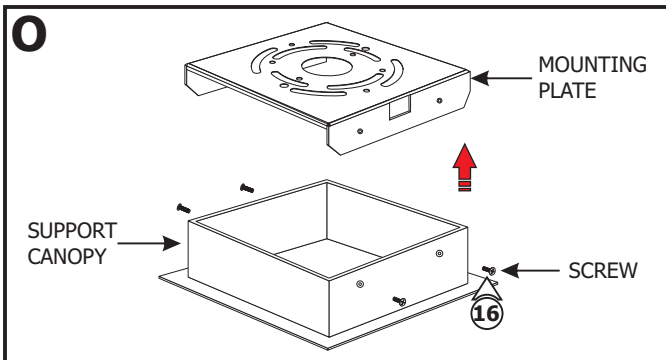

5" and 6" Support Canopy:

16: Remove the four screws from the canopy to remove the mounting plate.

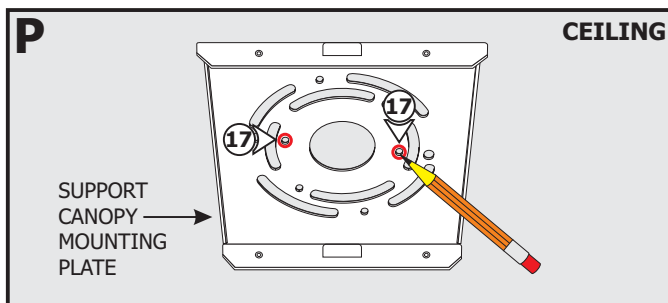

17: Mark two points through the mounting plate holes onto the ceiling.

NOTE: Step 18 is for drywall mounting. Omit this step if mounting directly to a wood surface.

18: Tap the anchors onto the marked points up to the threaded portion with a hammer. Then screw in the threaded portion with a Phillips screw driver.

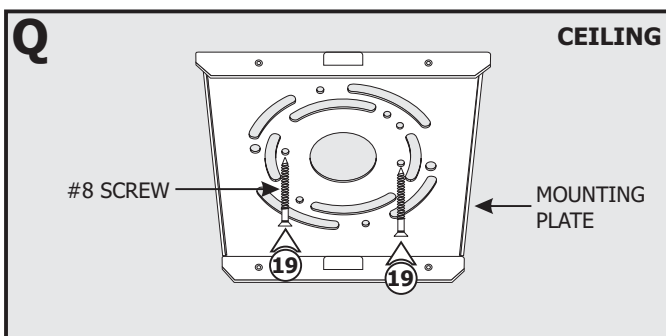
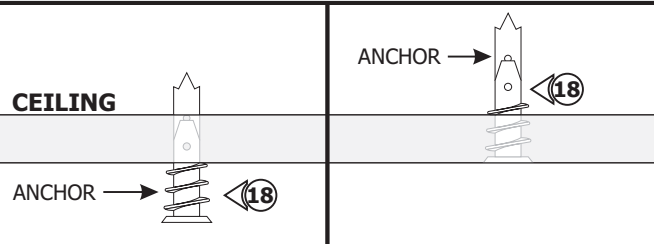

19: Secure the mounting plate to the ceiling using the #8 screws.

20: Unscrew the threaded post on the canopy.

21: Feed the aircraft cable through the threaded post. Tighten the post completely back onto the canopy.

22: Align the support canopy holes with the mounting plate and secure in place by tightening the four screws.

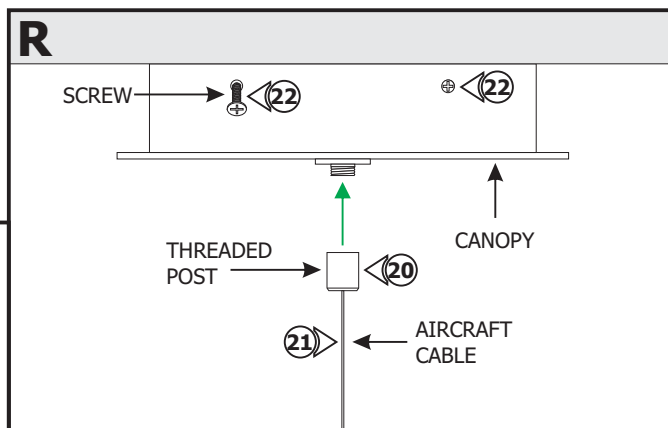

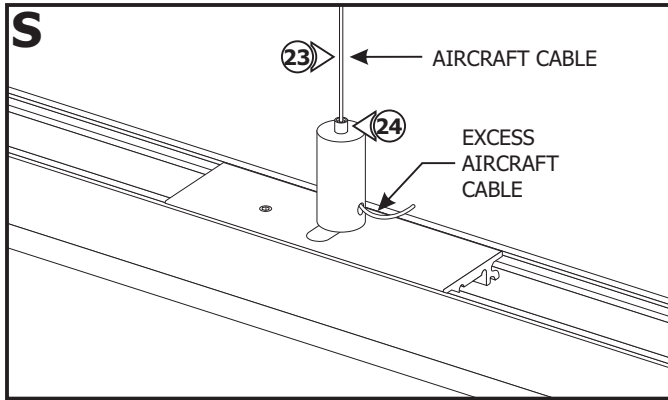

23: Insert the aircraft cable through the top of the tab on the sliding post.

24: Adjust the height of the fixture by pushing the tab and pulling the aircraft cable out of the side of the sliding post. Release the tab to secure the cable in place.

Section Five: Install the Coaxial Connector

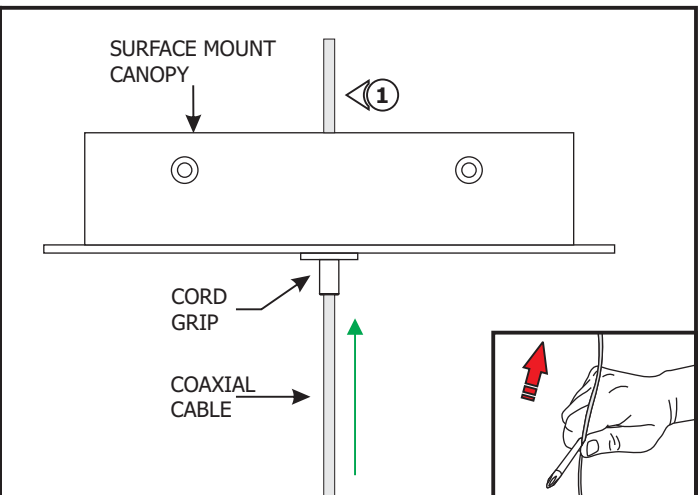
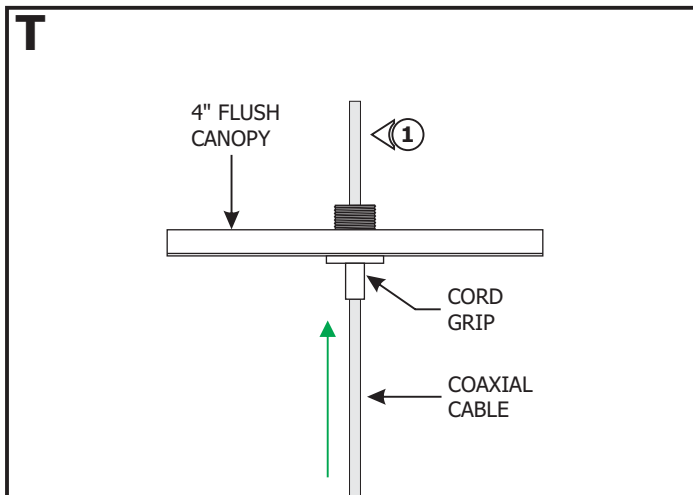

NOTE: If cable is curled or kinked, straighten by holding between the shaft of a screwdriver and thumb and pulling the cable through (see inset).

1: Push the coaxial cable through the cord grip of the canopy.



NOTE: Scan the QR Code to watch the video clip of the following steps or visit www.PureEdgeLighting.com/video_feed/installation_cxc_connector

2: Use the 18AWG hole of the wire stripper to remove 1-3/8" of the outer insulation to expose the braided wire.

3: Use the 18AWG hole of the wire stripper to remove 1" of the braided wire making sure not to nick the inner wire insulation.

4: Use the 20AWG hole of the wire stripper to remove 1/8" of the inner insulated wire.

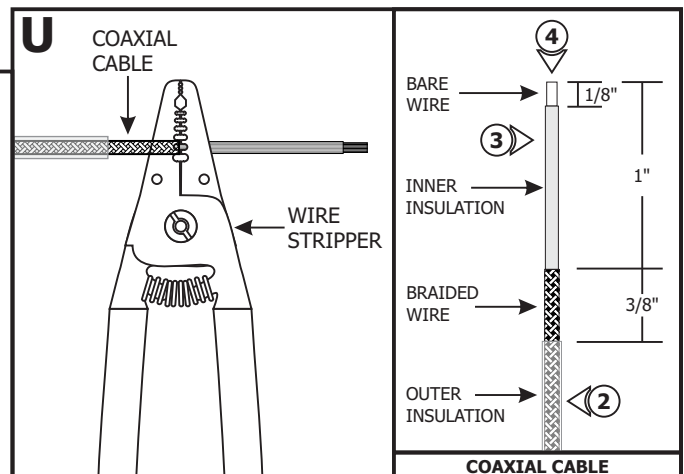

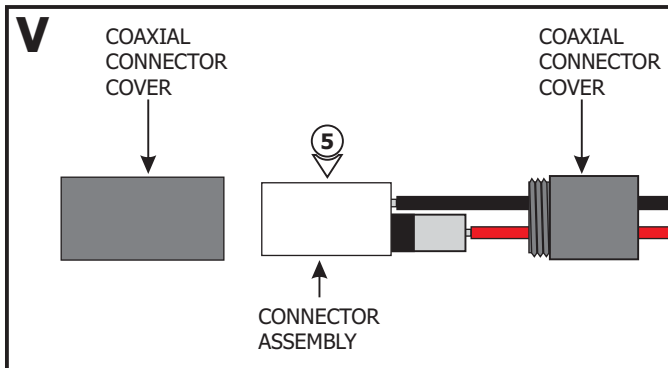

5: Unscrew the coaxial connector covers and remove from the connector assembly.

6: Using the provided 1.5mm Allen wrench, remove the M3 set screw from the coaxial connector assembly.

7: Using the provided 2mm Allen wrench to loosen (**Do Not Remove**) the M4 set screw.

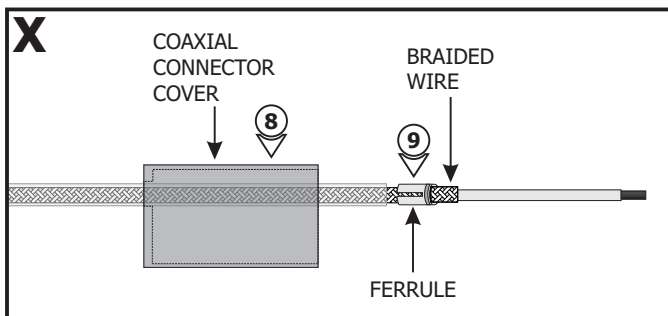
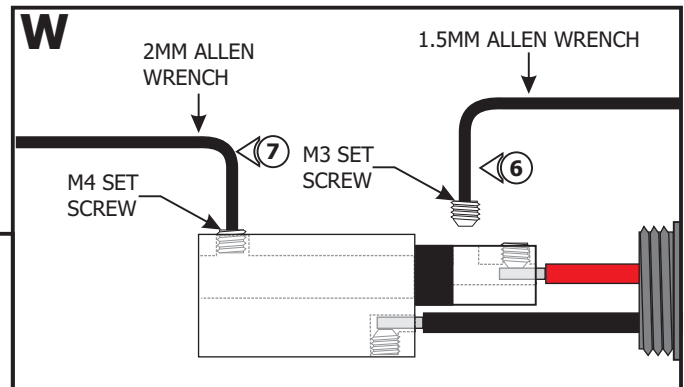

8: Slide the connector cover over the coaxial cable.

9: Place the ferrule over the 3/8" braided wire of the coaxial cable.

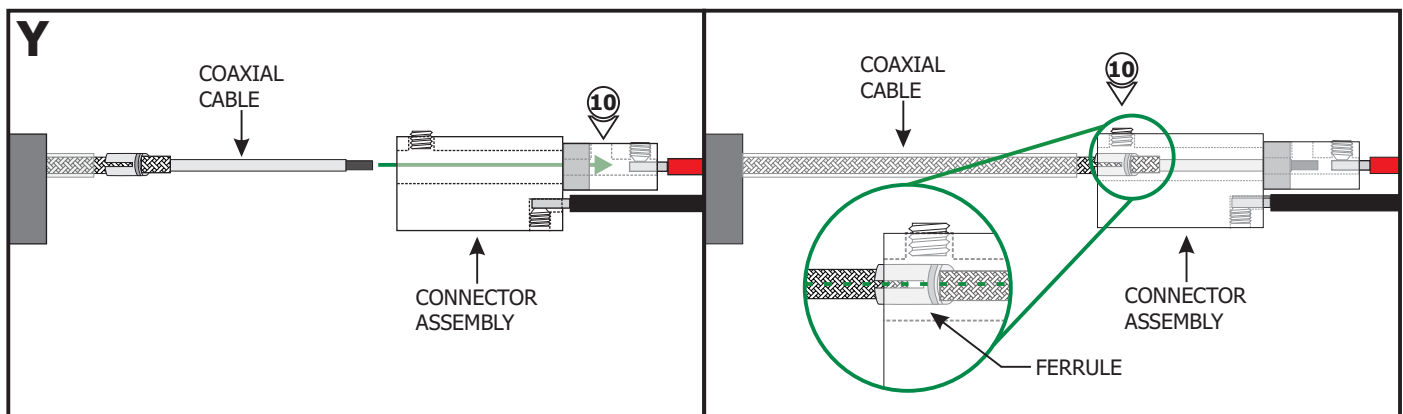

10: Insert the coaxial cable into the coaxial connector until the wires of the center conductor are visible through the M3 set screw hole.

NOTE: Ensure that the split in the ferrule is aligned 90° from the M4 set screw (see inset).

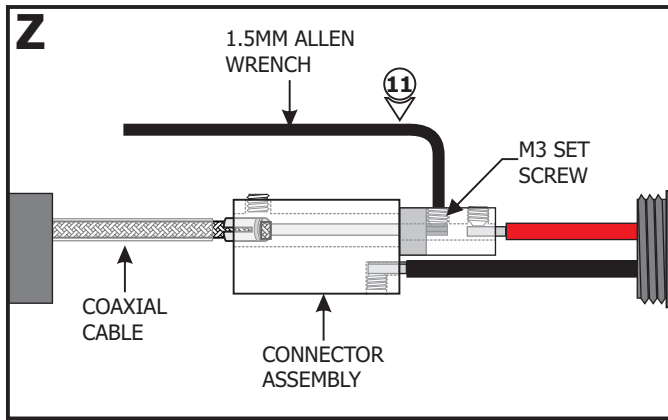

11: Use the provided 1.5mm Allen wrench to replace and securely tighten the M3 set screw.

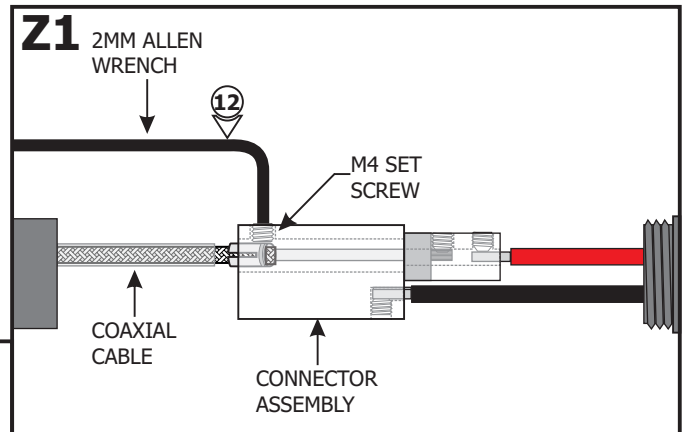

12: Use the provided 2mm Allen wrench to securely tighten the M4 set screw until it squeezes the wire ferrule tightly to the coaxial cable.

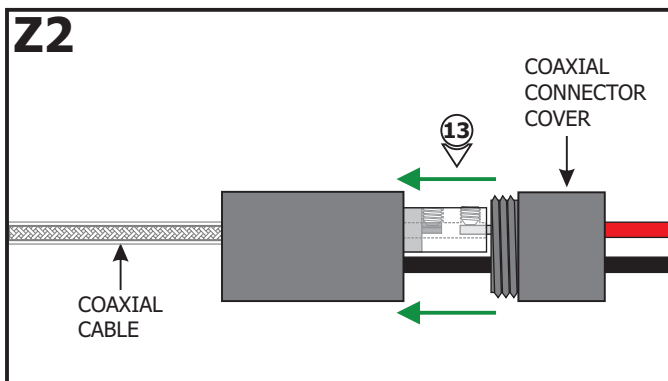

13: Replace the coaxial connector cover and tighten into place.

NOTE: For 5" and 6" Surface Mount Canopies, make sure that the coaxial connector is placed inside the power supply housing. **DO NOT** place it inside the junction box.

Section Six: Power the Fixture

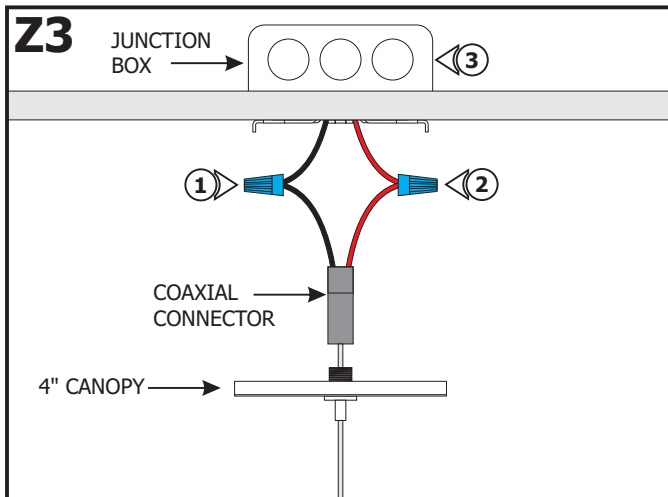

NOTE: Omit steps 1 through 4 if using 5" and 6" Surface Mount Canopies. Adjust fixture height by following step 9 on page 9.

4" Canopy:

- 1:** Connect the black wire of the coaxial connector to the -24VDC power supply wire using a wire nut.
- 2:** Connect the red wire of the coaxial connector to the +24VDC power supply wire using a wire nut.
- 3:** Place all connections inside the junction box.

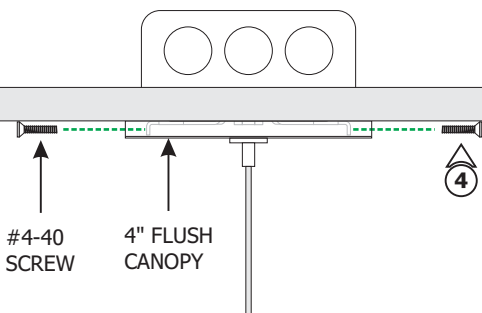
Z4

4: Align the canopy with the crossbar and secure it with the two #4-40 screws using a 1/16" Allen wrench.

5" and 6" Surface Mount Canopy:

5: Connect the white wire of the transformer to the 120VAC neutral wire using a wire nut.

6: Connect the black wire of the transformer to the 120VAC line wire using a wire nut.

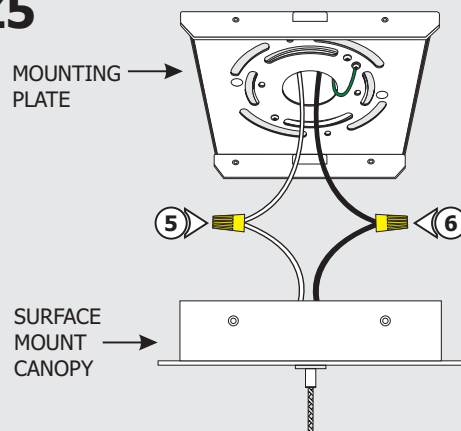
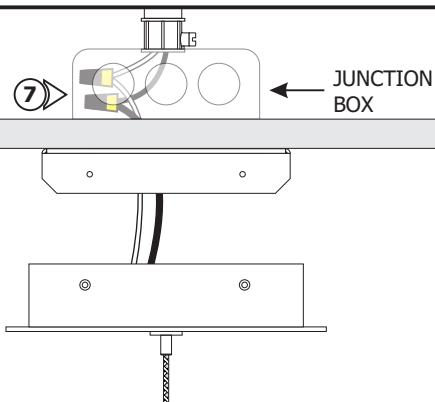
Z5**Z6**

7: Place all line voltage wires and wire nut connections inside the junction box.

8: Align the canopy holes and secure the canopy in place by tightening the four screws.

9: For fine adjusting the fixture height, push the cord grip to slide the fixture up and down until the desired height is achieved. Release the cord grip to lock the coaxial cable in place.

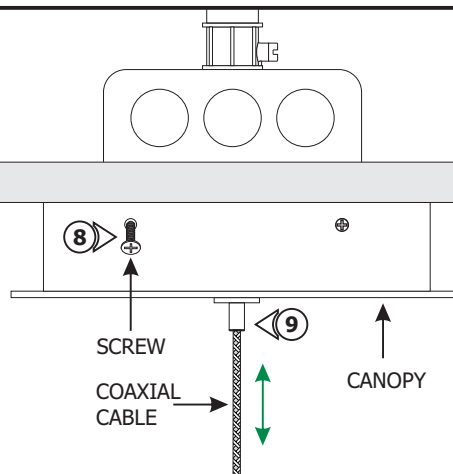
Z7

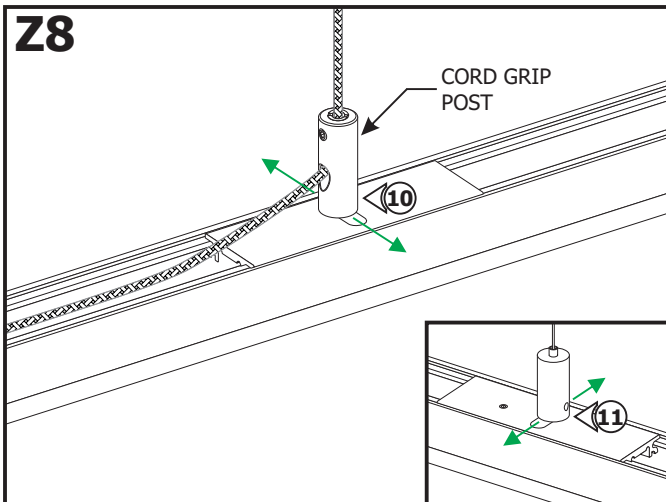

10: If necessary, slightly loosen (**DO NOT REMOVE**) the cord grip post by rotating it counter clockwise; balance the fixture by adjusting the position on the sliding post back and forth. Ensure the channel is straight then tighten the post clockwise to secure in place.

11: Repeat step 10 for each sliding post.

Section Seven: Connecting Channel Sections

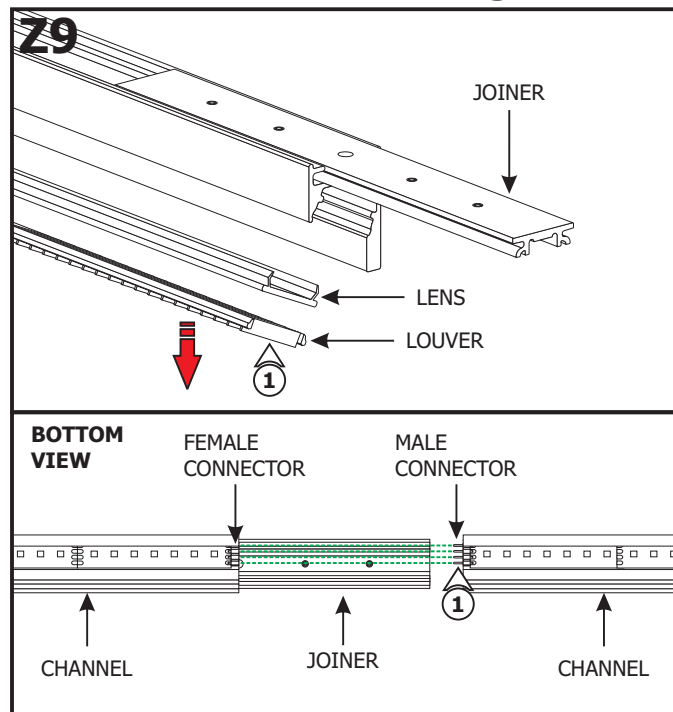

NOTE: Omit this section if the joiner did not come with the fixture depending on the overall fixture length.

NOTE: If applicable, multiple channels must be installed one by one.

1: Lift a section of the lens and louver at the end of the channels where the connectors are visible. Slide the channel over the joiner and ensure the male & female connectors mate properly.

2: Push the lens and louver back into the channel.

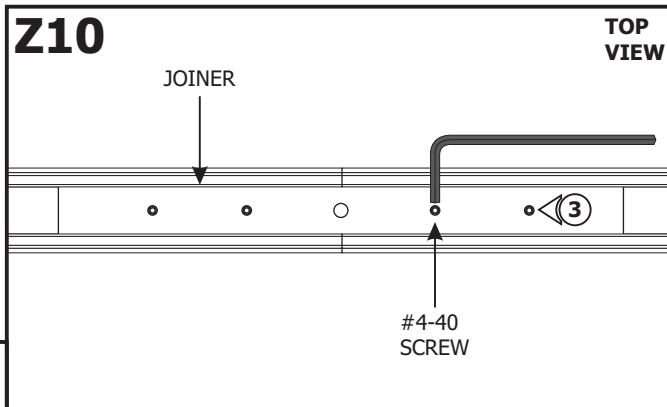

3: Tighten the remaining #4-40 set screws using the 0.05" Allen wrench.

General Wiring Diagram

