

# LUCA 2.7" STATIC WHITE

120V-277V, RECESSED FIXED & ADJUSTABLE DOWNLIGHTS

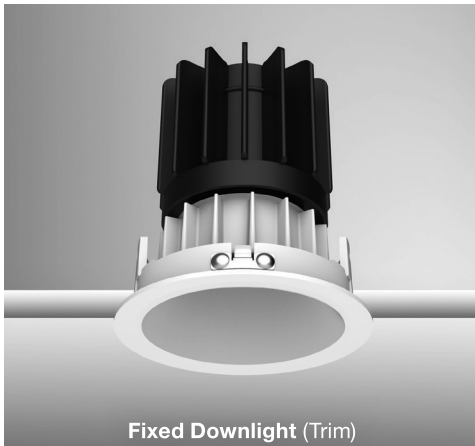

Fixed Downlight (Trim)

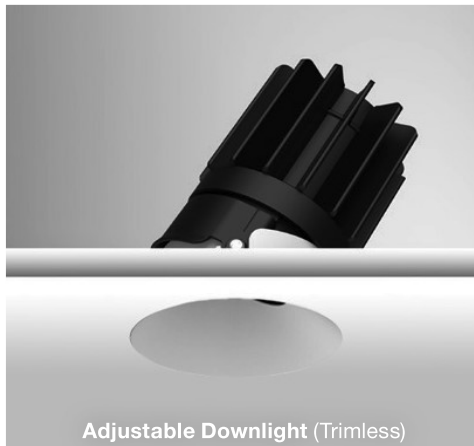

Adjustable Downlight (Trimless)



Adjustable Downlight Millwork (Trimless)

## DESCRIPTION

Introducing the Luca 2.7 "The Bringer of Light" Downlight Series—a beacon of innovation in lighting technology. Designed for high-performance, these downlights are crafted to enhance hospitality, retail, commercial, and luxury residential environments. Featuring precision optics, the Luca downlights deliver a beam that reaches the very top of the wall, creating an elegant wash of light. With a Color Rendering Index (CRI) surpassing 90, these lights ensure exceptional color accuracy, making them an ideal choice for spaces where ambiance and visual clarity are paramount.

The Luca Downlight series delivers captivating illumination across a wide spectrum, creating a visually engaging experience within any space. With its extensive range of design and installation options, our Luca 2.7 Downlight is versatile for a wide array of new construction and remodel applications. Moreover, the compact form factor of the Luca 2.7 allows for installation in spaces with limited clearance.

Discover a new era of lighting performance and versatility with the Luca 2.7 Downlight Series, where superior optics, lumen performance, and outstanding color consistency converge to transform a space. For personalized quotes and expert layout assistance, share your drawings and concepts with our design team at [design@PureEdgeLighting.com](mailto:design@PureEdgeLighting.com)

## SPECIFICATIONS

<b>TRIM OPTIONS</b>	Trim, Trimless, Round, Square for Fixed & Adjustable			<b>DIMMING</b>  Universal Dimming TRIAC/ELV: 100% – 3% 0-10V: 100% – 0.1% Dim to Off DALI2: 100% – 0.1% Dim to Off Pure Smart™ 100% – 5% Pure Smart™ Wi-Fi Dimmer TRIAC/ELV 2.4GHz Wi-Fi. No Hub needed. Voice control with Goggle Assistant, Alexa, Siri, Shortcuts, and IFTTT
<b>FINISH</b>	Reflector: White, Black, Haze Silver (low-glare), Trims: White, Black, Custom			
<b>ADJUSTABLE</b>	30° Tilt, 360° Rotation			
<b>OPTICS</b>	10°, 15°, 25°, 35°, 45°, 55°			
<b>WATTAGE</b>	16W	20W	24W	
<b>LUMENS @ 3000K, 30°</b>	1123 Lm	1346 Lm	1507 Lm	
<b>EFFICACY</b>	70 Lm/W	75 Lm/W	63 Lm/W	
<b>CCT</b>	2400K, 2700K, 3000K, 3500K & 4000K			
<b>AVERAGE CRI</b>	90+			
<b>INPUT VOLTAGE</b>	120V ELV/TRIAC, 120V-277V & 0-10V & DALI/DMX			
<b>CONSTRUCTION</b>	Housing: Galvanized Steel Heat Sink, Trims and Reflectors: Die-Cast Aluminum			
<b>ACCESSORIES</b>	Clear Glass & Soft Diffusing Film (Included) Linear Spread Glass Lens, Wide Diffused Glass Lens, Double Asymmetric Glass Lens, or Hexcell Louver			
<b>EMERGENCY POWER</b>	100W EM Power 120-277VAC			
<b>CUT OUT SIZE</b>	Round: Ø3", Square: 3"			
<b>CEILING THICKNESS</b>	0.5" - 1"			
<b>ENVIRONMENT</b>	Suitable for damp locations			
<b>CERTIFICATIONS</b>	ETL Listed. Meets Title 24 (JA8) requirements <b>Downlight Trim - Wet Listed Adjustable - Damp listed*</b> <small>*Glass Lens to be used in showers and similar environments</small>			
<b>AVERAGE LIFE</b>	50,000 Hours			
<b>WARRANTY*</b>	5 Years <small>*See published warranty terms for detailed information</small>			

	LUCA 2.7 STATIC WHITE														
	16W					20W					24W				
<b>WATTS PER FOOT</b>															
<b>COLOR TEMPERATURE</b>	24K	27K	30K	35K	40K	24K	27K	30K	35K	40K	24K	27K	30K	35K	40K
<b>LUMENS</b>	966	1078	1123	1146	1168	1158	1292	1346	1373	1400	1296	1447	1507	1537	1567
<b>LUMENS PER WATT (lm/w)</b>	60	67	70	72	73	64	72	75	76	78	54	60	63	64	65
<b>CRI</b>	93	93	93	93	93	92	92	92	92	92	92	92	92	92	92

PROJECT		FIXTURE TYPE		DATE	
---------	--	--------------	--	------	--

# LUCA 2.7" STATIC WHITE

## 120V-277V, RECESSED FIXED & ADJUSTABLE DOWNLIGHTS

### #1 Select LUCA 2.7 Beam, Color Temperature, Trim Options

System	Beam Spread	Color Temperature	Trim Shape	Trim Function	Reflector Finish	Trim Finish
<b>L27</b>	<b>NF</b>	<b>27K</b>	<b>R</b>	<b>D</b>	<b>W</b>	<b>L</b>
<b>L27</b> Luca 2.7 Light Engine	<b>VS</b> Very Narrow Spot 10° <b>NS</b> Narrow Spot 15° <b>SP</b> Spot 25° <b>NF</b> Narrow Flood 35° <b>FL</b> Flood 45° <b>WF</b> Wide Flood 55° <small>*NS: 16 Watt Only</small>	<b>24K*</b> 2400K Very Warm White <b>27K</b> 2700K Incandescent White <b>30K</b> 3000K Warm White <b>35K</b> 3500K Neutral White <b>40K</b> 4000K Cool White <small>*Only available in NS</small>	<b>R</b> Round <b>S</b> Square	<b>D</b> Downlight <b>A</b> Adjustable <b>P*</b> Pinhole/Adjustable <small>*Only available with black reflector and millwork, trimless or white trim</small>	<b>W</b> White <b>H</b> Haze <b>B</b> Black <b>C</b> Custom	<b>W</b> White <b>B</b> Black <b>L</b> Trimless <b>M</b> Wood Millwork <b>C</b> Custom



### #2 Select Housing & Driver Type

#### REMODEL NON-IC with 120V DRIVER

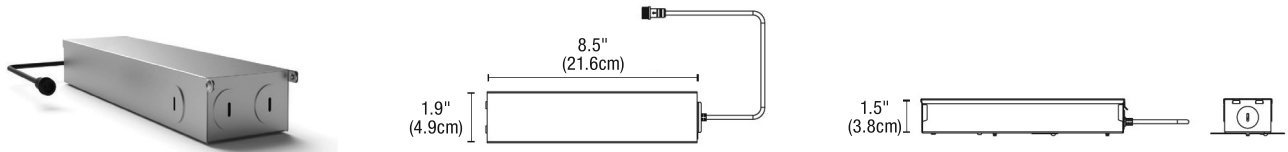

Product	Housing Type	Rating Type	Wattage/Lumens	Dimming
<b>L27</b>	<b>RM</b>	<b>NIC</b>	<b>20W</b>	<b>UN</b>
<b>L27</b> Luca 2.7 Downlight	<b>RM</b> Remodel	<b>NIC</b> Non-Insulation Contact	<b>16W</b> 16 Watts/1123 Lumens <b>20W</b> 20 Watts/1346 Lumens <b>24W</b> 24 Watts/1507 Lumens	<b>UN</b> TRIAC/MLV, ELV 120V Input <b>01</b> 0-10V 120V/277V Input <b>DA</b> DALI 2 120V/277V Input

#### NEW CONSTRUCTION FRAME NON-IC with 120V DRIVER

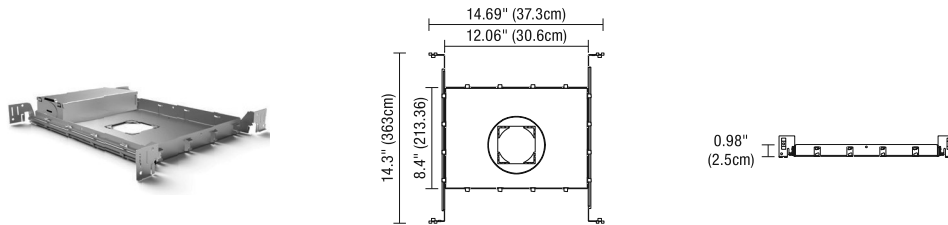

Product	Housing Type	Rating Type	Wattage/Lumens	Dimming
<b>L27</b>	<b>NCF</b>	<b>NIC</b>	<b>20W</b>	<b>UN</b>
<b>L27</b> Luca 2.7 Downlight	<b>NCF</b> New Construction Frame	<b>NIC</b> Non-Insulation Contact	<b>16W</b> 16 Watts/1123 Lumens <b>20W</b> 20 Watts/1346 Lumens <b>24W</b> 24 Watts/1507 Lumens	<b>UN</b> TRIAC/MLV, ELV 120V Input <b>01</b> 0-10V 120V/277V Input <b>DA</b> DALI 2 120V/277V Input

#### NEW CONSTRUCTION HOUSING IC WITH 120V DRIVER

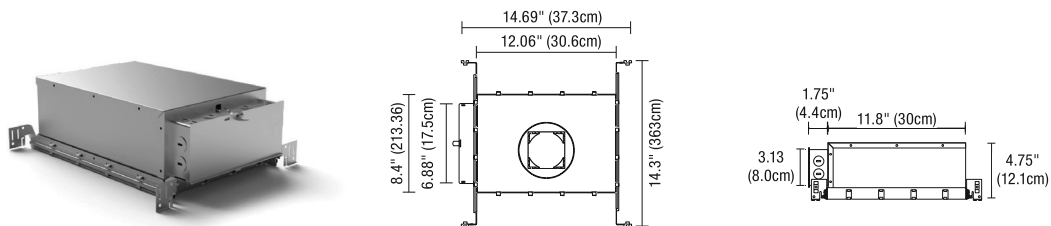

Product	Housing Type	Rating Type	Wattage/Lumens	Dimming
<b>L27</b>	<b>NCH</b>	<b>IC</b>	<b>16W</b>	<b>UN</b>
<b>L27</b> Luca 2.7 Downlight	<b>NCH</b> New Construction Housing	<b>IC</b> Insulation Contact	<b>16W</b> 16 Watts/1123 Lumens	<b>UN</b> TRIAC/MLV, ELV 120V Input <b>01</b> 0-10V 120V/277V Input <b>DA</b> DALI 2 120V/277V Input

PROJECT		FIXTURE TYPE		DATE	
---------	--	--------------	--	------	--

**LUCA 2.7 MILLWORK TRIMLESS ADAPTER (INCLUDED WITH TRIM OPTION M)**

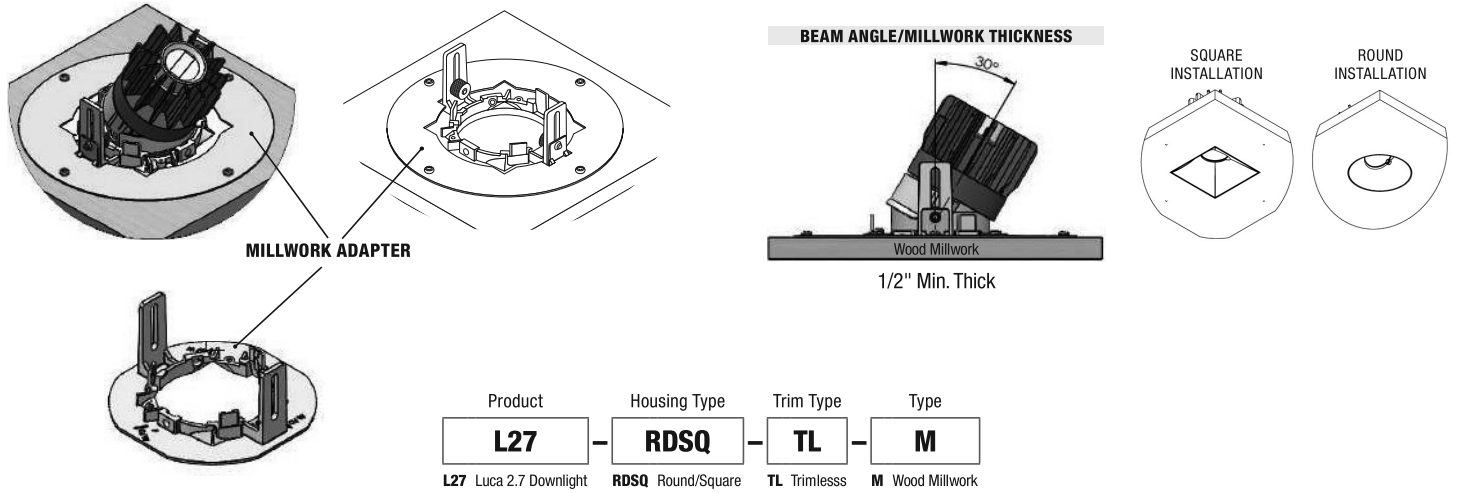

**TRIMLESS ADAPTER INSTALLATION**

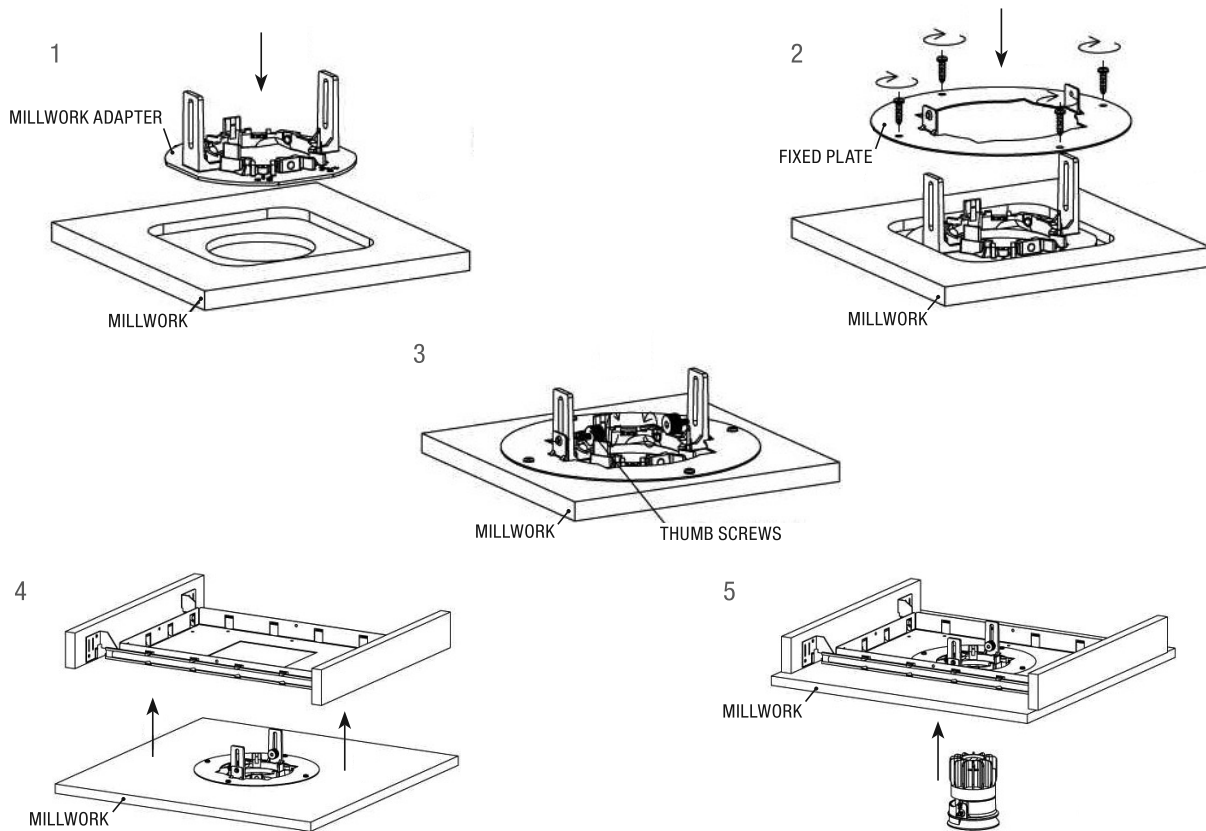

PROJECT		FIXTURE TYPE		DATE	
---------	--	--------------	--	------	--

# LUCA 2.7" STATIC WHITE

120V-277V, RECESSED FIXED & ADJUSTABLE DOWNLIGHTS

## LUCA 2.7 TRIM OPTIONS

REV 12.30.25

### Fixed Downlight

### Adjustable Downlight



Round Trim

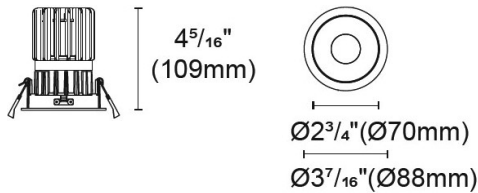

Round Trim

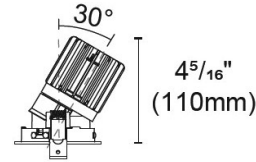

Round Trim Pinhole

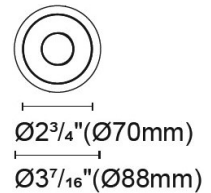

Round Trimless

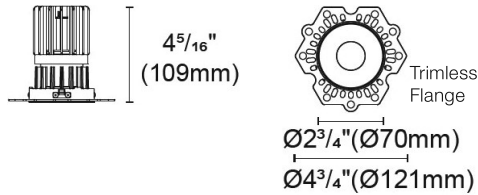

Round Trimless

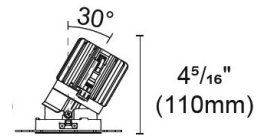

Round Trimless Pinhole

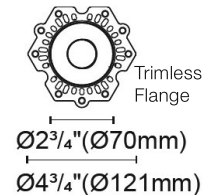

Square Trim

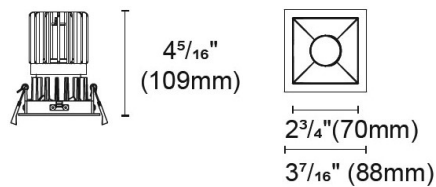

Square Trim

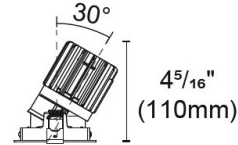

Square Trim Pinhole

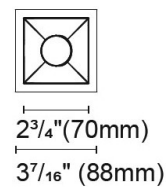

Square Trimless

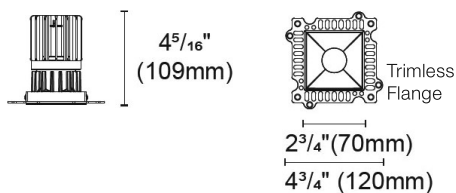

Square Trimless

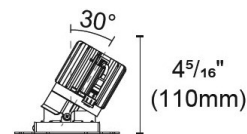

Square Trimless Pinhole

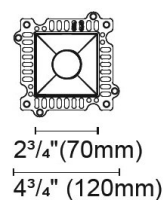

PROJECT		FIXTURE TYPE		DATE	
---------	--	--------------	--	------	--

**LUCA 2.7 TRIM & REFLECTOR OPTIONS**

**ROUND TRIM**

**Black Trim**

**White Trim**



**Black Reflector**



**White Reflector**

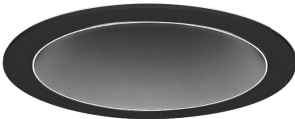

**Haze Reflector**



**Pinhole Trim**

**SQUARE TRIM**

**Black Trim**

**White Trim**



**Black Reflector**



**White Reflector**



**Haze Reflector**



**Pinhole Trim**

PROJECT		FIXTURE TYPE		DATE	
---------	--	--------------	--	------	--

# LUCA 2.7" STATIC WHITE

120V-277V, RECESSED FIXED & ADJUSTABLE DOWNLIGHTS

## BEAM SPREAD & LENSES

### LOW GLARE REFLECTOR

Designed with a 30 degree cut-off angle, the Luca provides high output and efficiency while maximizing visual comfort.

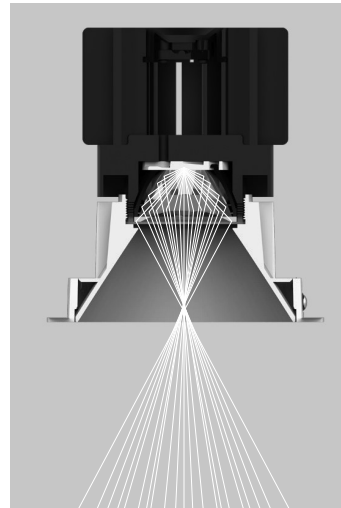
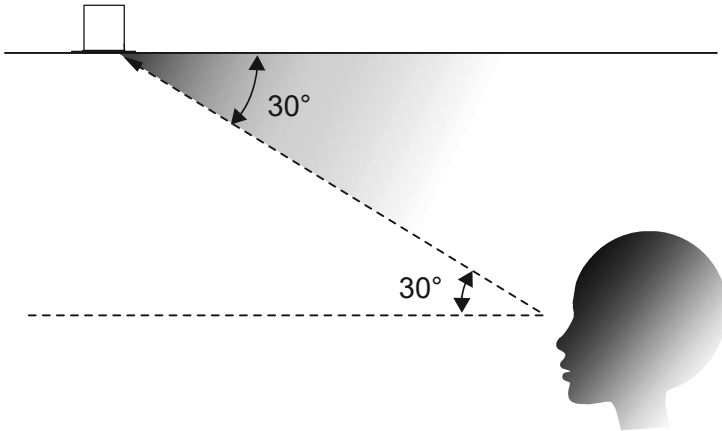

### OPTICS

Our Luca Downlight has been meticulously designed to deliver exceptional performance and visual comfort. With its deep baffle design and a 30° cut-off, it effectively minimizes glare while providing a consistent and high-quality distribution of white light.

Our Adjustable Downlight features a 30° tilt for precise aiming and control.

### SELECT UP TO TWO ACCESSORIES

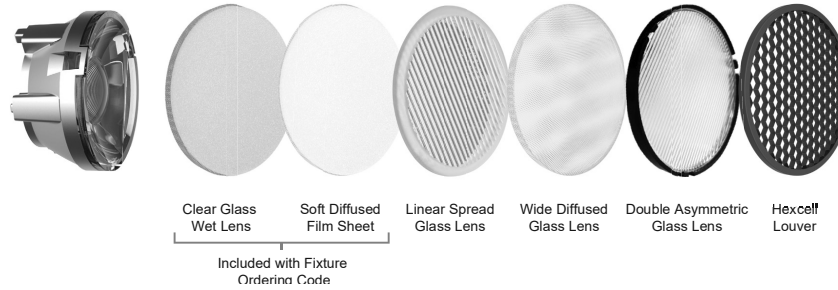

In addition to the included glass wet Lens and soft diffusion film we offer a variety of beam spreads, and lens accessories to tailor the output and beam shape for specific applications. The Linear spread lens glass produces an elliptical illumination pattern, while the Wide diffused glass lens evenly distribute the light. The Double Asymmetric Glass Lens splits the light beam evenly into two opposing directions, creating two elliptical illumination patterns. Additionally, the Hexcell Louver is available for enhanced glare control.

### REPLACEMENT OPTICS

Product	Type	Beam Spread*	Color Temperature
<b>LEN</b>	<b>L2.7</b>	<b>NF</b>	<b>SW</b>
LEN Lens	L2.7 Luca 2.7	<b>SP</b> Spot 25° <b>NF</b> Narrow Flood 35° <b>FL</b> Flood 45°	SW Static White

\*Restrictions: NS & WF not available for replacement optics

### Accessories (up to 2)

Product	Type
<b>GL13</b>	<b>L</b>
GL13 Glass 1 5/8" (40mm) Diameter	<b>C</b> Clear Glass Wet Lens <b>L</b> Linear Spread Glass Lens <b>W</b> Wide Diffuse Glass Lens <b>DAL</b> Double Asymmetric Glass Lens
LF13 Lens Film 1 5/8" (40mm) Diameter	<b>S</b> Soft Diffusion Film
L013 Louver 1 5/8" (40mm) Diameter	<b>H</b> Hexcell Louver

# LUCA 2.7" STATIC WHITE

120V-277V, RECESSED FIXED & ADJUSTABLE DOWNLIGHTS

## LUCA 2.7 FOOT CANDLE DISTRIBUTION (CONTINUED)

D - Distance From Luca fixture, FC - Initial foot candles at the center of beam, DIA - Diameter

### 16W at 3000K

**NARROW SPOT**  
15°

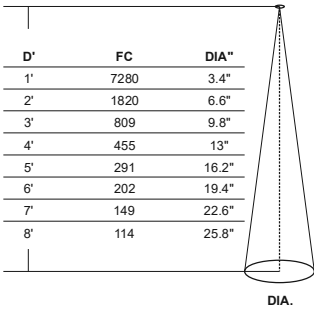
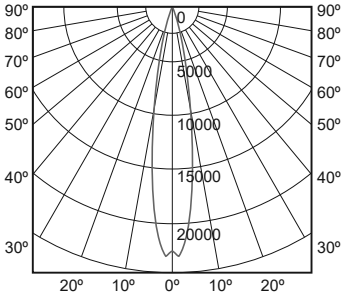

**SPOT**  
25°

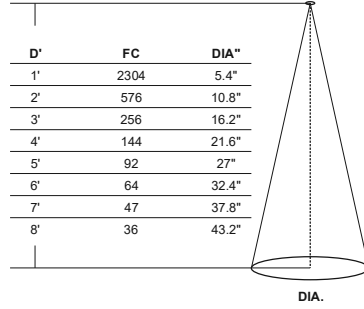
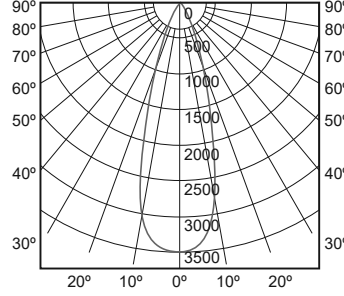

**NARROW FLOOD**  
30°

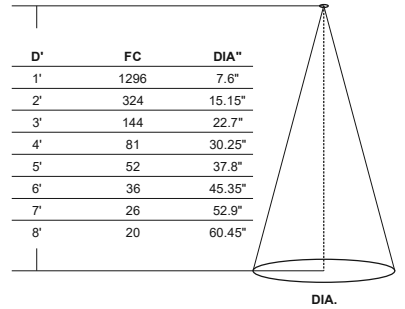
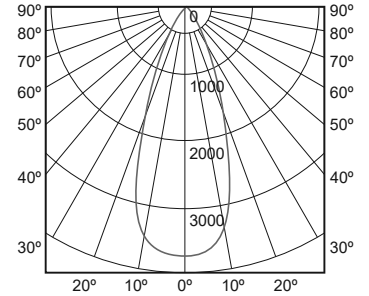

**FLOOD**  
40°

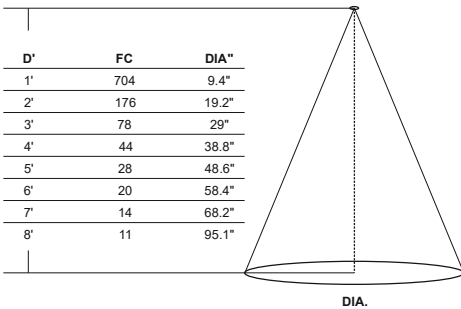
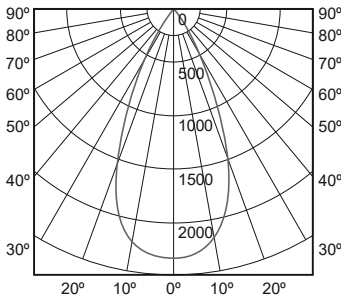

**WIDE FLOOD**  
55°

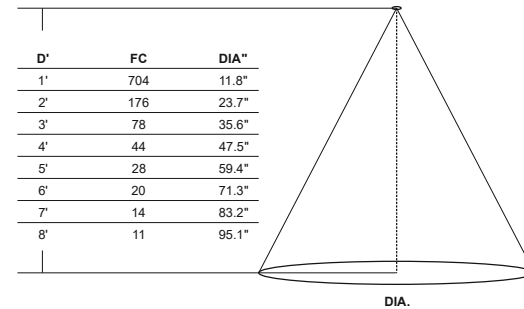
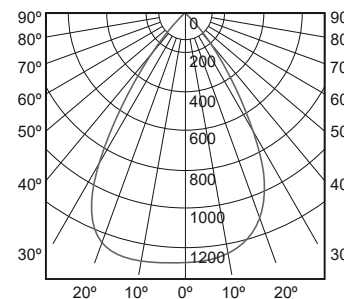

PROJECT	FIXTURE TYPE	DATE
---------	--------------	------

# LUCA 2.7" STATIC WHITE

120V-277V, RECESSED FIXED & ADJUSTABLE DOWNLIGHTS

## LUCA 2.7 FOOT CANDLE DISTRIBUTION (CONTINUED)

D - Distance From Luca fixture, FC - Initial foot candles at the center of beam, DIA - Diameter

### 20W at 3000K

**SPOT**  
25°

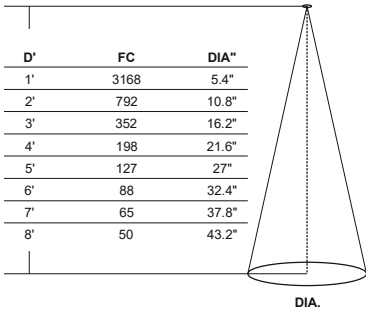
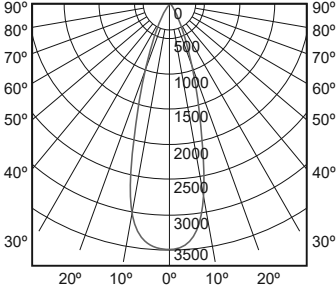

**NARROW FLOOD**  
35°

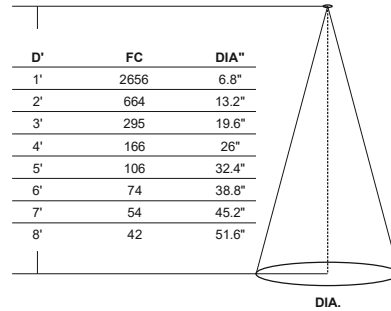
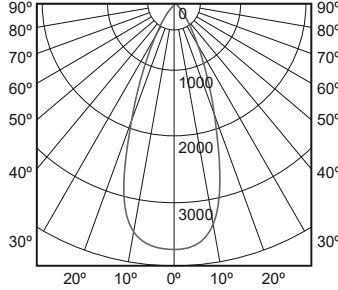

**FLOOD**  
45°

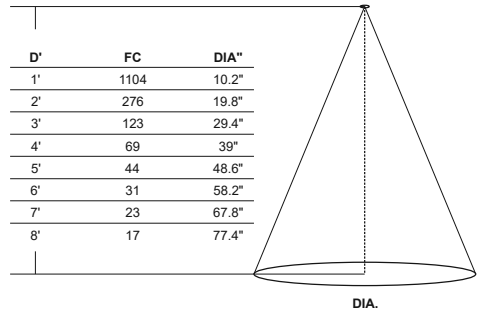
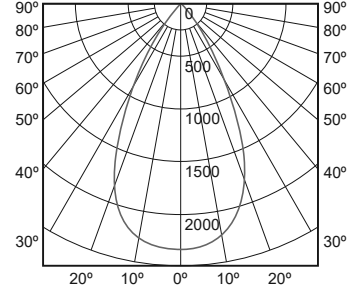

**WIDE FLOOD**  
55°

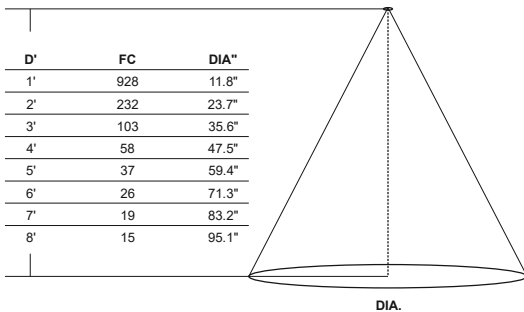
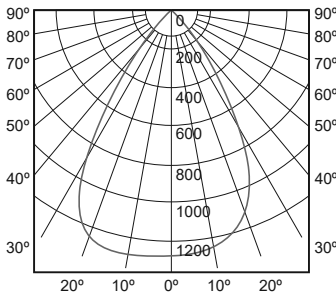

PROJECT	FIXTURE TYPE	DATE	
---------	--------------	------	--

# LUCA 2.7" STATIC WHITE

120V-277V, RECESSED FIXED & ADJUSTABLE DOWNLIGHTS

## LUCA 2.7 FOOT CANDLE DISTRIBUTION (CONTINUED)

D - Distance From Luca fixture, FC - Initial foot candles at the center of beam, DIA - Diameter

### 24W at 3000K

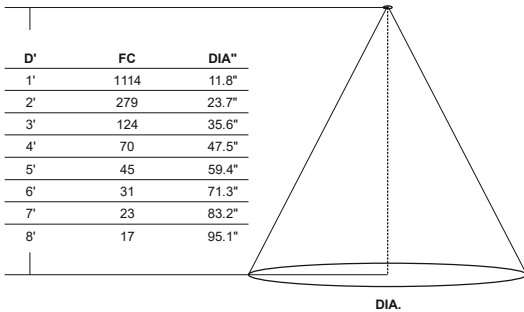
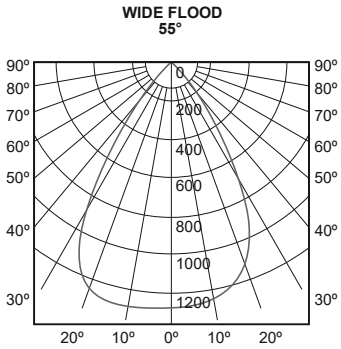
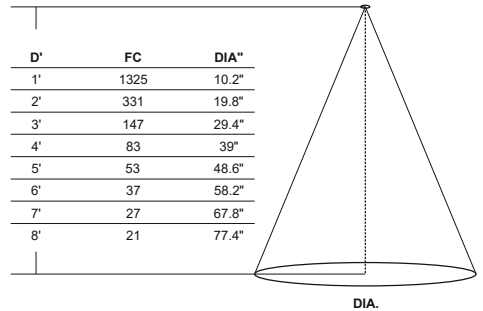
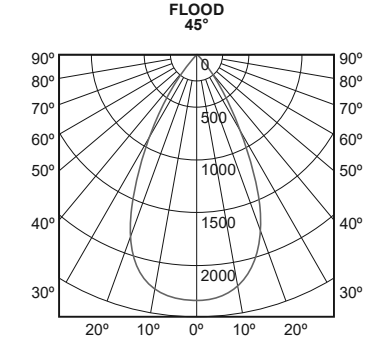
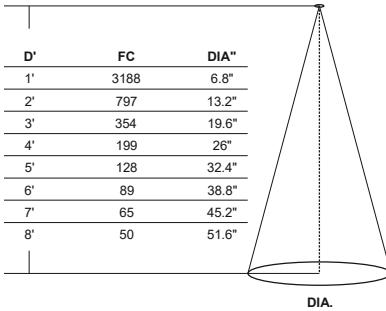
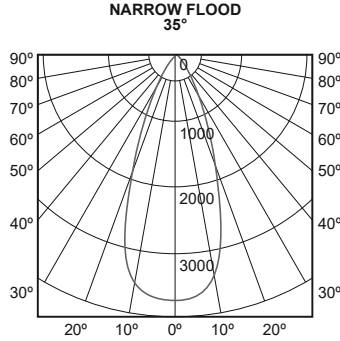
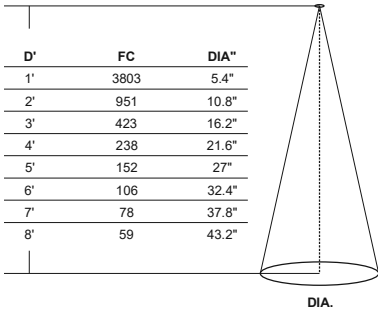
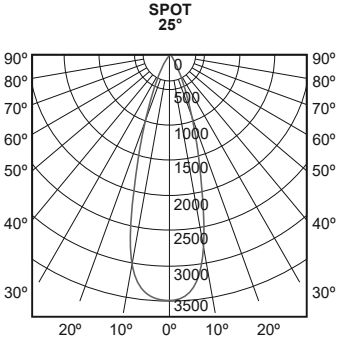

PROJECT		FIXTURE TYPE		DATE	
---------	--	--------------	--	------	--

# LUCA 2.7" STATIC WHITE

120V-277V, RECESSED FIXED & ADJUSTABLE DOWNLIGHTS

## LUCA 2.7 FOOT CANDLE DISTRIBUTION (CONTINUED)

D - Distance From Luca fixture, FC - Initial foot candles at the center of beam, DIA - Diameter

### 26W at 3000K

**SPOT**  
25°

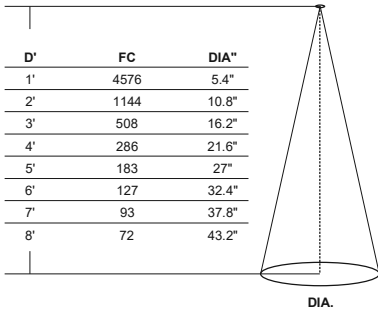
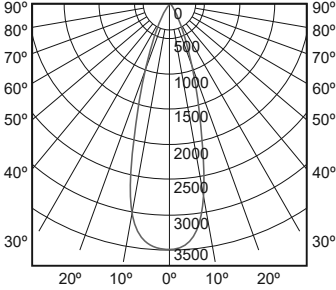

**NARROW FLOOD**  
35°

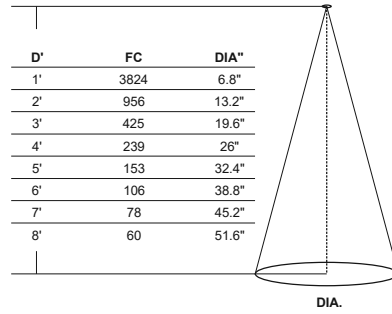
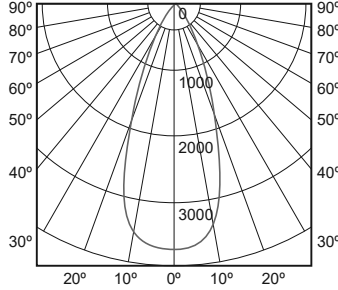

**FLOOD**  
45°

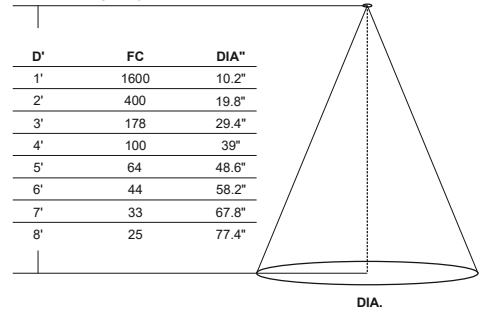
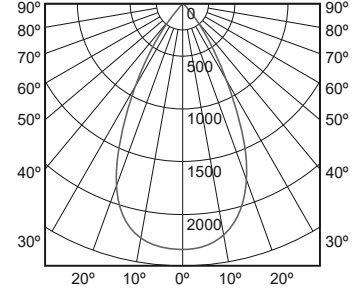

**WIDE FLOOD**  
55°

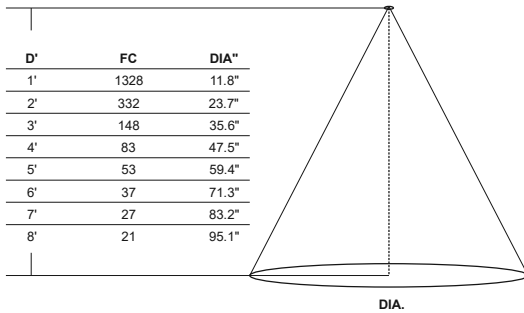
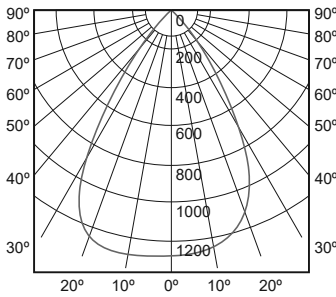

PROJECT	FIXTURE TYPE	DATE	
---------	--------------	------	--

# LUCA 2.7" STATIC WHITE

120V-277V, RECESSED FIXED & ADJUSTABLE DOWNLIGHTS

**TRIAC / FORWARD PHASE / LEADING EDGE DIMMING (TRI)**  
 Input 120VAC 50/60Hz  
 Range 3% - 100%

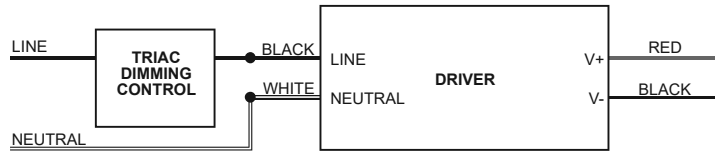

**ELV / REVERSE PHASE / TRAILING EDGE DIMMING (TRI)**  
 Input 120VAC 50/60Hz  
 Range 3% - 100%

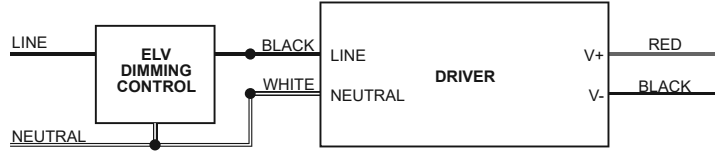

**0-10V DIMMING (010)**  
 Input 120VAC-277VAC 50/60Hz  
 Range 0.1% - 100% Dim to Off

**NOTE**  
 Cap off unused wires individually.  
 DO NOT cap together.

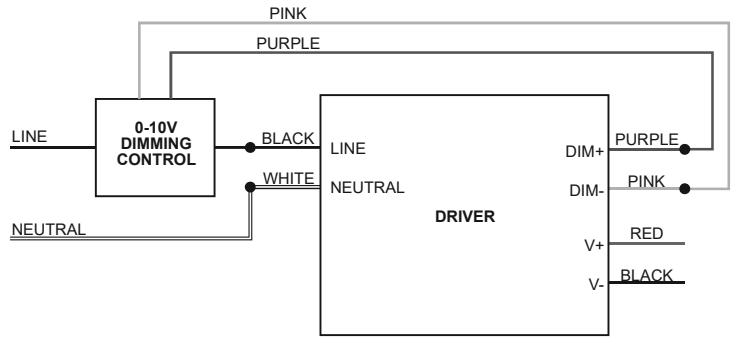

**DALI DIMMING (DAL)**  
 Input 120VAC-277VAC 50/60Hz  
 Range 0.1% - 100% Dim to Off

**NOTE**  
 Cap off unused wires individually.  
 DO NOT cap together.

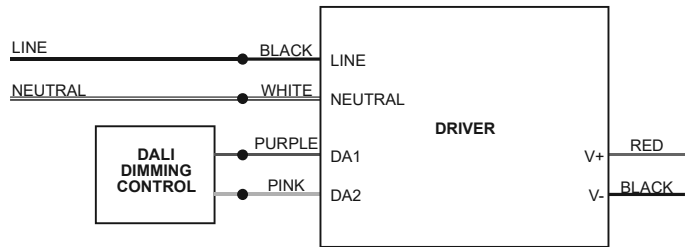

PROJECT		FIXTURE TYPE		DATE	
---------	--	--------------	--	------	--

**LUCA 2.7" STATIC WHITE**  
120V-277V, RECESSED FIXED & ADJUSTABLE DOWNLIGHTS

**TM-30-15 DATA**

**2400K** | Rf: 91.2 | Rg: 96.8

Color Vector Graphic

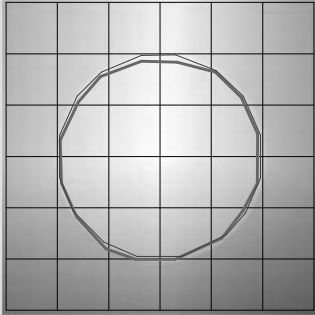

■ Test ■ Reference

		GRAPHIC SHIFTS %	
HUE BIN	Rf	CHROMA	HUE
1	92.0	-2.4%	1.5%
2	94.7	-2.1%	0.0%
3	95.4	-1.9%	-0.1%
4	88.7	-6.7%	-3.1%
5	92.8	-5.6%	1.0%
6	92.7	-3.4%	3.4%
7	89.9	-4.3%	4.1%
8	92.4	-1.4%	4.4%
9	89.0	-0.6%	5.8%
10	88.9	0.4%	6.2%
11	89.7	4.0%	5.4%
12	92.6	3.0%	-0.7%
13	90.9	1.1%	-7.0%
14	89.9	0.5%	-5.8%
15	92.1	-3.2%	0.1%
16	88.9	-1.7%	-6.3%

**2700K** | Rf: 87.7 | Rg: 96.1

Color Vector Graphic

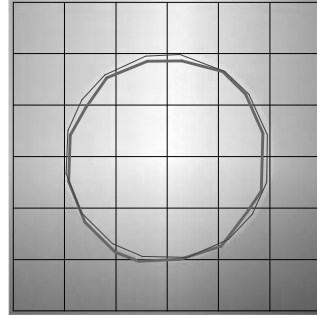

■ Test ■ Reference

		GRAPHIC SHIFTS %	
HUE BIN	Rf	CHROMA	HUE
1	88.0	-4.3%	2.6%
2	91.6	-2.4%	2.0%
3	93.7	-1.4%	1.9%
4	88.9	-5.6%	-3.1%
5	92.3	-5.5%	-0.5%
6	92.9	-3.5%	0.1%
7	84.5	-7.5%	4.6%
8	90.8	-3.0%	4.4%
9	84.5	-1.3%	8.3%
10	83.9	2.0%	9.8%
11	87.2	5.3%	7.1%
12	89.2	5.4%	-2.6%
13	88.7	0.3%	-7.8%
14	86.8	1.7%	-9.3%
15	87.6	-5.4%	-1.3%
16	83.6	-3.3%	-9.5%

**3000K** | Rf: 88.1 | Rg: 99.7

Color Vector Graphic

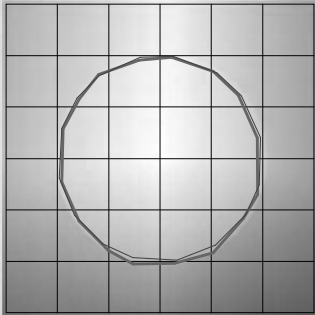

■ Test ■ Reference

		GRAPHIC SHIFTS %	
HUE BIN	Rf	CHROMA	HUE
1	92.5	-3.1%	0.3%
2	93.3	-2.3%	1.9%
3	90.9	-0.8%	3.9%
4	94.3	-1.1%	1.4%
5	92.5	-2.6%	1.5%
6	96.4	1.2%	-0.3%
7	92.6	-2.5%	-0.0%
8	96.9	-1.4%	0.2%
9	92.3	-1.8%	4.3%
10	86.6	-0.7%	7.0%
11	86.5	2.4%	8.2%
12	89.8	5.9%	1.7%
13	93.9	2.6%	-2.7%
14	89.4	5.1%	-5.8%
15	90.1	-0.1%	-4.7%
16	86.5	0.3%	-9.7%

**3500K** | Rf: 86.1 | Rg: 95.5

Color Vector Graphic

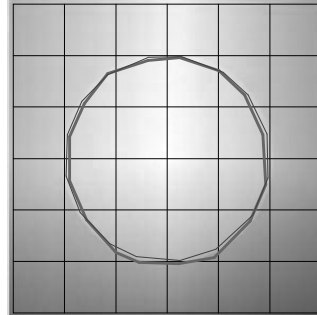

■ Test ■ Reference

		GRAPHIC SHIFTS %	
HUE BIN	Rf	CHROMA	HUE
1	90.8	-3.8%	0.3%
2	92.3	-2.8%	2.1%
3	89.7	-1.0%	4.3%
4	92.6	-1.4%	1.7%
5	91.8	-3.1%	1.3%
6	96.2	0.8%	-0.4%
7	92.9	-3.2%	0.2%
8	94.3	-2.5%	1.5%
9	90.4	-2.5%	5.2%
10	84.3	-1.4%	9.5%
11	83.1	3.5%	9.8%
12	88.2	4.8%	3.4%
13	94.0	2.7%	-2.0%
14	88.7	5.9%	-5.8%
15	88.7	0.7%	-5.9%
16	86.8	-0.7%	-6.7%

PROJECT		FIXTURE TYPE		DATE	
---------	--	--------------	--	------	--