



Pastille

12433 rB

Collar, Disc and
Wayfind
Low Voltage Input

Note: External power supply may be required.

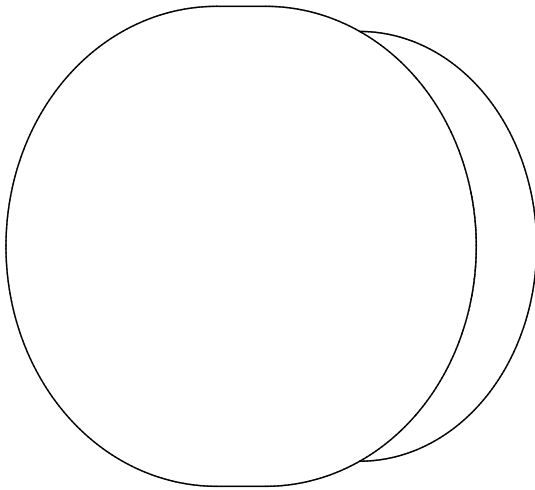

CAUTION:

Before starting, turn off power
at main circuit panel.

ADVERTENCIA:

Antes de comenzar la instalación,
apague la corriente en el tablero
principal.

ATTENTION:

Coupez l'alimentation avant de
procéder à l'installation.



Calling for backup? Scan above
to contact our team.

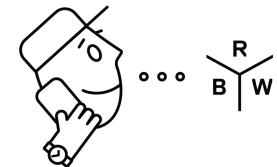
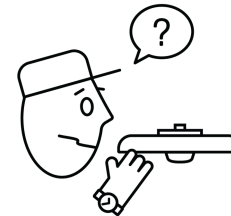

www.RBW.com

+1 212 388 0399

support@RBW.com

© RBW Studio LLC, 2013, 2020

What's Included: Part Configurations May Vary

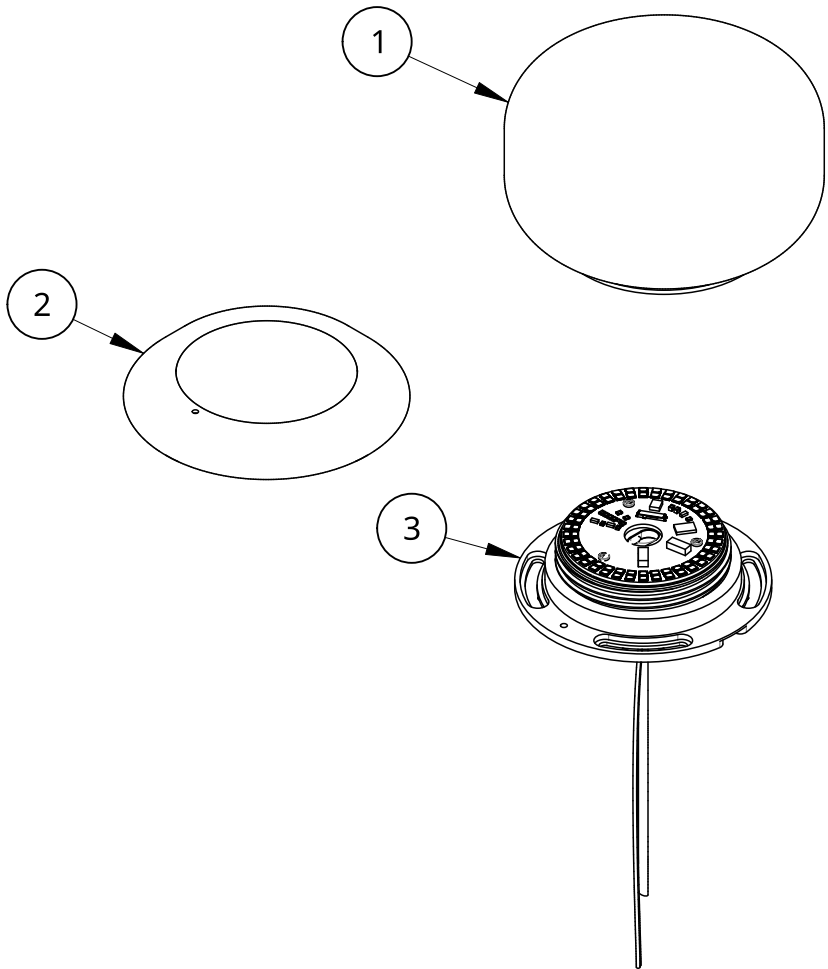

Item	Qty	Part number	Description
1	1	13737	Pastille Glass Droplet. IP20. w Mount Collar. PC20
2	1	13834-PC20	Package: Pastille Sconce Collar. Matte White
3	1	14061-27	Package: Pastille Module. Standard DC LED. IP20

What's Included: Part Configurations May Vary

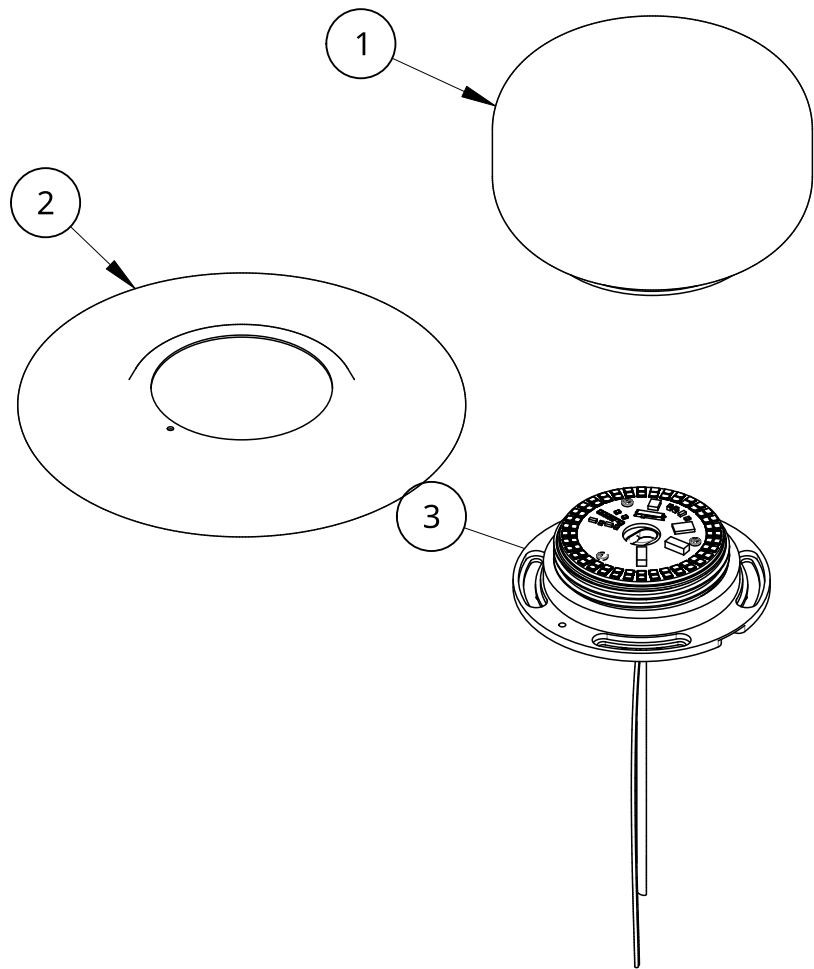

Item	Qty	Part number	Description
1	1	13737	Pastille Glass Droplet. IP20. w Mount Collar. PC20
2	1	13823-PC20	Package: Pastille Disc. Matte White
3	1	14061-27	Package: Pastille Module. Standard DC LED. IP20

Collar



Driver dimensions and location may vary, consult your order confirmation for details.

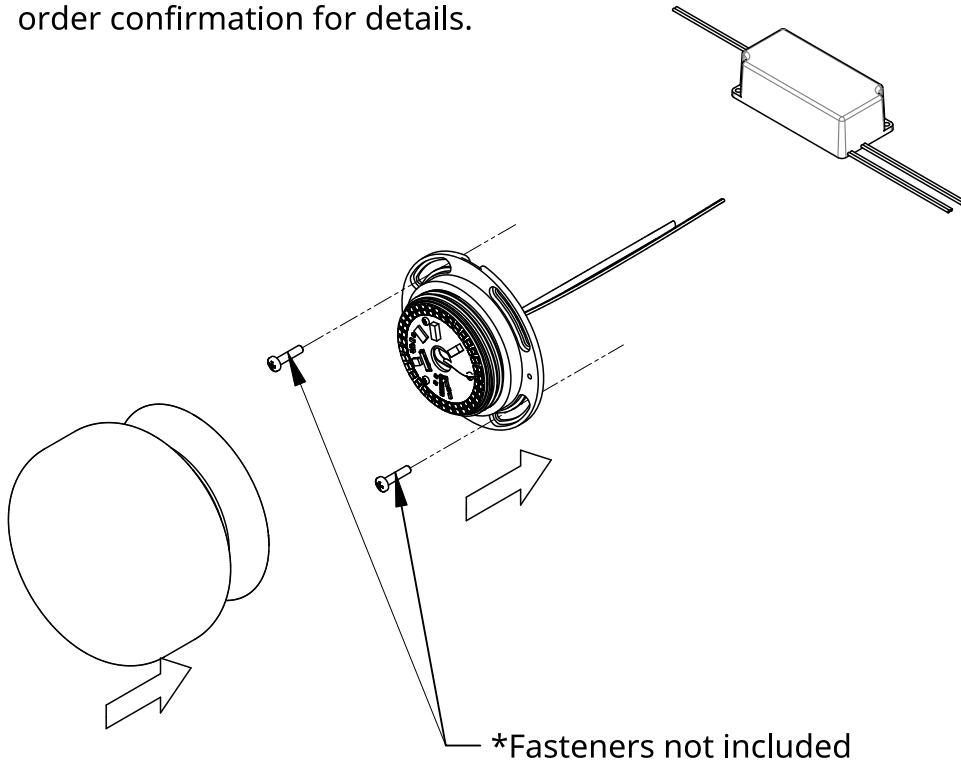

Installation - Pastille Collar

1. Connect Red (+) and Black (-) leads to low voltage leads from externally located driver.
2. Use appropriate fasteners to fasten the Sconce Kit to the mounting surface.
3. Place Collar or Sconce Plate 2 over Sconce Kit so it is flush with the wall.
4. Thread Pastille Globe onto the Sconce Kit to tightly secure all components.

Disc



Driver dimensions and location may vary, consult your order confirmation for details.

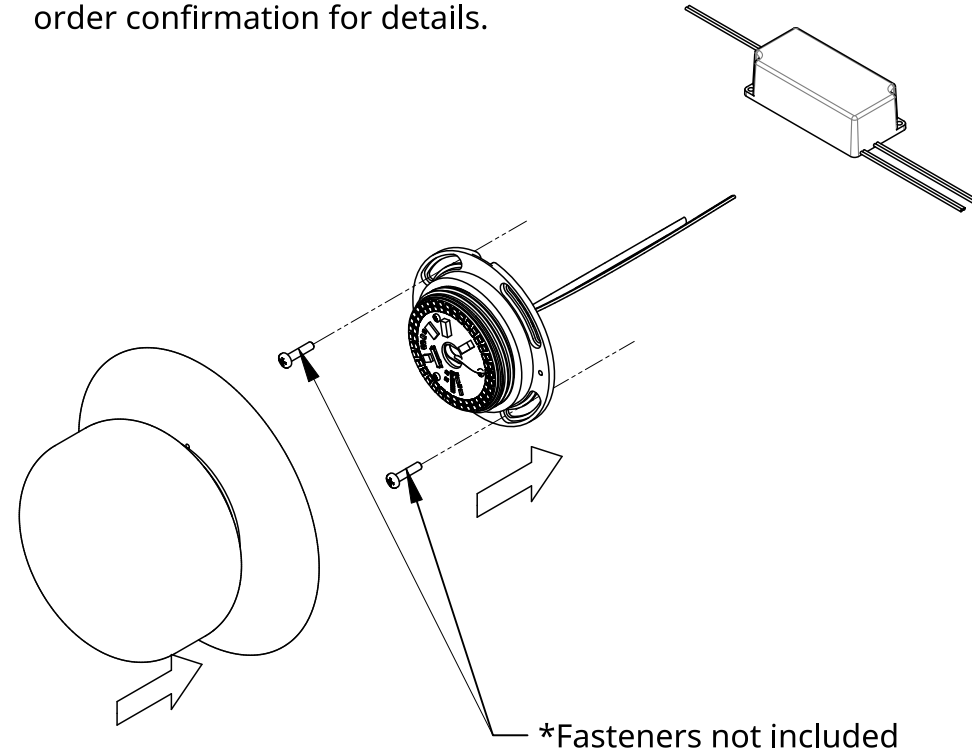

Installation - Pastille Disc

1. Refer to previous steps.

What's Included: Part Configurations May Vary

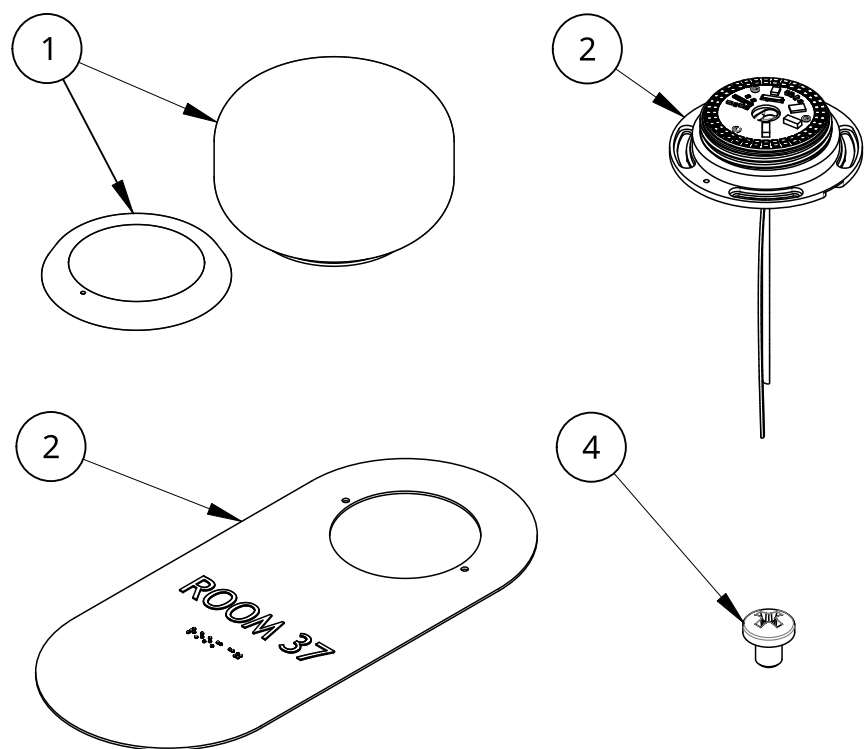

Item	Qty	Part number	Description
1	1	13737	Pastille Glass Droplet. IP20. w Mount Collar. PC20
2	1	14061-27	Package: Pastille Module. Standard DC LED. IP20
3	1	13826-PC20	Package: Pastille Wayfind. Matte White
4	2	91772A143	Pan head machine screw #6-32 x 0.1875 Stainless Steel



Driver dimensions and location may vary, consult your order confirmation for details.

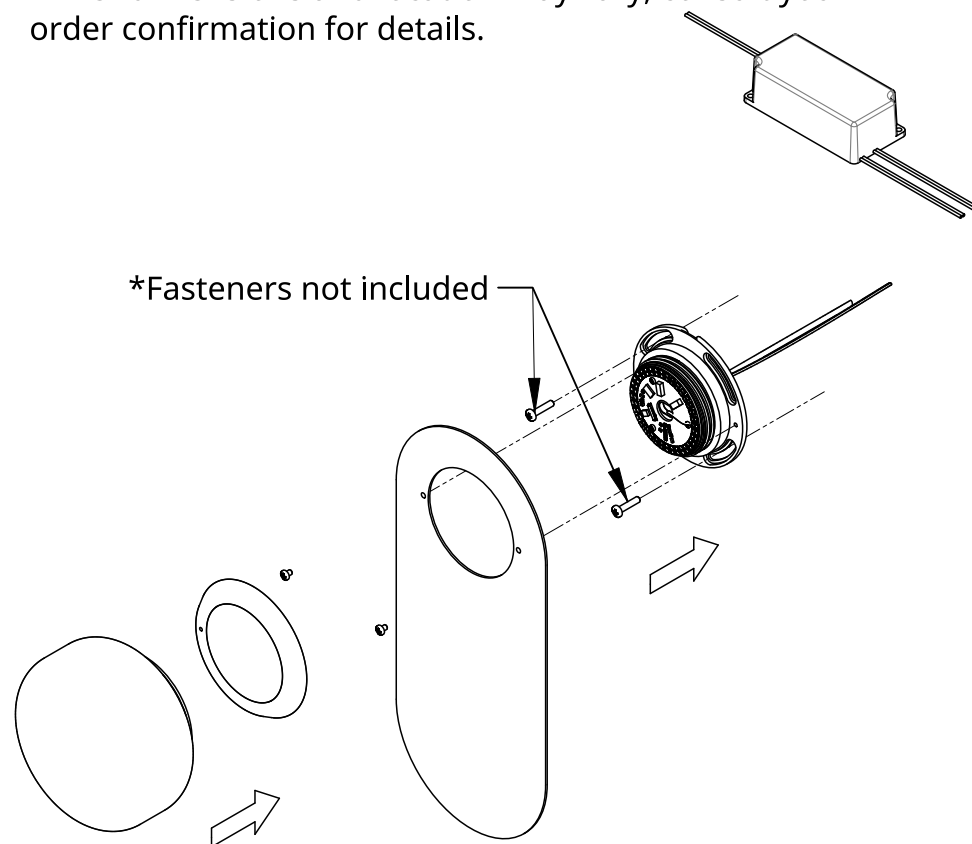

Installation - Pastille Wayfind

1. Connect Red (+) and Black (-) leads to low voltage leads from externally located driver.
2. Use appropriate fasteners to fasten the Sconce Kit to the mounting surface.
3. Fix Sconce Plate Sign to Sconce Kit using included 6-32 Machine Screws.
4. Place Mount Collar over Sconce Kit.
5. Thread Pastille Globe onto the Sconce Kit to tightly secure Mount Collar to Sconce Kit.
6. Congratulations! End of guide.



Pastille

12431 rA

Collar, Disc and
Wayfind
AC Input

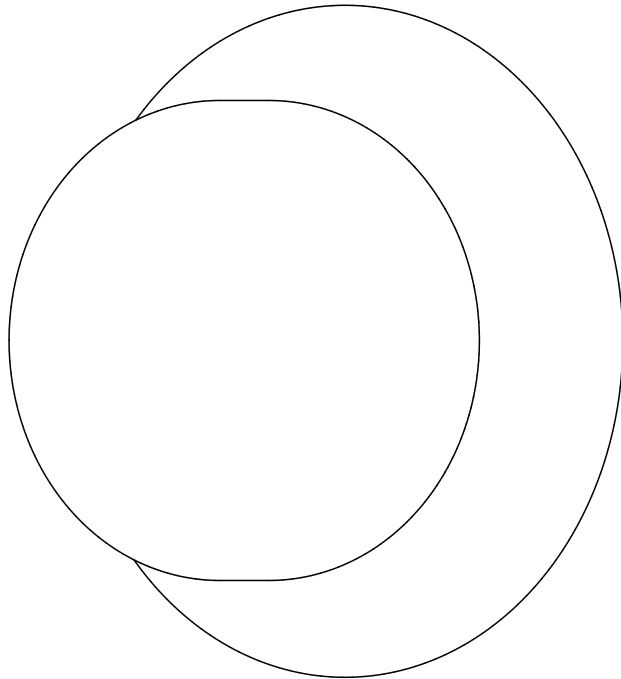

CAUTION:

Before starting, turn off power
at main circuit panel.

ADVERTENCIA:

Antes de comenzar la instalación,
apague la corriente en el tablero
principal.

ATTENTION:

Coupez l'alimentation avant de
procéder à l'installation.



Calling for backup? Scan above
to contact our team.

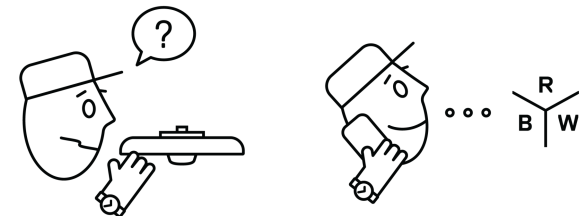

www.RBW.com

+1 212 388 1621

support@RBW.com

© RBW Studio LLC, 2013, 2020

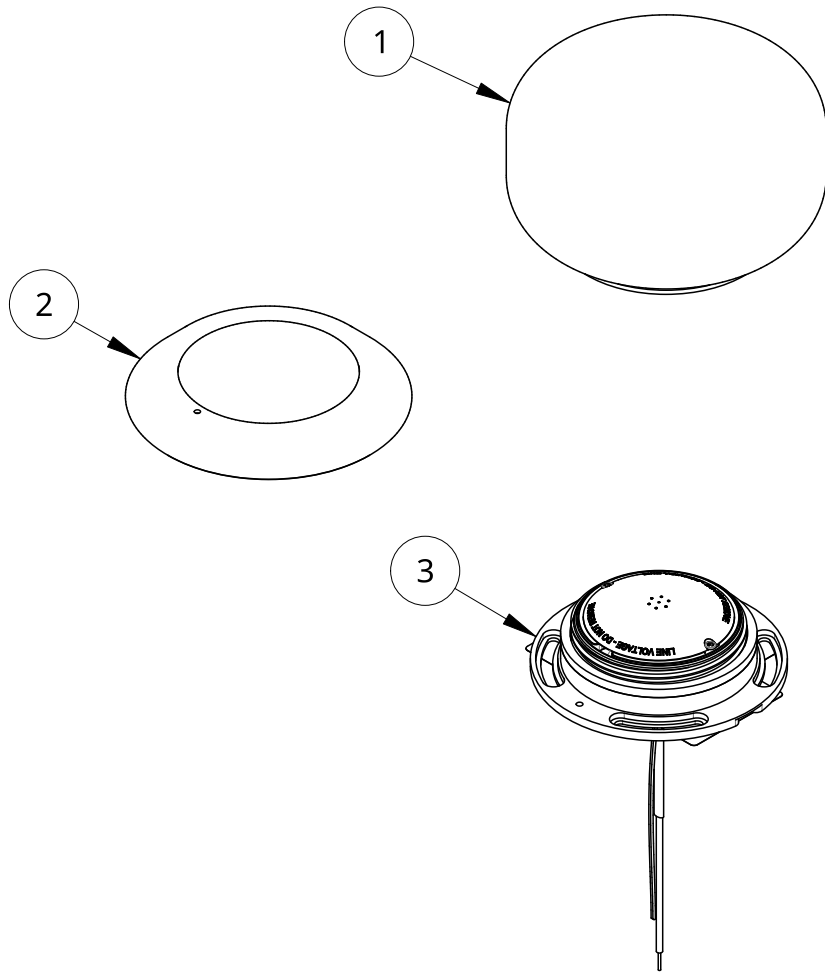

Item	Qty	Part number	Description
1	1	11955	Pastille Globe IP20 Sub-Assembly
2	1	11950-PC30	Pastille Sconce Collar PC30
3	1	10330-27	Pastille Sconce Kit 120V AB IP20 Sub-Assembly

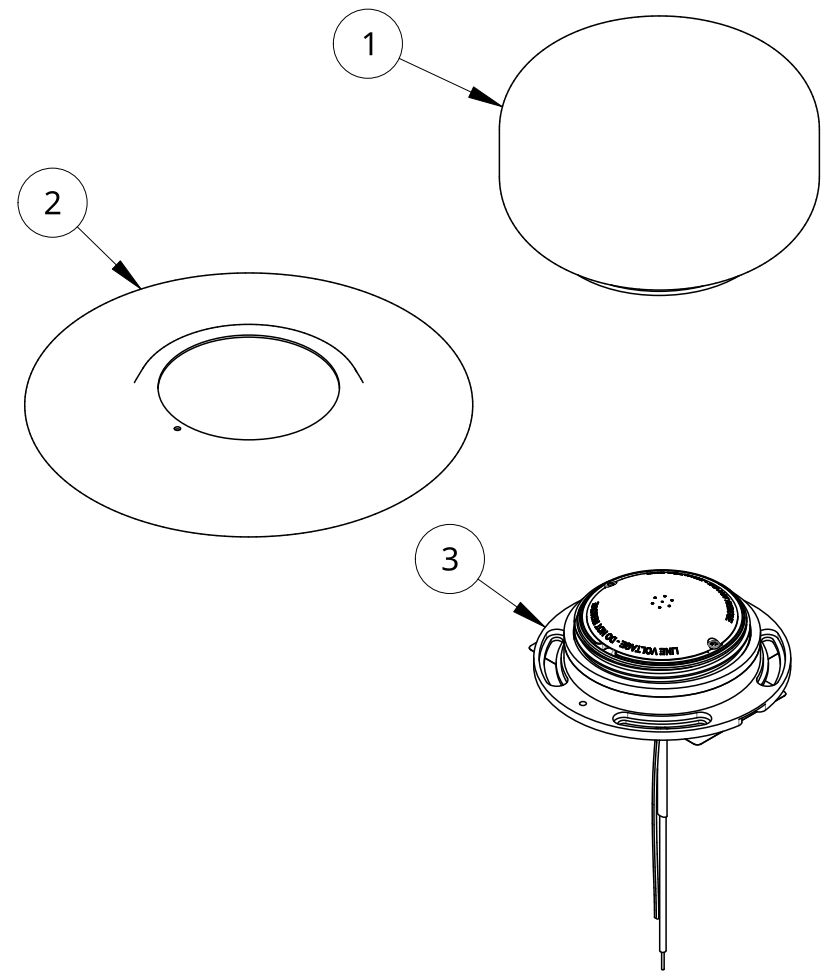

Item	Qty	Part number	Description
1	1	11955	Pastille Globe IP20 Sub-Assembly
2	1	11952-PC30	Pastille Sconce Plate 2 PC30
3	1	10330-27	Pastille Sconce Kit 120V AB IP20 Sub-Assembly

Collar

*Fasteners not included

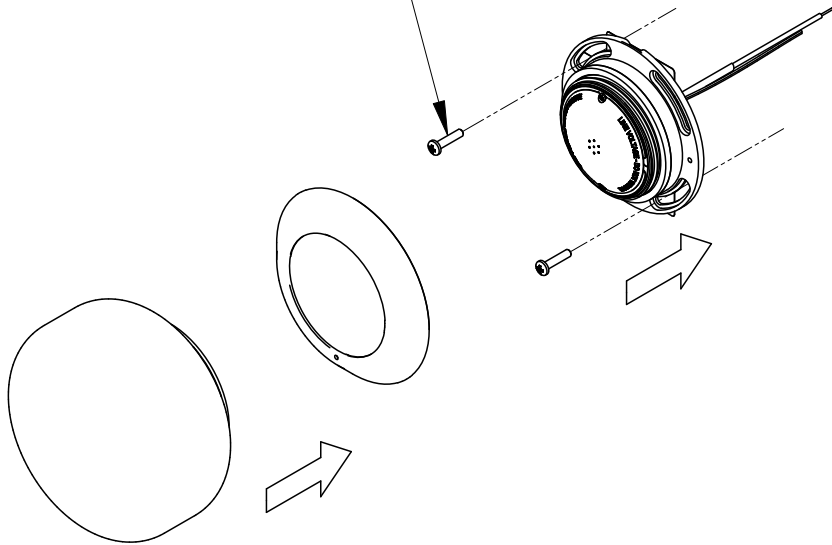

Installation - Pastille Collar

1. Connect sconce leads to power feed.
2. Use appropriate fasteners to fasten the Sconce Kit to the mounting surface.
3. Place Collar or Sconce Plate 2 over Sconce Kit so it is flush with the wall.
4. Thread Pastille Globe onto the Sconce Kit to tightly secure all components.

Disc

*Fasteners not included

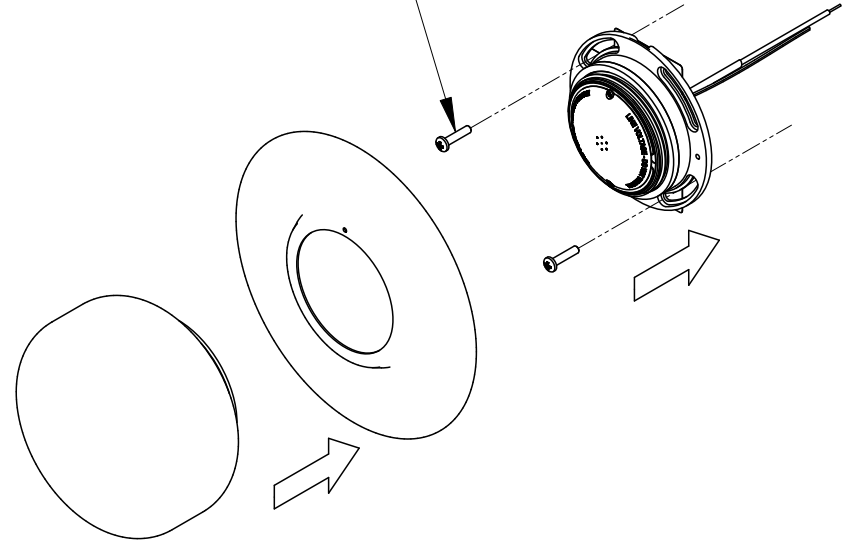

Installation - Pastille Collar

1. Refer to previous steps.

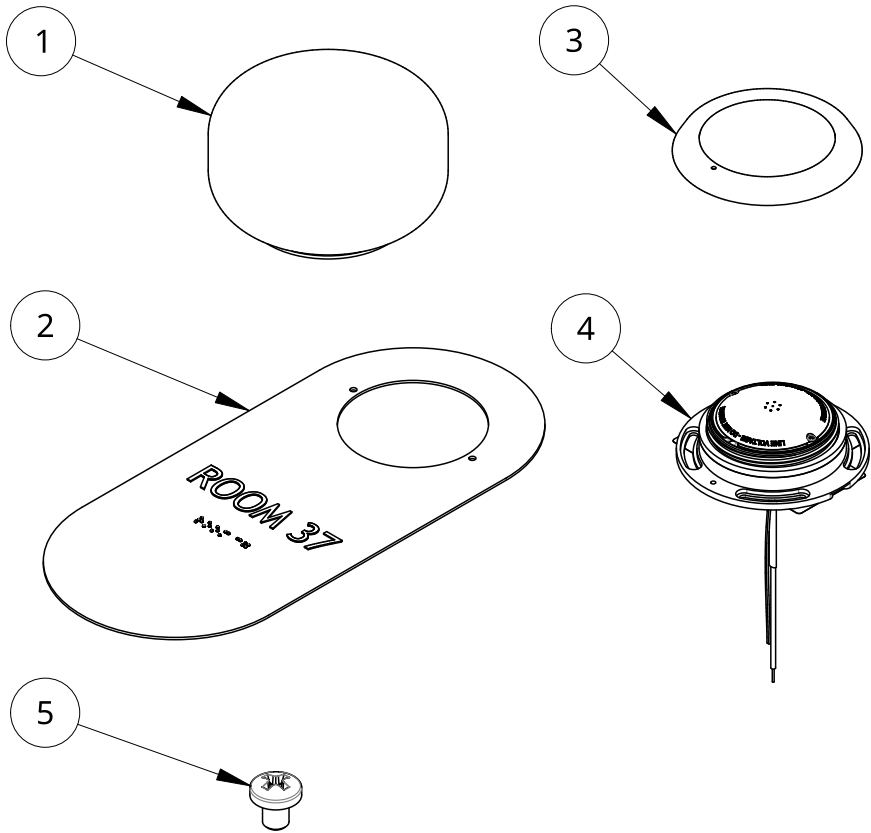

Item	Qty	Part number	Description
1	1	11955	Pastille Globe IP20 Sub-Assembly
2	1	11953-PC30	Pastille Sconce Plate Sign rF
3	1	11945-PC30	Mount Collar PC30
4	1	10330-27	Pastille Sconce Kit 120V AB IP20 Sub-Assembly
5	2	91772A143	Pan head machine screw #6-32 x 0.1875 Stainless Steel

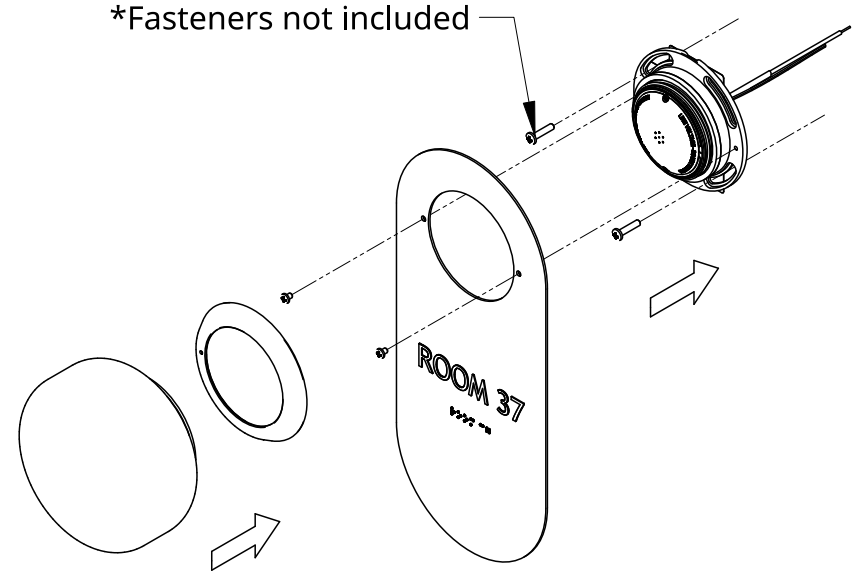

Installation - Pastille Wayfind

1. Connect electrical leads from the wall to the leads from Sconce Kit.
2. Use appropriate fasteners to fasten the Sconce Kit to the mounting surface.
3. Fix Sconce Plate Sign to Sconce Kit using included 6-32 Machine Screws.
4. Place Mount Collar over Sconce Kit.
5. Thread Pastille Globe onto the Sconce Kit to tightly secure Mount Collar to Sconce Kit.
6. Congratulations! End of guide.