



Pastille

12434 rB

Vanity and Cluster
Low Voltage Input

Note: External power supply may be required.

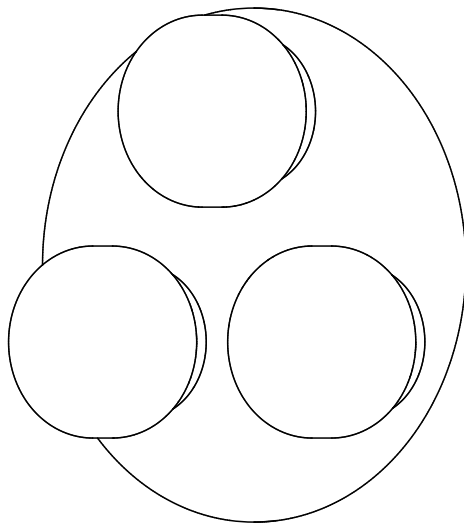

CAUTION:

Before starting, turn off power
at main circuit panel.

ADVERTENCIA:

Antes de comenzar la instalación,
apague la corriente en el tablero
principal.

ATTENTION:

Coupez l'alimentation avant de
procéder à l'installation.



Calling for backup? Scan above
to contact our team.

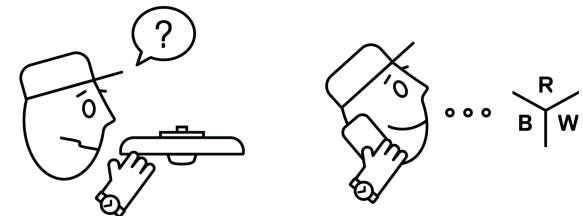

www.RBW.com

+1 212 388 0399

support@RBW.com

© RBW Studio LLC, 2013, 2020

What's Included: Part Configurations May Vary

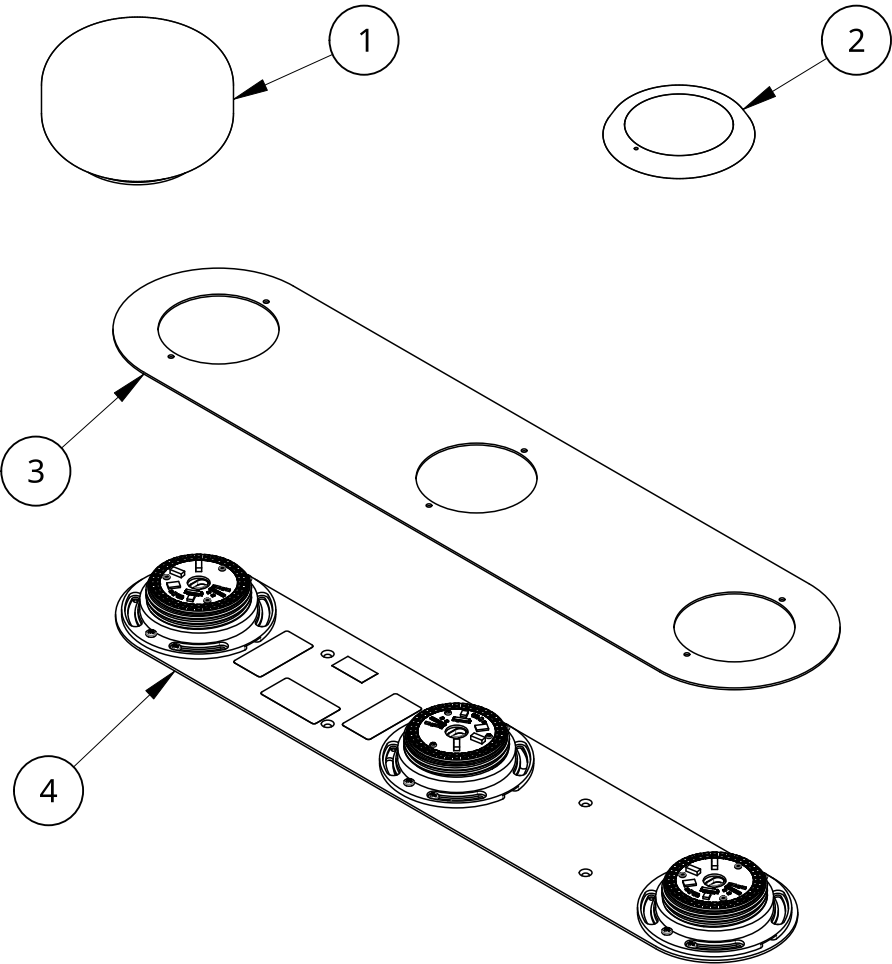

Item	Qty	Part number	Description
1	1	13737	Pastille Glass Droplet. IP20. w Mount Collar. PC20
2	3	13834-PC20	Package: Pastille Sconce Collar. Matte White
3	1	13830-PC20	Package: Pastille Vanity Plate. Matte White
4	1	13822-27	Package: Pastille Vanity. Standard DC LED. IP20

What's Included: Part Configurations May Vary

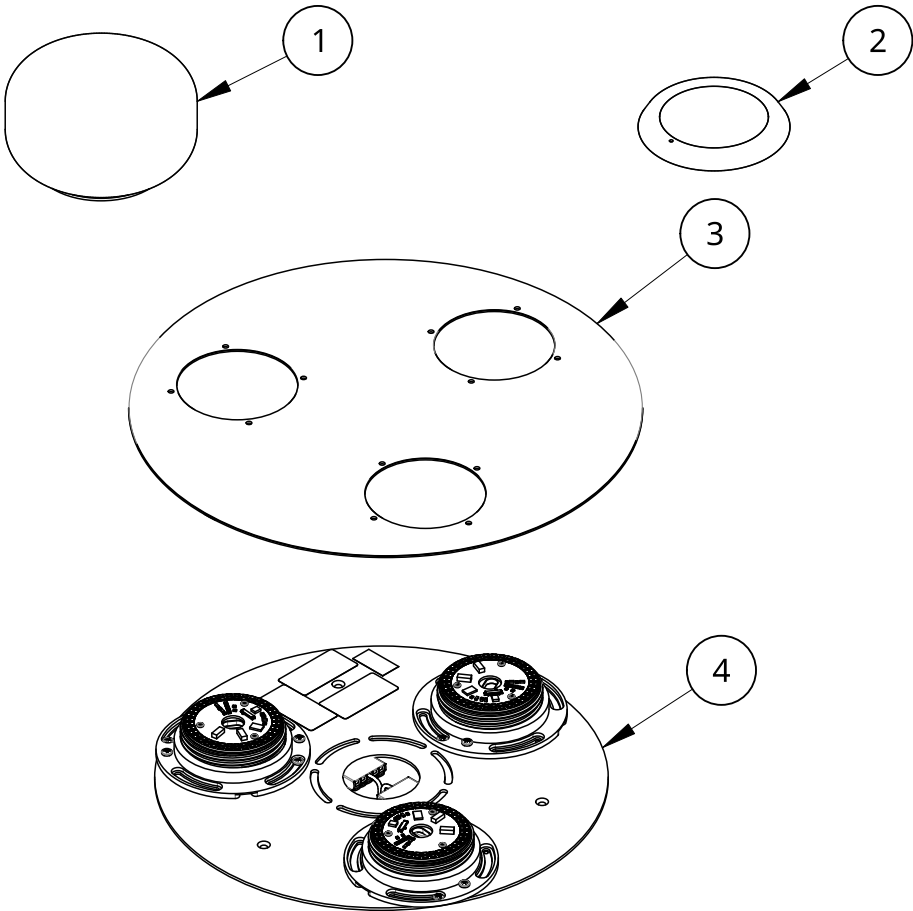

Item	Qty	Part number	Description
1	1	13737	Pastille Glass Droplet. IP20. w Mount Collar. PC20
2	3	13834-PC20	Package: Pastille Sconce Collar. Matte White
3	1	13828-PC20	Package: Pastille Cluster Plate. Matte White
4	1	13813-27	Package: Pastille Cluster. Standard DC LED. IP20



Driver dimensions and location may vary, consult your order confirmation for details.

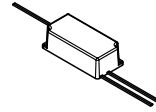

Sconce Plate Vanity

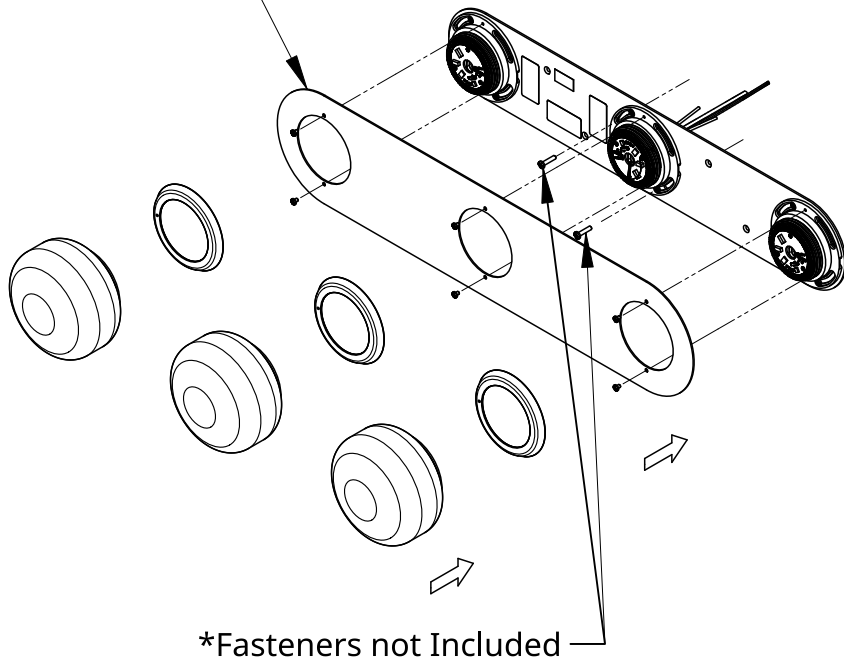

Installation - Pastille Vanity

1. Connect Red (+) and Black (-) leads to low voltage leads from externally located driver.
2. Use appropriate fasteners to fasten the Sconce Kit to the mounting surface.
3. Fix Sconce Plate to Sconce Kit assemblies using included 6-32 Machine Screws.
4. Place Mount Collar over Sconce Kits.
5. Thread Pastille Globes onto the Sconce Kits to tightly secure Mount Collars.



Driver dimensions and location may vary, consult your order confirmation for details.

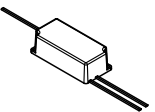

Sconce Plate Cluster

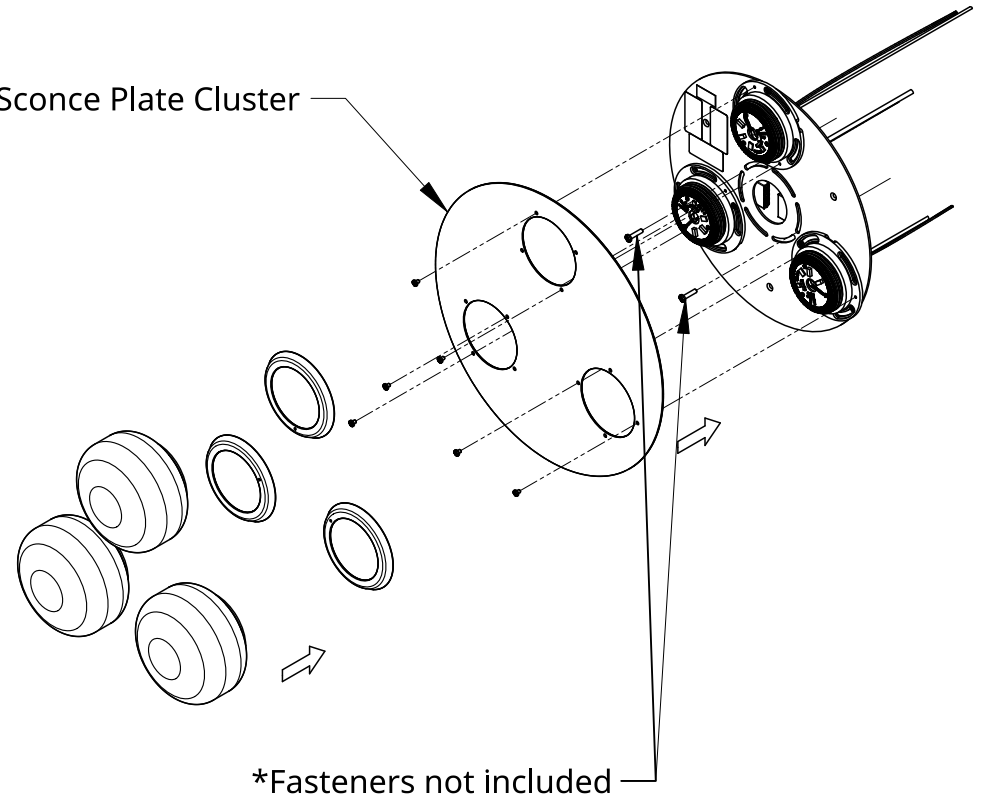

Installation - Pastille Cluster

1. Refer to Pastille Vanity steps.
2. Congratulations! End of guide.



Pastille

12432 rA

Vanity and Cluster
AC Input

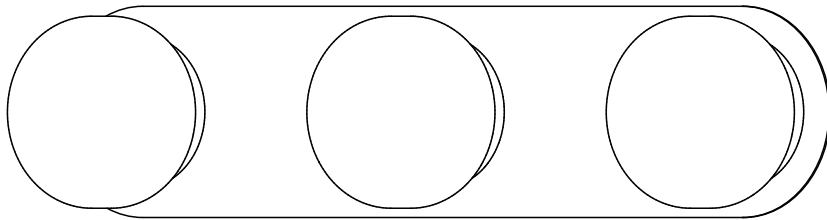

CAUTION:

Before starting, turn off power
at main circuit panel.

ADVERTENCIA:

Antes de comenzar la instalación,
apague la corriente en el tablero
principal.

ATTENTION:

Coupez l'alimentation avant de
procéder à l'installation.



Calling for backup? Scan above
to contact our team.

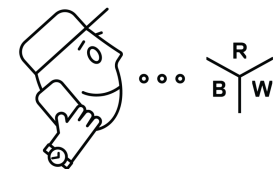
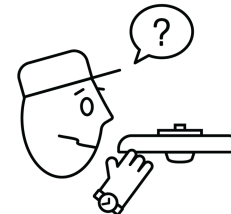

www.RBW.com

+1 212 388 1621

support@RBW.com

© RBW Studio LLC, 2013, 2020

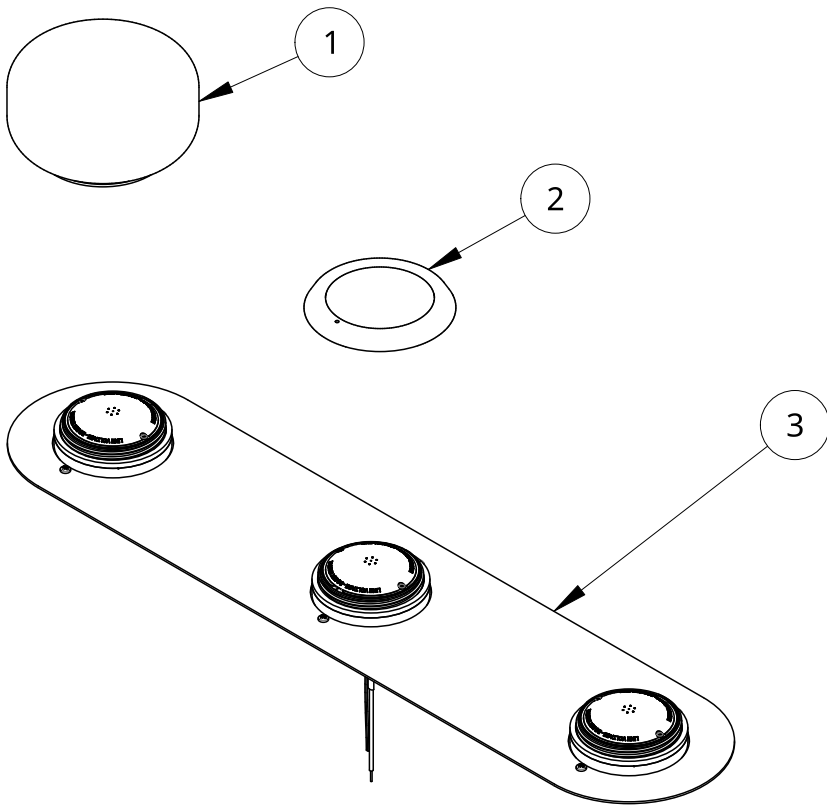

Item	Qty	Part number	Description
1	3	11955	Pastille Globe IP20 Sub-Assembly
2	3	11945-PC30	Mount Collar PC30
3	1	10379-PC30-27	Pastille Vanity 120V AB IP20 Sub-Assembly

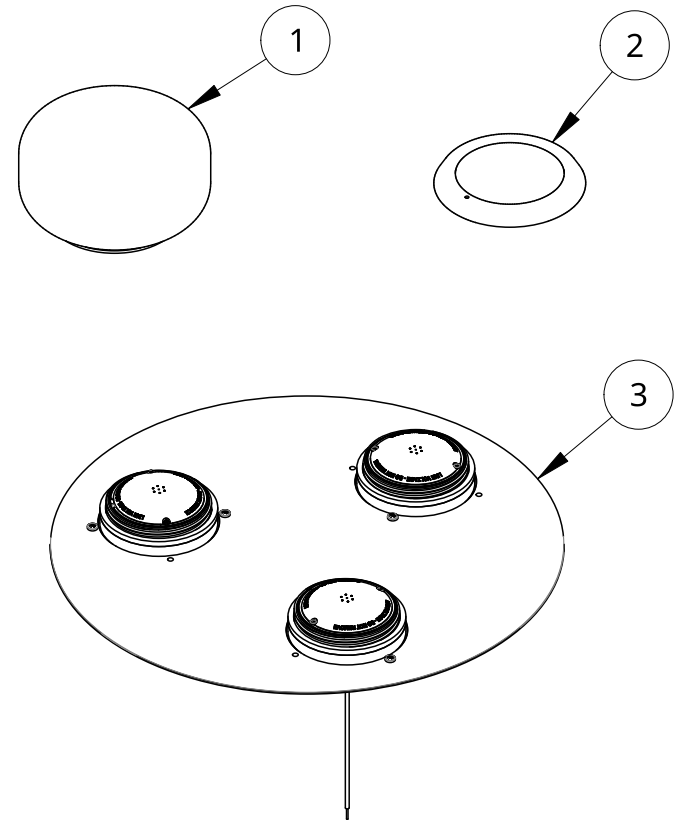

Item	Qty	Part number	Description
1	3	11955	Pastille Globe IP20 Sub-Assembly
2	3	11945-PC30	Mount Collar PC30
3	1	10387-PC30-27	Pastille Cluster 120V AB IP20 Plate Sub-Assembly

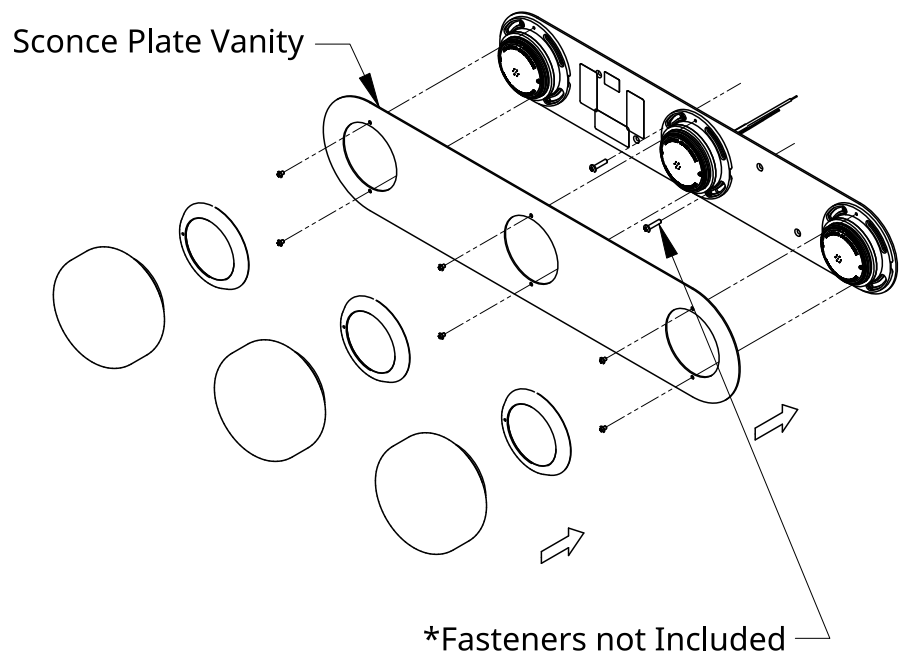

Installation - Pastille Vanity

1. Connect electrical leads from the wall to the leads from Sconce Kit.
2. Use appropriate fasteners to fasten the Sconce Kit to the mounting surface.
3. Fix Sconce Plate to Sconce Kit assemblies using included 6-32 Machine Screws.
4. Place Mount Collar over Sconce Kits.
5. Thread Pastille Globes onto the Sconce Kits to tightly secure Mount Collars.

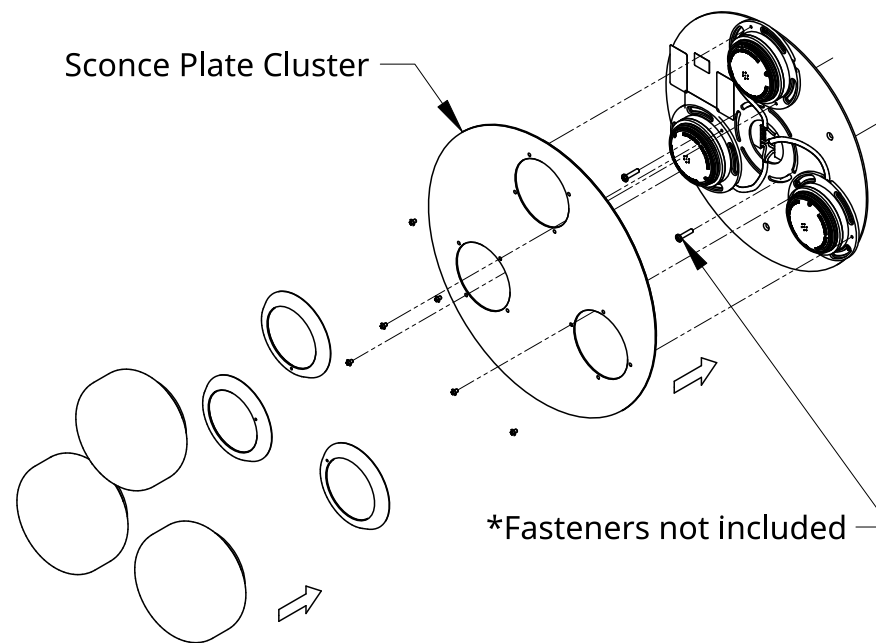

Installation - Pastille Cluster

1. Refer to previous steps.
2. Congratulations! End of guide.