



**WARNING – PLEASE READ ALL INSTRUCTIONS PRIOR TO INSTALLATION
READ AND FOLLOW ALL WARNINGS AND INSTRUCTIONS BEFORE INSTALLING OR MAINTAINING THIS PRODUCT.
TURN OFF POWER PRIOR TO ANY WORK ON THE SYSTEM OR PRODUCT.
DO NOT INSTALL DAMAGED PRODUCT.
AMBIENT TEMPERATURE AT LUMINAIRE LOCATION SHOULD NOT EXCEED 40°C DURING NORMAL OPERATION.**

Installing, wiring, and maintenance must be done by qualified persons or a certified electrician in accordance with all local and National Electrical Codes.

Warranty is voided in case of unauthorized modifications and/or improper use.

Save these instructions. Use as reference when service or maintenance is performed.

Refer to product label for voltage requirements and properly ground fixture in accordance with all local and national electrical codes.

If building and product supports optional dimming, connect dimming leads to dimming control system (provided by others). Refer to product label for dimming requirements. Isolate dimming wires individually if not in use.

Always turn off main power before installation.

***Note:**

- Must use 1 - 1/2" or 2 - 1/8" octagonal 4 in. junction box.
- Proper application of outdoor silicone caulk is necessary to obtain IP65 rating.

⚠ WARNING ⚠

- To avoid possible electrical shock, before installing light fixtures, disconnect power by turning off the circuit breakers both to the outlet box and to its associated wall switch location if you cannot lock the circuit breakers in the off position, securely fasten a prominent warning device, such as a tag to the service panel.
- Verify that supply voltage is correct by comparing it with the luminaire label information.
- Make all electrical and grounded connections in the accordance with the National Electrical Code (NEC) and any applicable local code requirements.

Allow sufficient time for fixture and / or driver to cool before servicing and performing maintenance.

⚠ ADVERTENCIA ⚠

- Para evitar un posible choque, antes de instalar luminarias, desconecte la alimentación apagando los interruptores de circuito y ubicación del interruptor de pared. Si no se pueden bloquear los interruptores en la posición de apagado, sujetar un dispositivo de advertencia en el panel de servicio.
- Compruebe que la tensión de alimentación es correcta comparándola con la información de etiqueta de la luminaria.
- Hacer todas las conexiones eléctricas y puesta a tierra de acuerdo con el código eléctrico nacional (NEC) y los requisitos del código local aplicable.
- Permitir suficiente tiempo para el luminario y el controlador para enfriar antes de enesar el servicios y mantenimiento.

⚠ AVERTISSEMENT ⚠

- Pour éviter les chocs, avant d'installer des appareils d'éclairage, coupez l'alimentation en désactivant les disjoncteurs et l'emplacement du commutateur mural. Si vous ne pouvez pas verrouiller les disjoncteurs en position d'arrêt, fixer un avertissement sur le panneau de service.
- Vérifiez que la tension d'alimentation est correcte en le comparant avec les informations d'étiquette de luminaire.
- Effectuer tous les raccordements électriques et mise à la terre dans la conformité avec le Code électrique National (NEC) et des exigences du code local applicable.
- Laisser suffisamment de temps pour l'appareil et pilote refroidir avant d'effectuer l'entretien et la maintenance.

⚠ CAUTION ⚠

- All wiring must be in accordance with national and local electrical codes and ANSI/NFPA 70. If you are unfamiliar with wiring you should use qualified electrician.
- PPE Personal Protective Equipment such as gloves and safety glasses should be used at all times when installing, maintaining or servicing.
- Risk of fire. Keep combustible material away from fixtures.

⚠ PRECAUCION ⚠



- Todo el cableado debe hacerse de conformidad con los códigos eléctricos nacionales y locales y ANSI/NFPA 70. Si no está familiarizado con el cableado, se debe utilizar a un electricista.
- Equipo de protección personal como guantes y lentes de seguridad se debe utilizar al instalar, mantener o reparar.
- Riesgo de incendio. Mantenga los materiales combustibles lejos de los luminarios.

⚠ MIS EN GARDE ⚠

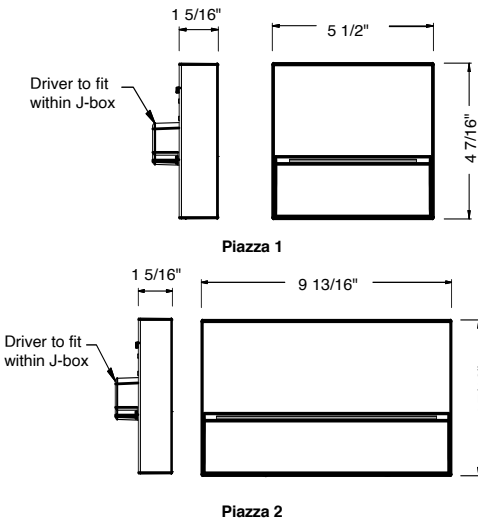
- Tout le câblage doit être effectué conformément aux codes électriques locaux et nationaux et ANSI/NFPA 70. Si vous êtes peu familier avec câblage, vous devez utiliser un électricien qualifié.
- Équipement de protection personnelle comme des gants et des lunettes de sécurité doivent être utilisé en tout temps lors de l'installation, maintenance ou entretien.
- Risque d'incendie. Garder les matières combustibles loin de luminaires.

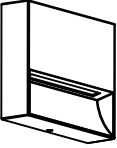

	Art.No	Power
	EXT-PZ1	LED 5W

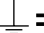

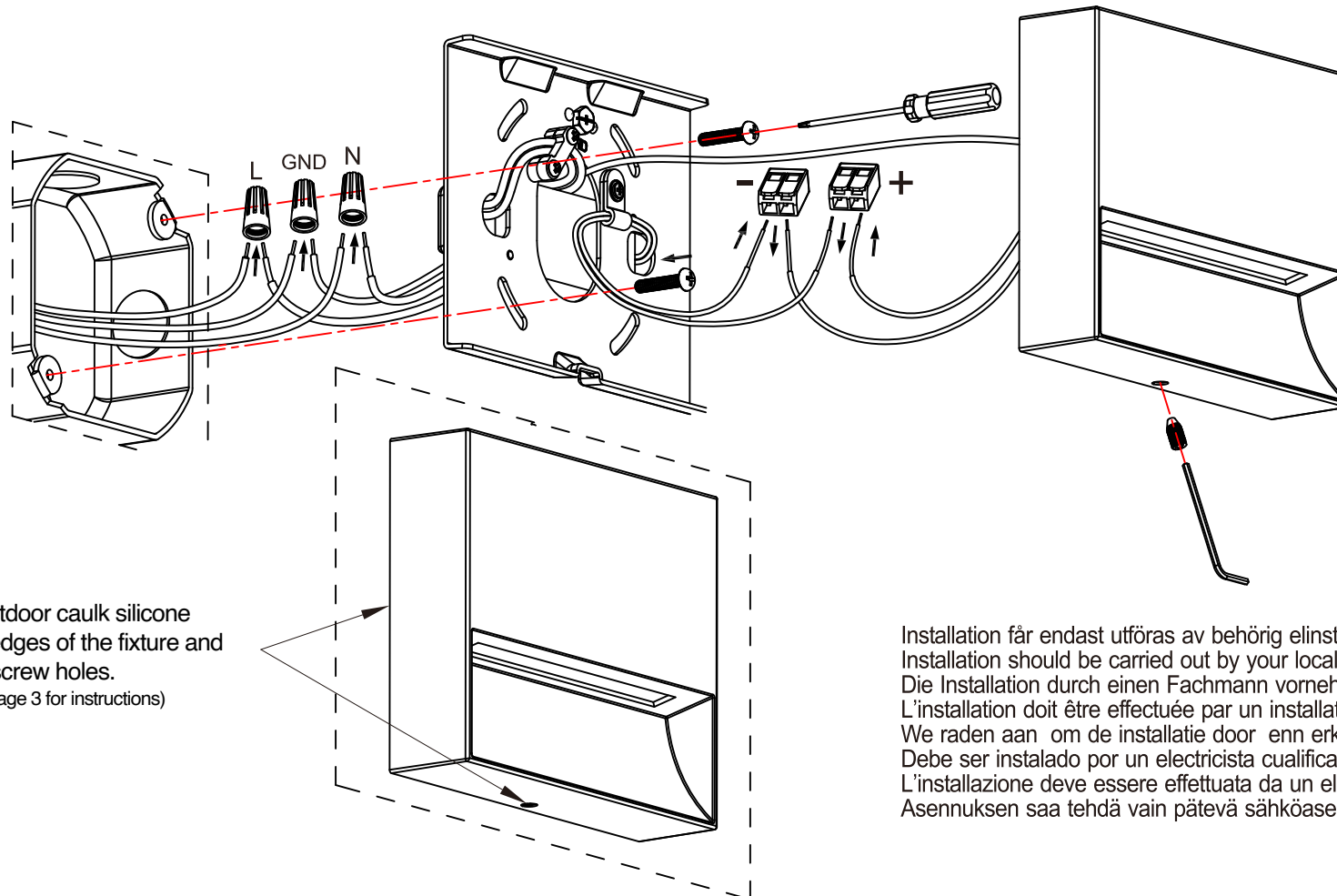
	L =	Brun • Brown Braun • Brun Bruin • Marró Marronen • Ruskea
	N =	Blå • Blue Blau • Bleu Blauw • Azul Blu • Sininen
		Grön/Gul • Green/Yellow Grün/Gelb • Vert/Jaune Groen/Geel • Verde/Amarillo Verde/Giallo • Vihreä/Keltainen

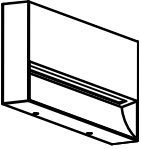

Apply outdoor caulk silicone around edges of the fixture and the two screw holes.
(Refer to Page 3 for instructions)

Installation får endast utföras av behörig elinstallatör.
Installation should be carried out by your local electrician.
Die Installation durch einen Fachmann vornehmen lassen.
L'installation doit être effectuée par un installateur qualifié.
We raden aan om de installatie door enn erkend vakman te laten doen.
Debe ser instalado por un electricista cualificado.
L'installazione deve essere effettuata da un elettricista qualificato.
Asennuksen saa tehdä vain pätevä sähköasentaja.

	Art.No	Power
	EXT-PZ2	LED 9W

	L =	Brun • Brown Braun • Brun Bruin • Marró Marronen • Ruskea
	N =	Blå • Blue Blau • Bleu Blauw • Azul Blu • Sininen
	=	Grön/Gul • Green/Yellow Grün/Gelb • Vert/Jaune Groen/Geel • Verde/Amarillo Verde/Giallo • Vihreä/Keltainen

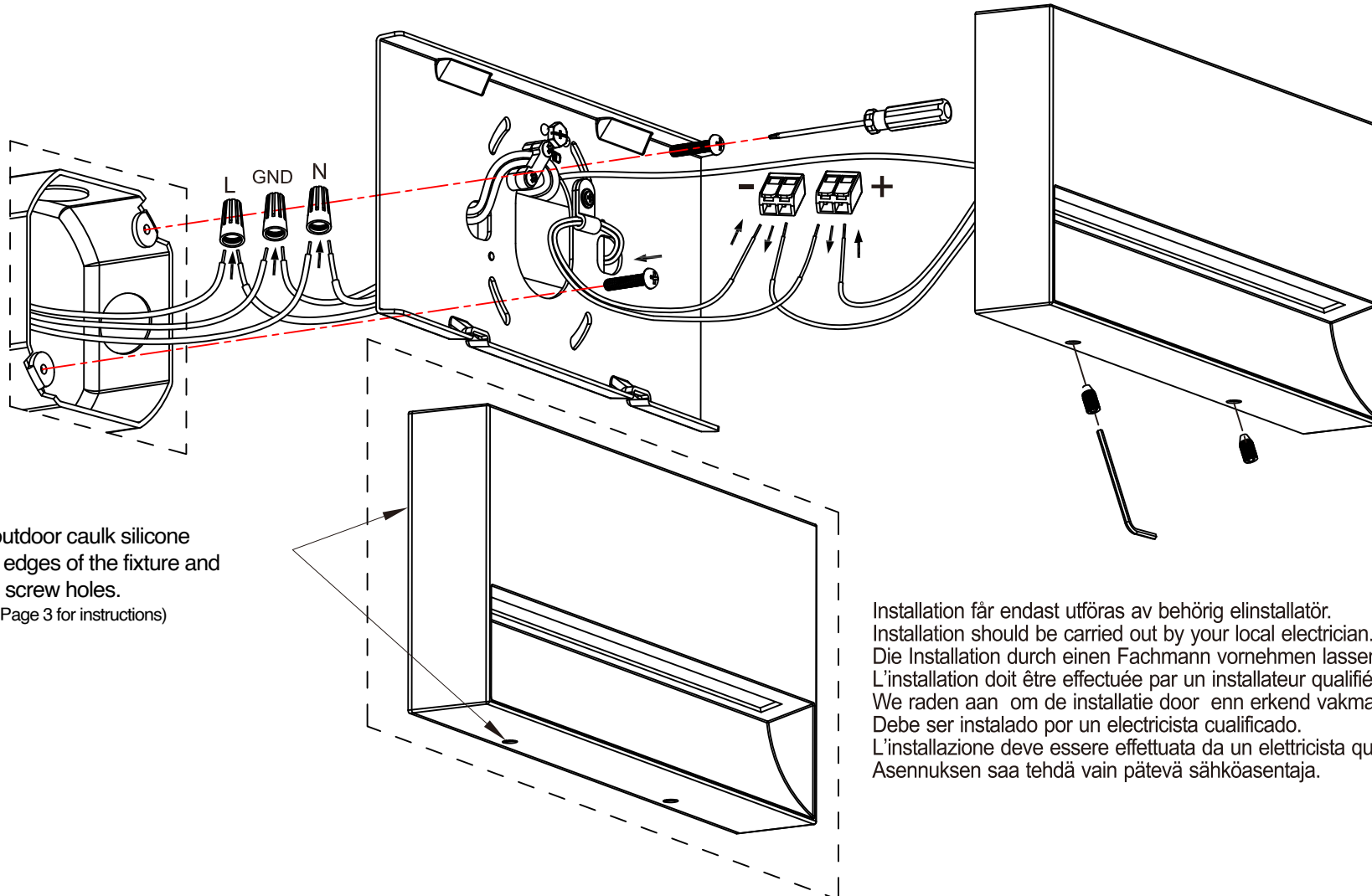

Apply outdoor caulk silicone around edges of the fixture and the two screw holes.
(Refer to Page 3 for instructions)

Installation får endast utföras av behörig elinstallatör.
Installation should be carried out by your local electrician.
Die Installation durch einen Fachmann vornehmen lassen.
L'installation doit être effectuée par un installateur qualifié.
We raden aan om de installatie door enn erkend vakman te laten doen.
Debe ser instalado por un electricista cualificado.
L'installazione deve essere effettuata da un elettricista qualificato.
Asennuksen saa tehdä vain pätevä sähköasentaja.

***Note:**

- Must use 1 - 1/2 " or 2 - 1/8 " octagonal 4inch junction box.
- Proper application of outdoor silicone caulk is necessary to obtain IP65 rating

Step 1 - Installing Mounting Bracket & Wiring Driver to junction Box:

Locate the driver on the mounting bracket. Use (2) wire nuts to connect both neutral and live wires from the junction box and driver. Feed LED positive (+), LED negative (-) and ground (Green) wires through the mounting bracket. Use (2) Phillips screws to secure the mounting bracket to the junction plate (Fig.1).

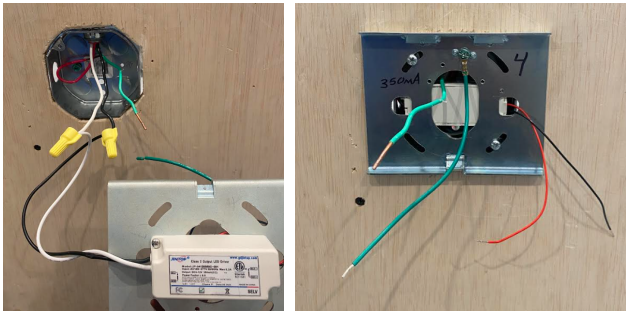

Fig.1: Wiring for junction box & driver. Secured mounting bracket.

Step 2 - Wire Driver to Fixture

Use (2) quick connects to wire the LED positive (+) and LED negative (-) from driver to fixture. Use a wire nut to connect all three ground (Green) wires from the fixture, mounting plate and junction box (Fig.2).

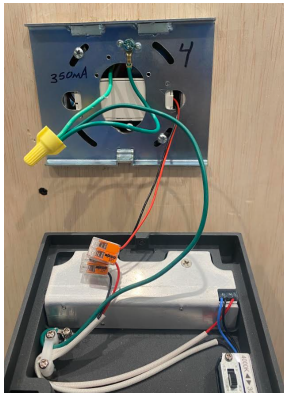

Fig.2: Wiring for Driver & Piazza fixture.

Step 3 - Apply Outdoor Caulk Silicone to edges

Apply silicone along the outside perimeter of the mounting brackets (Apply an approx. 3/8" thick bead of silicone) (Fig.3).

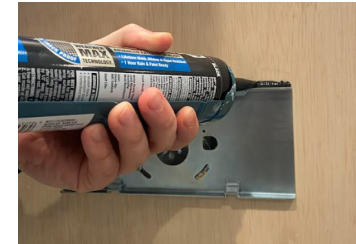

Fig.3: Apply Silicone around mounting bracket.

Step 4 - Mounting Fixture to Mounting Bracket

Install fixture onto the mounting bracket by hooking the top of the fixture, then pivot the bottom to mounting surface. Apply pressure to ensure fixture is flush with mounting bracket and mounting surface. Secure the hex screw(s) located on the bottom of the fixture (Fig.4).



Fig.4: Secure Piazza to mounting surface and secure hex screws.

Note: If needed, apply an additional bead of another layer of outdoor caulk silicone along exterior perimeter of the fixture to seal any opening (Fig.5).



Fig.5: Apply silicone around exterior perimeter.

Step 5 - Sealing edges

Use a close-corner tool or any desired method to create a clean finish around the perimeter and remove excess silicone.



Fig.6: Create a clean finish and remove excess silicone.