

LUCA 2.7" STATIC WHITE

120V-277V, RECESSED WALL WASH DOWNLIGHTS

ASSEMBLED IN AMERICA | USA PATENT

REV 05.11.26

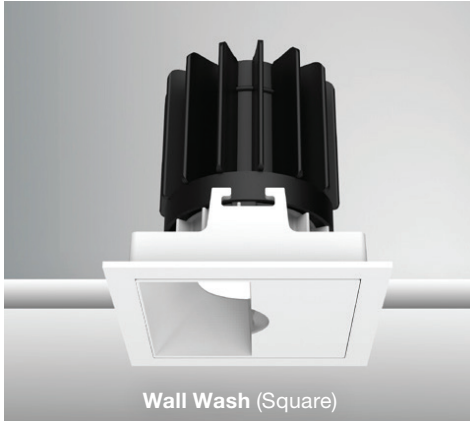

DESCRIPTION

Introducing the Luca 2.7 "The Bringer of Light" Wall Wash Downlight Series, a testament to the latest advancements in cutting-edge lighting technology, delivering high performance solutions designed to elevate hospitality, retail, commercial, and discerning residential spaces. Featuring precision optics, the Luca downlights deliver a beam that reaches the very top of the wall, creating an elegant wash of light. With a Color Rendering Index (CRI) surpassing 90, these lights ensure exceptional color accuracy, making them an ideal choice for spaces where ambiance and visual clarity are paramount.

The Luca Wall Wash Downlight series delivers captivating illumination across a wide spectrum, creating a visually engaging experience within any space. With its extensive range of design and installation options, our Luca 2.7 Wall Wash Downlight is versatile for a wide array of new construction and remodel applications. Moreover, the compact form factor of the Luca 2.7 allows for installation in spaces with limited clearance.

Discover a new era of lighting performance and versatility with the Luca 2.7 Downlight Series, where superior optics, lumen performance, and outstanding color consistency converge to transform a space. For personalized quotes and expert layout assistance, share your drawings and concepts with our design team at design@PureEdgeLighting.com

SPECIFICATIONS

TRIM OPTIONS	With Trim, Trimless, Round, Square			DIMMING	Universal Dimming TRIAC/ELV: 100% – 3% 0-10V: 100% – 0.1% Dim to Off DALI2: 100% – 0.1% Dim to Off Pure Smart™ 100% – 5% Pure Smart™ Wi-Fi Dimmer TRIAC/ELV 2.4GHz Wi-Fi. No Hub needed. Voice control with Goggle Assistant, Alexa, Siri, Shortcuts, and IFTTT
FINISH	Reflector: White, Black, Haze Silver (low-glare), Trims: White, Black, Custom				
BEAM ANGLE	Asymmetrical			EMERGENCY POWER	100W EM Power 120-277VAC
WATTAGE	16W	20W	24W	CUT OUT SIZE	Round: Ø3", Square: 3"
LUMENS @ 3000K, 30°	820Lm	983Lm	1100Lm	CEILING THICKNESS	0.5" - 1"
EFFICACY	51Lm/W	55Lm/W	46Lm/W	ENVIRONMENT	Suitable for damp locations, Chicago Plenum
CCT	2400K, 2700K, 3000K, 3500K & 4000K			CERTIFICATIONS	ETL Listed. Meets Title 24 (JA8) requirements.
AVERAGE CRI	90+			AVERAGE LIFE	50,000 Hours
INPUT VOLTAGE	120V ELV/TRIAC, 120V-277V & 0-10V & DALI/DMX			WARRANTY*	5 Years *See published warranty terms for detailed information
CONSTRUCTION	Housing: Galvanized Steel Heat Sink, Trims and Reflectors: Die-Cast Aluminum				

WATTS	LUCA 2.7 STATIC WHITE											
	16W				20W				24W			
COLOR TEMPERATURE	27K	30K	35K	40K	27K	30K	35K	40K	27K	30K	35K	40K
LUMENS	787	820	837	853	943	983	1002	1022	1056	1100	1122	1144
LUMENS PER WATT (lm/w)	49	51	52	53	52	55	56	57	44	46	47	48
CRI	93	93	93	93	92	92	92	92	92	92	92	92

LUCA 2.7" STATIC WHITE

120V-277V, RECESSED WALL WASH DOWNLIGHTS

LUCA 2.7 Light Engine

LIGHT ENGINE

System	Beam Spread	Color Temperature	Shape	Function	Reflector Finish	Trim Type/Finish
L27	WW	30K	R	W	W	W
L27 Luca 2.7 Light Engine	WW Wall Wash Asymmetrical Beam Spread	27K 2700K Incandescent White 30K 3000K Warm White 35K 3500K Neutral White 40K 4000K Cool White	R Round S Square	W Wall Wash	W White B Black C Custom H Haze (Satin Silver)	W White B Black L Trimless M Wood Millwork C Custom



#2 Select Housing & Driver Type

REMODEL NON-IC with 120V DRIVER

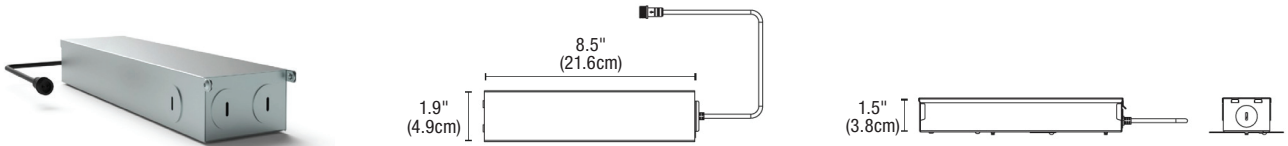

Product	Housing Type	Rating Type	Wattage/Lumens	Dimming
L27	RM	NIC	20W	UN
L27 Luca 2.7 Downlight	RM Remodel	NIC Non-Insulation Contact	16W 16 Watts/1123 Lumens 20W 20 Watts/1346 Lumens 24W 24 Watts/1507 Lumens	UN TRIAC/MLV, ELV 120V Input 01 0-10V 120V/277V Input DA DALI 2 120V/277V Input

NEW CONSTRUCTION FRAME NON-IC with 120V DRIVER

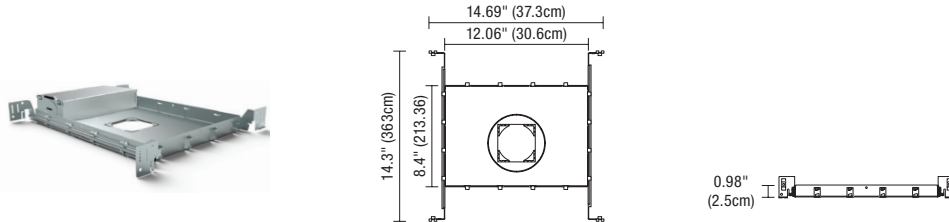

Product	Housing Type	Rating Type	Wattage/Lumens	Dimming
L27	NCF	NIC	20W	UN
L27 Luca 2.7 Downlight	NCF New Construction Frame	NIC Non-Insulation Contact	16W 16 Watts/1123 Lumens 20W 20 Watts/1346 Lumens 24W 24 Watts/1507 Lumens	UN TRIAC/MLV, ELV 120V Input 01 0-10V 120V/277V Input DA DALI 2 120V/277V Input

NEW CONSTRUCTION HOUSING IC WITH 120V DRIVER

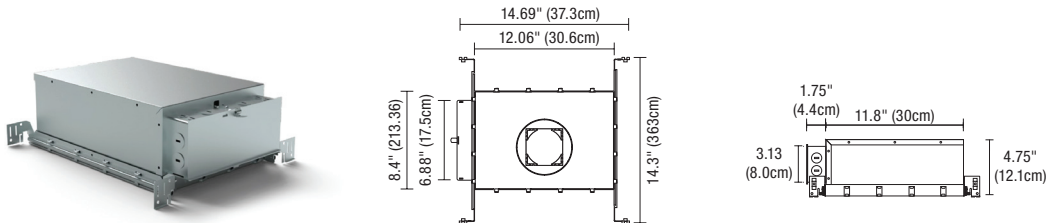

Product	Housing Type	Rating Type	Wattage/Lumens	Dimming
L27	NCH	IC	16W	UN
L27 Luca 2.7 Downlight	NCH New Construction Housing	IC Insulation Contact CP Chicago Plenum	16W 16 Watts/1123 Lumens	UN TRIAC/MLV, ELV 120V Input 01 0-10V 120V/277V Input DA DALI 2 120V/277V Input

LUCA 2.7" STATIC WHITE
120V-277V, RECESSED WALL WASH DOWNLIGHTS

LUCA 2.7 TRIMLESS HOUSING (INCLUDED WITH TRIM OPTION L)

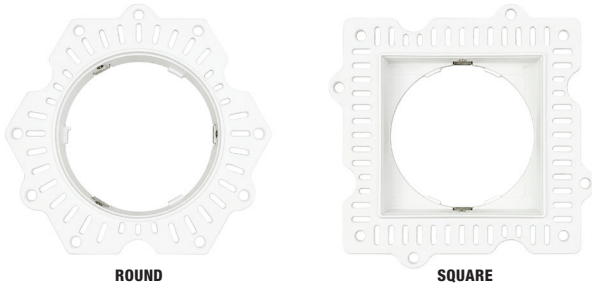

ROUND

SQUARE

Product	Housing Type	Trim Type	Finish
L27	RD	TL	WH
L27 Luca 2.7 Downlight	RD Round Square	TL Trimless	WH White

LUCA 2.7 MILLWORK TRIMLESS ADAPTER (INCLUDED WITH TRIM OPTION M)

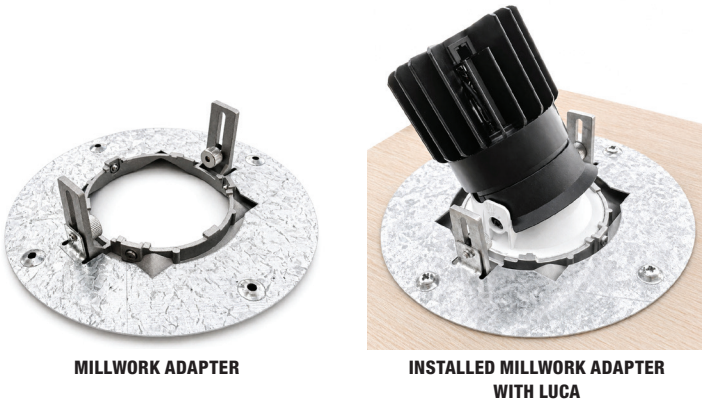

MILLWORK ADAPTER

INSTALLED MILLWORK ADAPTER WITH LUCA

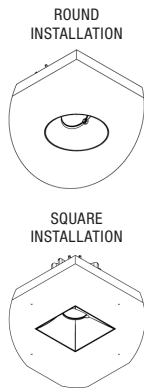

ROUND INSTALLATION

SQUARE INSTALLATION

Product	Housing Type	Trim Type	Type
L27	RDSQ	TL	M
L27 Luca 2.7 Downlight	RDSQ Round/Square	TL Trimless	M Wood Millwork

BEAM ANGLE/MILLWORK THICKNESS

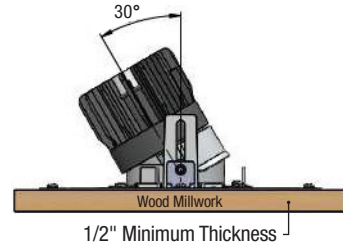

TRIMLESS ADAPTER INSTALLATION

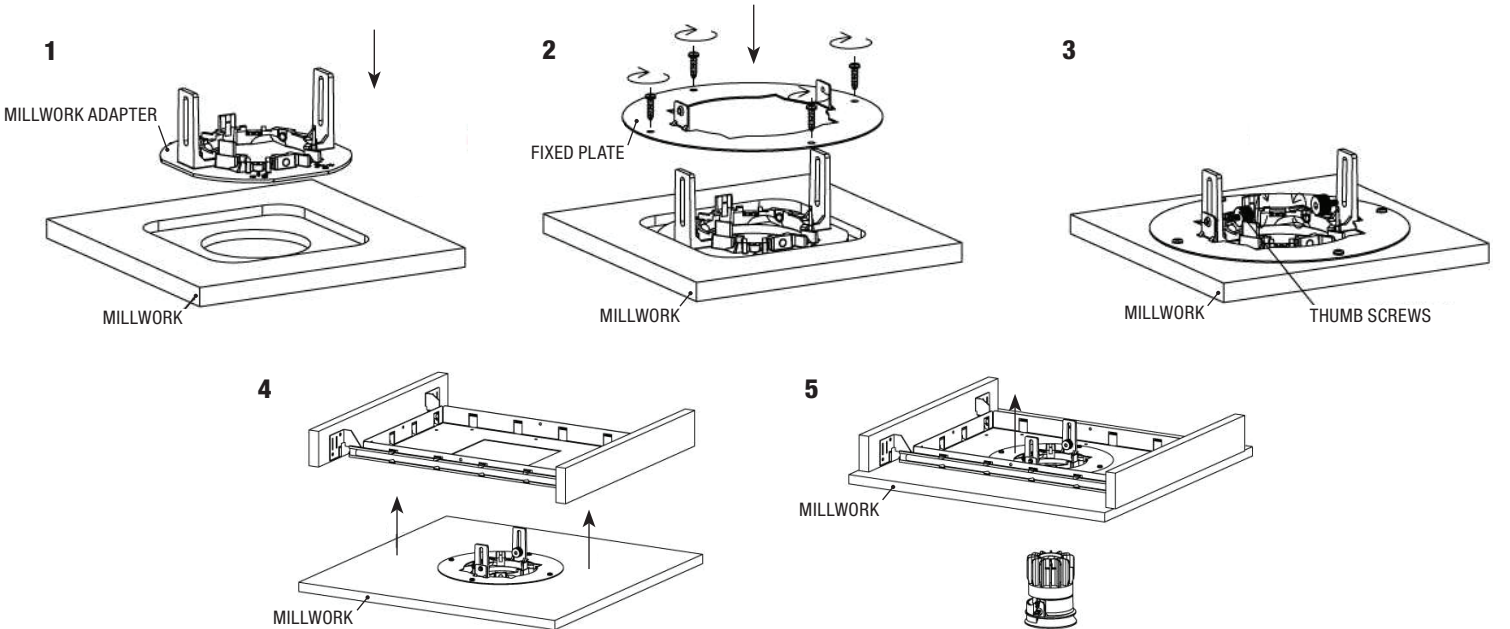

LUCA 2.7 WALL WASH TRIM OPTIONS

Wall Wash - Round



Round Trim

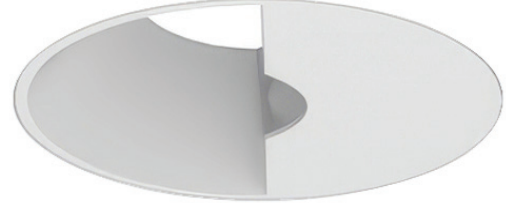
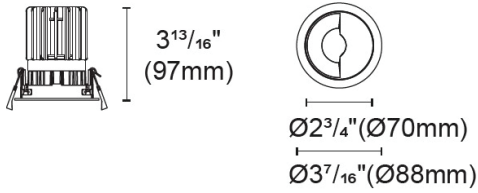

Round Trimless

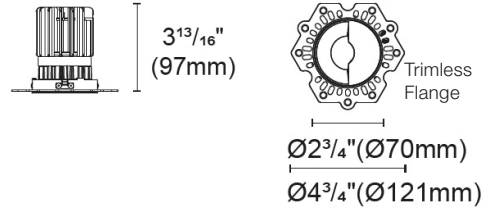

Wall Wash - Square



Square Trim

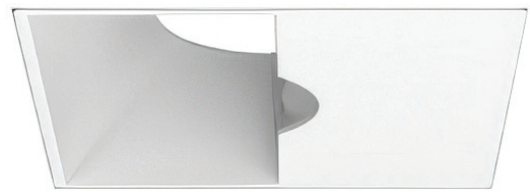
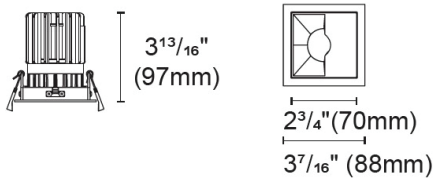

Square Trimless

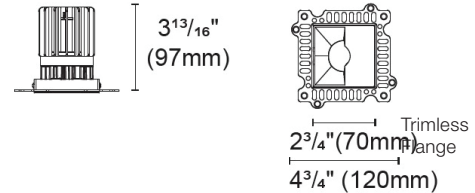

LUCA 2.7, 19W WALL WASH FOOT CANDLE DISTRIBUTION
 (2 FEET FROM WALL, 2 FEET APART)

	1FT	2.5FT	3FT CENTER OF DOWNLIGHT	4FT	5FT CENTER OF DOWNLIGHT	5.5FT	7FT
0FT	2	3	4	3	4	3	2
0.5FT	5	13	16	13	16	13	5
1FT	7	18	22	20	22	18	6
1.5FT	10	22	28	26	28	22	10
2FT	12	26	30	30	30	26	12
3FT	15	26	30	32	30	26	15
4FT	15	24	28	30	29	24	15
5FT	14	21	24	26	25	21	14
6FT	12	17	20	22	20	17	12
7FT	11	14	16	17	16	14	11
8FT	9	12	14	14	14	12	9
9FT	7	10	11	11	11	10	7

LUCA 2.7 TRIM & REFLECTOR OPTIONS

ROUND

Black Trim

White Trim

Trimless



Black Reflector with Black Cover



White Reflector with White Cover

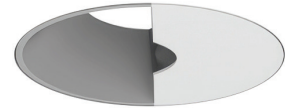
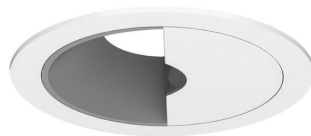

Haze Reflector with White Cover

SQUARE

Black Trim

White Trim

Trimless



Black Reflector with Black Cover



White Reflector with White Cover



Haze Reflector with White Cover

LUCA 2.7" STATIC WHITE
120V-277V, RECESSED WALL WASH DOWNLIGHTS

LUCA 2.7, 26W WALL WASH FOOT CANDLE DISTRIBUTION
(2 FEET FROM WALL, 2 FEET APART)

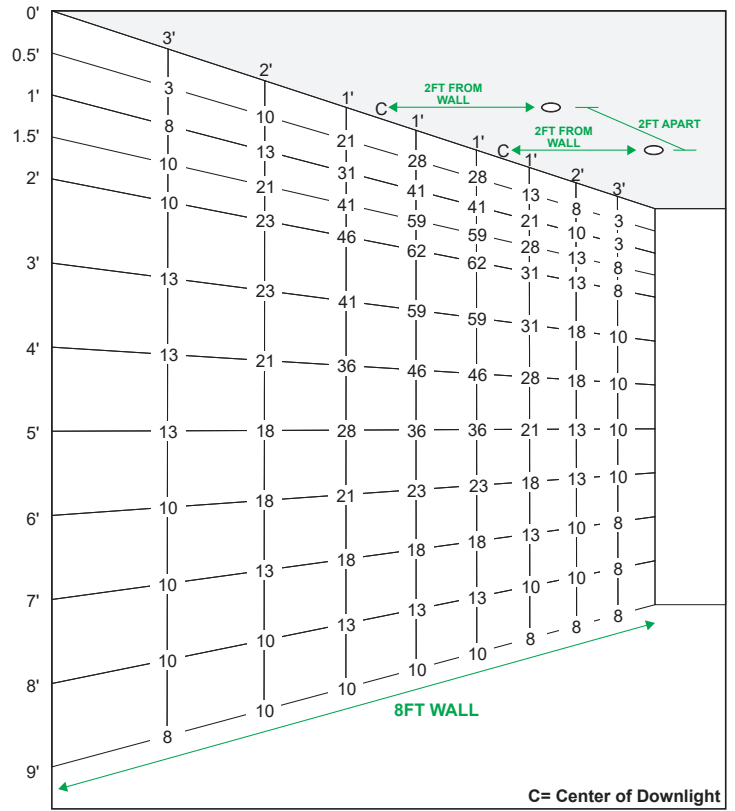
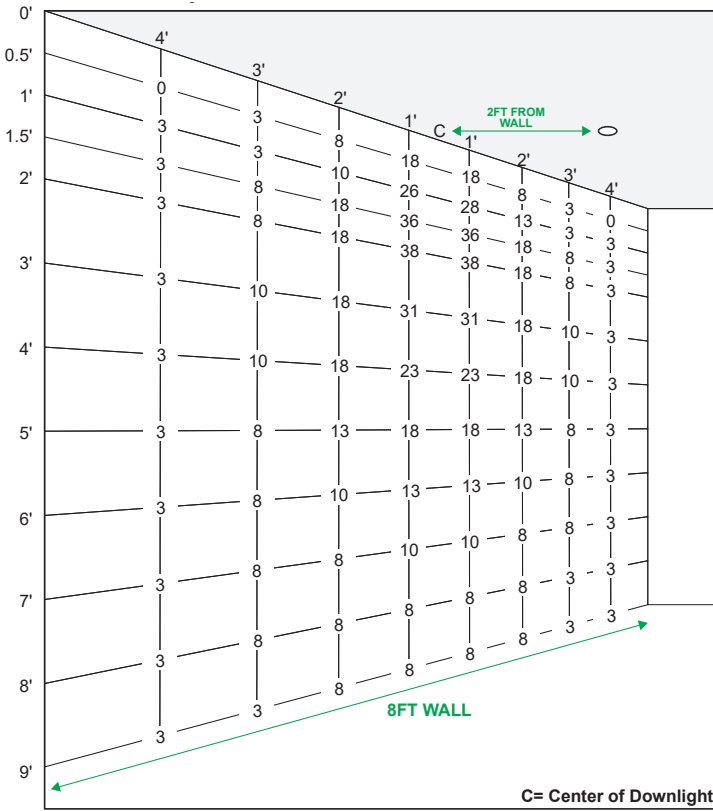

LUCA 2.7" STATIC WHITE
120V-277V, RECESSED WALL WASH DOWNLIGHTS

DISTANCE OUT AND BETWEEN CENTER OF FIXTURES (A)

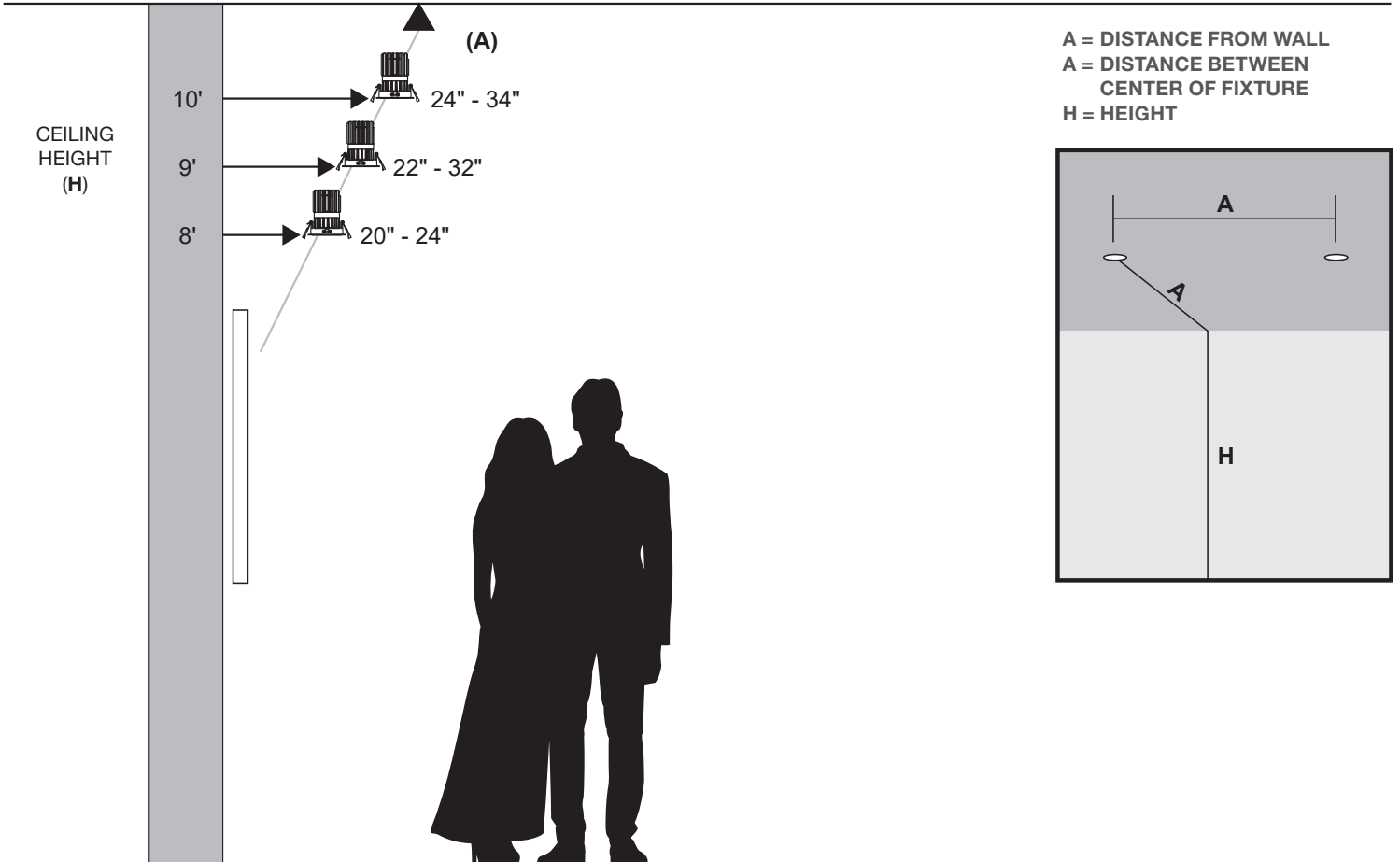

WIRING DIAGRAMS

TRIAC / FORWARD PHASE / LEADING EDGE DIMMING (TRI)
 Input 120VAC 50/60Hz
 Range 100% - 3%

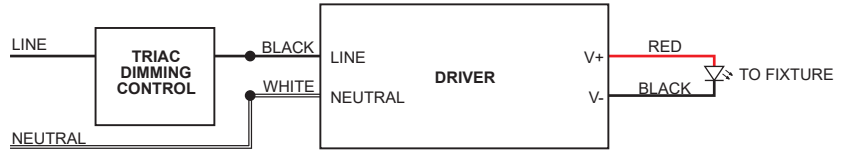

ELV / REVERSE PHASE / TRAILING EDGE DIMMING (TRI)
 Input 120VAC 50/60Hz
 Range 100% - 3%

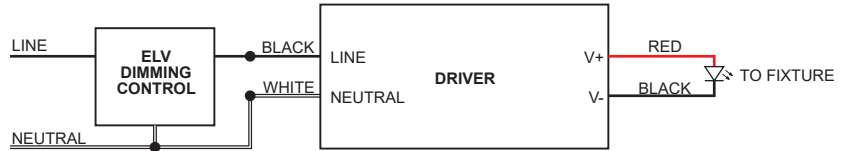

0-10V DIMMING (010)
 Input 120VAC-277VAC 50/60Hz
 Range 100% - 0.1% Dim to Off

NOTE
 Cap off unused wires individually.
 DO NOT cap together.

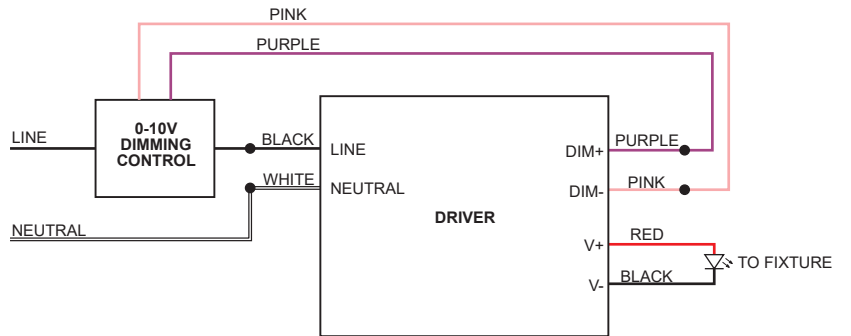

DALI DIMMING (DAL)
 Input 120VAC-277VAC 50/60Hz
 Range 100% - 0.1% Dim to Off

NOTE
 Cap off unused wires individually.
 DO NOT cap together.

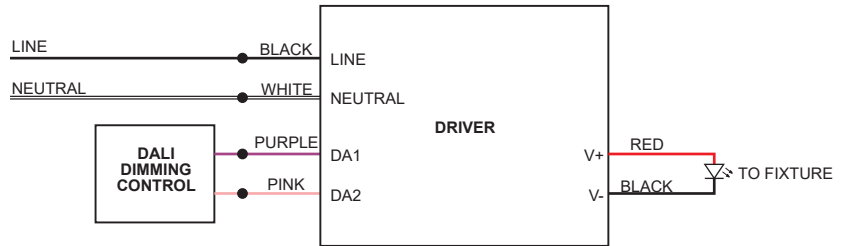

LUCA 2.7 DIMMING & CONTROLS FOR TRIAC/ELV ONLY



DESCRIPTION

The Pure Smart™ Wi-Fi dimmer works with non-smart bulbs and fixtures compatible with forward phase or Triac dimming (not compatible with 0-10V Dimming). Smart Wi-Fi Dimmer also allows for scheduling, grouping, voice control and control from anywhere via the WiZ app on your mobile device or the WiZ Pro Dashboard on your desktop.

OPERATION*

Features an ON/OFF switch and dimming functionality activated with a long press of the On (Brightness Up) or Off (Brightness Down) button. 400W Maximum Incandescent load, 150W CFL and/or retrofit LED bulb. Minimum trim and fade in/out settings are adjusted in the WiZ App. Communicates over 2.4 GHz Wi-Fi only. If remote power is being used, this dimmer is only compatible with PureEdge Universal Power Supplies. No Hub Required.

*When dimming traditional CFL/LEDs, ensure they are marked as dimmable.

BODY

Durable polycarbonate body. Compatible with decorator style wall plate (Not Included)

EASY INSTALLATION

The Pure Smart™ Wi-Fi Dimmer installs just like a regular in-wall switch. Works with any non-smart Static CCT or Warm Dim bulb/fixture compatible with forward phase or Triac dimming. Can be used in 3-way applications (Reference Manual for Wiring Diagram). Compatible with standard gangable boxes. Requires neutral wire. No Hub Required.

WiZ APP

The Pure Smart™ Dimmer can be controlled via the WiZ app (works with iOS and Android) from anywhere. Voice control enabled when used in conjunction with Google Assistant, Siri, Alexa, IFTTT, and SmartThings. Grouping, zoning, and scheduling can all be programmed with the WiZ app or WiZ Pro Dashboard.

SECURITY

3rd party log-in and cloud security provide a safe and protected connection. WiZ does not store nor share any personal information.

Product	Type	Finish
SWW	DIM	WH
SWW Pure Smart Wall WiZ Pro Connected	DIM Dimmer	WH White

NETWORK TOPOLOGY

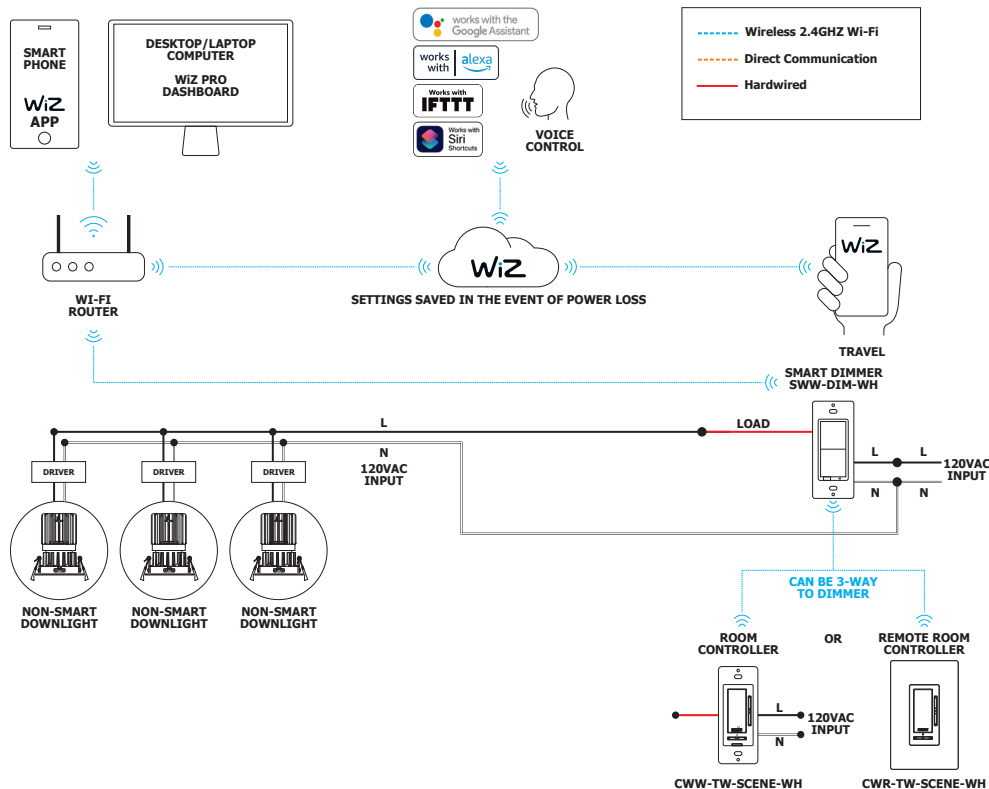

TM30 DATA

120V-277V, RECESSED WALL WASH DOWNLIGHTS

TM-30-15 DATA: The data below is for bare LED Static White Strip. Consistent color temperatures throughout a single strip and among multiple strips is possible through a 3 phase binning process in which each order is inspected with a color meter to ensure uniformity.

2400K | Rf: 84.5 | Rg: 94.4
Color Vector Graphic

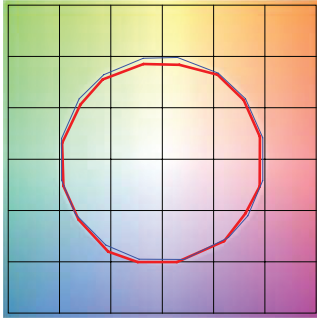

■ Test ■ Reference

		GRAPHIC SHIFTS %	
HUE BIN	Rf	CHROMA	HUE
1	92	-2.4%	1.5%
2	94.7	-2.1%	-0.0%
3	95.4	-1.9%	-0.1%
4	88.7	-6.7%	-3.1%
5	92.8	-5.6%	1.0%
6	92.7	-3.4%	3.4%
7	89.9	-4.3%	4.1%
8	92.4	-1.4%	4.4%
9	89	-0.6%	5.8%
10	88.9	0.4%	6.2%
11	89.7	4.0%	5.4%
12	92.6	3.0%	-0.7%
13	90.9	1.1%	-7.0%
14	89.9	0.5%	-5.8%
15	92.1	-3.2%	0.1%
16	88.9	-1.7%	-6.3%

2700K | Rf: 87.7 | Rg: 96.1
Color Vector Graphic

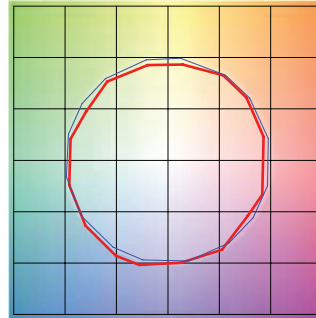

■ Test ■ Reference

		GRAPHIC SHIFTS %	
HUE BIN	Rf	CHROMA	HUE
1	88.0	-4.3%	2.6%
2	91.6	-2.4%	2.0%
3	93.7	-1.4%	1.9%
4	88.9	-5.6%	-3.1%
5	92.3	-5.5%	-0.5%
6	92.9	-3.5%	0.1%
7	84.5	-7.5%	4.6%
8	90.8	-3.0%	4.4%
9	84.5	-1.3%	8.3%
10	83.9	2.0%	9.8%
11	87.2	5.3%	7.1%
12	89.2	5.4%	-2.6%
13	88.7	0.3%	-7.8%
14	86.8	1.7%	-9.3%
15	87.6	-5.4%	-1.3%
16	83.6	-3.3%	-9.5%

3000K | Rf: 88.1 | Rg: 99.7
Color Vector Graphic

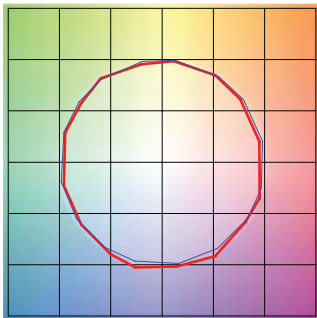

■ Test ■ Reference

		GRAPHIC SHIFTS %	
HUE BIN	Rf	CHROMA	HUE
1	92.5	-3.1%	0.3%
2	93.3	-2.3%	1.9%
3	90.9	-0.8%	3.9%
4	94.3	-1.1%	1.4%
5	92.5	-2.6%	1.5%
6	96.4	1.2%	-0.3%
7	92.6	-2.5%	-0.0%
8	96.9	-1.4%	0.2%
9	92.3	-1.8%	4.3%
10	86.6	-0.7%	7.0%
11	86.5	2.4%	8.2%
12	89.8	5.9%	1.7%
13	93.9	2.6%	-2.7%
14	89.4	5.1%	-5.8%
15	90.1	-0.1%	-4.7%
16	86.5	0.3%	-9.7%

3500K | Rf: 86.1 | Rg: 95.5
Color Vector Graphic

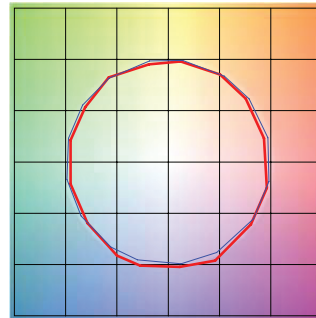

■ Test ■ Reference

		GRAPHIC SHIFTS %	
HUE BIN	Rf	CHROMA	HUE
1	90.8	-3.8%	0.3%
2	92.3	-2.8%	2.1%
3	89.7	-1.0%	4.3%
4	92.6	-1.4%	1.7%
5	91.8	-3.1%	1.3%
6	96.2	0.8%	-0.4%
7	92.9	-3.2%	0.2%
8	94.3	-2.5%	1.5%
9	90.4	-2.5%	5.2%
10	84.3	-1.4%	9.5%
11	83.1	3.5%	9.8%
12	88.2	4.8%	3.4%
13	94.0	2.7%	-2.0%
14	88.7	5.9%	-5.8%
15	88.7	0.7%	-5.9%
16	86.8	-0.7%	-6.7%

4000K | Rf: 87.6 | Rg: 96.8
Color Vector Graphic

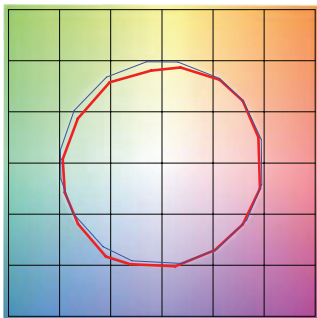

■ Test ■ Reference

		GRAPHIC SHIFTS %	
HUE BIN	Rf	CHROMA	HUE
1	88.9	-2.4%	2.5%
2	93.3	-0.4%	0.8%
3	94.8	-1.0%	-0.6%
4	87.9	-4.9%	-3.6%
5	85.3	-9.4%	-2.6%
6	90.2	-6.0%	0.2%
7	85.3	-7.6%	4.6%
8	83.7	-4.1%	8.2%
9	79.5	-1.1%	13.8%
10	78.6	1.5%	12.1%
11	83.5	6.4%	7.8%
12	90.9	3.6%	-1.1%
13	88.3	1.7%	-6.3%
14	91.9	-0.4%	-2.2%
15	84.5	-0.9%	-5.5%
16	84.7	-1.1%	-4.4%