

LUCA 2.7" WARM DIM

120V-277V, RECESSED FIXED & ADJUSTABLE DOWNLIGHTS

ASSEMBLED IN AMERICA | USA PATENT

REV 04.29.26



DESCRIPTION

Introducing the Luca 2.7 "The Bringer of Light" Downlight Series—a beacon of innovation in lighting technology. Designed for high-performance, these downlights are crafted to enhance hospitality, retail, commercial, and luxury residential environments. Featuring precision optics, the Luca downlights deliver a beam that reaches the very top of the wall, creating an elegant wash of light. With a Color Rendering Index (CRI) surpassing 90, these lights ensure exceptional color accuracy, making them an ideal choice for spaces where ambiance and visual clarity are paramount.

The Luca Downlight series delivers captivating illumination across a wide spectrum, creating a visually engaging experience within any space. With its extensive range of design and installation options, our Luca 2.7 Downlight is versatile for a wide array of new construction and remodel applications. Moreover, the compact form factor of the Luca 2.7 allows for installation in spaces with limited clearance.

Discover a new era of lighting performance and versatility with the Luca 2.7 Downlight Series, where superior optics, lumen performance, and outstanding color consistency converge to transform a space. For personalized quotes and expert layout assistance, share your drawings and concepts with our design team at design@PureEdgeLighting.com

SPECIFICATIONS

TRIM OPTIONS	Trim, Trimless, Round, Square for Fixed & Adjustable		
FINISH	Reflector: White, Black, Haze Silver (low-glare), Trims: White, Black, Custom		
ADJUSTABLE	30° Tilt, 360° Rotation		
OPTICS	15°, 25°, 30°, 40°, 45°		
WATTAGE	16W	20W	24W
LUMENS @ 3000K, 30°	821 Lm	905 Lm	988 Lm
EFFICACY	51 Lm/W	45 Lm/W	46 Lm/W
CCT	3000K-2000K		
AVERAGE CRI	93+		
INPUT VOLTAGE	120V ELV/TRIAC, 120V-277V & 0-10V & DALI/DMX		
CONSTRUCTION	Housing: Galvanized Steel Heat Sink, Trims and Reflectors: Die-Cast Aluminum		
ACCESSORIES	Clear Glass & Soft Diffusing Film (Included) Linear Spread Glass Lens, Wide Diffused Glass Lens, Double Asymmetric Lens, or Hexcell Louver		

DIMMING	Universal Dimming TRIAC/ELV: 100% – 3% 0-10V: 100% – 0.1% Dim to Off DALI2: 100% – 0.1% Dim to Off Pure Smart™ 100% – 5% Pure Smart™ Wi-Fi Dimmer TRIAC/ELV 2.4GHz Wi-Fi. No Hub needed. Voice control with Google Assistant, Alexa, Siri, Shortcuts, and IFTTT
EMERGENCY POWER	100W EM Power 120-277VAC
CUT OUT SIZE	Round: Ø3", Square: 3"
CEILING THICKNESS	0.5" - 1"
ENVIRONMENT	Suitable for damp locations, Chicago Plenum
CERTIFICATIONS	ETL Listed. Meets Title 24 (JA8) requirements Downlight Trim - Wet Listed Adjustable - Damp listed* <small>*Glass Lens to be used in showers and similar environments</small>
AVERAGE LIFE	50,000 Hours
WARRANTY*	5 Years <small>*See published warranty terms for detailed information</small>

NOMINAL LAMP DATA

	LUCA 2.7 STATIC WHITE		
	16W	20W	24W
WATTS PER FOOT	16W	20W	24W
COLOR TEMPERATURE	30D	30D	30D
LUMENS	821	905	988
LUMENS PER WATT (lm/w)	51	45	41
CRI	93	98	98

LUCA 2.7" WARM DIM

120V-277V, RECESSED FIXED & ADJUSTABLE DOWNLIGHTS

REV 04.29.26

#1 Select LUCA 2.7 Beam, Color Temperature, Trim Options

System	Beam Spread	Color Temperature	Trim Shape	Trim Function	Reflector Finish	Trim Finish
L27	NF	30D	R	D	W	L
L27 Luca 2.7 Light Engine	SP Spot 25° NF Narrow Flood 35° FL Flood 45°	30D 3000K Warm Dim	R Round S Square	D Downlight A Adjustable P* Pinhole/Adjustable <small>*Only available with black reflector and millwork, trimless or white trim</small>	W White H Haze B Black C Custom	W White B Black L Trimless M Wood Millwork C Custom

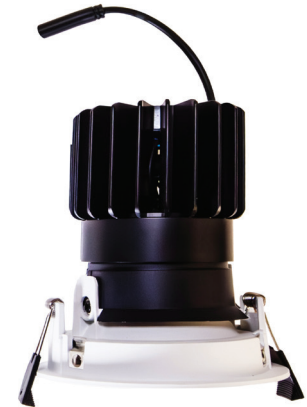

#2 Select Housing & Driver Type

REMODEL NON-IC with 120V DRIVER

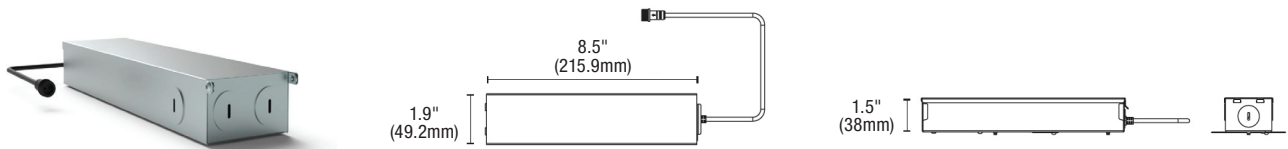

Product	Housing Type	Rating Type	Wattage/Lumens	Dimming
L27	RM	NIC	20W	UN
L27 Luca 2.7 Downlight	RM Remodel	NIC Non-Insulation Contact	16W 16 Watts/821 Lumens 20W 20 Watts/905 Lumens 24W 24 Watts/988 Lumens	UN TRIAC/MLV, ELV 120V Input 01 0-10V 120V/277V Input DA DALI 2 120V/277V Input

NEW CONSTRUCTION FRAME NON-IC with 120V DRIVER

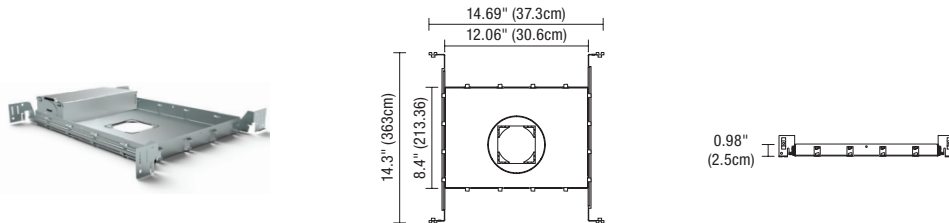

Product	Housing Type	Rating Type	Wattage/Lumens	Dimming
L27	NCF	NIC	20W	UN
L27 Luca 2.7 Downlight	NCF New Construction Frame	NIC Non-Insulation Contact	16W 16 Watts/1123 Lumens 20W 20 Watts/1346 Lumens 24W 24 Watts/1507 Lumens	UN TRIAC/MLV, ELV 120V Input 01 0-10V 120V/277V Input DA DALI 2 120V/277V Input

NEW CONSTRUCTION HOUSING IC WITH 120V DRIVER

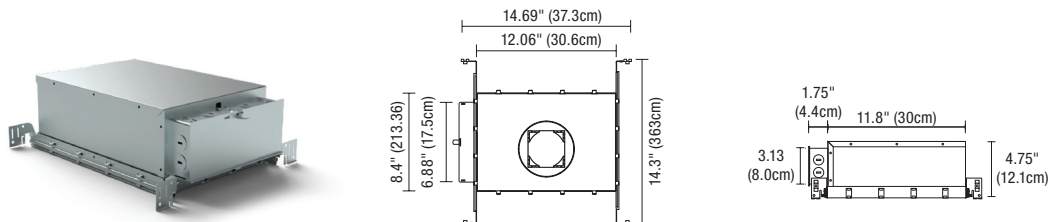

Product	Housing Type	Rating Type	Wattage/Lumens	Dimming
L27	NCH	IC	16W	UN
L27 Luca 2.7 Downlight	NCH New Construction Housing	IC Insulation Contact CP Chicago Plenum	16W 16 Watts/1123 Lumens	UN TRIAC/MLV, ELV 120V Input 01 0-10V 120V/277V Input DA DALI 2 120V/277V Input

LUCA 2.7" WARM DIM

120V-277V, RECESSED FIXED & ADJUSTABLE DOWNLIGHTS

LUCA 2.7 TRIMLESS HOUSING (INCLUDED WITH TRIM OPTION L)

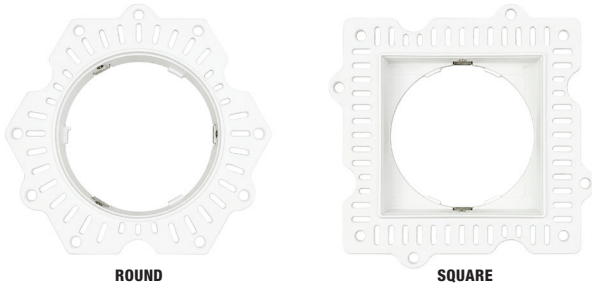

Product	Housing Type	Trim Type	Finish
L27	RD	TL	WH
L27 Luca 2.7 Downlight	RD Round Square	TL Trimless	WH White

LUCA 2.7 MILLWORK TRIMLESS ADAPTER (INCLUDED WITH TRIM OPTION M)

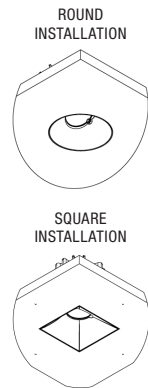

Product	Housing Type	Trim Type	Type
L27	RDSQ	TL	M
L27 Luca 2.7 Downlight	RDSQ Round/Square	TL Trimless	M Wood Millwork

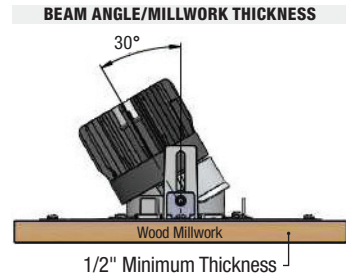

TRIMLESS ADAPTER INSTALLATION

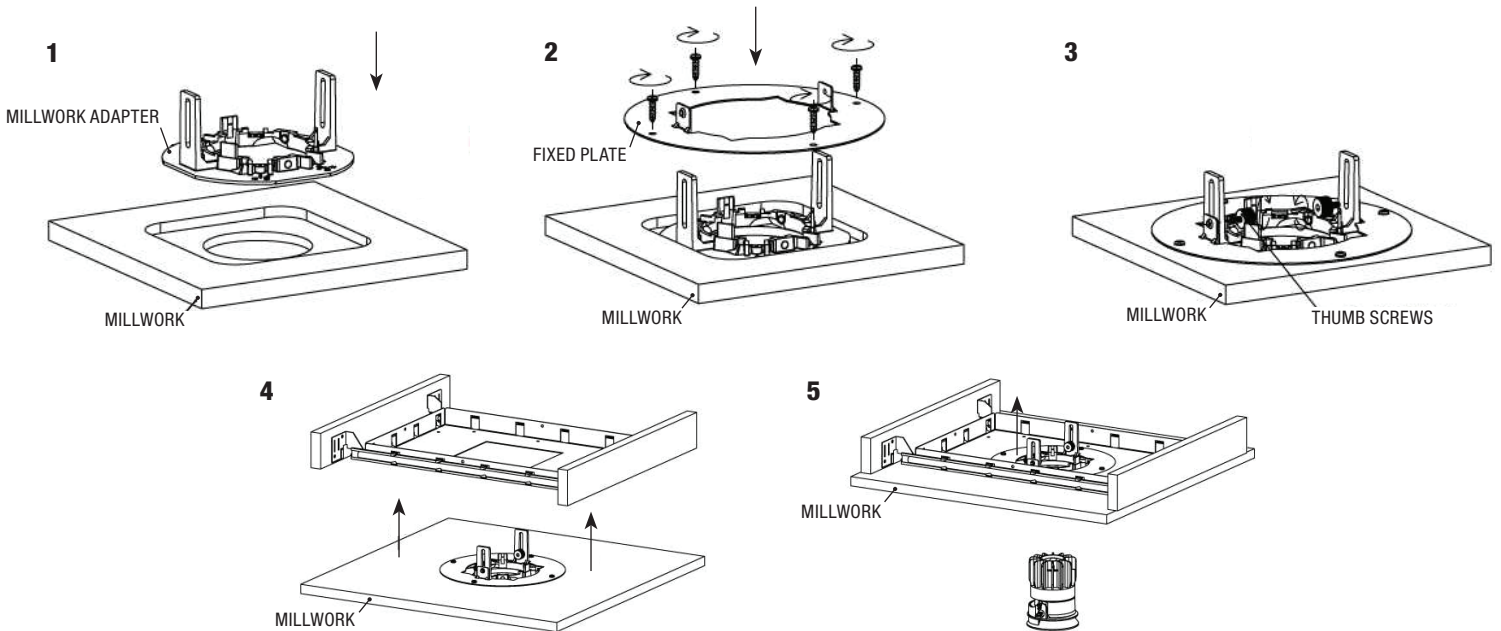

LUCA 2.7" WARM DIM

120V-277V, RECESSED FIXED & ADJUSTABLE DOWNLIGHTS

LUCA 2.7 TRIM OPTIONS

Fixed Downlight



Round Trim

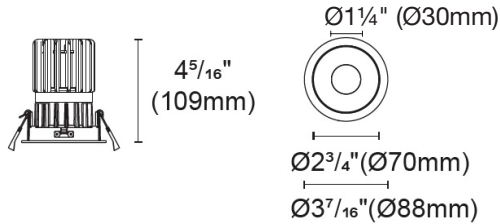

Round Trimless

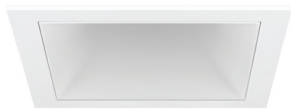
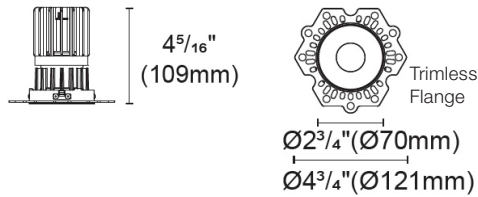

Square Trim

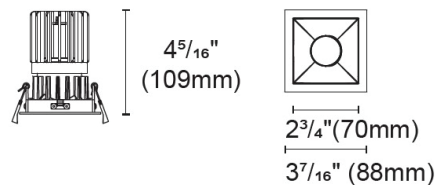

Square Trimless

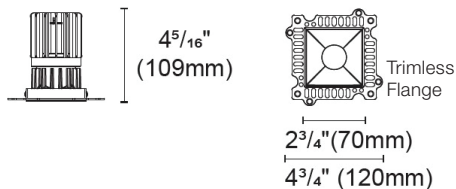

Adjustable Downlight



Round Trim

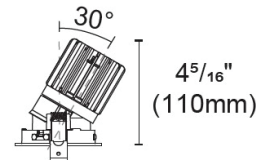

Round Trim Pinhole

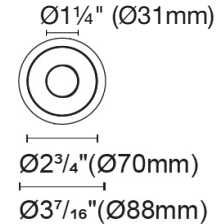

Round Trimless

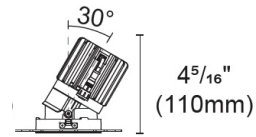

Round Trimless Pinhole

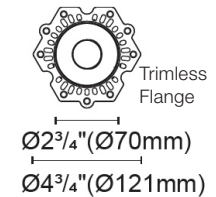

Square Trim

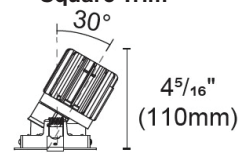

Square Trim Pinhole

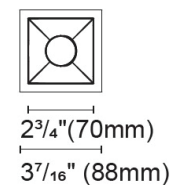

Square Trimless

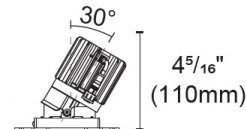

Square Trimless Pinhole

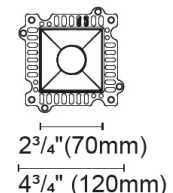

LUCA 2.7 TRIM & REFLECTOR OPTIONS

ROUND TRIM

Black Trim

White Trim



Black Reflector



White Reflector



Haze Reflector

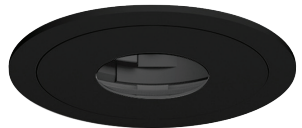

Pinhole Trim

SQUARE TRIM

Black Trim

White Trim



Black Reflector



White Reflector



Haze Reflector



Pinhole Trim

LUCA 2.7" WARM DIM

120V-277V, RECESSED FIXED & ADJUSTABLE DOWNLIGHTS

BEAM SPREAD & LENSES

LOW GLARE REFLECTOR

Designed with a 30 degree cut-off angle, the Luca provides high output and efficiency while maximizing visual comfort.

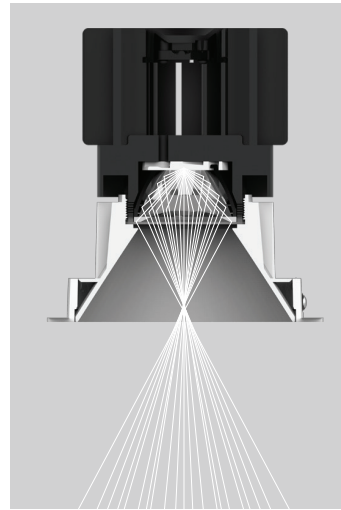
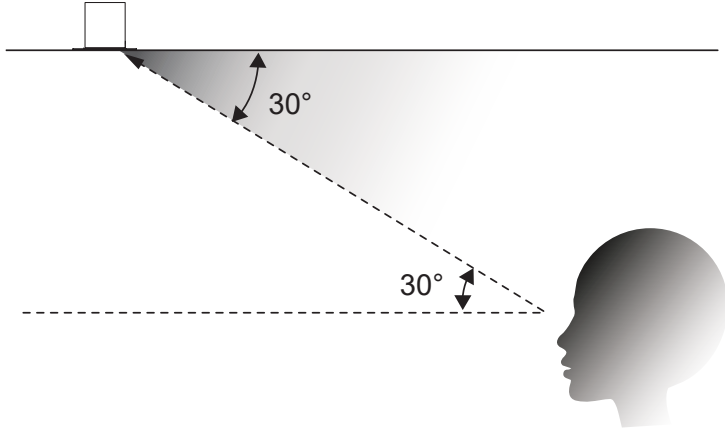

OPTICS

Our Luca Downlight has been meticulously designed to deliver exceptional performance and visual comfort. With its deep baffle design and a 30° cut-off, it effectively minimizes glare while providing a consistent and high-quality distribution of white light.

Our Adjustable Downlight features a 30° tilt for precise aiming and control.

SELECT UP TO TWO ACCESSORIES

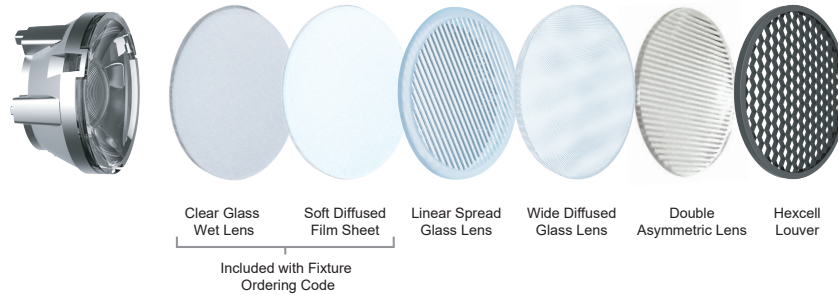

In addition to the included glass wet Lens and soft diffusion film we offer a variety of beam spreads, and lens accessories to tailor the output and beam shape for specific applications. The Linear spread lens glass produces an elliptical illumination pattern, while the Wide diffused glass lens evenly distribute the light. The Double Asymmetric Lens splits the light beam evenly into two opposing directions, creating two elliptical illumination patterns. Additionally, the Hexcell Louver is available for enhanced glare control.

REPLACEMENT OPTICS

Product	Type	Beam Spread*	Color Temperature
LEN	L2.7	NF	SW
LEN Lens	L2.7 Luca 2.7	SP Spot 25° NF Narrow Flood 35° FL Flood 45°	SW Static White

*Restrictions: NS & WF not available for replacement optics

Accessories (up to 2)

Product	Type
GL13	L
GL13 Glass 1 5/8" (40mm) Diameter	C Clear Glass Wet Lens L Linear Spread Glass Lens W Wide Diffuse Glass Lens DAL Double Asymmetric Lens
LF13 Lens Film 1 5/8" (40mm) Diameter	S Soft Diffusion Film
LO13 Louver 1 5/8" (40mm) Diameter	H Hexcell Louver

Double Asymmetric Lens Beam Spread

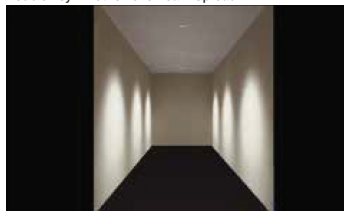

LUCA 2.7" WARM DIM

120V-277V, RECESSED FIXED & ADJUSTABLE DOWNLIGHTS

LUCA 2.7 FOOT CANDLE DISTRIBUTION (CONTINUED)

D - Distance From Luca fixture, FC - Initial foot candles at the center of beam, DIA - Diameter

16W at 3000K

NARROW SPOT 15°

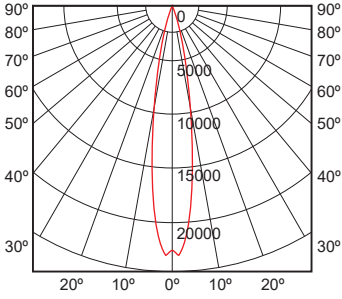

D'	FC	DIA"
1'	7280	3.4"
2'	1820	6.6"
3'	809	9.8"
4'	455	13"
5'	291	16.2"
6'	202	19.4"
7'	149	22.6"
8'	114	25.8"

DIA.

SPOT 25°

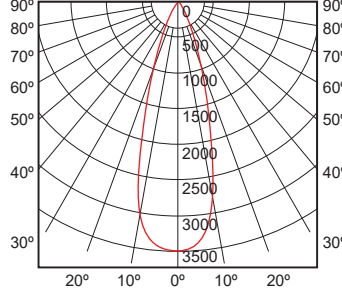

D'	FC	DIA"
1'	2304	5.4"
2'	576	10.8"
3'	256	16.2"
4'	144	21.6"
5'	92	27"
6'	64	32.4"
7'	47	37.8"
8'	36	43.2"

DIA.

NARROW FLOOD 30°

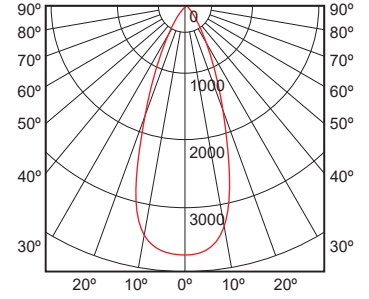

D'	FC	DIA"
1'	1296	7.6"
2'	324	15.15"
3'	144	22.7"
4'	81	30.25"
5'	52	37.8"
6'	36	45.35"
7'	26	52.9"
8'	20	60.45"

DIA.

FLOOD 40°

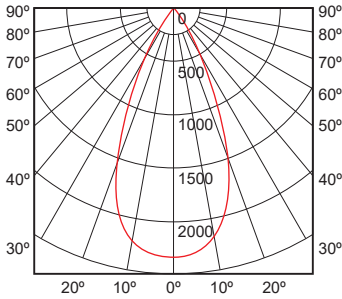

D'	FC	DIA"
1'	704	9.4"
2'	176	19.2"
3'	78	29"
4'	44	38.8"
5'	28	48.6"
6'	20	58.4"
7'	14	68.2"
8'	11	95.1"

DIA.

LUCA 2.7" WARM DIM

120V-277V, RECESSED FIXED & ADJUSTABLE DOWNLIGHTS

LUCA 2.7 FOOT CANDLE DISTRIBUTION (CONTINUED)

D - Distance From Luca fixture, FC - Initial foot candles at the center of beam, DIA - Diameter

20W at 3000K

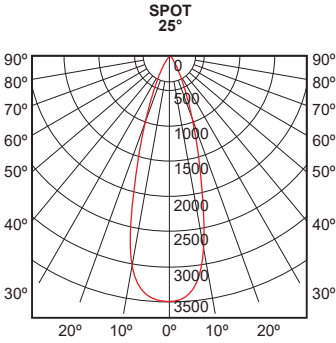

D'	FC	DIA"
1'	3168	5.4"
2'	792	10.8"
3'	352	16.2"
4'	198	21.6"
5'	127	27"
6'	88	32.4"
7'	65	37.8"
8'	50	43.2"

DIA.

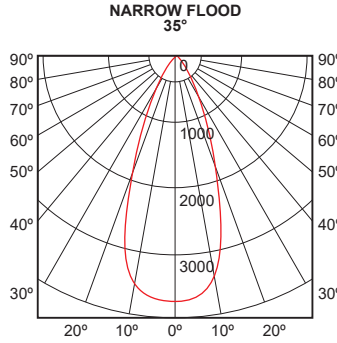

D'	FC	DIA"
1'	2656	6.8"
2'	664	13.2"
3'	295	19.6"
4'	166	26"
5'	106	32.4"
6'	74	38.8"
7'	54	45.2"
8'	42	51.6"

DIA.

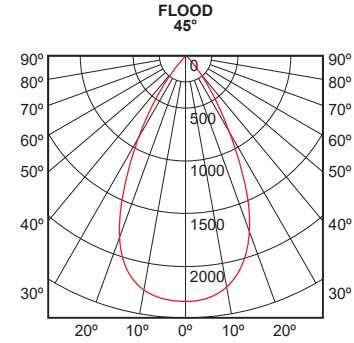

D'	FC	DIA"
1'	1104	10.2"
2'	276	19.8"
3'	123	29.4"
4'	69	39"
5'	44	48.6"
6'	31	58.2"
7'	23	67.8"
8'	17	77.4"

DIA.

24W at 3000K

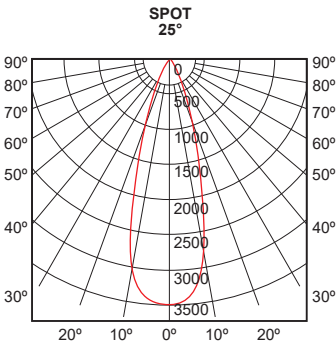

D'	FC	DIA"
1'	3803	5.4"
2'	951	10.8"
3'	423	16.2"
4'	238	21.6"
5'	152	27"
6'	106	32.4"
7'	78	37.8"
8'	59	43.2"

DIA.

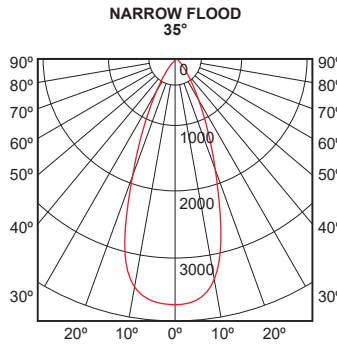

D'	FC	DIA"
1'	3188	6.8"
2'	797	13.2"
3'	354	19.6"
4'	199	26"
5'	128	32.4"
6'	89	38.8"
7'	65	45.2"
8'	50	51.6"

DIA.

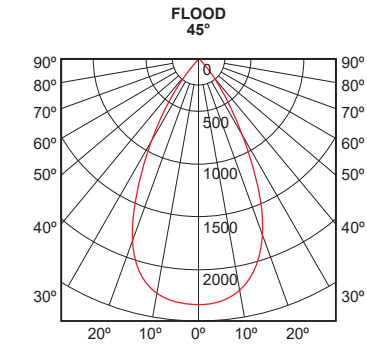

D'	FC	DIA"
1'	1325	10.2"
2'	331	19.8"
3'	147	29.4"
4'	83	39"
5'	53	48.6"
6'	37	58.2"
7'	27	67.8"
8'	21	77.4"

DIA.

LUCA 2.7" WARM DIM

120V-277V, RECESSED FIXED & ADJUSTABLE DOWNLIGHTS

REV 04.29.26

TRIAC / FORWARD PHASE / LEADING EDGE DIMMING (TRI)
 Input 120VAC 50/60Hz
 Range 3% - 100%

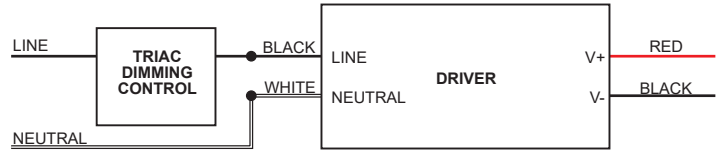

ELV / REVERSE PHASE / TRAILING EDGE DIMMING (TRI)
 Input 120VAC 50/60Hz
 Range 3% - 100%

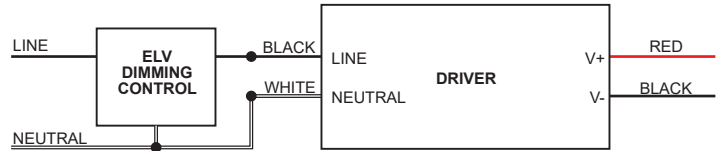

0-10V DIMMING (010)
 Input 120VAC-277VAC 50/60Hz
 Range 0.1% - 100% Dim to Off

NOTE
 Cap off unused wires individually.
 DO NOT cap together.

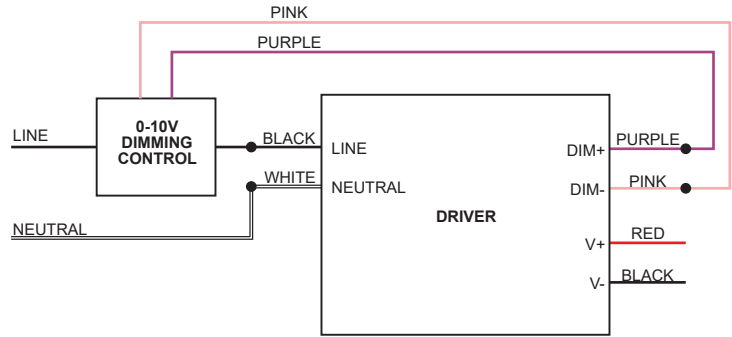

DALI DIMMING (DAL)
 Input 120VAC-277VAC 50/60Hz
 Range 0.1% - 100% Dim to Off

NOTE
 Cap off unused wires individually.
 DO NOT cap together.

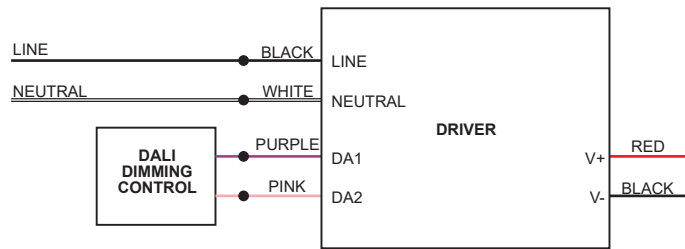

TM30 DATA

120V-277V, RECESSED FIXED & ADJUSTABLE DOWNLIGHTS

REV 04.29.26

TM-30-15 DATA: The data below is for bare LED Warm Dim Strip. Consistent color temperatures throughout a single strip and among multiple strips is possible through a 3 phase binning process in which each order is inspected with a color meter to ensure uniformity.

3000D | Rf: 90.6 | Rg: 101.1

Color Vector Graphic

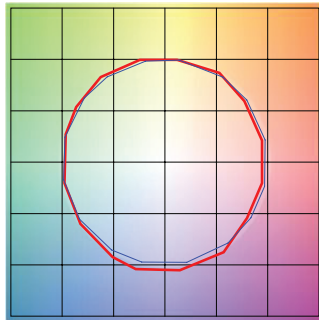

		GRAPHIC SHIFTS %	
HUE BIN	Rf	CHROMA	HUE
1	91.5	-3.5%	1.3%
2	92.2	-1.8%	3.0%
3	89.3	0.5%	4.8%
4	92.7	-1.1%	0.6%
5	93.3	0.5%	1.4%
6	93.8	2.7%	-0.8%
7	91.2	-2.1%	-0.2%
8	97.0	-0.5%	-0.7%
9	92.5	-0.7%	3.8%
10	88.3	0.9%	7.1%
11	87.5	3.9%	7.6%
12	88.2	6.2%	-0.2%
13	89.9	3.4%	-6.0%
14	86.9	4.4%	-8.5%
15	91.9	-1.9%	-2.9%
16	84.7	-1.3%	-10.6%

■ Test ■ Reference