

# TRULINE .5A DIY

## DO-IT-YOURSELF PLASTER-IN LED SYSTEM

DESIGNED BY GREGORY KAY | ASSEMBLED IN AMERICA

REV 10.05.23



### Let The Drywall Be Your Canvas

#### DESCRIPTION

PureEdge pioneered the TruLine .5A DIY (Do-It-Yourself) Plaster-in, 24VDC LED system that recesses within 5/8" drywall, without any framing modification required. Redefining the relationship between Lighting and Interior Design, this innovative and highly efficient system blends seamlessly into the drywall, becoming part of the architecture. TruLine .5A DIY system simplifies complex configurations by using pre-formed components, streamlining the installation process. The slim extrusions, LED strips, and Lenses are field-cuttable and ordered in various increments. Multiple runs of channel mount flawlessly together providing smooth and glare-free general illumination using designer-grade color rendering LEDs (95+ CRI). With the ability to run in vertical, horizontal, and diagonal directions or wrap both inside and outside corners, the compositions are truly endless. Offered in a broad range of wattages and color temperatures from 2400K through 4000K in Static White, Warm Dim (**27D** or **30D**), Pro-Dim (**27PD** or **30PD**), Tunable White (**2K6K** or **27K6**), Dynamic **RGB**, **RGB+White** in 2000K (special order in 27K, 30K and 40K), and **TruColor™ RGBTW** Color Changing RGB with Tunable White **1500K-6500K**. Influenced by simplicity and elegance, the TruLine .5A Plaster-in system brings together a modern and dynamic appearance to residential and commercial projects alike, offering unlimited creativity, and empowering you to design one-of-a-kind, personalized spaces every time. Let the drywall be your canvas. For custom designs and quotes, send drawings to [design@PureEdgeLighting.com](mailto:design@PureEdgeLighting.com).

#### ORDERING

TruLine .5A DIY can be secured to studs, joists, and rafters spaced 13"-24" apart or in between them with provided mounting straps. LED Strip and Remote Power Supplies are required and sold separately. In-Wall Mounting Kits are available for select options. Channels are sold in 8' lengths and are field cuttable to any dimension needed. The LED Strips are ordered in 1' increments and can be cut every 2.4", 3", or 4" depending on the color temperature selected.

#### PRE-FORMED COMPONENTS

8' Channel and Lens, End Feed Power Connector, Center Feed Power Connector, L-Picture Frame Power Connector, Junction Box, Outside Corner Channel Connector, Inside Corner Channel Connector, Channel Joiners, Take-Up Box, In & Out Modular Ceiling or Suspension Connector.

#### APPLICATIONS

Designed for any indoor space with drywall construction, including damp locations. Ideal applications in residential, commercial, retail, and hospitality environments.

#### LUMEN PERFORMANCE

- 347lm/ft at 3000K 5W per foot
- Designer Grade High CRI 95+ LEDs
- For all strip's lumen performance see Pg 12-19

#### LAMP

- Static White Color Temperatures ranging from **2400K** through **4000K**
- Warm Dim: **27D** (dims from 2700k-1800K) and **30D** (dims from 3000k-2000K) resembling incandescent and halogen light sources
- Pro-Dim: **27KPD** (dims down to 1800K) and **30KPD** (dims down to 2000K)
- Tunable White: **2K6K** and **27K6** grants independent control for adjusting color temperature and intensity
- Dynamic RGB & RGB+White in 2000K (**RGB**, **RGB20K**) (special order in 27K, 30K and 40K)
- **TruColor™ RGBTW** Dynamic RGB with Tunable White 1500K-6500K
- Average life: 50,000 hours

#### REMOTE POWER SUPPLIES\*, DIMMERS & CONTROLS (SOLD SEPARATELY)

24VDC, Class 2 wiring

\*See LED Strips for correlating power supplies (pages 9-16)

To determine the necessary wire gauge use our [Voltage Drop Calculator](#).

#### DESIGN NOTE

Use TruLine .5A Do-It-Yourself (**DIY**) with pre-formed components (sold separately) to create desired configurations, including Mitered Picture Frame and Inside or Outside Corners for room wrapping installations. Create square or rectangular compositions with [TruQuad .5A](#).

#### PICTURE FRAME INSTALLATION

Create 90° turns on a single surface with L-Picture Frame Channel Connectors (**TL.5A-L**) and/or L-Picture Frame Power Channel Connectors (**TL.5A-LP**). The LED Strip is installed flat on the side of the channel and bends within L-Shaped Channel Connectors to create continuous illumination on walls and ceilings.

#### ROOM WRAPPING

Room Wrapping is the style of installation in which you can create 90° angles with Inside Corner Channel Connectors (**TL.5A-IC**) and Outside Corner Channel Connectors (**TL.5A-OC**). The LED Strip is installed flat on the back wall of the channel, and bends within the inside or outside corners for seamless illumination across surfaces.

#### COMPLIANCE

ETL Listed, RoHS, Class 2, Title 24 JA8 approved for 2700K CCT and above when used with PureEdge remote Universal Power Supplies, Damp Location, Made in USA. To access our full Title 24 compliance listings: [pureedgelighting.com/resources](http://pureedgelighting.com/resources)

PureEdge is the original designer of 5/8" Drywall Products, backed by over 30 years of precision manufacturing and design.

PROJECT		FIXTURE TYPE		DATE	
---------	--	--------------	--	------	--

# TRULINE .5A DIY

## DO-IT-YOURSELF PLASTER-IN LED SYSTEM

REV 10.05.23

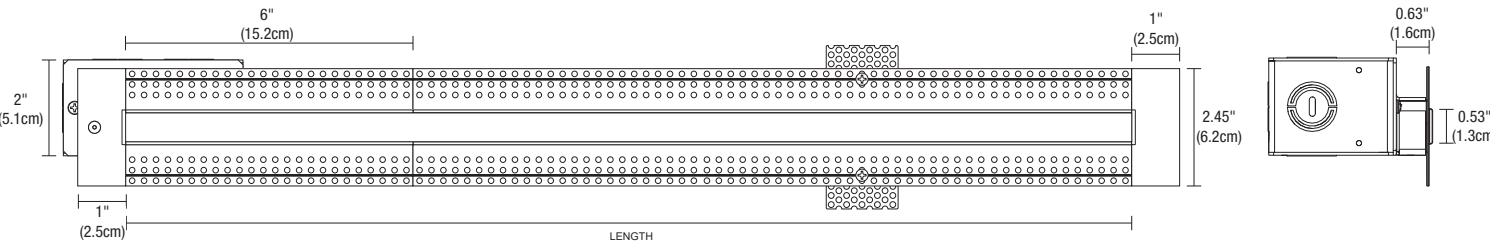

### TRADITIONAL DIMMING, 0-10V, DMX & DALI CONTROLLED COMPONENTS

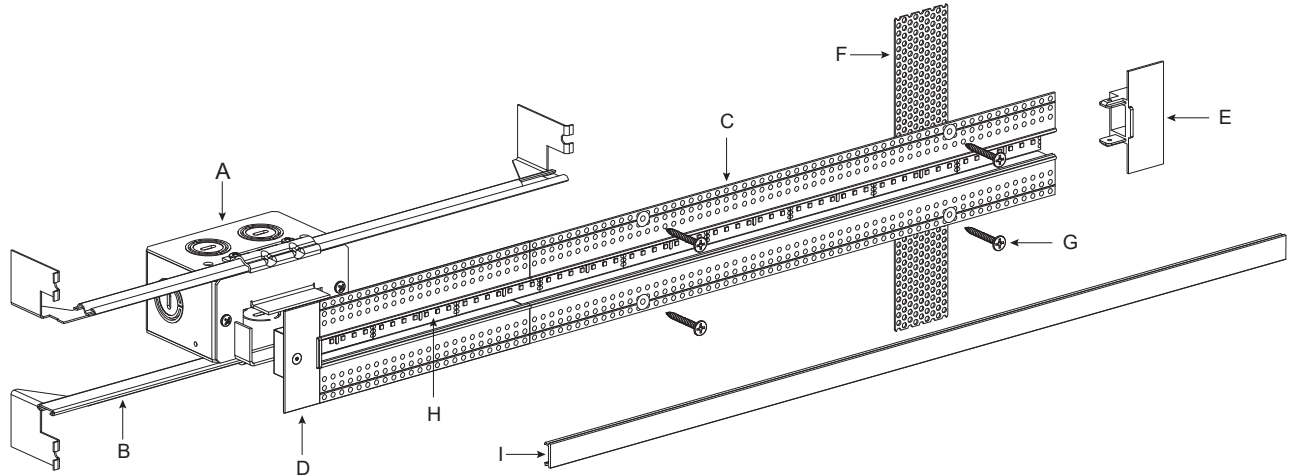

- A. JUNCTION BOX (24VDC INPUT CLASS 2 WIRING)**  
Mounts behind drywall with Adjustable Mounting Bars. Low Voltage 24VDC wires from Remote Power Supply connect to LED wires inside box. Junction Box opening is covered by channel. Required at the beginning of each run and necessary for rough-in electrical before TruLine installation.
- B. ADJUSTABLE MOUNTING BARS**  
Provides flexibility for mounting in a variety of spaces and orientations. May be secured to studs that are spaced 13"-24" apart.
- C. TRULINE .5A CHANNEL**  
5/8" deep extrusion houses a single row of LED Strip.
- D. POWER END CAP**  
Provides a finished look and prevents light leak at the feed-end of a run where LED Strip enters the channel.

- E. TAKE-UP BOX**  
Prevents dark spots at the end of a run by tucking excess LED Strip safely behind the wall.
- F. MOUNTING STRAP**  
Secures channel to drywall when wall stud is unavailable.
- G. DRYWALL SCREWS**  
Secures channel to drywall and stud.
- H. LED STRIP**  
Your choice of PureEdge LED Strip.
- I. LENS**  
0.53" wide diffused lens projects clean and continuous illumination without pixelation.

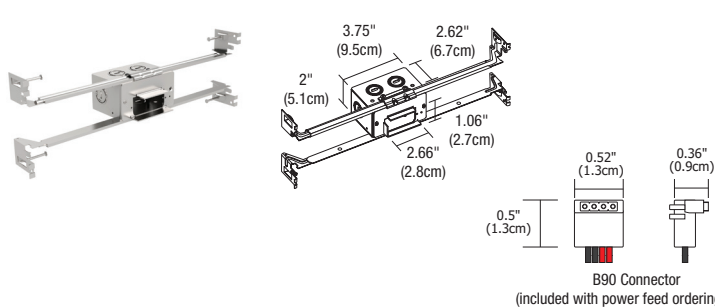

**TRADITIONAL DIMMING, 0-10V, DMX & DALI JUNCTION BOX ROUGH-IN COMPONENT (INCLUDED WITH TRADITIONAL DIMMING, DMX & DALI POWER FEEDS)**  
One Junction Box is included with TruLine .5A Power Feeds. Includes adjustable bar hangers. Quick shipment available for rough-in.

System	Size	Component
<b>TL.5A</b> TruLine .5A	<b>1RE</b>	<b>JBOX</b> Junction Box
	<b>1RC</b> 1" Rectangle Center Feed	
	<b>1LP</b> 1" Rectangle L Feed	

PROJECT		FIXTURE TYPE		DATE	
---------	--	--------------	--	------	--

# **TRULINE .5A DIY** DO-IT-YOURSELF PLASTER-IN LED SYSTEM

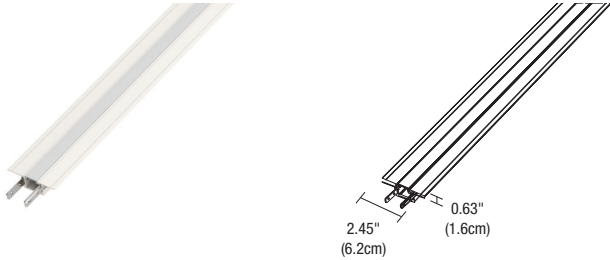

**8' CHANNEL & LENS**  
8' Plaster-In Channel with Lens. LED Strip (not included) may be installed flat or on the side of the channel. Allows for the creation of Truline .5A DIY systems. Field cuttable to any length. Includes Channel Joiners and Mounting Straps.

System	Component	Size
<b>TL.5A</b>	<b>CHLN</b>	<b>8FT</b>
<b>TL.5A</b> Truline .5" Diffused White Lens	<b>CHLN</b> Channel and Lens	<b>8FT</b> 8'
<b>TL.5DW</b> Truline .5" Diffused White Lens with White Louver		

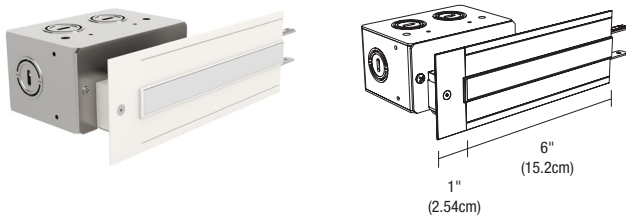

**TRADITIONAL DIMMING, 0-10V, DMX & DALI END FEED POWER CHANNEL CONNECTOR**  
Allows 24VDC power to be fed from either end of the channel. LED Strip (not included) may be installed flat or on the side of the channel. Includes Lens, Channel Joiners, Junction Box, Adjustable Mounting Bars, and Pin Power Connectors.

System	Component	Option
<b>TL.5A</b>	<b>EP</b>	<b>BLANK</b>
<b>TL.5A</b> Truline .5" Diffused White Lens	<b>EP</b> End Feed Power Channel Connector	<b>RGBW</b> Red, Green, Blue and White
<b>TL.5DW</b> Truline .5" Diffused White Lens with White Louver		<b>TC</b> TruColor™ RGBTW Red, Green, Blue and Tunable White
		*Leave blank for all other color temperatures

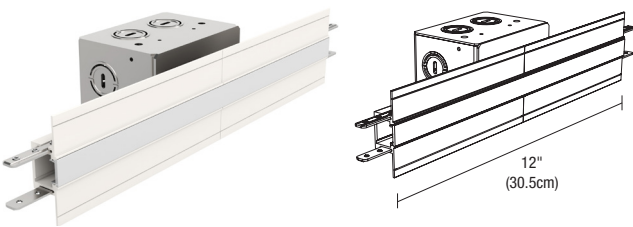

**TRADITIONAL DIMMING, 0-10V, DMX & DALI CENTER FEED/DUAL POWER CHANNEL CONNECTOR**  
Allows 24VDC power to be fed from the center of the channel in one or both directions. LED Strip (not included) may be installed flat or on the side of the channel. Includes Lens, Channel Joiners, Junction Box, Adjustable Mounting Bars, and 2 Power Connectors. Can be wired as a single or dual power feed.

System	Component	Option
<b>TL.5A</b>	<b>CFP</b>	<b>BLANK</b>
<b>TL.5A</b> Truline .5" Diffused White Lens	<b>CFP</b> Center Feed Power Channel Connector	<b>RGBW</b> Red, Green, Blue and White
<b>TL.5DW</b> Truline .5" Diffused White Lens with White Louver		<b>TC</b> TruColor™ RGBTW Red, Green, Blue and Tunable White
		*Leave blank for all other color temperatures

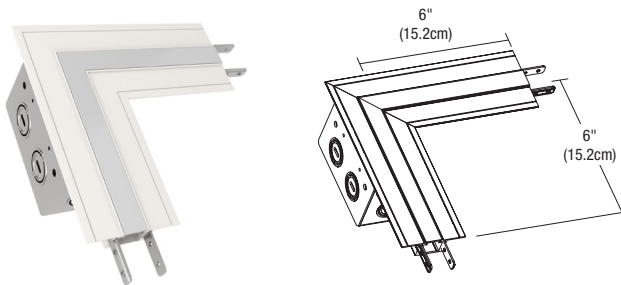

**TRADITIONAL DIMMING, 0-10V, DMX & DALI L-PICTURE FRAME POWER CHANNEL CONNECTOR**  
Allows 24VDC power to be fed from corners for 90° turns (with power in one or both directions) in picture frame installations. LED Strip (not included) is mounted on the side of the channel and follows the bend to create continuous illumination. Can be wired as a single or dual power feed. Includes Lens, Channel Joiners, Junction Box, Adjustable Mounting Bars, and two Pin Power Connectors.

System	Component	Option
<b>TL.5A</b>	<b>LP</b>	<b>BLANK</b>
<b>TL.5A</b> Truline .5" Diffused White Lens	<b>LP</b> L-Picture Frame Power Channel Connector	<b>RGBW</b> Red, Green, Blue and White
<b>TL.5DW</b> Truline .5" Diffused White Lens with White Louver		<b>TC</b> TruColor™ RGBTW Red, Green, Blue and Tunable White
		*Leave blank for all other color temperatures

PROJECT		FIXTURE TYPE		DATE	
---------	--	--------------	--	------	--

# TRULINE .5A DIY

## DO-IT-YOURSELF PLASTER-IN LED SYSTEM

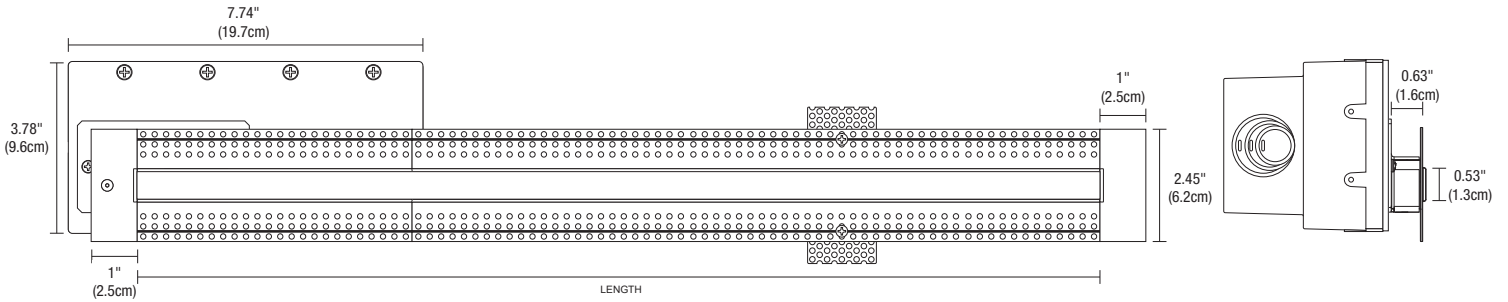

### PURE SMART WIZ PRO CONTROLLED COMPONENTS

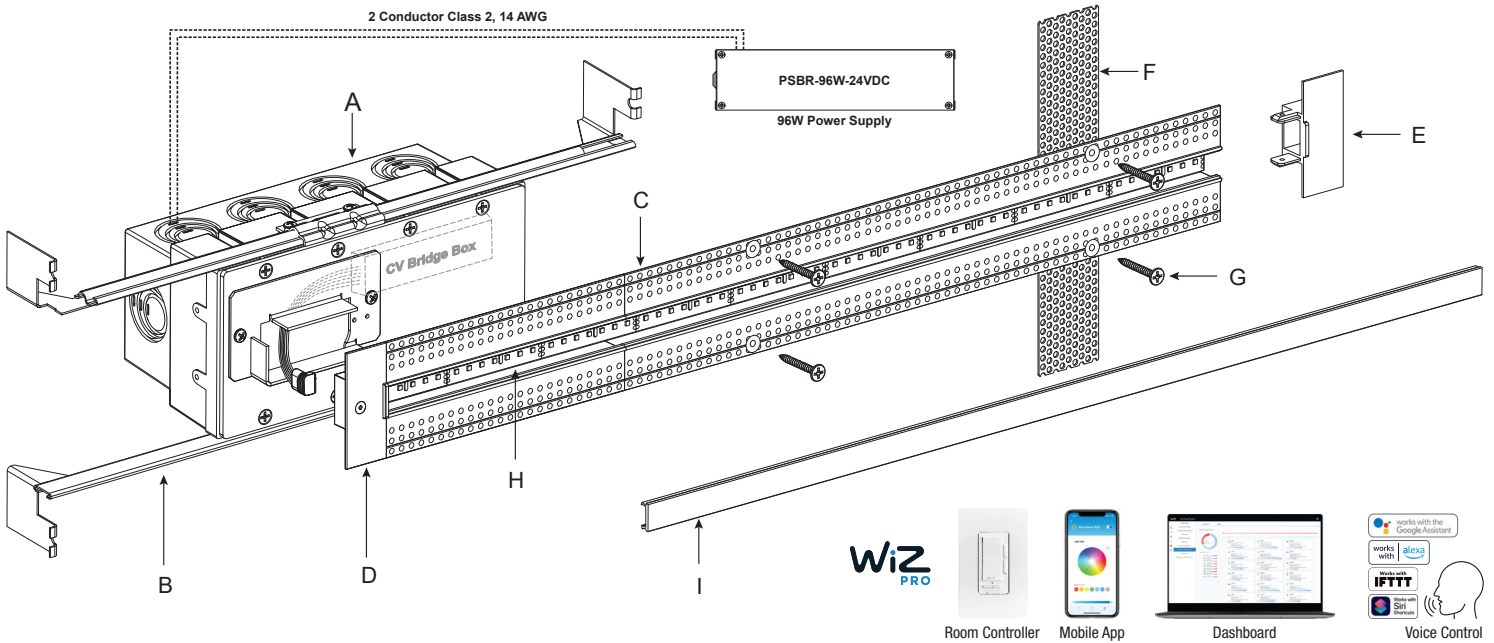

#### A. 4 GANG JUNCTION BOX WITH CV BRIDGE BOX TL.5A-WZ-EP4G-RGBTW (INCLUDED)

Mounts to framing with the included Adjustable Mounting Bars. 24VDC, Class 2, low voltage wires from PSBR Remote Power Supply connect to input wires on the CV Bridgebox inside the j-box. Low Voltage 24VDC wires from Remote Power Supply connect to input wires from bridgebox. Junction Box opening is covered by the included mounting plate and channel. Junction box is necessary for electrical rough-in prior to Truline channel installation. Junction Box and CV Bridgebox are included with Pure Smart Power Feed Connectors.

#### B. ADJUSTABLE MOUNTING BARS

Provide flexibility for mounting in a variety of spaces and orientations. May be secured to studs that are spaced 13"-24" apart.

#### C. TRULINE .5A CHANNEL

5/8" deep extrusion houses single row of LED Strip.

#### D. POWER END CAP

Provides a finished look and prevents light leak at the feed-end of a run where LED Strip enters channel.

#### E. TAKE-UP BOX

Prevents dark spots at the end of a run by tucking excess LED Strip safely behind the wall.

#### F. MOUNTING STRAP

Secures channel to drywall when framing is unavailable.

#### G. DRYWALL SCREW

Secures channel to drywall and framing.

#### H. LED STRIP

Your selection of LED Strip CCT.

#### I. LENS

0.53" wide diffused white lens projects a clean and continuous illumination without pixelation.



PROJECT		FIXTURE TYPE		DATE	
---------	--	--------------	--	------	--



# TRULINE .5A DIY DO-IT-YOURSELF PLASTER-IN LED SYSTEM

## PURE SMART WIZ CONNECTED POWER FEEDS

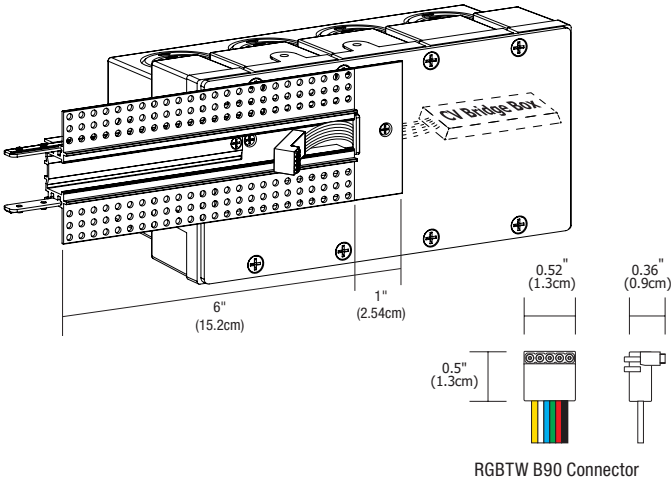

**PURE SMART END FEED POWER CONNECTOR WITH WIZ PRO CV BRIDGEBOX & JUNCTION BOX**

Includes WiZ Pro CV Bridgebox in a 4 gang Junction Box with adjustable bar hangers, B90 Pin Connector for LED strip, and Channel Joiners. LED Strip (not included) may be installed flat on the bottom or side of the channel. Two Class 2, 14AWG stranded conductors from the Remote Power Supply up to 40 ft away are required.

System	Control	Ceiling/Wall Type	Color Temperature Options
<b>TL.5A</b>	<b>WZ</b>	<b>EP4G</b>	<b>TC5W5</b>
TL.5A TruLine .5" Diffused White Lens	WZ WiZ Pro Smart System	EP4G End Feed Power 4 Gang Junction Box	DW Static White TW Tunable White TC5W5 TruColor™ RGBTW 5 watts RGB & 5 watts Tunable White TC5W7 TruColor™ RGBTW 5 watts RGB & 7 watts Tunable White

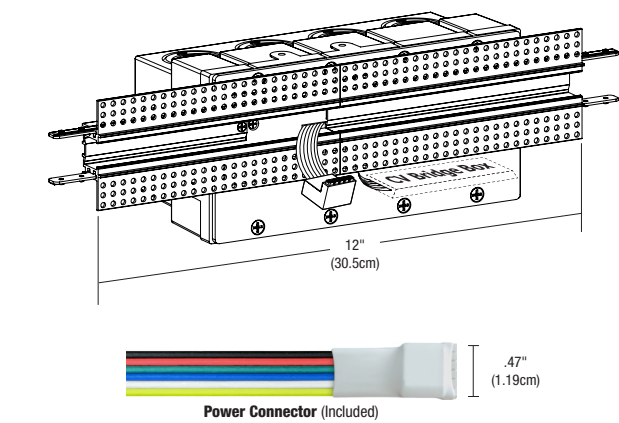

**PURE SMART CENTER FEED POWER CONNECTOR WITH WIZ PRO CV BRIDGEBOX & JUNCTION BOX**

Includes WiZ Pro CV Bridgebox in a 4 gang Junction Box with adjustable bar hangers, Pin Power Connector for LED strip, and Channel Joiners. LED Strip (not included) may be installed flat on the bottom or side of the channel. Two Class 2, 14 AWG stranded conductors from the Remote Power Supply are required per WiZ Pro CV Bridgebox.

System	Control	Ceiling/Wall Type	Color Temperature Options
<b>TL.5A</b>	<b>WZ</b>	<b>CFP4G</b>	<b>TC5W5</b>
TL.5A TruLine .5" Diffused White Lens	WZ WiZ Pro Smart System	CFP4G Center Feed Power with one WIZ connected CV bridgebox CFP24G Dual Center Feed with two WIZ connected CV bridge boxes	DW Static White TW Tunable White TC5W5 TruColor™ RGBTW 5 watts RGB & 5 watts Tunable White TC5W7 TruColor™ RGBTW 5 watts RGB & 7 watts Tunable White

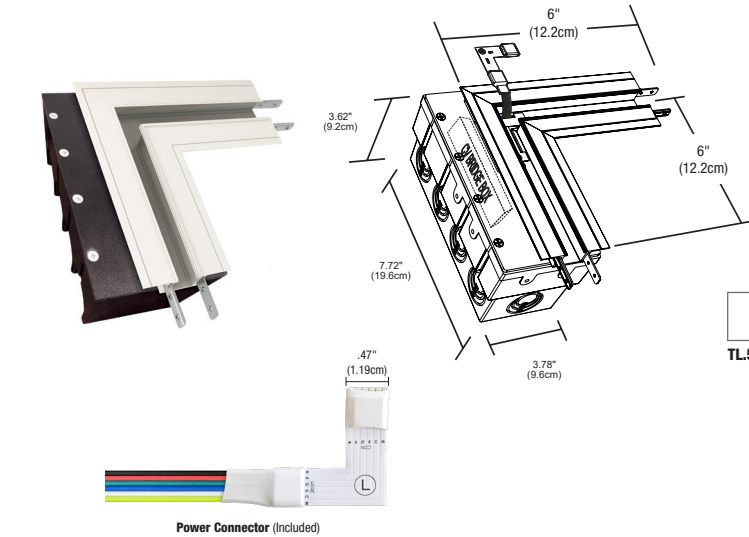

**PURE SMART L POWER FEED CHANNEL CONNECTOR WITH WIZ PRO CV BRIDGEBOX AND JUNCTION BOX**

Includes WiZ Pro CV Bridgebox in a 4 gang Junction Box, Lens, Channel Joiners, Adjustable Mounting Bars, and Pinned Power Connector. Allows 24VDC power to be fed from corners for 90° turns (with power) in Picture Frame installations either in one or both directions. LED Strip (not included) installs on the side of the channel to create continuous illumination on a wall or ceiling.

System	Control	Ceiling/Wall Type	Color Temperature Options
<b>TL.5A</b>	<b>WZ</b>	<b>LP4G</b>	<b>TC5W5</b>
TL.5A TruLine .5" Diffused White Lens	WZ WiZ Pro Smart System	LP4G L Power Feed with 4 Gang Junction box and one CV Bridgebox. LP24G Dual Feed with two WIZ connected CV bridge boxes	DW Static White TW Tunable White TC5W5 TruColor™ RGBTW 5 watts RGB & 5 watts Tunable White TC5W7 TruColor™ RGBTW 5 watts RGB & 7 watts Tunable White

PROJECT		FIXTURE TYPE		DATE	
---------	--	--------------	--	------	--

# TRULINE .5A DIY DO-IT-YOURSELF PLASTER-IN LED SYSTEM

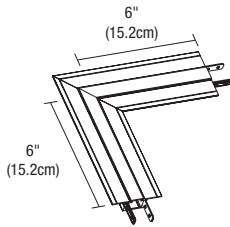

## L-PICTURE FRAME CHANNEL CONNECTOR

Allows for Picture Frame installation 90° turns. LED Strip (not included) bends on the side within the connector to create continuous illumination on a wall or ceiling. LED Strip is installed on the side of the channel. Includes Lens and Channel Joiners.

System	Component
<b>TL.5A</b>	<b>L</b>
<b>TL.5A</b> TruLine .5" Diffused White Lens	<b>L</b> L-Picture Frame Channel Connector
<b>TL.5DW</b> TruLine .5" Diffused White Lens with White Louver	

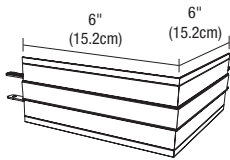

## OUTSIDE CORNER CHANNEL CONNECTOR

Outside corners for 90° Room Wrapping installation. LED Strip (not included) bends flat within the outside corners for seamless light across surfaces. For use from wall to ceiling or one wall to an adjacent wall. Includes Lens and Channel Joiners.

System	Component
<b>TL.5A</b>	<b>OC</b>
<b>TL.5A</b> TruLine .5" Diffused White Lens	<b>OC</b> Outside Corner Channel Connector
<b>TL.5DW</b> TruLine .5" Diffused White Lens with White Louver	

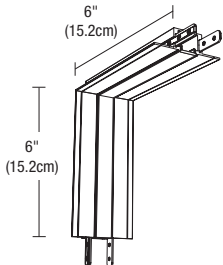

## INSIDE CORNER CHANNEL CONNECTOR

Inside corners for 90° Room Wrapping installation. LED Strip (not included) bends flat within the inside corners for seamless light across surfaces. For use from wall to ceiling or from one wall to an adjacent wall. Includes Lens and Channel Joiners.

System	Component
<b>TL.5A</b>	<b>IC</b>
<b>TL.5A</b> TruLine .5" Diffused White Lens	<b>IC</b> Inside Corner Channel Connector
<b>TL.5DW</b> TruLine .5" Diffused White Lens with White Louver	

## CHANNEL JOINERS

Included with Straight Channel, Channel Connectors, Power Feeds and Take-Up Box. Channel Joiners ship as a pair to connect two channels together. Additional channel joiners may be necessary based on lighting design.

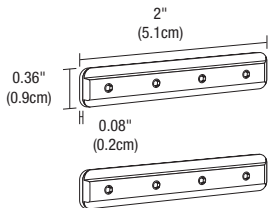

Product	Component
<b>LCR</b>	<b>SC</b>
<b>LCR</b> TruLine Channel Joiner	<b>SC</b> Straight Connector

## TAKE-UP BOX

Prevents dark spots at end of run by tucking excess LED Strip safely behind wall. Includes Channel Joiners.

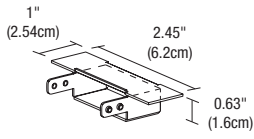

System	Component
<b>TL.5A</b>	<b>TBOX</b>
<b>TL.5A</b> TruLine .5A	<b>TBOX</b> Take-Up Box

PROJECT		FIXTURE TYPE		DATE	
---------	--	--------------	--	------	--

# TRULINE .5A DIY

## DO-IT-YOURSELF PLASTER-IN LED SYSTEM

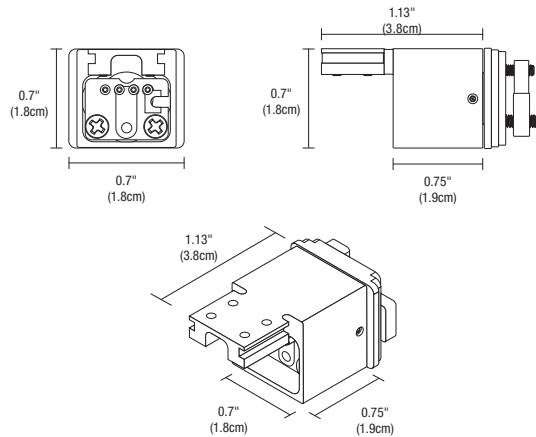

**IN & OUT CONNECTOR TO ZIPP MODULAR CEILING & SUSPENSION**  
TruLine .5A In & Out Connector joins the end of PureEdge Lighting's Zipp Modular Ceiling or Suspension systems to TruLine .5A recessed extrusion.

System	Type	Finish
<b>TL.5A-IO-ZIP</b>	<b>CA</b>	<b>SN</b>
TL.5A-IO-ZIP TruLine .5A to Zipp Modular Ceiling and Suspension	CA End Cap	SN Satin Nickel

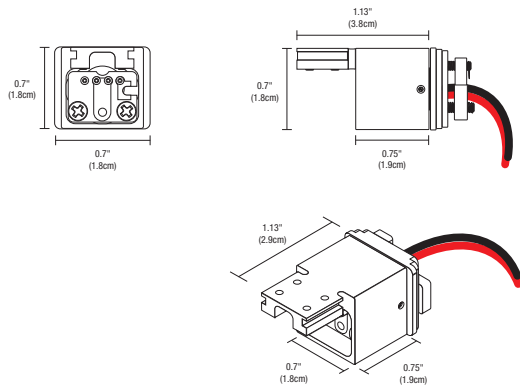

**IN & OUT POWER CONNECTOR TO ZIPP MODULAR CEILING & SUSPENSION**  
TruLine .5A In & Out Connector joins and provides power from the end of PureEdge Lighting's Zipp Modular Ceiling or Suspension systems to TruLine .5A recessed extrusion. Not available for RGBW or RGBTW. Static White Only

System	Type	Finish
<b>TL.5A-IO-ZIP</b>	<b>CAP</b>	<b>SN</b>
TL.5A-IO-ZIP TruLine .5A to Zipp Modular Ceiling and Suspension	CAP End Cap Power	SN Satin Nickel

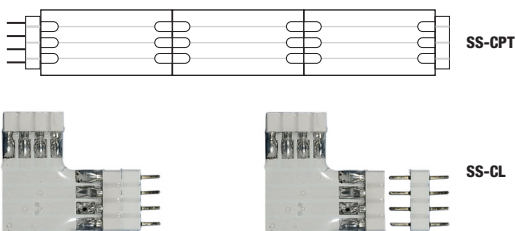

**ADDITIONAL CONNECTORS (INCLUDED WITH POWER FEEDS)**  
Additional Blank Flexible Connectors used in conjunction. Connector L is used for side mounting applications.

System	Type	Size	Option
<b>SS</b>	<b>CPT</b>	<b>SS-CL</b> (LEAVE BLANK)	<b>BLANK</b>
SS Soft Strip	CPT Connector Power Tape CL Connector L	3IN 3 Inches	RGBW Red, Green, Blue and White RGBTW Red, Green, Blue and Tunable White *Leave blank for all other color temperatures

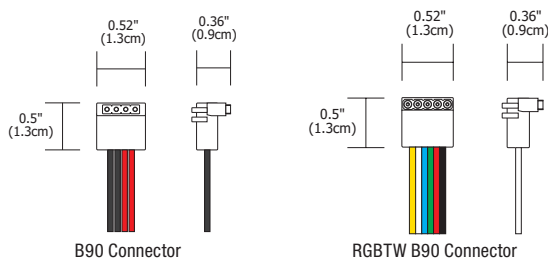

**B90 CONNECTORS**  
B90 Connectors are supplied with end power components. The ordering code below is to be used for replacements only.

System	Type	Component	Color Temperature Options
<b>LC</b>	<b>PFE</b>	<b>B90</b>	<b>BLANK</b>
LC LED Connector	PFE Power Feed	B90 Bends 90°	RGBW Red, Green, Blue and White RGBTW RGBTW (RGB + Tunable White 1500k-6500K) *Leave blank for Static White. Static Color, Tunable White and RGB

PROJECT		FIXTURE TYPE		DATE	
---------	--	--------------	--	------	--

# TRULINE .5A DIY

## DO-IT-YOURSELF PLASTER-IN LED SYSTEM

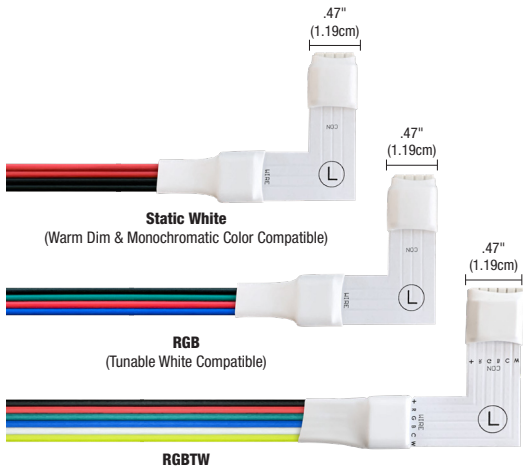

### POWER FEED/FLEXIBLE CONNECTOR

Included with Center Feed components. Part numbers listed below to be ordered for replacement only. For use with Static White, Warm Dim, Tunable White, RGB, RGBW, and RGBTW. Flexible Power Connectors link two sections of LED Strip end to end. To use as a Power Feed cut off the male end, and connect to the power supply.

Product	Type	Component	Orientation	Size	Color Temperature Options
<b>SS</b>	<b>FE</b>	<b>CON</b>	<b>LBL</b>	<b>6IN</b>	<b>RGBTW</b>
<b>SS</b> Stomp Strip/ Soft Strip	<b>FE</b> Female Pins	<b>CON</b> Connector	<b>LBL</b> L connector Bendable 90° Left <b>LBR</b> L connector Bendable 90° Right	<b>6IN</b> 6 inches	<b>DW</b> Static White, Warm Dim <b>RGB</b> Red, Green, & Blue or Tunable White <b>RGBW</b> Red, Green, Blue and White <b>RGBTW</b> Red, Green, Blue, and Tunable White

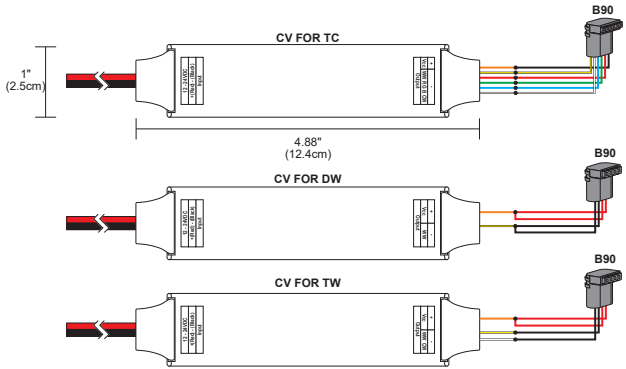

### PURE SMART/WIZ PRO CV BRIDGEBOX

WiZ Pro CV Bridgeboxes are included with all Pure Smart WiZ Pro connected power feeds and allow for integration into WiZ Pro wireless control ecosystem. The part numbers below are to be used for replacement only. Pure Smart/WiZ Pro CV Bridgeboxes are pre-programmed with Pure Smart app icons, and proprietary color mixing for tunable white and RGBTW.

Type	Type	Control	Color Temperature Options	System
<b>BR</b>	<b>LBL</b>	<b>CV96W</b>	<b>TC5W5</b>	<b>RL</b>
<b>BR</b> Bridgebox	<b>B90</b> 90° Connector <b>LBL</b> Flexible 90° L Connector Left <b>LBR</b> Flexible 90° L Connector Right <b>LBRL</b> Flexible 90° L Connector Left & Right	<b>CV96W</b> Slim Profile WiZ Bridgebox 	<b>DW</b> Static White <b>TW</b> Tunable White <b>TC5W5</b> TruColor™ RGBTW 5 watts RGB & 5 watts Tunable White <b>TC5W7</b> TruColor™ RGBTW 5 watts RGB & 7 watts Tunable White	<b>RL</b> Recessed Linear

### 4 GANG JUNCTION BOX WITH MOUNTING PLATE

(INCLUDED WITH PURE SMART POWER FEED ORDERING CODE)  
Includes a 4 gang Junction Box with adjustable bar hangers and mounting plate for the Truline .5A Channel.. Two Class 2, 14 AWG stranded conductors from remote located power supply are required per WiZ Pro CV Bridgebox used. Junction Box can be quick shipped for rough-in.

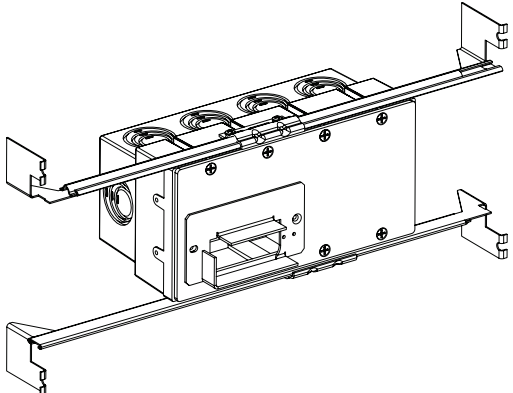

System	Type
<b>TL.5A</b>	<b>1RE4G</b>
<b>TL.5A</b> TruLine .5A	<b>1RE4G</b> 1" Rectangle End Feed* <b>1RC4G</b> 1" Rectangle Center Feed* <b>1LP4G</b> 1" Rectangle L Feed* *With 4 Gang Junction Box



# **TRULINE .5A DIY** DO-IT-YOURSELF PLASTER-IN LED SYSTEM

## **PICTURE FRAME INSTALLATION**

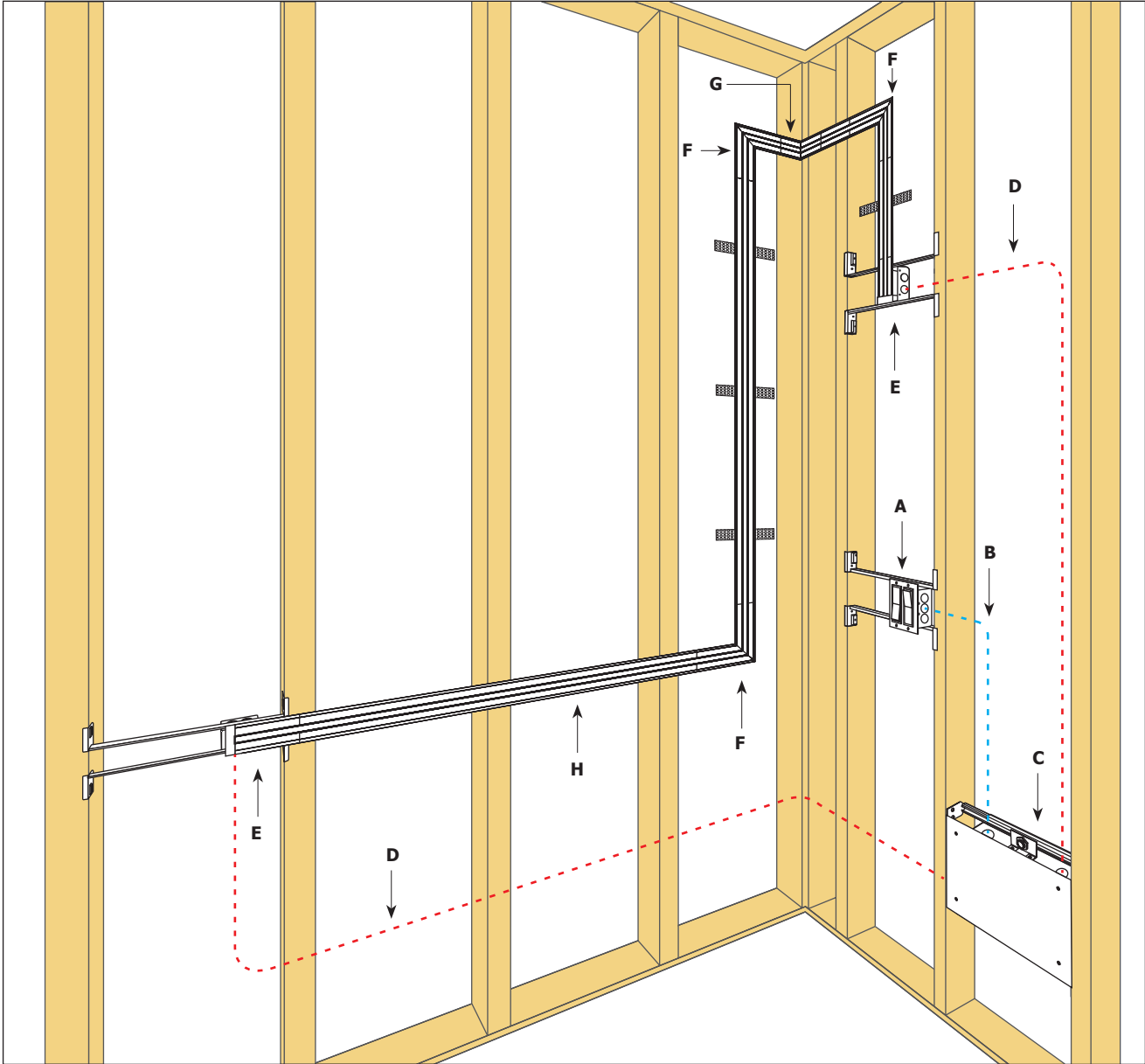

- A. DIMMER OR SWITCH
- B. 120VAC WIRING
- C. 120V/24VDC REMOTE POWER SUPPLY WITH IN-WALL MOUNTING KIT, FOR MORE REMOTE POWER SUPPLIES
- D. 24VDC, CLASS 2 WIRING
- E. END FEED POWER CHANNEL CONNECTOR WITH JUNCTION BOX
- F. L-PICTURE FRAME CHANNEL CONNECTOR
- G. INSIDE CORNER CHANNEL CONNECTOR
- H. TRULINE CHANNEL, LENS, & LED STRIP

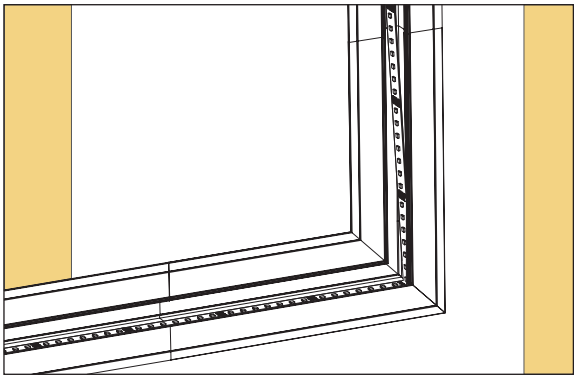

LED on the side of the Channel for the Picture Frame (L-Connector)

PROJECT		FIXTURE TYPE		DATE	
---------	--	--------------	--	------	--

# TRULINE .5A DIY

## DO-IT-YOURSELF PLASTER-IN LED SYSTEM

### ROOM WRAPPING INSTALLATION

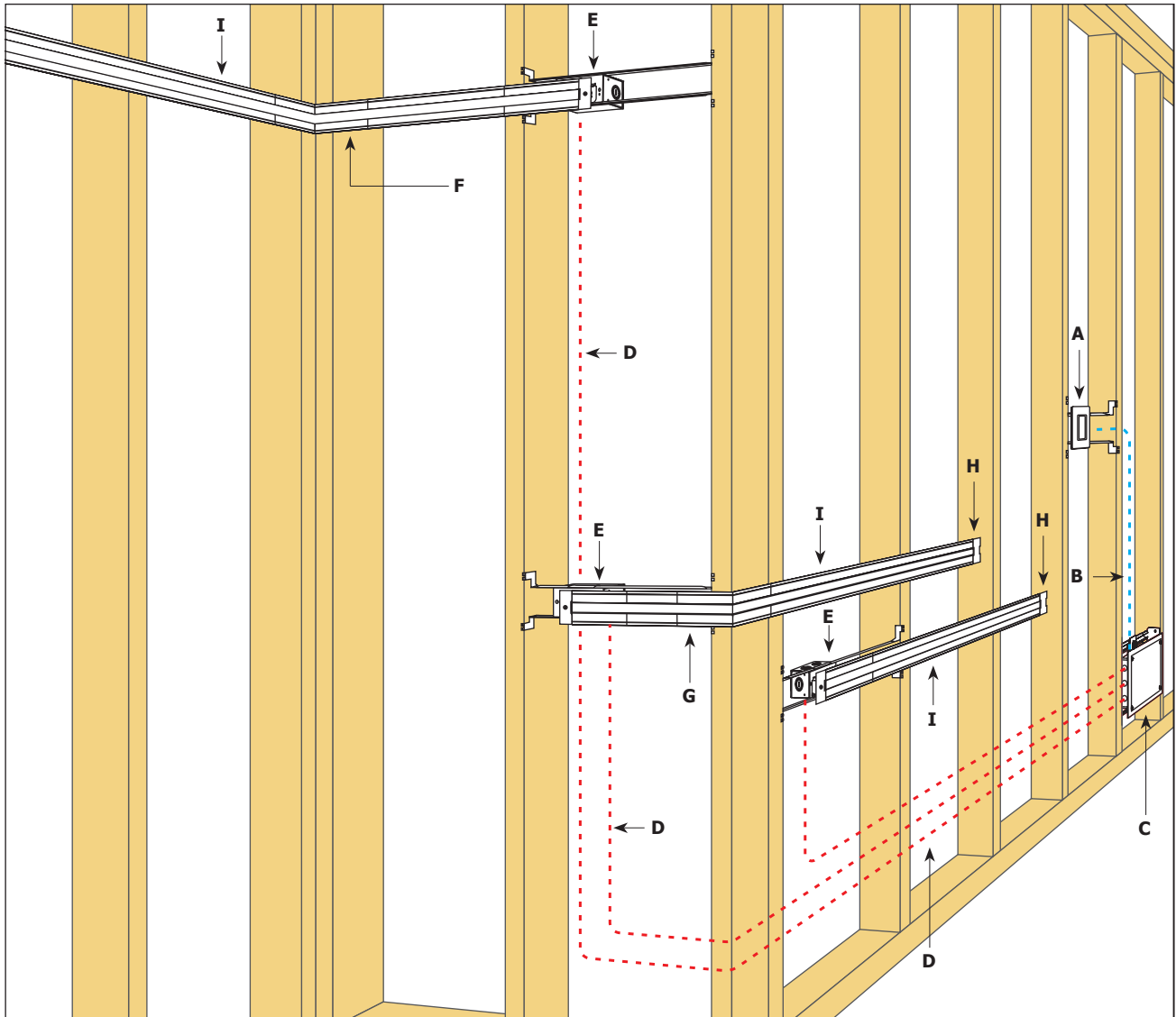

- A. DIMMER OR SWITCH
- B. 120VAC WIRING
- C. 120V/24VDC REMOTE POWER SUPPLY WITH IN-WALL MOUNTING KIT, FOR MORE REMOTE POWER SUPPLIES
- D. 24VDC, CLASS 2 WIRING
- E. END FEED POWER CHANNEL CONNECTOR WITH JUNCTION BOX
- F. INSIDE CORNER CHANNEL CONNECTOR
- G. OUTSIDE CORNER CHANNEL CONNECTOR
- H. TAKE-UP BOX
- I. TRULINE CHANNEL, LENS, & LED STRIP

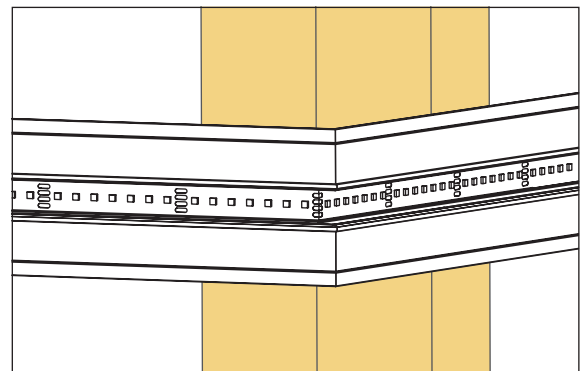

LED mounted to the back of the Channel for the Room Wrap Installation (outside corner)

PROJECT		FIXTURE TYPE		DATE	
---------	--	--------------	--	------	--

# TRULINE .5A DIY

## DO-IT-YOURSELF PLASTER-IN LED SYSTEM

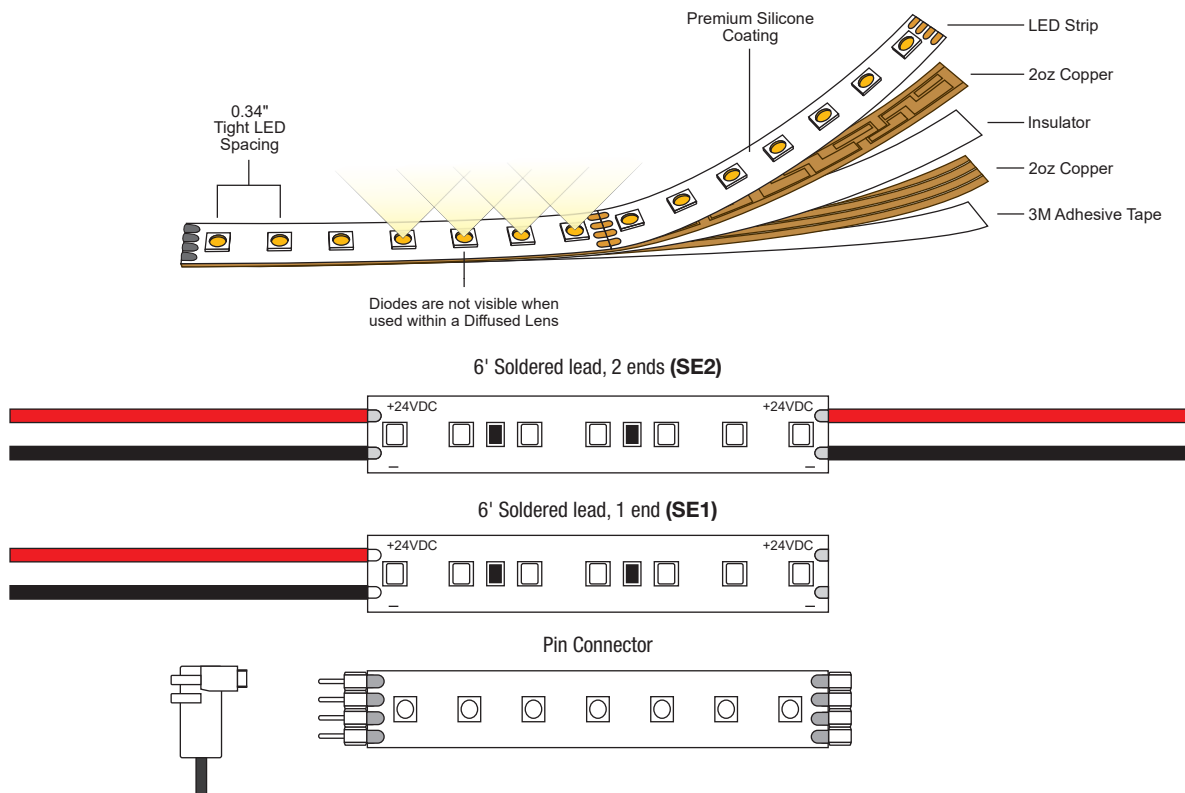

### NOMINAL DELIVERED LUMENS

DESCRIPTION	ST2A					ST5A								ST7A							
WATTS PER FOOT	2.5W					4.4W (*4.8W Warm Dim)								7.3W							
COLOR TEMPERATURE	24K	27K	30K	35K	40K	24K	27K	27D*	30K	30D*	35K	40K	22K	24K	27K	30K	35K	40K	57K		
LUMENS PER FOOT (lm/ft)	178	180	188	216	227	330	333	380	347	398	398	420	509	509	515	536	615	649	686		
LUMENS PER WATT (lm/w)	71	72	75	86	91	75	76	79	79	83	91	96	70	70	70	73	84	89	94		
CRI	92+	92+	92+	92+	92+	92+	92+	94+	92+	94+	92+	92+	92+	92+	92+	92+	92+	92+	92+		

\*27D, 30D - Warm Dim (4.8 Watts)

DESCRIPTION	ST2A									ST5A								
WATTS PER FOOT	2K6K 2W (2.5 watts)									2K6K 5W (4.4 watts)								
COLOR TEMPERATURE	20K	22K	24K	27K	30K	35K	40K	57K	65K	20K	22K	24K	27K	30K	35K	40K	57K	65K
LUMENS PER FOOT (lm/ft)	96	97	98	100	101	104	113	122	131	231	241	250	260	269	288	308	311	314
LUMENS PER WATT (lm/w)	52	50	49	50	51	52	57	61	73	58	56	54	56	58	63	67	68	79
CRI	92+	92+	92+	92+	92+	95+	93+	93+	93+	92+	92+	92+	92+	92+	95+	93+	93+	93+

DESCRIPTION	ST2A								ST5A							
WATTS PER FOOT	27K6 2W (2.5 watts)								27K6 5W (4.4 watts)							
COLOR TEMPERATURE	27K	30K	35K	40K	45K	57K	65K		27K	30K	35K	40K	45K	57K	65K	
LUMENS PER FOOT (lm/ft)	103	123	126	129	141	152	145		258	264	274	284	280	278	277	
LUMENS PER WATT (lm/w)	52	49	50	52	56	61	72		64	57	59	62	61	60	69	
CRI	92+	92+	92+	95+	93+	93+	93+		92+	92+	92+	95+	93+	93+	93+	

DESCRIPTION	5W5 5W RGB & 5W TUNABLE WHITE										5W7 5W RGB & 7W TUNABLE WHITE									
WATTS PER FOOT	5W Tunable White										7W Tunable White									
COLOR TEMPERATURE	20K	22K	24K	27K	30K	35K	40K	57K	65K		20K	22K	24K	27K	30K	35K	40K	57K	65K	
LUMENS PER FOOT (lm/ft)	107	161	195	219	226	239	258	181	167		132	221	284	322	330	348	341	200	181	
LUMENS PER WATT (lm/w)	73	35	88	52	53	103	61	116	69		40	57	46	54	54	57	58	58	60	
CRI	91.8	93.8	94.5	94.9	95.5	96.9	97.2	92.1	89.8		93	95	96	97	97	98	97	95	93	
Duv	-0.004	-0.0012	-0.0034	-0.0058	-0.0055	-0.0033	-0.0014	-0.0049	-0.0063		-0.0030	0.0002	0.0030	0.0030	0.0030	0.0009	0.0000	0.0030	0.0030	
Rf	91	93	94	94	95	94	94	92	90		92	93	95	95	95	95	94	92	91	
Rg	105	101	103	105	104	102	100	102	103		104	100	102	103	103	101	100	102	103	
R9	90	90	90	94	97	97	91	81	70		91	90	90	94	95	93	93	79	67	
R13	92	94	95	95	94	96	99	90	87		92	95	96	96	97	99	99	91	88	
R15	99	99	99	98	97	97	97	89	85		99	99	99	99	99	98	97	90	85	
WATTS/FOOT	2.7	4.55	4.35	4.25	4.25	4.35	4.2	2.95	2.4		3.35	3.85	6.15	5.95	6.15	6.15	5.84	3.45	3	

PROJECT		FIXTURE TYPE		DATE	
---------	--	--------------	--	------	--

# STOMP STRIP, STATIC WHITE

## 24VDC WITH PIN CONNECTORS

DESIGNED BY GREGORY KAY | ASSEMBLED IN AMERICA

REV 10.05.23

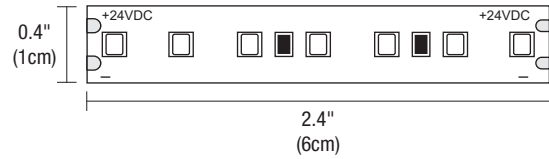

Our Low Voltage LED strips are highly durable, designed to withstand the harsh elements of a job site, and precision engineered to provide superior color rendering up to 92+ CRI. Both Stomp Strip and Soft Strip are used for our **DIY** (Do-it-Yourself) fixtures and systems.

### FEATURES & BENEFITS

- Offered with pin connectors reducing time and labor during installation
- Developed to meet popular demand for resilient performance without sacrificing output, color rendering and efficacy
- Tolerance: Created to resist damage in rigorous environments such as busy commercial jobsites
- Compact LED spacing: Produces uniform light distribution without visible diodes or hot spots when used within a diffused lens
- 4oz Layer of Copper Busbar: Provides superior heat dissipation and less voltage drop equivalent to 14AWG wire
- Premium Coating: Optically Clear Silicone prevents fading over time
- Mounting: Industrial 3M tape lined strip for strong, self-adhesion to most smooth, finished surfaces
- Suitable for indoor damp locations
- Warranty: Includes a 5-year pro-rated warranty

### MAXIMUM LENGTHS BEFORE RE-FEEDING

- 2WDC, 2.5 watts per foot - 40'
- 5WDC, 4.4 watts per foot - 20'
- 7WDC, 7.3 watts per foot - 12'

### LAMP

- Offered in multiple Static White Color Temperatures: 2400K, 2700K, 3000K, 3500K & 4000K
- Average life: 50,000 hours

### SPECIFICATIONS

- 24VDC
- 2.5, 4.4, or 7.3 watts per foot
- Sold in 1' increments
- Field-cutable in 2.4" increments
- Operating temperature: -22°F to 140°F (-30°C to 60°C)

### REMOTE POWER SUPPLIES\*, DIMMING & CONTROLS (SOLD SEPARATELY)

24VDC, Class 2 wiring

- [Pure Smart™ WiZ Pro Power Supplies & Controls](#)
- [UNI Driver: Universal Dimming \(TRIAC, ELV, 0-10V\)](#)
- [DALI/DALI-2](#)
- [Lutron Hi-Lume/Ecosystem](#)

\*In-Wall Mounting and drop ceiling Kits available for select power supplies

### APPROVALS

Class 2 Wiring up to 100 watts, Indoor Damp Location Suitable, RoHS, ETL listed.

NOMINAL LAMP DATA	ST2A					ST5A					ST7A				
WATTS PER FOOT	2.5W					4.4W					7.3W				
COLOR TEMPERATURE	24K	27K	30K	35K	40K	24K	27K	30K	35K	40K	24K	27K	30K	35K	40K
LUMENS PER FOOT (lm/ft)	284	287	299	343	362	525	531	553	634	669	811	820	854	980	1033
LUMENS PER WATT (lm/w)	114	115	120	137	145	119	121	126	144	152	111	112	117	134	142
CRI	92+	92+	92+	92+	92+	92+	92+	92+	92+	92+	92+	92+	92+	92+	92+

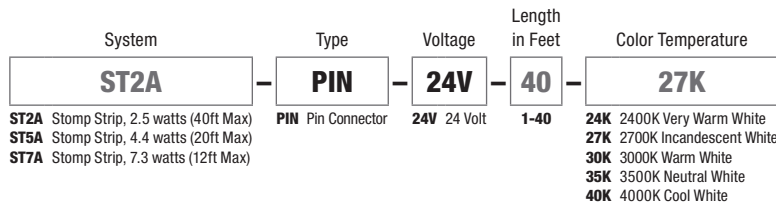

PROJECT		FIXTURE TYPE		DATE	
---------	--	--------------	--	------	--

# WARM DIM, STOMP STRIP 24VDC WITH PIN CONNECTORS

DESIGNED BY GREGORY KAY | ASSEMBLED IN AMERICA

REV 10.05.23

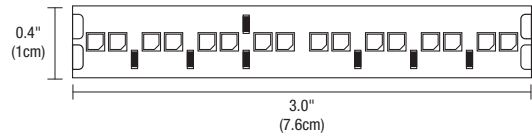
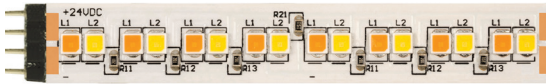

## CAN'T STOMP ME OUT

Our Low Voltage Stomp Strip is highly durable, designed to withstand the harsh elements of a job site, and precision engineered to provide superior color rendering up to 94+ CRI. Warm Dim technology (**27D** & **30D**) mimics an incandescent atmosphere by decreasing the color temperature as you dim. Our Warm Dim strips can be dimmed all the way down to a soothing amber hue at 1800K, reminiscent of candlelight along the halogen curve. Stomp Strip is used for our **DIY** (Do-it-Yourself) fixtures and systems. For custom quotes and layout assistance, send your drawings and ideas to our design team: [design@PureEdgeLighting.com](mailto:design@PureEdgeLighting.com).

## FEATURES & BENEFITS

- Offered with pin connectors reducing time and labor during installation
- Developed to meet popular demand for resilient performance without sacrificing output, color rendering and efficacy
- Tolerance: Created to resist damage in rigorous environments such as busy commercial jobsites
- Compact LED spacing: Produces uniform light distribution without visible diodes or hot spots when used within a diffused lens
- 4oz Layer of Copper Busbar: Provides superior heat dissipation and less voltage drop equivalent to 14AWG wire
- Premium Coating: Optically Clear Silicone prevents fading over time
- Mounting: Industrial 3M tape lined strip for strong, self-adhesion to most smooth, finished surfaces
- Suitable for indoor damp locations
- Warranty: Includes a 5-year pro-rated warranty

## MAXIMUM LENGTHS BEFORE RE-FEEDING

- 5WDC, 4.8 watts per foot - 20'

## LAMP

- **27D** dims from 2700K down to 1800K, and **30D** dims from 3000K down to 2000K, resembling Halogen light sources.
- Average life: 50,000 hours

## SPECIFICATIONS

- 24VDC
- 4.8 watts per foot
- Sold in 1' increments
- Field-cutable in 3" increments
- Operating temperature: -22°F to 140°F (-30°C to 60°C)

## REMOTE POWER SUPPLIES\*, DIMMING & CONTROLS (SOLD SEPARATELY)

24VDC, Class 2 wiring

- [UNI Driver: Universal Dimming \(TRIAC, ELV, 0-10V\)](#)
- [DALI/DALI-2](#)
- [Lutron Hi-Lume/Ecosystem](#)

\*In-Wall Mounting and drop ceiling Kits available for select power supplies

## MAKE IT SMART

[Pure Smart™ Wi-Fi Dimmer](#)

## APPROVALS

Class 2 Wiring up to 100 watts, Indoor Damp Location Suitable, RoHS, ETL listed.

NOMINAL LAMP DATA	ST5A	
WATTS PER FOOT	4.8W	
COLOR TEMPERATURE	27D	30D
LUMENS PER FOOT (lm/ft)	606	631
LUMENS PER WATT (lm/w)	126	131
CRI	94+	94+

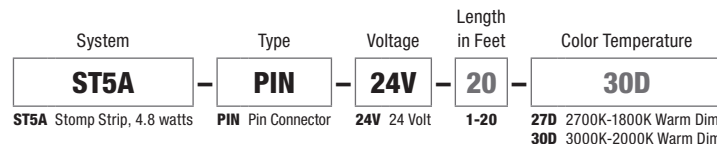

PROJECT		FIXTURE TYPE		DATE	
---------	--	--------------	--	------	--



# PRO WARM DIM, STOMP STRIP

## 24VDC WITH PIN CONNECTORS

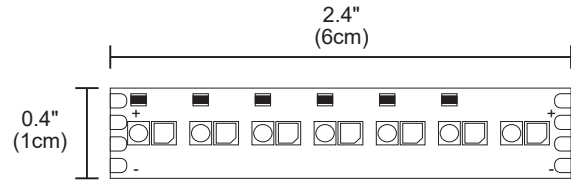
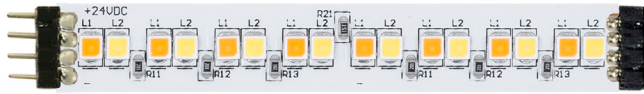

### FEATURES & BENEFITS

- Pro Dim LED Strip provides adaptable dim to warm light with 0.1% Dim to off
- High CRI LEDs, offering superior color rendering and enhanced color
- Offered in 2W, 5W, & 7W watts per foot
- The 0.4" (10mm) wide strip contains 35 LEDs per foot (7 LEDs per 2.4" Increment): Tight spacing of LEDs produce uniform light distribution without visible diodes or pixelation when used within a diffused lens
- Gold Plated Contacts: Prevent oxidation ensuring longevity of the LEDs
- 4oz Layer of Copper Busbar: Provides superior heat dissipation and less voltage drop equivalent to 14AWG wire
- Premium Coating: Optically Clear Silicone prevents fading over time
- Mounting: Industrial 3M tape lined strip for strong, self-adhesion to most smooth, finished surfaces
- Applications: Indoor, damp and dry locations
- Warranty: Includes a 5-year pro-rated warranty

### MAXIMUM LENGTHS BEFORE RE-FEEDING

- 2WDC, 2.5 watts per foot - 40'
- 5WDC, 5 watts per foot - 20'
- 7WDC, 7.5 watts per foot - 12'

### LAMP

- Available in 2700K **27KPD** (dims down to 1800K) and **3000K** (30KPD) that dims down to 2000K
- Linear Dimming Curve
- Designer Grade High CRI 92+ LEDs
- Average life: 50,000 hours

### SPECIFICATIONS

- 24VDC, 120-277VAC Input
- 2.5, 5, and 7.5 watts per foot
- Sold in 1' increments
- Field-cutable in 2.4" increments
- Operating temperature: -22°F to 140°F (-30°C to 60°C)

### REMOTE POWER SUPPLIES\*, DIMMING & CONTROLS

(SOLD SEPARATELY)

24VDC, Class 2 wiring

- [Pro Dim Power Supplies & Controls](#)

\*In-Wall Mounting Kits available for select Power Supplies

### APPROVALS

Class 2 Wiring up to 100 watts, Indoor Damp Location Suitable, RoHS, ETL listed.

NOMINAL LAMP DATA						
DESCRIPTION	ST2A KPD		ST5A KPD		ST7A KPD	
WATTS PER FOOT	2W (2.5 watts)		5W (5 watts)		7W (7.5 watts)	
COLOR TEMPERATURE	27KPD	30KPD	27KPD	30KPD	27KPD	30KPD
LUMENS PER FOOT (lm/ft)	165	173	426	451	523	548
LUMENS PER WATT (lm/w)	66	69	66	69	58	61
CRI	92+	92+	92+	92+	92+	92+

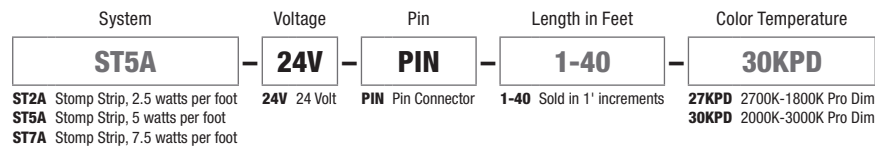

PROJECT		FIXTURE TYPE		DATE	
---------	--	--------------	--	------	--

# STOMP STRIP, TUNABLE WHITE

## 24VDC WITH PIN CONNECTORS

DESIGNED BY GREGORY KAY | ASSEMBLED IN AMERICA

REV 10.05.23

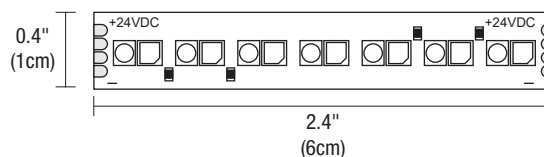

### CAN'T STOMP ME OUT

Our Low Voltage Tunable White Stomp Strip is highly durable, designed to withstand the harsh elements of a job site, and precision engineered to provide superior color rendering up to 94+ CRI. Tunable White 2000K-6500K (**2K6K**) or 2700K-6500K (**27K6**) grants independent control and adjustment of color temperature and intensity from 2000K (Sunset) through 6500K (Day Light White). Tunable white lighting visually, biologically and emotionally contributes to human interaction with the physical world. Human centric lighting (HCL) builds on this technology bringing the dynamics of natural daylight indoors, and delivering a positive effect on human health, well-being and performance. Stomp Strip is used for our **DIY** (Do-it-Yourself) fixtures and systems.

### FEATURES & BENEFITS

- Offered with pin connectors reducing time and labor during installation
- Developed to meet popular demand for resilient performance without sacrificing output, color rendering and efficacy
- Tolerance: Created to resist damage in rigorous environments such as busy commercial jobsites
- Compact LED spacing: Produces uniform light distribution without visible diodes or hot spots when used within a diffused lens
- 4oz Layer of Copper Busbar: Provides superior heat dissipation and less voltage drop equivalent to 14AWG wire
- Premium Coating: Optically Clear Silicone prevents fading over time
- Mounting: Industrial 3M tape lined strip for strong, self-adhesion to most smooth, finished surfaces
- Suitable for indoor damp locations
- Warranty: Includes a 5-year pro-rated warranty

### LAMP

- Tunable White: 2000K-6500K (**2K6K**) and 2700K-6500K (**27K6**) grants independent control for adjusting color temperature and intensity
- Average life: 50,000 hours

### SPECIFICATIONS

- 24VDC
- 2.5, 4.6, or 7.5 watts per foot
- Sold in 1' increments
- Field-cutttable in 2.4" increments
- Operating temperature: -22°F to 140°F (-30°C to 60°C)

### REMOTE POWER SUPPLIES\*, DIMMING & CONTROLS (SOLD SEPARATELY)

24VDC, Class 2 wiring

- [Pure Smart™ WiZ Pro Power Supplies & Controls](#)
- [0-10V](#): Requires two dimmers, one for intensity and one for color temperature
- [DMX Dynamic Color Changing](#)
- [Controllers](#)
- [DALI/DALI-2](#)

\*In-Wall Mounting and drop ceiling Kits available for select power supplies

### MAXIMUM LENGTHS BEFORE RE-FEEDING

- 2WDC, 2.5 watts per foot - 40'
- 5WDC, 4.6 watts per foot - 20'
- 7WDC, 7.5 watts per foot - 12'

### APPROVALS

Class 2 Wiring, Indoor Damp Location Suitable, RoHS, ETL listed.

NOMINAL LAMP DATA	ST2A 2K6K										ST5A 2K6K										ST7A 2K6K									
WATTS PER FOOT	2.5 Watts										4.6 Watts										7.5 Watts									
COLOR TEMPERATURE	20K	22K	24K	27K	30K	35K	40K	57K	65K	20K	22K	24K	27K	30K	35K	40K	57K	65K	20K	22K	24K	27K	30K	35K	40K	57K	65K			
LUMENS PER FOOT (lm/ft)	152	154	156	158	160	165	180	194	208	368	383	398	413	428	458	491	496	500	512	536	560	584	608	656	691	698	705			
LUMENS PER WATT (lm/w)	82	77	78	79	80	82	90	97	115	80	80	83	86	89	95	102	103	109	80	74	78	81	84	91	96	97	110			
CRI	91+	91+	91+	94+	93+	92+	92+	91+	91+	91+	91+	91+	94+	93+	92+	92+	91+	91+	91+	91+	91+	94+	93+	92+	92+	91+	91+			

NOMINAL LAMP DATA	ST2A 27K6								ST5A 27K6								ST7A 2K6K							
WATTS PER FOOT	2.5 Watts								4.6 Watts								7.5 Watts							
COLOR TEMPERATURE	27K	30K	35K	40K	45K	57K	65K	27K	30K	35K	40K	45K	57K	65K	27K	30K	35K	40K	45K	57K	65K			
LUMENS PER FOOT (lm/ft)	164	195	201	206	225	242	231	411	420	436	452	447	443	442	555	567	589	610	603	598	596			
LUMENS PER WATT (lm/w)	82	78	80	82	90	97	115	103	91	95	98	97	96	110	87	79	82	85	84	83	93			
CRI	94+	93+	92+	92+	92+	92+	91+	94+	93+	92+	92+	92+	92+	91+	94+	93+	92+	92+	92+	92+	91+			

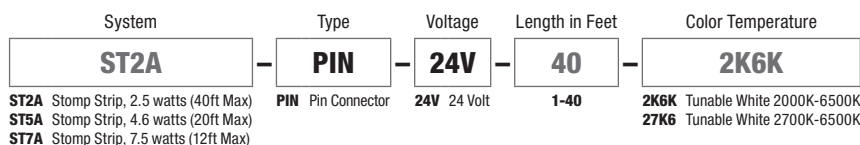

PROJECT		FIXTURE TYPE		DATE	
---------	--	--------------	--	------	--

# SOFT STRIP, RGB

## 24VDC WITH PIN CONNECTORS

DESIGNED BY GREGORY KAY | ASSEMBLED IN AMERICA

REV 10.05.23

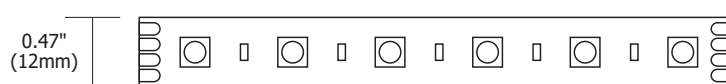

### DESCRIPTION

PureEdge RGB Soft Strip provides dynamic color effects with red, green and blue LEDs. Our color-changing LED strip provides bright, continuous light offered in two wattage options of 3 or 5 watts per foot. PureEdge's focus on chromacity quality provides a balanced output across the color gamut, allowing the creation of millions of beautiful colors. The flexible strip is sold in 1 foot increments. RGB Soft Strip can be controlled using a compatible 24 volt DC power supply with an integrated RGB DMX driver. Includes a flexible aluminum heat sink to extend LED life. Both Stomp Strip and Soft Strip are used for our **DIY** (Do-it-Yourself) fixtures and systems.

### SPECIFICATIONS

- 24VDC, Class 2
- Power Consumption: 2.6 or 5 watts per foot
- Maximum Lengths Before Re-feeding: SS3- 36', SS5- 20'
- Sold in 1' increments
- Field-cutttable in increments: SS3- 4" SS5- 2.4"
- Operating temperature: -22°F to 140°F (-30°C to 60°C)

### MAXIMUM LENGTHS BEFORE RE-FEEDING

SS3, 2.6 watts per foot - 36'  
 SS5, 5 watts per foot - 20'

### MOUNTING

Self-adhering SS6 mounts to most smooth finished surfaces with industrial strength 3M tape (provided on back of strip); some unfinished surfaces may require screw-in mounting clips **SS-MCL** (sold separately).

### LAMP

- RGB: Dynamic Red, Green, and Blue
- Wattage options: 3 or 5 watts
- 50,000 Hour Lamp Life

### ACCESSORIES (SOLD SEPARATELY)

- 24VDC Power Connectors and Jumpers
- Flexible Connectors
- Mounting Straps & Clips

### REMOTE POWER SUPPLIES\*, DIMMING & CONTROLS (SOLD SEPARATELY)

24VDC, Class 2 wiring

- [Pure Smart™ WiZ Pro Power Supplies & Controls](#)
- [DMX Dynamic Color Changing](#)
- [Controllers](#)
- [DALI/DALI-2](#)

\*In-Wall Mounting and drop ceiling Kits available for select power supplies

### APPLICATIONS

Designed for any Indoor space, including Damp locations. Ideal applications in Residential, Commercial, Retail, and Hospitality environments.

### APPROVALS

Class 2 Wiring, Indoor Damp Location Suitable, RoHS, ETL listed.

System	Voltage	Type	Length in Feet	Color Temperature
<b>SS3</b>	<b>24V</b>	<b>PIN</b>	<b>36</b>	<b>RGB</b>
SS3 Soft Strip 2.6 watts per foot (max 36')	24V 24 Volt	PIN Pin Connector	1-36 Sold in 1 ft. increments	RGB Dynamic Color Red, Green, and Blue
SS5 Soft Strip 5 watts per foot (max 20')				

PROJECT		FIXTURE TYPE		DATE	
---------	--	--------------	--	------	--

# SOFT STRIP, RGB+WHITE

## 24VDC WITH PIN CONNECTORS

DESIGNED BY GREGORY KAY | ASSEMBLED IN AMERICA

REV 10.05.23

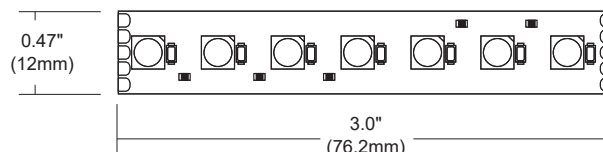

### DESCRIPTION

PureEdge's RGB+White Soft Strip (**SS6**) provides dynamic color effects with red, green, blue plus white. Now offered with four choices of White; 2000K and special order in 2700K, 3000K, and 4000K. Our color-changing LED strip provides bright, continuous light, our focus on chromacity quality provides a balanced output across the color gamut, allowing the creation of millions of beautiful colors and pure white. The flexible strip is sold in 1 foot increments up to 16 ft with cutting increments every 3 inches. At 6.3 watts per foot, RGB+W can be controlled using a compatible 24 volt DC power supply with an integrated RGB DMX driver. SS6 includes a flexible aluminum heat sink to extend LED life. Includes 5 year pro-rated warranty.

### SPECIFICATIONS

- 24VDC, Class 2
- Power Consumption: 6.3 watts per foot
- Maximum Length Before Re-feeding: 16'
- Sold in 1' increments
- Field-cutable in 3" increments
- Operating temperature: -22°F to 140°F (-30°C to 60°C)

### MOUNTING

Self-adhering SS6 mounts to most smooth finished surfaces with industrial strength 3M tape (provided on back of strip); some unfinished surfaces may require screw-in mounting clips **SS-MCL** (sold separately).

### LAMP

- RGB+W: Dynamic Red, Green, Blue plus 2000K White
- Special order in 2700K, 3000K, and 4000K
- 50,000 Hour Lamp Life

### REMOTE POWER SUPPLIES\*, DIMMING & CONTROLS (SOLD SEPARATELY)

24VDC, CLASS 2 WIRING

- [Pure Smart™ WiZ Pro Power Supplies & Controls](#)
- [DMX Dynamic Color Changing](#)
- [Controllers](#)
- [DALI/DALI-2](#)

\*In-Wall Mounting and drop ceiling Kits available for select power supplies

### ACCESSORIES (SOLD SEPARATELY)

- 24VDC Power Connectors and Jumpers
- Flexible Connectors
- Mounting Straps & Clips

### APPLICATIONS

Designed for any Indoor space, including Damp locations. Ideal applications in Residential, Commercial, Retail, and Hospitality environments.

### APPROVALS

Class 2 Wiring, Indoor Damp Location Suitable, RoHS, ETL listed.

System	Voltage	Type	Length in Feet	Color Temperature
<b>SS6</b>	<b>24V</b>	<b>PIN</b>	<b>16</b>	<b>RGB20K</b>
SS6 Soft Strip 6.3 watts per foot	24V 24 Volt	PIN Pin Connector	1-16 Sold in 1 ft. increments	<b>RGB20K</b> Red, Green, Blue + White 2000K <b>RGB27K</b> Red, Green, Blue + White 2700K <b>Special Order</b> <b>RGB30K</b> Red, Green, Blue + White 3000K <b>Special Order</b> <b>RGB40K</b> Red, Green, Blue + White 4000K <b>Special Order</b>

PROJECT		FIXTURE TYPE		DATE	
---------	--	--------------	--	------	--

# TRUCOLOR™ RGB & TUNABLE WHITE LED STRIP

24VDC, 5 CHANNEL CONTROL, WITH PIN CONNECTORS

DESIGNED BY GREGORY KAY | ASSEMBLED IN AMERICA | PATENT PENDING

REV 10.05.23

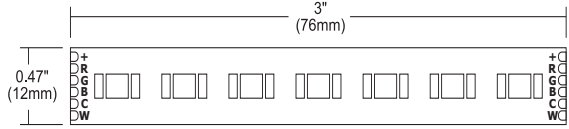

## DESCRIPTION

PureEdge Pure Smart **TruColor™** technology uses five channels of tunable LEDs, composed of **RGBTW** red, blue, green, and Tunable White (**1500K-6500K**). With our precision-engineered, proprietary color mixing, we produce one of the widest, most accurate spectrums available, giving our customers access to the warm glow of the sunset (1500K-2400K golden hour) to the pure white light of the mid-day sun (5700K) and everything in between. **TruColor™** LED's achieve an average CRI-Color Rendering Index of 94+ and a Duv of +-0.0021 in relation to the blackbody curve at any point on the spectrum of tunable white CCT. Dynamic Color Changing functionality provides millions of possibilities for intricate customization, rich saturated or secondary colors, and unprecedented ease of installation, making **RGBTW** the ideal choice for residential and commercial applications. **TruColor™ RGBTW** adds more than just decorative flexibility; it also helps to support a healthy Circadian Rhythm and well-being. Let **TruColor™** transform your space and the people within it. 24VDC Remote Power Supplies required.

## FEATURES & BENEFITS

- State-of-the-Art **TruColor™** (1500K-6500K) spectrum offers dynamic effects with RGB and Tunable White
- Optimized for use with WiZ Pro wire control ecosystem and Pure Smart Wi-Fi Room Controller. DMX control are also available.
- Offered with pin connectors reducing time and labor during installation
- Dims from full brightness down to 5%, and tuned anywhere from 1500K to 6500K.
- Developed to meet popular demand for resilient performance without sacrificing output, color rendering, CCT range, spectrum accuracy, or efficacy.
- Tolerance: Created to resist damage in rigorous environments such as busy commercial jobsites
- Compact LED spacing: Produces uniform light distribution without visible diodes or hot spots when used within a diffused lens
- Three 1oz Layers of Copper Busbar per foot provides superior heat dissipation and less voltage drop equivalent to 14AWG wire
- Premium Coating: Optically Clear Silicone prevents fading over time
- Mounting: Industrial 3M tape lined strip for strong, self-adhesion to most smooth, finished surfaces
- Warranty: Includes a 5-year pro-rated warranty

## LAMP PERFORMANCE

- **TruColor™ RGBTW** Red, Green, and Blue with Tunable White (**1500K-6500K**)
- Average life: 50,000 hours

## AVERAGE PERFORMANCE 2000K-5500K

- Average CRI: 97+
- Average DUV: +-0.0002
- Average R9: 91, Rg: 102, Rf: 93

## SPECIFICATIONS

- 24VDC
- S5W5: 5W RGB & 5W Tunable White (WiZ: 5 watts total)
- S5W7: 5W RGB & 7W Tunable White (WiZ: 7 watts total)
- Sold in 1' increments
- Field-cutable in 3" increments
- Operating temperature: -22°F to 140°F (-30°C to 60°C)

## MAXIMUM LENGTHS BEFORE RE-FEEDING

- S5W5 – Pure Smart™ WiZ Pro: 20ft
- S5W7 – Pure Smart™ WiZ Pro: 12ft

## REMOTE POWER SUPPLIES, DIMMERS & CONTROLS (SOLD SEPARATELY)

24VDC, Class 2 wiring

- [Pure Smart™ WiZ Pro PSBR Power Supplies](#)

Pure Smart™ PSBR Power Supply for Remote Bridgebox is developed to support Pure Smart TC TruColor RGBTW luminaires connected by WiZ Pro.

- [Pure Smart™ Wi-Fi Controller](#)

Features ON/OFF buttons, CCT and brightness control as well as four preset/custom scenes programmable in the WiZ app. Communicates via 2.4GHz Wi-Fi. No Hub needed. Voice control with Google Assistant, Alexa, Siri, Shortcuts, and IFTTT

## APPLICATIONS

Designed for indoor use only. Ideal applications for residential, commercial, hospitality environments, and general human centric lighting.

## APPROVALS

Class 2 Wiring up to 100 watts, Indoor Damp Location, ETL listed, RoHS.

NOMINAL LAMP DATA																			
WATTS PER FOOT	S5W5 5W RGB & 5W TUNABLE WHITE										S5W7 5W RGB & 7W TUNABLE WHITE								
COLOR TEMPERATURE	20K	22K	24K	27K	30K	35K	40K	57K	65K	20K	22K	24K	27K	30K	35K	40K	57K	65K	
LUMENS PER FOOT (lm/ft)	171	256	311	349	360	380	410	288	265	211	352	452	513	526	554	543	319	289	
LUMENS PER WATT (lm/w)	63	56	71	82	85	87	98	98	111	63	91	73	86	86	90	93	92	96	
CRI	91+	93+	94+	94+	95+	96+	97+	92+	89+	93+	95+	96+	97+	97+	98+	97+	95+	92+	
Duv	-0.004	-0.0012	-0.0034	-0.0058	-0.0055	-0.0033	-0.0014	-0.0049	-0.0063	-0.003	0.0002	0.003	0.003	0.003	0.0009	0	0.003	0.003	
Rf	91	93	94	94	95	94	94	92	90	92	93	95	95	95	95	94	92	91	
Rg	105	101	103	105	104	102	100	102	103	104	100	102	103	103	101	100	102	103	
R9	90	90	90	94	97	97	91	81	70	91	90	90	94	95	93	93	79	67	
R13	92	94	95	95	94	96	99	90	87	92	95	96	96	97	99	99	91	88	
R15	99	99	99	98	97	97	97	89	85	99	99	99	99	99	98	97	90	85	
WIZ PRO WATTS/FOOT	2.7	4.55	4.35	4.25	4.25	4.35	4.2	2.95	2.4	3.35	3.85	6.15	5.95	6.15	6.15	5.84	3.45	3	

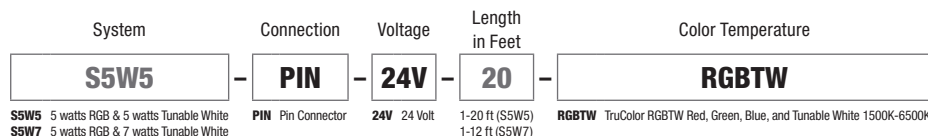

PROJECT	FIXTURE TYPE	DATE
---------	--------------	------



# TRUCOLOR™ RGB & TUNABLE WHITE LED STRIP

24VDC, 5 CHANNEL CONTROL

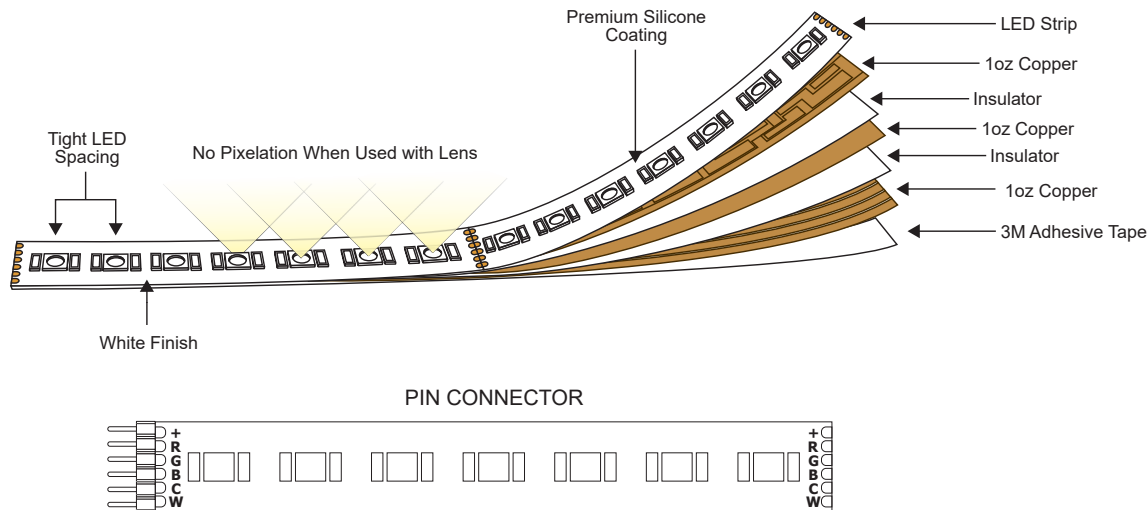

S5W5 WATTS PER FOOT			
LENGTH IN FEET	RGB Wattage	Tunable White Wattage	Pure Smart™ WiZ Pro Wattage
1	5	5	5
2	10	10	10
3	15	15	15
4	20	20	20
5	25	25	25
6	30	30	30
7	35	35	35
8	40	40	40
9	45	45	45
10	50	50	50
11	55	55	55
12	60	60	60
13	65	65	65
14	70	70	70
15	75	75	75
16	80	80	80
17	85	85	85
18	90	90	90
19	95	95	95
20	100	100	100

S5W7 WATTS PER FOOT			
LENGTH IN FEET	RGB Wattage	Tunable White Wattage	Pure Smart™ WiZ Pro Wattage
1	5	7	7
2	10	14	14
3	15	21	21
4	20	28	28
5	25	35	35
6	30	42	42
7	35	49	49
8	40	56	56
9	45	63	63
10	50	70	70
11	55	77	77
12	60	84	84

PROJECT		FIXTURE TYPE		DATE	
---------	--	--------------	--	------	--

# SOFT STRIP, MONOCHROMATIC COLOR

## 24VDC WITH PIN CONNECTORS

DESIGNED BY GREGORY KAY | ASSEMBLED IN AMERICA | PATENT PENDING

REV 10.05.23



RRR - Red



BBB - Blue

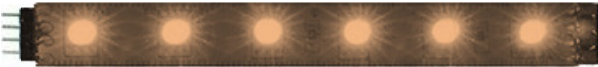

AAA - Amber

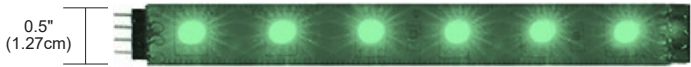

GGG - Green

4"  
(10.16cm)

### DESCRIPTION

PureEdge Monochromatic Color Soft Strip provides dynamic color effects with monochromatic color LEDs. Offered in Red, Amber, Blue, and Green. The 1/2" wide flexible copper strip, with an optically clear protective coating, is sold in 1ft increments up to 36 ft with cutting increments every 4 inches. Self-adhering, our strip mounts to most smooth finished surfaces with the industrial strength 3M tape on the back. Our Soft Strip is used for our **DIY** (Do-it-Yourself) fixtures and systems. Includes 5 year warranty.

### SPECIFICATIONS

- 24VDC, Class 2
- Power Consumption: 2.6 or 5 watts per foot
- Sold in 1' increments
- Field-cutttable in 4" increments
- Operating temperature: -22°F to 140°F (-30°C to 60°C)

### MOUNTING

Industrial 3M tape lines back of strip for self-adhesion to most smooth finished surfaces Additional Connectors, Mounting Straps, and Clips may be needed for some applications (sold separately).

### ACCESSORIES (SOLD SEPARATELY)

- 24VDC Power Connectors and Jumpers
- Flexible Connectors
- Mounting Straps & Clips

### LAMP

- Monochromatic Red, Amber, Blue, and Green
- 18 LEDs per foot
- 50,000 Hour Lamp Life

### MAXIMUM LENGTHS BEFORE RE-FEEDING

- 3WDC, 2.6 watts per foot - 36'
- 5WDC, 5 watts per foot - 20'

### REMOTE POWER SUPPLIES\*, DIMMING & CONTROLS (SOLD SEPARATELY)

24VDC, Class 2 wiring

- [Pure Smart™ WiZ Pro Power Supplies & Controls](#)
- [UNI Driver: Universal Dimming \(TRIAC, ELV, 0-10V\)](#)
- [Lutron Hi-Lume/Ecosystem](#)
- [DALI/ DALI 2](#)

\*In-Wall Mounting Kits available for select power supplies

### APPLICATIONS

Indoor and damp locations. Applications include coves, toe-kicks, under cabinets and shelving, bookcases, drawers, pathways, accent lighting, task lighting, and general illumination.

### APPROVALS

Class 2 Wiring up to 100 watts, Indoor Damp Location Suitable, RoHS, ETL listed.

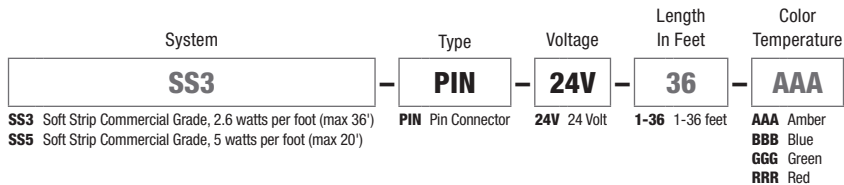

PROJECT		FIXTURE TYPE		DATE	
---------	--	--------------	--	------	--

# TM30 DATA

## 24VDC WITH PINS & SOLDERED LEADS

**TM-30-15 DATA:** The data below is for bare LED Static White Strip. Consistent color temperatures throughout a single strip and among multiple strips is possible through a 3 phase binning process in which each order is inspected with a color meter to ensure uniformity.

**2400K** | Rf: 84.5 | Rg: 94.4

Color Vector Graphic

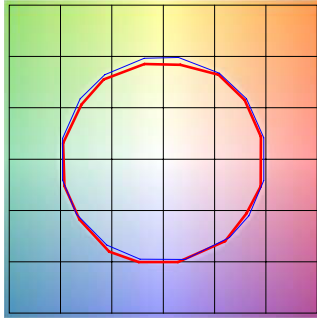

■ Test ■ Reference

HUE BIN	Rf	GRAPHIC SHIFTS %	
		CHROMA	HUE
1	92	-2.4%	1.5%
2	94.7	-2.1%	-0.0%
3	95.4	-1.9%	-0.1%
4	88.7	-6.7%	-3.1%
5	92.8	-5.6%	1.0%
6	92.7	-3.4%	3.4%
7	89.9	-4.3%	4.1%
8	92.4	-1.4%	4.4%
9	89	-0.6%	5.8%
10	88.9	0.4%	6.2%
11	89.7	4.0%	5.4%
12	92.6	3.0%	-0.7%
13	90.9	1.1%	-7.0%
14	89.9	0.5%	-5.8%
15	92.1	-3.2%	0.1%
16	88.9	-1.7%	-6.3%

**2700K** | Rf: 87.7 | Rg: 96.1

Color Vector Graphic

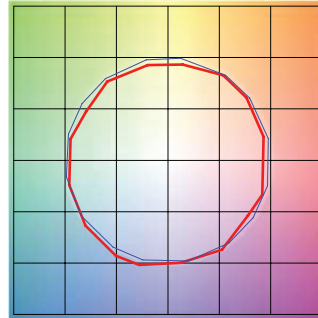

■ Test ■ Reference

HUE BIN	Rf	GRAPHIC SHIFTS %	
		CHROMA	HUE
1	88.0	-4.3%	2.6%
2	91.6	-2.4%	2.0%
3	93.7	-1.4%	1.9%
4	88.9	-5.6%	-3.1%
5	92.3	-5.5%	-0.5%
6	92.9	-3.5%	0.1%
7	84.5	-7.5%	4.6%
8	90.8	-3.0%	4.4%
9	84.5	-1.3%	8.3%
10	83.9	2.0%	9.8%
11	87.2	5.3%	7.1%
12	89.2	5.4%	-2.6%
13	88.7	0.3%	-7.8%
14	86.8	1.7%	-9.3%
15	87.6	-5.4%	-1.3%
16	83.6	-3.3%	-9.5%

**3000K** | Rf: 88.1 | Rg: 99.7

Color Vector Graphic

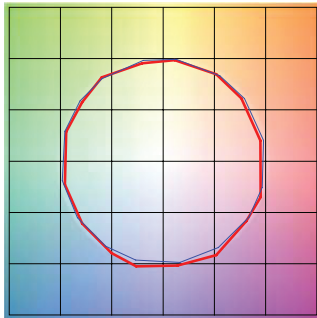

■ Test ■ Reference

HUE BIN	Rf	GRAPHIC SHIFTS %	
		CHROMA	HUE
1	92.5	-3.1%	0.3%
2	93.3	-2.3%	1.9%
3	90.9	-0.8%	3.9%
4	94.3	-1.1%	1.4%
5	92.5	-2.6%	1.5%
6	96.4	1.2%	-0.3%
7	92.6	-2.5%	-0.0%
8	96.9	-1.4%	0.2%
9	92.3	-1.8%	4.3%
10	86.6	-0.7%	7.0%
11	86.5	2.4%	8.2%
12	89.8	5.9%	1.7%
13	93.9	2.6%	-2.7%
14	89.4	5.1%	-5.8%
15	90.1	-0.1%	-4.7%
16	86.5	0.3%	-9.7%

**3500K** | Rf: 86.1 | Rg: 95.5

Color Vector Graphic

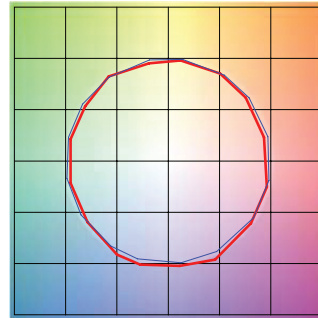

■ Test ■ Reference

HUE BIN	Rf	GRAPHIC SHIFTS %	
		CHROMA	HUE
1	90.8	-3.8%	0.3%
2	92.3	-2.8%	2.1%
3	89.7	-1.0%	4.3%
4	92.6	-1.4%	1.7%
5	91.8	-3.1%	1.3%
6	96.2	0.8%	-0.4%
7	92.9	-3.2%	0.2%
8	94.3	-2.5%	1.5%
9	90.4	-2.5%	5.2%
10	84.3	-1.4%	9.5%
11	83.1	3.5%	9.8%
12	88.2	4.8%	3.4%
13	94.0	2.7%	-2.0%
14	88.7	5.9%	-5.8%
15	88.7	0.7%	-5.9%
16	86.8	-0.7%	-6.7%

**4000K** | Rf: 87.6 | Rg: 96.8

Color Vector Graphic

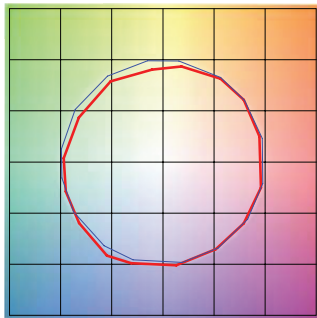

■ Test ■ Reference

HUE BIN	Rf	GRAPHIC SHIFTS %	
		CHROMA	HUE
1	88.9	-2.4%	2.5%
2	93.3	-0.4%	0.8%
3	94.8	-1.0%	-0.6%
4	87.9	-4.9%	-3.6%
5	85.3	-9.4%	-2.6%
6	90.2	-6.0%	0.2%
7	85.3	-7.6%	4.6%
8	83.7	-4.1%	8.2%
9	79.5	-1.1%	13.8%
10	78.6	1.5%	12.1%
11	83.5	6.4%	7.8%
12	90.9	3.6%	-1.1%
13	88.3	1.7%	-6.3%
14	91.9	-0.4%	-2.2%
15	84.5	-0.9%	-5.5%
16	84.7	-1.1%	-4.4%

PROJECT		FIXTURE TYPE		DATE	
---------	--	--------------	--	------	--

# TRULINE .5A DIY

## DO-IT-YOURSELF PLASTER-IN LED SYSTEM

### LENGTH LOAD CHARTS

2.5 WATTS PER FOOT							
LENGTH IN FEET	WATTS	LENGTH IN FEET	WATTS	LENGTH IN FEET	WATTS	LENGTH IN FEET	WATTS
1	3	11	27	21	51	31	75
2	5	12	29	22	54	32	78
3	8	13	32	23	56	33	80
4	10	14	34	24	58	34	82
5	13	15	37	25	61	35	85
6	15	16	39	26	63	36	87
7	17	17	41	27	66	37	90
8	20	18	44	28	68	38	92
9	22	19	46	29	70	39	94
10	24	20	48	30	72	40	96

5 WATTS PER FOOT							
LENGTH IN FEET	WATTS	LENGTH IN FEET	WATTS	LENGTH IN FEET	WATTS	LENGTH IN FEET	WATTS
1	5	6	30	11	54	16	78
2	10	7	34	12	58	17	82
3	16	8	40	13	64	18	88
4	20	9	44	14	68	19	92
5	24	10	48	15	72	20	96

6 WATTS PER FOOT							
LENGTH IN FEET	WATTS	LENGTH IN FEET	WATTS	LENGTH IN FEET	WATTS	LENGTH IN FEET	WATTS
1	6	5	30	9	54	13	78
2	12	6	36	10	60	14	84
3	18	7	42	11	66	15	90
4	24	8	48	12	72	16	96

7 WATTS PER FOOT							
LENGTH IN FEET	WATTS	LENGTH IN FEET	WATTS	LENGTH IN FEET	WATTS	LENGTH IN FEET	WATTS
1	7.5	4	30	7	52.5	10	75
2	15	5	37.5	8	60	11	82.5
3	22.5	6	45	9	67.5	12	90

PROJECT		FIXTURE TYPE		DATE	
---------	--	--------------	--	------	--

# LED STRIP TM30 DATA

## DO-IT-YOURSELF PLASTER-IN LED SYSTEM

**TM-30-15 DATA:** The data below is for bare LED Static White Strip. Consistent color temperatures throughout a single strip and among multiple strips is possible through a 3 phase binning process in which each order is inspected with a color meter to ensure uniformity.

**2400K** | Rf: 84.5 | Rg: 94.4

Color Vector Graphic

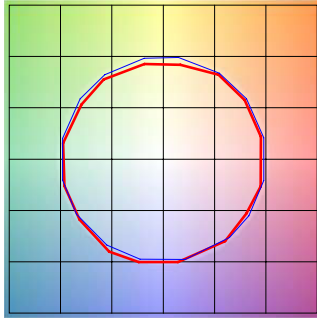

■ Test ■ Reference

HUE BIN	Rf	GRAPHIC SHIFTS %	
		CHROMA	HUE
1	92	-2.4%	1.5%
2	94.7	-2.1%	-0.0%
3	95.4	-1.9%	-0.1%
4	88.7	-6.7%	-3.1%
5	92.8	-5.6%	1.0%
6	92.7	-3.4%	3.4%
7	89.9	-4.3%	4.1%
8	92.4	-1.4%	4.4%
9	89	-0.6%	5.8%
10	88.9	0.4%	6.2%
11	89.7	4.0%	5.4%
12	92.6	3.0%	-0.7%
13	90.9	1.1%	-7.0%
14	89.9	0.5%	-5.8%
15	92.1	-3.2%	0.1%
16	88.9	-1.7%	-6.3%

**2700K** | Rf: 87.7 | Rg: 96.1

Color Vector Graphic

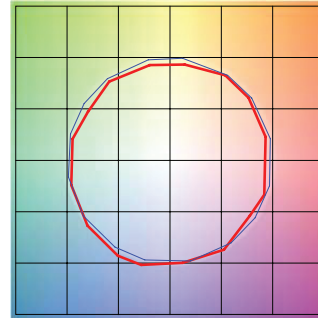

■ Test ■ Reference

HUE BIN	Rf	GRAPHIC SHIFTS %	
		CHROMA	HUE
1	88.0	-4.3%	2.6%
2	91.6	-2.4%	2.0%
3	93.7	-1.4%	1.9%
4	88.9	-5.6%	-3.1%
5	92.3	-5.5%	-0.5%
6	92.9	-3.5%	0.1%
7	84.5	-7.5%	4.6%
8	90.8	-3.0%	4.4%
9	84.5	-1.3%	8.3%
10	83.9	2.0%	9.8%
11	87.2	5.3%	7.1%
12	89.2	5.4%	-2.6%
13	88.7	0.3%	-7.8%
14	86.8	1.7%	-9.3%
15	87.6	-5.4%	-1.3%
16	83.6	-3.3%	-9.5%

**3000K** | Rf: 88.1 | Rg: 99.7

Color Vector Graphic

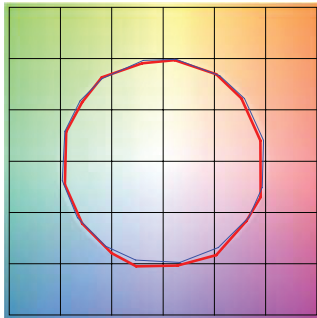

■ Test ■ Reference

HUE BIN	Rf	GRAPHIC SHIFTS %	
		CHROMA	HUE
1	92.5	-3.1%	0.3%
2	93.3	-2.3%	1.9%
3	90.9	-0.8%	3.9%
4	94.3	-1.1%	1.4%
5	92.5	-2.6%	1.5%
6	96.4	1.2%	-0.3%
7	92.6	-2.5%	-0.0%
8	96.9	-1.4%	0.2%
9	92.3	-1.8%	4.3%
10	86.6	-0.7%	7.0%
11	86.5	2.4%	8.2%
12	89.8	5.9%	1.7%
13	93.9	2.6%	-2.7%
14	89.4	5.1%	-5.8%
15	90.1	-0.1%	-4.7%
16	86.5	0.3%	-9.7%

**3500K** | Rf: 86.1 | Rg: 95.5

Color Vector Graphic

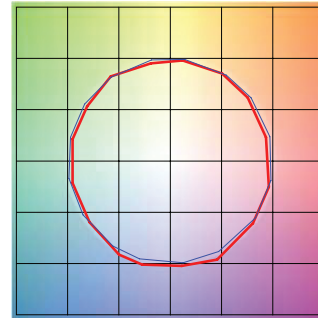

■ Test ■ Reference

HUE BIN	Rf	GRAPHIC SHIFTS %	
		CHROMA	HUE
1	90.8	-3.8%	0.3%
2	92.3	-2.8%	2.1%
3	89.7	-1.0%	4.3%
4	92.6	-1.4%	1.7%
5	91.8	-3.1%	1.3%
6	96.2	0.8%	-0.4%
7	92.9	-3.2%	0.2%
8	94.3	-2.5%	1.5%
9	90.4	-2.5%	5.2%
10	84.3	-1.4%	9.5%
11	83.1	3.5%	9.8%
12	88.2	4.8%	3.4%
13	94.0	2.7%	-2.0%
14	88.7	5.9%	-5.8%
15	88.7	0.7%	-5.9%
16	86.8	-0.7%	-6.7%

**4000K** | Rf: 87.6 | Rg: 96.8

Color Vector Graphic

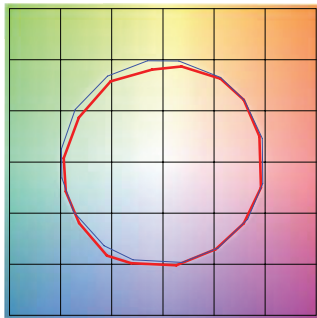

■ Test ■ Reference

HUE BIN	Rf	GRAPHIC SHIFTS %	
		CHROMA	HUE
1	88.9	-2.4%	2.5%
2	93.3	-0.4%	0.8%
3	94.8	-1.0%	-0.6%
4	87.9	-4.9%	-3.6%
5	85.3	-9.4%	-2.6%
6	90.2	-6.0%	0.2%
7	85.3	-7.6%	4.6%
8	83.7	-4.1%	8.2%
9	79.5	-1.1%	13.8%
10	78.6	1.5%	12.1%
11	83.5	6.4%	7.8%
12	90.9	3.6%	-1.1%
13	88.3	1.7%	-6.3%
14	91.9	-0.4%	-2.2%
15	84.5	-0.9%	-5.5%
16	84.7	-1.1%	-4.4%

PROJECT		FIXTURE TYPE		DATE	
---------	--	--------------	--	------	--



LED STRIP TM30 DATA
DO-IT-YOURSELF PLASTER-IN LED SYSTEM

TM-30-15 DATA: The data below is for bare LED Warm Dim Strip. Consistent color temperatures throughout a single strip and among multiple strips is possible through a 3 phase binning process in which each order is inspected with a color meter to ensure uniformity.

2700D | Rf: 90.7 | Rg: 101.1
Color Vector Graphic

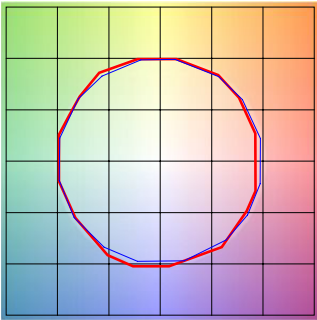

Test Reference

Table with 4 columns: Hue Bin, Rf, Chroma, Hue. Rows 1-16 showing color shift data for 2700D.

3000D | Rf: 90.6 | Rg: 101.1
Color Vector Graphic

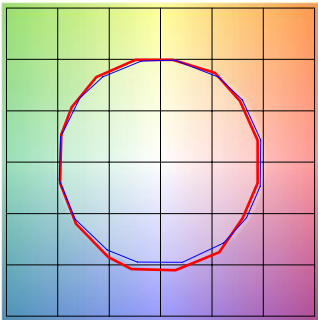

Test Reference

Table with 4 columns: Hue Bin, Rf, Chroma, Hue. Rows 1-16 showing color shift data for 3000D.

LED STRIP TM30 DATA

DO-IT-YOURSELF PLASTER-IN LED SYSTEM

**TM-30-15 DATA:** The data below is for Pro Dim bare LED Strips. Consistent color temperatures throughout a single strip and among multiple strips is possible through a 3 phase binning process in which each order is inspected with a color meter to ensure uniformity.

2000K ONLY (30KPD)

View Angle: 2 Deg

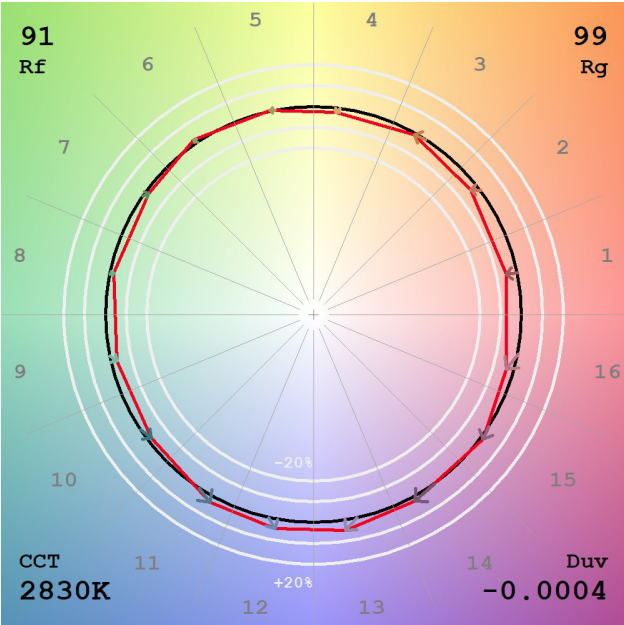

3000K ONLY (30KPD)

View Angle: 2 Deg

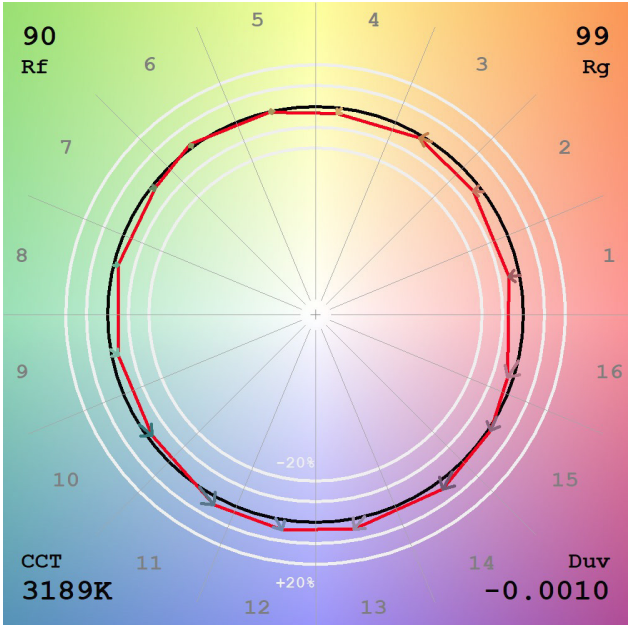

PROJECT		FIXTURE TYPE		DATE	
---------	--	--------------	--	------	--

# LED STRIP TM30 DATA

## DO-IT-YOURSELF PLASTER-IN LED SYSTEM

**TM-30-15 DATA:** The data below is for Tunable White bare LED Strip. Consistent color temperatures throughout a single strip and among multiple strips is possible through a 3 phase binning process in which each order is inspected with a color meter to ensure uniformity.

### 2000K ONLY (2K6K/27K6) | Rf: 90.6 | Rg: 98.5

Color Vector Graphic

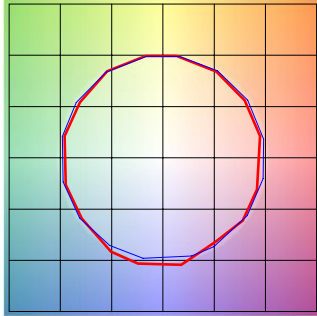

■ Test ■ Reference

		GRAPHIC SHIFTS %	
HUE BIN	Rf	CHROMA	HUE
1	87.7	-5.5%	1.2%
2	88.7	-3.9%	4.2%
3	90.5	-1.5%	4.3%
4	95.0	-1.7%	0.8%
5	95.2	-0.2%	2.1%
6	94.2	1.6%	1.9%
7	95.9	-0.8%	-2.2%
8	95.5	-1.7%	1.3%
9	93.8	-1.4	2.6%
10	91.9	-0.7%	4.2%
11	91.3	3.6%	3.7%
12	91.2	4.2%	-1.0%
13	86.6	3.8%	-12.7%
14	67.2	-3.0%	-16.3%
15	84.9	-3.3%	-9.4%
16	84.2	-5.7%	-7.5%

### 3000K (2K6K/27K6) | Rf: 90.5 | Rg: 100.7

Color Vector Graphic

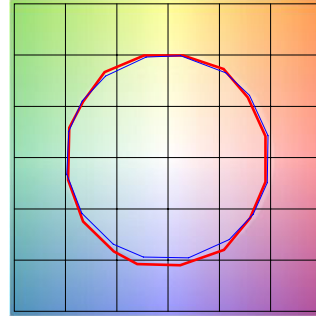

■ Test ■ Reference

		GRAPHIC SHIFTS %	
HUE BIN	Rf	CHROMA	HUE
1	91.5	-3.5%	1.2%
2	92.4	-1.8%	2.7%
3	89.8	0.3%	4.5%
4	92.4	-1.7%	0.4%
5	93.3	-0.1%	1.4%
6	94.5	2.1%	-0.6%
7	91.0	-2.5%	0.3%
8	96.9	-0.8%	-0.2%
9	91.6	-0.9%	4.6%
10	86.7	0.7%	7.8%
11	86.3	3.8%	8.5%
12	88.3	6.1%	0.6%
13	90.9	3.1%	-5.2%
14	87.3	4.7%	-7.9%
15	92.1	-1.9%	-2.5%
16	84.5	-0.9%	-10.9%

### 4000K ONLY (2K6K/27K6) | Rf: 86.4 | Rg: 96.1

Color Vector Graphic

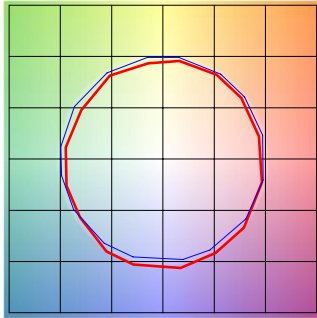

■ Test ■ Reference

		GRAPHIC SHIFTS %	
HUE BIN	Rf	CHROMA	HUE
1	86.5	-5.5%	1.3%
2	90.4	-3.0%	2.3%
3	89.8	-2.1%	3.6%
4	89.1	-3.4%	0.4%
5	88.5	-5.9%	0.1%
6	93.6	-3.0%	-0.4%
7	88.9	-6.2%	1.7%
8	87.3	-5.0%	4.9%
9	82.4	-3.6%	11.3%
10	77.4	-1.8%	12.7%
11	79.8	4.9%	11.4%
12	88.7	4.4%	2.7%
13	88.7	4.0%	-5.1%
14	91.2	2.2%	-3.8%
15	82.7	-0.1%	-9.2%
16	82.8	-2.2%	-7.6%

PROJECT		FIXTURE TYPE		DATE	
---------	--	--------------	--	------	--

# LED STRIP TM30 DATA

## DO-IT-YOURSELF PLASTER-IN LED SYSTEM

**TM-30-15 DATA:** The data below is for TruColor™ RGBTW (S5W7) bare LED Strips. Consistent color temperatures throughout a single strip and among multiple strips is possible through a 3 phase binning process in which each order is inspected with a color meter to ensure uniformity.

2000K (TruColor™ RGBTW)

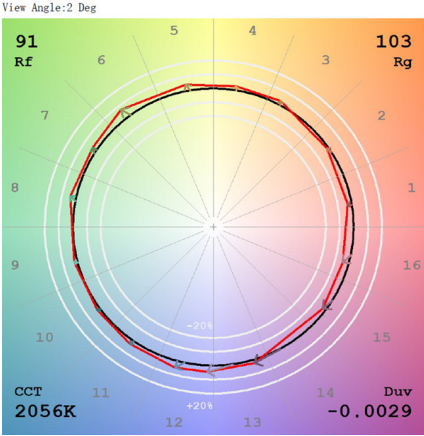

2200K (TruColor™ RGBTW)

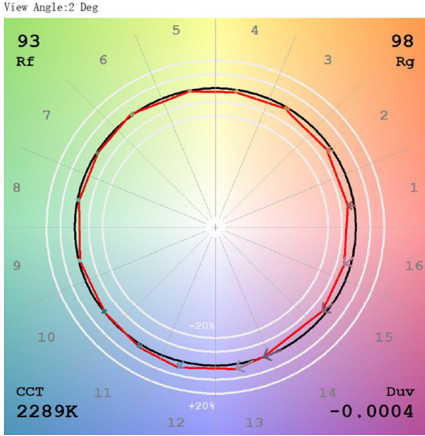

2400K (TruColor™ RGBTW)

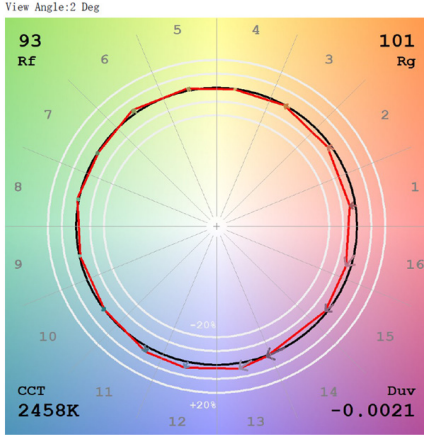

2700K (TruColor™ RGBTW)

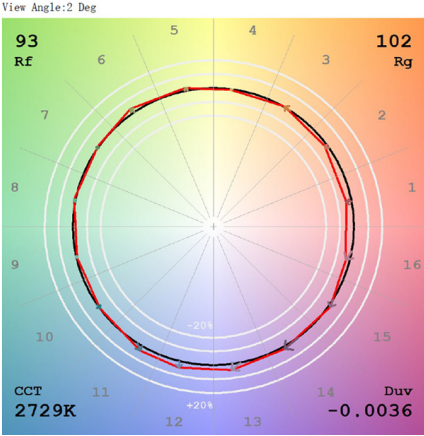

3000K (TruColor™ RGBTW)

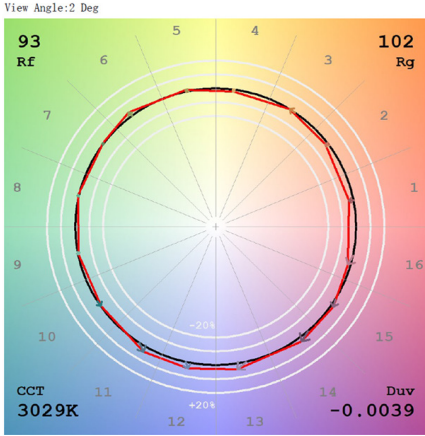

3500K (TruColor™ RGBTW)

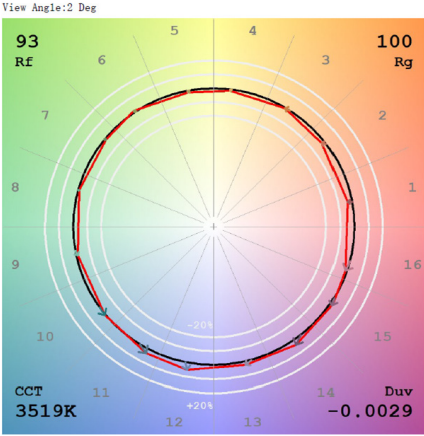

4000K (TruColor™ RGBTW)

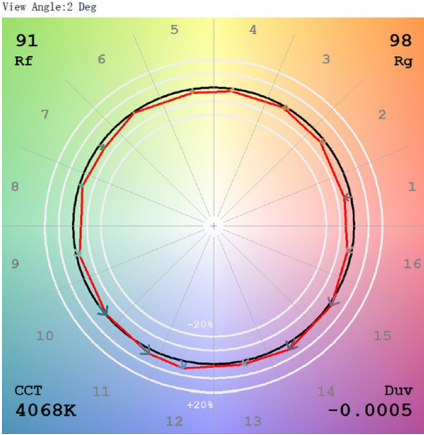

5700K (TruColor™ RGBTW)

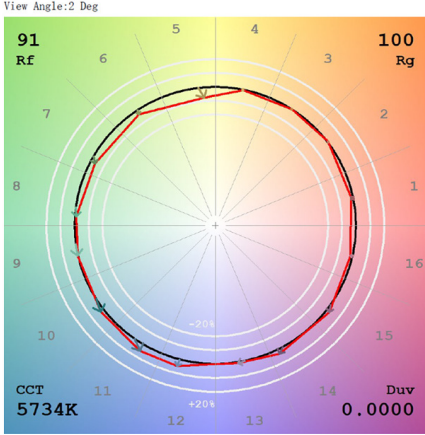

6500K (TruColor™ RGBTW)

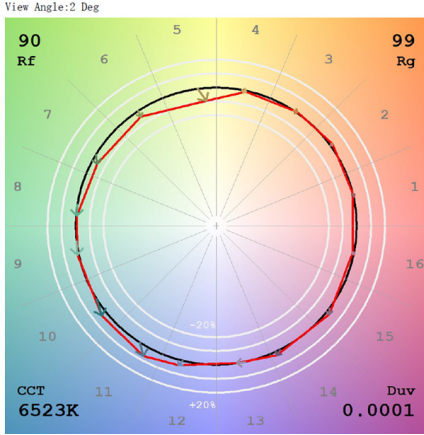

PROJECT		FIXTURE TYPE		DATE	
---------	--	--------------	--	------	--