

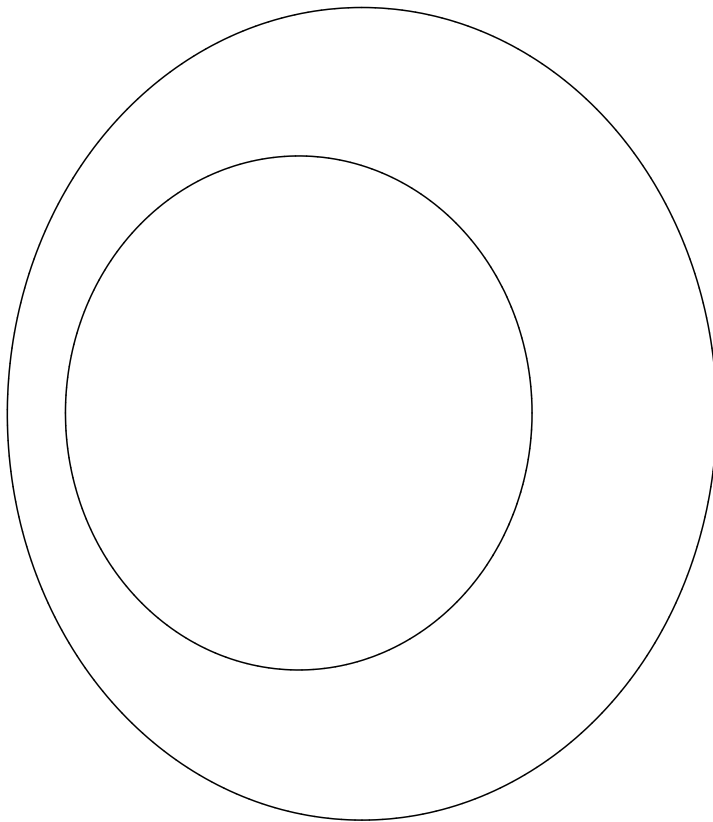

# Topo Disc

18704 rA

Low Voltage Input



## CAUTION:

Before starting, turn off power at main circuit panel.

## ADVERTENCIA:

Antes de comenzar la instalación, apague la corriente en el tablero principal.

## ATTENTION:

Coupez l'alimentation avant de proceder à l'installation.



Calling for backup? Scan above to contact our team.

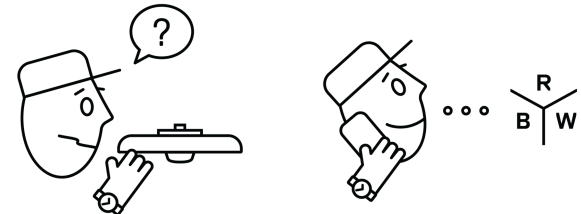

[www.RBW.com](http://www.RBW.com)  
+1 212 388 0399  
[support@RBW.com](mailto:support@RBW.com)  
© 2023, RBW Studio LLC

What's Included: Part Configurations May Vary

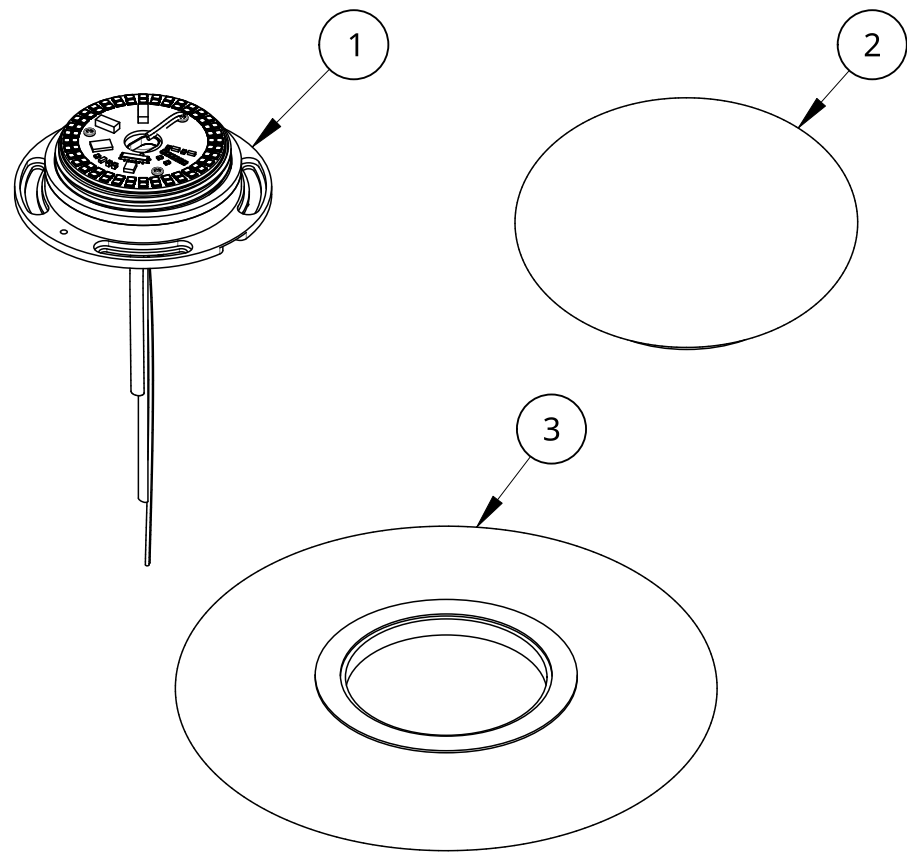

| Item | Qty | Part number | Description  |
|------|-----|-------------|--|
| 1    | 1   | 18719-27    | Package: Topo Module.<br>Standard DC LED. 2700K<br>CCT |
| 2    | 1   | 18468       | Package: Elliptical Glass<br>Globe. Small              |
| 3    | 1   | 18588       | Package: Topo Disc. Small                              |

What's Included: Part Configurations May Vary

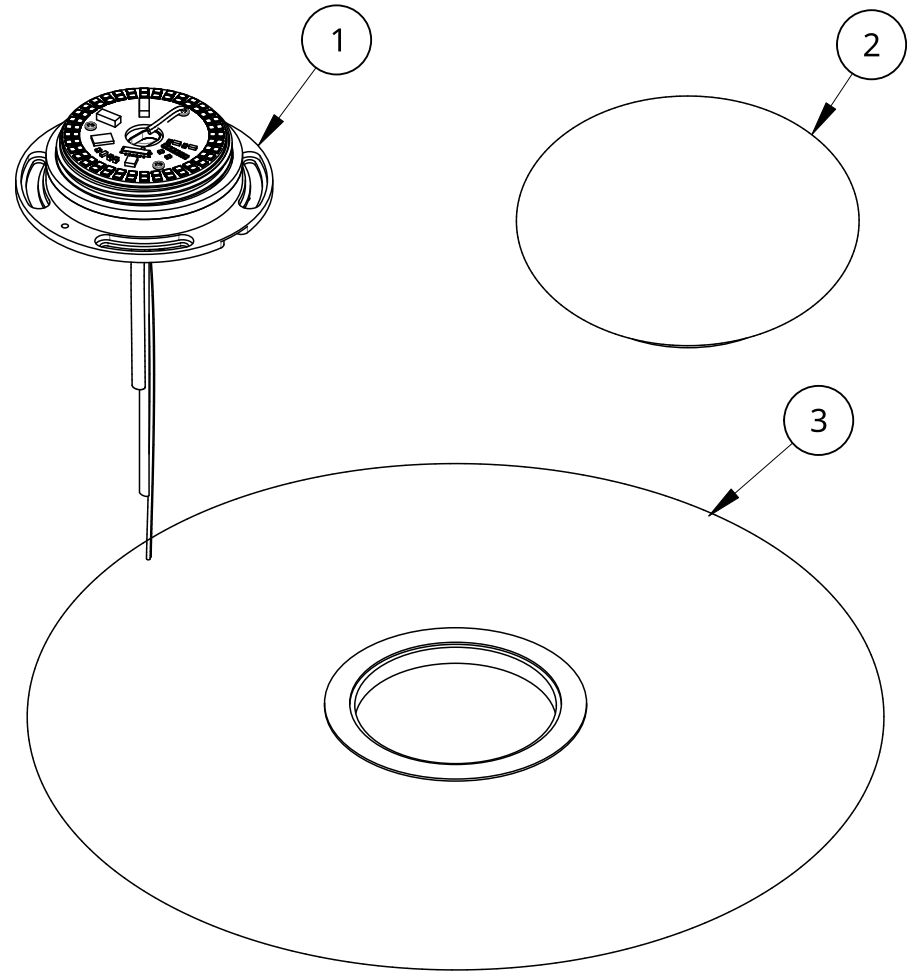

| Item | Qty | Part number | Description  |
|------|-----|-------------|--|
| 1    | 1   | 18719-27    | Package: Topo Module.<br>Standard DC LED. 2700K<br>CCT |
| 2    | 1   | 18468       | Package: Elliptical Glass<br>Globe. Small              |
| 3    | 1   | 18494       | Package: Topo Disc.<br>Medium                          |

## Disc Small



Driver dimensions and location may vary, consult your order confirmation for details.

\* Fasteners not included

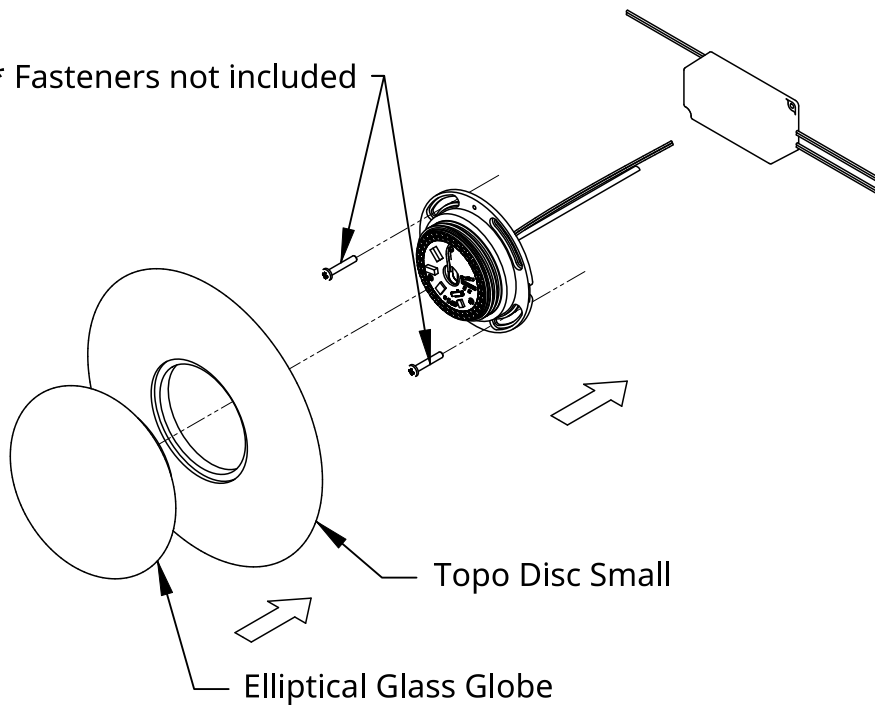

### Installation - Topo Disc Small

1. Connect Red (+) and Black (-) leads to low voltage leads from externally located driver.
2. Use appropriate fasteners to fasten the Module to the mounting surface.
3. Place Topo Disc Small or Topo Disc Medium over Module so gasket is facing the wall.
4. Thread Elliptical Glass Globe onto the Module to tightly secure all components.

## Disc Medium



Driver dimensions and location may vary, consult your order confirmation for details.

\* Fasteners not included

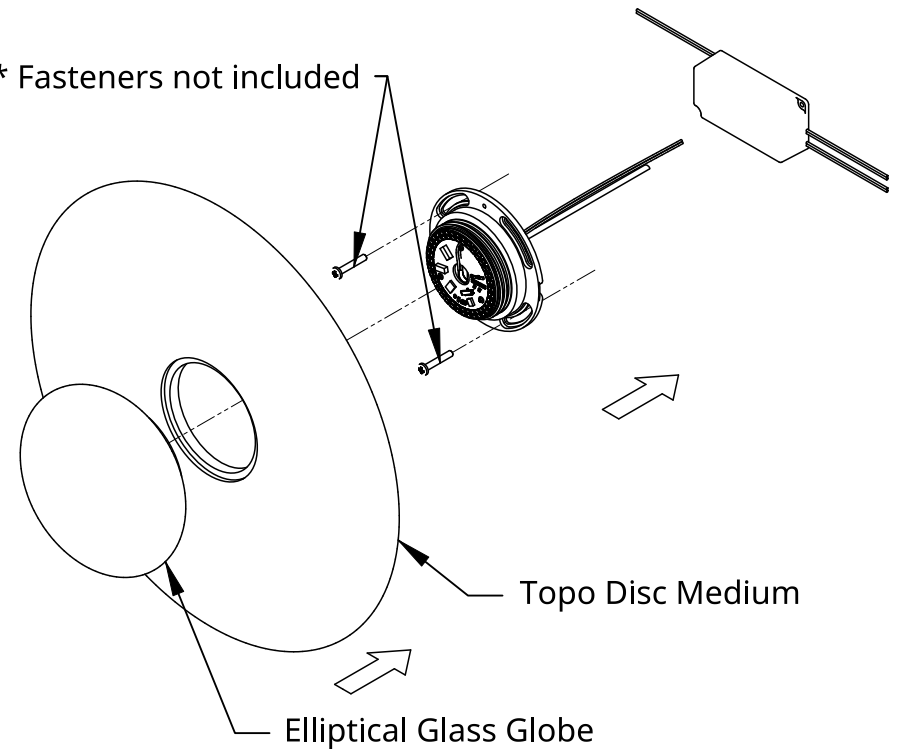

### Installation - Topo Disc Medium

1. Refer to previous steps.
2. Congratulations! End of guide.

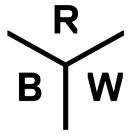

# Topo Disc

18717 rA

AC Input

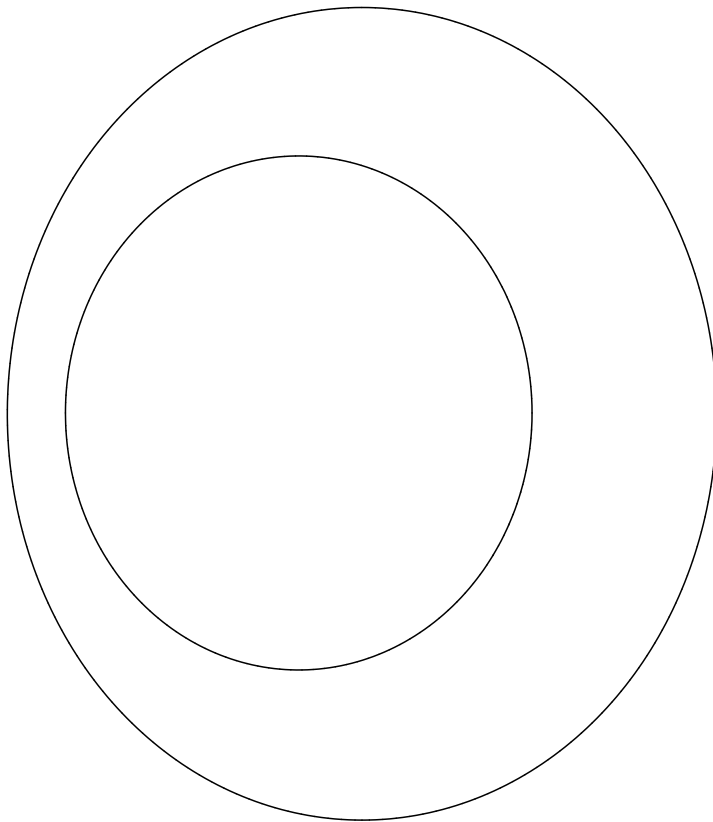

## CAUTION:

Before starting, turn off power at main circuit panel.

## ADVERTENCIA:

Antes de comenzar la instalación, apague la corriente en el tablero principal.

## ATTENTION:

Coupez l'alimentation avant de proceder à l'installation.



Calling for backup? Scan above to contact our team.

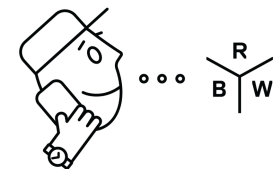
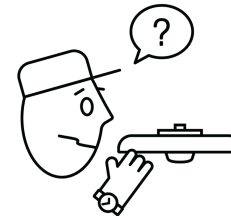

[www.RBW.com](http://www.RBW.com)  
+1 212 388 0399  
[support@RBW.com](mailto:support@RBW.com)  
© 2023, RBW Studio LLC

What's Included: Part Configurations May Vary

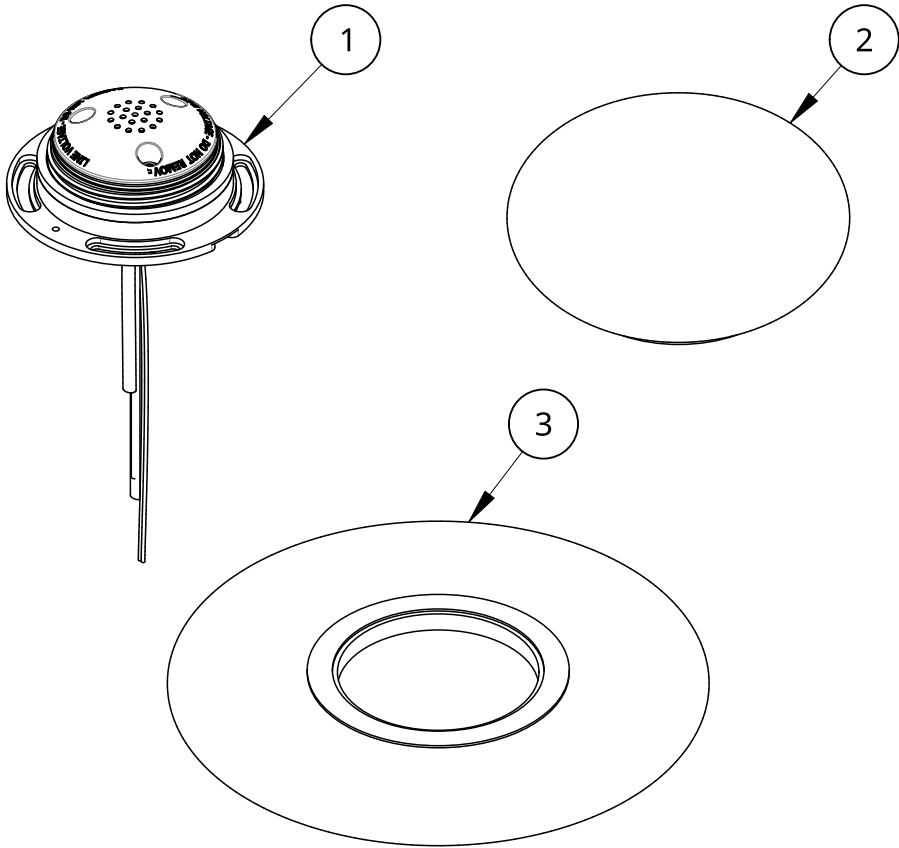

| Item | Qty | Part number | Description                                      |
|------|-----|-------------|--|
| 1    | 1   | 18718-27    | Package: Topo Module. Standard AC LED. 2700K CCT |
| 2    | 1   | 18468       | Package: Elliptical Glass Globe. Small           |
| 3    | 1   | 18588       | Package: Topo Disc. Small                        |

What's Included: Part Configurations May Vary

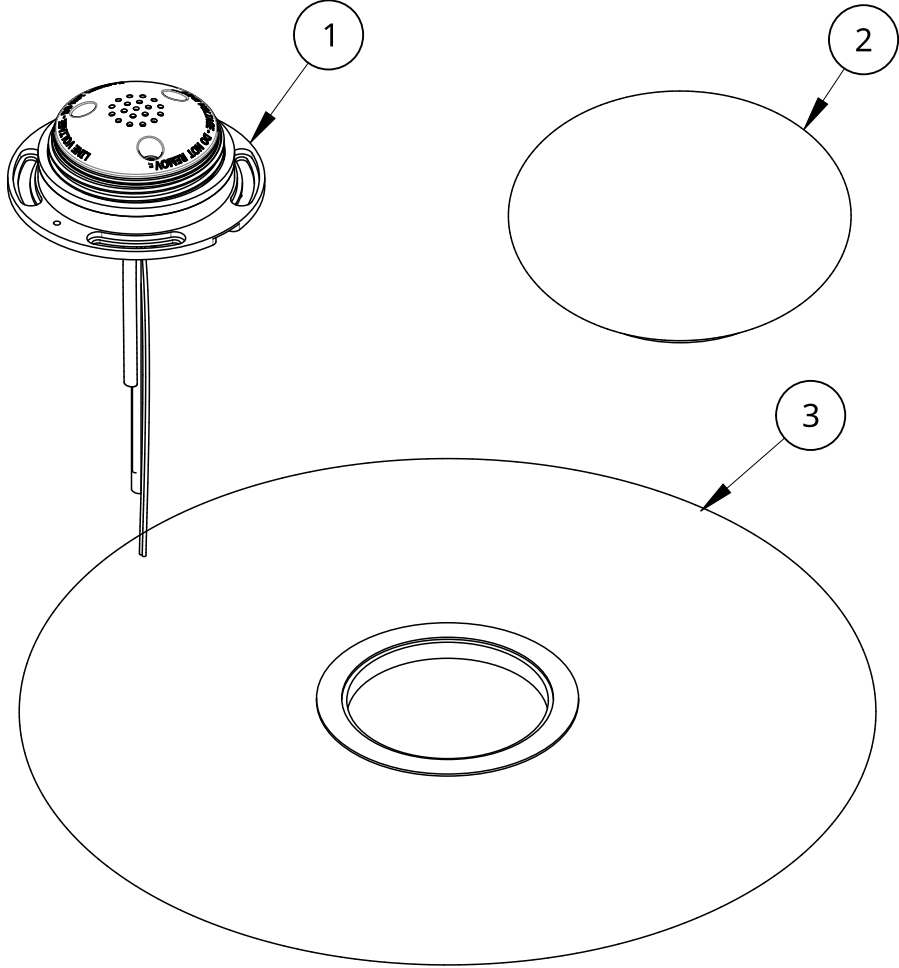

| Item | Qty | Part number | Description                                      |
|------|-----|-------------|--|
| 1    | 1   | 18718-27    | Package: Topo Module. Standard AC LED. 2700K CCT |
| 2    | 1   | 18468       | Package: Elliptical Glass Globe. Small           |
| 3    | 1   | 18494       | Package: Topo Disc. Medium                       |

## Disc Small

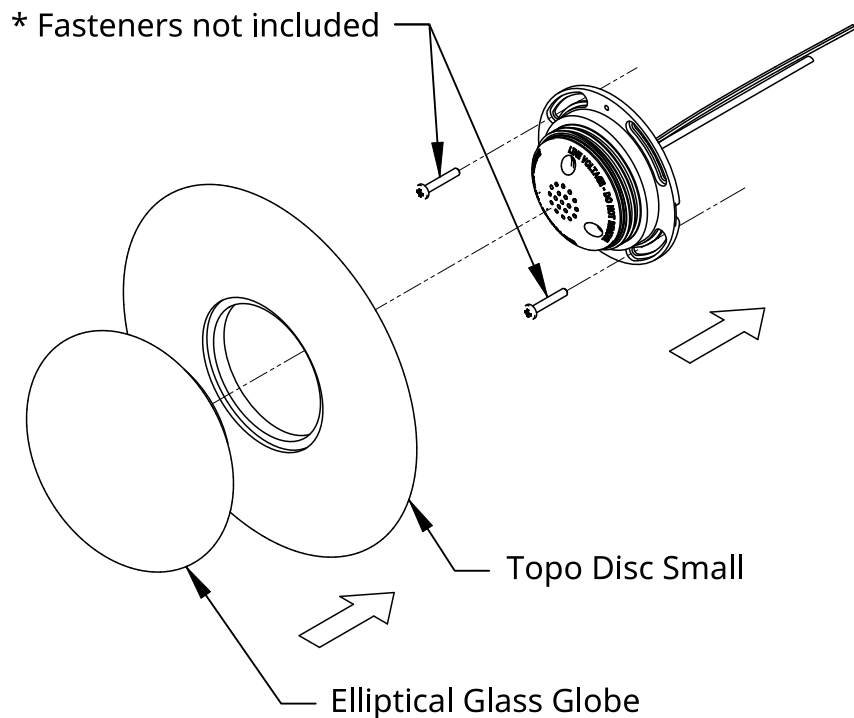

### Installation - Topo Disc Small

1. Connect scone leads to power feed.
2. Use appropriate fasteners to fasten the Module to the mounting surface.
3. Place Topo Disc Small or Topo Disc Medium over Module so gasket is facing the wall.
4. Thread Elliptical Glass Globe onto the Module to tightly secure all components.

## Disc Medium

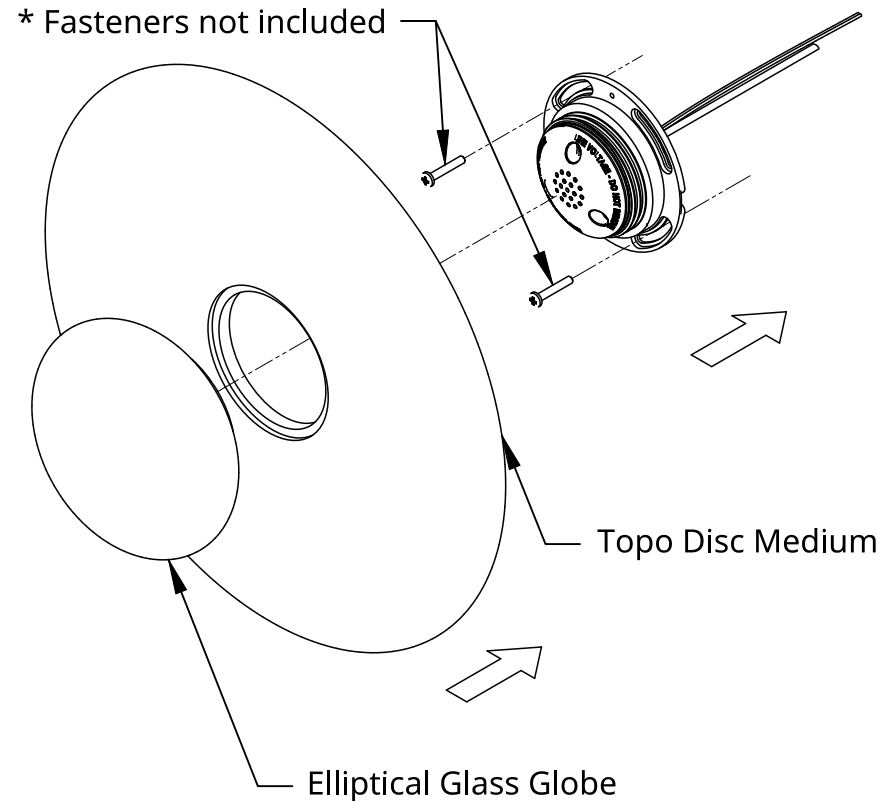

### Installation - Topo Disc Medium

1. Refer to previous steps.
2. Congratulations! End of guide.