

Design Louise Campbell

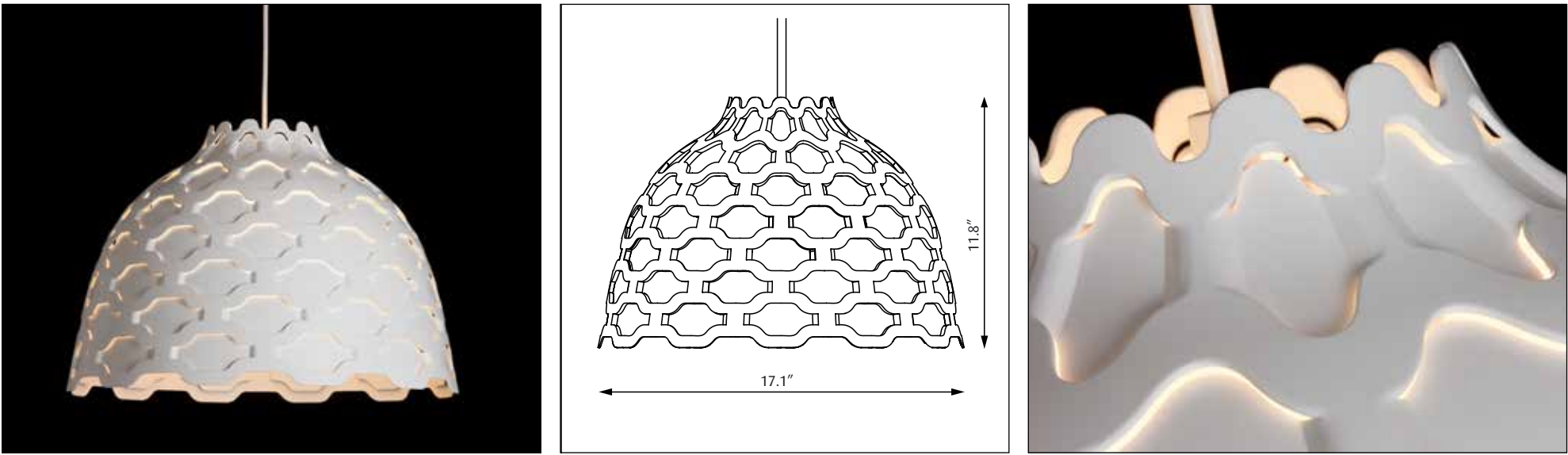

| | | | |
|-----------------------------------|--------------------|---------|---------------------|
| Light source | Voltage | Weight | Ingress protection |
| Max 60W / E26 / A19 Bulb / Medium | Max 120V / 50-60Hz | 8.8 Lbs | IP20 / Dry Location |

Recommended cleaning substances:
Wipe off dust with a dry, soft cloth. Remove greasy spots etc. with a soft cloth dampened in lukewarm water (<122° F/ 50° C) with a mild detergent.
Never use detergents containing abrasives and solvents.

Warning: Scouring powder and similar substances will scratch surfaces.

All installation is subject to local code and jurisdiction.

The installer must ensure that the ceiling can support the luminaire's weight. The installer must if necessary reinforce the ceiling structure by adequate means.

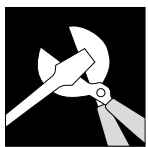

White to White (Neutral)
Black to Black (Line)

16204-I1

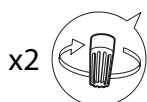

1

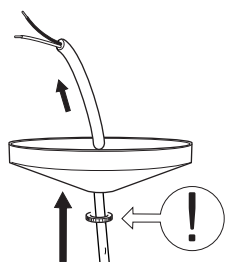

See further mounting
instructions in the
manual supplied with
the canopy

The installer must ensure to use
proper means (rawplugs/screws/
expansion bolts) to secure the fixture
to the ceiling material.
(Means not provided)
The installer must if necessary
reinforce the ceiling structure by
adequate means.

2

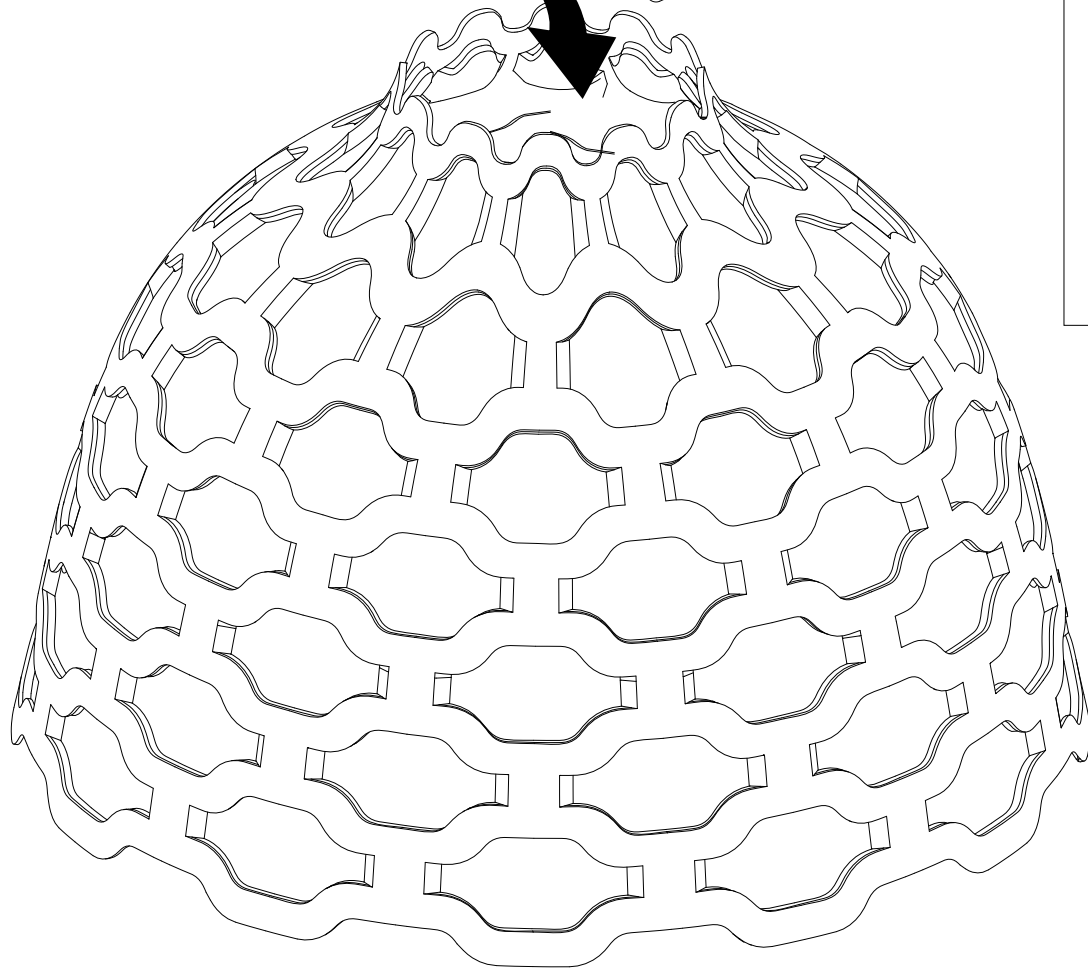
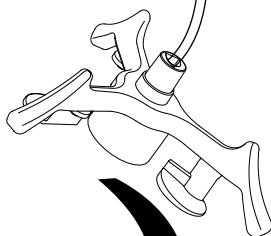

3

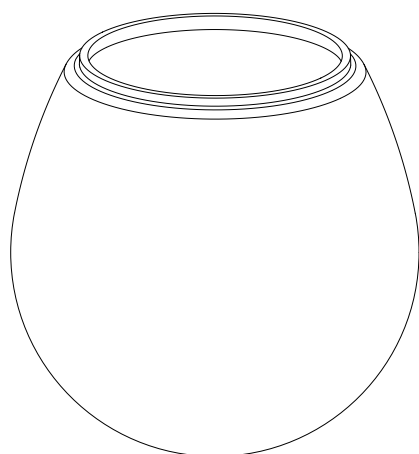
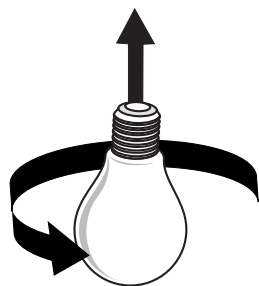

4

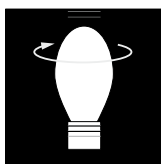

1

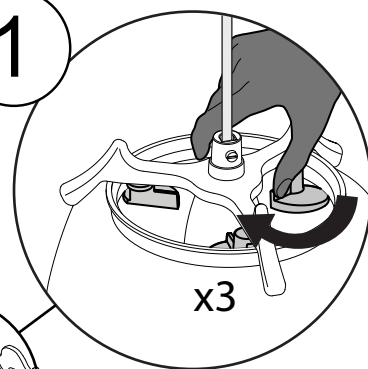

x3

2

3

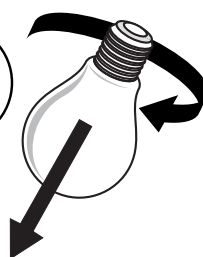

5

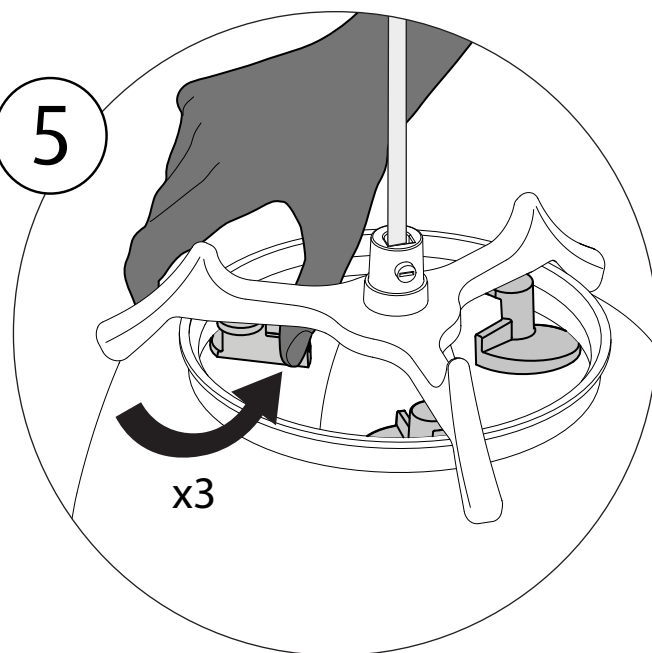

x3

