

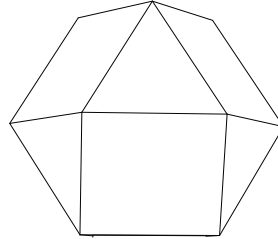

FILE#: E356487

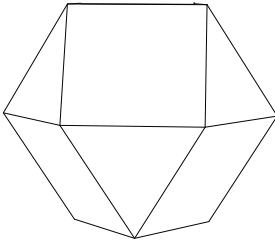

The **WELLES** DOUBLE BLOWN GLASS WALL SCONCE

Installation Guide

- Certified electrician recommended for electrical installation.
- Terminal Block not included. Installation may require advice from a qualified person.
- Junction box or structural blocking rated minimum to support 25 lbs required.
- For all LED fixtures, use only with class 2 power unit.
- The light source contained in this luminaire shall only be replaced by the manufacturer or his service agent or a similar qualified person.

***IMPORTANT: Please provide email confirmation that your order and its related components have been received in their entirety and in good condition. Failure to do so within 7 days of delivery will waive all product warranties.**

GABRIEL SCOTT

EST 2012



Provided Supplies

- Socket Assembly
- Canopy + Screws
- T-Bar
- Welles Double Blown glass volume
- LED Driver
- Spare LED chip

Required Tools:

- Screwdriver
- 4x 2-pole Wiring Terminals, screw or screwless, 12-18AWG (1.0-2.5mm²), rated for 600V, 15A - EX: WAGO 222-412
- Requires LED driver; Input: Local Line Voltage, Output 12Vdc SELV, 5A, Max 60 Watt, Class 2 LED Driver.

STEP 1

Shut-down associated electrical breaker and wire LED driver to power source. Then secure driver in junction box using provided universal T-bar.

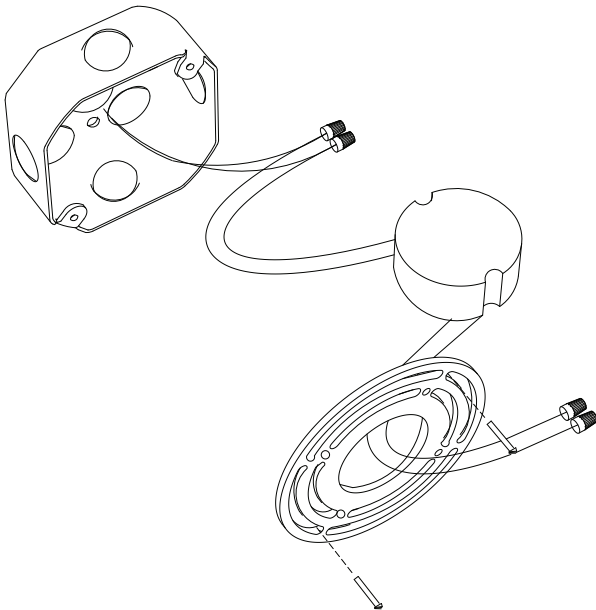

STEP 2

Using terminals, wire in light fixture to the LED driver. On Gabriel Scott fixtures, the black wire is positive (+) and the white wire is ground (-). Then screw the light assembly to the T-bar with the provided screws.

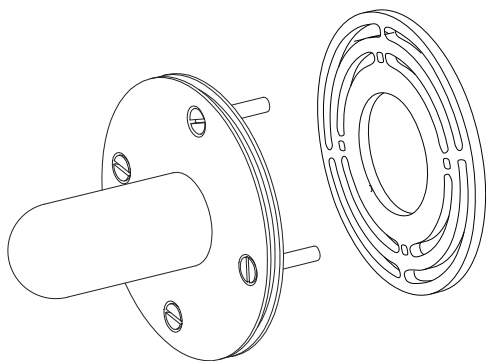

STEP 3

Gently slide the glass volume over the light assembly and fix in place by screwing the set screws in. The set screws should land in between a groove on the light assembly.

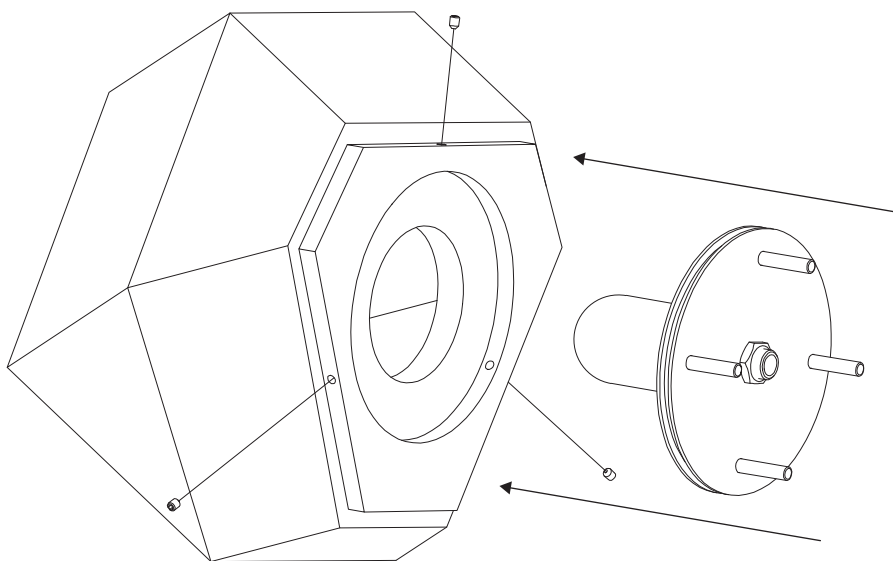



e: info@GabrielScott.com

t: (646) 783-3770