

Installation Instructions For Aurora Dual MR16 Round & Square Edge 3.3"

1718 W. Fullerton Ave
Chicago, IL 60614
Tel: 773-770-1195
Fax: 773-935-5613
www.purelighting.com
info@purelighting.com

General Information

Fixture must be installed by a qualified electrician (check with local and national codes for proper installation). To prevent electrical shock, disconnect electrical supply before installation or servicing. Compatible only with traditional, level 5 surface finishing, not self-leveling, PVA primer systems. **Not for use in wood or tile ceilings.**

WORKFLOW CHART



ELECTRICAL CONTRACTOR

1. Locate and mount housing
2. Screw and lock-in housing
3. Connect wires un housing



DRYWALL CONTRACTOR

1. Install and cut drywall around housing.



ELECTRICAL CONTRACTOR

1. Adjust plaster flange frame and tighten wing nuts.
2. Connect the MR16 and LEDS wiring to the plaster plate.
3. Screw plaster plate into housing.
4. Test MR16 and LEDS.



DRYWALL CONTRACTOR

1. Plaster, sand & paint.
2. Clean aperture with clean damp towel.



ELECTRICAL CONTRACTOR

1. Clean aperture with clean damp towel, where the drywall contractor missed.
2. Adjust pan rotation ring and aim lamp. You're done!

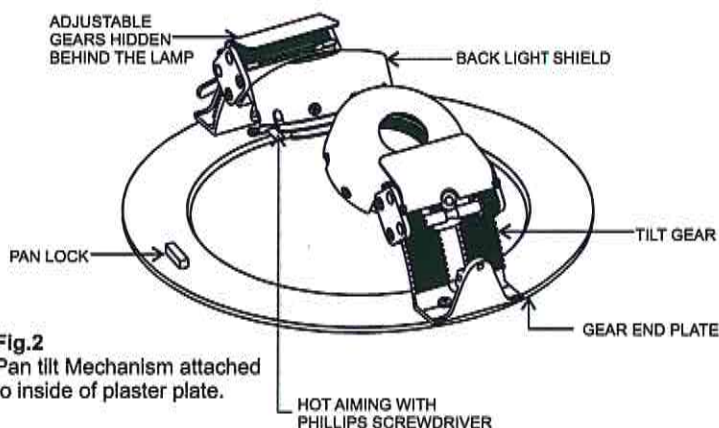
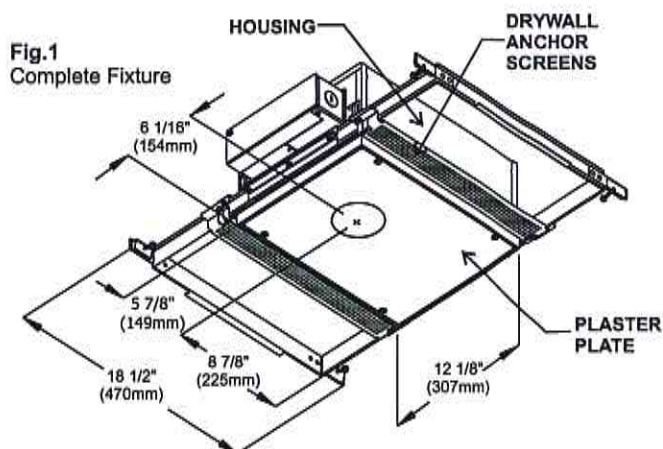

Fig.2
Pan tilt Mechanism attached to inside of plaster plate.

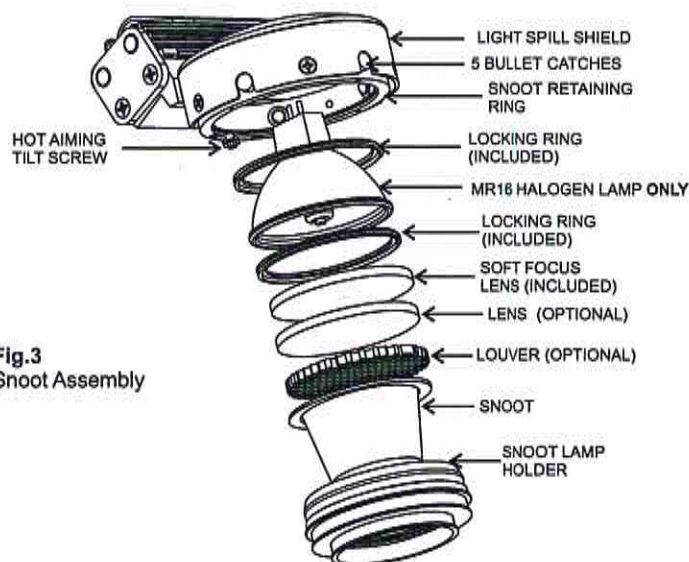

Fig.3
Snoot Assembly



Important

Scan with your mobile device to watch the installation video or visit www.purelighting.com/aurora-install

Importante

Escanear con el dispositivo móvil para ver el video de instalación o visite www.purelighting.com/aurora-install



ELECTRICAL CONTRACTOR

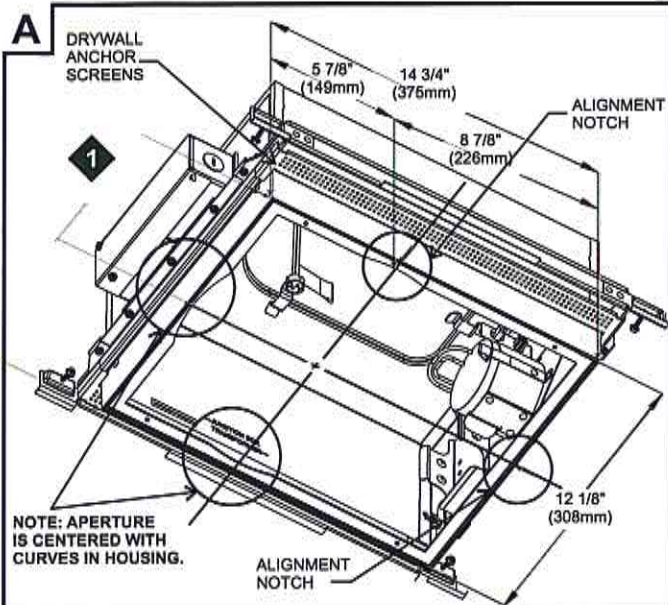

1: Use these dimensions when locating the center point of the aperture during the installation process. Align the fixture using a laser or a chalk line.

NOTE: Drywall anchor screens may be removed, if the joist are less than 14 1/2" apart.

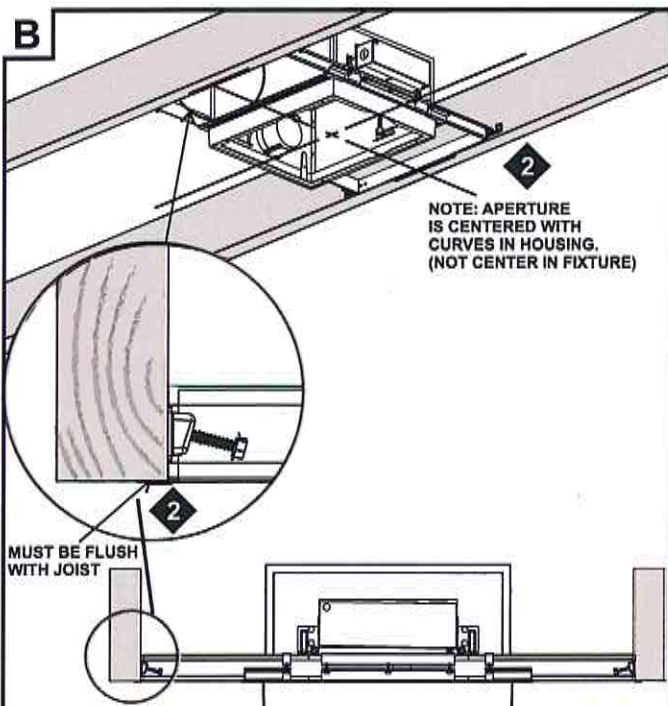

2: Hanger bars must align and remain flush with joist.

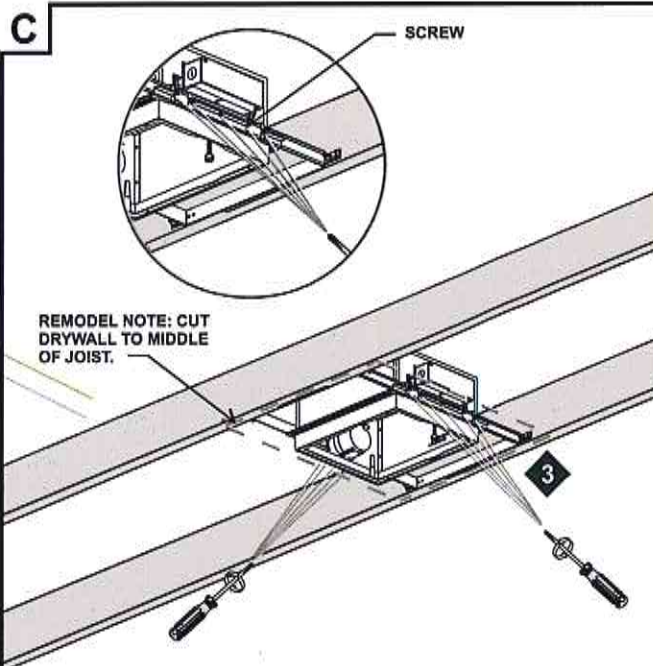

3: After fixture is positioned, tighten all (10) screws on hanger bars.

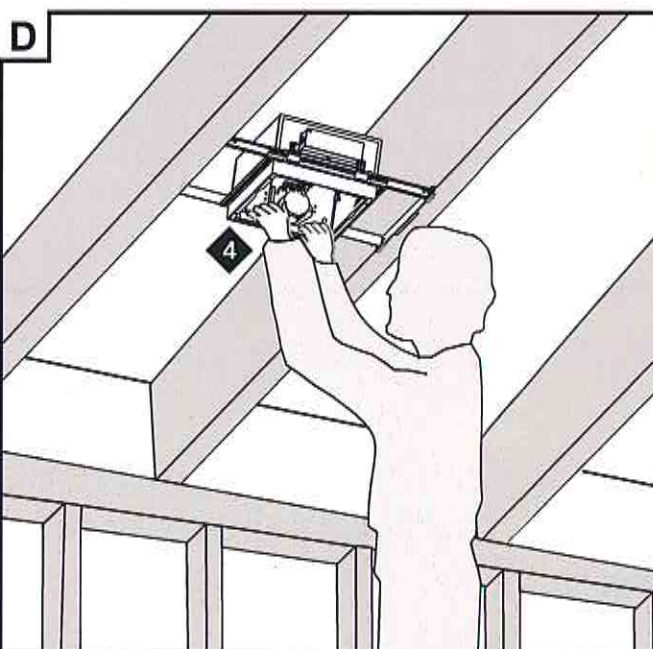

4: After installation, slightly pull on fixture to ensure there is no movement.



E

LINE INPUT 120V - 240V

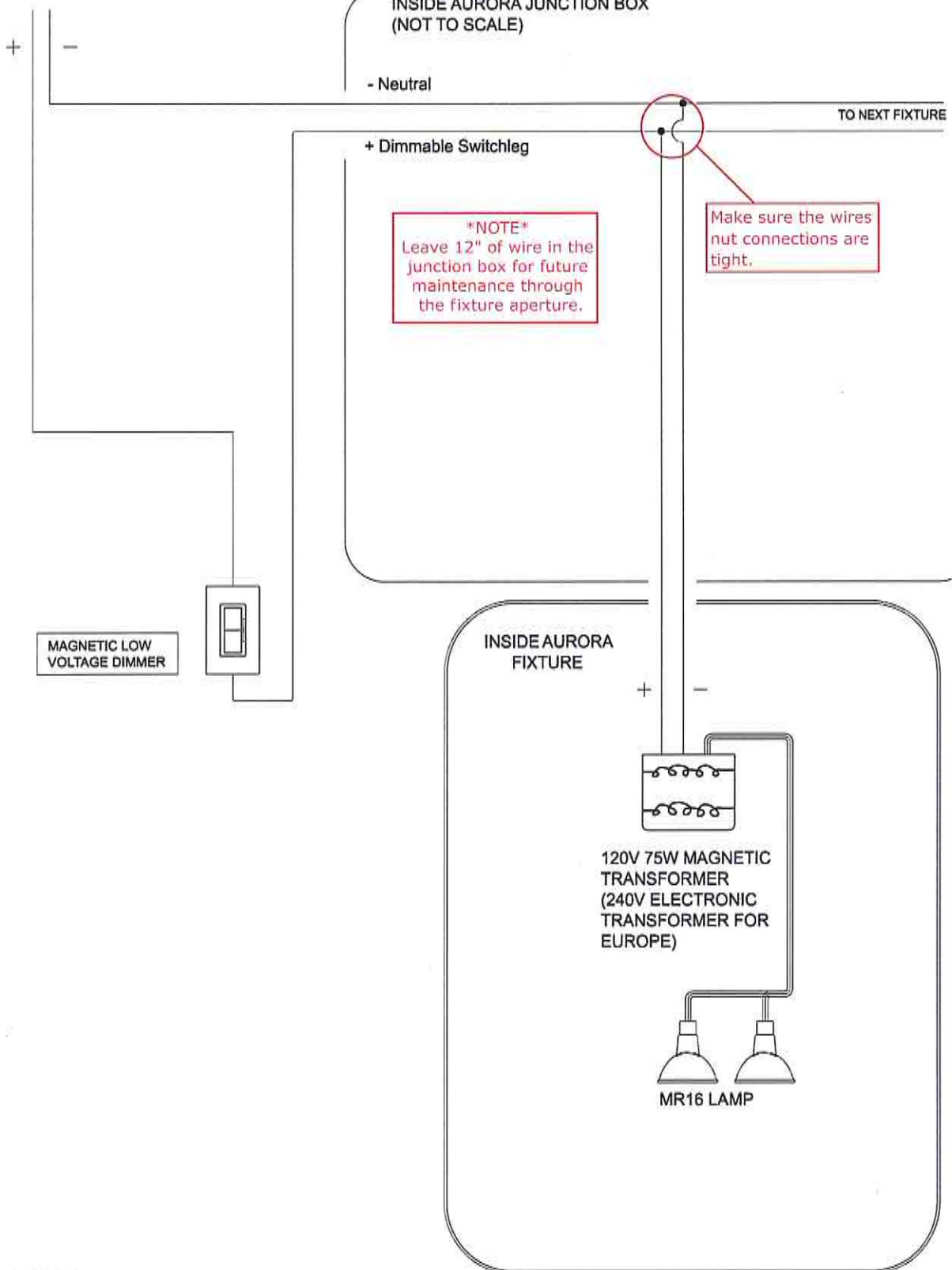

WIRING DIAGRAM
FOR USE WITH PURE LIGHTING® AURORA NON-RGB FIXTURES

DRYWALL CONTRACTOR

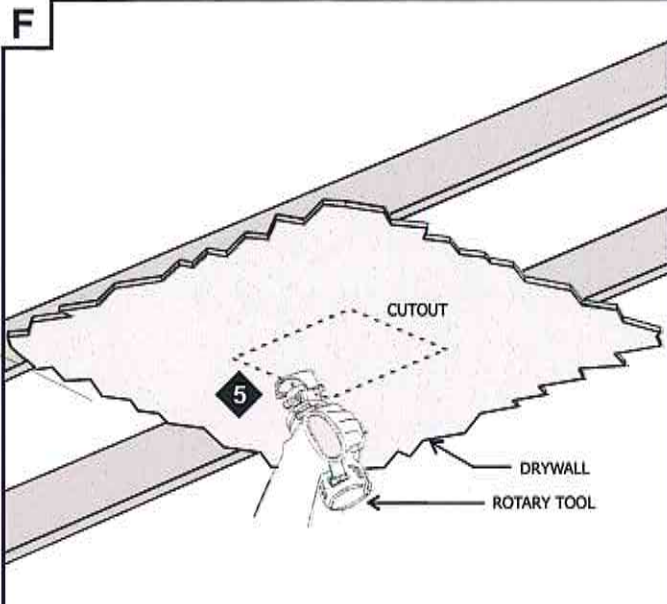

5: Drywall contractor must install drywall and cut 14-3/4" (375mm) X 12-1/8" (308mm) hole with rotary cutting tool around fixture or pre-cut hole in drywall prior to installation.

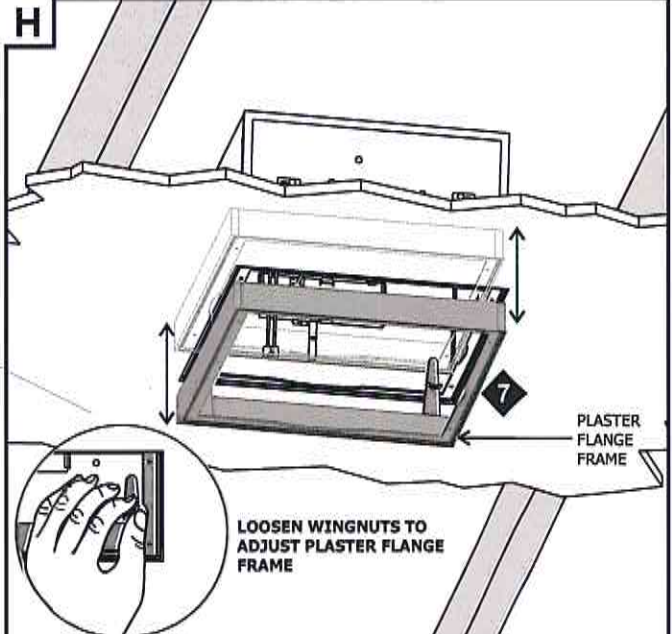

7: Loosen (4) wing nuts and adjust plaster flange frame to be flush with drywall. All 4 corners MUST be exactly even with drywall. Plaster flange frame adjusts to accommodate 1/2" (13mm) to 1-1/4" (32mm) ceiling thickness.

ELECTRICAL CONTRACTOR

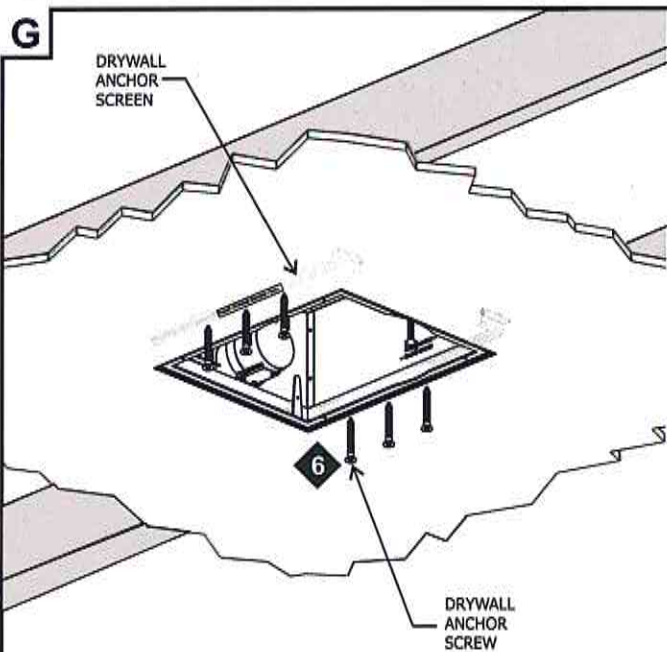

6: Electrician must anchor drywall anchor screens. Insert screws through drywall into anchor screen on fixture.

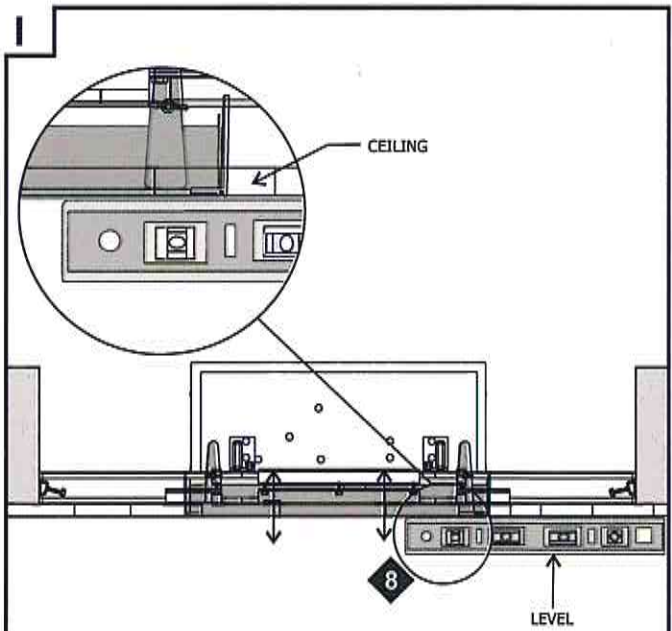

8: Use a straight edge or level and move plaster flange frame up or down to be exactly even with drywall ceiling.



ELECTRICAL CONTRACTOR

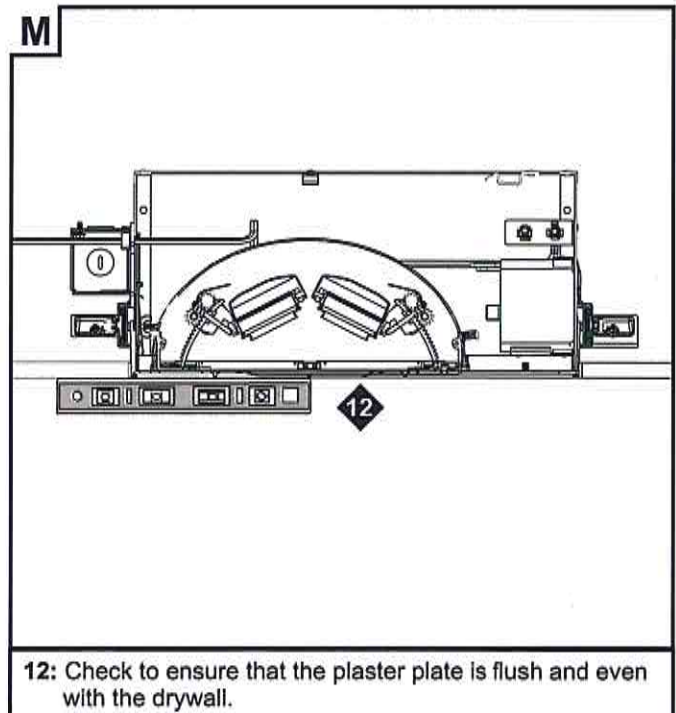
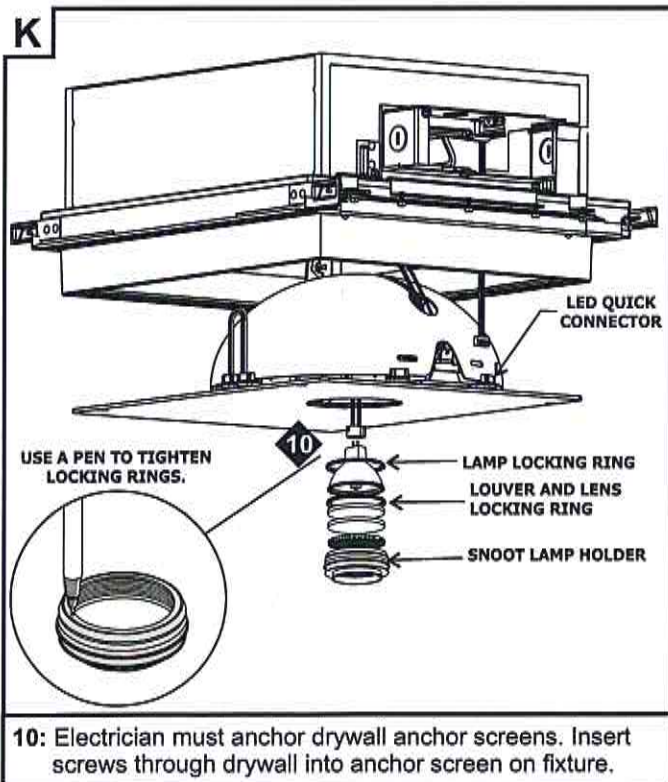
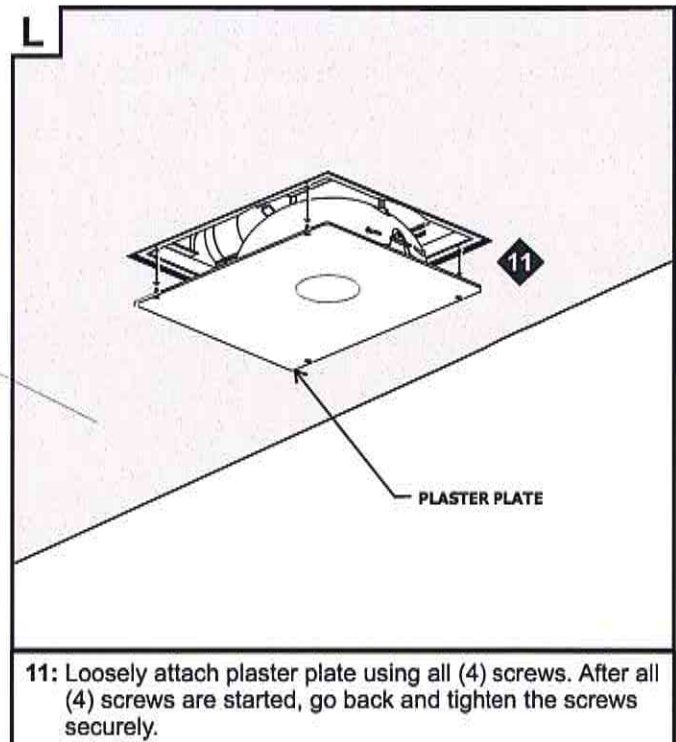
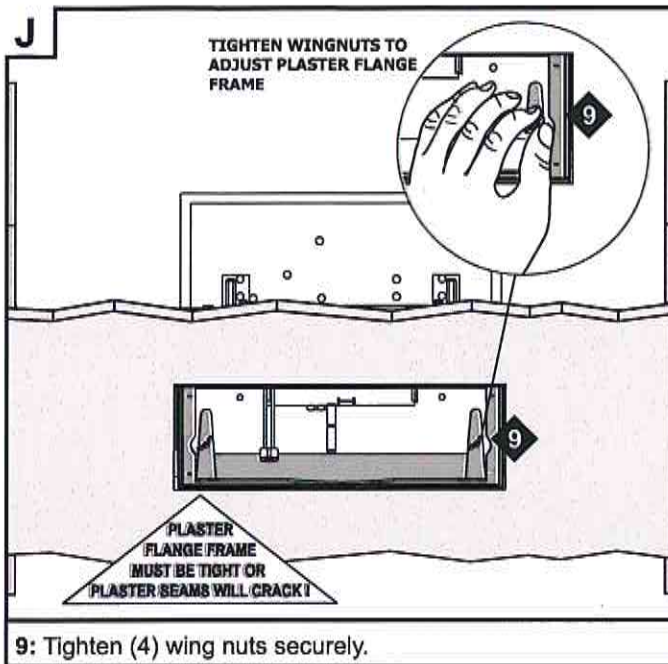



N

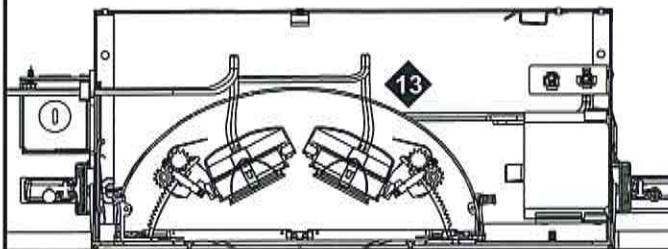

MR16
HALOGEN
ACCENT LIGHT
(NO MR16 LED)

13: Turn on and test MR16 lamps to ensure they are properly installed.

P

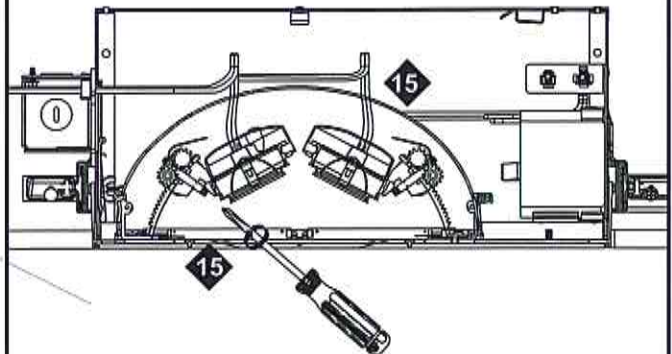

HANDS MUST BE CLEAN WHEN ADJUSTING FIXTURE

15: Tilt and rotate MR16 lamp cartridge as needed. When lamp is properly adjusted secure pan lock.

O

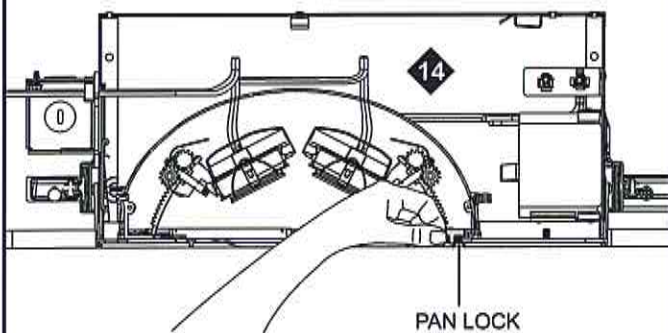

HANDS MUST BE CLEAN WHEN ADJUSTING FIXTURE

14: To aim lamp, loosen pan lock, rotate and position the pan rotation ring.

Q

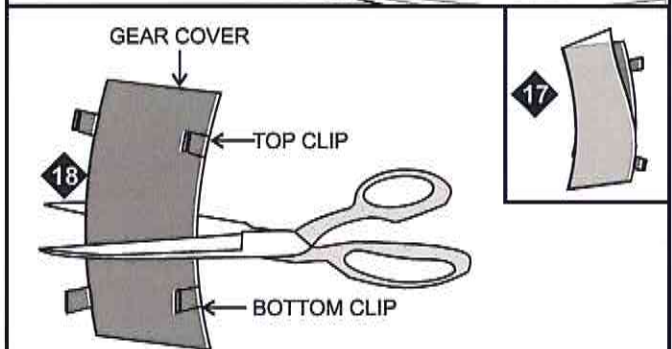
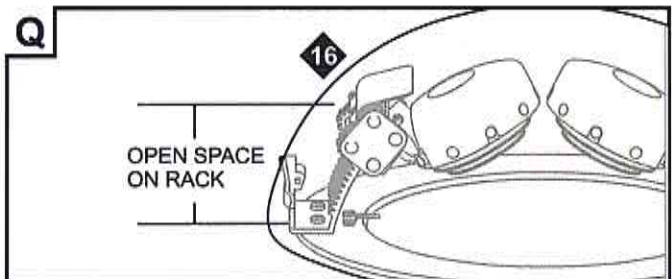

16: Measure the distance of the open space on the track.

17: Remove the protective film from the gear cover.

18: Cut the gear cover to fit the space if necessary.



ELECTRICAL CONTRACTOR

R

19: Insert the gear cover (make sure the gear cover clips are facing the lamp assembly rack) from the bottom of the aperture.

20: Start by snapping the two bottom gear cover clips onto the bottom edge and then snap the top two clips onto the top edge.

DRYWALL CONTRACTOR

Compatible only with traditional, level 5 surface finishing, not self-leveling, PVA primer systems.

S

APPLY A THIN LAYER OF DURABOND® 45 COMPOUND AROUND ALL FOUR SIDE. DO NOT USE TAPE. DO NOT USE PVA PRIMER SYSTEMS.

21: Plaster.

22: Sand.

T

23: Paint.

PAINT OVER PAINT SHIELD. REMOVE PAINT SHIELD 20-60 MINUTE AFTER PAINTING.

U

REMOVE ANY EXCESS PAINT THAT IS ON THE BEVELED EDGE. ANY EXCESS PAINT WILL BE NOTICEABLE WHEN LIGHT IS POWERED ON. WIPE INSIDE OF APERTURE WITH CLEAN DAMP TOWEL.

24: Clean Area.



ELECTRICAL CONTRACTOR

V

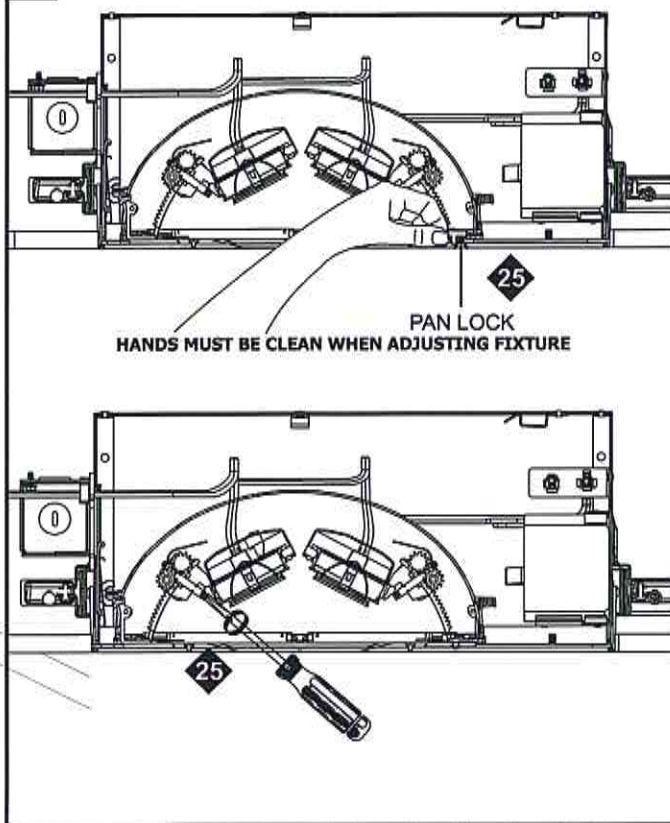

25: Wash hands and clean all drywall residue from inside aperture, with a clean damp towel. Electrician or lighting designer - ensure pan rotation ring is adjusted, locked in place, and the lamp is aimed properly.