

# SPECIFICATION SHEET

4" 2000 SERIES

# NW2000CE NW2000CE2

SHALLOW NEW CONSTRUCTION HOUSING  
WITH ELECTRONIC CONVERTER

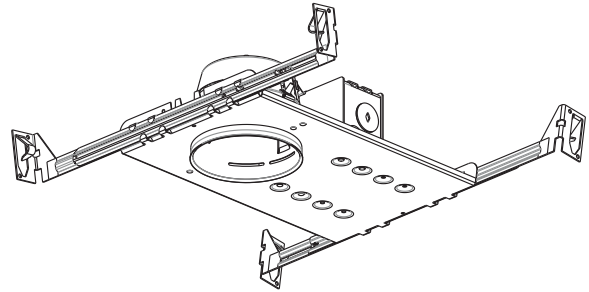

YES

Damp Location



MR16 42W MAX

MR16



Voltage

120 VOLTS (CAN & USA.)  
277 VOLTS (USA)



Electronic converter 120V / 12V  
Electronic converter 277V / 12V



Thermal Protector

T°C 120°C No 031



OD Cut

4 1/4" (108mm)



UL US LISTED

E174023



Dimensions

Overall Dimensions :  
Length : 14 1/2" (368mm)  
Width : 7 1/2" (190mm)  
Height : 3 1/2" (89mm)

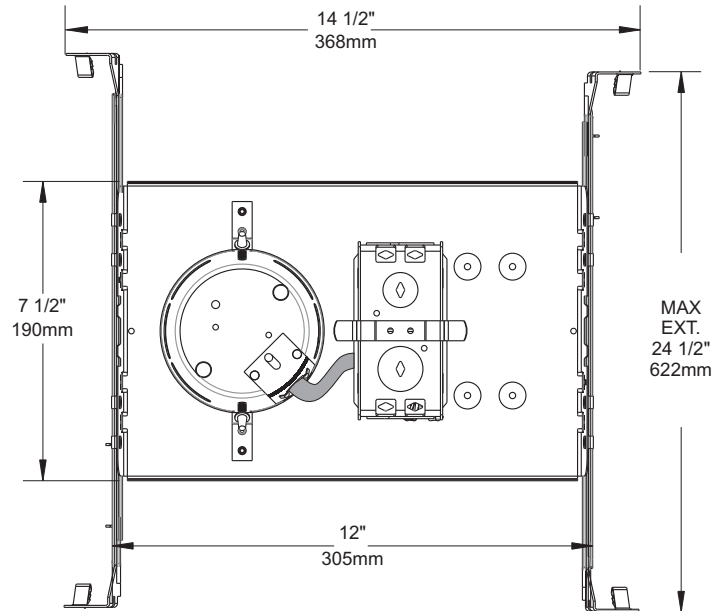
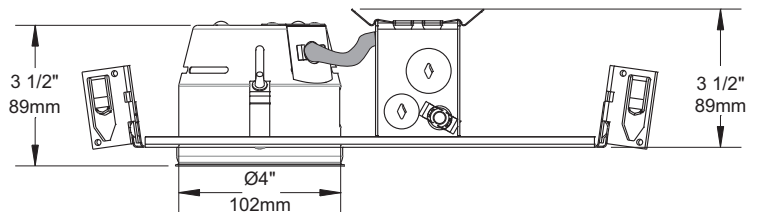

## COMPATIBLE TRIMS

### 42W MAX

R2000	S2000
R2051	S2051
R2100	S2100
R2100VSM/ST	T2000
R2110VSM/ST	T2000V (T2010V)
R2130VSM/ST	T2000VL (T2010VL)
R2100VT	T2000VS (T2010VS)
R2450VT	T2000VLS (T2010VLS)

## TECHNICAL SPECIFICATIONS

0,051" (1,3mm) thickness Galvanized Steel.  
Below-ceiling accessible.  
Hooks PAT#CAN 2,088,648 and #USA 5,377,088.  
Takes up to 7/8" thick ceiling.  
Perfect fit into ceiling.  
No light leak.  
Each part of the case should be at 3 "(76mm) MINIMUM from insulation (if applicable).



Your representative : \_\_\_\_\_

Your project : \_\_\_\_\_