

Modul-Aim™

ISMOD

Project

Notes

Fixture Type

Date

Assembled Insulated Ceiling Housing

DESCRIPTION

Assembled Modul-Aim units for new construction in insulated ceilings, Offered in 1 or 2 head configurations.

SPECIFICATIONS

HOUSING DETAILS Powder coated, 22 gauge 0.036" (0.91 mm) galvanized steel housing. Configured with butterfly brackets (Patent Pending) with mounting bars for fixed or suspended ceilings (included). Can fit in ceilings up to 1" (25 mm) thick. Perfect fit into ceiling. No light leakage. Junction box is accessible from below the ceiling for ease of maintenance.

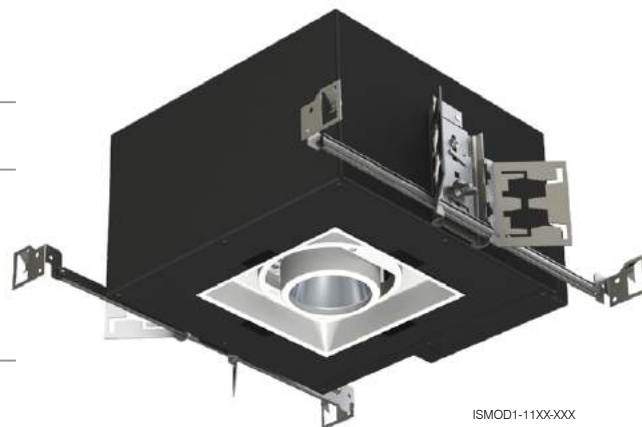

ISMOD1-11XX-XXX

LED ENGINE

Standard:

Lumileds Luxeon CoB 1205, delivers a lumen maintenance greater than 70% after 50,000 hours of operation (L_{70}). Provides a high quality true color and a clean white light without hot spots. Color binning within 3 steps on MacAdam ellipse which surpasses ANSI binning requirements.

Offered in 2,700K, 3,000K, 3,500K and 4,000K. 90+ CRI (97 nominal).

Several driver models available offering 3 dimming options:

ELV: 120V to 277V (20W)

0-10V: 120V to 277V (20W)

Lutron Ecosystem addressable: 120V to 277V (20W)

CrispWhite:

Lumileds LUXEON CoB 1205 with CrispWhite Technology delivers the warm saturated colors of high 90 + CRI solutions while creating the natural crisp whiteness required for merchandising. Offered in 3,000K only.

Several driver models available offering 3 dimming options:

ELV: 120V to 277V (20W)

0-10V: 120V to 277V (20W)

Lutron Ecosystem addressable: 120V to 277V (20W)

Lumenetix Warm Dimming:

Lumenetix Araya DDM1 Dynamic Dimming Module delivers dimmable white light that warms as it dims reproducing dimming conditions of a halogen lamp. It allows the user to change the color temperature from 3,050K at full intensity to 1,800K at minimum intensity all this while ensuring a 90+ CRI over the full dimming range. Lumenetix: 100V to 240V (20W)

Lumenetix Color Tuning:

Lumenetix Araya CTM1 Color Tuning Module allows the user to program millions of color combinations using a user friendly Bluetooth application available on iOS mobile devices. The application allows programming of different scenes, colors, and color temperatures while the day-to-day control is ensured by standard 0-10V wall mounted dimmers. 90+ CRI.

Lumenetix: 100V to 240V (20W)

DELIVERED LUMENS

Performance 1 (20W) Standard: 1,267 lumens @ 3,000K, 63 lm/W

Performance 1 (20W) "CrispWhite": 1,195 lumens @ 3,000K, 56 lm/W

Warm Dimming (20W): 936 lumens @ 3,000K, 47 lm/W

Color Tuning (20W): 936 lumens @ 4,000K, 47 lm/W

*** Average lumens output shown. Consult ies files on our Website for more details.**



CONTRAST
L I G H T I N G

2015-12

1009, rue du Parc Industriel
Lévis (Québec) G6Z 1C5 Canada
Tel.: 1-888-839-4624 Fax: 1-877-839-7057
info@contrastlighting.com
www.contrastlighting.com

© 2015 Contrast Lighting M.L. Inc.
All rights reserved

Contrast Lighting reserves the right to make changes in specifications and/or to discontinue any product at any time without notice or obligation and will not be liable for any consequences resulting from the use of this publication.

Modul-Aim™

ISMOD

SPECIFICATIONS (CONT'D)

UNIT FINISH	Powder coated: Matte White (-11) or Matte Black (-22)
OPTIC SYSTEM	Interchangeable optional optical reflectors and lenses available to customize your lighting. Choice of available lenses: Standard: No lens Accessories (sold separately): Clear (C) , Frosted (F) , Honeycombs (H) , Linear (L) , Prismatic (P) and Solite (S) (Color lenses available upon request.) Optical reflectors available: (Standard and CrispWhite) S: Spot → 15° MS: Medium Spot → 19° M: Narrow Flood → 32° W: Flood → 45° * Average beams shown. Consult ies files on our Website for more details.
ADJUSTABILITY	Swivel: 359° Tilt: 40° Locking device: Only one screw to lock both axis into position.
HEAT SINK	High quality aluminum injected heat sink ensuring maximum heat dissipation.
CEILING CUTOUT	6-1/4" x 6-1/4" (159 mm x 159 mm) or 6-1/4" x 12-1/4" (159 mm x 312 mm)
CERTIFICATION	<ul style="list-style-type: none"> cULus for damp locations Energy Star® certified IC rated
WARRANTY	1 year on components against manufacturing defects. 5 years on LED modules and drivers.

ASSEMBLED MODELS

ISMOD1

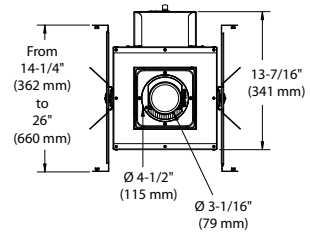
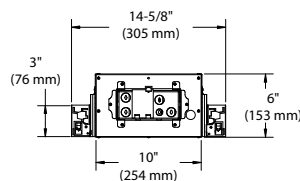
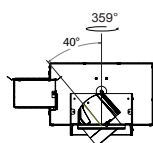
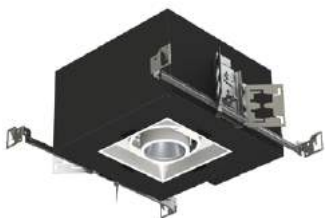

ISMOD2

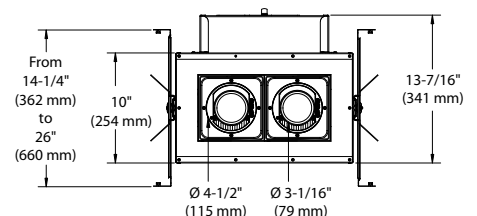
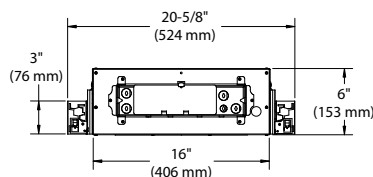

CONTRAST

L I G H T I N G

2015-12

1009, rue du Parc Industriel
Lévis (Québec) G6Z 1C5 Canada
Tel.: 1-888-839-4624 Fax: 1-877-839-7057
info@contrastlighting.com
www.contrastlighting.com

© 2015 Contrast Lighting M.L. Inc.
All rights reserved

Contrast Lighting reserves the right to make changes in specifications and/or to discontinue any product at any time without notice or obligation and will not be liable for any consequences resulting from the use of this publication.

Modul-Aim™

ISMOD

TRIMS

Available finishes: Matte White (-11), Metallic Grey (-15) and Matte Black (-22)

TRMOD1

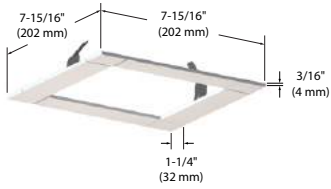

TRMOD2

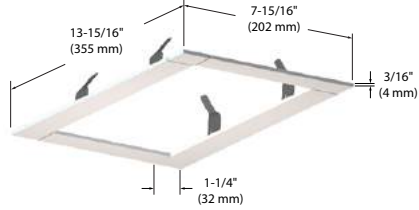

MESH PLATE (Trimless)

SFMOD1

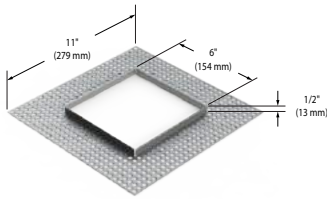

SFMOD2

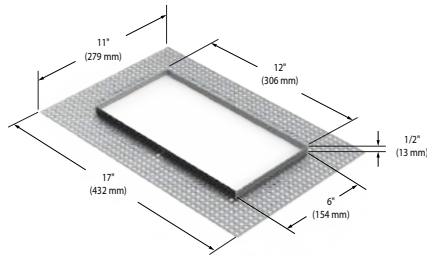

MASK

Available finishes: Matte White (-11) and Matte Black (-22)

MASK1-11



MASK1-22



Modul-Aim™

ISMOD

PHOTOMETRIC DATA

3,000K, 90 + of CRI, Spot, Performance 1

CANDLEPOWER DISTRIBUTION

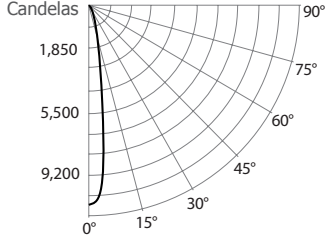

LIGHT CONE

Distance	FC	DIA
06'	291.4	1.5
08'	163.9	2.0
10'	104.9	2.5
12'	72.9	3.0
14'	53.5	3.5
16'	41.0	4.0

Beam: 14.2"
Beam Edge defined as 50% of Maximum Nadir Candlepower.

LUMINAIRE

Modul-Aim Performance 1 LED	3,000K Spot
CBCP / Lumens	10,492 / 1,241
Watts	120V 277V 20.9W 21.4W
Operating AMPS	0.17A 0.07A
Lumen Maintenance	L70 @ 50,000 Hrs
CRI	90 +
Lumens/Watt	59.3
Spacing Criteria	0.24

COEFFICIENT OF UTILIZATION - %

RCC %	80			50			30		
RWC %	50	30	50	30	50	30	50	30	
RCR	0	119	119	111	111	106	106	106	
	2	108	105	103	101	100	98		
	4	99	95	96	93	94	92		
	6	92	88	90	87	89	86		
	8	87	82	85	82	84	81		
	10	82	78	81	77	80	77		

Zonal Cavity Method
Effective Floor Cavity Reflectance 20%

ZONAL LUMEN SUMMARY

ZONE	LUMENS	%LUMINAIRE
0-30	1,121.7	90.4%
0-40	1,231.5	99.2%
0-60	1,241.0	100%
60-90	0	0%
0-90	1,241.0	100%

MULTIPLE UNIT DATA - (RCR 2)

SPACING ON CENTER	INITIAL FOOTCANDLES	WATTS/SQ. FT.
5'	62	0.93
6'	35	0.52
7'	24	0.36
8'	24	0.36
9'	16	0.23

38' x 38' x 10' Room. Workplan located 2-1/2' (30").
Reflection factor of 80%/50%/30%.

CANDELAS DISTRIBUTION

DEGREES/VERTICAL	CANDELAS	DEGREES/VERTICAL	CANDELAS
0	10,492	40	17
5	7,932	50	3
10	2,683	60	0
15	1,017	70	0
20	613	80	0
25	534	90	0
30	458		

3,000K, 90 + of CRI, Medium Spot, Performance 1

CANDLEPOWER DISTRIBUTION

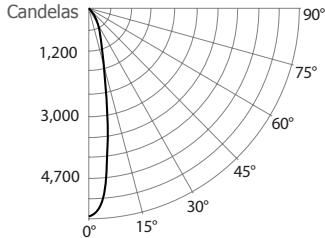

LIGHT CONE

Distance	FC	DIA
06'	164.6	2.1
08'	92.6	2.9
10'	59.3	3.6
12'	41.2	4.3
14'	30.2	5.0
16'	23.1	5.7

Beam: 20.2"
Beam Edge defined as 50% of Maximum Nadir Candlepower.

LUMINAIRE

Modul-Aim Performance 1 LED	3,000K Medium Spot
CBCP / Lumens	5,926 / 1,194.4
Watts	120V 277V 20.9W 21.4W
Operating AMPS	0.17A 0.07A
Lumen Maintenance	L70 @ 50,000 Hrs
CRI	90 +
Lumens/Watt	57.1
Spacing Criteria	0.35

COEFFICIENT OF UTILIZATION - %

RCC %	80			50			30		
RWC %	50	30	50	30	50	30	50	30	
RCR	0	119	119	111	111	106	106	106	
	2	107	104	102	100	99	97		
	4	98	93	94	91	93	90		
	6	90	86	88	84	87	83		
	8	84	79	82	79	81	78		
	10	78	74	77	74	77	73		

Zonal Cavity Method
Effective Floor Cavity Reflectance 20%

ZONAL LUMEN SUMMARY

ZONE	LUMENS	%LUMINAIRE
0-30	1,068.3	89.4%
0-40	1,182.3	99%
0-60	1,194.4	100%
60-90	0	0%
0-90	1,194.4	100%

MULTIPLE UNIT DATA - (RCR 2)

SPACING ON CENTER	INITIAL FOOTCANDLES	WATTS/SQ. FT.
5'	60	0.93
6'	34	0.52
7'	23	0.36
8'	23	0.36
9'	15	0.23

38' x 38' x 10' Room. Workplan located 2-1/2' (30").
Reflection factor of 80%/50%/30%.

CANDELAS DISTRIBUTION

DEGREES/VERTICAL	CANDELAS	DEGREES/VERTICAL	CANDELAS
0	5,926	40	27
5	5,139	50	3
10	3,003	60	0
15	1,287	70	0
20	741	80	0
25	545	90	0
30	453		



Modul-Aim™

ISMOD

PHOTOMETRIC DATA

3,000K, 90 + of CRI, Narrow Flood, Performance 1

CANDLEPOWER DISTRIBUTION

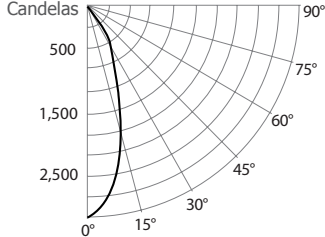

LIGHT CONE

Distance	FC	DIA
06'	82.4	3.6
08'	46.3	4.8
10'	29.7	6.0
12'	20.6	7.2
14'	15.1	8.4
16'	11.6	9.6

Beam: 33.5"
Beam Edge defined as 50% of Maximum Nadir Candlepower.

LUMINAIRE

Modul-Aim Performance 1 LED	3,000K	Narrow Flood
CBCP / Lumens	2,965	/ 1,189.5
Watts	120V	277V
	20.9W	21.4W
Operating AMPS	0.17A	0.07A
Lumen Maintenance	L70 @ 50,000 Hrs	
CRI	90 +	
Lumens/Watt	56.9	
Spacing Criteria	0.58	

COEFFICIENT OF UTILIZATION - %

RCC %	80			50			30		
RWC %	50	30	50	30	50	30	50	30	
RCR	0	119	119	111	111	106	106	106	
	2	106	102	101	98	98	96	96	
	4	95	91	92	88	90	87	87	
	6	86	82	84	80	83	79	79	
	8	79	74	78	73	77	73	73	
	10	73	68	72	68	71	67	67	

Zonal Cavity Method

Effective Floor Cavity Reflectance 20%

ZONAL LUMEN SUMMARY

ZONE	LUMENS	%LUMINAIRE
0-30	1,053.4	88.6%
0-40	1,173.8	98.7%
0-60	1,185.8	99.7%
60-90	3.7	0.3%
0-90	1,189.5	100%

MULTIPLE UNIT DATA - (RCR 2)

SPACING ON CENTER	INITIAL FOOTCANDLES	WATTS/SQ. FT.
5'	59	0.93
6'	33	0.52
7'	23	0.36
8'	23	0.36
9'	15	0.23

38' x 38' x 10' Room. Workplan located 2-1/2' (30").
Reflection factor of 80%/50%/30%.

CANDELAS DISTRIBUTION

DEGREES/VERTICAL	CANDELAS	DEGREES/VERTICAL	CANDELAS
0	2,965	40	23
5	2,810	50	4
10	2,348	60	2
15	1,722	70	1
20	1,065	80	1
25	715	90	0
30	502		

3,000K, 90 + of CRI, Flood, Performance 1

CANDLEPOWER DISTRIBUTION

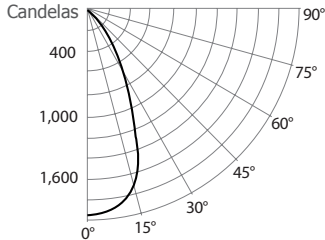

LIGHT CONE

Distance	FC	DIA
06'	54.4	5.4
08'	30.6	7.2
10'	19.6	8.9
12'	13.6	10.7
14'	10.0	12.5
16'	7.6	14.3

Beam: 48.2"
Beam Edge defined as 50% of Maximum Nadir Candle-power.

LUMINAIRE

Modul-Aim Performance 1 LED	3,000K	Flood
CBCP / Lumens	1,958	/ 1,225.9
Watts	120V	277V
	20.9W	21.4W
Operating AMPS	0.17A	0.07A
Lumen Maintenance	L70 @ 50,000 Hrs	
CRI	90 +	
Lumens/Watt	58.7	
Spacing Criteria	0.82	

COEFFICIENT OF UTILIZATION - %

RCC %	80			50			30		
RWC %	50	30	50	30	50	30	50	30	
RCR	0	119	119	111	111	106	106	106	
	2	105	101	100	98	97	95	95	
	4	94	89	90	87	89	85	85	
	6	84	79	82	78	81	77	77	
	8	76	71	75	70	74	70	70	
	10	69	64	68	64	68	63	63	

Zonal Cavity Method

Effective Floor Cavity Reflectance 20%

ZONAL LUMEN SUMMARY

ZONE	LUMENS	%LUMINAIRE
0-30	1,061.0	86.6%
0-40	1,212.8	98.9%
0-60	1,224.7	99.9%
60-90	1.1	0.1%
0-90	1,225.9	100%

MULTIPLE UNIT DATA - (RCR 2)

SPACING ON CENTER	INITIAL FOOTCANDLES	WATTS/SQ. FT.
5'	60	0.93
6'	34	0.52
7'	23	0.36
8'	23	0.36
9'	15	0.23

38' x 38' x 10' Room. Workplan located 2-1/2' (30").
Reflection factor of 80%/50%/30%.

CANDELAS DISTRIBUTION

DEGREES/VERTICAL	CANDELAS	DEGREES/VERTICAL	CANDELAS
0	1,958	40	34
5	1,910	50	4
10	1,845	60	2
15	1,697	70	0
20	1,316	80	0
25	910	90	0
30	600		



Modul-Aim™

ISMOD

LIGHTING FACTS

LED lighting facts®
A Program of the U.S. DOE

Light Output (Lumens)	1155
Watts	20.98
Lumens per Watt (Efficacy)	55.1

Color Accuracy Color Rendering Index (CRI)	97
---	----

Light Color
Correlated Color Temperature (CCT) **2763 (Warm White)**

2700K 3000K 4500K 6500K

Warm White Bright White Daylight

All results are according to IESNA LM-79-2008: Approved Method for the Electrical and Photometric Testing of Solid-State Lighting. The U.S. Department of Energy (DOE) verifies product test data and results.

Visit www.lightingfacts.com for the Label Reference Guide.

Registration Number: LVBP-33Q3K3 (6/22/2015)
Model Number: MOD1-XX-E1-27M
Type: Luminaire - Downlight

LED lighting facts®
A Program of the U.S. DOE

Light Output (Lumens)	1155
Watts	20.98
Lumens per Watt (Efficacy)	55.05

Color Accuracy Color Rendering Index (CRI)	97
---	----

Light Color
Correlated Color Temperature (CCT) **2763 (Warm White)**

2700K 3000K 4500K 6500K

Warm White Bright White Daylight

All results are according to IESNA LM-79-2008: Approved Method for the Electrical and Photometric Testing of Solid-State Lighting. The U.S. Department of Energy (DOE) verifies product test data and results.

Visit www.lightingfacts.com for the Label Reference Guide.

Registration Number: LVBP-3KZQLE (6/22/2015)
Model Number: MOD1-XX-E1-27MS
Type: Luminaire - Downlight

LED lighting facts®
A Program of the U.S. DOE

Light Output (Lumens)	1249
Watts	20.99
Lumens per Watt (Efficacy)	59.5

Color Accuracy Color Rendering Index (CRI)	97
---	----

Light Color
Correlated Color Temperature (CCT) **2767 (Warm White)**

2700K 3000K 4500K 6500K

Warm White Bright White Daylight

All results are according to IESNA LM-79-2008: Approved Method for the Electrical and Photometric Testing of Solid-State Lighting. The U.S. Department of Energy (DOE) verifies product test data and results.

Visit www.lightingfacts.com for the Label Reference Guide.

Registration Number: LVBP-L7FQVM (6/22/2015)
Model Number: MOD1-XX-E1-27S
Type: Luminaire - Downlight

LED lighting facts®
A Program of the U.S. DOE

Light Output (Lumens)	1208
Watts	20.99
Lumens per Watt (Efficacy)	57.6

Color Accuracy Color Rendering Index (CRI)	97
---	----

Light Color
Correlated Color Temperature (CCT) **2760 (Warm White)**

2700K 3000K 4500K 6500K

Warm White Bright White Daylight

All results are according to IESNA LM-79-2008: Approved Method for the Electrical and Photometric Testing of Solid-State Lighting. The U.S. Department of Energy (DOE) verifies product test data and results.

Visit www.lightingfacts.com for the Label Reference Guide.

Registration Number: LVBP-QXM5Q2 (6/22/2015)
Model Number: MOD1-XX-E1-27W
Type: Luminaire - Downlight

LED lighting facts®
A Program of the U.S. DOE

Light Output (Lumens)	1268
Watts	20.9
Lumens per Watt (Efficacy)	60.7

Color Accuracy Color Rendering Index (CRI)	91
---	----

Light Color
Correlated Color Temperature (CCT) **2995 (Warm White)**

2700K 3000K 4500K 6500K

Warm White Bright White Daylight

All results are according to IESNA LM-79-2008: Approved Method for the Electrical and Photometric Testing of Solid-State Lighting. The U.S. Department of Energy (DOE) verifies product test data and results.

Visit www.lightingfacts.com for the Label Reference Guide.

Registration Number: LVBP-Q21AA (6/22/2015)
Model Number: MOD1-XX-E1-30W
Type: Luminaire - Downlight



CONTRAST

L I G H T I N G

2015-12

1009, rue du Parc Industriel
Lévis (Québec) G6Z 1C5 Canada
Tel.: 1-888-839-4624 Fax: 1-877-839-7057
info@contrastlighting.com
www.contrastlighting.com

© 2015 Contrast Lighting M.L. Inc.
All rights reserved

Contrast Lighting reserves the right to make changes in specifications and/or to discontinue any product at any time without notice or obligation and will not be liable for any consequences resulting from the use of this publication.

Modul-Aim™

ISMOD

INSULATED CEILING UNIT WITH STANDARD LED ENGINE CODIFICATION EXAMPLE

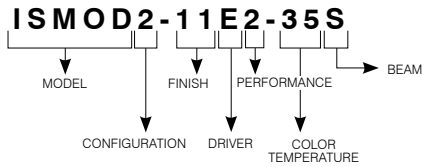

ORDERING CODE for Insulated Ceiling Unit with Standard LED Engine

MODEL	CONFIGURATION	FINISH	DRIVER	PERFORMANCE	COLOR TEMPERATURE	BEAM	
ISMOD				1			
ISMOD	Insulated Ceiling	1 1 unit 2 2 units	-11 Matte White -22 Matte Black	E ELV D 0-10V A Lutron Ecosystem Addressable	1 1,267 Lumens (delivered)	-27 2,700K -30 3,000K -35 3,500K -40 4,000K	S Spot 15° MS Medium Spot 19° M Narrow Flood 32° W Flood 45°

Trim, mask and trimless mesh plate to be ordered separately based on your configuration.

INSULATED CEILING UNIT WITH CRISPWHITE TECHNOLOGY CODIFICATION EXAMPLE

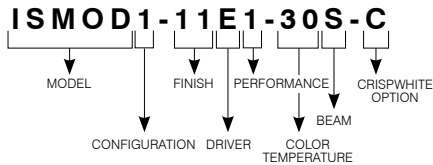

ORDERING CODE for Insulated Ceiling Unit with CrispWhite Technology

MODEL	CONFIGURATION	FINISH	DRIVER	PERFORMANCE	COLOR TEMPERATURE	BEAM	CRISPWHITE OPTION	
ISMOD				1	-30		-C	
ISMOD	Insulated Ceiling	1 1 unit 2 2 units	-11 Matte White -22 Matte Black	E ELV D 0-10V A Lutron Ecosystem Addressable	1 1,195 Lumens (delivered)	-30 3,000K	S Spot 15° MS Medium Spot 19° M Narrow Flood 32° W Flood 45°	-C CrispWhite Technology

Trim, mask and trimless mesh plate to be ordered separately based on your configuration.



Modul-Aim™

ISMOD

INSULATED CEILING UNIT WITH LUMENETIX ENGINE CODIFICATION EXAMPLE

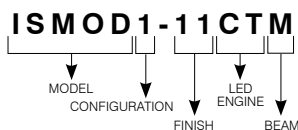

ORDERING CODE for Insulated Ceiling Unit with Lumenetix Engine

MODEL	CONFIGURATION	FINISH	LED ENGINE	BEAM
ISMOD				
ISMOD Insulated Ceiling	1 1 unit 2 2 units	-11 Matte White -22 Matte Black	CT Color Tuning WD Warm Dimming	M Narrow Flood 26° W Flood 41°

Trim, mask and trimless mesh plate to be ordered separately based on your configuration.

TRIM CODIFICATION EXAMPLE

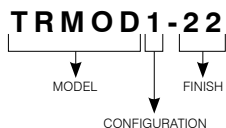

ORDERING CODE for Trim

MODEL	CONFIGURATION	FINISH
TRMOD		
TRMOD	1 1 unit 2 2 units	-11 Matte White -15 Metallic Grey -22 Matte Black

MESH PLATE (TRIMLESS) CODIFICATION EXAMPLE

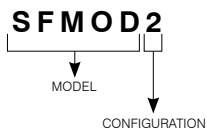

ORDERING CODE for Mesh Plate (Trimless)

MODEL	CONFIGURATION
SFMOD	
SFMOD	1 1 unit 2 2 units



Modul-Aim™

ISMOD

MASK CODIFICATION EXAMPLE

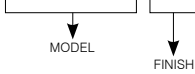
MASK1-11

ORDERING CODE for Mask

MODEL	FINISH
MASK1	
MASK1	-11 Matte White
	-22 Matte Black

ORDERING CODES for replacement lenses and reflectors

For future on site modifications of the light distribution.

Lenses (to modify light diffusion)

Clear: **103105**
 Frosted: **103189**
 Honeycombs: **103822**
 Linear: **103823**
 Prismatic: **103824**
 Solite: **100741**

Reflectors (to modify the beam angle)

*** Only with standard engine and CrispWhite technology**

For a Spot: **103737**
 For a Medium Spot: **103738**
 For a Narrow Flood: **103739**
 For a Flood: **316545**

CONTRAST
 LIGHTING

2015-12

1009, rue du Parc Industriel
 Lévis (Québec) G6Z 1C5 Canada
 Tel.: 1-888-839-4624 Fax: 1-877-839-7057
 info@contrastlighting.com
 www.contrastlighting.com

© 2015 Contrast Lighting M.L. Inc.
 All rights reserved

Contrast Lighting reserves the right to make changes in specifications and/or to discontinue any product at any time without notice or obligation and will not be liable for any consequences resulting from the use of this publication.

