

# MONORAIL FAST JACK CONNECTORS

REV.11.17.15

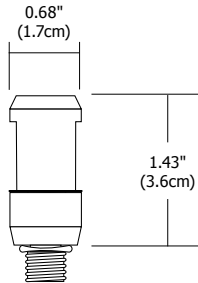

## Monorail Fast Jack Fixture Connector

The Monorail Fast Jack Fixture Connector attaches any Fast Jack head or pendant to Monorail. Satin nickel, polished nickel or antique bronze finish.

### Weight:

.10 lb (.045 kg)

System	Type	Finish
<b>MC</b>	<b>FJ</b>	<b>SN</b>
MC Monorail Connector	FJ Fast Jack	SN Satin Nickel PN Polished Nickel BZ Antique Bronze

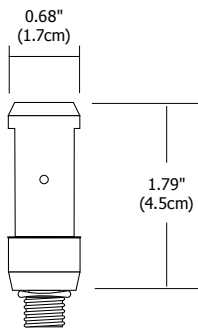

## Monorail 2 Circuit Fast Jack Fixture Connector

The Monorail 2 Circuit Fast Jack Fixture Connector attaches any Fast Jack head or pendant to Monorail 2 Circuit. Satin nickel, polished nickel or antique bronze finish.

### Weight:

.12 lb (.054 kg)

System	Type	Finish
<b>M2C</b>	<b>FJ</b>	<b>SN</b>
M2C Monorail 2 Circuit Connector	FJ Fast Jack	SN Satin Nickel PN Polished Nickel BZ Antique Bronze

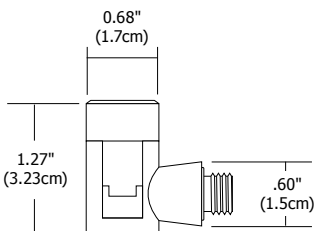

## Monorail Wall Fast Jack Fixture Connector

The Monorail Wall Fast Jack Fixture Connector attaches select Fast Jack heads to Monorail Wall. Satin nickel, polished nickel or antique bronze finish.

### Weight:

.11 lb (.045 kg)

System	Type	Finish
<b>MWC</b>	<b>FJ</b>	<b>SN</b>
MWC Monorail Wall Connector	FJ Fast Jack	SN Satin Nickel PN Polished Nickel BZ Antique Bronze

PROJECT:

FIXTURE  
TYPE:

DATE:

