



1718 W. Fullerton Chicago, IL 60614
 Ph: 773.770.1195 • Fax: 773.935.5613
 www.PureEdgeLighting.com • info@PureEdgeLighting.com
 © 2016 PureEdge Lighting. All Rights Reserved.

Installation Instructions for TruLine 1.6A Channel and Lens

IMPORTANT INFORMATION

- This instruction must be used concurrently with other TruLine 1.6A BIY installation instructions.
- This product is wall or ceiling mount.
- This instruction shows a typical installation.

SAVE THESE INSTRUCTIONS!

Section One: Prepare and Cut the Channel

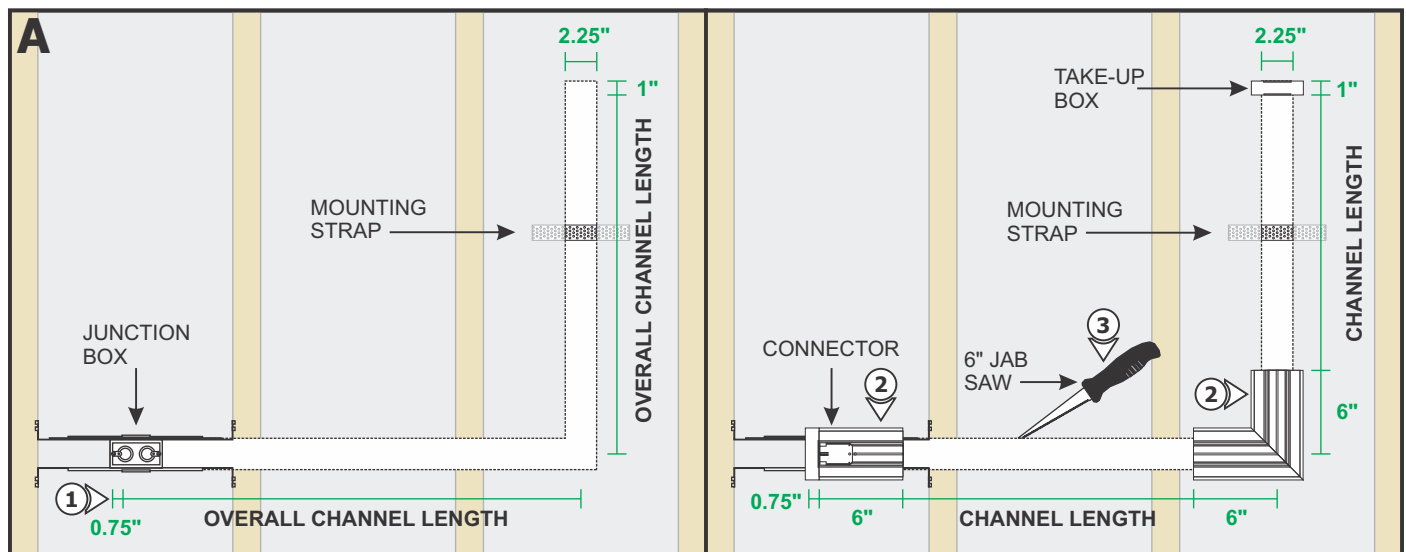

NOTE: Refer to the instructions provided with any of the TL1.6A Power Channel Connectors to install the junction box.

- 1: Mark the area where the installation will be located on the drywall using the junction box opening as a guide (MIN 2.25"). Allow for 0.75" extra space at junction box for power end caps (if any) and 1" at the end of the installation for the Take-Up Box.
- 2: Place the desired BIY Channel Connectors against the wall. Ensure the connector is aligned with the installation location. Mark the location of each BIY Channel Connector to determine the cut length of the channel and lens.
- 3: Cut out the marked area using a "Dremel Multi-Max" or a 6" Fixed Jab Saw. Mark the location of the studs on the drywall.

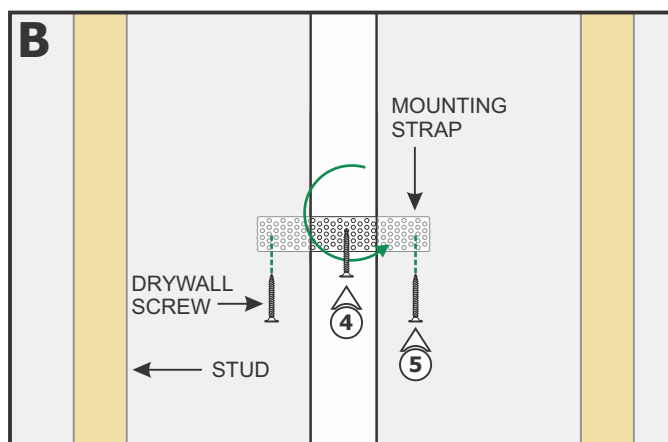

NOTE: To install the channel in a wall without standard-spaced studs, install perforated mounting straps every 32" behind drywall.

NOTE: For areas with lots of vibrations, it is suggest to install 2X4 support braces (suggested spacing is every 32") before installing and finishing drywall to avoid cracking of plaster. Refer to step 6.

- 4: Thread a drywall screw into the perforated material. Place the mounting strap behind the drywall and rotate into place using the drywall screw.
- 5: Secure the mounting strap to the drywall using two drywall screws. Mark the location on of the mounting strap on the drywall.

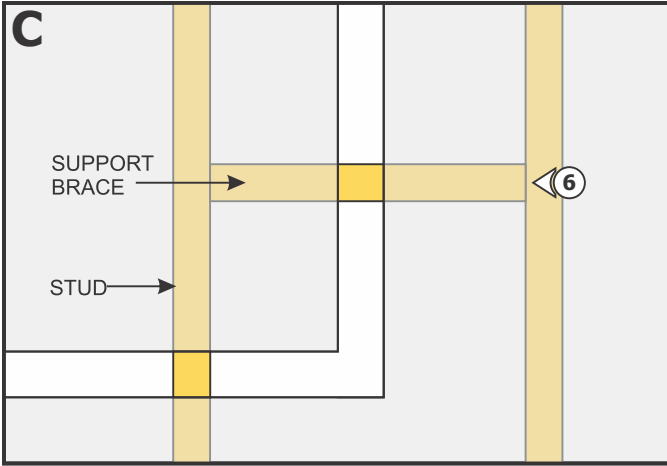

ALTERNATE INSTALLATION OPTION:
 6: Install 2x4 support braces (suggested spacing is every 32") before installing and finishing drywall.

7: Snap the lens into the channel **BEFORE** cutting to length. This ensures a proper fit after installation.

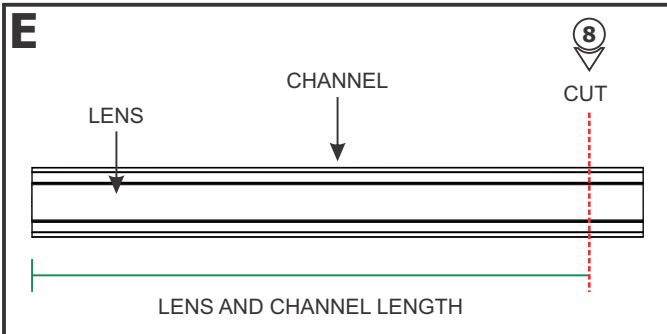
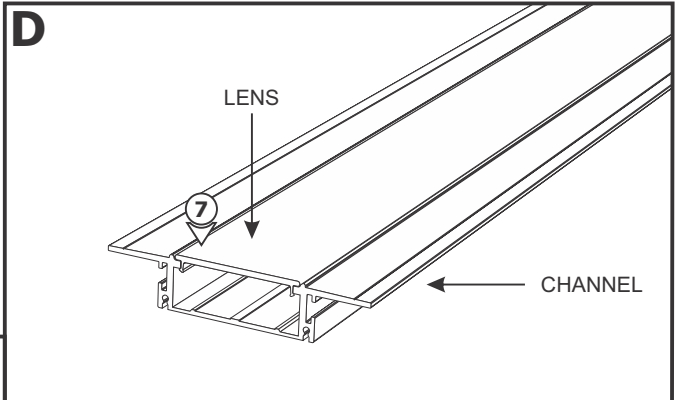

8: Cut the channel and lens to match the desired lit installation length.

Section Two: Install Channels and Connectors

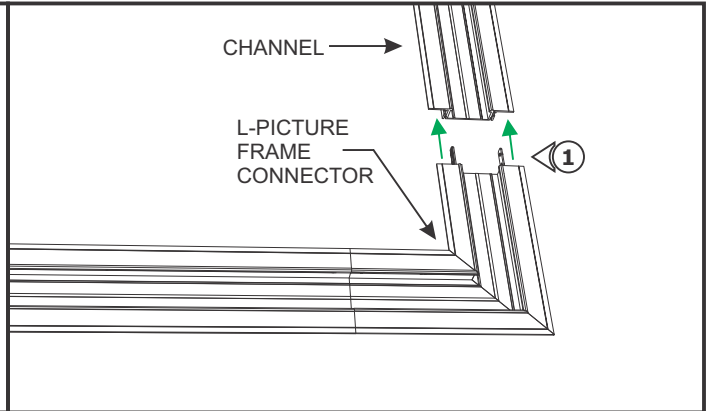
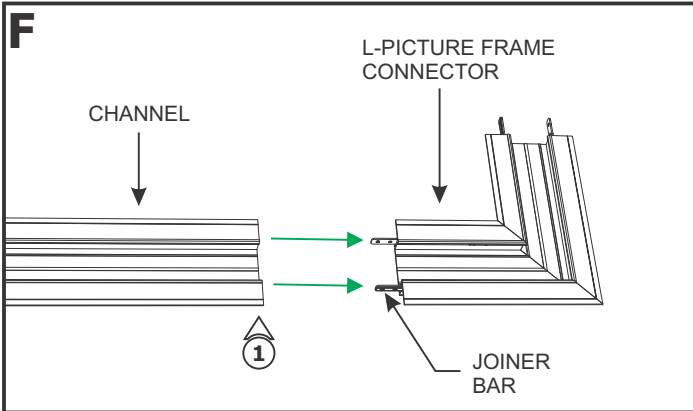

NOTE: TL1.6A L-Picture Frame connector is shown for demonstration purposes.

1: Install channel connector(s) to the channels. Refer to the instructions provided with the desired TL1.6A channel connector.

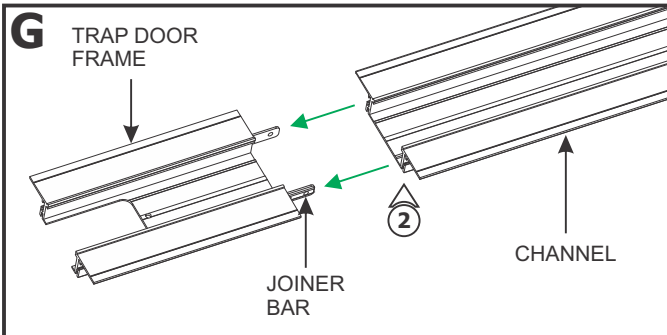

NOTE: TL1.6A End Feed Power is shown for demonstration purposes.

2: Install TL1.6A powered connectors to the channels. Slide a channel onto the joiner bars on the trap door frame and tighten the two M3 set screws using a 1.5mm Allen wrench.

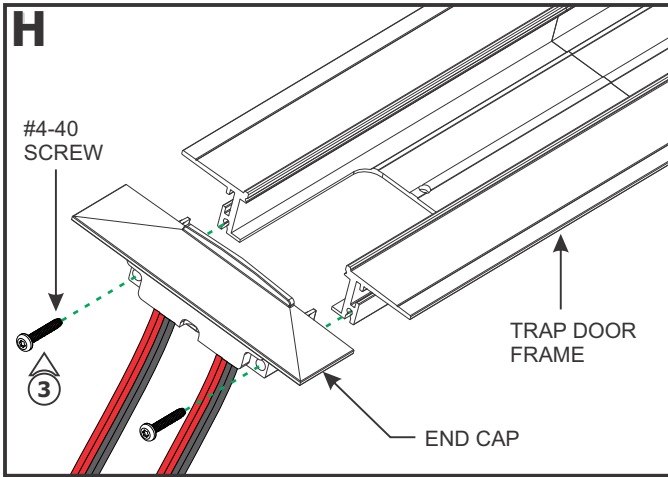

NOTE: Refer to instructions provided with the TL1.6A-EP to wire and install B90 Connector or Snap & Light Connector.

3: Secure the end cap to the trap door frame with the two #4-40 Torx screws using a T10 Torx screw driver.

4: Loosen (**Do Not Remove**) the four M3 set screws on the Take-Up Box using a 1.5mm Allen wrench.

5: Install the Take-Up Box at the end of an installation run. Slide the Take-Up Box into the channel and tighten the four M3 set screws using a 1.5mm Allen wrench to secure in place.

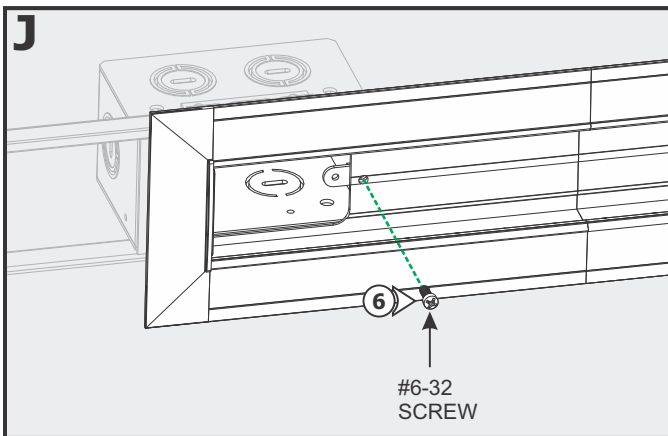
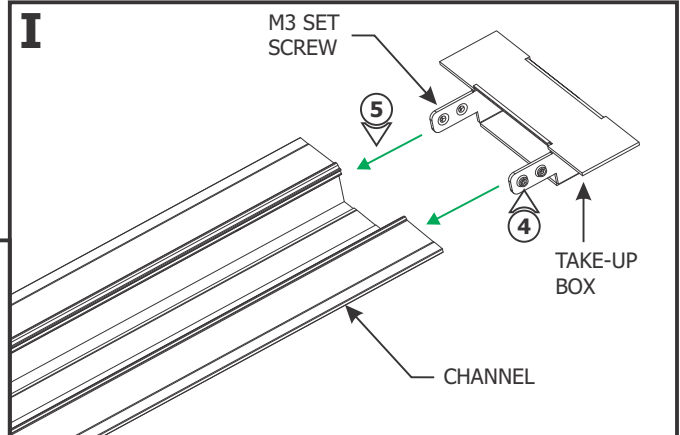

6: Place the assembled channel to the drywall cutout. Attach the assembled trap door frame and channel to the junction box using the #6-32 screw.

Section Three: Tape and Plaster

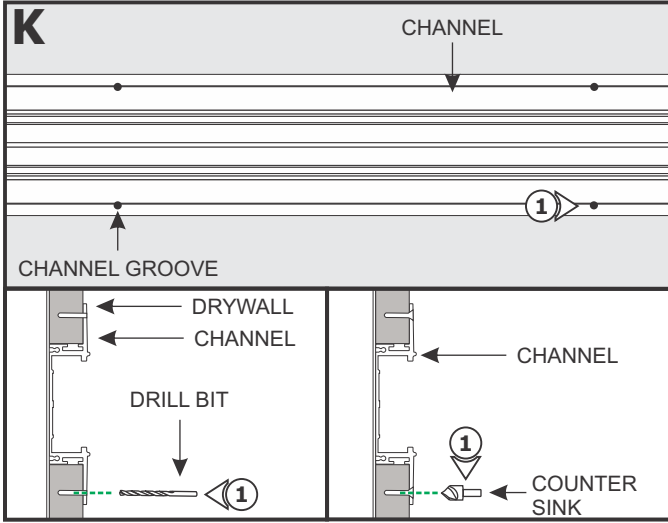

1: Using the marked locations on the drywall, drill and countersink the channel using the provided square drill with countersink bit.

2: Secure the channel to the studs and mounting straps through the drywall with the #6 screws using the provided square recess bit.

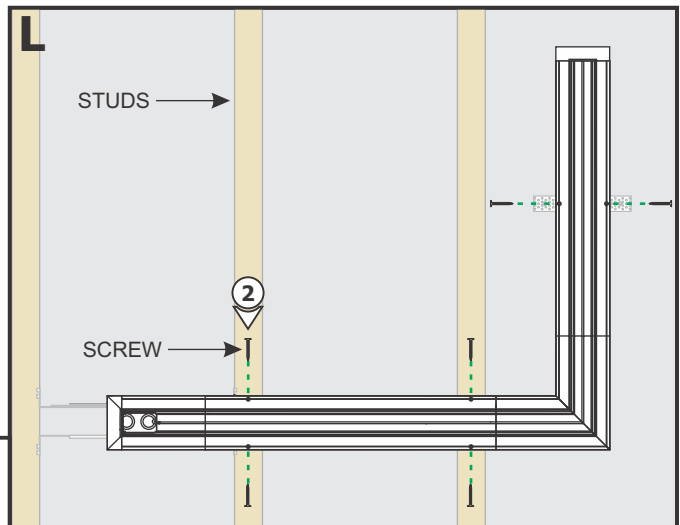

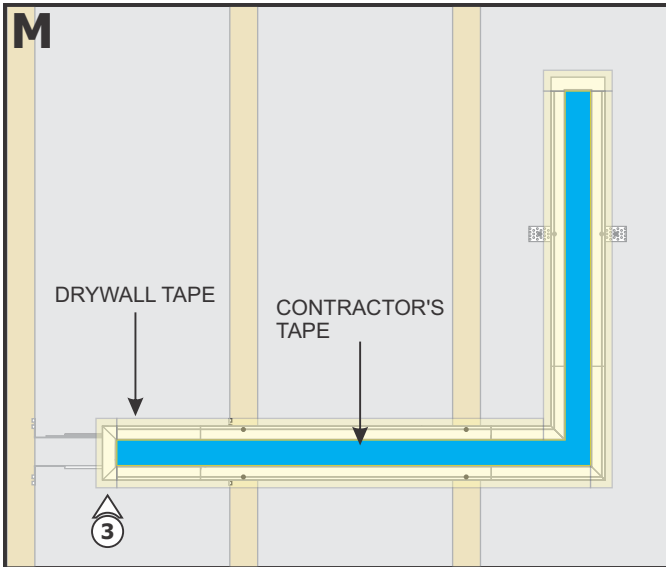

NOTE: Cover the channel opening with blue contractor's tape before plastering.

NOTE: For areas with lots of vibration, it is suggested to use Durabond to avoid cracking of plaster.

NOTE: Do Not use premixed joint compound "Soft Mud." No use compuesto para juntas premezclado "Soft Mud."

3: Must apply drywall tape (Ultra-Thin drywall tape suggested) along edges of channel to prevent cracking of plaster after installation. **DO NOT** overlap strips of drywall tape.

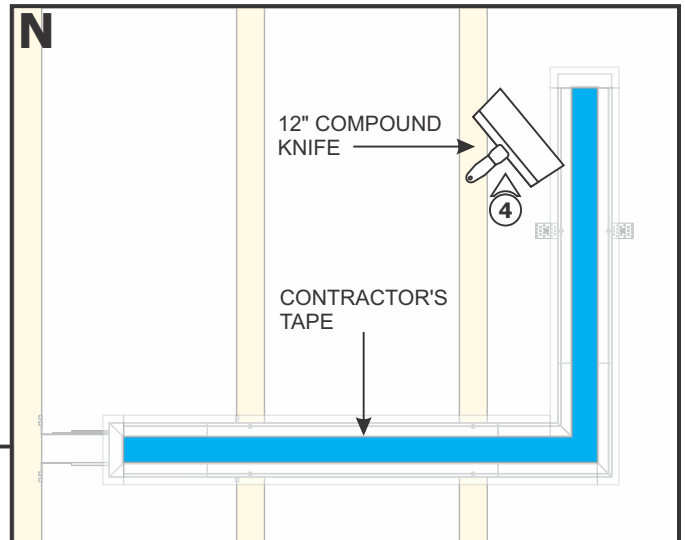

4: Use a compound knife for a smooth compound spread. Sand, paint, and finish the plaster and drywall before removing the blue contractor's tape.

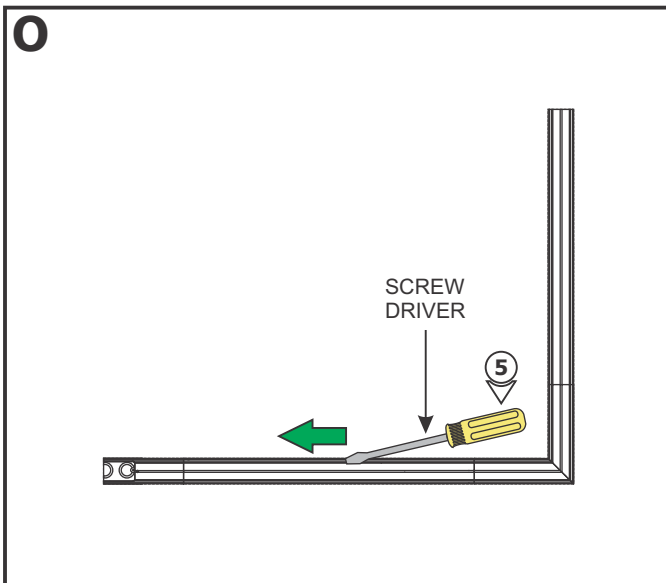

5: Carefully use a flathead screwdriver to remove excess drywall from the internal bevel/edge.

6: Remove the blue contractor's tape from the inside of the channel. Clean the channel surface with alcohol to remove any dust or debris before continuing.

7: Replace the trap door and secure using the #6-32 screw.

NOTE: If installation requires RGB, RGB+W, or Tunable White, refer to wiring diagrams on pages 8-10.

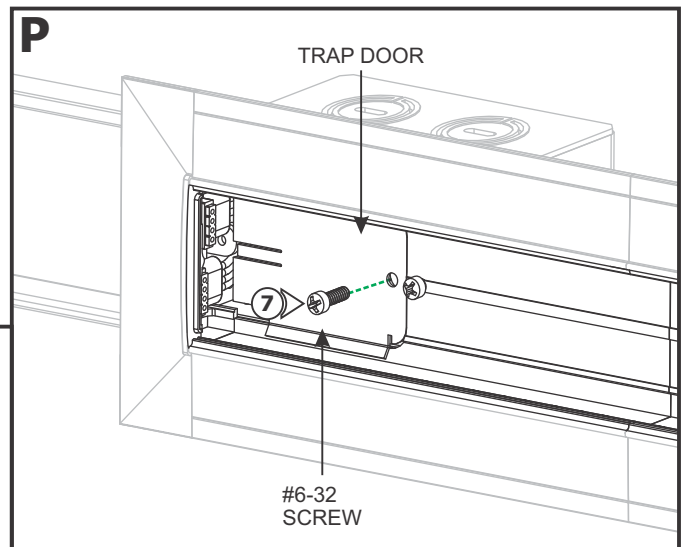

Section Four: Install LED Soft Strip

Q

BOTTOM MOUNT

B90 CONNECTOR

PAPER BACKING

LED STRIP

BOTTOM MOUNT

SNAP & LIGHT CONNECTOR

1: Connect the LED strips to the power connectors. Refer to instructions provided with the TL1.6A Power Channel Connectors to connect the LED strips to the desired power connectors.

2: Carefully remove the backing from each LED strip, making sure not to remove the tape from the LED strips. Firmly press down the adhesive portion of the LED strip onto the channel surface while removing the rest of the backing, making sure there are no air bubbles that can cause surface irregularities.

NOTE: Refer to page 7 for important information regarding installation and rework of the LED strip.

R

LED STRIP BOTTOM MOUNT

3: For Room Wrapping configurations, bend the LED strips 90° flat on the channel to match the corners. Ensure the entire length of the channel is covered with LED strip to avoid unlit areas.

S

SIDE MOUNT

LED STRIP

SIDE MOUNT

LED STRIP

Alternate Power Feed Installation

4: Connect the LED strips to the power connectors.

5: Repeat step 2 to properly install the LED strip on the sides of the channel.

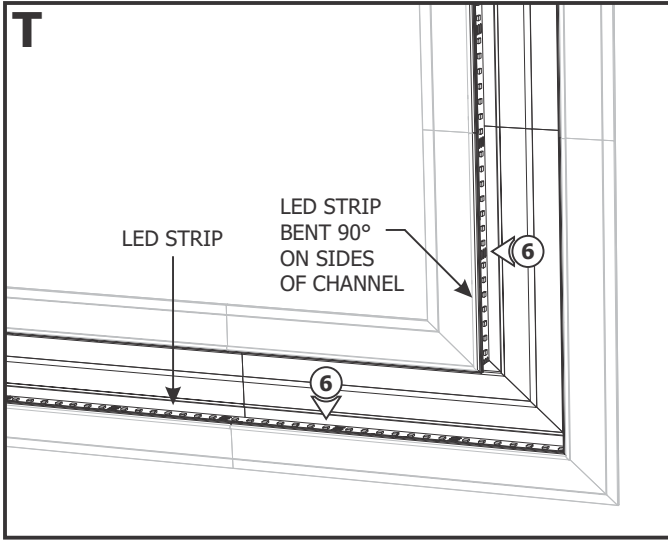

6: For Picture Frame configurations, bend the LED strips 90° on the sides of the channel to match the installation corner. Ensure the entire length of the channel is covered with LED strip to avoid unlit areas.

7: If required, trim the LED strips on the dashed cuttable section, place the excess LED strips inside the Take-Up Box. Ensure the entire length of the channel is covered with LED strips to avoid unlit areas.

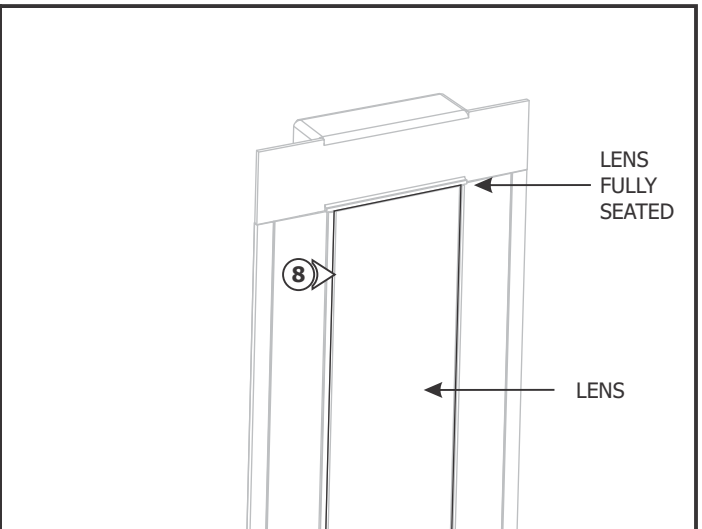
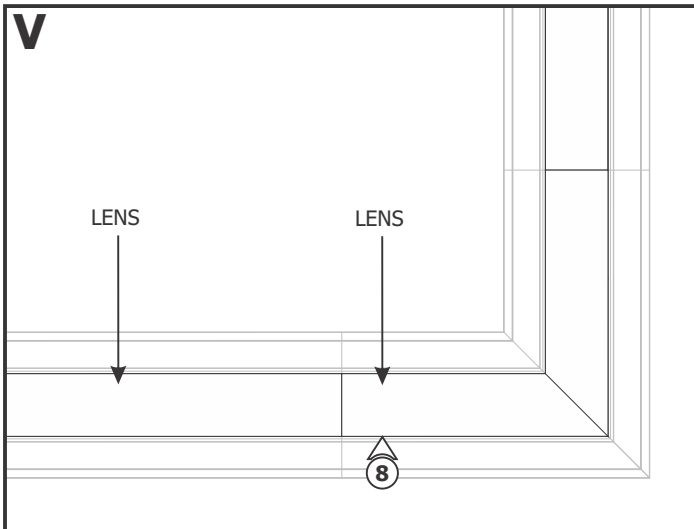
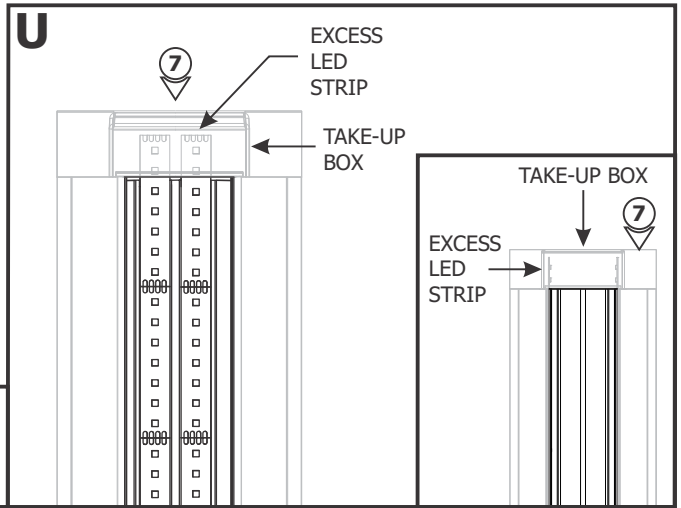

8: Snap the lens onto the channels and connectors. Ensure the lenses are fully seated.

IMPORTANT INFORMATION REGARDING INSTALLATION AND REWORK OF SOFT STRIP LED

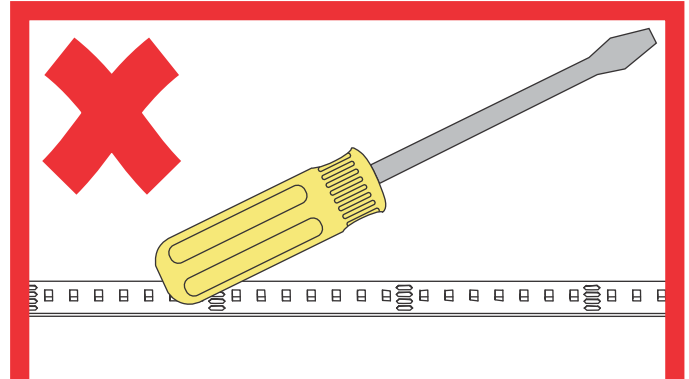
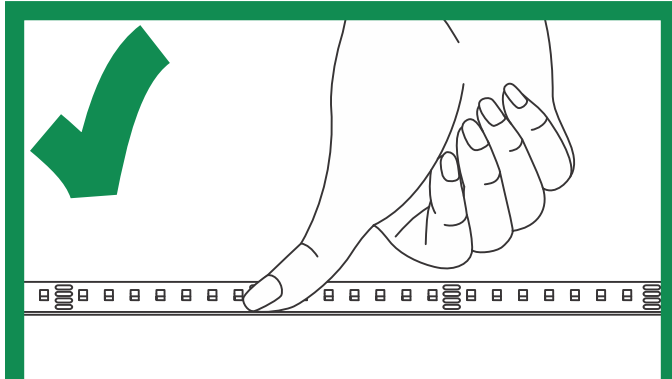
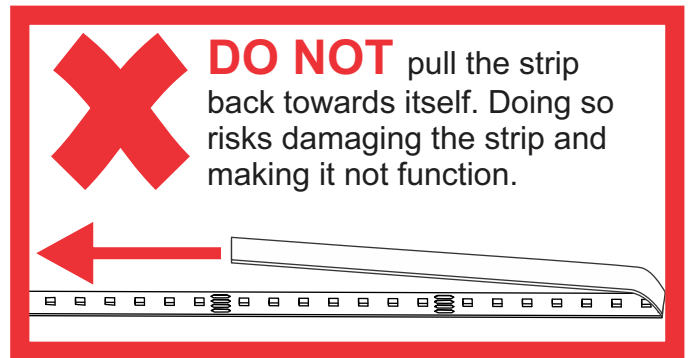
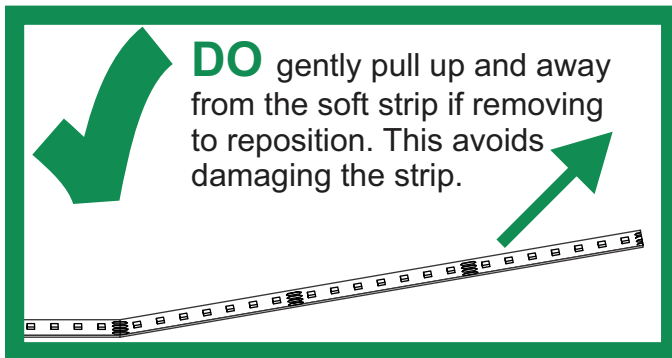

Section Five: Relocating Soft Strip (Optional)

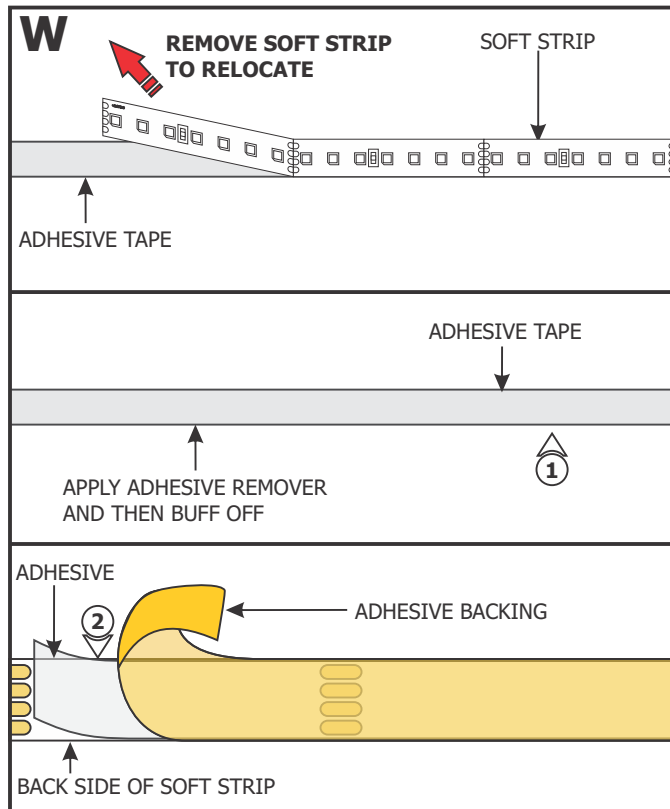

NOTE: If relocating the installed soft strip, make sure that the adhesive tape on back of the soft strip covers the entire strip. The adhesive tape isolates the strip from the installation surface. Damaged or inconsistent adhesive tape may cause the contacts on the back of the strip to come in contact with the conductive heat sink which will cause the strip to short and burn. Call Edge Lighting to get replacement adhesive tape and/or optional aluminum heat sink tape (SS-HR-F).

- 1:** To remove tape residue from back of the strip, apply WD-40, Goo Gone, or a mixture of warm water and lemon oil to the corner of a clean, dry towel. Gently buff the area containing the adhesive residue until it is completely removed.
- 2:** Gently remove a few inches from one side of the tape backing. Attach the adhesive tape to the back of the soft strip and apply moderate pressure to affix the tape. Continue this step a few inches at the time until the entire adhesive tape is attached to back of the soft strip.
- 3:** Refer to Section Four to reinstall the LED soft strip.

RGB+W Configuration

Using LED Power Supply with RGB+W Soft Strip & CDP, CTP, or CDMX Control

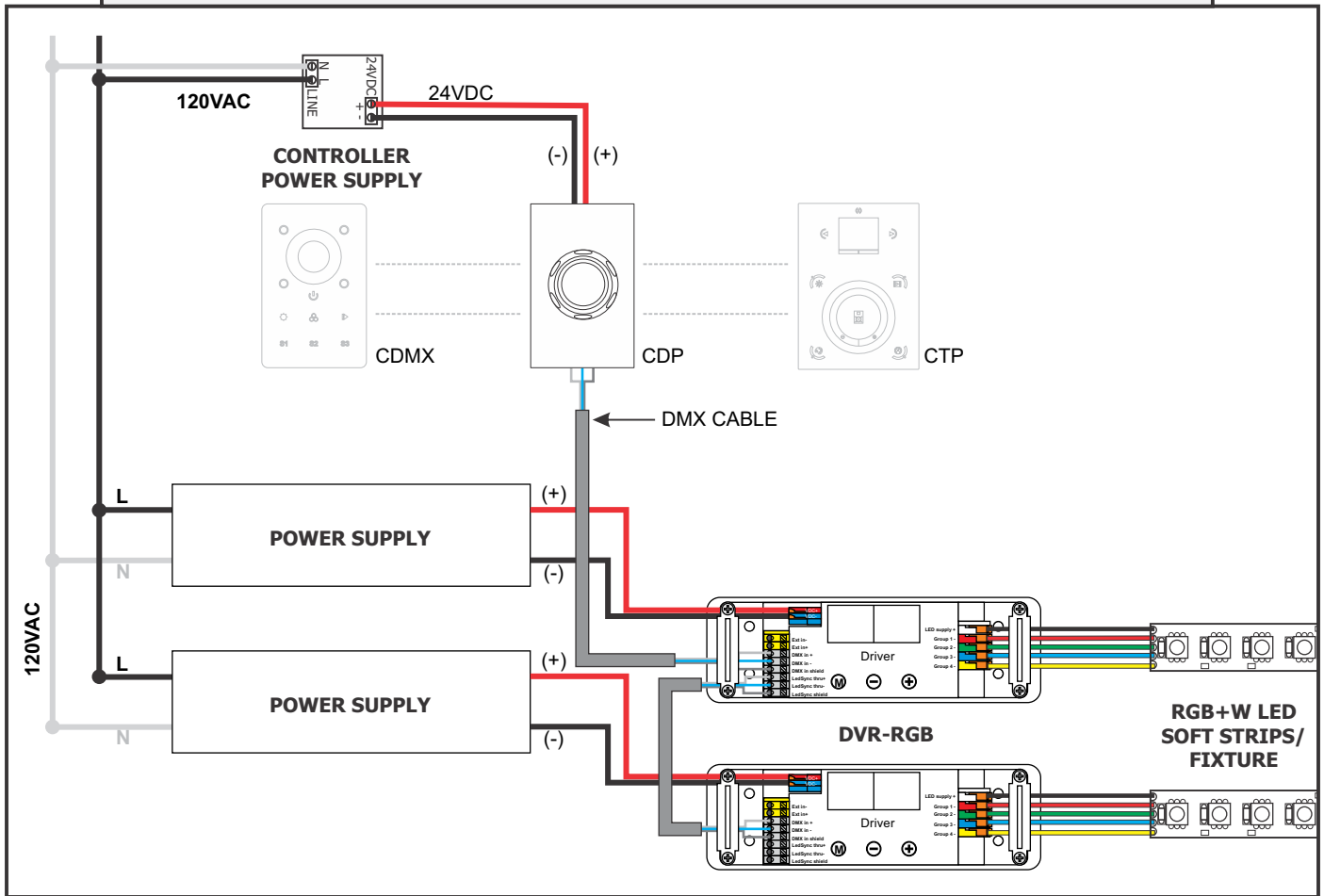

Tunable White Configuration

Dual Power Supplies Controlled Via Individual ELV Dimmers

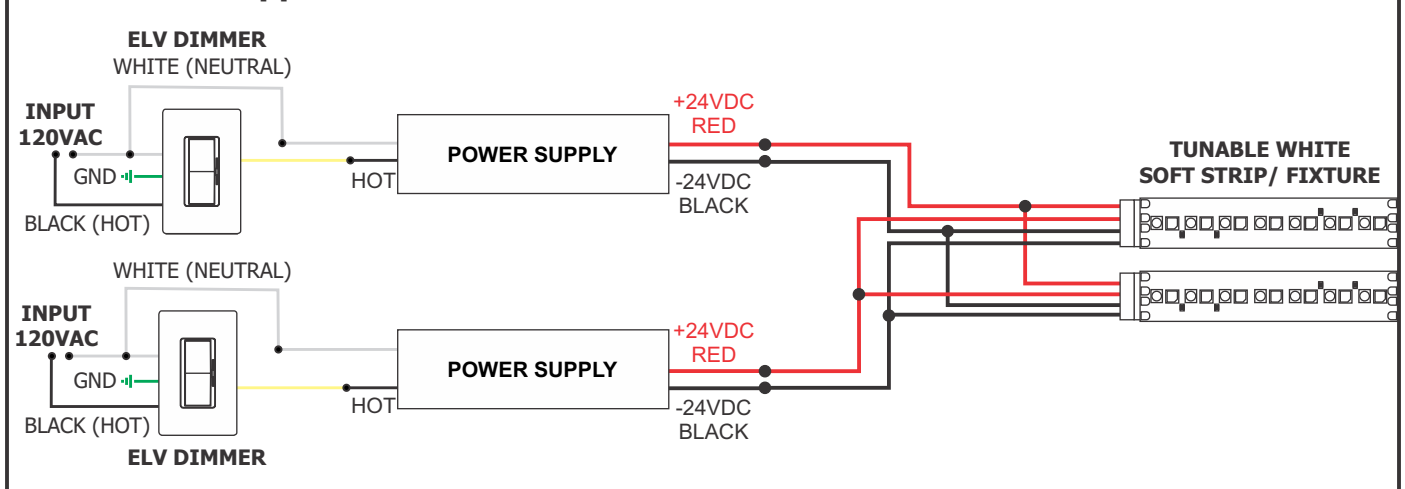

Section Six: Wiring Diagrams

General 24VDC Configuration

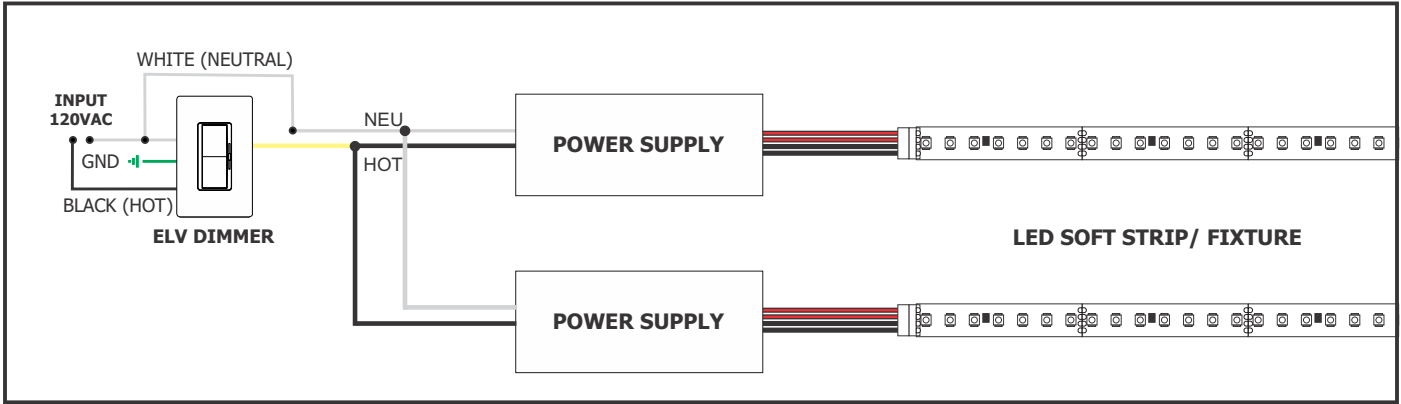

Standard RGB Configuration

Using LED Power Supply with RGB Soft Strip & CDP, CTP, or CDMX Control

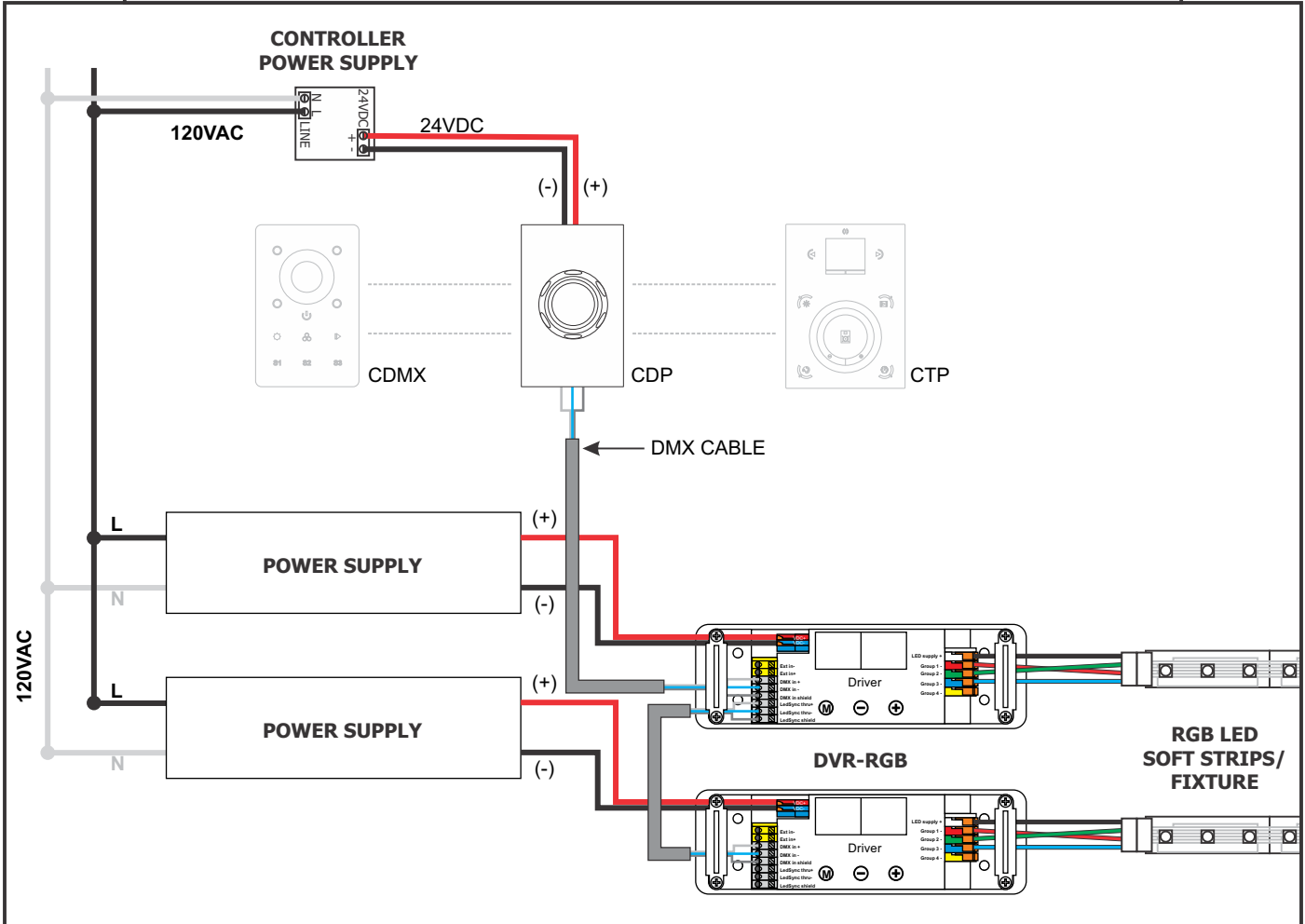

Tunable White Configuration

Power Supply with DMX Driver

If using a CDP Color Dial, configure your CDP to Warm White mode using DIP switches and follow CDP operating instructions:

