



1718 W. Fullerton Chicago, IL 60614
 Ph: 773.770.1195 • Fax: 773.935.5613
 www.PureEdgeLighting.com • info@PureEdgeLighting.com
 © 2016 PureEdge Lighting. All Rights Reserved.

Installation Instructions for TruLine 1A Channel and Lens

IMPORTANT INFORMATION

- This instruction must be used concurrently with other TruLine 1A BIY installation instructions.
- This product is wall or ceiling mount.
- This instruction shows a typical installation.

SAVE THESE INSTRUCTIONS!

Section One: Prepare and Cut the Channel

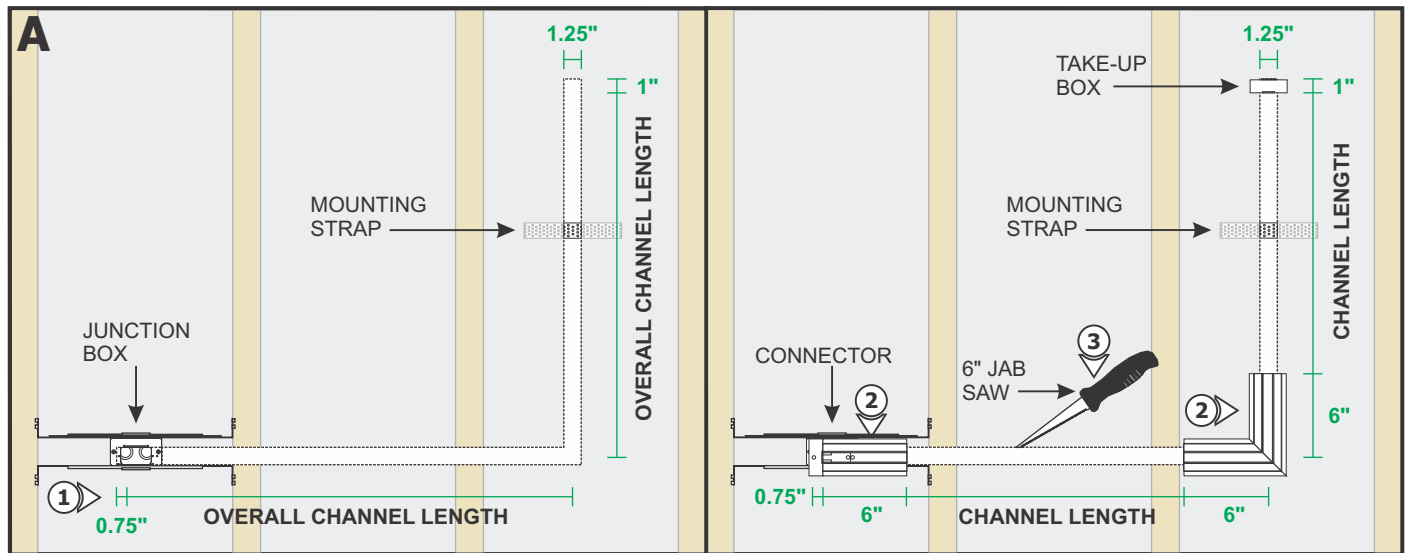

NOTE: Refer to the instructions provided with any of the TL1A Power Channel Connectors to install the junction box.

- 1: Mark the area where the installation will be located on the drywall using the junction box opening as a guide (MIN 1.25"). Allow for 0.75" extra space at junction box for power end caps (if any) and 1" at the end of the installation for the Take-Up Box.
- 2: Place the desired BIY Channel Connectors against the wall. Ensure the connector is aligned with the installation location. Mark the location of each BIY Channel Connector to determine the cut length of the channel and lens.
- 3: Cut out the marked area using a "Dremel Multi-Max" or a 6" Fixed Jab Saw. Mark the location of the studs on the drywall.

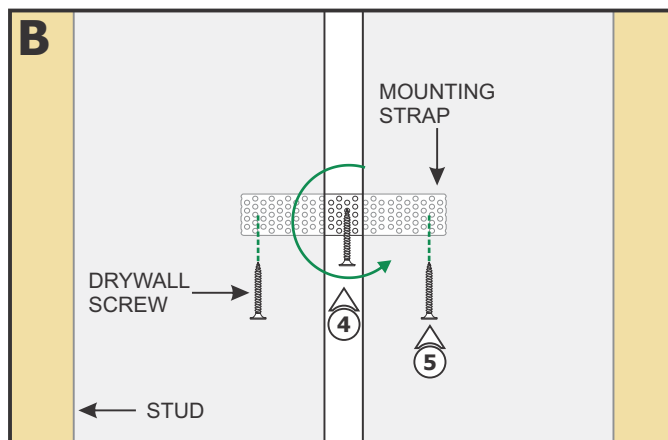

NOTE: To install the channel in a wall without standard-spaced studs, install perforated mounting straps every 32" behind drywall.

NOTE: For areas with lots of vibrations, it is suggest to install 2X4 support braces (suggested spacing is every 32") before installing and finishing drywall to avoid cracking of plaster. Refer to step 6.

- 4: Thread a drywall screw into the perforated material. Place the mounting strap behind the drywall and rotate into place using the drywall screw.
- 5: Secure the mounting strap to the drywall using two drywall screws. Mark the location on of the mounting strap on the drywall.

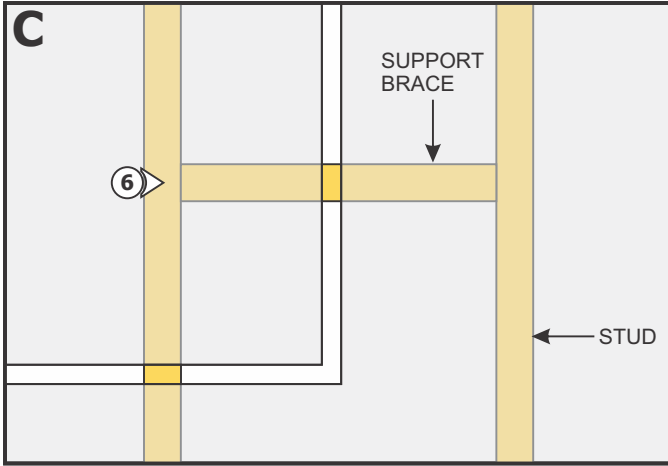

ALTERNATE INSTALLATION OPTION:
6: Install 2x4 support braces (suggested spacing is every 32") before installing and finishing drywall.

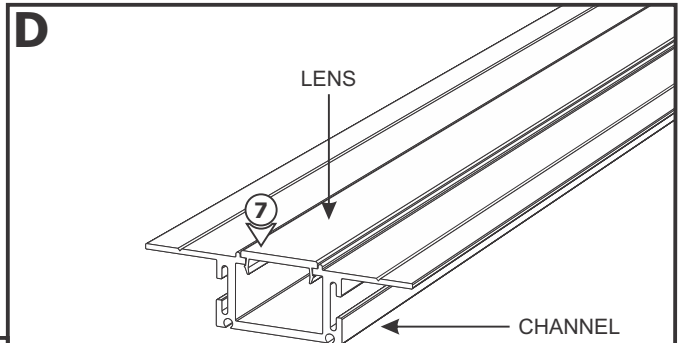

7: Snap the lens into the channel **BEFORE** cutting to length. This ensures a proper fit after installation.

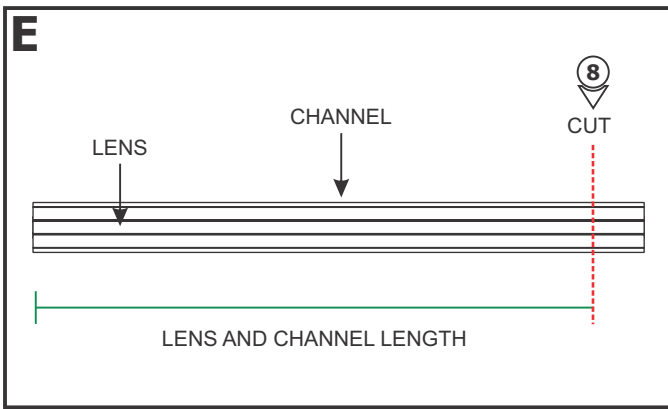

8: Cut the channel and lens to match the desired lit installation length.

Section Two: Install Channels and Connectors

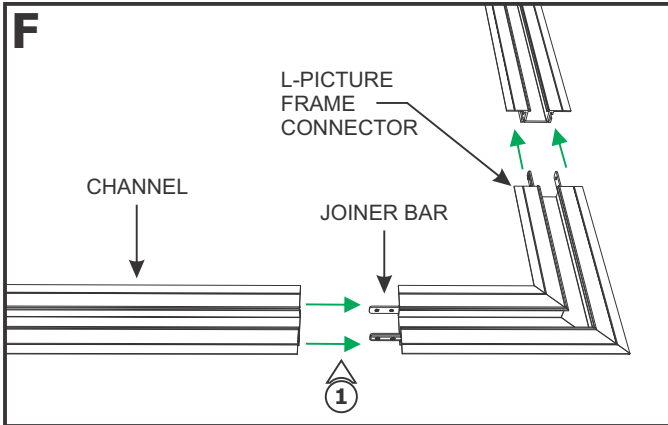

NOTE: TL1A L-Picture Frame connector is shown for demonstration purposes.
1: Install channel connector(s) to the channels. Refer to the instructions provided with the desired TL1A channel connector.

NOTE: TL1A End Feed Power is shown for demonstration purposes.
2: Install TL1A powered connectors to the channels. Slide a channel onto the joiner bars on the trap door frame and tighten the two M3 set screws using a 1.5mm Allen wrench.

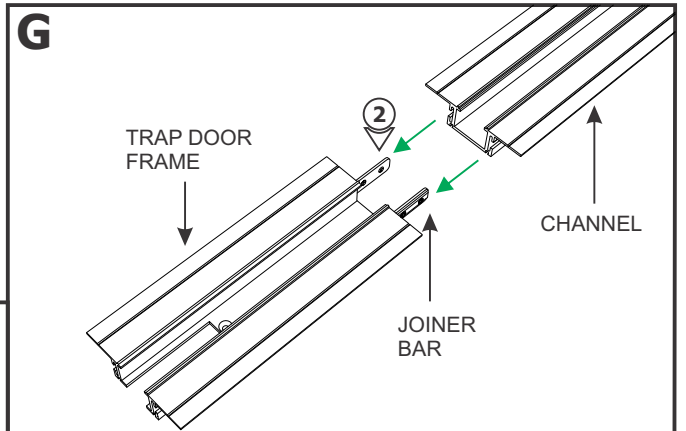

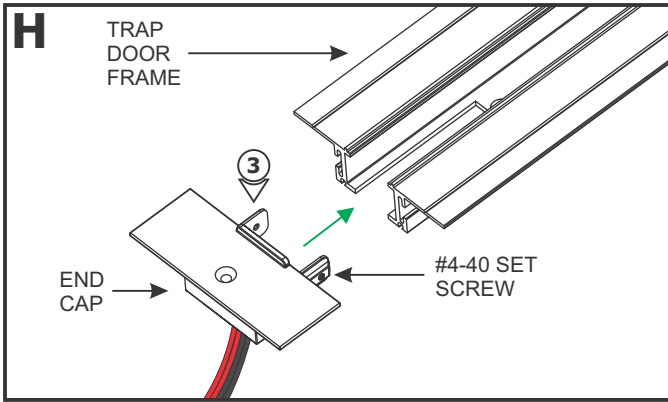

NOTE: Refer to instructions provided with the TL1A-EP to wire and install B90 Connector or Snap & Light Connector.

3: Insert the end cap into the TruLine 1A trap door frame and tighten the two #4-40 set screws with a 0.05" Allen wrench.

4: Loosen (**Do Not Remove**) the two M3 set screws on the Take-Up Box using a 1.5mm Allen wrench.

5: Install the Take-Up Box at the end of an installation run. Slide the Take-Up Box into the channel and tighten the two M3 set screws using a 1.5mm Allen wrench to secure in place.

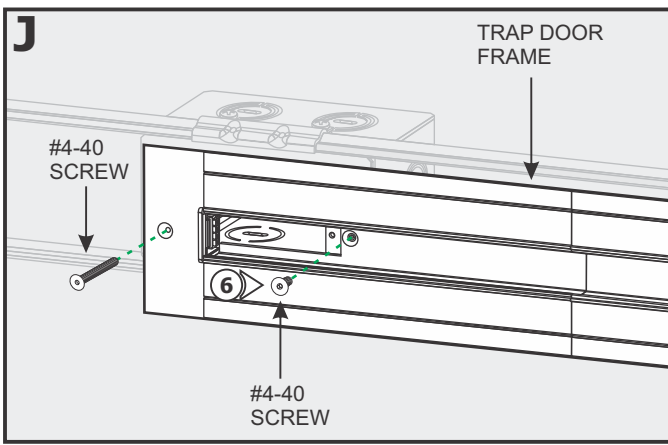
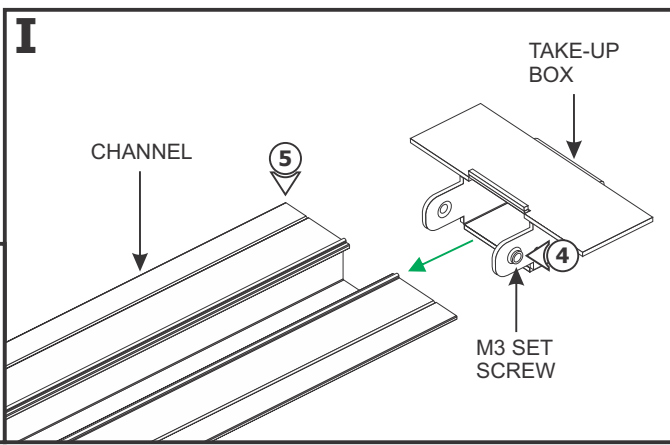

6: Place the assembled channel to the drywall cutout. Attach the assembled trap door frame and channel to the junction box using the #4-40 screws.

Section Three: Tape and Plaster

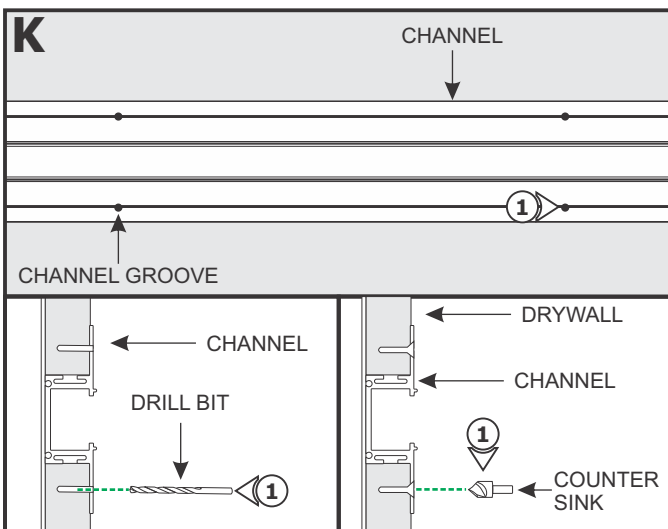

1: Using the marked locations on the drywall, drill and countersink the channel using the provided square drill with countersink bit.

2: Secure the channel to the studs and mounting straps through the drywall with the #6 screws using the provided square recess bit.

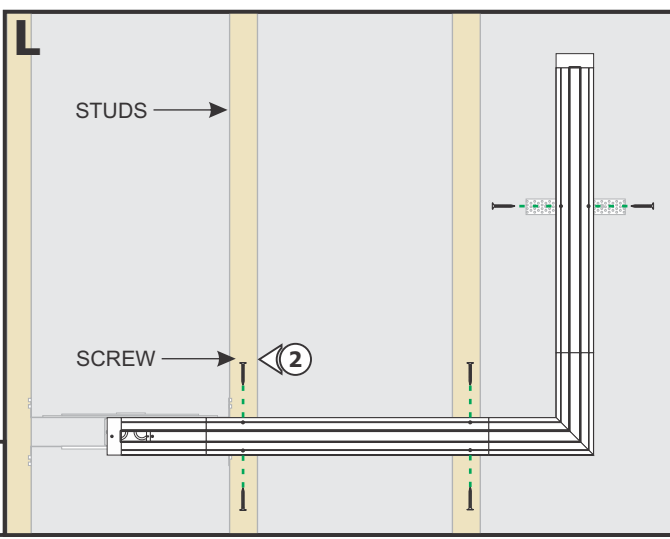

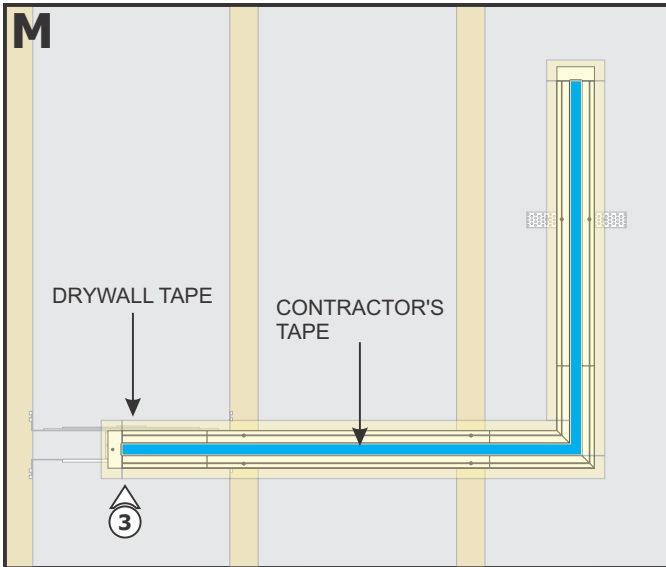

NOTE: Cover the channel opening with blue contractor's tape before plastering.

NOTE: For areas with lots of vibration, it is suggested to use Durabond to avoid cracking of plaster.

NOTE: Do Not use premixed joint compound "Soft Mud." No use compuesto para juntas premezclado "Soft Mud."

3: Must apply drywall tape (Ultra-Thin drywall tape suggested) along edges of channel to prevent cracking of plaster after installation. **DO NOT** overlap strips of drywall tape.

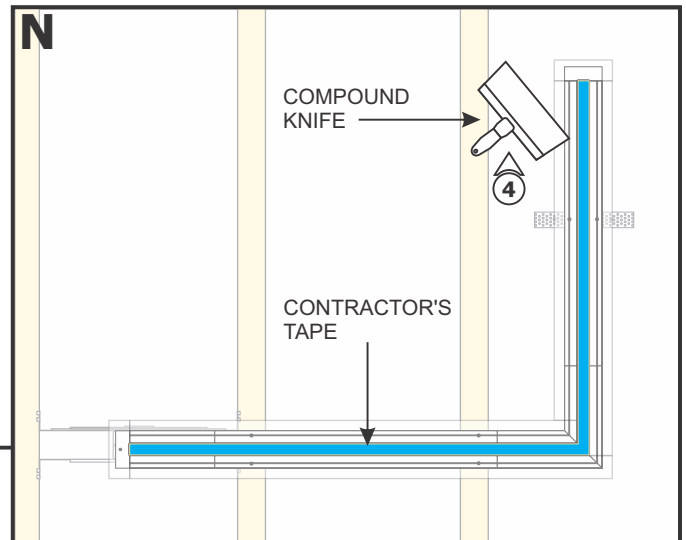

4: Use a compound knife for a smooth compound spread. Sand, paint, and finish the plaster and drywall before removing the blue contractor's tape.

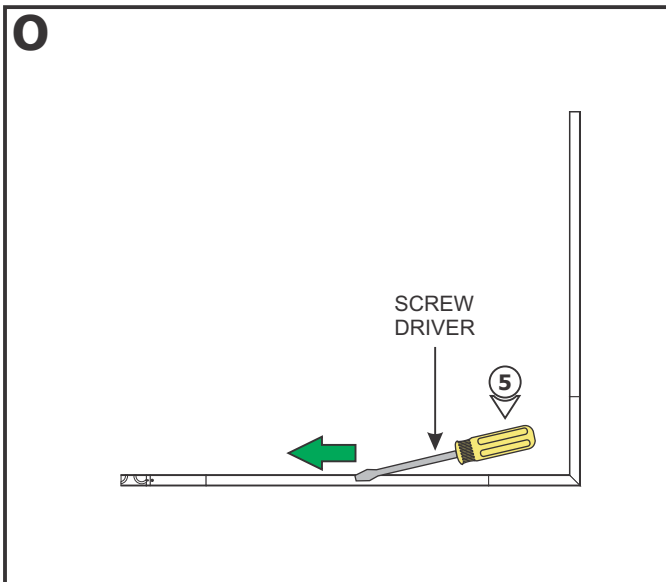

5: Carefully use a flathead screwdriver to remove excess drywall from the internal bevel/edge.

6: Remove the blue contractor's tape from the inside of the channel. Clean the channel surface with alcohol to remove any dust or debris before continuing.

7: Replace the trap door and secure using the #4-40 screw.

NOTE: If installation requires RGB, RGB+W, or Tunable White, refer to wiring diagrams on pages 8-10.

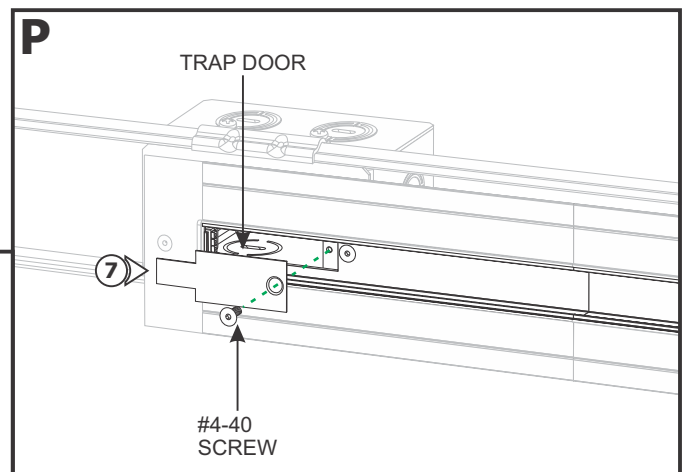

Section Four: Install LED Soft Strip

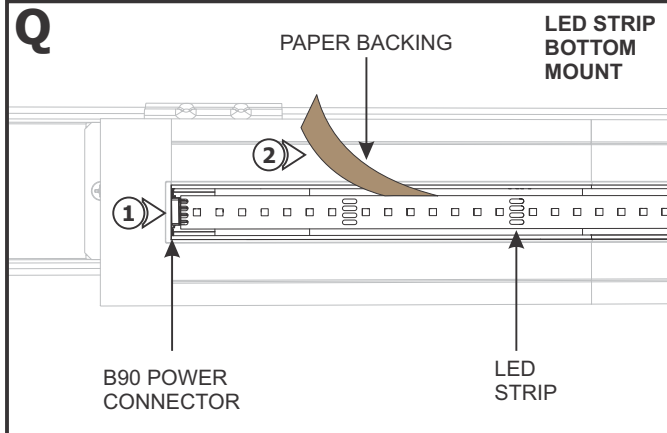

1: Connect the LED strip to the power connector. Refer to instructions provided with the TL1A Power Channel Connectors to connect the LED strip to the desired power connector.

2: Carefully remove the backing from the LED strip, making sure not to remove the tape from the LED strip. Firmly press down the adhesive portion of the LED strip onto the channel surface while removing the rest of the backing, making sure there are no air bubbles that can cause surface irregularities.

NOTE: Refer to page 7 for important information regarding installation and rework of the LED strip.

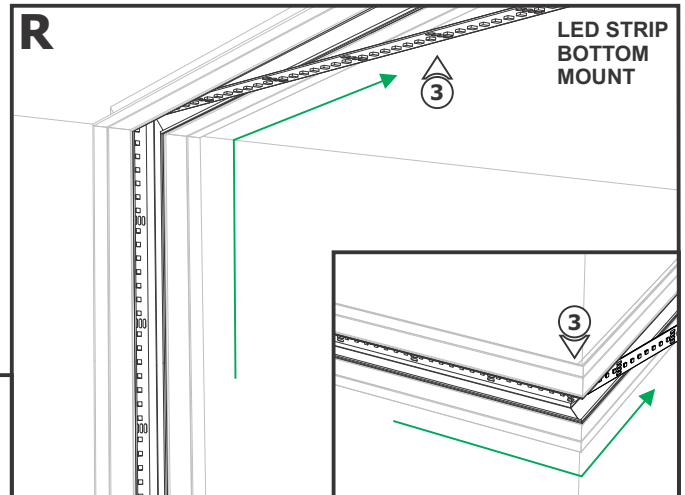
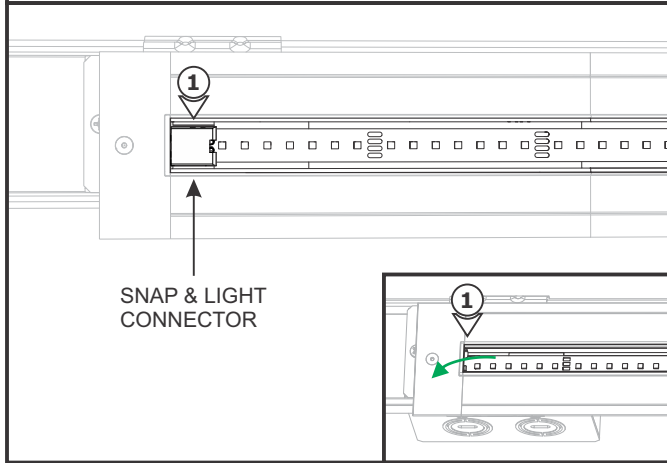

3: For Room Wrapping configurations, bend the LED strip 90° flat on the channel to match the corners. Ensure the entire length of the channel is covered with LED strip to avoid unlit areas.

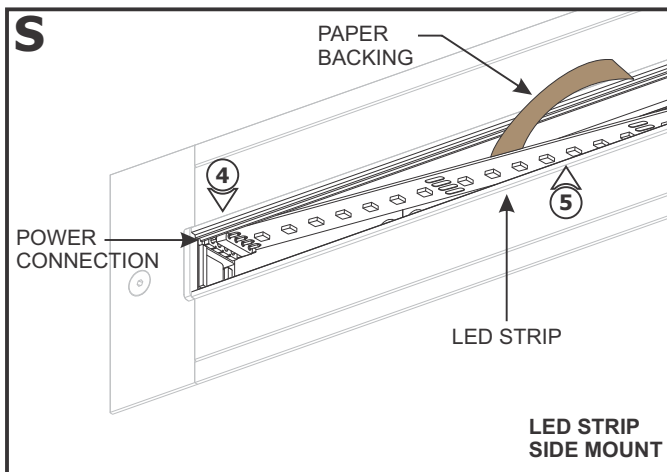

Alternate Power Feed Installation

4: Connect the LED strip to the power connector.

5: Repeat step 2 to properly install the LED strip on the side of the channel.

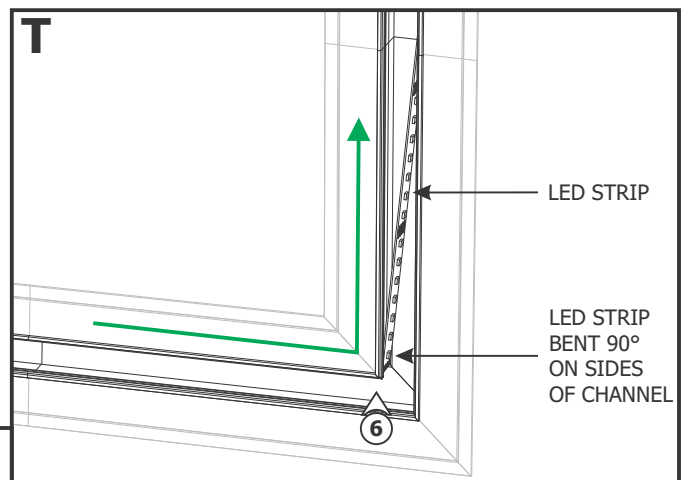

6: For Picture Frame configurations, bend the LED strip 90° on the side of the channel to match the installation corner.

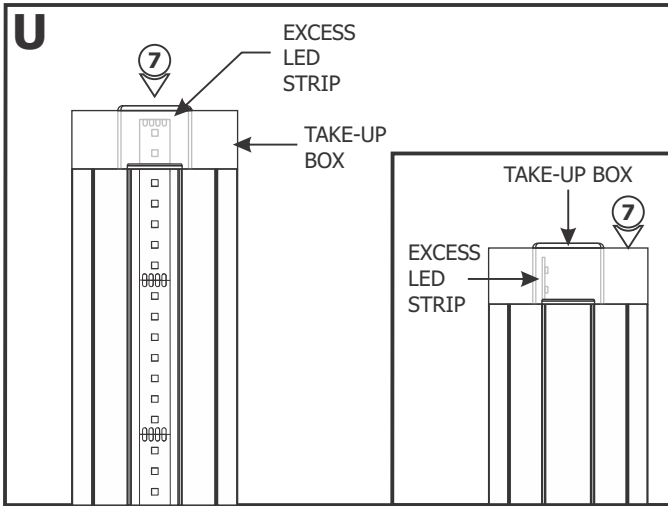

7: If required, trim the LED strip on the dashed cuttable section and place the excess LED strip inside the Take-Up Box. Ensure the entire length of the channel is covered with LED strips to avoid unlit areas.

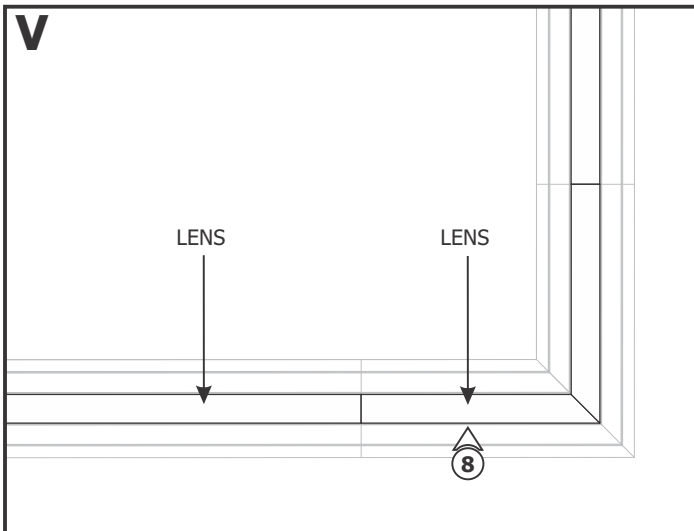

8: Snap the lens onto the channel and connectors. Ensure the lenses are fully seated.

IMPORTANT INFORMATION REGARDING INSTALLATION AND REWORK OF SOFT STRIP LED

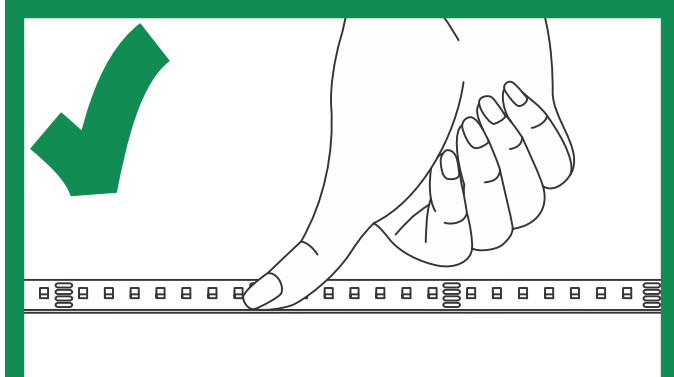
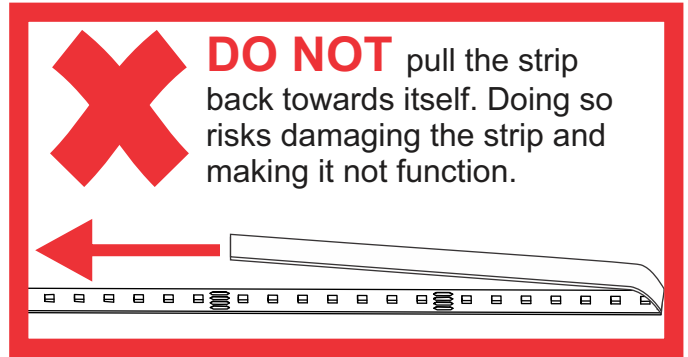
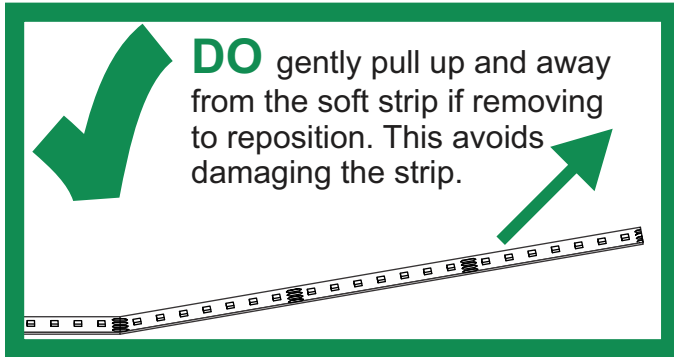

DO only ever use fingers to gently install soft strip to a surface **AFTER** cleaning the surface with alcohol.

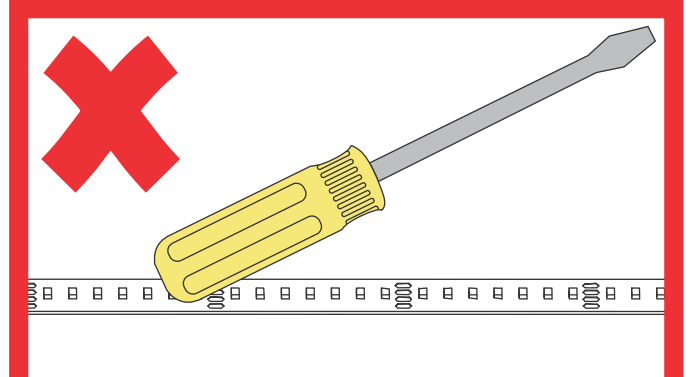

DO NOT use any tool to install soft strip to a surface. This will damage the soft strip component.

Section Five: Relocating Soft Strip (Optional)

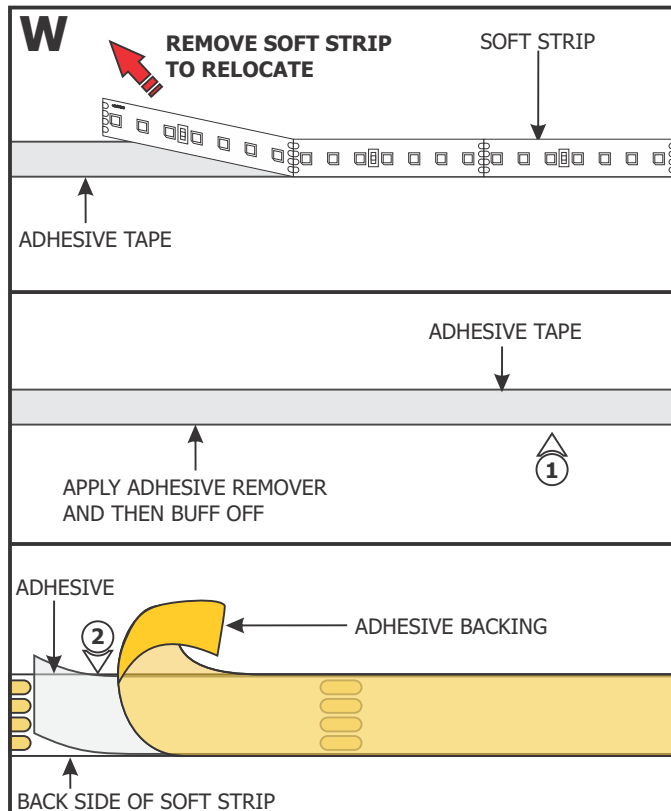

NOTE: If relocating the installed soft strip, make sure that the adhesive tape on back of the soft strip covers the entire strip. The adhesive tape isolates the strip from the installation surface. Damaged or inconsistent adhesive tape may cause the contacts on the back of the strip to come in contact with the conductive heat sink which will cause the strip to short and burn. Call Edge Lighting to get replacement adhesive tape and/or optional aluminum heat sink tape (SS-HR-F).

- 1:** To remove tape residue from back of the strip, apply WD-40, Goo Gone, or a mixture of warm water and lemon oil to the corner of a clean, dry towel. Gently buff the area containing the adhesive residue until it is completely removed.
- 2:** Gently remove a few inches from one side of the tape backing. Attach the adhesive tape to the back of the soft strip and apply moderate pressure to affix the tape. Continue this step a few inches at the time until the entire adhesive tape is attached to back of the soft strip.
- 3:** Refer to Section Four to reinstall the LED soft strip.

Section Six: Wiring Diagrams

General 24VDC Configuration

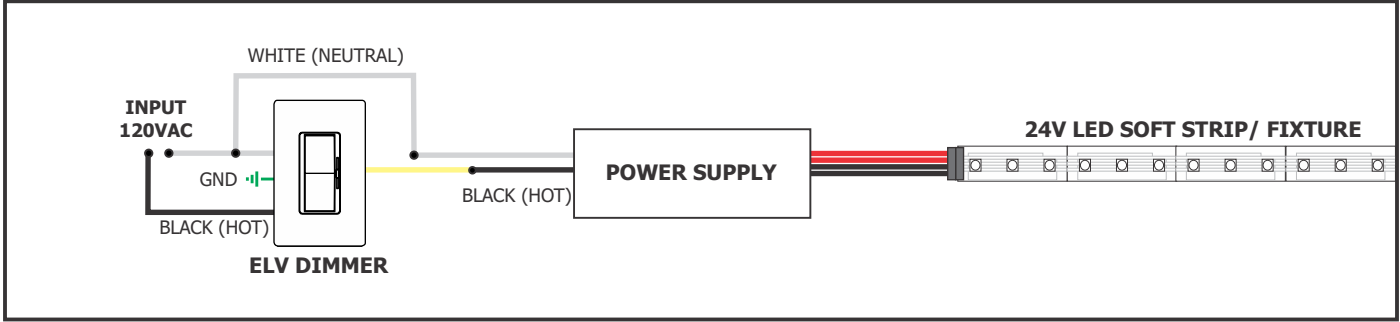

Standard RGB Configuration

Using LED Power Supply with RGB Soft Strip & CDP, CTP or CDMX Control

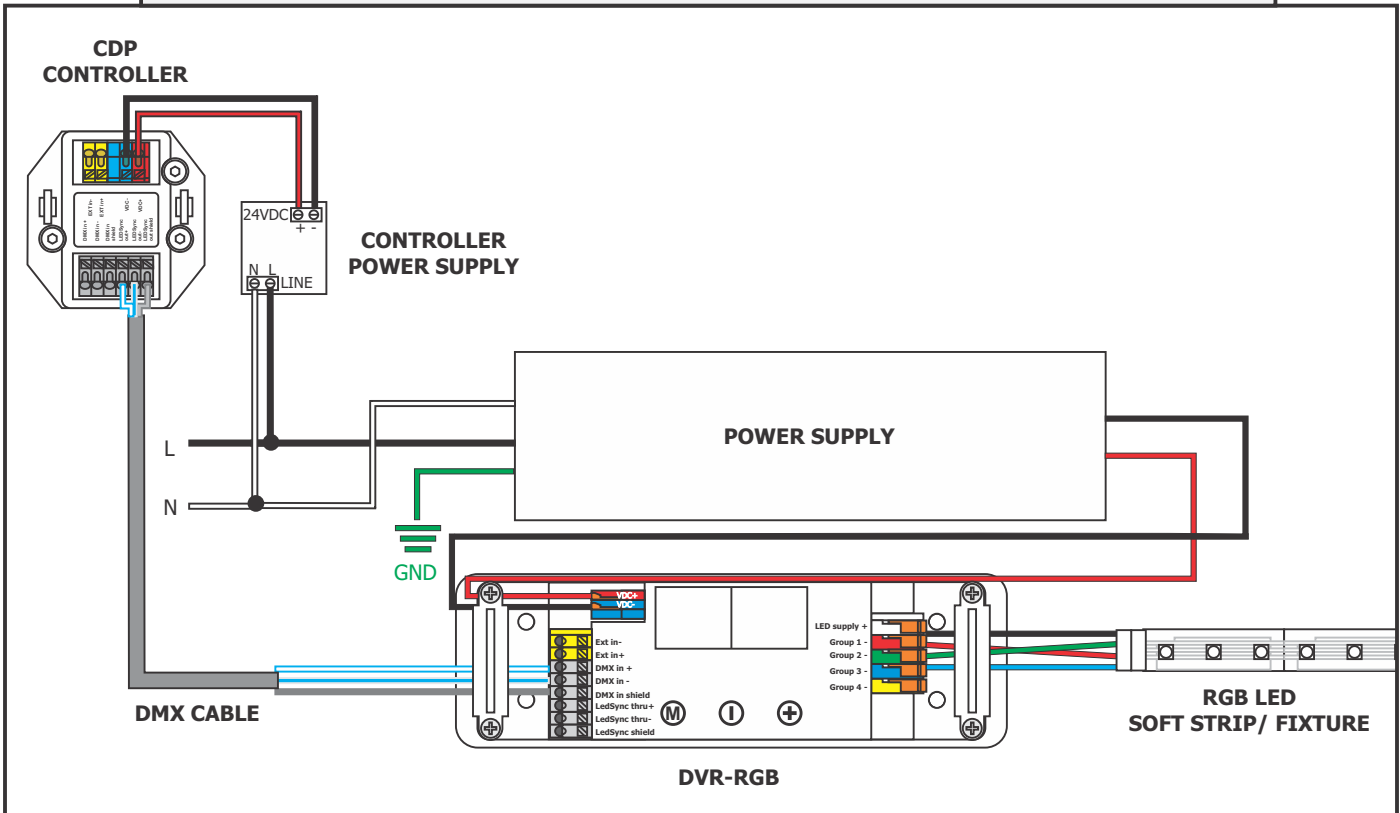

RGB+W Configuration

Using LED Power Supply with RGB+W Soft Strip & CDP, CTP or CDMX Control

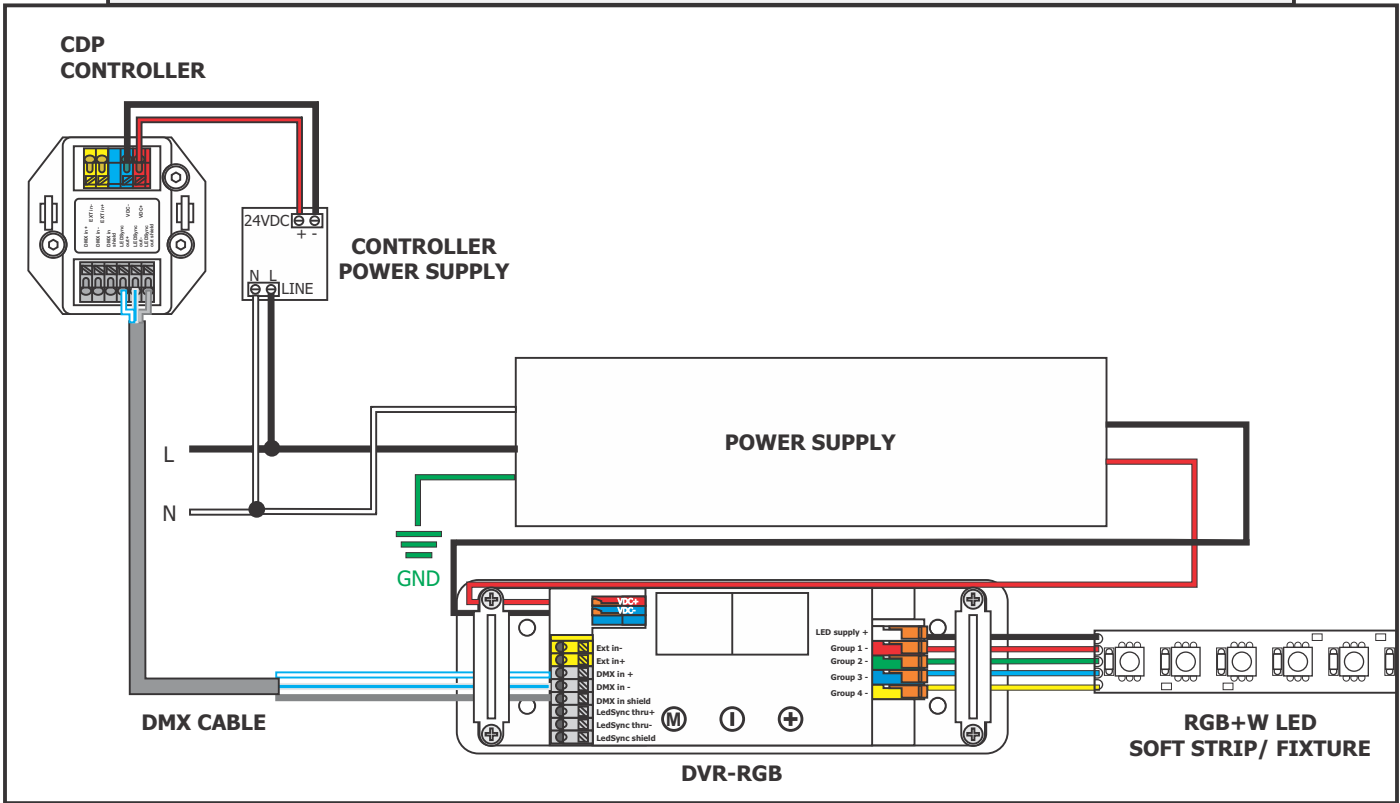

Tunable White Configuration

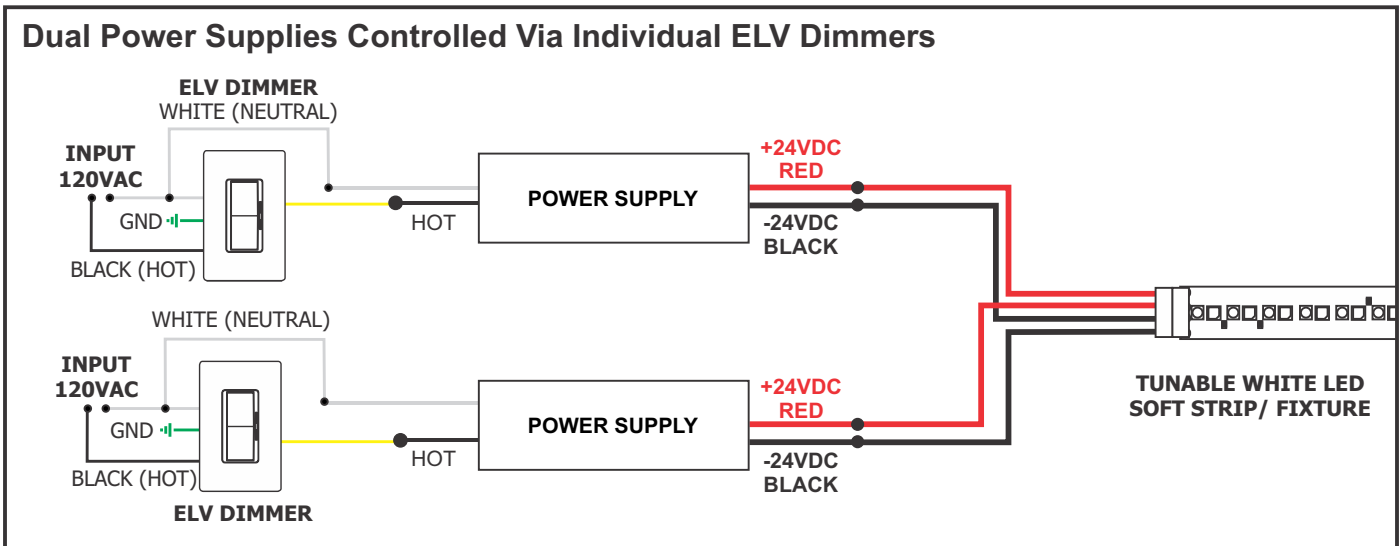

Tunable White Configuration

