



1718 W. Fullerton Chicago, IL 60614
 Ph: 773.770.1195 • Fax: 773.935.5613
 www.PureEdgeLighting.com • info@PureEdgeLighting.com
 © 2016 PureEdge Lighting. All Rights Reserved.

Installation Instructions for Monorail 1" Rigid Standoff

MS-1-

IMPORTANT INFORMATION

- This product is ETL listed for indoor dry locations.
- The product is intended to be used with PureEdge Lighting Monorail systems only.
- Use Monorail standoffs next to where the Monorail sections join together and approximately every 3 feet throughout the Monorail run.

SAVE THESE INSTRUCTIONS!

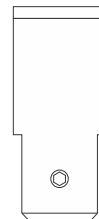

Install the Standoff

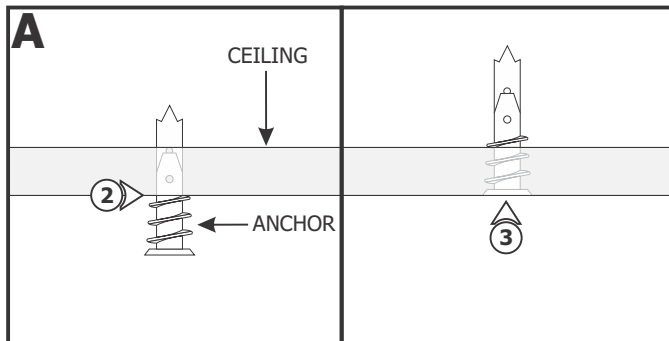

- 1: Hold the Monorail section against the ceiling (this may require more than one person) or use a plumb bob to mark the standoff locations onto the ceiling.
- 2: Tap the anchors onto the marked locations up to the threaded portion with a hammer.
- 3: Screw the threaded portion of the anchors in with a Phillips screwdriver.

4: Mount the standoffs onto the anchors with the #8 screws provided. **Make sure that the cut out portion of the standoffs lines up with the Monorail.**

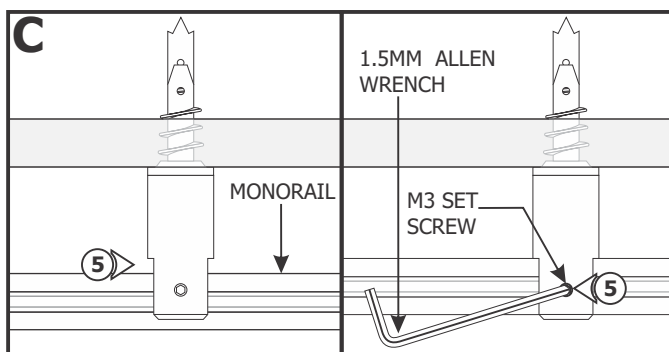
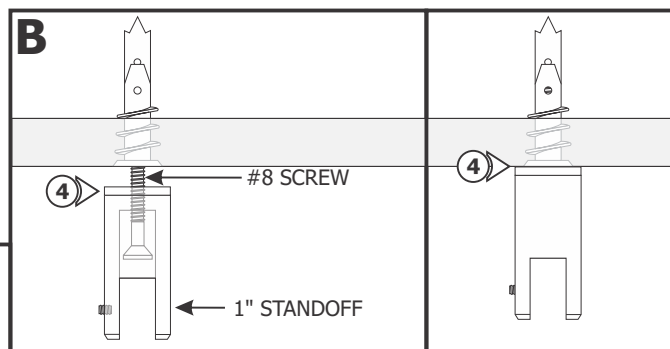

- 5: Slide Monorail into the cut out portion of the standoffs. Hold the Monorail against the standoffs (this may require more than one person) and tighten the M3 set screw on each standoff with the 1.5mm Allen wrench.

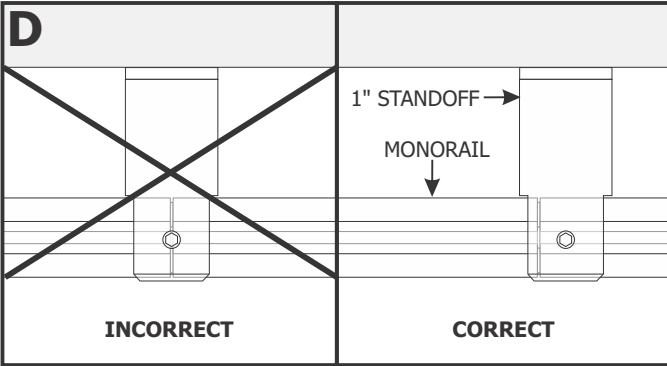

NOTE: Do not install the Monorail 1" standoff directly centered onto where the Monorail sections are joined together. The set screw will come in contact with the conductive joining connectors which will cause a short in the system. The set screw should come into contact with the Monorail insulator to support the rail properly.